

# Land Man Inc. Sketch with Landscaping for Site Plan, Zoning By-Law & Official Plan Amendments

2545 9th Line Road  
 Part Lots 19 and 20, Concession 9  
 Geographic Township of Osgoode  
 CITY OF OTTAWA

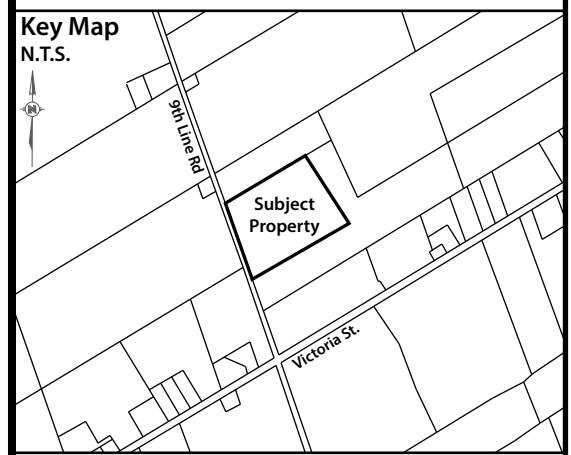

- ### Legend
- Wooded Area
  - Proposed Cedar Trees (Screening)

- ### Notes:
- Phase I of the site plan for the new use will utilize existing on-site buildings for operations. No new buildings and no building demolition is proposed at this time.
  - Open storage will be directed to the concrete area east of the existing timber / concrete block building previously used for mushroom production.
  - Existing driveways and site accesses will be maintained for the proposed use.
  - Screening in the form of cedar trees is proposed along the front of the site. Given surrounding properties are vacant, lands across the road are zoned for mineral aggregates reserve, and the facility is being used as it currently sits no further landscaping is proposed.
  - Boundary and dimensions of the subject property and the locations of all on-site features derived from a topographic plan of survey completed by Callon Dietz in January of 2023.

Version Date: February 1, 2023  
 File No. 22-130 Drawn By: CC  
**ZONDERPLAN**  
 Your rural land planning experts  
 40 Sunset Boulevard, Perth, ON K7H 2Y4 613-264-9600

