

NOTES:

- $f'c = 35 \text{ MPa}$, EXPOSURE CLASS C-1
- REFER TO SITE PLAN FOR ELEVATIONS AND LOCATIONS

1 SECTION: RETAINING WALL
 SK-1 SCALE: 1/2" = 1'-0" HIGH POINT ON BUILDING SIDE



PROJECT NAME AND ADDRESS:
 1591 MICHAEL STREET

DRAWING NAME:
 RETAINING WALL DESIGN - HIGH POINT ON BUILDING SIDE

DESIGNED BY: E.B.
 DRAWN BY: J.L.
 DATE: 2023 02 10
 D+M PROJECT #: 22-075

SK-1

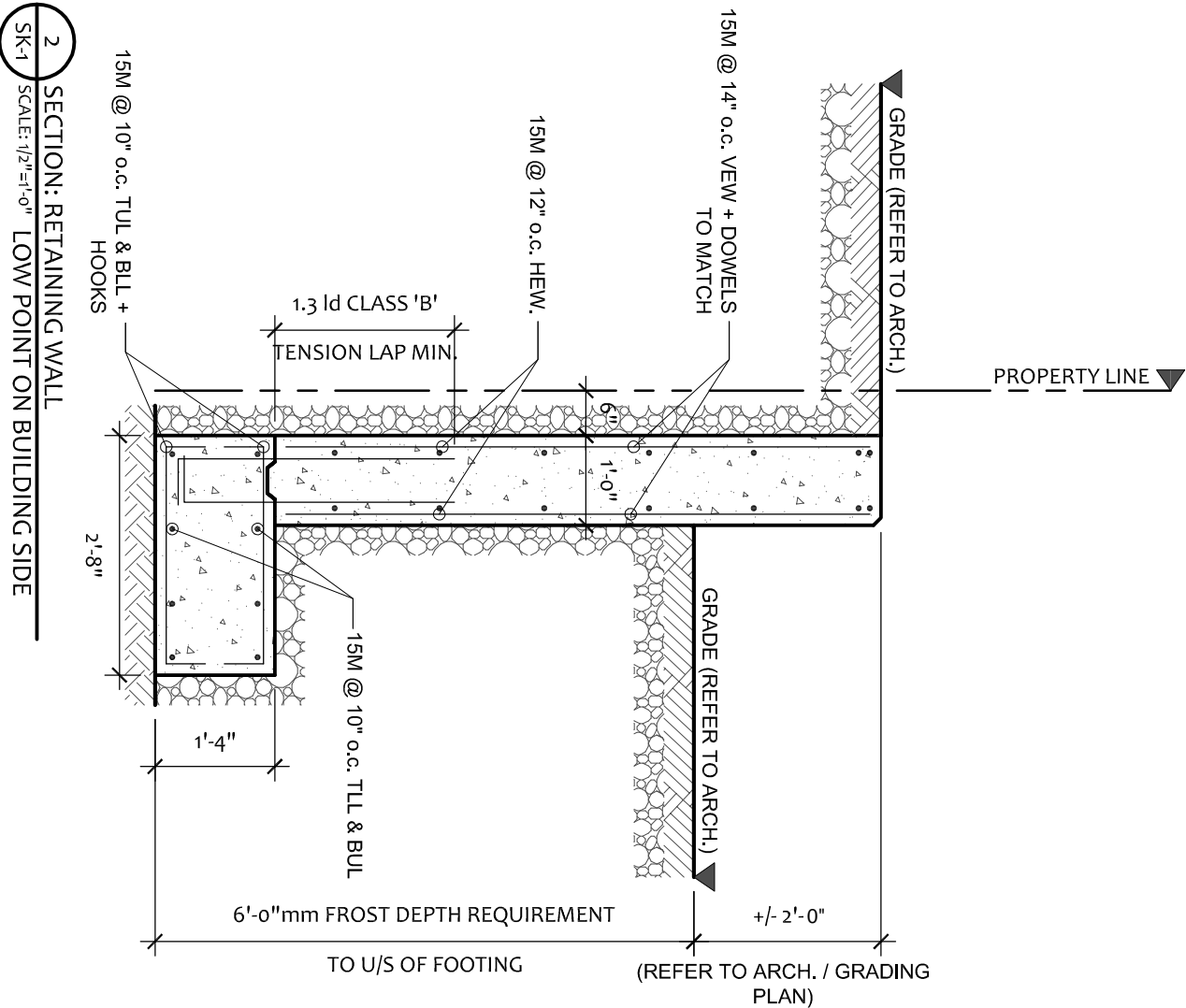

2 SECTION: RETAINING WALL
 SK-1 SCALE: 1/2" = 1'-0" LOW POINT ON BUILDING SIDE