

- LEGEND**
- EXISTING TREE TO REMAIN, SYMBOL SIZE REFLECTS CRZ
 - EXISTING TREE TO REMOVE, SYMBOL SIZE REFLECTS CRZ
 - PROPERTY LIMIT
 - TREE PROTECTION FENCE
- TREE PROTECTION**
- Implement the following protection measures for retained trees, both on site and on adjacent sites, prior to any work activity, including tree removal. Maintain tree protection fence in place and in good condition for the duration of site works:

- GENERAL**
- Read and interpret this drawing/ drawing set in conjunction with all the contract details and specifications, including related civil, utility, structural, architectural, mechanical, electrical, environmental, geotechnical, and survey information.
 - The Contractor is to determine the exact location, size, material, and elevation of all existing utilities prior to commencing construction. Protect and assume responsibility for all existing utilities regardless of being shown on the drawings.
 - It is essential to use the plans and details in conjunction with the specifications and notes.
 - Do not scale drawings. Work to dimensions only.
 - Protect all existing and retained vegetation for the duration of construction according to the contract details and specifications.
 - Reinstate all areas and items damaged or disturbed, beyond the Limit of Work, because of construction activities, including but not limited to construction staging areas, haul roads, stockpile areas, etc. to the satisfaction of the Consultant. Unless otherwise noted, Contractor is to reinstate all areas to pre-construction condition or better to the satisfaction of the Contract Administrator.
- The Landscape Architect or Certified Arborist is to determine the location of the tree protection fence and detail it on any associated plans for the site (e.g. tree conservation report, tree disclosure report, etc.).
 - Under the guidance of a Landscape Architect or Certified Arborist, erect a fence at the critical root zone (CRZ) of trees. Diameter at breast height (DBH) is the trunk diameter measured at 1.3m height on the tree trunk. The CRZ is calculated as DBH x 10. Refer to the Tree Protection Fence detail.
 - Refer to the Tree Protection Plan for fence location. City Forestry Staff are to approve both the plan and the installed fence prior to work commencement.
 - Do not place any material or equipment within 2m of the CRZ of any tree, including outhouses.
 - Do not attach any signs, notices, or posters to any tree.
 - Do not disturb, raise, or lower the existing grade within the CRZ without approval.
 - Only tunnel or bore when digging within the CRZ of a tree. Hand work only where required within the CRZ, absolutely no machinery permitted.
 - Do not damage the root system, trunk, or branches, or any tree.
 - Do not extend hard surface or significantly change landscaping.
 - Ensure that exhaust fumes from all equipment are directed away from any tree canopy.
 - When trees marked for removal overlap with the CRZ of trees marked for preservation: cut roots at the edge of the CRZ and grind down stumps after tree removals, do not pull out stumps. Ensure there is no root pulling or disturbance of the ground within the CRZ.
 - Prior to work taking place, notify and consult the Landscape Architect and City Forestry Staff if roots must be cut. Roots 20mm or larger should be cut at right angles with clean, sharp horticultural tools without tearing, crushing, or pulling. Refer to City of Ottawa Specification S.P. F-8011 Tree Protection, Excavation of Root Zone.
 - If damaged or objectionable branches are observed, consult the Landscape Architect, before any work is conducted. Do not prune leaders. Do not prune more than 1/4 of crown.
 - Set up a water and fertilizing program, if trees are being affected by site works, to the satisfaction of the Landscape Architect.
 - The Landscape Architect is to prescribe mitigation measures if the protected fenced area must be reduced to facilitate construction. Measures may include the placement of plywood, wood chips, or steel plating over the roots for protection. City Forestry Staff are to approve said measures prior to fence movement.
 - City of Ottawa By-law: Protects municipal trees and municipal natural areas in the City of Ottawa and trees on private property in the urban area of the City of Ottawa (2020-340).

EXISTING TREE INVENTORY

No.	Botanical Name	Common Name	DBH (cm)	CRZ (m)	Condition	Owner	Remarks	Recomm.
1	<i>Acer platanoides</i>	Norway Maple	75	7.50	VP	Private on adjoining site	Major internal rot, white face scar, fungus on dead part of wood, 50% dieback of crown	PROTECT
2	<i>Acer rubrum</i>	Red Maple	60	6.00	P	Client	Large limb lost, open wound, internal rot	Conflict
3	<i>Acer rubrum</i>	Red Maple	65	6.50	P	Owned by the City	Multiple wounds, major limb lost, internal rot	Conflict
4	<i>Acer rubrum</i>	Red Maple	87	8.70	P	Client	Major limb lost	Conflict
5	<i>Acer negundo</i>	Manitoba Maple	90	9.00	P	Co-owned (tree on property line)	Barrelling	Conflict
6	<i>Tilia americana</i>	Basswood	52	5.20	F	Client	Multistem, major stem wound, 25% dieback of crown	Conflict
7	<i>Tilia americana</i>	Basswood	32	3.20	F	Client	Crook in main stem	Conflict
8	<i>Tilia americana</i>	Basswood	30	3.00	G	Client	Multistem	Conflict
9	<i>Tilia americana</i>	Basswood	30	3.00	G	Private on adjoining site	Low vigour	Conflict
10	<i>Tilia americana</i>	Basswood	47	4.70	P	Client	Large wound on two sides of trunk, Low vigour, Mechanical damage	Conflict
11	<i>Tilia americana</i>	Basswood	33	3.30	G	Client	Multistem, low vigour	Conflict
12	<i>Tilia americana</i>	Basswood	42	4.20	F	Client	Mechanical damage, exposed wood at base	Conflict
13	<i>Tilia americana</i>	Basswood	46	4.60	P	Client	Low vigour	Conflict
14	<i>Ulmus americana</i>	Elm	62	6.20	P	Client	Dutch Elm disease, Slime Flux	Conflict
15	<i>Tilia americana</i>	Basswood	24	2.40	F	Client	Multistem, Mechanical damage, wounds touching ground	Conflict
16	<i>Tilia americana</i>	Basswood	29	2.90	P	Client	Multiple wounds	Conflict
17	<i>Populus tremuloides</i>	Trembling Aspen	31	3.10	F	Client	Crown dieback, large volume of fill placed within CRZ of tree	Conflict
18	<i>Populus tremuloides</i>	Trembling Aspen	17	1.70	G	Client	Large volume of fill placed within CRZ of tree	Conflict
19	<i>Populus tremuloides</i>	Trembling Aspen	20	2.00	P	Client	Large volume of fill placed within CRZ of tree	Conflict
20	<i>Populus tremuloides</i>	Trembling Aspen	23.0	2.30	P	Client	Large volume of fill placed within CRZ of tree	Conflict
21	<i>Tilia americana</i>	Basswood	39.0	3.90	F	Private on adjoining site	Roots covered in debris, crown dieback	Conflict
22	<i>Ulmus Americana</i>	Elm	49.0	4.90	VP	Private on adjoining site	Very poor vigour. Severe crown dieback, slime flux, internal rot evident	Conflict

Legend

G	Good	Conflict	Remove due to conflict with construction.
F	Fair	Remove	Remove due to tree health or invasive status.
P	Poor	PROTECT	Protect trees as per contract details and specifications.
VP	Very Poor		

NOTE:
THE POSITION OF ALL POLE LINES, CONDUITS, WATERMANS, SEWERS AND OTHER UNDERGROUND AND OVERGROUND UTILITIES AND STRUCTURES IS NOT NECESSARILY SHOWN ON THE CONTRACT DRAWINGS, AND WHERE SHOWN, THE ACCURACY OF THE POSITION OF SUCH UTILITIES AND STRUCTURES IS NOT GUARANTEED. BEFORE STARTING WORK, DETERMINE THE EXACT LOCATION OF ALL SUCH UTILITIES AND STRUCTURES AND ASSUME ALL LIABILITY FOR DAMAGE TO THEM.

Owner:
Roca Homes
c/o Roberto campagna
24 George Street West
Ottawa, ON K1S 3J2
Phone: (613) 851-7523

NOT FOR CONSTRUCTION

No.	REVISION	DATE	BY
2.	REVISED PER CITY COMMENTS	DEC 15/23	RJ
1.	ISSUED FOR SITE PLAN APPLICATION	FEB 13/23	RJ

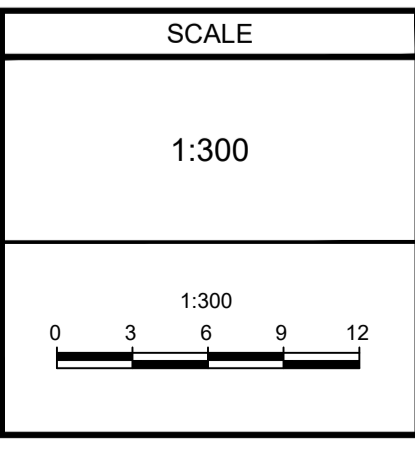

DESIGN	TCB
CHECKED	RGJ
DRAWN	TCB
CHECKED	JP
APPROVED	RGJ

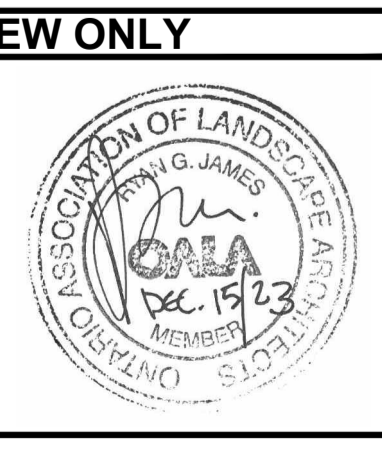

NOVATECH
Engineers, Planners & Landscape Architects
Suite 200, 240 Michael Cowpland Drive
Ottawa, Ontario, Canada K2M 1P6
Telephone: (613) 254-9643
Facsimile: (613) 254-5867
Website: www.novatech-eng.com

LOCATION CITY OF OTTAWA 1591 MICHAEL STREET	
DRAWING NAME TREE CONSERVATION PLAN	
PROJECT No.	122104-00
REV	REV # 2
DRAWING No.	122104-TCR

C:\temp\p\p\122104-00.dwg, TCR, Dec 08, 2023, 1:03pm, barakale

D07-12-23-0017

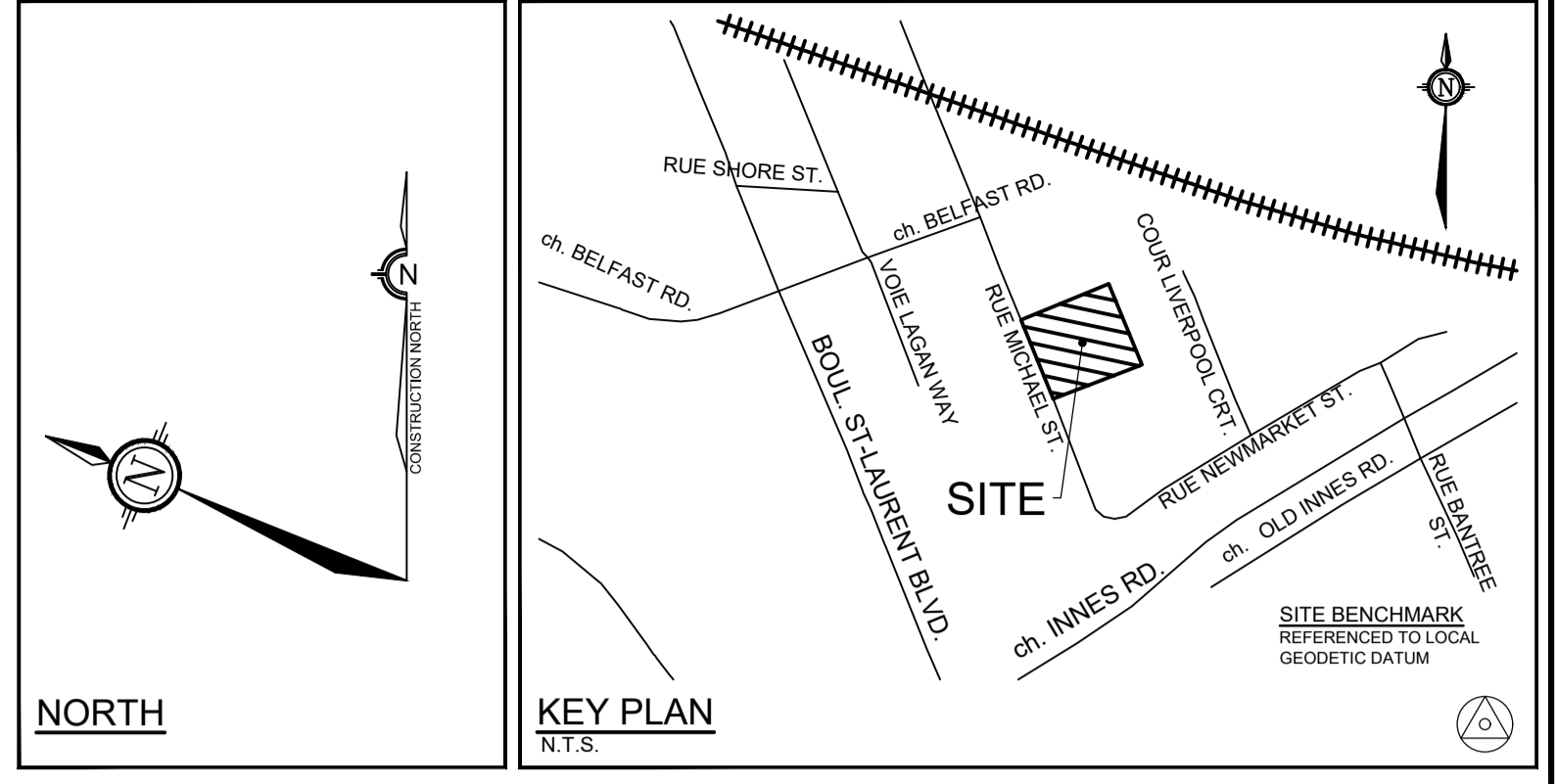
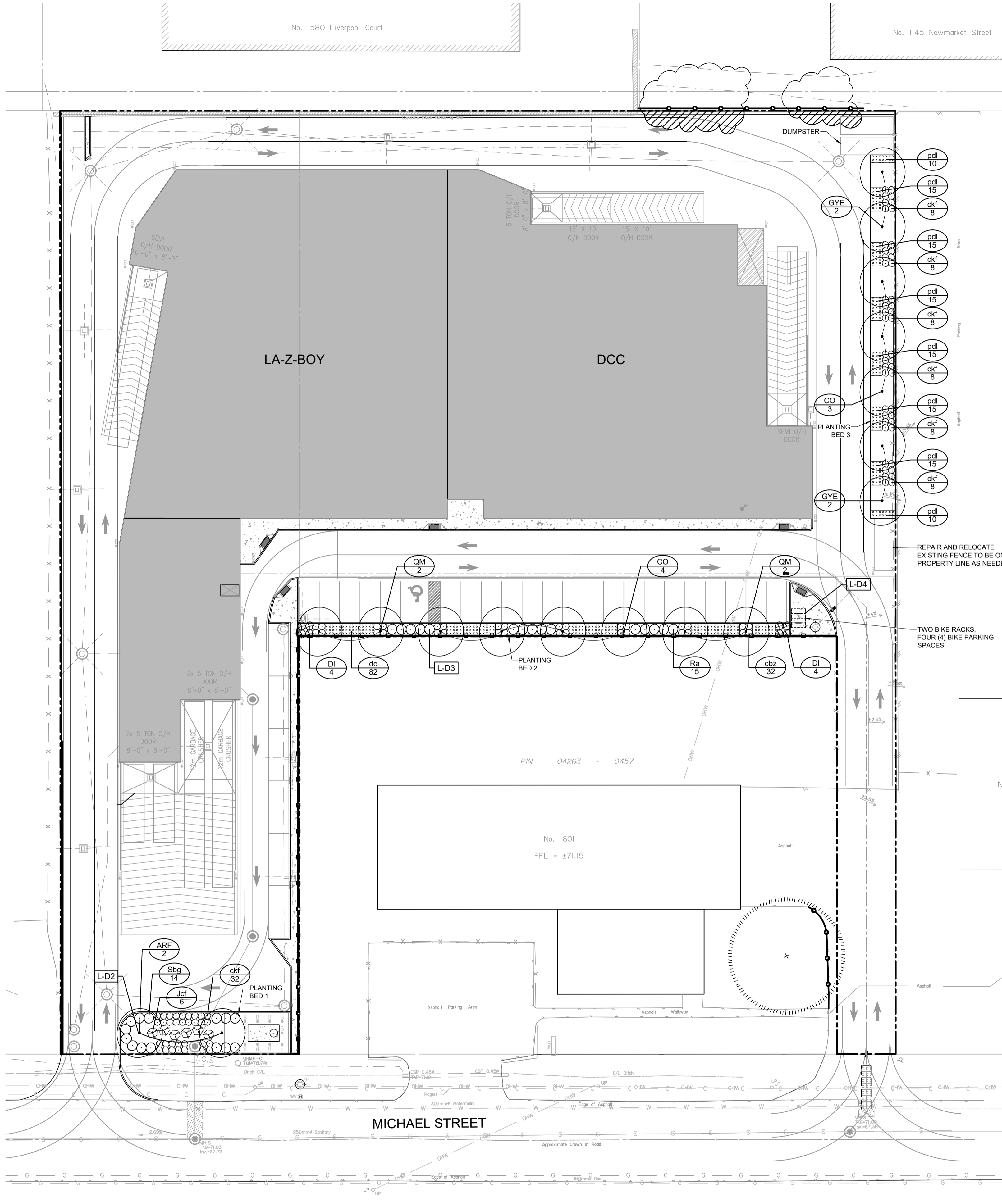
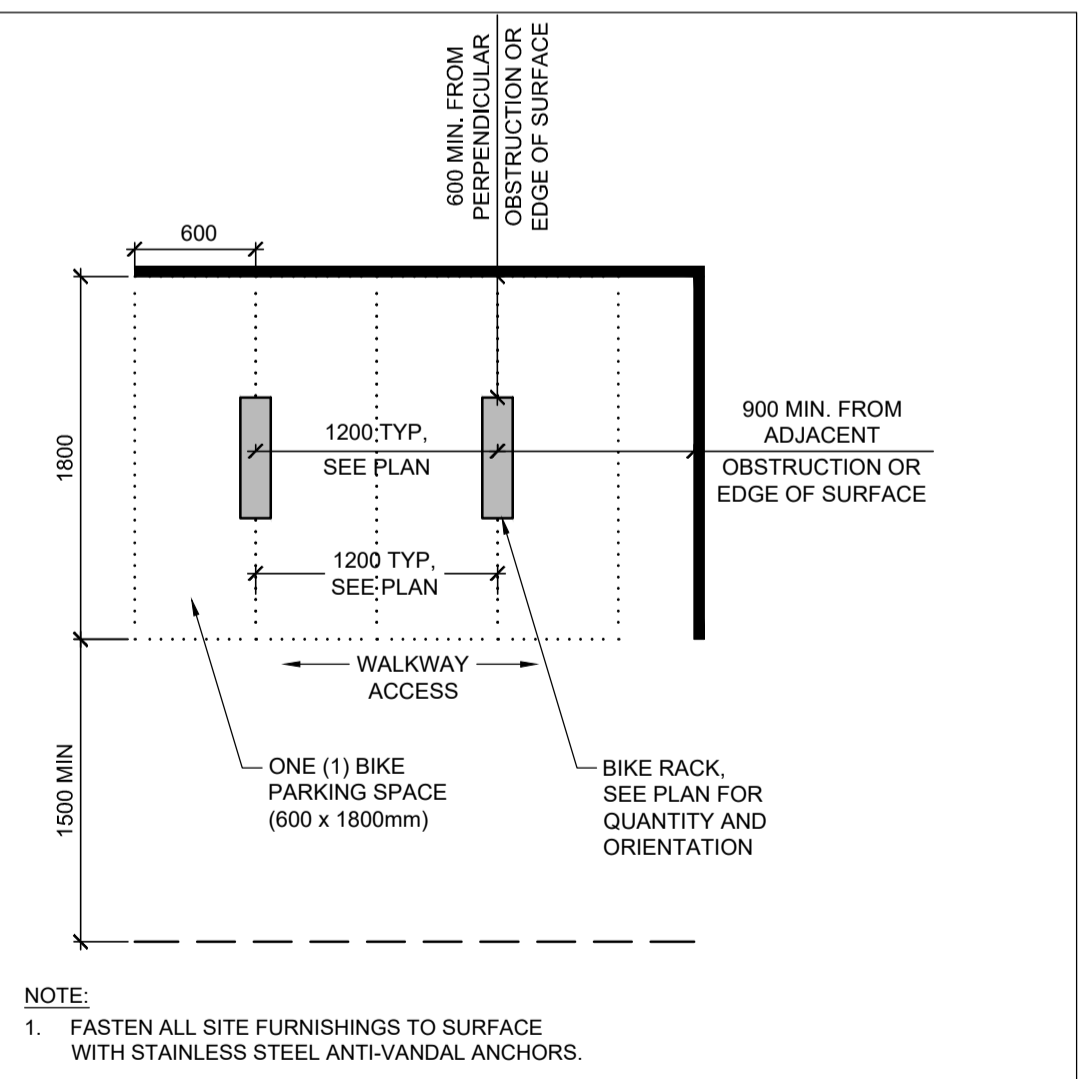
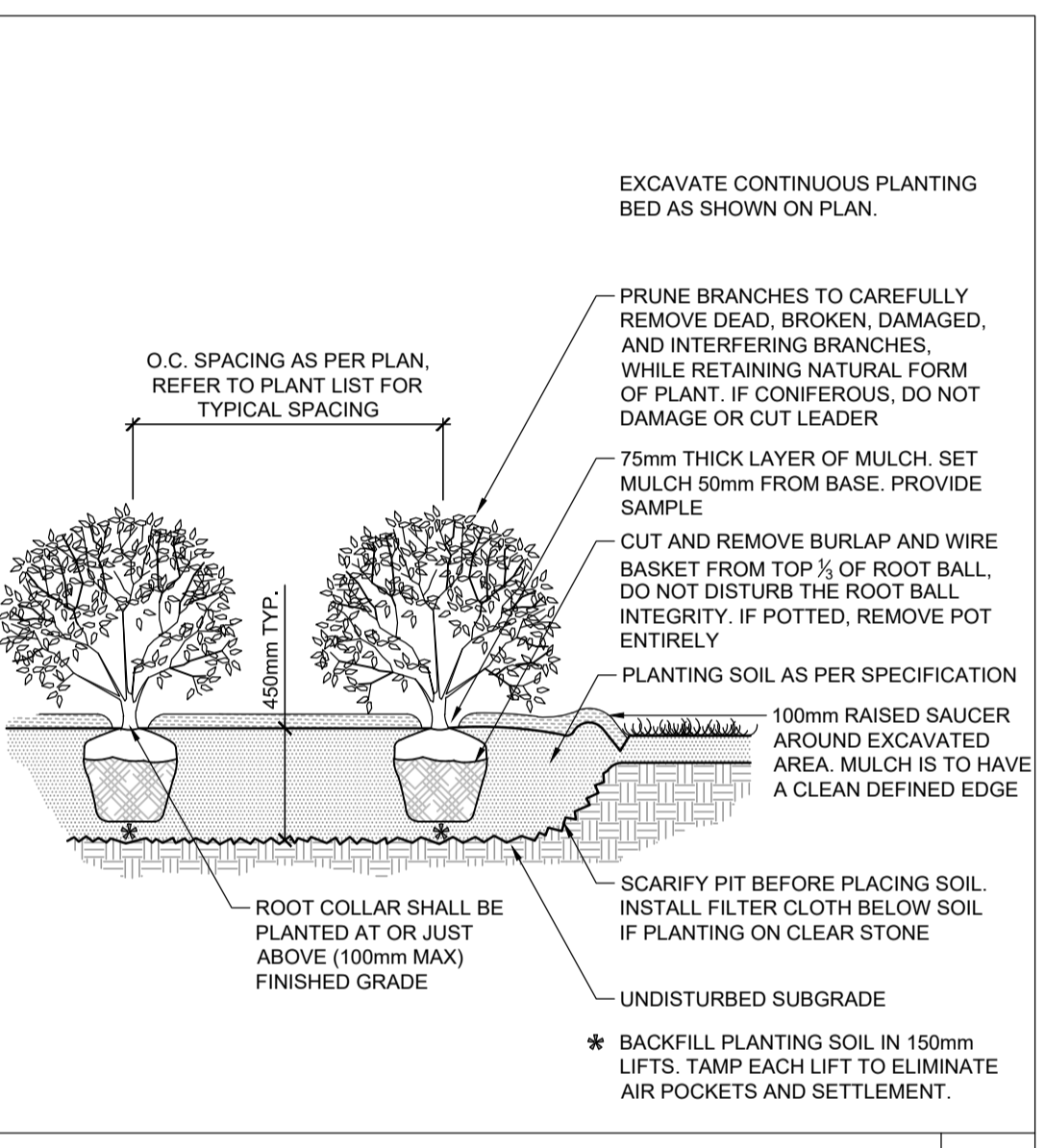
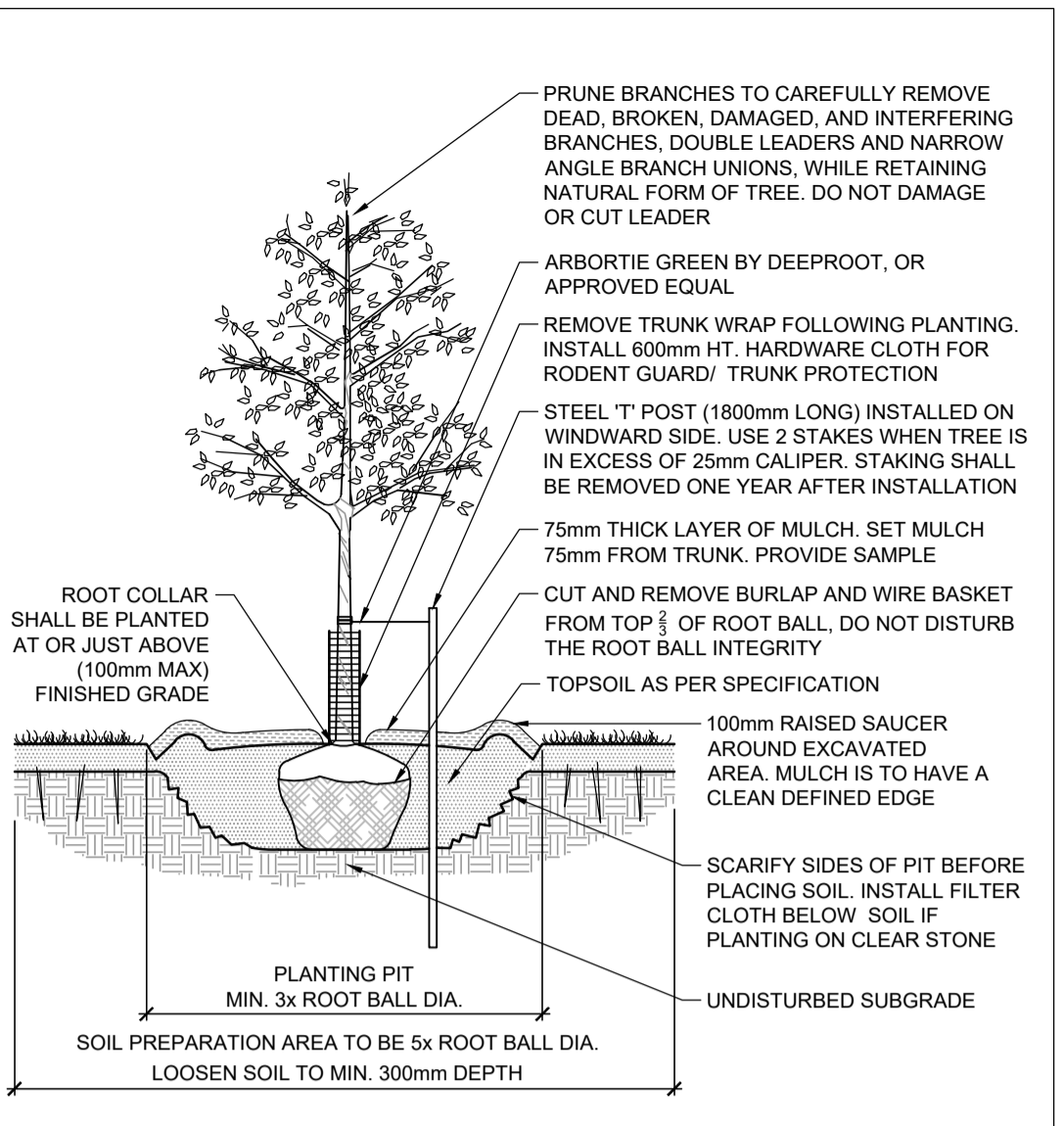

LEGEND

GENERAL

1. Read and interpret this drawing/ drawing set in conjunction with all the contract details and specifications, including related civil, utility, structural, architectural, mechanical, electrical, environmental, geotechnical, and survey information.
2. The Contractor is to determine the exact location, size, material, and elevation of all existing utilities prior to commencing construction. Protect and assume responsibility for all existing utilities regardless of being shown on the drawings.
3. It is essential to use the plans and details in conjunction with the specifications and notes.
4. Do not scale drawings. Work to dimensions only.
5. Protect all existing and retained vegetation for the duration of construction according to the contract details and specifications.
6. Reinstall all areas and items damaged or disturbed, beyond the Limit of Work, because of construction activities, including but not limited to construction staging areas, haul roads, stockpile areas, etc. to the satisfaction of the Consultant. Unless otherwise noted, Contractor is to reinstall all areas to pre-construction condition or better to the satisfaction of the Contract Administrator.

PLANTING

1. Plant material to be No. 1 Grade and is to comply with Canadian Standards for Nursery Stock (latest edition) published by the Canadian Nursery Landscape Association. Use structurally sound plant material with strong fibrous root system free of disease, defects, and injuries. Use trees with straight trunks, well and characteristically branched for species. Obtain approval from consultant of plant material at source prior to digging. All trees and shrubs to be container grown, potted, WB or B/B, as indicated on Plant List. Bare root plants are only acceptable for certain species and as approved by the Landscape Architect.
2. Plant material substitutions are not permitted without the written approval from the Consultant, with 48 hours notice, prior to shipping plant material.
3. Plant locations are schematic / approximate only. Contractor is to stake out locations on site for approval by the Landscape Architect prior to installation.
4. The illustrated number of plants shown in the Planting Plan supersedes the estimated number in the Plant List. Contractor to report any discrepancies to the Landscape Architect prior to installation. Contractor will assume full responsibility if the Landscape Architect is not notified.
5. Ensure trees are thoroughly watered following planting. Monitor material and ensure adequate moisture until acceptance.
6. In heavy clay or poorly drained soils, set root ball with root collar 75-100mm higher than finished grade.
7. Approved topsoil depths are as follows:
 - a. Plant Beds - 450mm continuous depth. Applies to shrubs, perennials, vines, and groundcovers.
 - b. Sod/Seed Areas - 100mm depth.
8. Sod to be No. 1 Kentucky Bluegrass Sod grown from minimum mixture of 3 Kentucky Bluegrass cultivars. Quality and source are to comply with Canadian Standards for Nursery Stock, Section 17, (latest edition) published by the Canadian Nursery Landscape Nursery Landscape Association.
9. Apply the following mineral fertilizer unless soil tests show other requirements:
 - a. Plant Beds - (8-32-16), i.e. 8% Nitrogen, 32% Phosphorus, 16% Potash per manufacturer specifications.
 - b. Sod Areas - (8-32-16), i.e. 8% Nitrogen, 32% Phosphorus, 16% Potash at a rate of 350kg/ha.
10. Where applicable, for any plant areas with a mix of species/ cultivars notes. Contractor is to cluster like plants in groups of 3-5 and evenly distribute these in the noted area.

CITY DETAILS

Related details from City of Ottawa Standard Tender Documents Volume No. 2 Standard Detail Drawings.

SC4. Typical Concrete Sidewalk on Boulevard
SC5. Sidewalk Construction Joints

NOVATECH DETAILS

Found on Sheet TCR
D1. Tree Protection Fence
D2. Deciduous Tree Planting
D3. Shrub and Perennial Planting
D4. Bike Layout

NOTE:
The soil calculations assume an overall 1.0 m of soil depth for all proposed tree planting, which would be approximately 0.5m of topsoil and minimum 0.5m of subsoil. Contractor to verify subsoil conditions prior to tree installation on site and notify any discrepancies to the Landscape Architect and City Forestry staff.

PLANT LIST

KEY	QTY	BOTANICAL NAME	COMMON NAME	SIZE	COND	SPACING
Deciduous Trees						
ARF	2	<i>Acer rubrum 'Autumn Flame'</i>	Autumn Flame Red Maple	50mm Cal	WB	As Shown
GYE	4	<i>Gymnocladus dioica 'Espresso-JFS'</i>	Espresso Kentucky Coffee Tree	50mm Cal	WB	As Shown
CO	7	<i>Celtis occidentalis</i>	Hackberry	50mm Cal	WB	As Shown
QM	4	<i>Quercus macrocarpa</i>	Burr Oak	50mm Cal	WB	As Shown
Coniferous Shrubs						
Jcf	6	<i>Juniperus chinensis 'Fairview'</i>	Fairview Juniper	200cm Ht	WB	150cm O.C.
Deciduous Shrubs						
DI	8	<i>Diervilla lonicera</i>	Bush Honeysuckle	50cm Ht	PT	100cm O.C.
Ra	11	<i>Rhus aromatica</i>	Fragrant Sumac	60cm Ht	PT	120cm O.C.
Sbg	14	<i>Spiraea betulifolia 'Glow Girl' (Tor Gold)</i>	Glow Girl Birchleaf Spirea	60cm Ht	PT	100cm O.C.
Groundcovers & Perennials						
dc	82	<i>Deschampsia cespitosa</i>	Tufted Hair Grass	1g	PT	80cm O.C.
cbz	32	<i>Carex flacca 'Blue Zinger'</i>	Blue Sedge Grass	1g	PT	80cm O.C.
ckf	80	<i>Calamagrostis acutiflora 'Karl Foerster'</i>	Karl Foerster Feather Reed Grass	1g	PT	45cm O.C.
pdl	110	<i>Perovskia atriplicifolia 'Denim 'n Lace'</i>	Denim 'n Lace Russian Sage	1g	PT	60cm O.C.

NOTE:
THE POSITION OF ALL POLE LINES, CONDUITS, WATERMANS, SEWERS AND OTHER UNDERGROUND AND OVERGROUND UTILITIES AND STRUCTURES IS NOT NECESSARILY SHOWN ON THE CONTRACT DRAWINGS, AND WHERE SHOWN, THE ACCURACY OF THE POSITION OF SUCH UTILITIES AND STRUCTURES IS NOT GUARANTEED. BEFORE STARTING WORK, DETERMINE THE EXACT LOCATION OF ALL SUCH UTILITIES AND STRUCTURES AND ASSUME ALL LIABILITY FOR DAMAGE TO THEM.

Owner:
Roca Homes
c/o Roberto Campagna
24 George Street West
Ottawa, ON K1S 3J2
Phone: (613) 851-7522

NOT FOR
CONSTRUCTION

No.	REVISION	DATE	BY
2.	REVISED PER CITY COMMENTS	DEC 15/23	RJ
1.	ISSUED FOR SITE PLAN APPLICATION	FEB 13/23	RJ

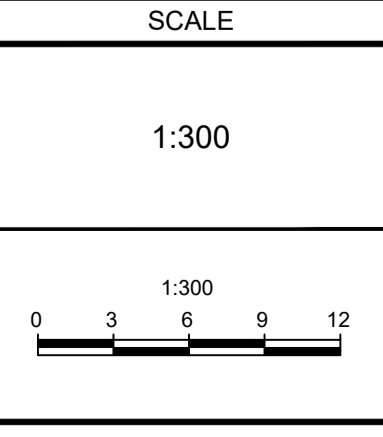

DESIGN	TCB
CHECKED	RGJ
DRAWN	TCB
CHECKED	RGJ
APPROVED	RGJ

FOR REVIEW ONLY

NOVATECH
Engineers, Planners & Landscape Architects
Suite 200, 240 Michael Cowpland Drive
Ottawa, Ontario, Canada K2M 1P6

Telephone: (613) 254-9643
Facsimile: (613) 254-5867
Website: www.novatech-eng.com

LOCATION
CITY OF OTTAWA
1591 MICHAEL STREET

DRAWING NAME
LANDSCAPE PLAN

PROJECT No.	122104-00
REV	REV # 2
DRAWING No.	122104-L1

#18942

C:\temp\p\p\122104-00.dwg, L1, Dec 08, 2023, 1:03pm, hankale

D07-12-23-0017