

CONTRACTOR TO ESTABLISH ANOTHER BENCHMARK AS THE FIRE HYDRANT IS BEING RELOCATED

SITE BENCHMARK TOP OF SPINDLE ELEV. 64.02

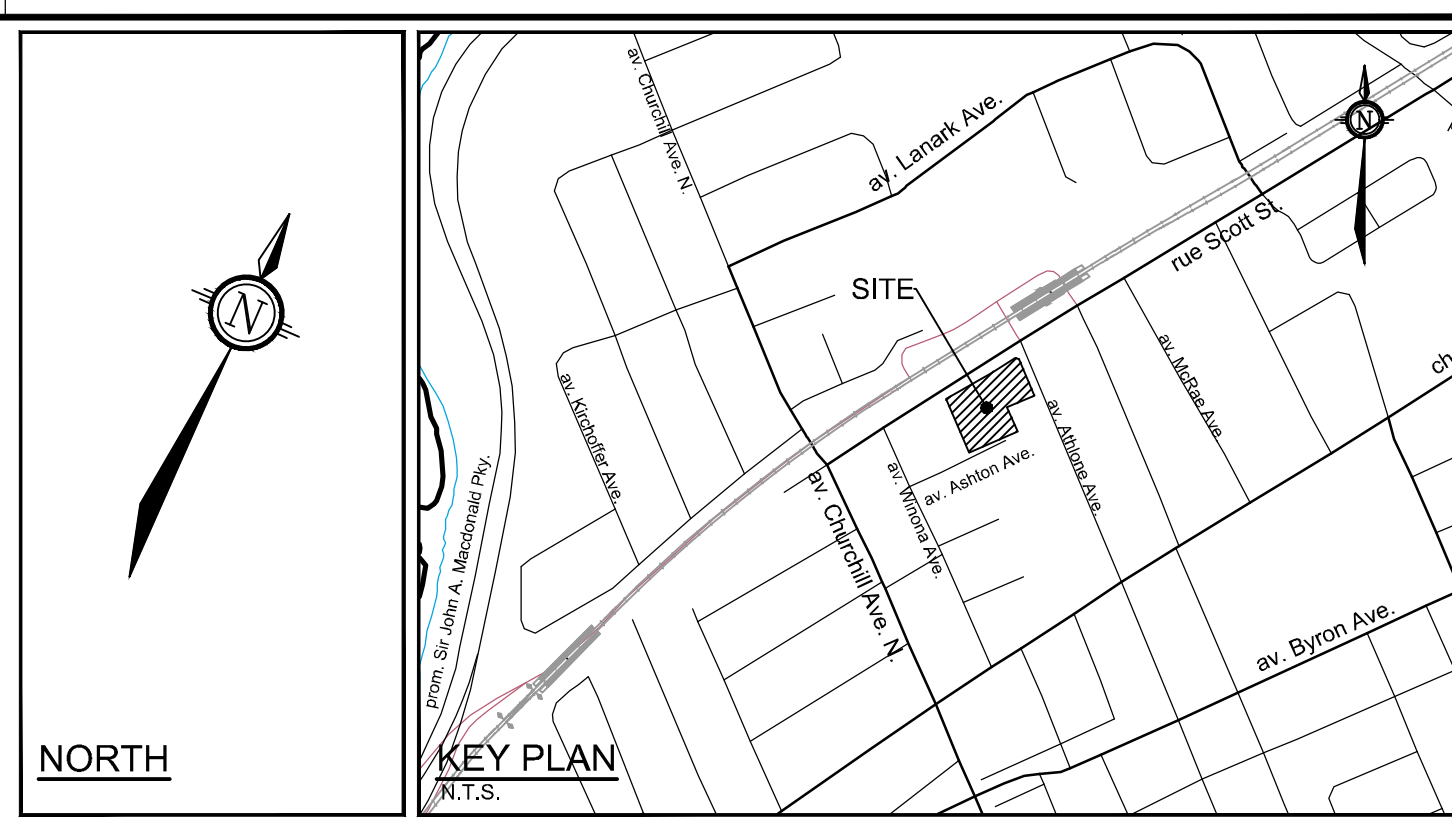

LEGEND

- REMOVALS**
- X REMOVALS
 - EXISTING CONCRETE CURB
 - V&V EXISTING VALVE & VALVE BOX
 - SP EXISTING SERVICE POST
 - HYD EXISTING HYDRANT
 - CBM# EXISTING CATCHBASIN
 - CB EXISTING CATCHBASIN#
 - EX UP EXISTING UTILITY POLE
 - CW GUY WIRES
 - EXISTING TREES / VEGETATION

GENERAL NOTES:

- COORDINATE AND SCHEDULE ALL WORK WITH OTHER TRADES AND CONTRACTORS.
- DETERMINE THE EXACT LOCATION, SIZE, MATERIAL AND ELEVATION OF ALL EXISTING UTILITIES PRIOR TO COMMENCING CONSTRUCTION. PROTECT AND ASSUME RESPONSIBILITY FOR ALL EXISTING UTILITIES WHETHER OR NOT SHOWN ON THIS DRAWING.
- ALL ELEVATIONS ARE GEODETIC.

BENCHMARK NOTES:

- ELEVATIONS SHOWN ARE GEODETIC AND ARE REFERRED TO THE CGVD28 GEODETIC DATUM. DERIVED ARE DERIVED FROM A SITE BENCHMARK AS SHOWN ON P6 HAVING AN ELEVATION OF 64.02.
- IT IS THE RESPONSIBILITY OF THE USER OF THIS INFORMATION TO VERIFY THAT THE JOB BENCHMARK HAS NOT BEEN ALTERED OR DISTURBED AND THAT ITS RELATIVE ELEVATION AND DESCRIPTION AGREES WITH THE INFORMATION SHOWN ON THIS DRAWING.
- BENCHMARK WAS PROVIDED ON PLAN OF SURVEY OF PART OF LOT 60 AND ALL OF LOTS 61 & 62, REGISTERED PLAN 263 AND PART OF LOT 31, CONCESSION 1 (OTTAWA FRONT), SURVEYED BY STANTEC GEOMATICS LTD.
- NEW BENCHMARK TO BE ESTABLISHED BY SURVEYOR PRIOR TO CONSTRUCTION TO REPLACE EXISTING BENCHMARK ON FIRE HYDRANT THAT WILL BE RELOCATED.

NOTE: THE POSITION OF ALL POLE LINES, CONDUITS, WATERMANS, SEWERS AND OTHER UNDERGROUND AND OVERGROUND UTILITIES AND STRUCTURES IS NOT NECESSARILY SHOWN ON THE CONTRACT DRAWINGS, AND WHERE SHOWN, THE ACCURACY OF THE POSITION OF SUCH UTILITIES AND STRUCTURES IS NOT GUARANTEED. BEFORE STARTING WORK, DETERMINE THE EXACT LOCATION OF ALL SUCH UTILITIES AND STRUCTURES AND ASSUME ALL LIABILITY FOR DAMAGE TO THEM.

OWNER INFORMATION
 HOPPNER HOLDINGS INC.
 1818 BRADLEY SIDE ROAD,
 CARP, ONTARIO K0A 1L0
 KEN HOPPNER
 PHONE: 613-831-5490
 khoppner@morleyhoppner.com

No.	REVISION	DATE	BY
2.	REVISED PER CITY COMMENTS	OCT 16/23	FST
1.	ISSUED FOR SPC APPLICATION	FEB 22/23	FST

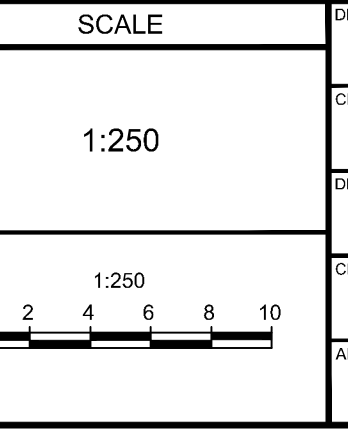

DESIGN	CV
CHECKED	FST
DRAWN	CV
CHECKED	FST
APPROVED	FST

FOR REVIEW ONLY



NOVATECH
 Engineers, Planners & Landscape Architects
 Suite 200, 240 Michael Cowpland Drive
 Ottawa, Ontario, Canada K2M 1P6
 Telephone (613) 254-9643
 Facsimile (613) 254-5867
 Website www.novatech-eng.com

LOCATION CITY OF OTTAWA 2020 SCOTT STREET	PROJECT No. 121302
DRAWING NAME EXISTING CONDITIONS AND REMOVALS PLAN	REV #2 REV
	DRAWING No. 121302-REM

D07-12-23-0019
PLAN #18976