



GENERAL NOTES

- A. CONTRACTOR SHALL BE GENERALLY RESPONSIBLE FOR SUPPLY AND INSTALLATION OF THE FOLLOWING, INCLUDING BUT NOT LIMITED TO:
 - CONCRETE ENCASED PRIMARY DUCTBANK FROM PADMOUNTED SERVICE TRANSFORMER TO PROPERTY LINE
 - LINEAR LENGTH OF 30MM HIGH VOLTAGE CABLES TO BE PROVIDED BY HYDRO ONE AS PART OF UTILITIES
 - PRIMARY DUCTBANK MANHOLE
 - TRANSFORMER BOLLARDS INCLUDING GROUNDING GRID, PROTECTIVE BOLLARDS, ETC. (TRANSFORMER TO BE PROVIDED BY HYDRO ONE, PRIMARY AND SECONDARY TERMINATIONS BY HYDRO ONE)
 - CONCRETE ENCASED SECONDARY DUCTBANK AND SERVICE CONDUCTIONS FROM PADMOUNTED SERVICE TRANSFORMER INTO BUILDING.

DRAWING NOTES

- 1. PROVIDE 3 PHASE TRANSFORMER FOUNDATION AS PER HYDRO ONE STANDARD. CONFIRM FOUNDATION SPECIFICATION WITH HYDRO UTILITIES PRIOR TO PURCHASE/INSTALLATION. PROVIDE TRANSFORMER GROUND GRID USING 20 BARE STRANDED COPPER 4.0 (W/ 1.34" STEEL GALVANIZED GROUND ROD AS PER HYDRO ONE STANDARD. ENSURE 2 GROUNDING TAILS ARE LEFT IN THE FOUNDATION WITH SUFFICIENT LENGTH OF 20 BARE COPPER WIRE FOR FENCE LOCK & THE CONNECTION TO THE GROUNDING BAR ON PANEL UTILITIES INSTALLED TRANSFORMER. REFER TO DETAILS ON E-003 FOR PROTECTIVE BOLLARDS, GROUNDING REQUIREMENTS.
- 2. REFER TO HYDRO ONE STANDARD FOR CONCRETE ENCASED DUCT BANK & 1240 FOR DIRECT BURIED CONCRETE ENCASEMENT OF DUCTS TO BE STORIED FROM TRANSFORMER FOUNDATION. COORDINATE INSTALLATION OF PRIMARY DUCTS & FOUNDATION WITH HYDRO UTILITIES AND GIVE MINIMUM 5 BUSINESS DAYS FOR INSPECTOR PRIOR TO BACKFILLING.
- 3. CONTRACTOR SHALL PROVIDE SECONDARY CABLES FROM THE TRANSFORMER TO THE MEB. PROVIDE SUFFICIENT LENGTH OF WIRE IN THE TRANSFORMER BASE FOR A PROPER FROST LOCK AND INSTALL TO THE SECONDARY SPACES.
- 4. PRIMARY CABLES SUPPLIED & INSTALLED BY HYDRO UTILITIES. REFER TO OTC IN SPECIFICATION 26.24.01.01 APPENDIX FOR SCOPE DELINEATION.
- 5. CONTRACTOR SHALL PROVIDE THE ENTIRE PRIMARY & SECONDARY DUCT BANKS IN CONCRETE ENCASEMENT UP TO THE PROPERTY LINE. REFER TO DETAIL IN DRAWING E-003.
- 6. POLE MOUNTED LIGHTING WITH PHOTOCELLS. REFER TO EXTERIOR LIGHTING CONTROL WIRING DIAGRAM ON E-003 FOR DETAILS.
- 7. PROVIDE 15A 120V DIRECT CONNECTION VIA CONTROL CIRCUIT INDICATED FOR PERMANENT BUILDING SIGNAGE. ALSO INCLUDE FOR EMPTY PVC CONDUIT BACK TO COMMUNICATIONS ROOM FOR FUTURE DATA CABLING (TYPICAL 1 LOCATION).
- 8. USE DIRECT BURIED "CABLE IN CONDUIT" INSTALLATION FOR THE INSTALLATION OF POWER AND CONTROL WIRING FOR OUTDOOR SIGNAGE. REFER TO DETAIL 4-01 DRAWING E1-02.
- 9. APPROXIMATE LOCATION OF NEW GENERATOR. REFER TO SPECIFICATIONS, PROTECTIVE BOLLARDS FOR GENERATOR WILL BE PROVIDED UNDER ARCHITECTURAL SCOPE. REFER TO ARCHITECTURAL DRAWINGS AND COORDINATE INSTALLATION WITH GENERAL CONTRACTOR. ENSURE MIN. 15MM FROM TANGS, SPACED NO MORE THAN 150MM APART AND ENSURE CORNER COVERAGE.
- 10. LIGHTING CONDUIT IN RACEWAY (PVC CONDUIT) TO BE 30MM DEPTH INTO CONCRETE. CROSS OTHER SERVICES PERPENDICULAR AND MAINTAIN 30MM CLEARANCE. ARBITRARY GROUPING SHOWN FOR POLE FITURES. PRESUME EACH FEED FROM THE BUILDING CAN HANDLE LOAD AND VOLTAGE DROP BUT WILL NEED TO BE CHECKED/VALIDATED AS REQUIRED.
- 11. ONE CIRCUIT FOR EACH RECEPTACLE AND GROUP OF BOLLARDS TO CLOSEST PANEL. TRENCH DETAIL FOR COURTYARD BELOW 450MM DEPTH.

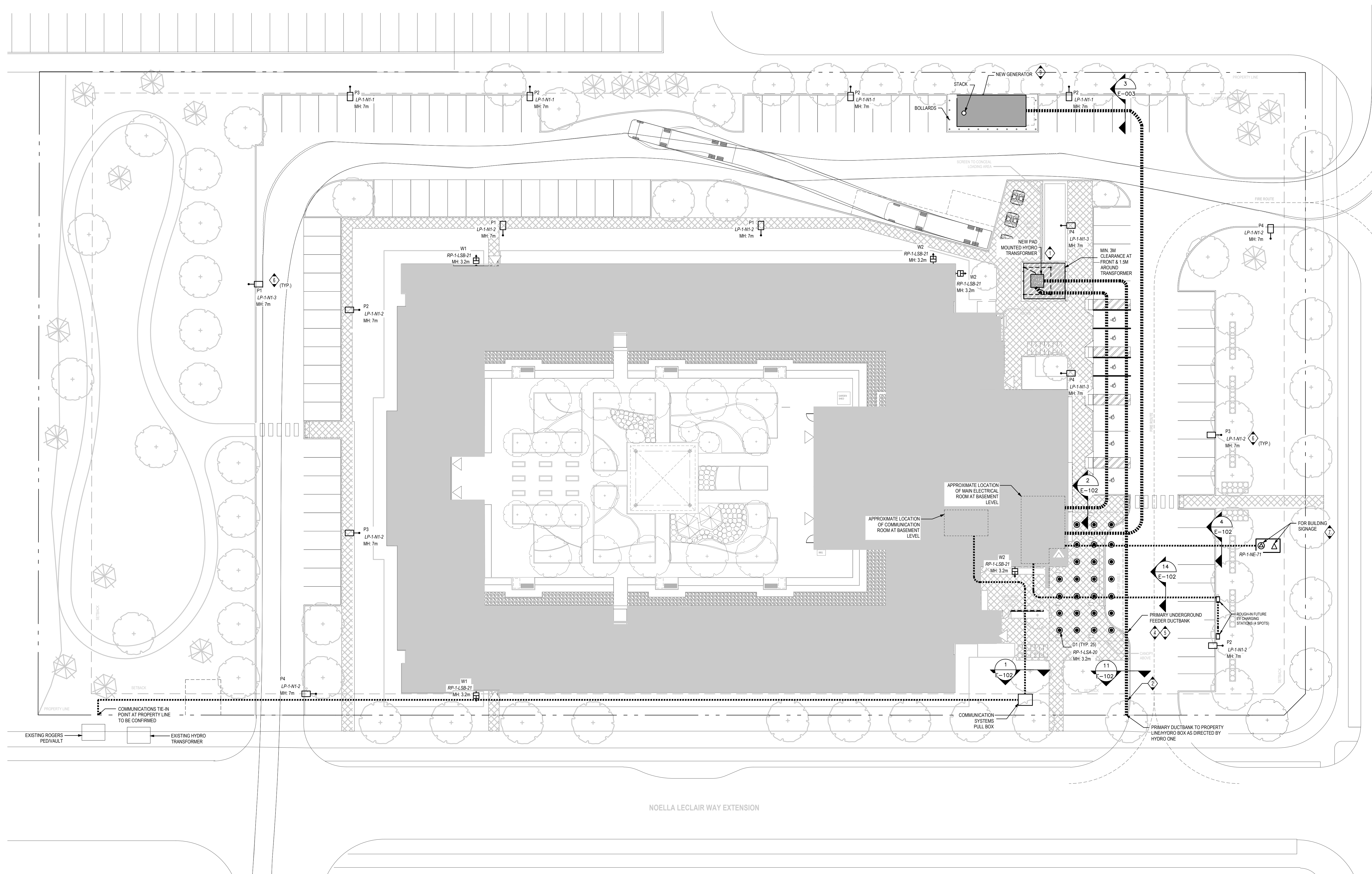

1 ELECTRICAL SITE PLAN
E-002 1:250

3 JUN 2023	ISSUED FOR SPA SUBMISSION	CB
2 MAY 2023	ISSUED FOR IAL TO WORKING DRAWING SUBMISSION	CB
1 FEB 2023	ISSUED FOR SITE PLAN APPLICATION	CB
#	DATE:	REVISION:

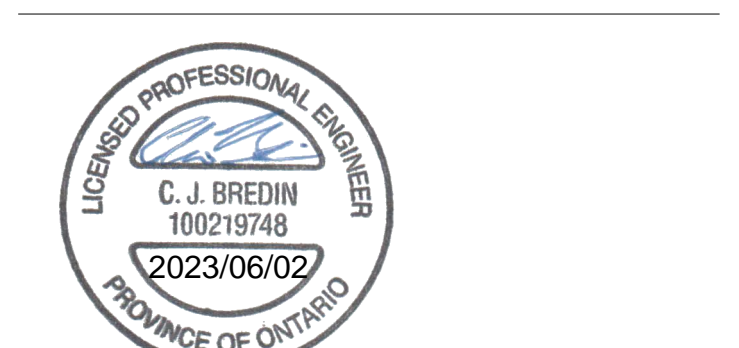

Extendicare Orleans

1045 Noella Leclair Street
Ottawa, ON

SITE PLAN - ELECTRICAL

scale: GTABS
drawn by: JP
reviewed by: ALL-22015422-AD
job number: ALL-22015422-AD
plot date: 2022/01/31
drawing number:

E-101

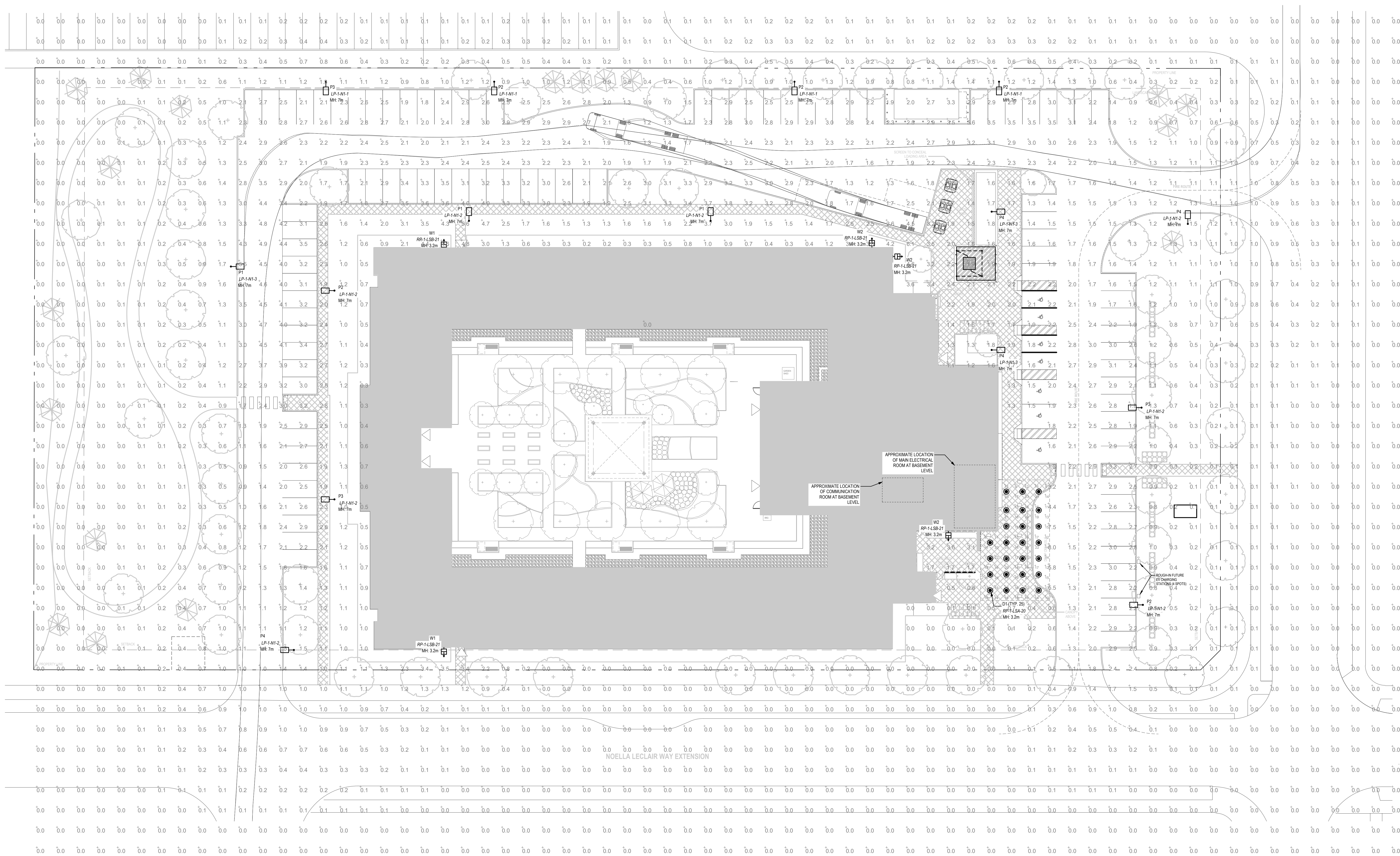

1 PHOTOMETRIC LIGHTING SITE PLAN
E-04 1/20

Luminaire Schedule								
Qty	Label	Arrangement	Description	LLF	Luminaire Lumens	Luminaire Watts	Arrangement Watts	Total Watts
25	D1	Single	LFR-4RD-M-15L40K8MD-DM1_LFR-4RD-T-S	0.850	1497	11.8	11.8	295
2	W1	Single	RWL1-48L-25-4K7-3	0.850	3731	28	28	56
3	W2	Single	RWL1-48L-25-4K7-4W	0.850	3679	28	28	84
3	P1	Single	VP-1-160L-100-4K7-2	0.850	13963	97.2	97.2	291.6
4	P2	Single	VP-1-160L-100-4K7-3	0.850	14109	97.2	97.2	388.8
4	P3	Single	VP-1-160L-100-4K7-4W	0.850	13847	97.2	97.2	388.8
4	P4	Single	VP-1-160L-100-4K7-5QW	0.850	14178	97.2	97.2	388.8

Calculation Summary								
Label	Units	Avg	Max	Min	Avg/Min	Max/Min	PtSpcLr	PtSpcTb
All CalcPts Extending Out To	Fc	0.72	8.0	0.0	N.A.	N.A.	10	10
Zero Foot-Candles								
Main Canopy	Fc	17.43	27	8	2.05	3.22	5	5
StatArea - Parking Areas	Fc	3.00	27.0	0.2	15.00	135.00		

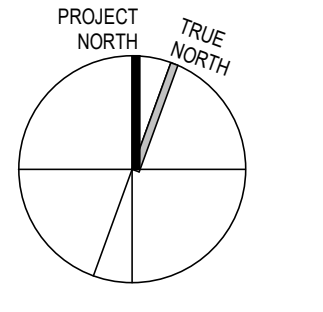

A:\work\Draw\22026_Extendicare Orleans\ALL-22016422-AD_Extendicare Orleans_ELEC.dwg 01/02/23 11:31 AM