



STM STRUCTURE TABLE						
NAME	RIM ELEV.	INVERT IN	INVERT IN AS-BUILT	INVERT OUT	INVERT OUT AS-BUILT	DESCRIPTION
CBMH01	86.27	W82.995		E82.975		1200# OPSD 701.010
CBMH02	86.12	E83.843 S83.394		N83.374		1200# OPSD 701.010
CBMH03	86.40		E83.121			1500# OPSD 701.011
CBMH04	86.27	W83.068		E83.048		1200# OPSD 701.010
CBMH05	86.40	W82.932		S82.912		1500# OPSD 701.011
CBMH09	86.13	W84.594		S83.500		1200# OPSD 701.010
CBMH14	86.40		W83.834			1200# OPSD 701.010
CBMH20	86.13		W83.956			1200# OPSD 701.010
EXCBMH11	86.55	W82.454 S82.423		E82.423		1200# OPSD 701.010
EXCBMH12	83.92		E82.621			1200# OPSD 701.010
EXMH1	86.39	W82.266 E82.145		N82.015		1200# OPSD 701.010
EXMH49	86.63	W84.590		N82.577		1200# OPSD 701.010
EXMH50	86.48	S82.315		W82.285		1200# OPSD 701.010
EXMH51	83.19	S81.821				1200# OPSD 701.010
MH10	86.66	SW83.168 SE83.213		N83.063		1200# OPSD 701.010
MH11	86.44	E83.738		N83.408		1200# OPSD 701.010
MH12	86.38		N83.774			1200# OPSD 701.010
MH16	86.67	S82.917		N82.434		1200# OPSD 701.010
MH17	86.56	S83.190 W82.335		E82.355		1200# OPSD 701.010
MH18	86.17	W83.317 S83.242		NE83.212		1200# OPSD 701.010
MH19	86.54	N84.793		E83.498		1200# OPSD 701.010
MH21	86.28	S83.670 W83.986 N83.670		E83.610		1200# OPSD 701.010
MH22	86.23	E84.666 NW84.711		S83.681		1200# OPSD 701.010
MH25	86.55	SW84.378 E83.512		NE83.461		1200# OPSD 701.010
MH26	86.23	S83.674		NW83.341		1200# OPSD 701.010
MH75	88.91	W83.483 E83.463		N83.403		1200# OPSD 701.010

SAN STRUCTURE TABLE						
NAME	RIM ELEV.	INVERT IN	INVERT IN AS-BUILT	INVERT OUT	INVERT OUT AS-BUILT	DESCRIPTION
EXMH1A	86.43	E83.993		N83.963		1200# OPSD 701.010
EXMH2A	86.44	S84.146		W84.116		1200# OPSD 701.010
EXMH03A	86.58			N84.408		1200# OPSD 701.010
EXMH9A	86.57			NW84.453		1200# OPSD 701.010
EXSANMH	84.70					1200# OPSD 701.010
MH1A	86.28	W83.914 S83.594		N83.894		1200# OPSD 701.010
MH2A	86.66	SW84.330		N84.310		1200# OPSD 701.010
MH4A	86.50	S84.113		E84.093		1200# OPSD 701.010
MH5A	86.38	W84.033 S84.073		E84.013		1200# OPSD 701.010
MH7A	86.53	S84.123		N84.103		1200# OPSD 701.010
MH8A	86.67	S84.165		N84.145		1200# OPSD 701.010
MH11A	86.62			N84.324		1200# OPSD 701.010
MH28A	86.68	NW84.435 SE84.435		N84.415		1200# OPSD 701.010
MH29A	86.69	W84.559		SE84.499		1200# OPSD 701.010

WATERMAIN SCHEDULE					
Station	Description	Finished Grade	Top of Watermain	As Built Watermain	
A 0+000.00	VB	86.700	84.30		
0+005.00	TVS	86.096	84.30		
0+007.69	V BEND	86.096	84.30		
0+007.94	V BEND	86.680	83.94		
0+008.57	11 1/4 BEND	86.644	83.94		
0+010.19	V BEND	86.607	83.94		
0+010.44	V BEND	86.601	84.20		
0+012.84	200-100RED	86.545	84.15		
0+018.11	VB	86.468	84.07		
0+025.81	HYD	86.360	83.96		
0+030.17	V BEND	86.296	83.90		
0+035.65	45 BEND	86.393	83.99		
0+040.02	V BEND	86.511	84.15		
0+042.26	45 BEND	86.588	84.19		
0+047.69	V BEND	86.754	84.38		
0+101.32	45 BEND	86.644	84.24		
0+102.94	45 BEND	86.576	84.18		
0+105.12	V BEND	86.470	84.07		
0+105.37	V BEND	86.469	83.62		
0+107.62	V BEND	86.467	83.62		
0+107.87	V BEND	86.431	84.03		
0+109.38	3' DEFLECTION	86.407	84.01		
0+113.52	VB	86.298	83.90		
0+115.65	HYD	86.443	84.04		
0+119.95	VB	86.507	84.11		
0+129.99	22 1/2 BEND	86.304	83.90		
0+129.22	11 1/4 BEND	86.363	83.96		
0+132.92	45 BEND	86.568	84.17		
0+161.75	VB	86.754	84.35		
0+192.02	22 1/2 BEND	86.516	84.12		
0+197.24	22 1/2 BEND	86.38	83.98		
0+202.90	22 1/2 BEND	86.242	83.84		
0+207.70	VB	86.134	83.73		
0+211.74	HYD	86.222	83.62		
0+214.68	VB	86.298	83.50		
0+218.12	11 1/4 BEND	86.328	83.63		
0+218.27	200-150RED	86.39	83.99		
0+219.72	TEE	86.419	84.02		
0+222.04	V BEND	86.444	84.04		
0+222.29	V BEND	86.446	83.30		
0+224.59	V BEND	86.453	83.30		
0+224.84	V BEND	86.454	84.05		

JEANNE D'ARC BLVD

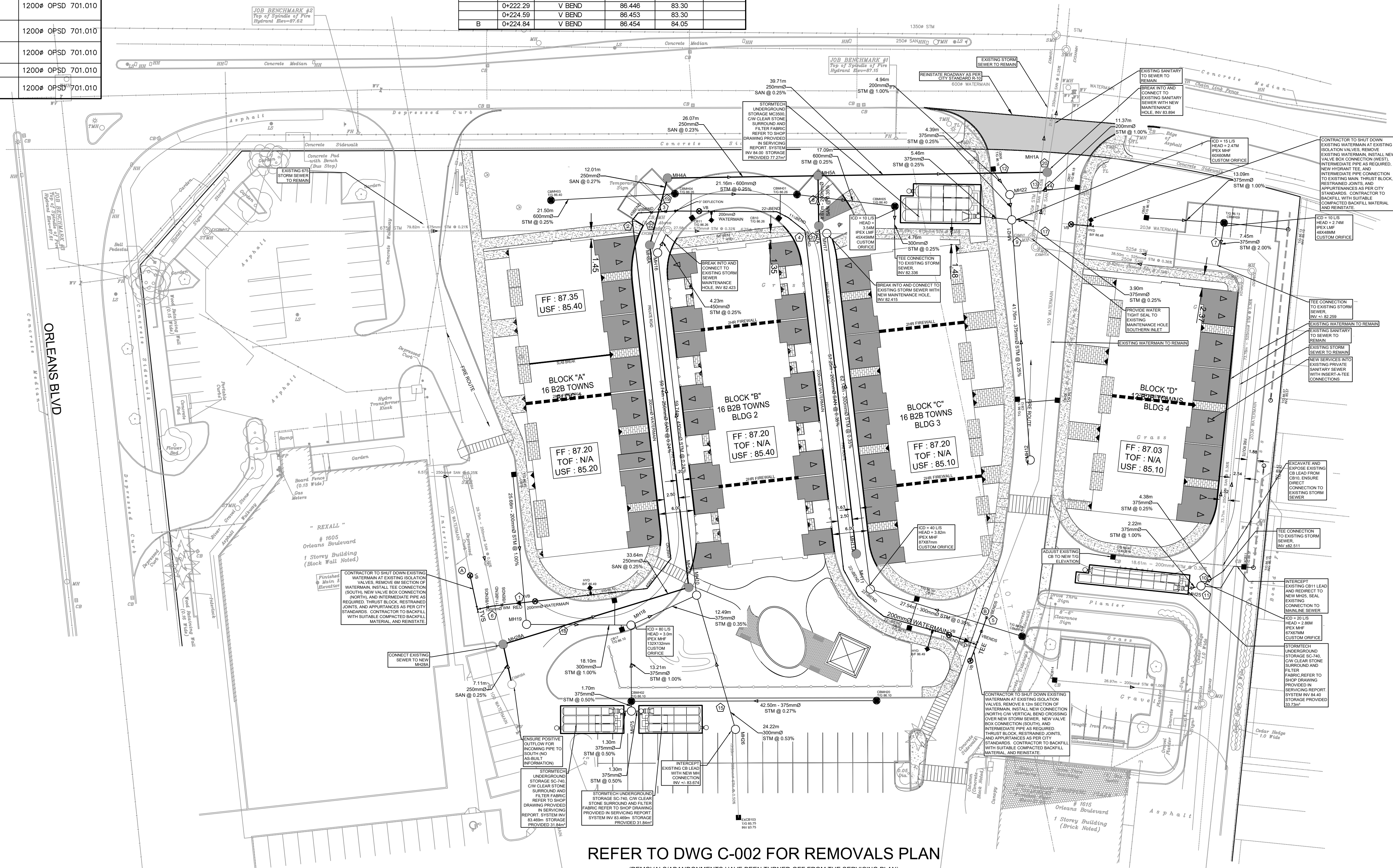

REFER TO DWG C-002 FOR REMOVALS PLAN  
(REMOVALS/ABANDONMENTS HAVE BEEN TURNED OFF FROM THE SERVICING PLAN)

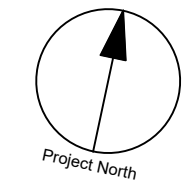

CLIENT  
**NORTH AMERICAN DEVELOPMENT GROUP**

COPYRIGHT  
This drawing has been prepared solely for the intended use. Any reproduction or distribution for any purpose other than that authorized by IBI Group is forbidden. When dimensions shall have precedence over scaled dimensions, the job, and IBI Group shall be informed of any variations from the dimensions and conditions shown on the drawing. Shop drawings shall be submitted to IBI Group for general conformance before proceeding with fabrication.

IBI Group Professional Services (Canada) Inc.  
is a member of the IBI Group of companies.

ISSUES	No.	DESCRIPTION	DATE
	1	ISSUED FOR CITY REVIEW	2023-02-06
	2	REVISED AS PER NEW SITE PLAN	2023-09-06

SEE 010, 011, 012 FOR NOTES, LEGEND, CB TABLE, STREET SECTIONS AND DETAILS.

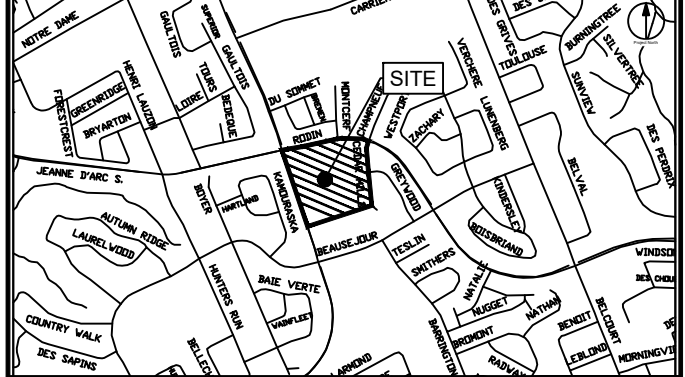

CONSULTANTS  
Project Coordinator:  
North American Development Group  
Site Plan Architect:  
Q4 Architects Inc.  
Surveyor:  
Fairhall, Moffatt and Woodland Ltd.  
Geotechnical:  
Paterson Group  
Traffic:  
IBI Group  
Electrical:  
Hammerschlag & Joffe Inc.  
Landscape:  
Levetek Consultants Inc.

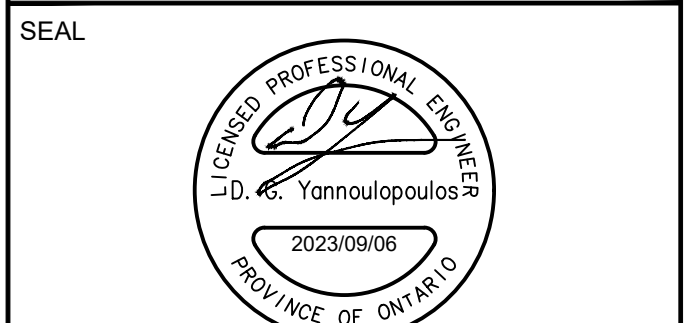
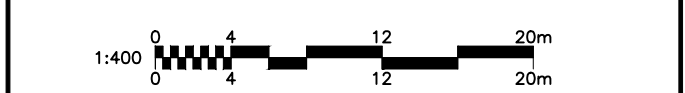

IBI GROUP  
400 - 333 Preston Street  
Ottawa ON K1S 5M4 Canada  
Tel 613 225 5111 Fax 613 225 5868  
ibigroup.com

PROJECT  
**ORLEANS GARDENS**  
1615 ORLEANS BOULEVARD

PROJECT NO:  
122764  
DRAWN BY:  
A.B. / E.H.  
PROJECT MGR:  
R.M.  
CHECKED BY:  
D.G.Y.  
APPROVED BY:  
D.G.Y.

SHEET TITLE  
**GENERAL PLAN OF SERVICES**

SHEET NUMBER  
**C-001**  
ISSUE  
**2**

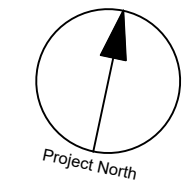

CLIENT  
**NORTH AMERICAN  
DEVELOPMENT GROUP**

**COPYRIGHT**  
This drawing has been prepared solely for the intended use. Any reproduction or distribution for any purpose other than authorized by IBI Group is forbidden. Written dimensions shall have precedence over scaled dimensions. Contractors shall verify and be responsible for all dimensions and conditions on the job, and IBI Group shall be informed of any variations from the dimensions and conditions shown on the drawing. Shop drawings shall be submitted to IBI Group for general concurrence before proceeding with fabrication.

**IBI Group Professional Services (Canada) Inc.**  
is a member of the IBI Group of companies

**ISSUES**

No.	DESCRIPTION	DATE
1	ISSUED FOR CITY REVIEW	2023-02-06
2	REVISED AS PER NEW SITE PLAN	2023-09-06

SEE 010, 011, 012 FOR NOTES, LEGEND, CB TABLE, STREET SECTIONS AND DETAILS

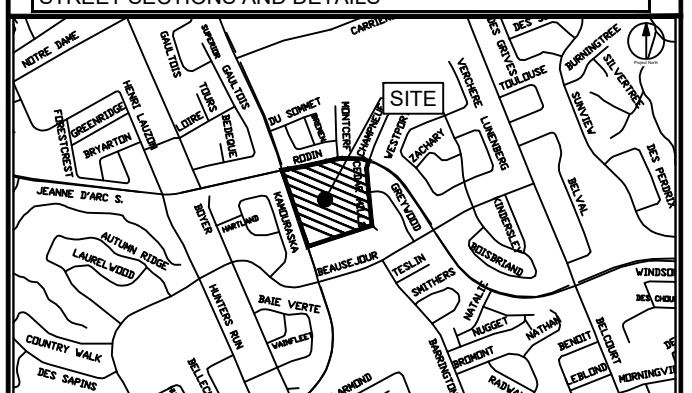

**CONSULTANTS**  
Project Coordinator:  
North American Development Group  
Site Plan Architect:  
Q4 Architects Inc.  
Surveyor:  
Fairhall, Moffatt and Woodland Ltd.  
Geotechnical:  
Paterson Group  
Traffic:  
IBI Group  
Electrical:  
Hammerschlag & Joffe Inc.  
Landscape:  
Levstek Consultants Inc.

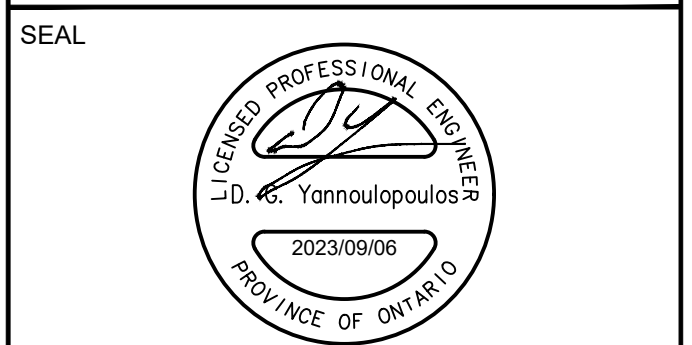

**IBI GROUP**  
400 - 333 Preston Street  
Ottawa ON K1S 5M4 Canada  
tel 613 225 1311 fax 613 225 5866  
ibigroup.com

**PROJECT**  
**ORLEANS GARDENS**  
**1615 ORLEANS BOULEVARD**

PROJECT NO:  
122764

DRAWN BY:  
A.B. / E.H.

CHECKED BY:  
D.G.Y.

PROJECT MGR:  
R.M.

APPROVED BY:  
D.G.Y.

**SHEET TITLE**  
**REMOVAL PLAN**

SHEET NUMBER  
**C-002**

ISSUE  
**2**

**REMOVALS LEGEND**

- REMOVAL
- ⊗ ADJUST MANHOLE, VALVES
- ⊠ ADJUST CATCH BASIN
- ⊙ ADJUSTMENT BY BELL OR HYDRO APPROVED CONTRACTOR
- ✕ REMOVE OR ABANDON SEWER, WATERMAIN, UTILITY, CURB RETURNS
- ⌋ PLUG
- DRY GRIND EXISTING ASPHALT. AVERAGE DEPTH 50mm.
- FULL DEPTH ASPHALT REMOVAL
- AREA TO BE CLEARED AND GRUBBED
- REMOVAL OF BUILDINGS, FOUNDATIONS, SEPTIC SYSTEM AND WELL.
- REMOVALS OF CONCRETE/ ASPHALT SIDEWALK

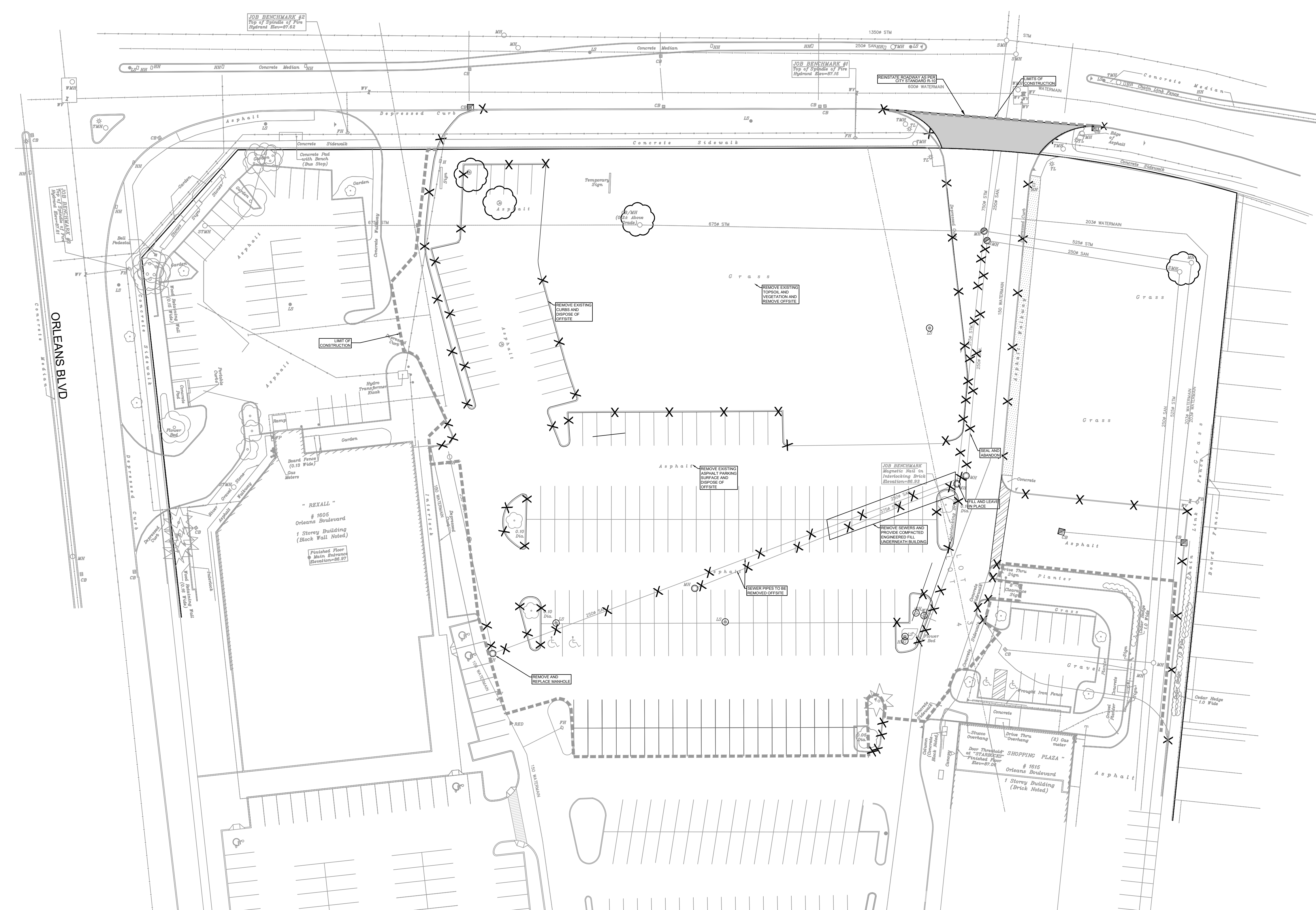

CITY PLAN NO. 18981  
CITY FILE NO. D07-12-23-0026  
Last Saved: September 1, 2023, by Ehenrie  
Pinned: Wednesday, September 6, 2023 2:16:03 PM by Eric Henrie

COPYRIGHT  
This drawing has been prepared solely for the intended use. Any reproduction or distribution for any purpose other than authorized by IBI Group is forbidden. Written dimensions shall have precedence over scaled dimensions. Contractors shall verify and be responsible for all dimensions and conditions on the job, and IBI Group shall be informed of any variations from the dimensions and conditions shown on the drawing. Shop drawings shall be submitted to IBI Group for general conformance before proceeding with fabrication.

IBI Group Professional Services (Canada) Inc.  
is a member of the IBI Group of companies.

No.	DESCRIPTION	DATE
1	ISSUED FOR CITY REVIEW	2023-02-06
2	REVISED AS PER NEW SITE PLAN	2023-09-06

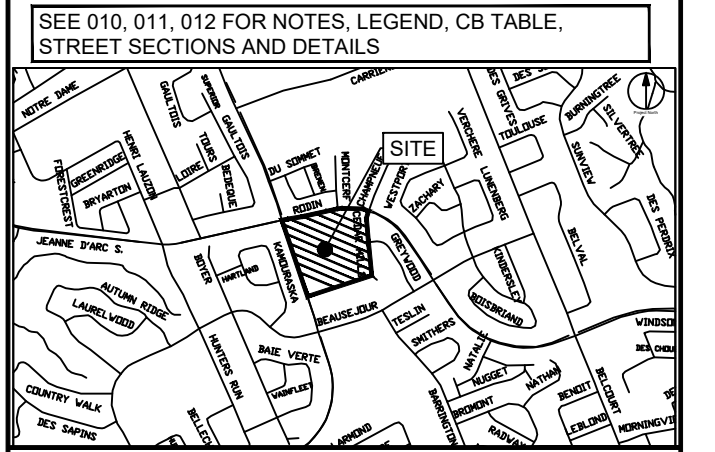

SEE 010, 011, 012 FOR NOTES, LEGEND, CB TABLE, STREET SECTIONS AND DETAILS.

CONSULTANTS  
Project Coordinator:  
North American Development Group  
Site Plan Architect:  
Q4 Architects Inc.  
Surveyor:  
Fairhall, Moffatt and Woodland Ltd.  
Geotechnical:  
Paterson Group  
Traffic:  
IBI Group  
Electrical:  
Hammerschlag & Joffe Inc.  
Landscape:  
Levstek Consultants Inc.

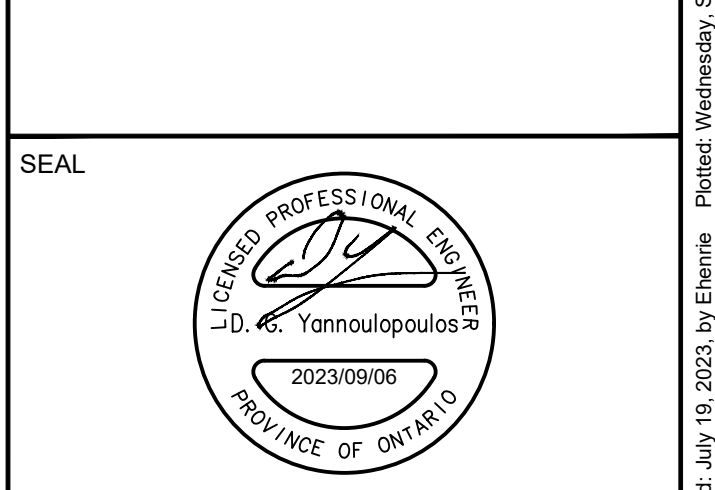

SEAL

PROJECT  
ORLEANS GARDENS  
1615 ORLEANS BOULEVARD

PROJECT NO:  
122764  
DRAWN BY:  
A.B. / E.H.  
PROJECT MGR:  
R.M.  
SHEET TITLE  
GENERAL NOTES,  
LEGEND AND  
CB DATA TABLE

CHECKED BY:  
R.M./D.G.Y.  
APPROVED BY:  
D.G.Y.  
SHEET NUMBER  
C-010  
ISSUE  
2

GENERAL LEGEND

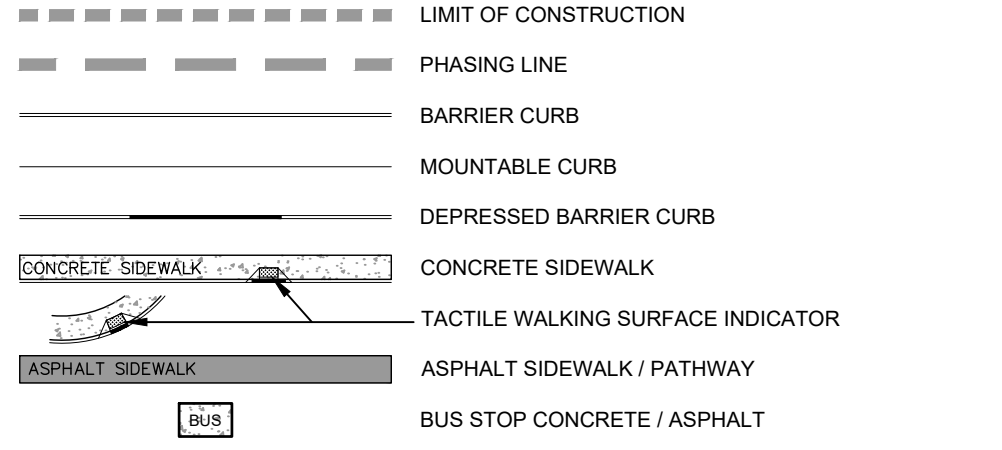

SERVICING LEGEND

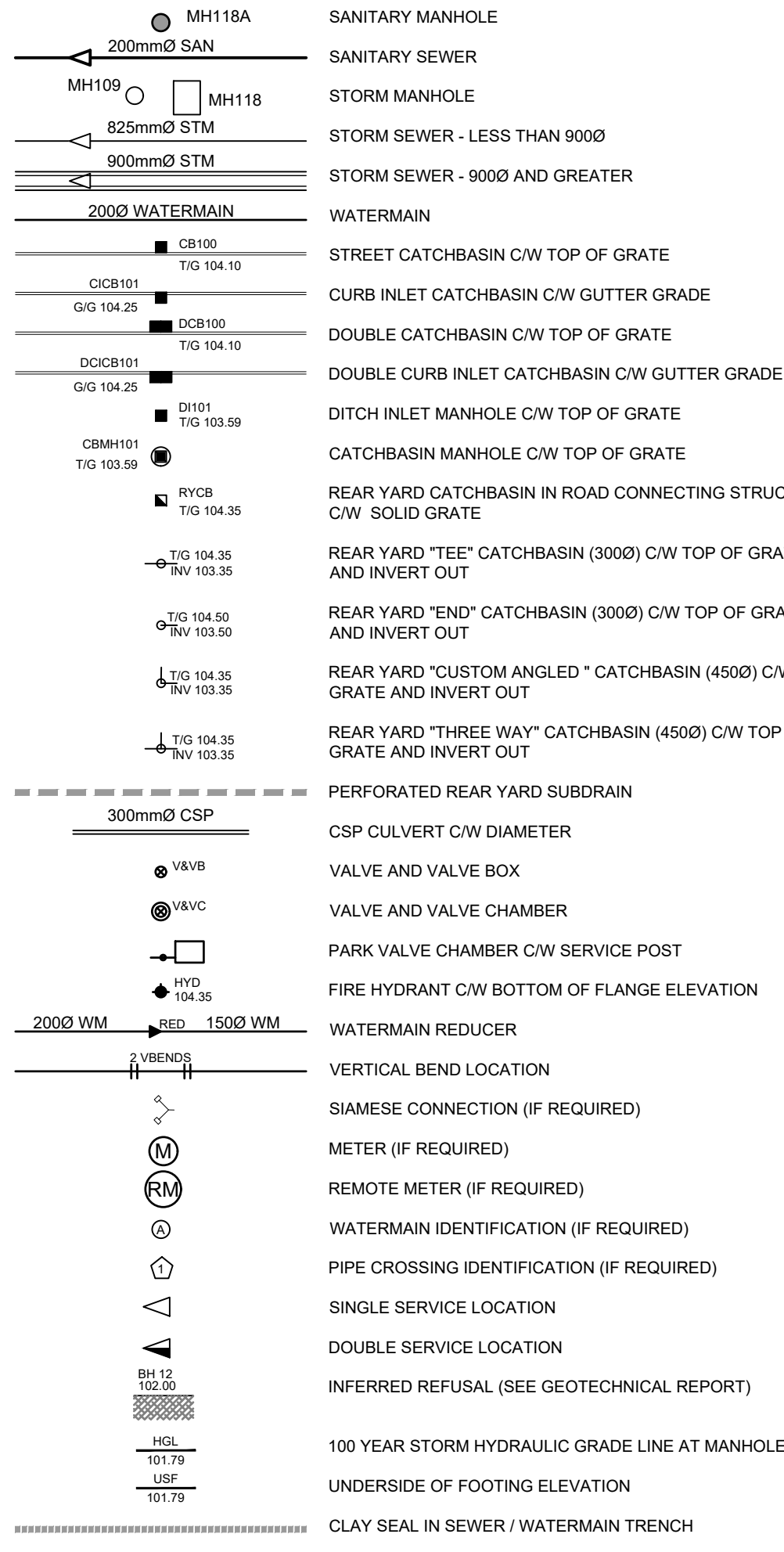

LEGEND - FAIRHALL, MOFFATT & WOODLAND LTD.



CATCHBASIN DATA TABLE

STRUCTURE ID	STORM AREA ID	STRUCTURE	FRAME & COVER	ELEVATION		OUTLET PIPE	
				TOP OF GRATE	INVERT INLET OUTLET	DIAMETER (mm)	TYPE
CB03	CB03	OPSD 705.010	S19	86.30	84.73	375	PVC DR35
CB06	EXMH11	OPSD 705.010	S19	86.16	84.76	200	PVC DR35
CB07		OPSD 705.010	S19	86.18	84.78	200	PVC DR35
CB08	CB08	OPSD 705.010	S19	86.13	84.56	375	PVC DR35
CB12	MH12	OPSD 705.010	S19	86.17	84.77	200	PVC DR35
CB13		OPSD 705.010	S19	86.17	84.77	200	PVC DR35
CB15	CB14-3	OPSD 705.010	S19	86.21	84.81	200	PVC DR35
CB16		OPSD 705.010	S19	86.21	84.81	200	PVC DR35
CB17	MH10	OPSD 705.010	S19	86.10	84.70	200	PVC DR35
CB18		OPSD 705.010	S19	86.11	84.71	200	PVC DR35
CB19	CB19	OPSD 705.010	S19	86.45	85.05	200	PVC DR35
EXCB10	EXMH49-2	OPSD 705.010	S19	86.40	84.40	200	PVC DR35
EXCB103	EX02	OPSD 705.010	S19	85.75	83.75	300	PVC DR35
EXCB11	EXMH49-1	OPSD 705.010	S19	86.37	84.17	200	PVC DR35
EXCB14	EXMH49	OPSD 705.010	S19	86.26	84.86	200	PVC DR35

NOTES

- ALL MATERIALS AND CONSTRUCTION IS TO BE IN ACCORDANCE WITH THE CURRENT CITY OF OTTAWA STANDARD DRAWINGS & SPECIFICATIONS OR OPSD/OPSS IF CITY DRAWINGS AND SPECIFICATIONS DO NOT APPLY.
- THE POSITION OF UNDERGROUND AND ABOVEGROUND SERVICE, UTILITIES AND STRUCTURES ARE NOT NECESSARILY SHOWN ON THE CONTRACT DRAWINGS, AND WHERE SHOWN, THE ACCURACY OF THE POSITION OF SUCH SERVICE, UTILITIES AND STRUCTURES IS NOT GUARANTEED. THE CONTRACTOR IS RESPONSIBLE FOR DETERMINING THE EXACT LOCATION, SIZE, MATERIAL AND ELEVATION OF ALL EXISTING SERVICES AND UTILITIES PRIOR TO CONSTRUCTION.
- THE CONTRACTOR SHALL REPORT ALL CONFLICTS, DISCOVERIES OF ERROR AND DISCREPANCIES TO THE ENGINEER.
- THE CONTRACTOR SHALL BE RESPONSIBLE TO PROTECT AND ASSUME RESPONSIBILITY FOR ALL UTILITIES WHETHER OR NOT SHOWN ON THESE DRAWINGS.
- THE CONTRACTOR SHALL BE RESPONSIBLE TO PROTECT ALL LANDS BEYOND THE SITE LIMITS. ANY AREAS BEYOND THE SITE LIMITS, WHICH ARE DISTURBED DURING CONSTRUCTION, SHALL BE REPAIRED AND RESTORED TO ORIGINAL CONDITION OR BETTER, TO THE SATISFACTION OF THE ADJACENT LAND OWNER, THE OWNER, THE OWNERS REPRESENTATIVES AND/OR THE AUTHORITY HAVING JURISDICTION AT THE EXPENSE OF THE CONTRACTOR.
- WHERE NECESSARY, THE CONTRACTOR SHALL IMPLEMENT A TRAFFIC MANAGEMENT PLAN TO THE SATISFACTION OF THE CITY OF OTTAWA. ALL CONSTRUCTION SIGNAGE MUST CONFORM TO THE LATEST VERSION OF THE M.T.O. MANUAL OF UNIFORM TRAFFIC CONTROL DEVICES. ALL TEMPORARY TRAFFIC CONTROL MEASURES MUST BE REMOVED UPON THE COMPLETION OF THE WORKS.
- SHOULD ANY BURIED ARCHAEOLOGICAL REMAINS BE FOUND ON THE PROPERTY DURING CONSTRUCTION ACTIVITIES, THE CONTRACTOR SHALL NOTIFY THE OWNER, TO CONTACT THE HERITAGE OPERATIONS UNIT OF THE ONTARIO MINISTRY OF CULTURE. MUST BE NOTIFIED IMMEDIATE, AND WORK WITHIN THE AREA SHALL BE CEASED UNTIL FURTHER NOTICE.
- FOR GEOTECHNICAL INFORMATION REFER TO GEOTECHNICAL REPORT PG3088-1 PREPARED BY PATERSON GROUP INC.
- FOR GEODETIC BENCHMARK AND GEOMETRIC LAYOUT OF STREET AND LOTS, REFER TO TOPOGRAPHICAL SURVEY AND PLAN OF SUBDIVISION PREPARED BY FAIRHALL, MOFFATT & WOODLAND LIMITED BENCHMARK, BASED ON CAN-NET VIRTUAL REFERENCE SYSTEM NETWORK.
- FOR SITE PLAN INFORMATION, REFER TO SITE PLAN PREPARED BY Q4 ARCHITECTS INC.
- FOR NOISE ATTENUATION PLAN REFER TO N1 PREPARED BY IBI GROUP.
- THESE DRAWINGS ARE NOT TO BE SCALED OR USED FOR LAYOUT PURPOSES.
- ROADWAY SECTIONS REQUIRING GRADE RAISE TO PROPOSED SUB GRADE LEVEL TO BE FILLED WITH ACCEPTABLE NATIVE EARTH BORROW OR IMPORTED OPSS SELECTED SUBGRADE MATERIAL. IF NATIVE MATERIAL IS DESIGNATED AS PER RECOMMENDATION OF GEOTECHNICAL ENGINEER.
- IN AREAS WHERE EXISTING GROUND IS BELOW THE PROPOSED ELEVATION OF SEWER AND WATERMANS, GRADE RAISING AND FILLING IS TO BE IN ACCORDANCE WITH THE RECOMMENDATIONS OF THE GEOTECHNICAL REPORT. AS PER CITY GUIDELINES ALL WATERMANS IN FILL AREAS ARE TO BE TIED WITH RESTRAINING JOINTS AND THRUST BLOCKS.
- REFER TO DRAWING C-011 FOR ROADWAY CROSS SECTIONS (IF APPLICABLE).
- THE CONTRACTOR SHALL IMPLEMENT THE EROSION AND SEDIMENT CONTROL PLAN PRIOR TO THE COMMENCEMENT OF ANY SITE CONSTRUCTION. ALL EROSION AND SEDIMENT CONTROL MEASURES SHALL BE INSTALLED TO THE SATISFACTION OF THE ENGINEER, OR ANY REGULATORY AGENCY. ALL EROSION AND SEDIMENT CONTROL MEASURES SHALL BE MAINTAINED UNTIL VEGETATION IS ESTABLISH OR UNTIL THE START OF A SUBSEQUENT PHASE.
- CONTRACTORS SHALL BE RESPONSIBLE FOR KEEPING CLEAN ALL ROADS WHICH BECOME COVERED IN DUST, DEBRIS AND/OR MUD AS A RESULT OF ITS CONSTRUCTION OPERATIONS.
- THE CONTRACTOR SHALL BE RESPONSIBLE FOR ANY ADDITIONAL BEDDING OR ADDITIONAL STRENGTH PIPE SHOULD THE MAXIMUM OPSD TRENCH WIDTH BE EXCEEDED.
- ALL PIPE, CULVERTS, STRUCTURES REFER TO NOMINAL INSIDE DIMENSIONS.
- SHOULD CLAY SEALS BE REQUIRED, THEY SHALL BE INSTALLED AS PER THE RECOMMENDATIONS WITHIN THE GEOTECHNICAL REPORT.
- UNLESS SPECIFICALLY NOTED OTHERWISE, PIPE MATERIALS SHALL BE AS FOLLOWS:  
-WATERMANS TO BE PVC DR19  
-SANITARY SEWER TO BE PVC DR35  
-PERFORATED STORM SEWERS IN REAR YARDS AND LANDSCAPE AREAS TO BE HDPE  
-STORM SEWERS 375MM DIAMETER AND LESS TO BE PVC DR35  
-STORM SEWERS 450MM DIAMETER AND GREATER TO BE CONCRETE, CLASS AS PER OPSD 807.010 OR 807.030, OR HIGHER
- ALL CONNECTIONS TO EXISTING WATERMANS ARE TO BE COMPLETED BY CITY FORCES. CONTRACTOR IS TO EXCAVATE, BACKFILL, COMPACT AND REINSTATE.
- ANY WATERMAIN WITH LESS THAN 2.4M, AND ANY SEWER WITH LESS THAN 2.0M DEPTH OF COVER REQUIRES THERMAL INSULATION AS PER CITY OF OTTAWA STANDARD W22, OR AS APPROVED BY THE ENGINEER.
- ALL FIRE HYDRANTS AS PER CITY STANDARD W19, c/w 150mmØ LEAD UNLESS OTHERWISE SPECIFIED.
- ALL STUBBED SEWERS SHALL HAVE PRE-MANUFACTURED CAPS INSTALLED.
- ALL CATCHBASINS SHALL HAVE A 600MM SUMP. ALL CATCHBASIN MANHOLES, AND ALL STORM MANHOLES WITH OUTLETTING PIPE SIZES LESS THAN 900MM, SHALL HAVE A 300MM SUMP.
- ALL SANITARY MANHOLES SHALL BE EQUIPPED WITH A WATERTIGHT COVER.
- ALL LEADS FOR STREET CATCHBASINS AND CURB INLET CATCHBASINS CONNECTED TO MAIN SHALL BE 200MMØ PVC DR35 @ MIN 2% SLOPE UNLESS NOTED OTHERWISE. ALL LEADS FOR RYCBs CONNECTED TO MAIN SHALL BE 200MMØ PVC DR35 @ MIN 1% SLOPE UNLESS NOTED OTHERWISE.
- UNLESS SPECIFICALLY NOTED OTHERWISE, ALL STREET CATCHBASINS SHALL BE INSTALLED WITH TWO - 3.0M MINIMUM SUBDRAINS INSTALLED LONGITUDINALLY, PARALLEL WITH THE CURB. ALL CATCHBASINS IN ASPHALT AREAS, NOT ADJACENT TO A CURB, SHALL BE INSTALLED WITH FOUR - 3.0M MINIMUM SUBDRAINS INSTALLED ORTHOGONALLY.
- INLET CONTROL DEVICES SHALL BE INSTALLED PRIOR TO COMPLETING THE ROAD BASE (GRANULAR A).
- ALL SEWER SERVICE LATERALS WITH MAINLINE CONNECTIONS DEEPER THAN 5.0M REQUIRE A CONTROLLED SETTLEMENT JOINT.
- EACH BUILDING SHALL BE EQUIPPED WITH A SANITARY AND STORM SEWER BACKWATER VALVE AND CLEAN-OUT ON ITS PRIMARY SERVICE, AS PER ONTARIO BUILDING CODE REQUIREMENTS (BY OTHERS).
- THE SUBGRADE OF ALL STRUCTURES, PIPE, ROADS, SIDEWALKS, WALKWAYS, AND BUILDINGS SHALL BE INSPECTED BY THE GEOTECHNICAL ENGINEER PRIOR TO PROCEEDING WITH CONSTRUCTION.
- TOP COURSE ASPHALT SHALL NOT BE PLACED UNTIL THE FINAL CCTV INSPECTION AND NECESSARY REPAIRS HAVE BEEN COMPLETED TO THE SATISFACTION OF THE ENGINEER AND THE CITY OF OTTAWA.
- ALL RETAINING WALLS GREATER THAN 1.0M IN HEIGHT SHALL BE DESIGNED BY A QUALIFIED STRUCTURAL ENGINEER.
- ALL RETAINING WALLS GREATER THAN 0.6M IN HEIGHT REQUIRE A GUARD. ANY GUARD ON A RETAINING WALL GREATER THAN 1.0M IN HEIGHT SHALL BE DESIGNED BY THE QUALIFIED STRUCTURAL ENGINEER RESPONSIBLE FOR THE WALL DESIGN.
- UPON COMPLETION OF THE RETAINING WALL, THE CONTRACTOR SHALL REQUEST A PERFORMANCE CERTIFICATE FROM THE QUALIFIED ENGINEER RESPONSIBLE FOR THE WALL DESIGN.

Crossing No.	PIPE 1	PIPE 2	Clearance
1	STM Bottom 84.825	WM Top 84.111	0.714
2	WM Bottom 84.026	STM Top 83.161	0.864
3	SAN Bottom 84.121	WM Top 83.621	0.500
4	WM Bottom 83.945	STM Top 83.401	0.543
5	STM Bottom 83.801	WM Top 83.300	0.501
6	SAN Bottom 84.442	WM Top 83.898	0.500
7	WM Bottom 84.319	STM Top 83.583	0.421
8	SAN Bottom 84.080	STM Top 83.583	0.497
9	STM Bottom 83.601	STM Top 82.970	0.631
10	SAN Bottom 84.322	STM Top 83.905	0.417
11	SAN Bottom 84.328	STM Top 84.010	0.318
12	STM Bottom 84.750	STM Top 84.194	0.556
13	STM Bottom 84.709	STM Top 82.744	1.965
14	STM Bottom 84.720	SAN Top 84.168	0.552
15	STM Bottom 83.876	STM Top 83.623	0.253
17	SAN Bottom 83.947	STM Top 82.762	1.185
18	SAN Bottom 84.378	STM Top 83.737	0.641
19	SAN Bottom 84.113	STM Top 83.768	0.345
20	SAN Bottom 83.909	STM Top 82.726	1.183
21	SAN Bottom 84.122	STM Top 83.431	0.691
22	SAN Bottom 84.130	STM Top 83.154	0.976

REMOVALS LEGEND

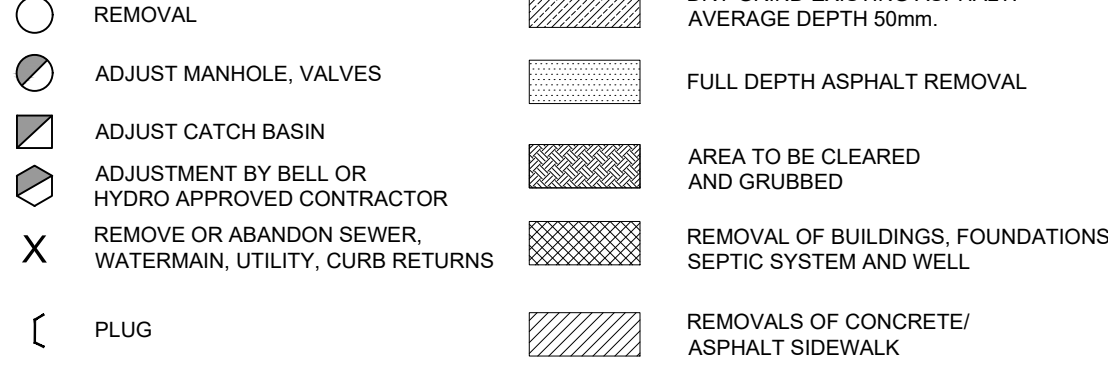

ROADWAY STRUCTURE:

- CAR ONLY PARKING AREA (600mm)
- 50mm - SUPERPAVE 12.5 ASPHALTIC CONCRETE
  - 150mm - OPSS GRANULAR "A" CRUSHED STONE
  - 300mm - OPSS GRANULAR "B" TYPE II
- PRIVATE ROADWAY & MAIN DRIVE AISLE ROADS (690mm)
- 40mm - SUPERPAVE 12.5 ASPHALTIC CONCRETE
  - 50mm - SUPERPAVE 19.0 ASPHALTIC CONCRETE
  - 150mm - OPSS GRANULAR "A" CRUSHED STONE
  - 450mm - OPSS GRANULAR "B" TYPE II

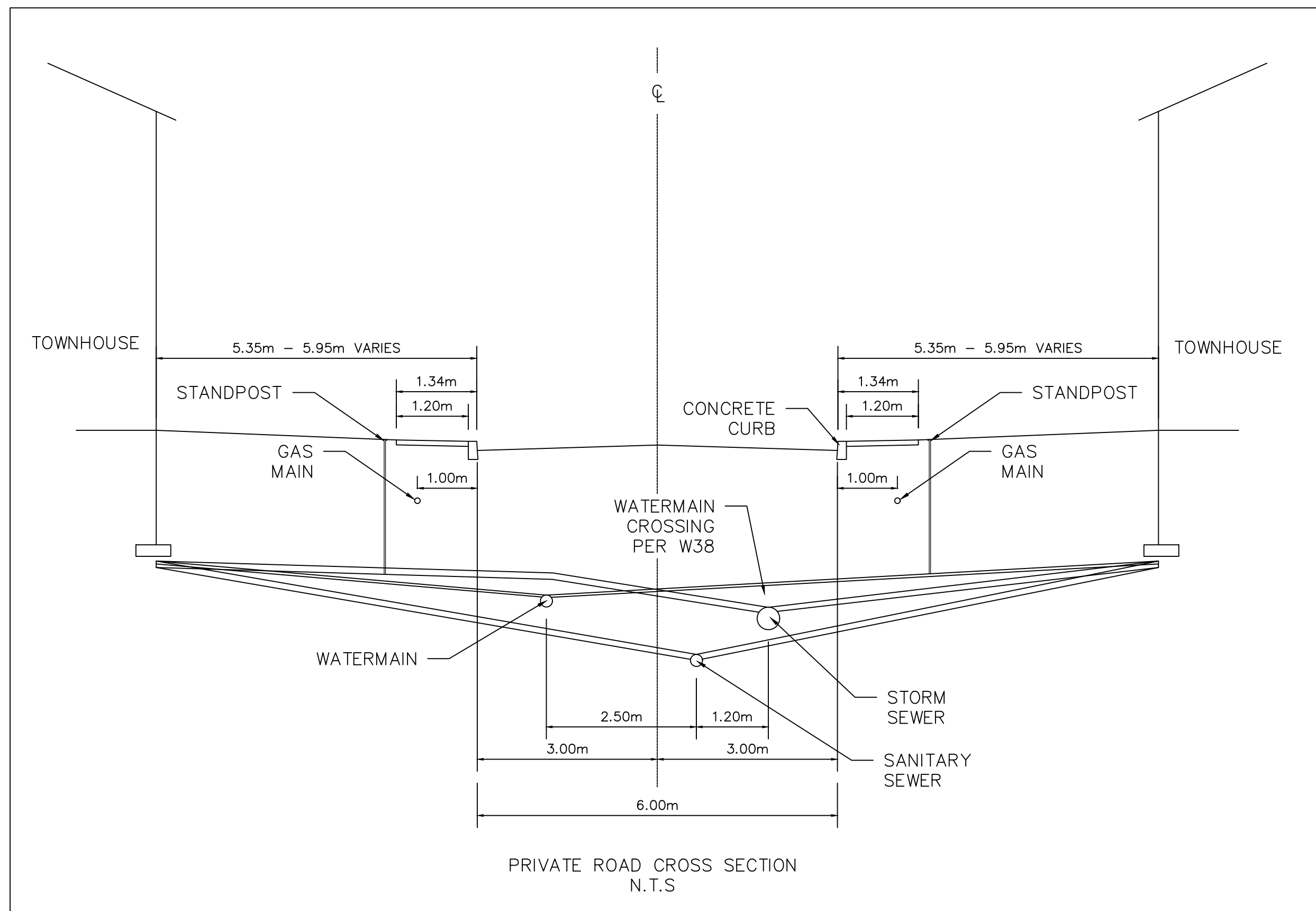

CLIENT  
**NORTH AMERICAN  
DEVELOPMENT GROUP**

**COPYRIGHT**  
This drawing has been prepared solely for the intended use, thus any reproduction or distribution for any purpose other than authorized by IBI Group is forbidden. Written dimensions shall have precedence over scaled dimensions. Contractors shall verify and be responsible for all dimensions and conditions on the job, and IBI Group shall be informed of any variations from the dimensions and conditions shown on the drawing. Shop drawings shall be submitted to IBI Group for general concurrence before proceeding with fabrication.  
**IBI Group Professional Services (Canada) Inc.**  
is a member of the IBI Group of companies.

**ISSUES**

No.	DESCRIPTION	DATE
1	ISSUED FOR CITY REVIEW	2023-02-06
2	REVISED AS PER NEW SITE PLAN	2023-09-06

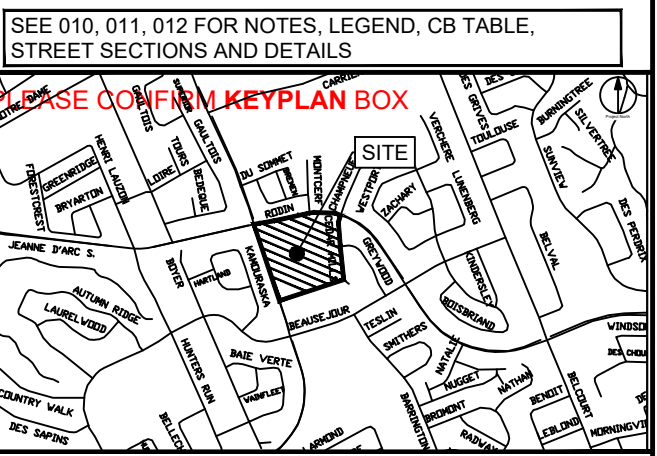

**CONSULTANTS**

Project Coordinator:  
North American Development Group

Site Plan Architect:  
Q4 Architects Inc.

Surveyor:  
Fairhall, Moffatt and Woodland Ltd.

Geotechnical:  
Paterson Group

Traffic:  
IBI Group

Electrical:  
Hammerschlag & Joffe Inc.

Landscape:  
Levstek Consultants Inc.

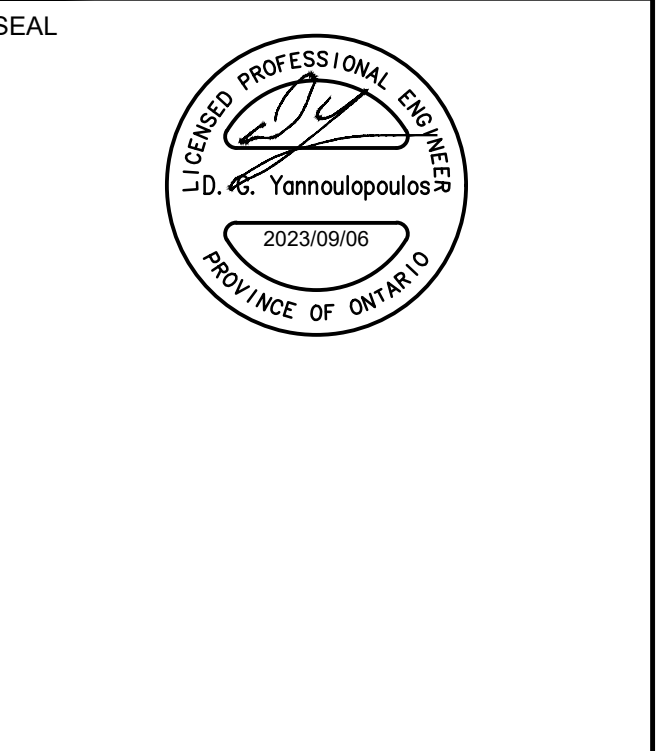

**IBI GROUP**  
400 - 333 Preston Street  
Ottawa ON K1S 5M4 Canada  
tel 613 225 1311 fax 613 225 9868  
ibigroup.com

**PROJECT**  
**ORLEANS GARDENS**  
  
1615 ORLEANS BOULEVARD

PROJECT NO:  
122764

DRAWN BY: A.B. / E.H.	CHECKED BY: R.M./D.G.Y.
PROJECT MGR: R.M.	APPROVED BY: D.G.Y.

SHEET TITLE  
**STREET SECTIONS**

SHEET NUMBER <b>C-011</b>	ISSUE <b>2</b>
------------------------------	-------------------

**GRADING LEGEND**

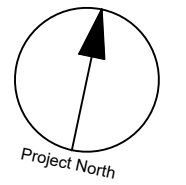
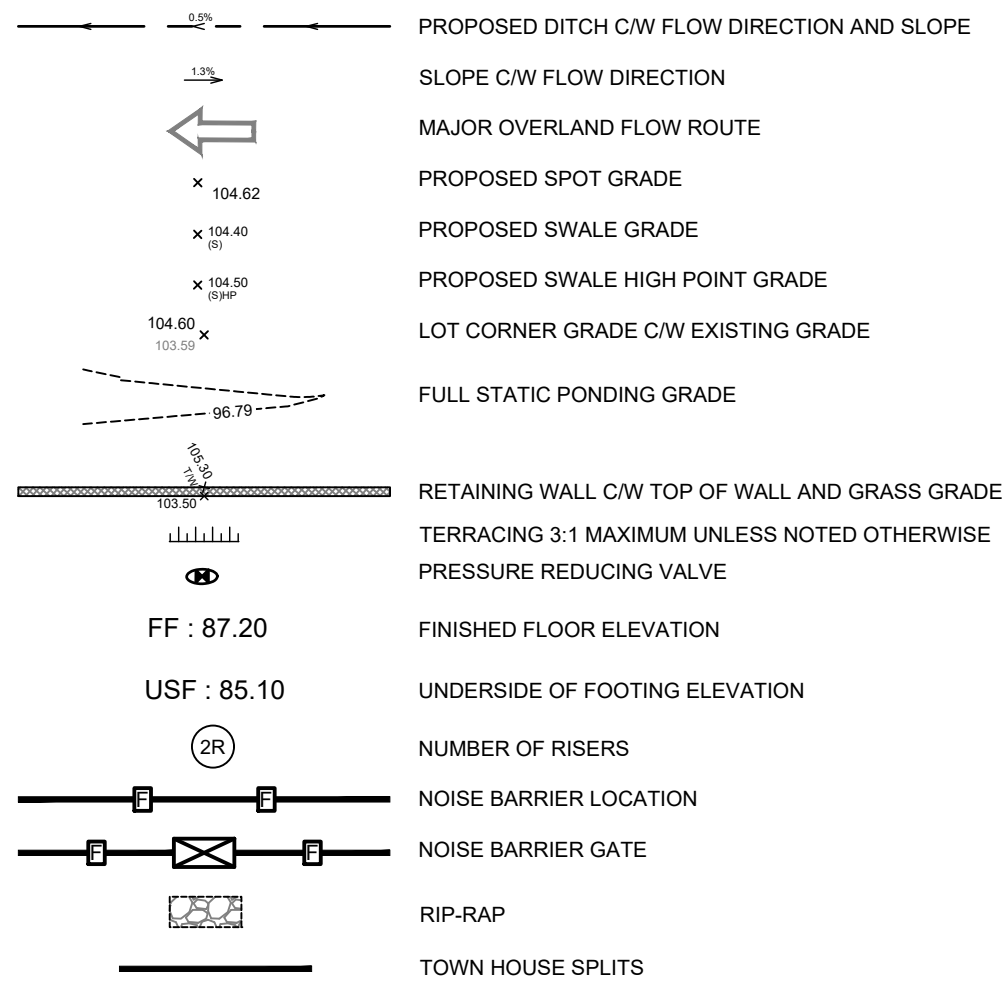

CLIENT  
**NORTH AMERICAN DEVELOPMENT GROUP**

**COPYRIGHT**  
 This drawing has been prepared solely for the intended use. No reproduction or distribution for any purpose other than authorized by IBI Group is permitted. When dimensions shall have precedence over scaled dimensions, Contractors shall verify and be responsible for all dimensions and conditions on the job, and IBI Group shall be informed of any variations from the dimensions and conditions shown on the drawing. Shop drawings shall be submitted to IBI Group for general concurrence before proceeding with fabrication.  
**IBI Group Professional Services (Canada) Inc.**  
 is a member of the IBI Group of companies.

**ISSUES**

No.	DESCRIPTION	DATE
1	ISSUED FOR CITY REVIEW	2023-02-06
2	REVISED AS PER NEW SITE PLAN	2023-09-06

SEE 010, 011, 012 FOR NOTES, LEGEND, CB TABLE, STREET SECTIONS AND DETAILS.

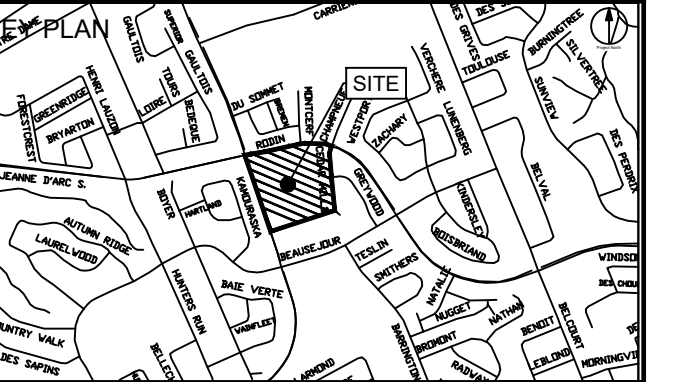

**CONSULTANTS**  
 Project Coordinator:  
 North American Development Group  
 Site Plan Architect:  
 Q4 Architects Inc.  
 Surveyor:  
 Fairhall, Moffatt and Woodland Ltd.  
 Geotechnical:  
 Paterson Group  
 Traffic:  
 IBI Group  
 Electrical:  
 Hammerschlag & Joffe Inc.  
 Landscape:  
 Levstek Consultants Inc.

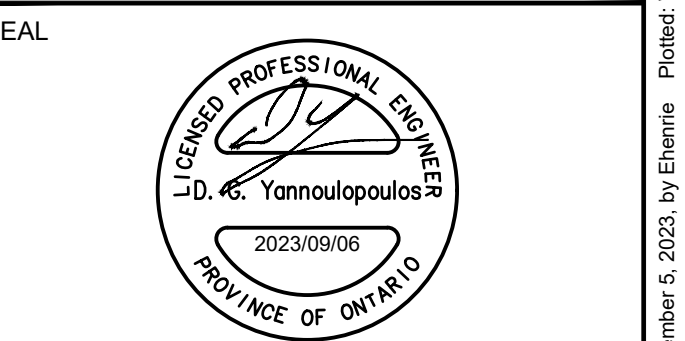
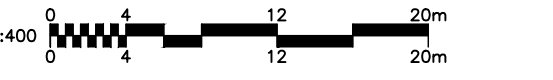

**IBI GROUP**  
 400 - 333 Preston Street  
 Ottawa ON K1S 5M4 Canada  
 tel 613 225 1311 fax 613 225 5966  
 ibigroup.com

**PROJECT**  
**ORLEANS GARDENS**  
 1615 ORLEANS BOULEVARD  
 PROJECT NO:  
 122764  
 DRAWN BY:  
 A.B. / E.H.  
 PROJECT MGR:  
 R.M.  
 SHEET TITLE  
**GRADING PLAN**  
 SHEET NUMBER  
**C-200**  
 CHECKED BY:  
 R.M./D.G.Y.  
 APPROVED BY:  
 D.G.Y.  
 ISSUE  
**2**

**JEANNE D'ARC BLVD**

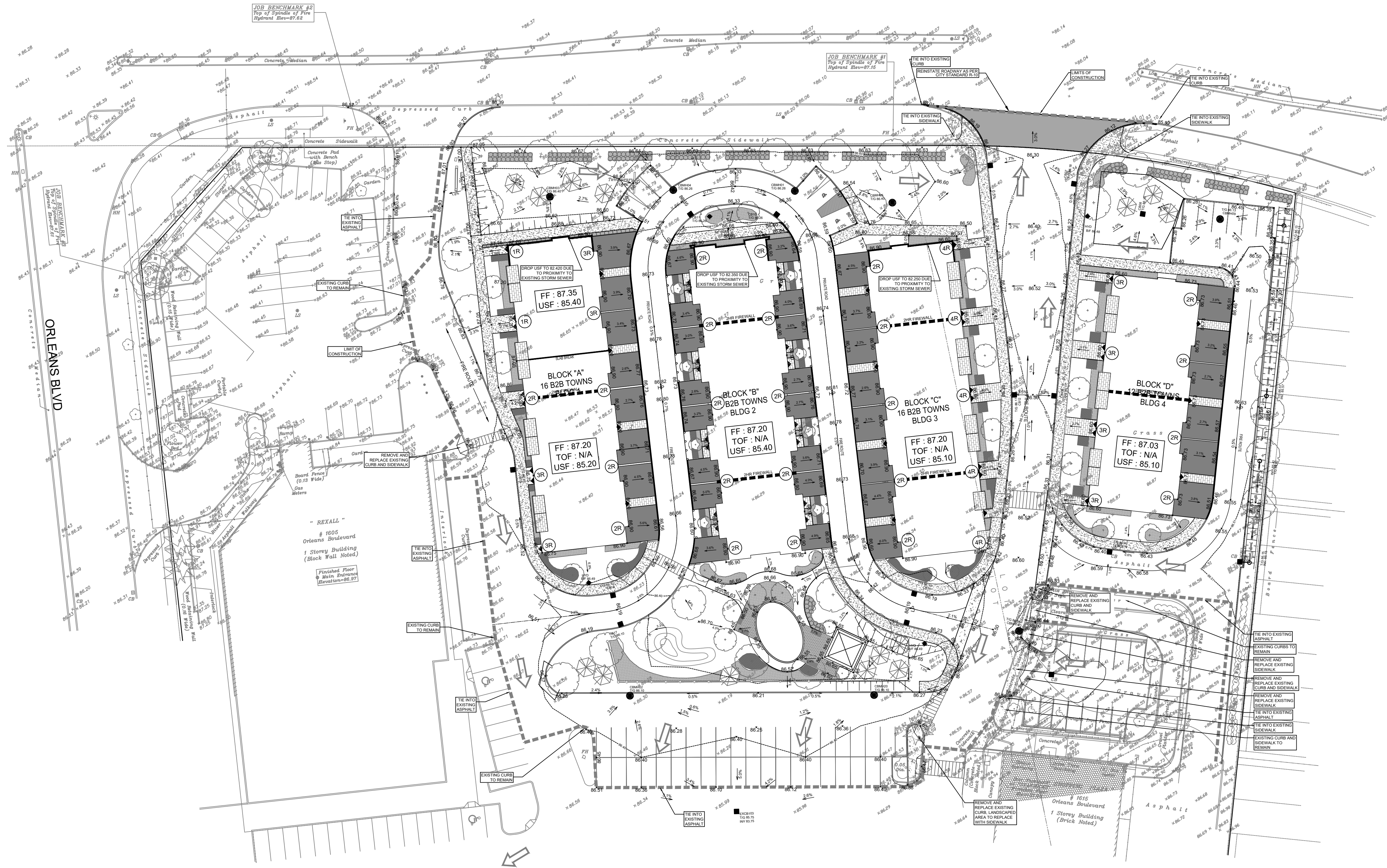

File Location: \\1122764\_OrleansGardens\7\_0\_Production\7\_3\_Design\04\_Civil\Sheet\C-200 GRADING PLAN.dwg  
 Last Saved: September 5, 2023, by E.H.  
 Printed: Wednesday, September 6, 2023 2:17:37 PM by Eric Henne  
**CITY FILE NO. D07-12-23-0026**  
**CITY PLAN NO. 18981**

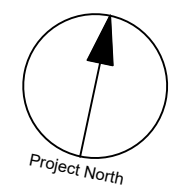

CLIENT  
**NORTH AMERICAN DEVELOPMENT GROUP**

**COPYRIGHT**  
This drawing has been prepared solely for the intended use. No reproduction or distribution for any purpose other than authorized by IBI Group is permitted. When dimensions shall have precedence over scaled dimensions. Contractors shall verify and be responsible for all dimensions and conditions on the job, and IBI Group shall be informed of any variations from the dimensions and conditions shown on the drawing. Shop drawings shall be submitted to IBI Group for general concurrence before proceeding with fabrication.  
**IBI Group Professional Services (Canada) Inc.**  
is a member of the IBI Group of companies.

**ISSUES**

No.	DESCRIPTION	DATE
1	ISSUED FOR CITY REVIEW	2023-02-06
2	REVISED AS PER NEW SITE PLAN	2023-09-06

SEE 010, 011, 012 FOR NOTES, LEGEND, CB TABLE, STREET SECTIONS AND DETAILS

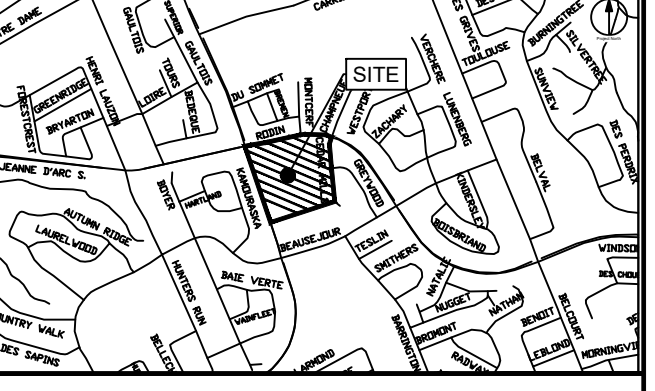

**CONSULTANTS**  
Project Coordinator:  
North American Development Group  
Site Plan Architect:  
Q4 Architects Inc.  
Surveyor:  
Fairhall, Moffatt and Woodland Ltd.  
Geotechnical:  
Paterson Group  
Traffic:  
IBI Group  
Electrical:  
Hammerschlag & Joffe Inc.  
Landscape:  
Levstek Consultants Inc.

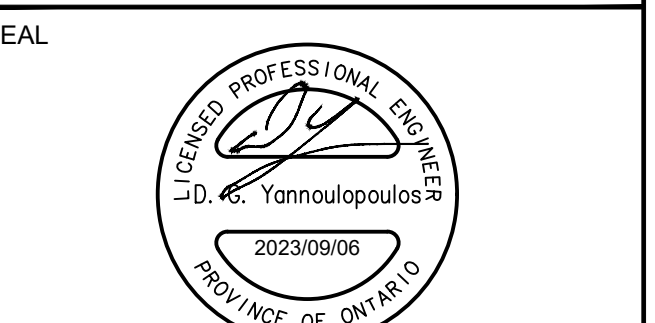

**IBI GROUP**  
400 - 333 Preston Street  
Ottawa ON K1S 5M4 Canada  
tel 613 225 1311 fax 613 225 5866  
ibigroup.com

**PROJECT**  
**ORLEANS GARDENS**  
1615 ORLEANS BOULEVARD

**PROJECT NO:** 122764  
**DRAWN BY:** A.B. / E.H.  
**PROJECT MGR:** R.M.  
**CHECKED BY:** D.G.Y.  
**APPROVED BY:** D.G.Y.

**SHEET TITLE**  
**SANITARY DRAINAGE AREA PLAN**

**SHEET NUMBER** C-400 **ISSUE** 2

**LEGEND**

- SANITARY TRIBUTARY OUTLINE
- AREA NUMBER
- POPULATION
- AREA (ha)

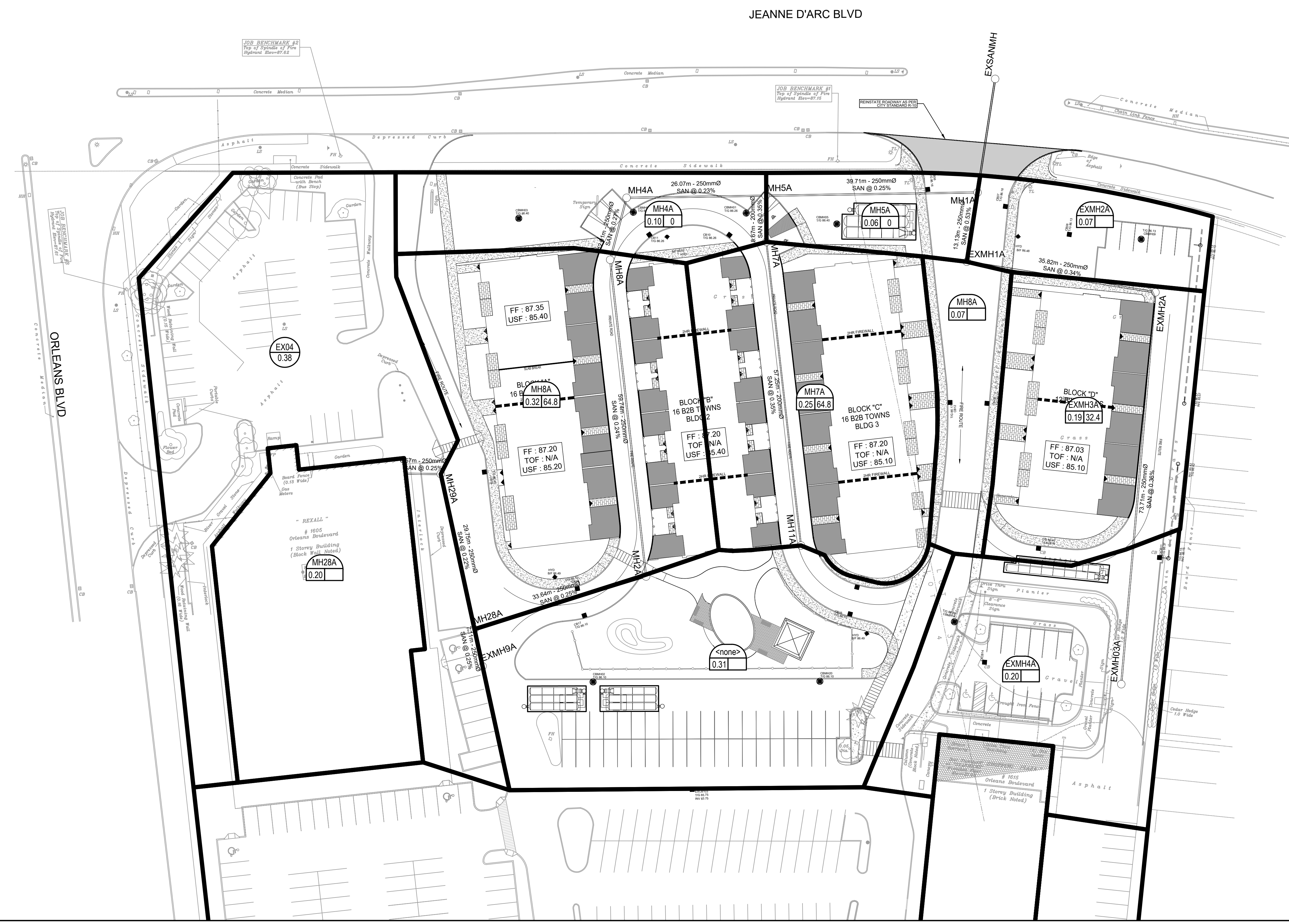

CITY PLAN NO. 18981  
CITY FILE NO. D07-12-23-0026  
Last Saved: July 19, 2023, by: Elenie  
Plotted: Wednesday, September 6, 2023 2:18:08 PM by: Eric Henrie

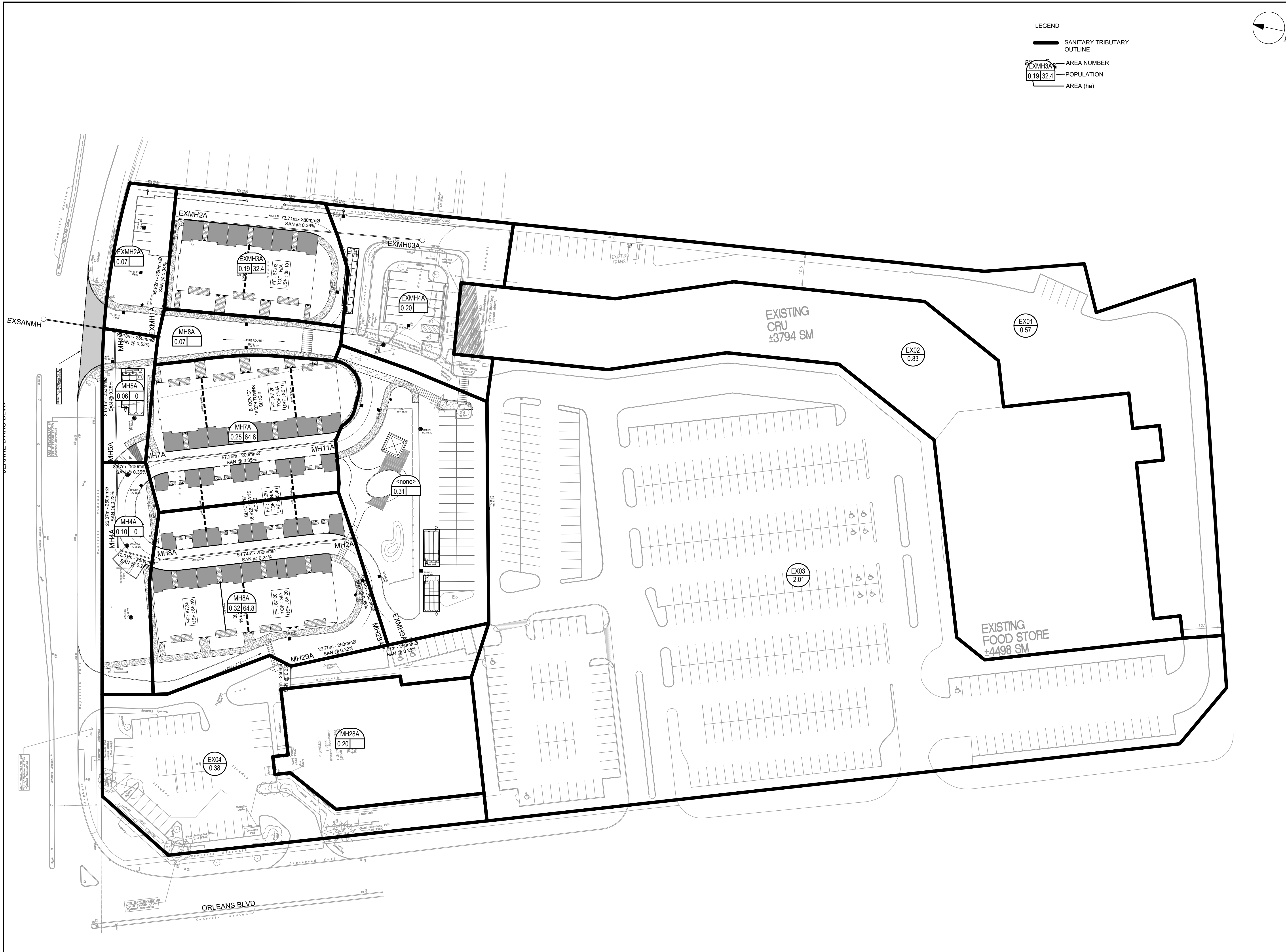

**LEGEND**

- SANITARY TRIBUTARY OUTLINE
- AREA NUMBER  
POPULATION
- AREA (ha)

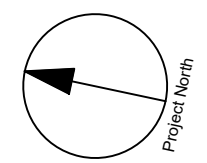

CLIENT  
**NORTH AMERICAN DEVELOPMENT GROUP**

**COPYRIGHT**  
This drawing has been prepared solely for the intended use. This any reproduction or distribution for any purpose other than authorized by IBI Group is forbidden. When dimensions shall have precedence over scaled dimensions. Contractors shall verify and be responsible for all dimensions and conditions on the job, and IBI Group shall be informed of any variations from the dimensions and conditions shown on the drawing. Shop drawings shall be submitted to IBI Group for general conformance before proceeding with fabrication.  
**IBI Group Professional Services (Canada) Inc.**  
is a member of the IBI Group of companies.

**ISSUES**

No.	DESCRIPTION	DATE
1	ISSUED FOR CITY REVIEW	2023-02-06
2	REVISED AS PER NEW SITE PLAN	2023-09-06

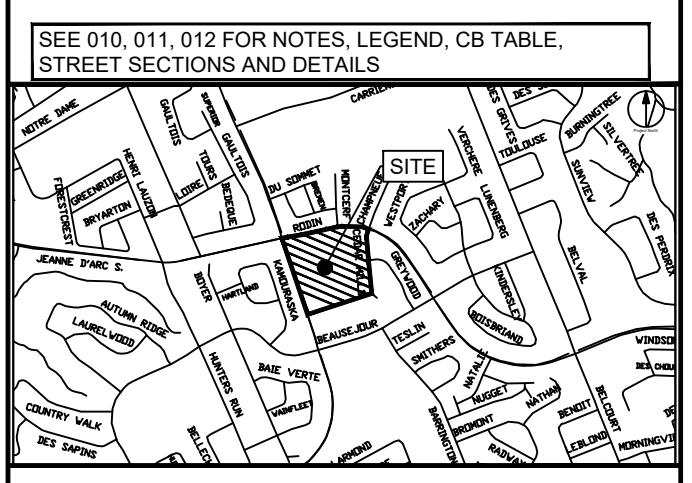

**CONSULTANTS**  
Project Coordinator:  
North American Development Group  
Site Plan Architect:  
Q4 Architects Inc.  
Surveyor:  
Fairhall, Moffatt and Woodland Ltd.  
Geotechnical:  
Paterson Group  
Traffic:  
IBI Group  
Electrical:  
Hammerschlag & Joffe Inc.  
Landscape:  
Levstek Consultants Inc.

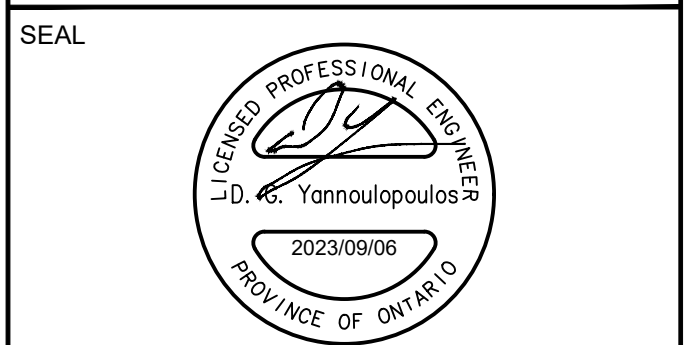

**IBI GROUP**  
400 - 333 Preston Street  
Ottawa ON K1S 5M4 Canada  
tel 613 225 5111 fax 613 225 5986  
ibigroup.com

**PROJECT**  
**ORLEANS GARDENS**  
  
1615 ORLEANS BOULEVARD

**PROJECT NO:**  
122764  
**DRAWN BY:** A.B. / E.H. **CHECKED BY:** D.G.Y.  
**PROJECT MGR:** R.M. **APPROVED BY:** D.G.Y.

**SHEET TITLE**  
**EXTERNAL SANITARY DRAINAGE AREA PLAN**

**SHEET NUMBER** C-401 **ISSUE** 2

CITY PLAN NO. 18981  
CITY FILE NO. D07-12-23-0026  
Last Saved: July 19, 2023, by Elmerie  
Printed: Wednesday, September 6, 2023 2:18:40 PM by Eric Herrie



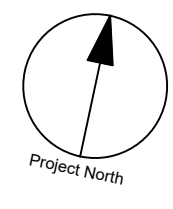

CLIENT  
**NORTH AMERICAN DEVELOPMENT GROUP**

COPYRIGHT  
This drawing has been prepared solely for the intended use. No reproduction or distribution for any purpose other than authorized by IBI Group is permitted. When dimensions shall have precedence over scaled dimensions. Contractors shall verify and be responsible for all dimensions and conditions on the job, and IBI Group shall be informed of any variations from the dimensions and conditions shown on the drawing. Shop drawings shall be submitted to IBI Group for general concurrence before proceeding with fabrication.

IBI Group Professional Services (Canada) Inc.  
is a member of the IBI Group of companies.

ISSUES		
No.	DESCRIPTION	DATE
1	ISSUED FOR CITY REVIEW	2023-02-06
2	REVISED AS PER NEW SITE PLAN	2023-09-06

SEE 010, 011, 012 FOR NOTES, LEGEND, CB TABLE, STREET SECTIONS AND DETAILS.

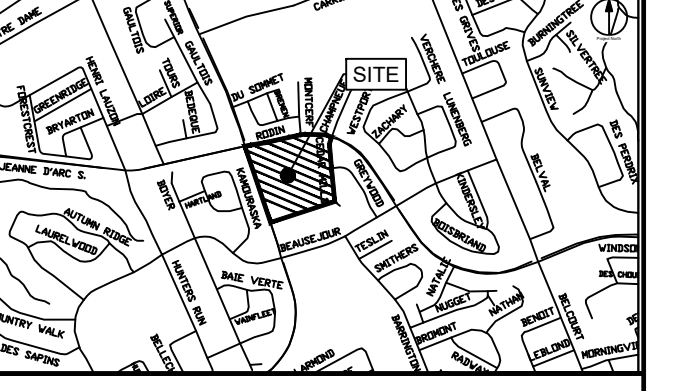

CONSULTANTS

Project Coordinator:  
North American Development Group

Site Plan Architect:  
Q4 Architects Inc.

Surveyor:  
Fairhall, Moffatt and Woodland Ltd.

Geotechnical:  
Paterson Group

Traffic:  
IBI Group

Electrical:  
Hammerschlag & Joffe Inc.

Landscape:  
Levstek Consultants Inc.

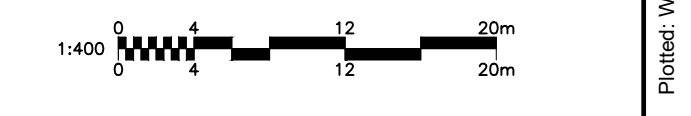

SEAL

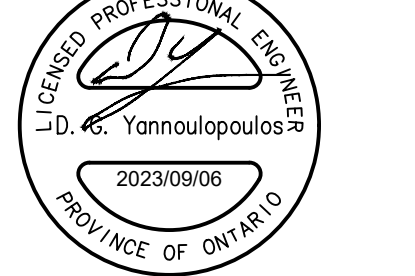

**IBI GROUP**  
400 - 333 Preston Street  
Ottawa ON K1S 5M4 Canada  
tel 613 225 1311 fax 613 225 5966  
ibigroup.com

PROJECT  
**ORLEANS GARDENS**

1615 ORLEANS BOULEVARD

PROJECT NO:  
122764

DRAWN BY:  
A.B. / E.H.

CHECKED BY:  
D.G.Y.

PROJECT MGR:  
R.M.

APPROVED BY:  
D.G.Y.

SHEET TITLE  
**STORM DRAINAGE AREA PLAN**

SHEET NUMBER  
**C-500**

ISSUE  
**2**

LEGEND

	STORM TRIBUTARY OUTLINE
	AREA NUMBER
	COEFFICIENT
	AREA (ha)

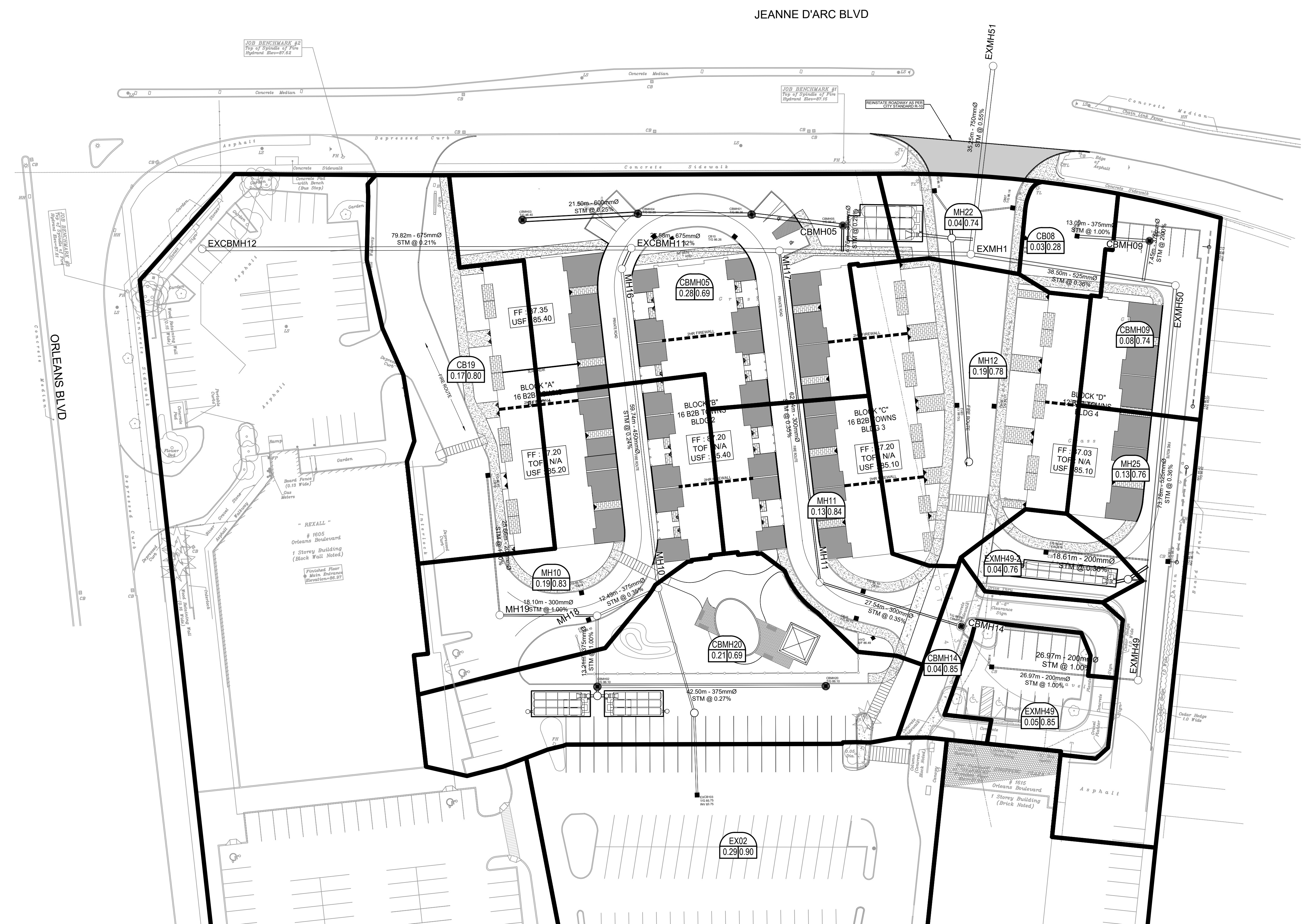

CITY PLAN NO. 18981  
CITY FILE NO. D07-12-23-0026  
File Location: J:\122764\_OrleansGardens\7\_0\_Production\7\_3\_Design\04\_Civil\Sheet\C-500 STORM DRAINAGE AREA PLAN.dwg Last Saved: July 21, 2023, by Elvirene Printed: Wednesday, September 6, 2023 2:19:10 PM by Eric Henne



**LEGEND**

- STORM TRIBUTARY OUTLINE
- AREA NUMBER
- COEFFICIENT
- AREA (ha)

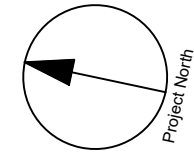

CLIENT  
**NORTH AMERICAN DEVELOPMENT GROUP**

**COPYRIGHT**  
This drawing has been prepared solely for the intended use. Any reproduction or distribution for any purpose other than authorized by IBI Group is forbidden. When dimensions shall have precedence over scaled dimensions, Contractors shall verify and be responsible for all dimensions and conditions on the job, and IBI Group shall be informed of any variations from the dimensions and conditions shown on the drawing. Shop drawings shall be submitted to IBI Group for general conformance before proceeding with fabrication.

**IBI Group Professional Services (Canada) Inc.**  
is a member of the IBI Group of companies.

**ISSUES**

No.	DESCRIPTION	DATE
1	ISSUED FOR CITY REVIEW	2023-02-06
2	REVISED AS PER NEW SITE PLAN	2023-09-06

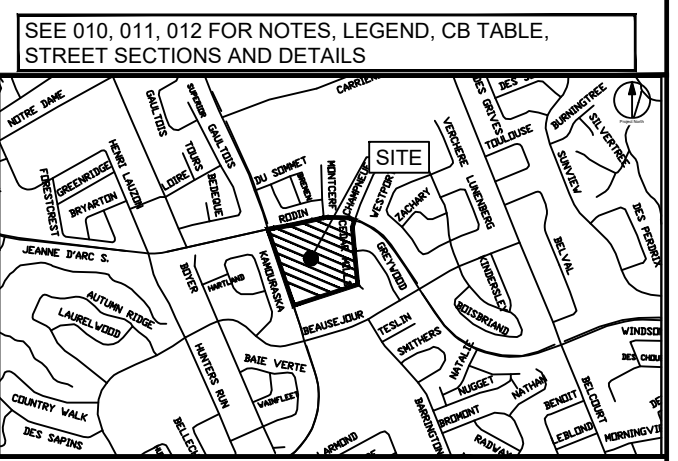

**CONSULTANTS**

Project Coordinator:  
North American Development Group

Site Plan Architect:  
Q4 Architects Inc.

Surveyor:  
Fairhall, Moffatt and Woodland Ltd.

Geotechnical:  
Paterson Group

Traffic:  
IBI Group

Electrical:  
Hammerschlag & Joffe Inc.

Landscape:  
Levstek Consultants Inc.

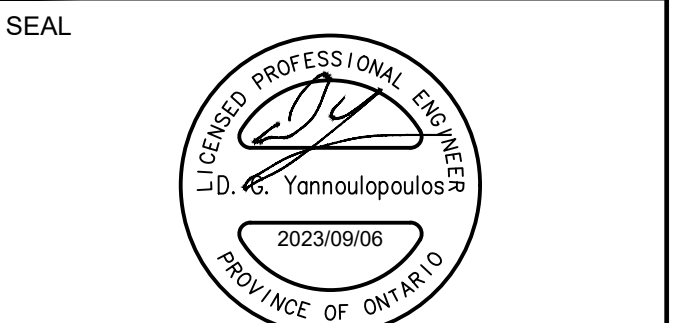

**IBI GROUP**  
400 - 333 Preston Street  
Ottawa ON K1S 5M4 Canada  
tel 613 225-1311 fax 613 225-5966  
ibigroup.com

**PROJECT**  
**ORLEANS GARDENS**  
  
1615 ORLEANS BOULEVARD

**PROJECT NO:**  
122764

<b>DRAWN BY:</b> A.B. / E.H.	<b>CHECKED BY:</b> D.G.Y.
<b>PROJECT MGR:</b> R.M.	<b>APPROVED BY:</b> D.G.Y.

**SHEET TITLE**  
**EXTERNAL STORM DRAINAGE AREA PLAN**

<b>SHEET NUMBER</b> <b>C-501</b>	<b>ISSUE</b> <b>2</b>
-------------------------------------	--------------------------

CITY PLAN NO. 18981  
CITY FILE NO. D07-12-23-0026  
Last Saved: July 19, 2023, by Ehenie  
Printed: Wednesday, September 6, 2023 2:19:42 PM by Eric Henne

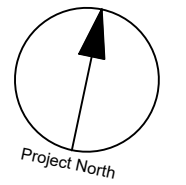

CLIENT  
**NORTH AMERICAN DEVELOPMENT GROUP**

COPYRIGHT  
This drawing has been prepared solely for the intended use, and any reproduction or distribution for any purpose other than authorized by IBI Group is forbidden. When dimensions shall have precedence over scaled dimensions, Contractors shall verify and be responsible for all dimensions and conditions on the job, and IBI Group shall be informed of any variations from the dimensions and conditions shown on the drawing. Shop drawings shall be submitted to IBI Group for general conformance before proceeding with fabrication.  
**IBI Group Professional Services (Canada) Inc.**  
is a member of the IBI Group of companies.

ISSUES		
No.	DESCRIPTION	DATE
1	ISSUED FOR CITY REVIEW	2023-02-06
2	REVISED AS PER NEW SITE PLAN	2023-09-06

SEE 010, 011, 012 FOR NOTES, LEGEND, CB TABLE, STREET SECTIONS AND DETAILS.

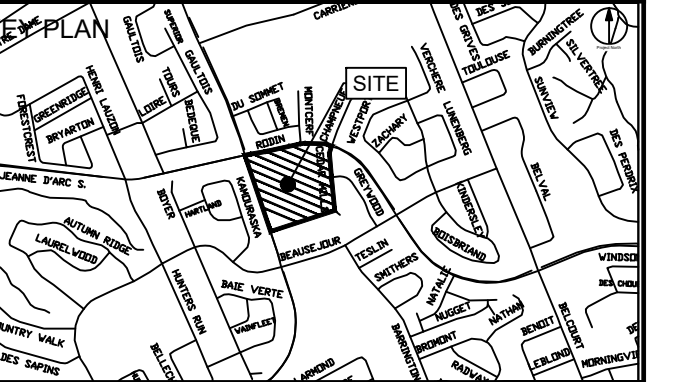

CONSULTANTS  
Project Coordinator:  
North American Development Group  
Site Plan Architect:  
Q4 Architects Inc.  
Surveyor:  
Fairhall, Moffatt and Woodland Ltd.  
Geotechnical:  
Paterson Group  
Traffic:  
IBI Group  
Electrical:  
Hammerschlag & Joffe Inc.  
Landscape:  
Levstek Consultants Inc.

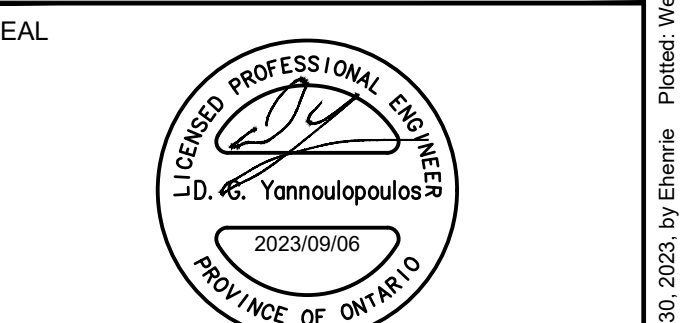

SEAL

**IBI GROUP**  
400 - 333 Preston Street  
Ottawa ON K1S 5M4 Canada  
tel 613 225-1311 fax 613 225-5966  
ibigroup.com

PROJECT  
**ORLEANS GARDENS**  
1615 ORLEANS BOULEVARD

PROJECT NO:  
122764  
DRAWN BY:  
A.B. / E.H.  
PROJECT MGR:  
R.M.  
CHECKED BY:  
R.M./D.G.Y.  
APPROVED BY:  
D.G.Y.

SHEET TITLE  
**PONDING PLAN**

SHEET NUMBER  
**C-600**  
ISSUE  
**2**

JEANNE D'ARC BLVD

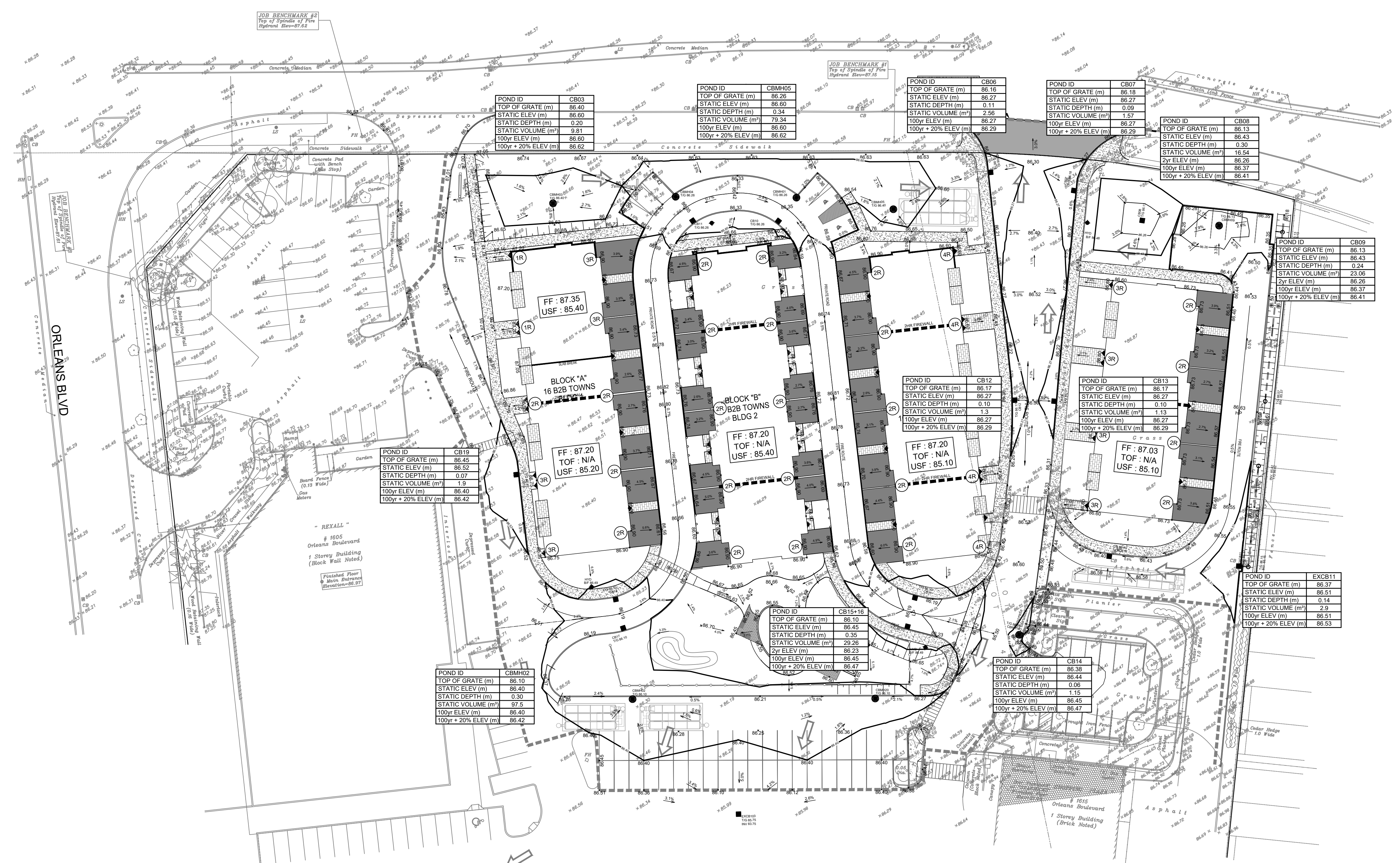

POND ID	CB03
TOP OF GRATE (m)	86.40
STATIC ELEV (m)	86.60
STATIC DEPTH (m)	0.20
STATIC VOLUME (m³)	9.81
100yr ELEV (m)	86.60
100yr + 20% ELEV (m)	86.62

POND ID	CBM05
TOP OF GRATE (m)	86.26
STATIC ELEV (m)	86.60
STATIC DEPTH (m)	0.34
STATIC VOLUME (m³)	79.34
100yr ELEV (m)	86.27
100yr + 20% ELEV (m)	86.62

POND ID	CB06
TOP OF GRATE (m)	86.16
STATIC ELEV (m)	86.27
STATIC DEPTH (m)	0.11
STATIC VOLUME (m³)	2.56
100yr ELEV (m)	86.27
100yr + 20% ELEV (m)	86.29

POND ID	CB07
TOP OF GRATE (m)	86.18
STATIC ELEV (m)	86.27
STATIC DEPTH (m)	0.09
STATIC VOLUME (m³)	1.67
100yr ELEV (m)	86.27
100yr + 20% ELEV (m)	86.29

POND ID	CB08
TOP OF GRATE (m)	86.13
STATIC ELEV (m)	86.43
STATIC DEPTH (m)	0.30
STATIC VOLUME (m³)	19.54
2yr ELEV (m)	86.26
100yr ELEV (m)	86.37
100yr + 20% ELEV (m)	86.41

POND ID	CB09
TOP OF GRATE (m)	86.13
STATIC ELEV (m)	86.43
STATIC DEPTH (m)	0.30
STATIC VOLUME (m³)	23.06
2yr ELEV (m)	86.26
100yr ELEV (m)	86.37
100yr + 20% ELEV (m)	86.41

POND ID	CB12
TOP OF GRATE (m)	86.17
STATIC ELEV (m)	86.27
STATIC DEPTH (m)	0.10
STATIC VOLUME (m³)	1.13
100yr ELEV (m)	86.27
100yr + 20% ELEV (m)	86.29

POND ID	CB13
TOP OF GRATE (m)	86.17
STATIC ELEV (m)	86.27
STATIC DEPTH (m)	0.10
STATIC VOLUME (m³)	1.13
100yr ELEV (m)	86.27
100yr + 20% ELEV (m)	86.29

POND ID	CB19
TOP OF GRATE (m)	86.45
STATIC ELEV (m)	86.52
STATIC DEPTH (m)	0.07
STATIC VOLUME (m³)	1.9
100yr ELEV (m)	86.45
100yr + 20% ELEV (m)	86.42

POND ID	CB15-16
TOP OF GRATE (m)	86.10
STATIC ELEV (m)	86.45
STATIC DEPTH (m)	0.35
STATIC VOLUME (m³)	29.26
2yr ELEV (m)	86.23
100yr ELEV (m)	86.45
100yr + 20% ELEV (m)	86.47

POND ID	CB14
TOP OF GRATE (m)	86.39
STATIC ELEV (m)	86.44
STATIC DEPTH (m)	0.06
STATIC VOLUME (m³)	1.15
100yr ELEV (m)	86.45
100yr + 20% ELEV (m)	86.47

POND ID	CBM02
TOP OF GRATE (m)	86.10
STATIC ELEV (m)	86.40
STATIC DEPTH (m)	0.30
STATIC VOLUME (m³)	97.5
100yr ELEV (m)	86.40
100yr + 20% ELEV (m)	86.42

POND ID	EXCB11
TOP OF GRATE (m)	86.37
STATIC ELEV (m)	86.51
STATIC DEPTH (m)	0.14
STATIC VOLUME (m³)	2.9
100yr ELEV (m)	86.51
100yr + 20% ELEV (m)	86.53

CITY PLAN NO. 18981  
CITY FILE NO. D07-12-23-0026  
Last Saved: August 30, 2023, by: Shereen - Plotter: Wednesday, September 6, 2023 2:20:11 PM by: Eric Henne

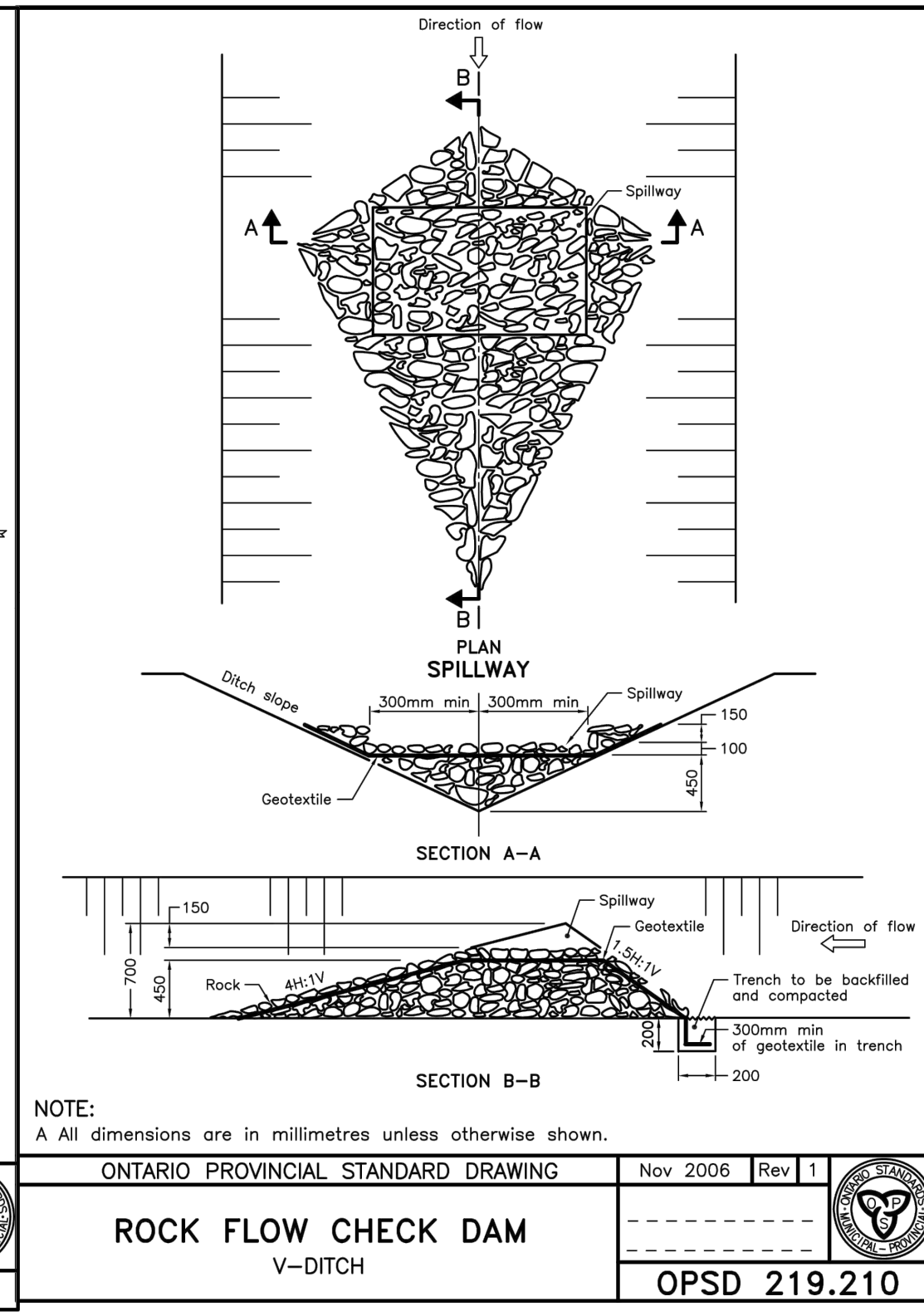
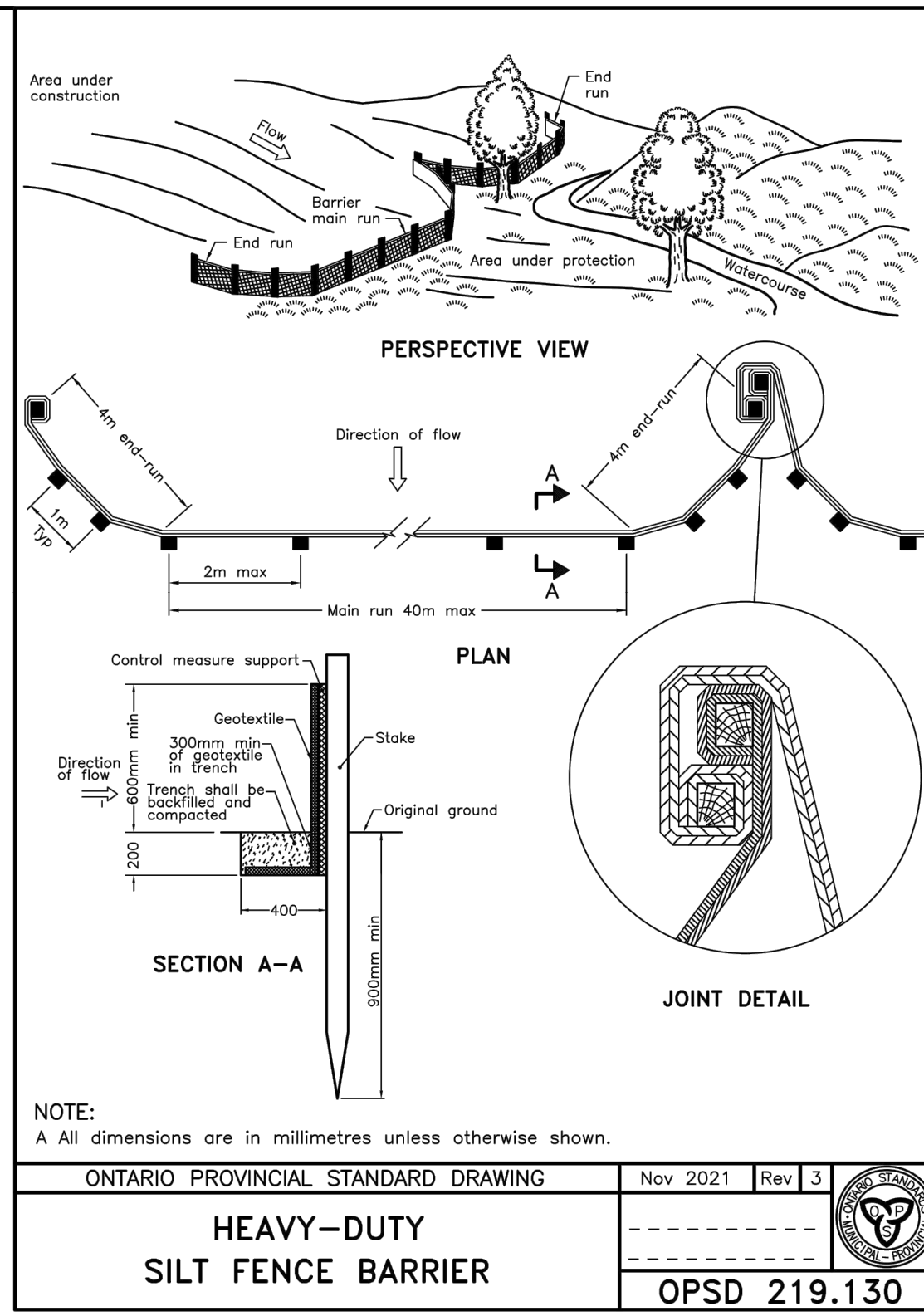

- NOTES:**
- SILT FENCE TO BE ERECTED PRIOR TO EARTH WORKS BEING COMMENCED. SILT FENCE TO BE MAINTAINED UNTIL VEGETATION IS ESTABLISHED OR UNTIL START OF SUBSEQUENT PHASE.
  - STRAW BALE SEDIMENT TRAPS TO BE CONSTRUCTED IN EXISTING ROAD SIDE DITCHES. TRAPS TO REMAIN AND BE MAINTAINED UNTIL VEGETATION IS ESTABLISHED.
  - SILT SACK TO BE PLACED AND MAINTAINED UNDER COVER OF ALL CATCHBASINS. GEOTEXTILE SILT SACK IN STREET C&Bs TO REMAIN UNTIL ALL CURBS ARE CONSTRUCTED. GEOTEXTILE FABRIC IN RYCBs TO REMAIN UNTIL VEGETATION IS ESTABLISHED. ALL CATCHBASINS TO BE REGULARLY INSPECTED AND CLEANED, AS NECESSARY, UNTIL SOD AND CURBS ARE CONSTRUCTED.
  - CONTRACTOR TO PROVIDE DETAILS ON LOCATION(S) AND DESIGN OF DEWATERING TRAP(S) PRIOR TO COMMENCING WORK. CONTRACTOR ALSO RESPONSIBLE FOR MAINTAINING TRAP(S) AND ADJUSTING SIZE(S) IF DEEMED REQUIRED BY THE ENGINEER DURING CONSTRUCTION.
  - CONTRACTOR TO PROTECT EXISTING CATCHBASINS WITH FILTER CLOTH UNDER THE COVERS TO TRAP SEDIMENTATION. REFER TO IDENTIFIED STRUCTURES.
  - WORKS NOTED ABOVE ARE TO BE INSTALLED, INSPECTED, MAINTAINED AND ULTIMATELY REMOVED BY SERVICING CONTRACTOR.
  - THIS IS A "LIVING DOCUMENT" AND MAY BE MODIFIED IN THE EVENT THE PROPOSED CONTROL MEASURES ARE INSUFFICIENT.

- LEGEND:**
- HEAVY DUTY SILT FENCE AS PER OPSD-219.130
  - SNOW FENCE
  - STRAW BALE CHECK DAM AS PER OPSD-219.180
  - ROCK CHECK DAM AS PER OPSD-219.210
  - SILT SACK PLACED UNDER EXISTING CB COVER
  - TEMPORARY MUD MAT 0.15m THICK 50mm CLEAR STONE ON NON WOVEN FILTER CLOTH

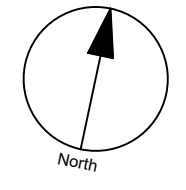

CLIENT  
**NORTH AMERICAN DEVELOPMENT GROUP**

**COPYRIGHT**  
This drawing has been prepared solely for the intended use. Any reproduction or distribution for any purpose other than authorized by IBI Group is forbidden. Written dimensions shall have precedence over scaled dimensions. Contractors shall verify and be responsible for all dimensions and conditions on the job, and IBI Group shall be informed of any variations from the dimensions and conditions shown on the drawing. Shop drawings shall be submitted to IBI Group for general concurrence before proceeding with fabrication.

IBI Group Professional Services (Canada) Inc.  
is a member of the IBI Group of companies.

**ISSUES**

No.	DESCRIPTION	DATE
1	ISSUED FOR CITY REVIEW	2023-02-06
2	REVISED AS PER NEW SITE PLAN	2023-09-06

SEE 010, 011, 012 FOR NOTES, LEGEND, CB TABLE, STREET SECTIONS AND DETAILS.

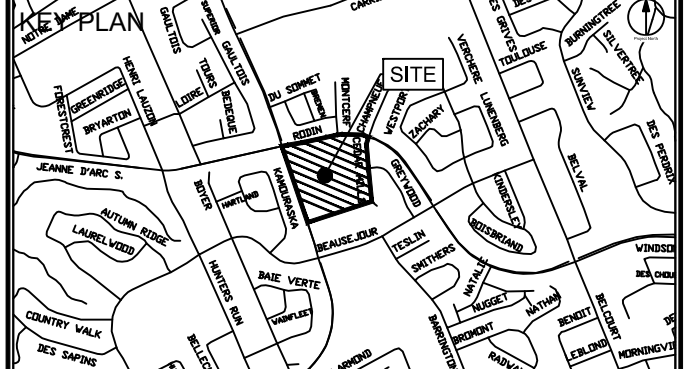

**LEGEND**

Project Coordinator:  
North American Development Group

Site Plan Architect:  
Q4 Architects Inc.

Surveyor:  
Fairhall, Moffatt and Woodland Ltd.

Geotechnical:  
Paterson Group

Traffic:  
IBI Group

Electrical:  
Hammerschlag & Joffe Inc.

Landscape:  
Levstek Consultants Inc.

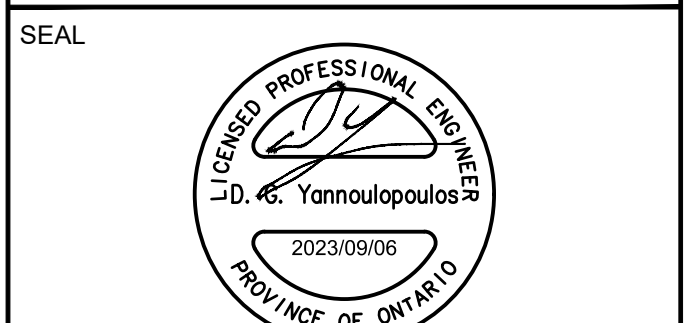

**IBI GROUP**  
Suite 400 - 333 Preston Street  
Ottawa ON K1S 5N4 Canada  
Tel: 613 225 1311 / 613 241 3300 Fax: 613 225 9868  
ibigroup.com

**PROJECT**  
ORLEANS GARDENS  
1615 ORLEANS BOULEVARD

**PROJECT NO:**  
122764

**DRAWN BY:**  
A.B. / E.H.

**CHECKED BY:**  
R.M./D.G.Y.

**PROJECT MGR:**  
R.M.

**APPROVED BY:**  
D.G.Y.

**SHEET TITLE**  
SEDIMENT-EROSION PLAN

**SHEET NUMBER**  
C-900

**ISSUE**  
2

Missing or invalid reference  
File: \\...\Library\OPSD\OPSD219.180.pdf  
Sheet: 1

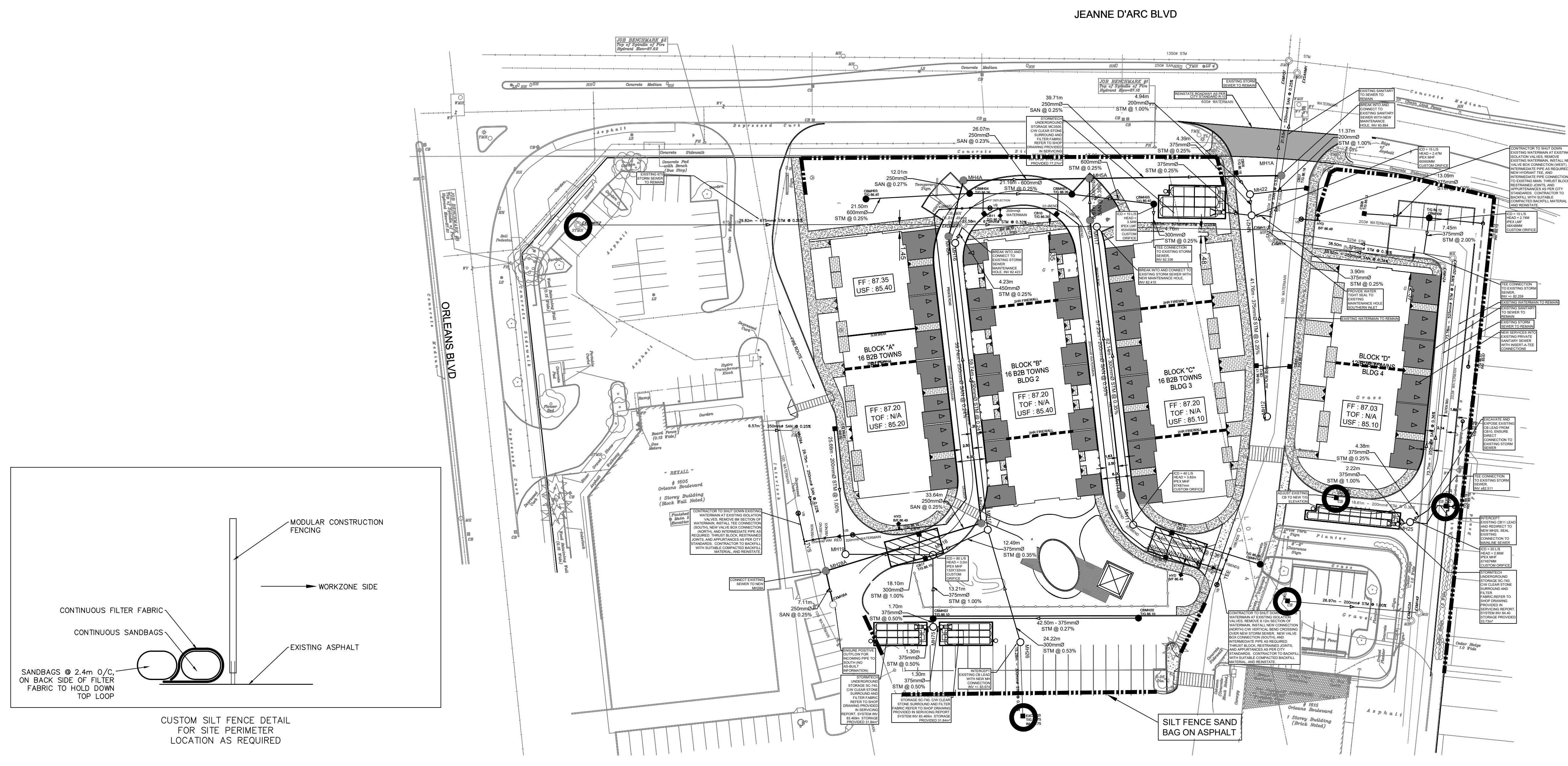

CITY PLAN NO. 18981  
CITY FILE NO. D07-12-23-0026  
Last Saved: July 20, 2023, by: Elenie  
Project: Wednesday, September 6, 2023 2:20:07 PM by: Eric Heine