

LEGEND

---	SITE BOUNDARY	---	EXISTING ADJACENT LEGAL LINE
---	LIMIT OF SITE PLAN CONTROL APPLICATION	---	EXISTING CULVERT
---	PROPOSED LIGHT DUTY SILT FENCE (AS PER O.P.S.D. 219.110)	---	EXISTING STORM MANHOLE
---	PROPOSED STRAW BALE (AS PER O.P.S.D. 219.180)	---	EXISTING CATCHBASIN
X X X	EXISTING BARRIER CURB TO BE REMOVED	---	EXISTING SANITARY MANHOLE
---	PROPOSED ASPHALT REMOVAL	---	EXISTING HYDRANT
---	PROPOSED MUD MAT	---	EXISTING VALVE & VALVE BOX
---	EXISTING LIGHT STANDARD ON CONCRETE BASE TO BE RELOCATED	---	EXISTING CENTERLINE SWALE
---		---	EXISTING TOP OF GRATE ELEVATION
---		---	EXISTING INVERT ELEVATION
---		---	EXISTING OVERHEAD WIRES
---		---	EXISTING UTILITY POLE
---		---	EXISTING TRAFFIC MANHOLE
---		---	EXISTING UTILITY POLE ANCHOR
---		---	EXISTING TRAFFIC SIGNAL LIGHT
---		---	EXISTING LIGHT STANDARD ON CONCRETE BASE
---		---	EXISTING SIGN
---		---	EXISTING CONCRETE

N.T.S.
NOTE: ALL EXISTING AND PROPOSED CATCHBASINS ARE TO HAVE AN INSERT UNTIL CONSTRUCTION OF SUBDIVISION IS COMPLETE.

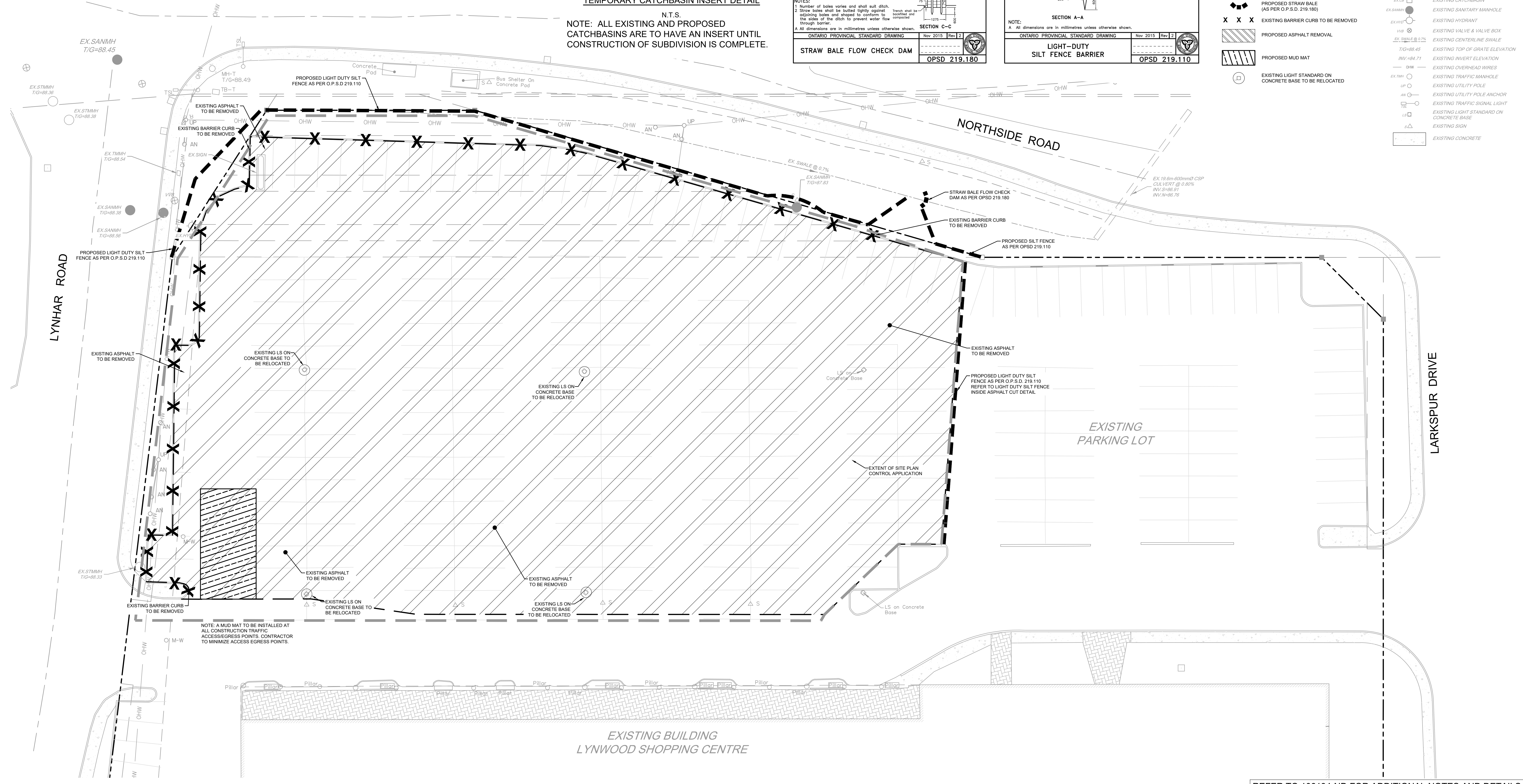

NOTE: A MUD MAT TO BE INSTALLED AT ALL CONSTRUCTION TRAFFIC ACCESS/EGRESS POINTS. CONTRACTOR TO MINIMIZE ACCESS/EGRESS POINTS.

REFER TO 106134-ND FOR ADDITIONAL NOTES AND DETAILS

**PRELIMINARY
NOT FOR
CONSTRUCTION**

No.	REVISION	DATE	BY
3.	REVISED AS PER CITY OF OTTAWA COMMENTS	APR 19/24	SAZ
2.	REVISED AS PER CITY OF OTTAWA COMMENTS	NOV 17/23	SAZ
1.	ISSUED WITH SITE PLAN APPLICATION	MAR 3/23	SAZ

SCALE	1:200
FOR REVIEW ONLY	SAZ
	MSP
	MTM
	SAZ
	MSP



CITY OF OTTAWA 1826 ROBERTSON ROAD LYNHAR RETAIL PLAZA		PROJECT No. 106134-00
DRAWING NAME REMOVALS AND EROSION & SEDIMENT CONTROL PLAN		REV # 3
		DRAWING No. 106134-RM-ESC

C:\0000106134-ND\design\106134-RM-ESC.dwg PLANS SET, Apr 19, 2024, 11:07am, mmskocp

D07-12-23-0027