

PLANTING SCHEDULE:

KEY	QTY.	BOTANICAL NAME	COMMON NAME	CALIPER (mm)	SIZE (cm)	CONDITION FORM	MIN. O.C. SPACING (m)
TREES							
Co	3	<i>Celtis occidentalis</i>	Common Hackberry	60		W.B.	12
PpG	3	<i>Picea pungens 'Glauca'</i>	Colorado Blue Spruce		200	W.B.	6
Qa	3	<i>Quercus alba</i>	White Oak	60		W.B.	12
Sd	7	<i>Sorbus decora</i>	Northern Mountain Ash	50		W.B.	6
TOTAL:	16						
SHRUBS							
Js	2	<i>Juniperus sabina</i>	Savin Juniper	40		3 Gal.	2
Rr	70	<i>Rosa rugosa</i>	Rugosa Rose	40		3 Gal.	1
SW	117	<i>Spiraea japonica 'Walburna'</i>	Magic Carpet Spirea	40		3 Gal.	1
ToE	17	<i>Thuja occidentalis 'Smaragd'</i>	Emerald Cedar	200			2
TOTAL:	206						
GRASSES							
CaK	187	<i>Calamagrostis acutiflora 'Karl Foerster'</i>	Karl Foerster Feather Reed Grass			1 Gal.	0.50
MsA	234	<i>Miscanthus sinensis 'Autumn Red'</i>	Autumn Red Maiden Grass			1 Gal.	0.50
TOTAL:	421						
PERENNIALS							
Hs	140	<i>Hemerocallis 'Stella de Oro'</i>	Stella de Oro Daylily			1 Gal.	0.50
TOTAL:	140						

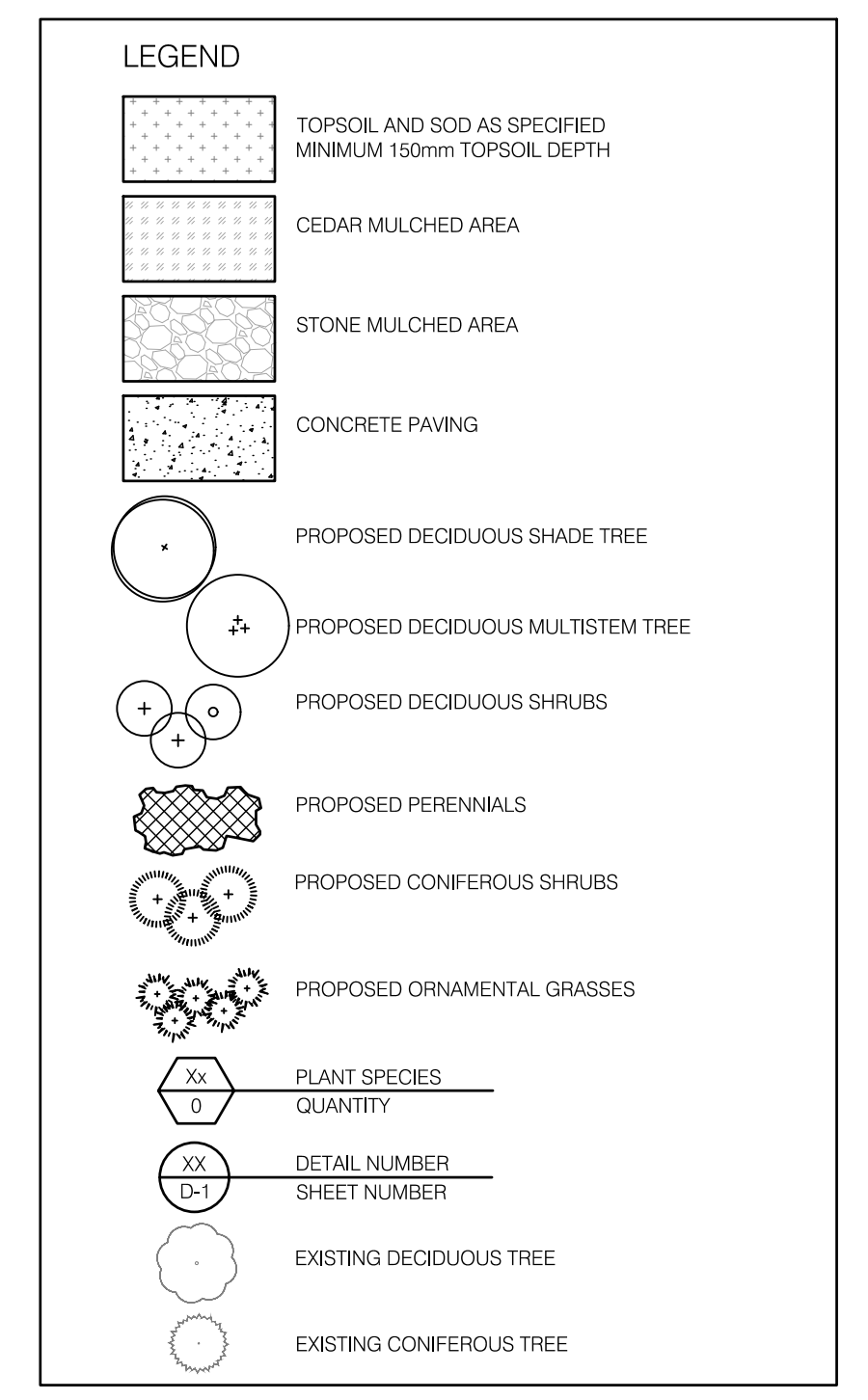

Allison Hamlin

ALLISON HAMLIN
MANAGER (A), DEVELOPMENT REVIEW WEST
PLANNING, REAL ESTATE & ECONOMIC DEVELOPMENT
DEPARTMENT, CITY OF OTTAWA

APPROVED
 By Allison Hamlin at 1:55 pm, Sep 19, 2023

- GENERAL NOTES**
- Any ambiguity in the drawings, specifications or details are to be reported to the Landscape Architect for direction. These drawings shall not be used for construction unless stamped and signed by the Landscape Architect. The Contractor is not to proceed in uncertainty. The limits of work are to be clearly understood by the Contractor prior to any work taking place on the site.
 - All dimensions are in meters unless otherwise noted. The drawings may be scaled for approximate layout. The Contractor is to verify all dimensions on the drawing(s) and report any discrepancies to the Landscape Architect.
 - The Contractor is to locate and mark all infrastructure and utilities prior to any excavation work or planting on the site. Do not plant directly above underground utilities or infrastructure unless approved by the Landscape Architect. Dig all holes by hand when closer than 1.0m to any underground power, telephone or gas utility. The Contractor is responsible for the coordination and maintenance of all utility/infrastructure locates for the duration of the Contract.
 - The Contractor shall supply all materials in quantities sufficient to complete work shown on these drawings. The Contractor is not to substitute materials, products or quantities without prior written consent of the Landscape Architect.
 - The Contractor is to take all necessary precautions to protect all existing site features unless specified for removal/demolition. This includes all survey bars, stakes, monuments and sediment barriers. The Contractor is responsible for all protection or hoarding measures of all existing trees and vegetation to be preserved within or adjacent to construction work limits.
 - Contractor is responsible for the removal of all debris, garbage and surplus materials on site related to their contract or work and must keep the site in a clean, safe, useable condition at all times or as directed by the Contract Administrator.

- SOD NOTES**
- Any lawn areas disturbed by construction shall be re-sodded and repaired to original condition or better.
 - Sod and sodding operations to be in accordance with OPSS 803, except as noted below.
 - Sod to be delivered to project within 24 hours of being harvested and laid within 36 hours thereafter.
 - Rough graded and compacted soil shall be scarified to a minimum depth of 100 mm free of all stones, roots, branches, larger than 25 mm diameter. Topsoil to be spread at a minimum depth of 150 mm compacted to 85% S.P.D.
 - Place sod on prepared topsoil with staggered joints and butt tightly. Irrigate immediately to ensure moisture penetration into the upper 100 mm (4") of soil. Machine roll to ensure contact with topsoil. Repair minor grade deficiencies and irregularities.
 - Water sod immediately after laying to obtain moisture penetration to a minimum of 100 mm depth within topsoil. Maintain sod per OPSS 803. Sod must be cut a minimum of two times for Final Acceptance at the discretion of the Landscape Architect.
- PLANTING NOTES**
- The Contractor must notify the Landscape Architect prior to the commencement of any planting. The Contractor shall supply all plants and materials in quantities sufficient to complete the work shown on this drawing. Any discrepancies between quantities shall be reported to the Landscape Architect.
 - All landscape works will be warranted for a period of two years following inspection and written notice of start of warranty period as determined and provided by the Landscape Architect. Plant material, which is not in a healthy, vigorous growing condition at the end of the warranty period, shall be replaced to the satisfaction of the Landscape Architect / Owner.
 - The Landscape Architect reserves the right to extend Contractor's warranty responsibilities for an additional year if, at the end of initial warranty period, leaf development and growth is not sufficient to ensure future survival as determined by the Landscape Architect.
 - The Contractor is to identify with Landscape Architect/Owner any maintenance requirements necessary for warranty purposes.
 - Plant materials specified for this project will conform to the Canadian Nursery Landscape Association (C.N.L.A.) for size, variety and condition as indicated on the plant schedule shown on these drawings. Any plant materials which do not conform will be promptly removed from the site and replaced by the Contractor at no additional cost to the project.
 - The Landscape Architect is to be contacted for inspection and written approval prior to plant material arriving on site. The Landscape Architect reserved the right to reject any plant materials that have not been inspected and approved.

- The Landscape Architect reserves the right to refuse acceptance of any plant displaying poor growth habits, injury or disease. Any plant material that is rejected by the Landscape Architect will be promptly removed from the site and replaced with material of acceptable quality at no additional charge to the project.
- Plant materials collected from wild sources will not be accepted without written approval of the Landscape Architect. The Landscape Architect reserves the right to require that supplier invoices be submitted for inspection and approval prior to acceptance.
- On-site layout of the plant materials to be approved by the Landscape Architect prior to installation. Minor field adjustments to plant material locations may be necessary to respond to the locations of existing plants and site conditions. The Contractor to review with Landscape Architect where relocations are necessary. The Contractor must receive approval from Landscape Architect prior to installation.
- Plants are not to be installed during extreme heat, drought, or other undesirable conditions. Thoroughly water all plants immediately after installation. The Contractor shall regularly monitor site conditions and water as required to ensure healthy growth conditions throughout the duration of the warranty period.
- Do not plant directly in centerline of drainage swales or depression areas. Where proposed planting locations conflict with constructed swales or low-lying wet areas, contact Landscape Architect for direction.
- All trees and shrubs are to be planted in accordance with the planting details shown on this drawing.
- Topsoil: Each source of topsoil, imported or native to be approved by Landscape Architect prior to use. Submit topsoil analysis/test results to Landscape Architect prior to order or delivery to site. Testing to be in accordance with Contract specifications. Supply and place topsoil in accordance with OPSS 802 to a minimum depth of 150mm in seed/sod areas, 600mm depth in perennial shrub planting beds, and 1000mm depth where trees are supported, unless otherwise specified.
- Mulch: to be spread uniformly around the base of trees and shrubs to a minimum depth of 100 mm. Do not place mulch in direct contact with trunk or stem(s). Allow a 100 mm mulch free zone at trunk/stems. Shrubs to be in continuously mulched planting beds unless otherwise specified.
- The Contractor is to remove dead or damaged branches on trees or shrubs. All pruning shall be performed in accordance with standard horticultural practices and appropriate timing for each species.
- All stakes and associated ties are to be removed after the first full growing season. Rodent guards are to be removed at the conclusion of the warranty period. Gatorbags are to be removed for winter months.

CLIENT
CHICK-FIL-A

BUILDING 17, 3000 PALLADIUM DRIVE, KANATA, ONTARIO

COPYRIGHT
This drawing has been prepared solely for the intended use. This any reproduction or distribution for any purpose other than that authorized by IBI Group is forbidden. While dimensions shall have precedence over scaled dimensions, Contractors shall verify and be responsible for all dimensions and conditions on the job, and IBI Group shall be informed of any variations from the dimensions and conditions shown on the drawing. Shop drawings shall be submitted to IBI Group for general conformance before proceeding with fabrication.

IBI Group Professional Services (Canada) Inc.
is a member of the IBI Group of companies.

ISSUES

No.	DESCRIPTION	DATE
1	FOR CLIENT REVIEW	2023.03.14
2	ISSUED FOR SPA	2023.06.01
3	ISSUED FOR SPA	2023.07.06

KEY PLAN
N.T.S.

CONSULTANTS

SEAL

SITE PLAN NUMBER

PRIME CONSULTANT
IBI GROUP
 Suite 101 - 410 Albert Street
 Waterloo ON N2L 3V3 Canada
 tel 519 585 2255
 ibigroup.com

PROJECT
BUILDING 17 CHICK-FIL-A
 3000 PALLADIUM DRIVE

PROJECT NO: 141991
DRAWN BY: R.S.
PROJECT MGR: M.P.

CHECKED BY: M.P.
APPROVED BY: T.M.

SHEET TITLE
LANDSCAPE PLAN

SHEET NUMBER LP-1 **ISSUE** 3

SCALE CHECK
 File Location: Q:\141991_Chick-Fil-A_17.d; Production\7_03_Design\Landscaping\141991_Landsc...
 Last Saved: August 1, 2023, by Raehnaa.Shenoy
 Plotted: Friday, August 25, 2023 9:39:23 AM by Raehnaa.Shenoy
 CITY FILE NO. D07-12-23-0000
 CITY PLAN NO. 18996