

- NOTES:**
- GENERAL CONTRACTOR SHALL REFER TO CHICK-FIL-A PARKING LOT STRIPING SPECIFICATIONS. SEE DETAIL.
 - CONTRACTOR SHALL USE WHITE REFLECTIVE PAINT ON ASPHALT & YELLOW REFLECTIVE PAINT ON CONCRETE.

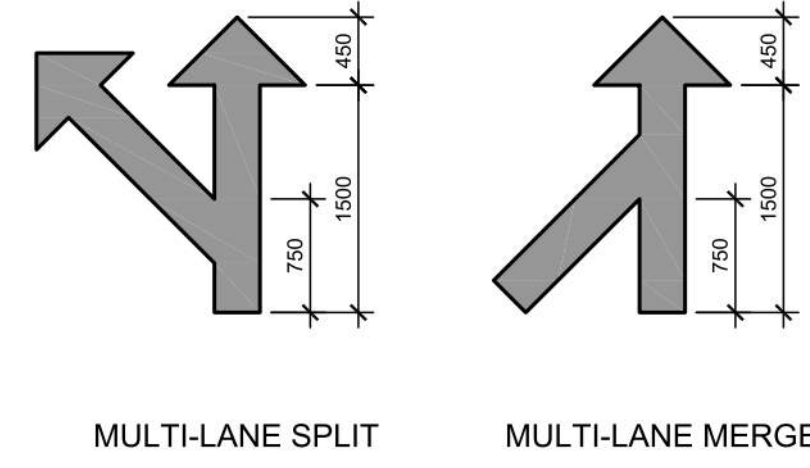

- NOTES:**
- GENERAL CONTRACTOR SHALL REFER TO CHICK-FIL-A PARKING LOT STRIPING SPECIFICATIONS. SEE DETAIL.
 - CONTRACTOR SHALL USE WHITE REFLECTIVE PAINT ON ASPHALT & YELLOW REFLECTIVE PAINT ON CONCRETE.

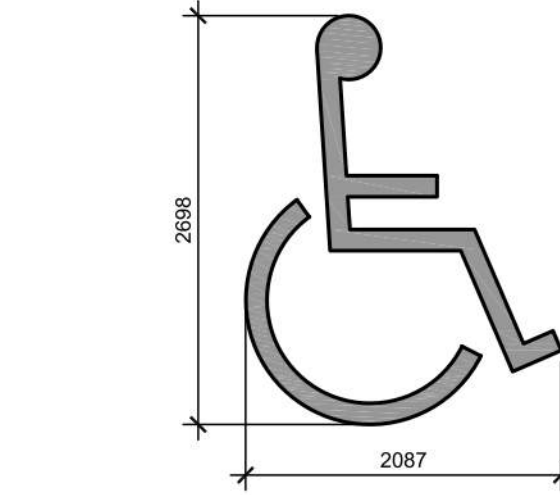

- NOTES:**
- GENERAL CONTRACTOR SHALL REFER TO CHICK-FIL-A PARKING LOT STRIPING SPECIFICATIONS. SEE DETAIL.
 - CONTRACTOR SHALL USE WHITE REFLECTIVE PAINT ON ASPHALT & YELLOW REFLECTIVE PAINT ON CONCRETE.

PARKING LOT STRIPING SPECIFICATIONS:

- STANDARDS:**
- ALWAYS FOLLOW ALL APPLICABLE GOVERNING AUTHORITY'S STANDARDS.
 - SURFACES SHOULD BE CLEAN, DRY, AND FREE FROM LOOSE OR PEELING PAINT. REMOVE ALL OIL, DUST, GREASE, DIRT, AND OTHER FOREIGN MATERIAL TO ENSURE ADEQUATE ADHESION. DO NOT APPLY WHEN AIR OR SURFACE TEMPERATURES ARE BELOW 40°F.
 - APPLY SHERWIN-WILLIAMS SETFAST PREMIUM ALKYD ZONE MARKING PAINT A300 WHITE OR A303 YELLOW USING EITHER AIRLESS OR CONVENTIONAL LINE STRIPING EQUIPMENT. USE THE FOLLOWING SETTINGS AS A GUIDE-ACTUAL SETTINGS DEPEND ON ATMOSPHERIC CONDITIONS AT THE TIME OF APPLICATION:

- | | |
|------------------------|---|
| AIRLESS | 1800-2700 PSI |
| • PRESSURE | 7/8" ID |
| • NOSE | 0.015"-0.017" |
| • TIP | 60 MESH |
| • FILTER | ONLY IF NECESSARY, UP TO 1PT/GAL. VM&P NAPHTHA R1K3 |
| • REDUCTION | |
| CONVENTIONAL | |
| • GUN | BLINKS 21 (BLEEDER) OR EQUIVALENT |
| • FLUID NOZZLE | #88 |
| • AIR NOZZLE | INTERNAL MIX, #709 |
| • ATOMIZATION PRESSURE | 45-80 PSI |
| • FLUID PRESSURE | 40-70 PSI |
| • REDUCTION | ONLY IF NECESSARY, UP TO 1PT/GAL. VM&P NAPHTHA R1K3 |

- SHERWIN WILLIAMS, H&C SHARK GRIP SLIP RESISTANT ADDITIVE TO BE MEASURED AND ADDED TO ALL PAINT PER MANUFACTURER'S WRITTEN SPECIFICATIONS. MIX THOROUGHLY PER MANUFACTURER'S RECOMMENDATIONS SO THAT NO CLUMPING IS APPARENT AND UNTIL EVEN DISTRIBUTION IS ACHIEVED. MAINTAIN EVEN DISTRIBUTION OF ADDITIVE IN PAINT THROUGHOUT THE APPLICATION PROCESS.
- MIX PAINT THOROUGHLY BY BOXING, STIRRING, OR POWER AGITATION BEFORE USE. APPLY AT 15 MILS WET TO ACHIEVE A SPREAD RATE OF 400-500 LINEAL FEET OF STANDARD 100mm STRIPE PER GALLON. APPLIED AT THIS RATE AT 70 DEGREES F AND 50% RELATIVE HUMIDITY, PAINT WILL DRY WITH NO TRAFFIC PICKUP AFTER 30 MINUTES.
- GENERAL CONTRACTOR TO RE-STRIP THE LOT 45 DAYS AFTER OPENING.

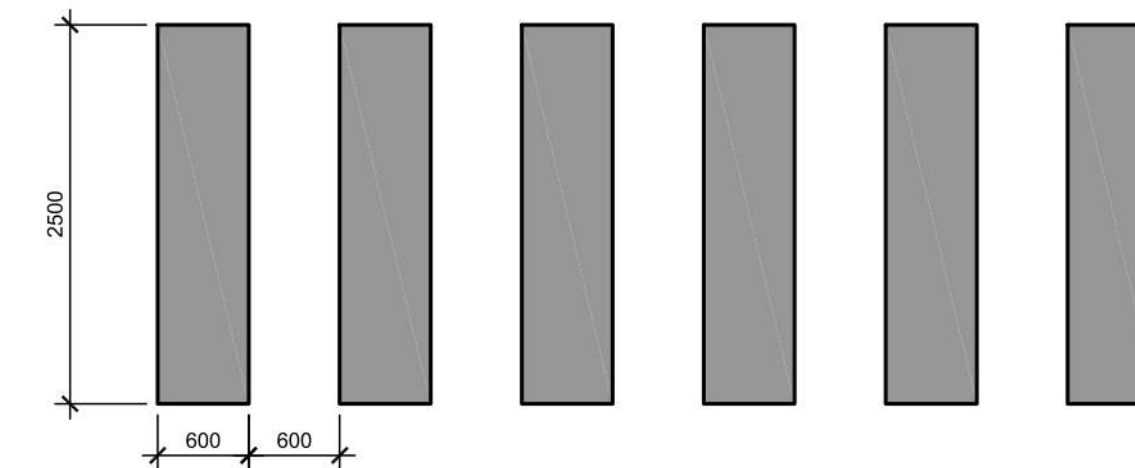

- NOTES:**
- REFER TO PARKING LOT STRIPING SPECIFICATION.
 - CROSSWALK ALONG AN ACCESSIBLE ROUTE SHALL MAINTAIN A CROSS SLOPE OF 1.5% MAX AND A RUNNING SLOPE OF 5% MAX.

Allison Hamlin
ALLISON HAMLIN
MANAGER (A), DEVELOPMENT REVIEW WEST
PLANNING, REAL ESTATE & ECONOMIC DEVELOPMENT
DEPARTMENT, CITY OF OTTAWA

APPROVED

By Allison Hamlin at 1:54 pm, Sep 19, 2023

1 DIRECTIONAL ARROWS
A102 N.T.S.

2 MULTI-LANE DIRECTIONAL ARROWS
A102 N.T.S.

3 ACCESSIBLE SYMBOL
A102 N.T.S.

4 CROSSWALK DETAIL
A102 N.T.S.

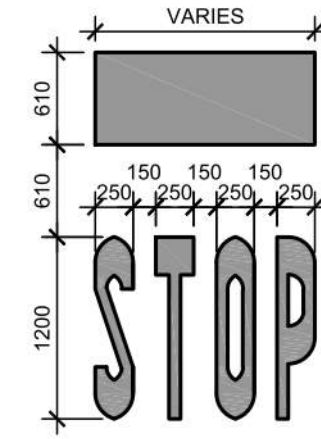

- NOTES:**
- GENERAL CONTRACTOR SHALL REFER TO CHICK-FIL-A PARKING LOT STRIPING SPECIFICATIONS. SEE DETAIL.
 - CONTRACTOR SHALL USE WHITE REFLECTIVE PAINT ON ASPHALT & YELLOW REFLECTIVE PAINT ON CONCRETE.
 - IF STOP SIGN IS PROPOSED, STOP LINE GRAPHIC NOT REQUIRED.

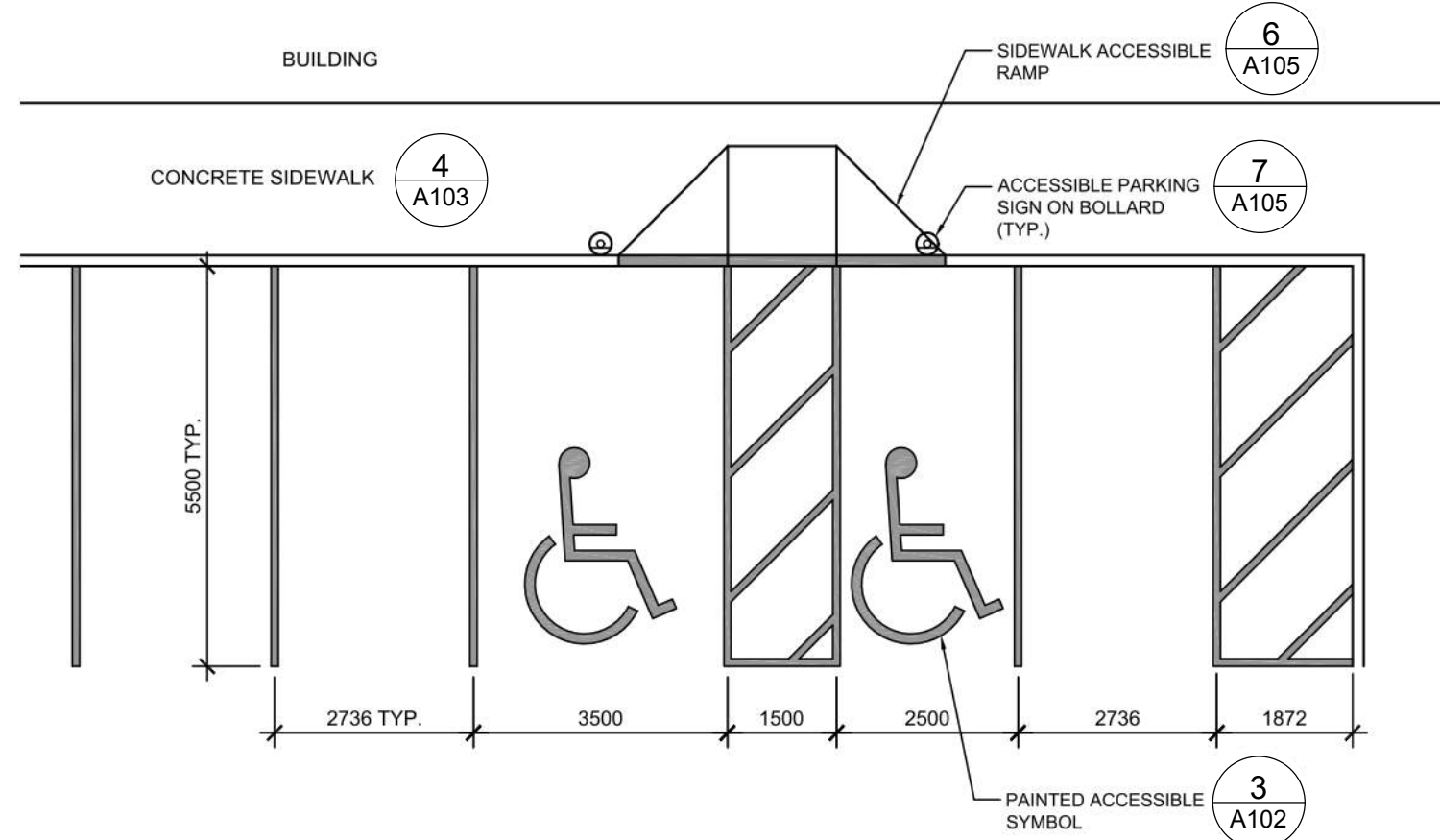

NOTES:

- ACCESSIBLE PARKING AND ACCESSIBLE AISLES SHALL NOT EXCEED 1.5% IN SLOPE IN ANY DIRECTION. IF ONLY ONE ACCESS AISLE IS INSTALLED, IT IS TO BE A VAN SIZE.
- PARKING STALL DIMENSIONING SHALL BE IN ACCORDANCE WITH APPLICABLE GOVERNING AUTHORITY'S AND ADA STANDARDS AND IF DIFFERENT THAN THIS DETAIL SHALL BE THE DIMENSIONING SHOWN ON THE SITE LAYOUT PLAN.
- GENERAL CONTRACTOR SHALL REFER TO CHICK-FIL-A PARKING LOT STRIPING SPECIFICATIONS.
- CONTRACTOR SHALL USE 100mm WIDE WHITE REFLECTIVE PAINT FOR STRIPING ON ASPHALT PARKING LOTS.
- CONTRACTOR SHALL USE 100mm WIDE YELLOW REFLECTIVE PAINT FOR STRIPING ON CONCRETE PARKING LOTS.
- NO WHEEL STOPS TO BE INSTALLED WHEN PARKING IS ADJACENT TO SIDEWALK.
- ACCESSIBLE SIGNS IN BOLLARDS AND BOLLARDS SHALL BE INSTALLED WHEN PARKING IS ADJACENT TO FLUSH CURB OR A RAMP.

M-GREASE

- CAPACITY: 800 L / 1.0 YD 3
MOLOK WASTE MANagements SYSTEMS
- FRAMING:**
- CEDAR
 - MAHOAGANY
- RECYCLED PLASTIC FRAMING**
- RED
 - ORANGE
 - CEDAR BEIGE
 - GREEN
 - BLUE
 - GREY
 - BLACK
- ALUMINUM FRAMING**
- SILVER
 - BLACK

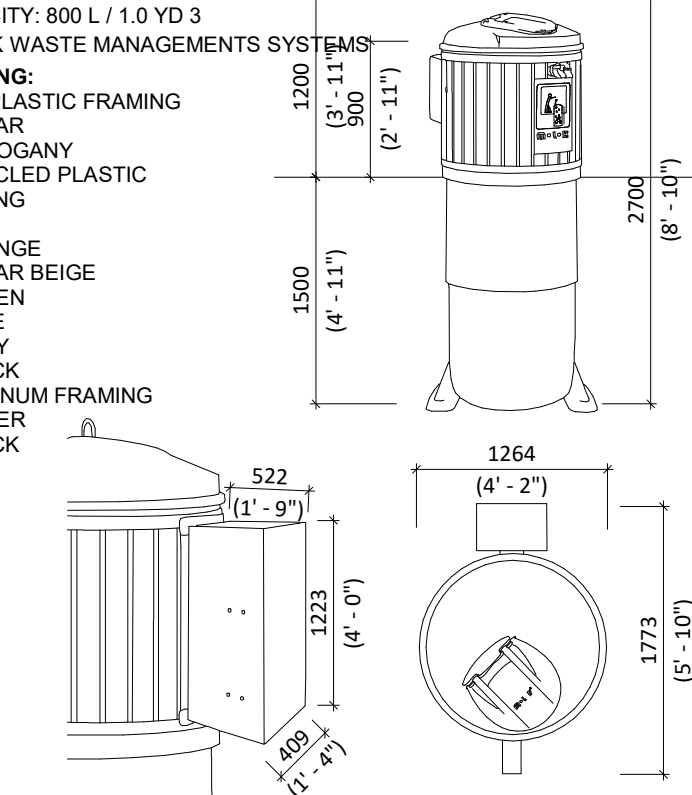

7 MOLOK DETAIL (GREASE)
A102 1:50

5 STOP GRAPHICS
A102 N.T.S.

6 STANDARD PARKING LAYOUT
A102 N.T.S.

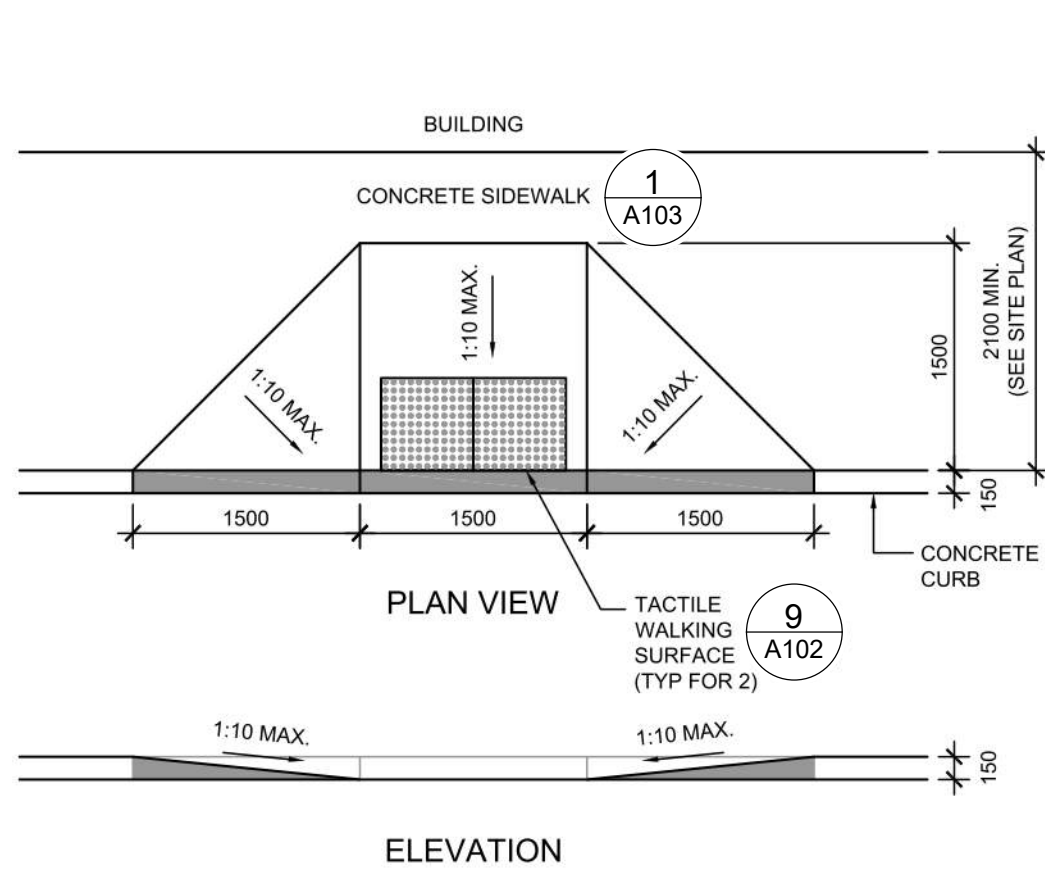

8 CURB RAMP DETAIL
A102 N.T.S.

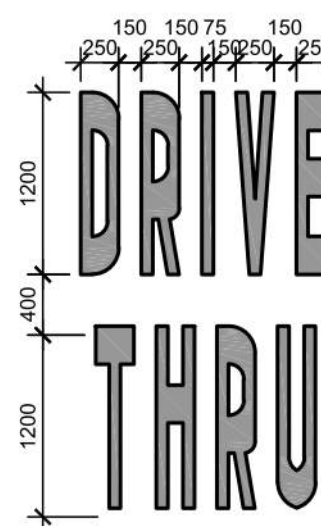
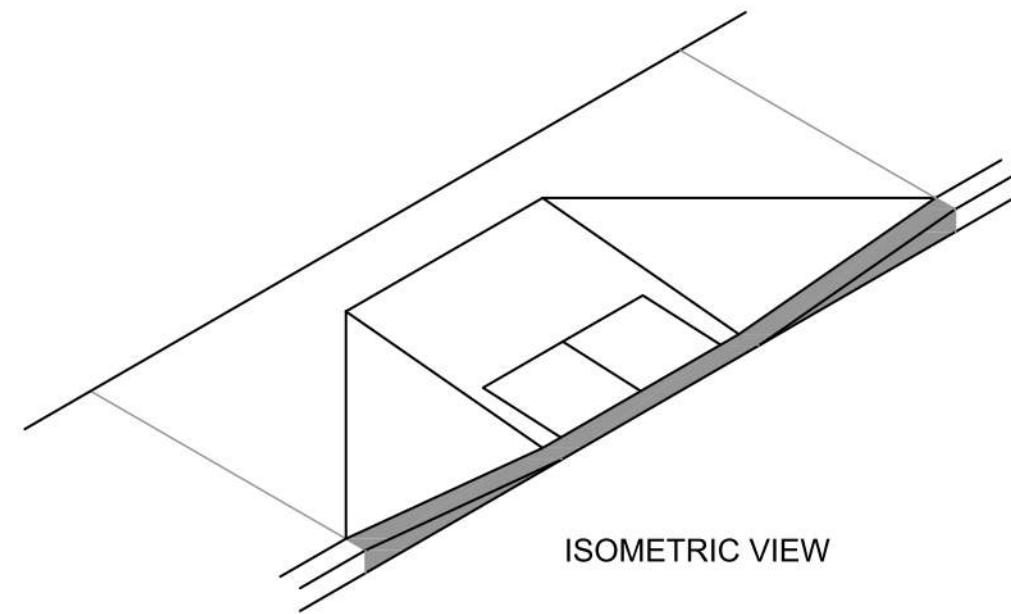

NOTES:

- GENERAL CONTRACTOR SHALL REFER TO CHICK-FIL-A PARKING LOT STRIPING SPECIFICATIONS. SEE DETAIL.
- CONTRACTOR SHALL USE WHITE REFLECTIVE PAINT ON ASPHALT & YELLOW REFLECTIVE PAINT ON CONCRETE.

10 DRIVE-THRU GRAPHICS
A102 N.T.S.

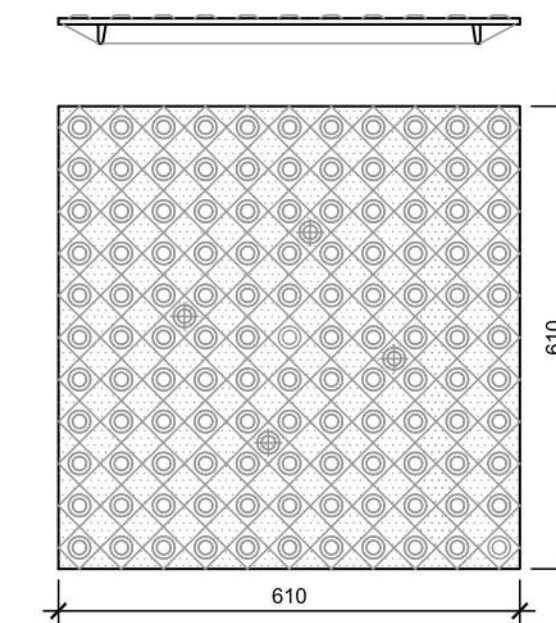

NOTES:

- TACTILE WALKING SURFACE TO COMPLY WITH O.B.C. 3.8.3.18 AND OPSD 310.039 - "CONCRETE SIDEWALK RAMPS TACTILE WALKING SURFACE INDICATOR COMPONENTS"

9 TACTILE WALKING SURFACE
A102 N.T.S.

NOTES:

- CURB RAMP RUNNING SLOPES SHALL NOT BE STEEPER THAN 1:14 AND CROSS SLOPE SHALL BE 1.5% OR FLATTER.
- DETECTABLE WARNING (IF REQUIRED) SHALL BE INSTALLED AT A DEPTH OF 24" FROM THE BACK OF CURB LINE FOR THE LENGTH OF THE RAMP LANDING.
- DETECTABLE WARNING SURFACES SHALL BE CONSTRUCTED BY TEXTURING PRODUCTS CONFORMING TO PROWAG R304. TRANSITION SLOPES ARE NOT TO HAVE DETECTABLE WARNINGS. CONTRACTOR SHALL CONFIRM LOCAL CODES ARE MET.
- WHERE A CURB RAMP IS CONSTRUCTED WITHIN AN EXISTING CURB, CURB & GUTTER AND/OR SIDEWALK, THE EXISTING CURB & GUTTER SHALL BE REMOVED TO THE NEAREST JOINT BEYOND THE CURB TRANSITIONS OR TO THE EXTENT THAT NO REMAINING SECTION OF CURB OR CURB & GUTTER IS LESS THAN 5' LONG. THE EXISTING SIDEWALK SHALL BE REMOVED TO THE NEAREST JOINT BEYOND THE TRANSITION SLOPE WALK AROUND OR TO THE EXTENT THAT NO REMAINING SECTION OF SIDEWALK IS LESS THAN 5'.
- THE PLAN MUST PROVIDE FOR DETECTABLE WARNING SURFACE COLORS OR MATERIALS THAT PROVIDE THE NECESSARY CONTRAST, EITHER DARK-ON-LIGHT, OR LIGHT-ON-DARK. STANDARD DOME COLOR IS BRICK RED.
- TRUNCATED DOMES TO BE INSTALLED USING ARMOR TILE CAST IN PLACE DOME TACTILE TILE. PART NUMBER ADA-2424 OR OTHER EQUIVALENT APPROVED MATERIAL. PREFERRED MANUFACTURER ARMOR TILE TACTILE SYSTEMS LANCE MITCHELL (919)622-4615 UNLESS PAVERS ARE REQUIRED, CONTRACTOR TO VERIFY THAT CURB RAMPS MEET LOCAL CODES AND ADA REQUIREMENTS.

| # | DATE | DESCRIPTION | BY |
|---|------------|----------------------------|-----|
| 7 | 2023-08-03 | ISSUE FOR SPA SUBMISSION 3 | MHB |
| 6 | 2023-07-18 | ISSUE FOR SPA SUBMISSION 3 | MHB |
| 5 | 2023-07-13 | ISSUE FOR SPA SUBMISSION 2 | MHB |
| 4 | 2023-06-30 | ISSUE FOR SPA SUBMISSION 2 | MHB |
| 3 | 2023-06-14 | ISSUE FOR SPA SUBMISSION 2 | MHB |
| 2 | 2023-03-14 | ISSUE FOR SPA SUBMISSION 1 | MHB |
| 1 | 2023-03-07 | ISSUE FOR REVIEW | MHB |

RIO CAN

PROJECT
CHICK-FIL TANGER OUTLETS OTTAWA

3000 PALLADIUM DRIVE, STITTSVILLE, ON K2S 1B9

DRAWING

SITE DETAILS

PROJECT NO.

12-258P01

PROJECT DATE

2023-02-14

DRAWN BY

Author

CHECKED BY

Checker

SCALE

As indicated

DRAWING NO.

A102

REV

7

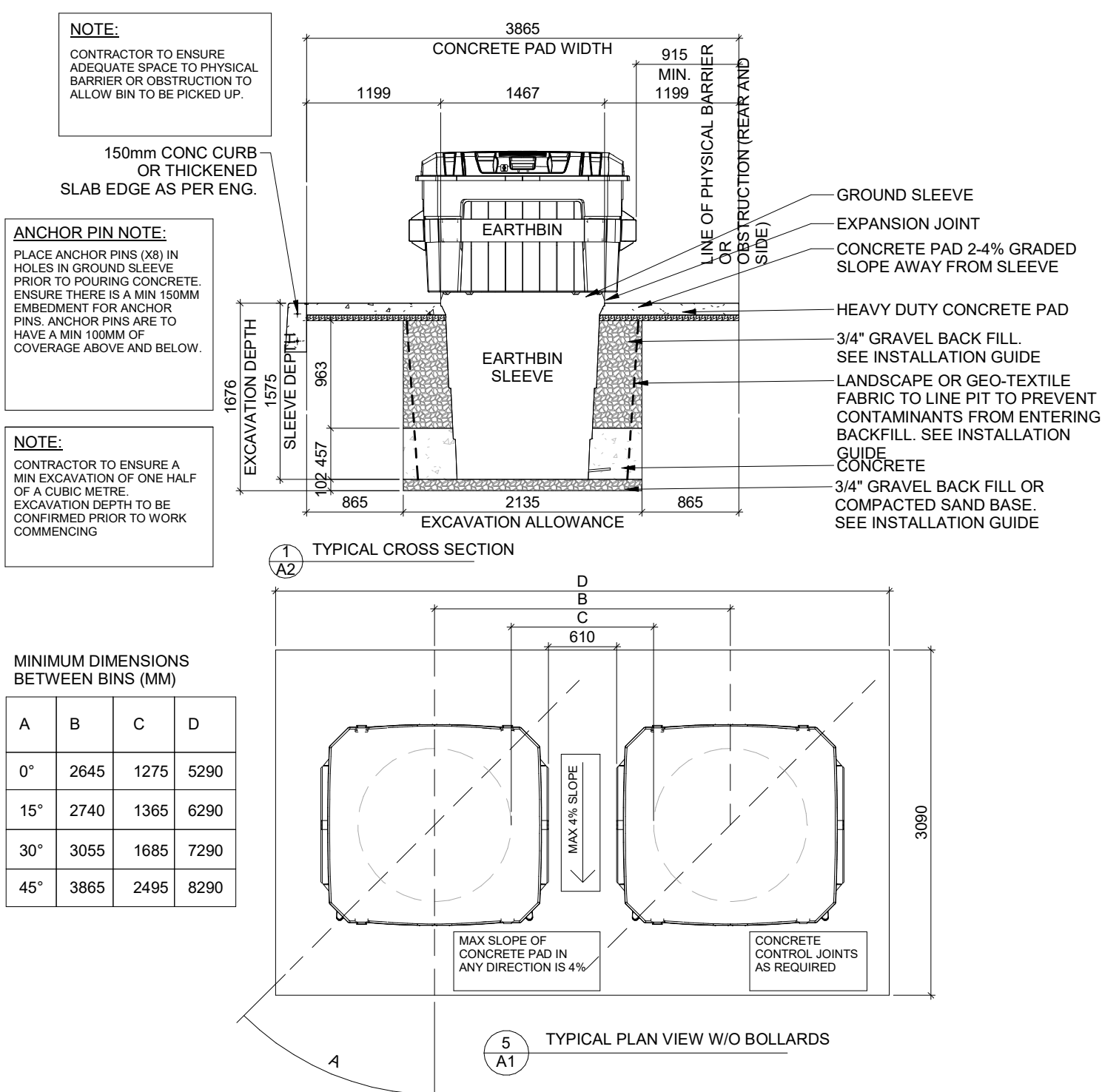

1 EARTH BIN DETAIL
A103 1:50

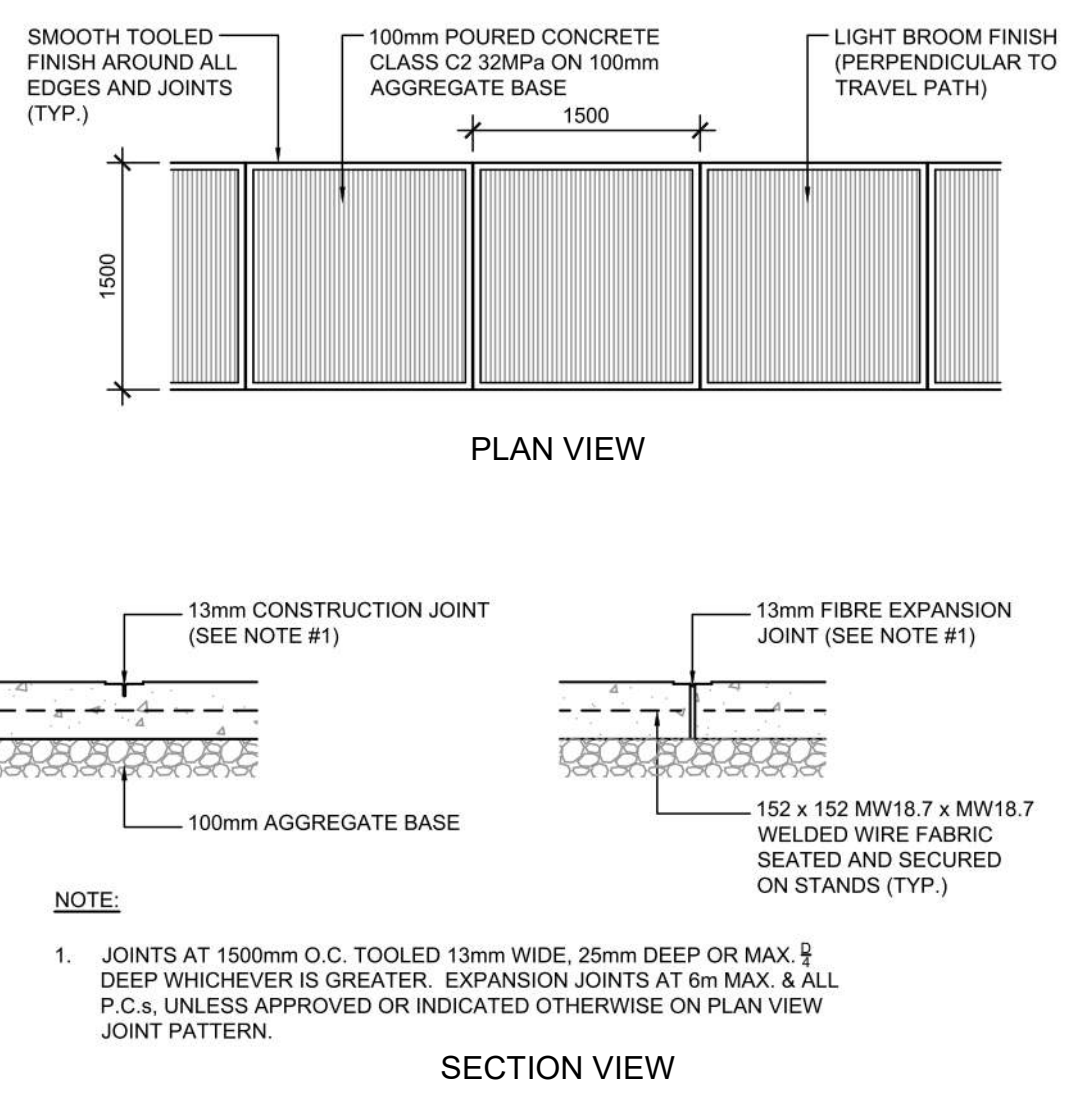

2 LIGHT STANDARD BASE
A103 N.T.S.

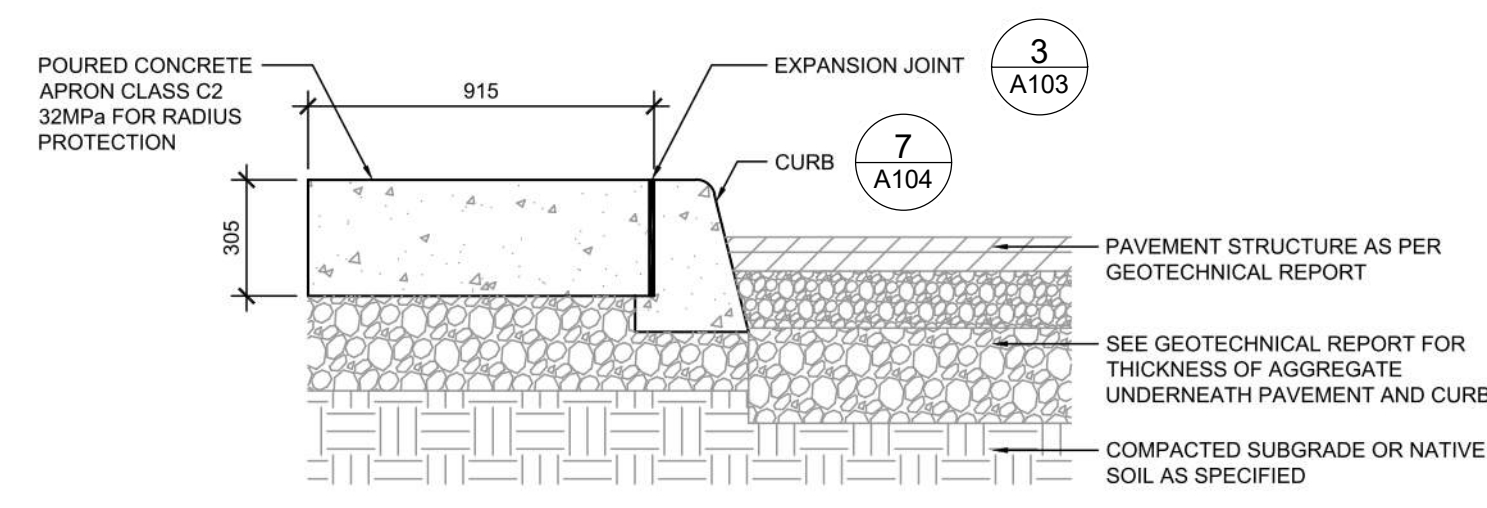

3 TYPICAL SIDEWALK DETAIL
A103 N.T.S.

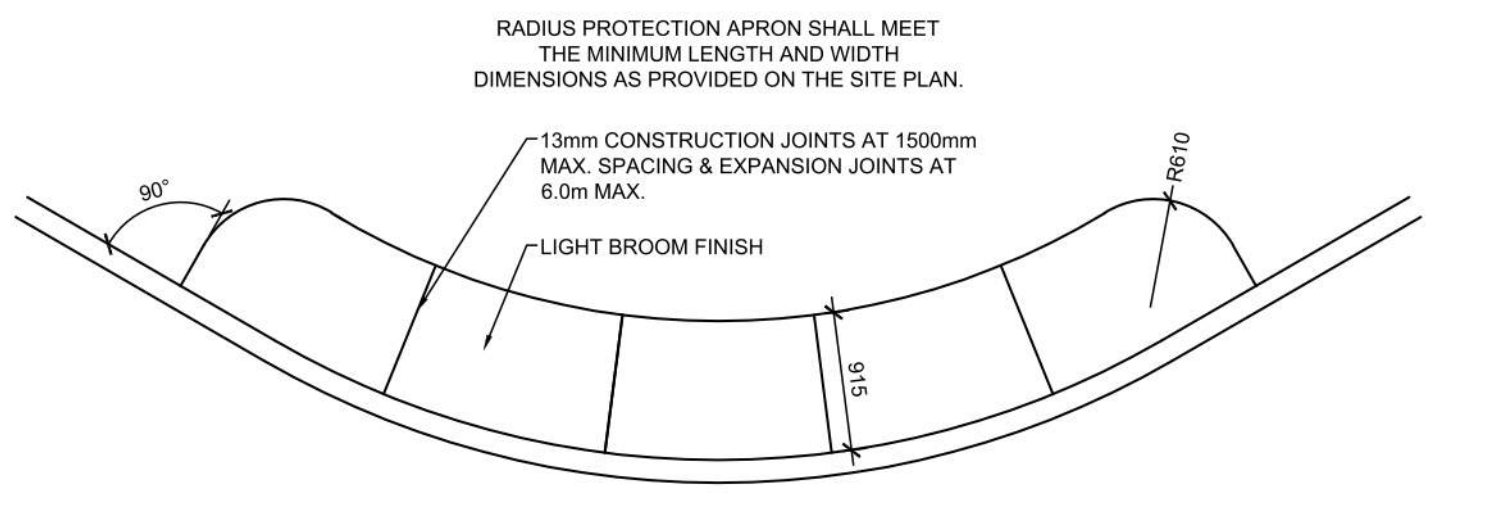

5 LANDSCAPE & IRRIGATION PROTECTION DETAIL
A103 N.T.S.



7 LANDSCAPE & IRRIGATION PROTECTION PLAN
A103 N.T.S.

NOTES:
1. CONTRACTOR HAS THE OPTION TO DRILL, SET AND EPOXY GROUT DOWELS, IF NOT INSTALLED WHEN THE BUILDING SLAB WAS POURED.
2. REFER TO ARCHITECTURAL DRAWINGS FOR DOOR LOCATIONS. DOOR STOOP SHALL EXTEND 300mm PAST EACH SIDE OF DOOR MIN. STOOPS TO BE SEPARATED ON ALL SIDES WITH 13mm EXPANSION JOINT MATERIAL, TOPPED WITH SEALANT.
3. USE A 2400X2100mm SLAD MINIMUM AT A DOUBLE DOOR ENTRY.
4. USE A 2100X1500mm SLAD MINIMUM AT A DOUBLE DOOR ENTRY.
5. DOWELS TO BE INSTALLED INTO THE BUILDING FOUNDATION ONLY. THE REMAINING THREE SIDES OF THE SLAB TO NOT GET TIED TO THE SURROUNDING SIDEWALK.

3 TYPICAL SIDEWALK DETAIL
A103 N.T.S.

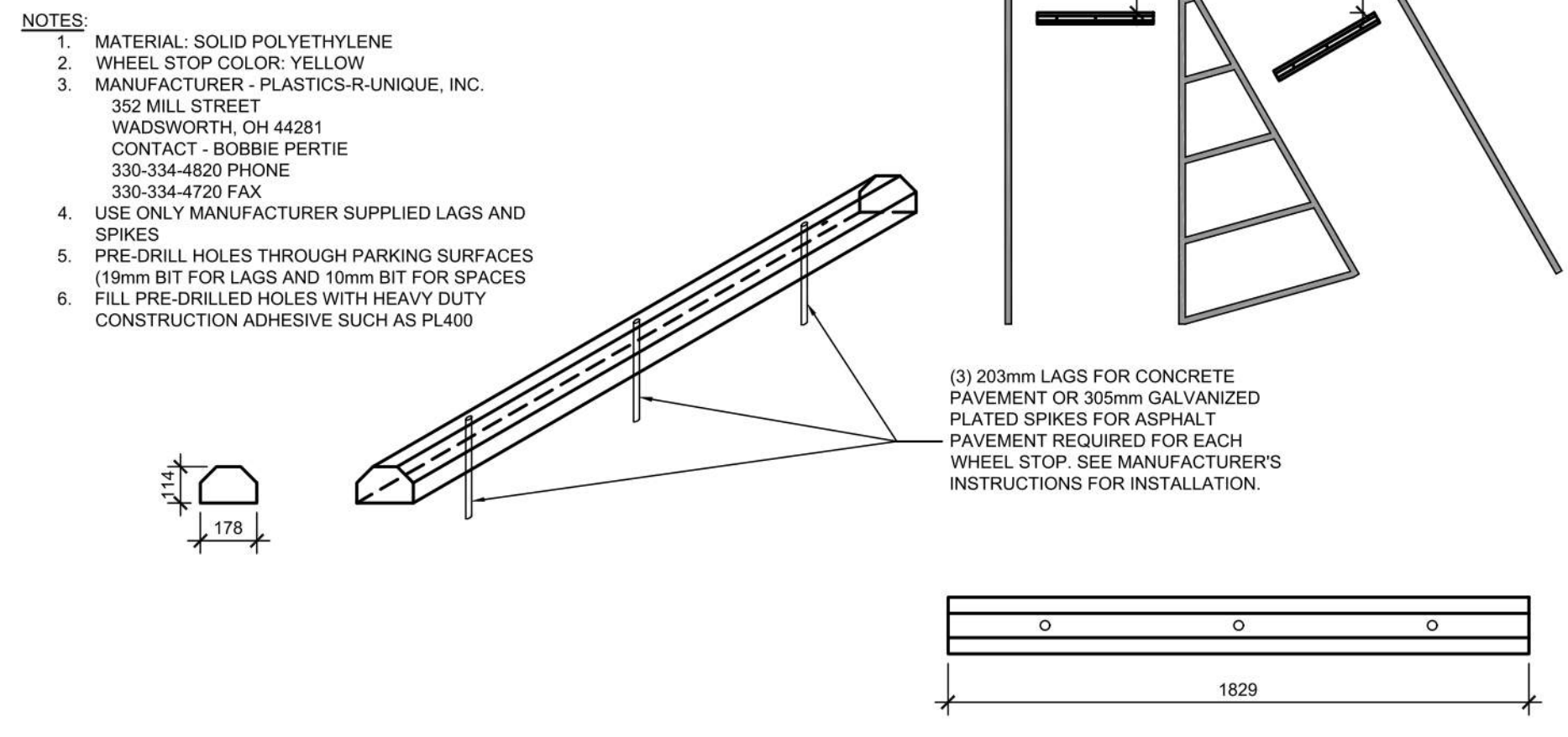

6 SOLID PLASTIC WHEEL STOP DETAIL
A103 N.T.S.

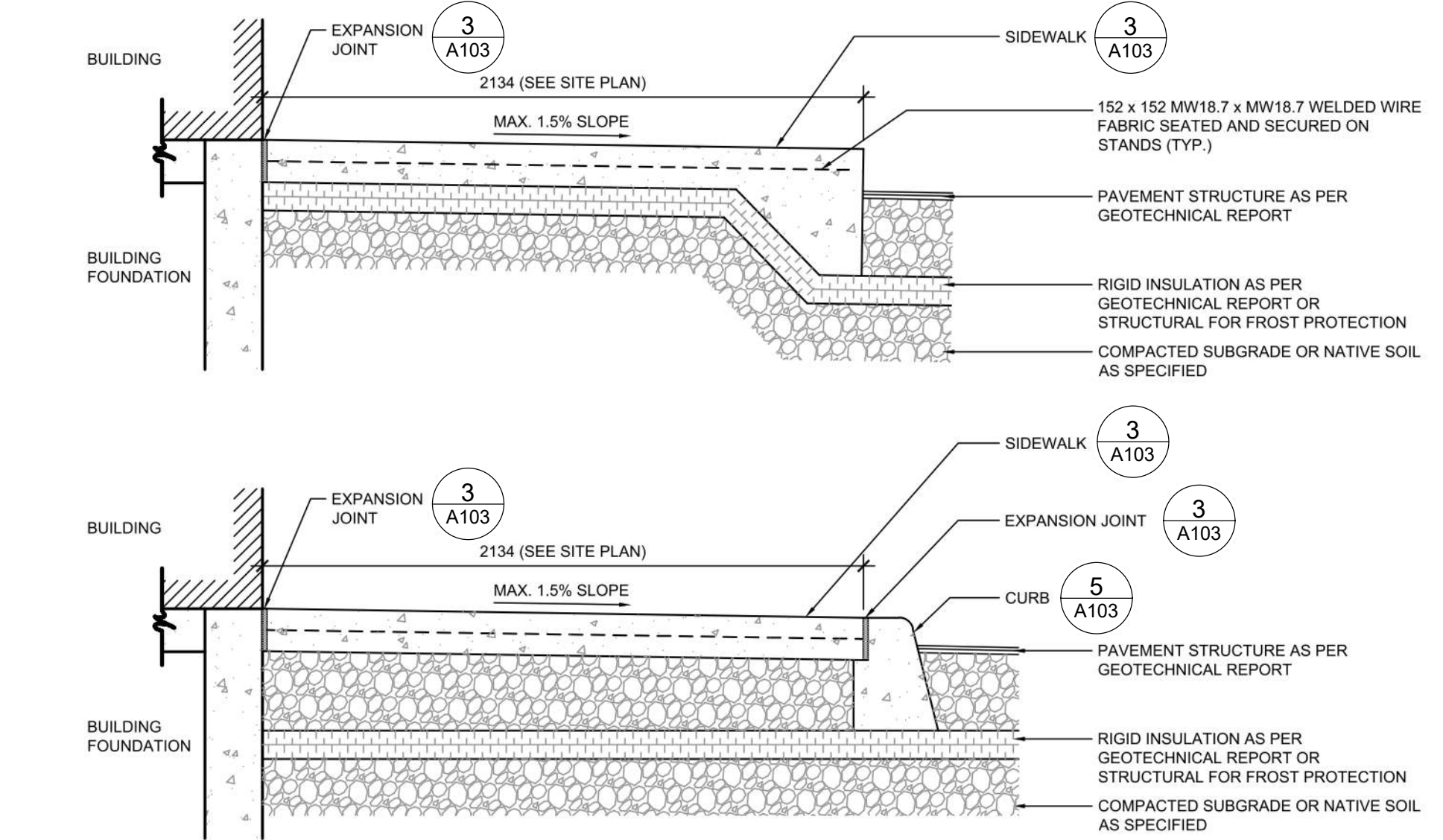

4 SIDEWALK AT BUILDING DETAILS
A103 N.T.S.

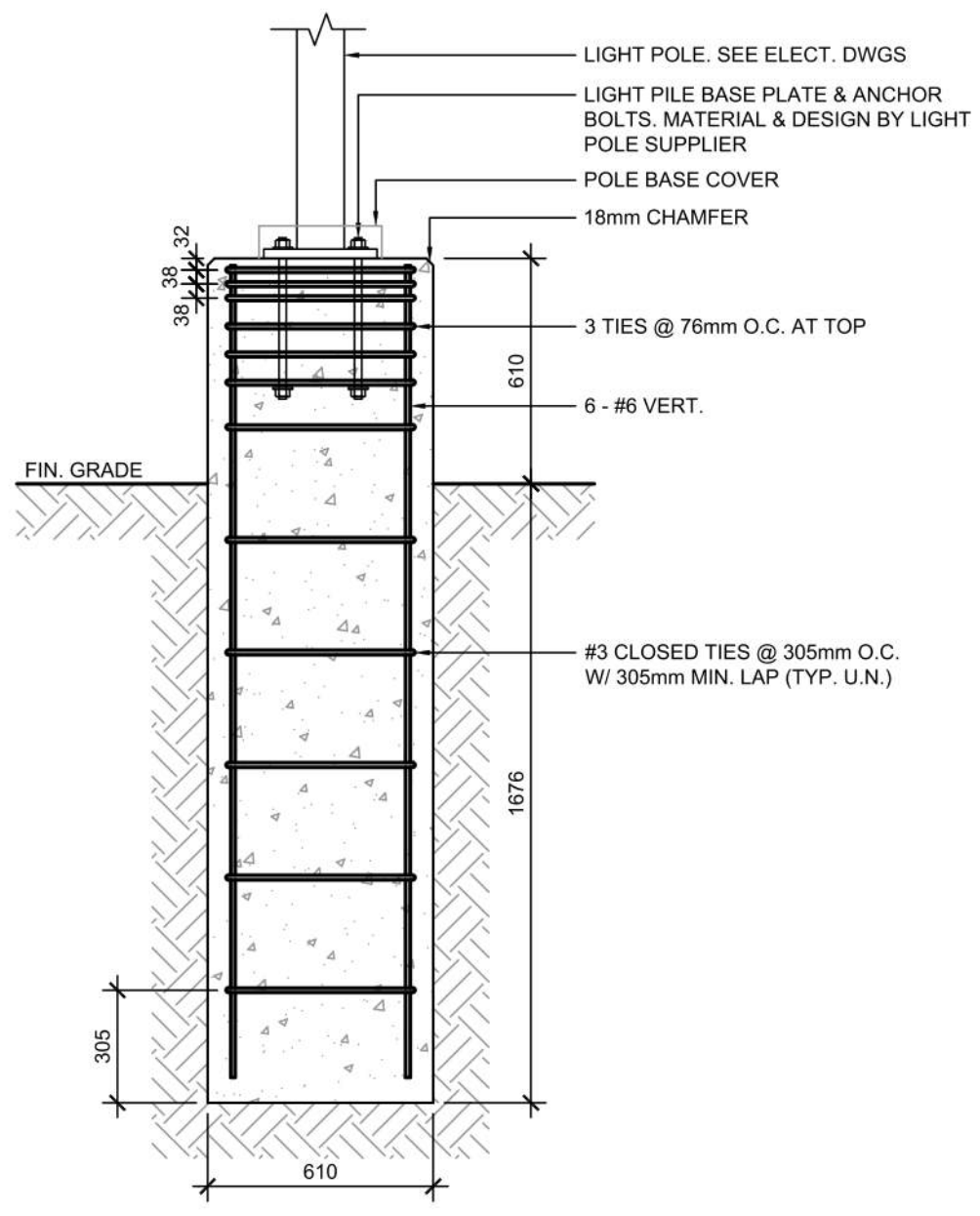

NOTES:
1. MAX. HEIGHT OF LIGHT POLE IS 7.62m ABOVE GRADE.
2. MAX HEIGHT OF CONCRETE BASE IS .81m ABOVE FINISHED GRADE.
3. MAX. EXPOSED AREA OF LIGHT FIXTURES IS 0.2 sq. m @ EACH FIXTURE.
4. MAX. 3 FIXTURES PER POLE.
5. TOTAL EXPOSED AREA OF POLE = 1 sq. m.

2 LIGHT STANDARD BASE
A103 N.T.S.

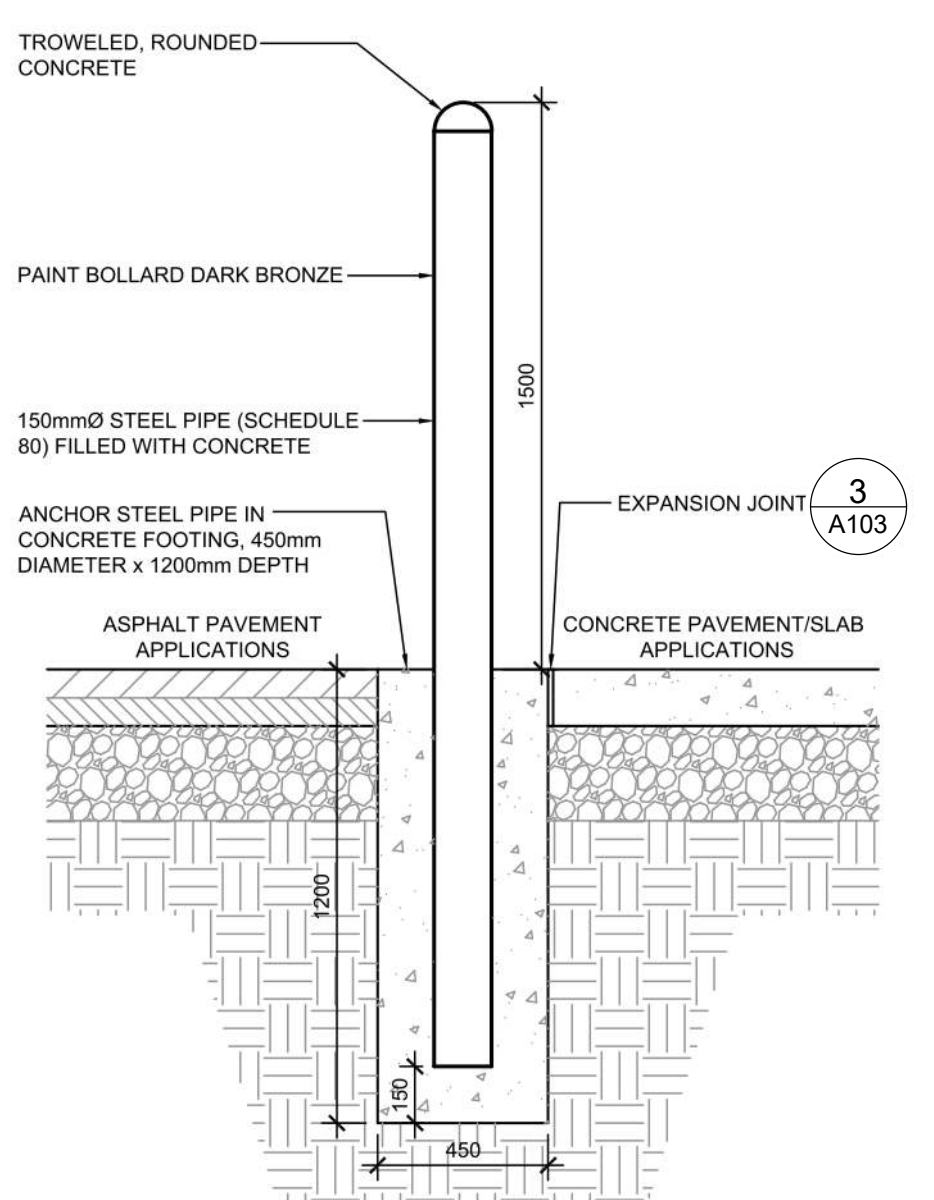

8 CONCRETE BOLLARD
A103 N.T.S.

Allison Hamlin
ALLISON HAMLIN
MANAGER (A), DEVELOPMENT REVIEW WEST
PLANNING, REAL ESTATE & ECONOMIC DEVELOPMENT
DEPARTMENT, CITY OF OTTAWA

APPROVED
By Allison Hamlin at 1:54 pm, Sep 19, 2023

| # | DATE | DESCRIPTION | BY |
|---|------------|----------------------------|-----|
| 6 | 2023-07-18 | ISSUE FOR SPA SUBMISSION 3 | MHB |
| 5 | 2023-07-13 | ISSUE FOR SPA SUBMISSION 2 | MHB |
| 4 | 2023-06-30 | ISSUE FOR SPA SUBMISSION 2 | MHB |
| 2 | 2023-03-14 | ISSUE FOR SPA SUBMISSION 2 | MHB |
| 1 | 2023-03-07 | ISSUE FOR REVIEW | MHB |

RIO CAN

PROJECT CHECK-FIL TANGER OUTLETS OTTAWA

3000 PALLADIUM DRIVE, STITTSVILLE, ON K2S 1B9

SITE DETAILS

| | |
|--------------------------|----------------------------|
| PROJECT NO. 12-258P01 | PROJECT DATE 2023-02-14 |
| DRAWN BY Author | CHECKED BY Checker |
| SCALE As indicated | |

DRAWING NO. **A103** REV. **6**

Allison Hamlin

ALLISON HAMLIN
MANAGER (A), DEVELOPMENT REVIEW WEST
PLANNING, REAL ESTATE & ECONOMIC DEVELOPMENT
DEPARTMENT, CITY OF OTTAWA

APPROVED

By Allison Hamlin at 1:54 pm, Sep 19, 2023

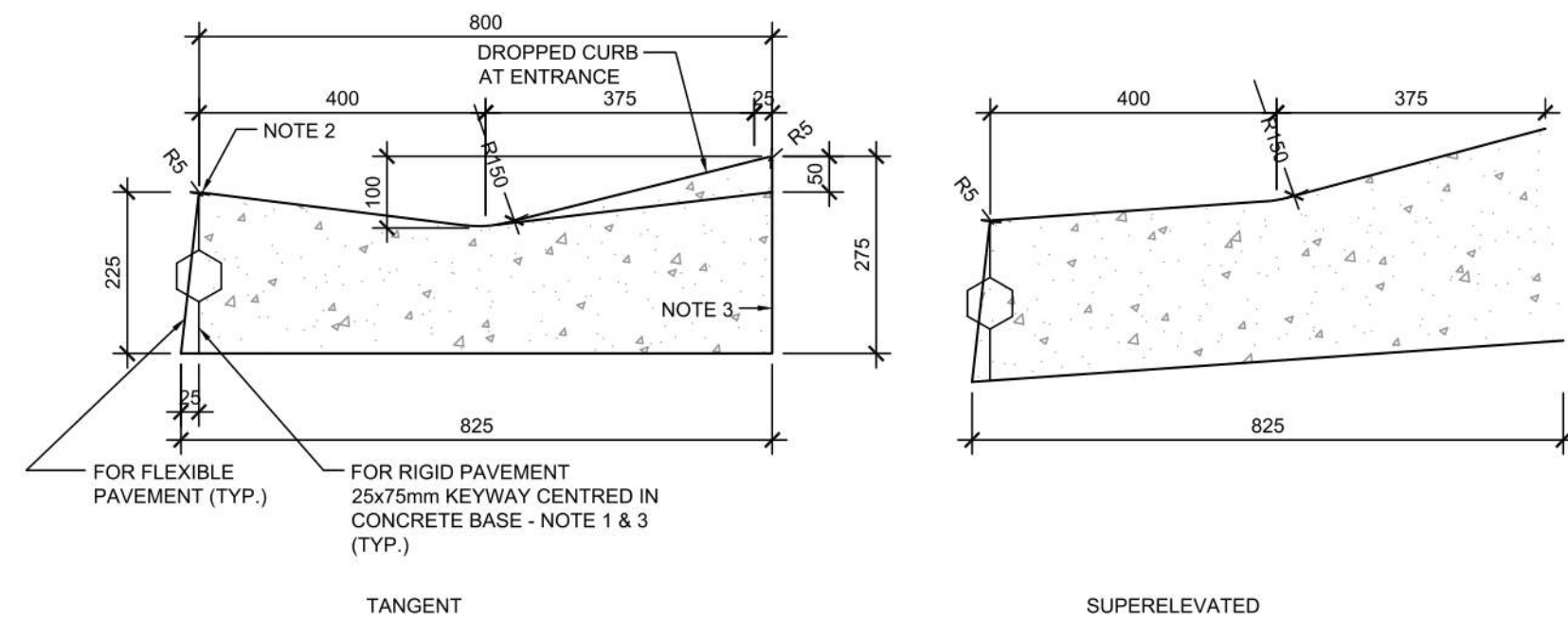

CONCRETE MOUNTABLE CURB WITH WIDE GUTTER (AS PER OPSD 600.030)

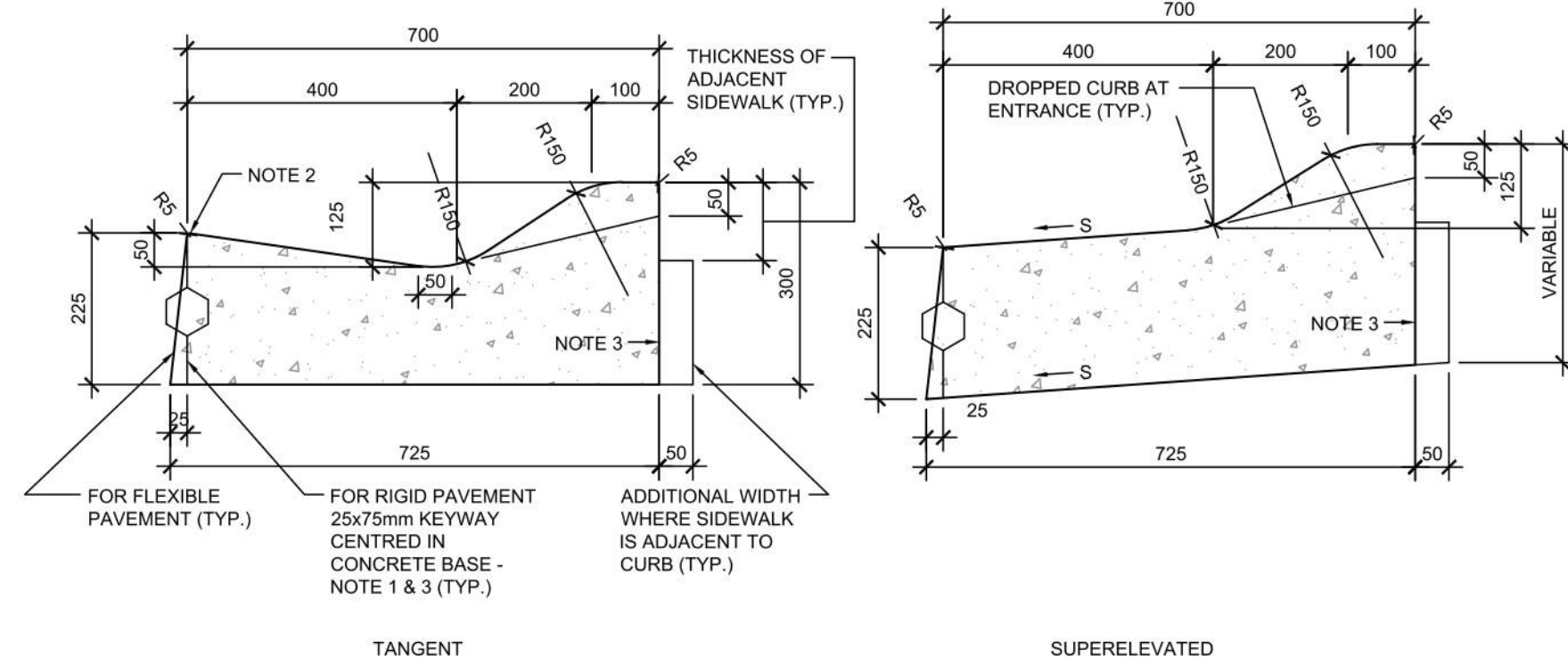

CONCRETE SEMI-MOUNTABLE CURB WITH WIDE GUTTER (AS PER OPSD 600.020)

- NOTES:
- WHEN CURB AND GUTTER IS ADJACENT TO CONCRETE PAVEMENT OR BASE, THIS DRAWING IS TO BE USED IN CONJUNCTION WITH OPSD-552.010 AND 552.020.
 - FLEXIBLE AND COMPOSITE PAVEMENT SHALL BE PLACED 5mm ABOVE THE ADJACENT EDGE OF GUTTER.
 - FOR SLIPFORMING PROCEDURE, A 5% BATTER IS ACCEPTABLE.
 - TREATMENT AT ENTRANCES SHALL CONFORM WITH OPSD-351.010.
 - OUTLET TREATMENT SHALL CONFORM WITH OPSD-610 SERIES.
 - THE TRANSITION FROM ONE CURB TYPE TO ANOTHER SHALL BE A MINIMUM LENGTH OF 3.0m, EXCEPT IN CONJUNCTION WITH GUIDE RAIL WHERE IT SHALL BE ACCORDING TO THE OPSD-900 SERIES.
 - ALL DIMENSIONS ARE IN MILLIMETRES UNLESS OTHERWISE SHOWN.

LEGEND:
S - RATE OF PAVEMENT SUPERELEVATION IN PERCENT, %.

6 CONCRETE MOUNTABLE CURB DETAILS 1
A104 N.T.S.

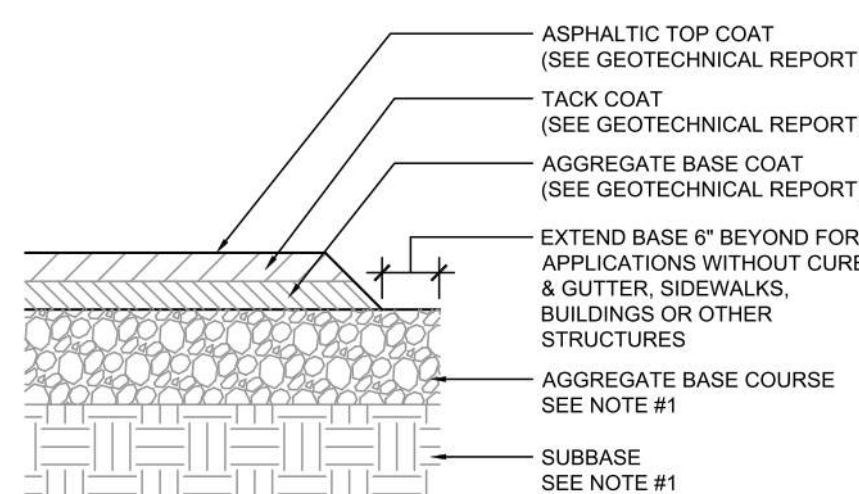

IF PRESENT ON-SITE, UNSUITABLE SUBGRADE MATERIAL SHALL BE REPLACED WITH SUITABLE MATERIAL AS SPECIFIED IN THE GEOTECHNICAL REPORT.

8 TYPICAL ASPHALT SECTION
A104 N.T.S.

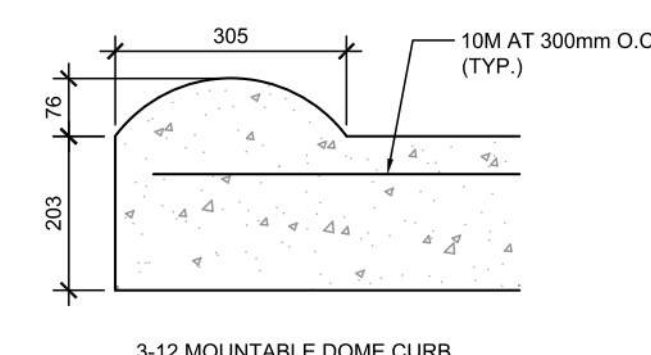

- NOTES:
- PRE-CUT EXPANSION JOINT MATERIAL SHALL BE USED IN ALL EXPANSION JOINTS.
 - DUMMY JOINTS SHALL BE INSTALLED AT 10 ft. INTERVALS, MAXIMUM.
 - INSTALL EXPANSION JOINTS EVERY 40 ft., MAXIMUM, AT ENDS OF RADIUS, AND A MINIMUM OF 5 ft. FROM INLET STRUCTURES.
 - BREAK AS NEEDED TO ENSURE POSITIVE DRAINAGE.
 - CONCRETE TO BE 3,000 P.S.I.
 - MOUNTABLE CURB TO BE PAINTED YELLOW WITH 6" BLACK STRIPE PAINTED EVERY 24" O.C..

- NOTES:
- GENERAL CONTRACTOR SHALL REFERENCE GEOTECHNICAL REPORT FOR PAVEMENT SECTION REQUIREMENTS.
 - EXPANSION JOINT FILLER SHALL BE FLEXIBLE, LIGHTWEIGHT, NON-STAINING, POLYETHYLENE, CLOSED-CELL EXPANSION JOINT.

5 CONCRETE MOUNTABLE CURB DETAILS
A104 N.T.S.

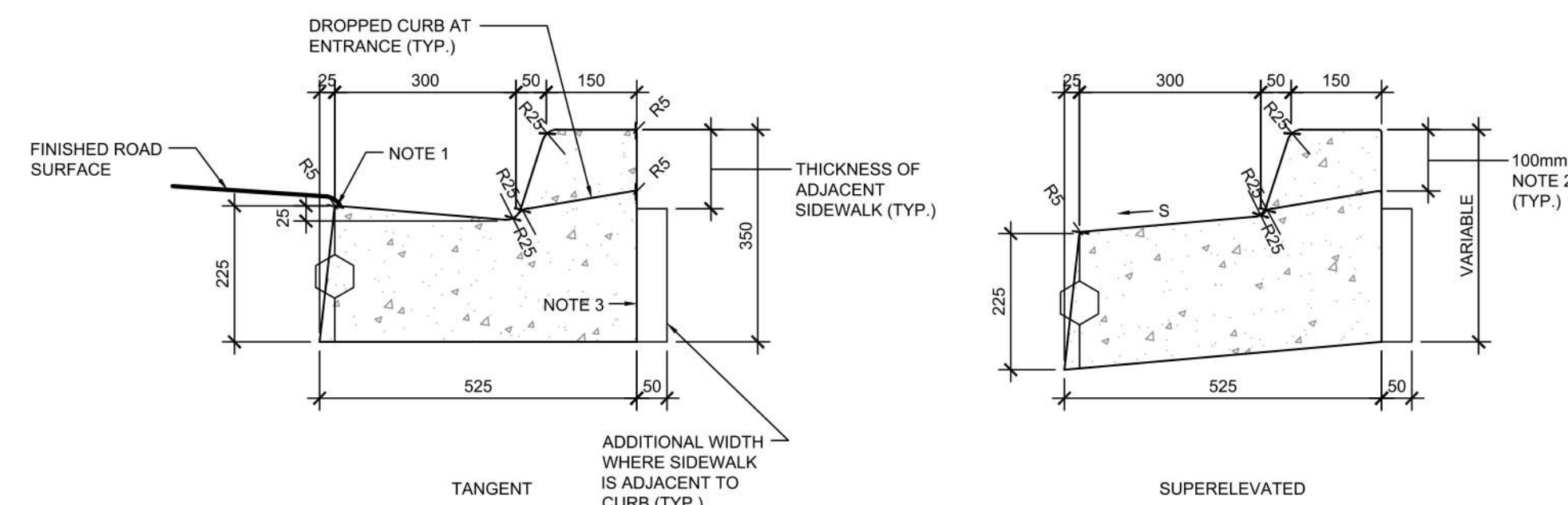

CONCRETE BARRIER CURB WITH STANDARD GUTTER (AS PER OPSD 600.040)

- NOTES:
- FLEXIBLE AND COMPOSITE PAVEMENT SHALL BE PLACED 5mm ABOVE THE ADJACENT EDGE OF GUTTER.
 - WHERE SIDEWALK IS CONTINUOUSLY ADJACENT, REDUCE THE DROPPED CURB AT ENTRANCES TO 75mm.
 - FOR SLIPFORMING PROCEDURE, A 5% BATTER IS ACCEPTABLE.
 - FOR COMPOSITE PAVEMENT THE DEPTH OF CONCRETE CURB SHALL BE ADJUSTED TO DEPTH OF CONCRETE PAVEMENT.
 - WHEN TIE BARS ARE SPECIFIED, REFER TO OPSD 552.010 AND 552.020 FOR DETAILS.
 - TREATMENT AT ENTRANCES SHALL CONFORM WITH OPSD-351.010.
 - OUTLET TREATMENT SHALL CONFORM WITH OPSD-610 SERIES.
 - THE TRANSITION FROM ONE CURB TYPE TO ANOTHER SHALL BE A MINIMUM LENGTH OF 3.0m, EXCEPT IN CONJUNCTION WITH GUIDE RAIL WHERE IT SHALL BE ACCORDING TO THE OPSD-900 SERIES.
 - ALL DIMENSIONS ARE IN MILLIMETRES UNLESS OTHERWISE SHOWN.

LEGEND:
S - RATE OF PAVEMENT SUPERELEVATION IN PERCENT, %.

1 CONCRETE CURB WITH GUTTER DETAILS
A104 N.T.S.

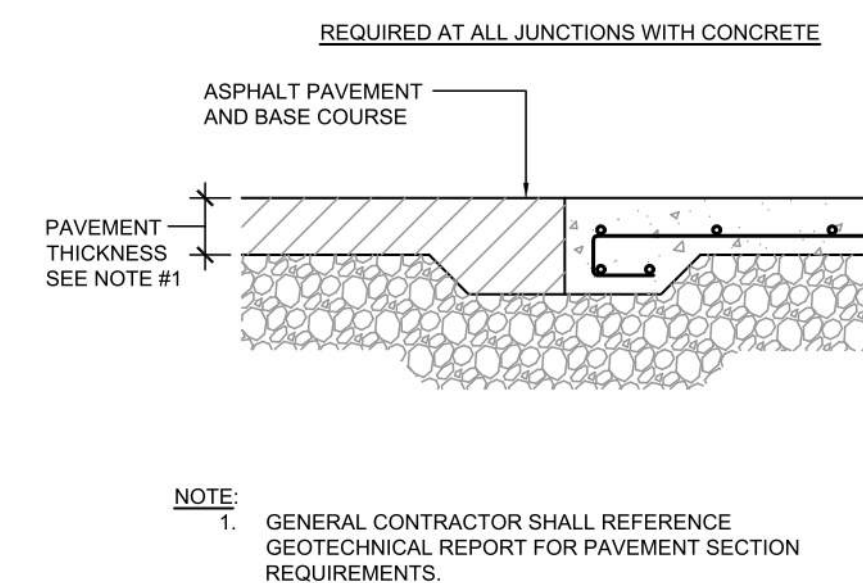
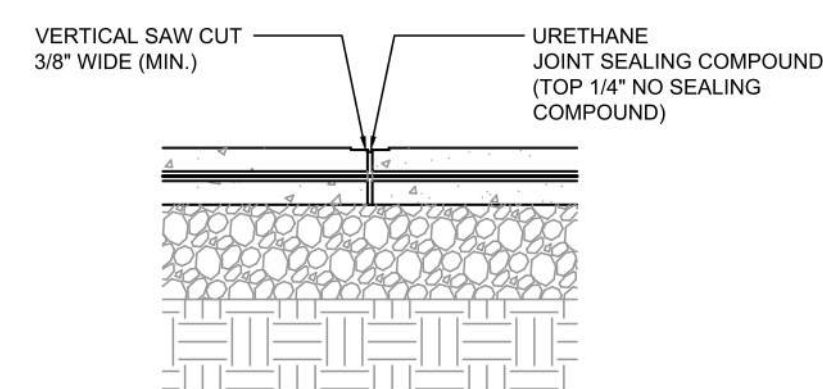

- NOTE:
- GENERAL CONTRACTOR SHALL REFERENCE GEOTECHNICAL REPORT FOR PAVEMENT SECTION REQUIREMENTS.

9 CONCRETE PAVING DRIVE-THRU LANE 1
A104 N.T.S.

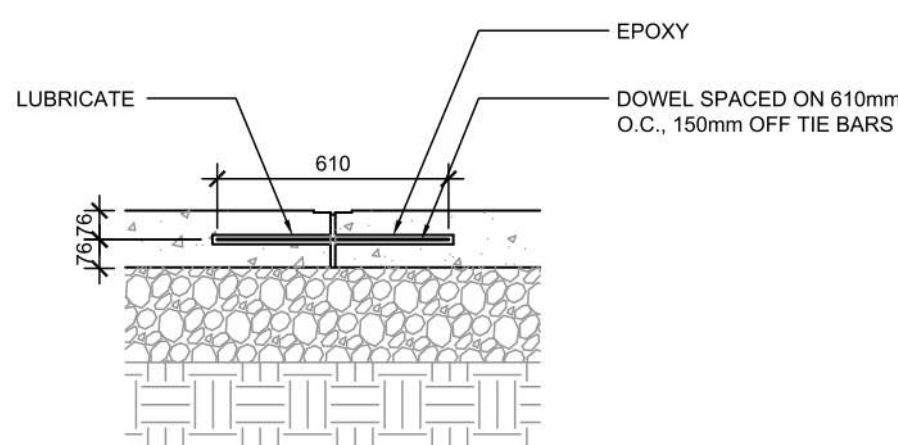

- NOTES:
- NO. 5 SMOOTH DOWEL BAR MAY BE USED IN 125mm AND 150mm PAVEMENT THICKNESS.
 - LONGITUDINAL BUTT CONSTRUCTION MAY BE UTILIZED IN PLACE OF LONGITUDINAL HINGED (KEYWAY) JOINT AT CONTRACTORS OPTION.
 - DOWEL BARS SHALL BE DRILLED & EPOXIED INTO PAVEMENT HORIZONTALLY BY USE OF MECHANICAL EQUIP.
 - PUSHING DOWEL BARS INTO WET CONCRETE NOT ACCEPTABLE.

12 LONGITUDINAL BUTT JOINT
A104 N.T.S.

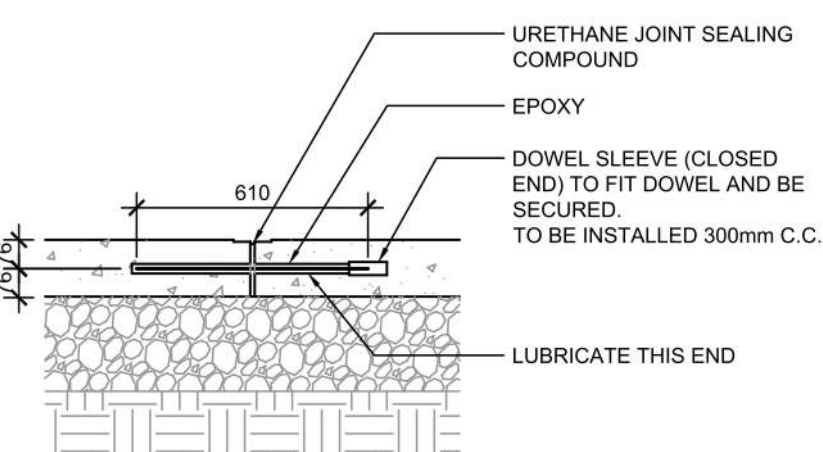

- NOTES:
- NO. 5 SMOOTH DOWEL BAR MAY BE USED IN 125mm AND 150mm PAVEMENT THICKNESS.
 - LONGITUDINAL BUTT CONSTRUCTION MAY BE UTILIZED IN PLACE OF LONGITUDINAL HINGED (KEYWAY) JOINT AT CONTRACTORS OPTION.
 - DOWEL BARS SHALL BE DRILLED INTO PAVEMENT HORIZONTALLY BY USE OF A MECHANICAL EQUIPMENT.
 - DRILLING BY HAND IS NOT ACCEPTABLE. PUSHING DOWEL BARS INTO WET CONCRETE NOT ACCEPTABLE.
 - JOINT SPACING TO BE 24'X24' (EVERY OTHER JOINT).

2 EXPANSION JOINT
A104 N.T.S.

10 PAVEMENT EDGE DETAIL
A104 N.T.S.

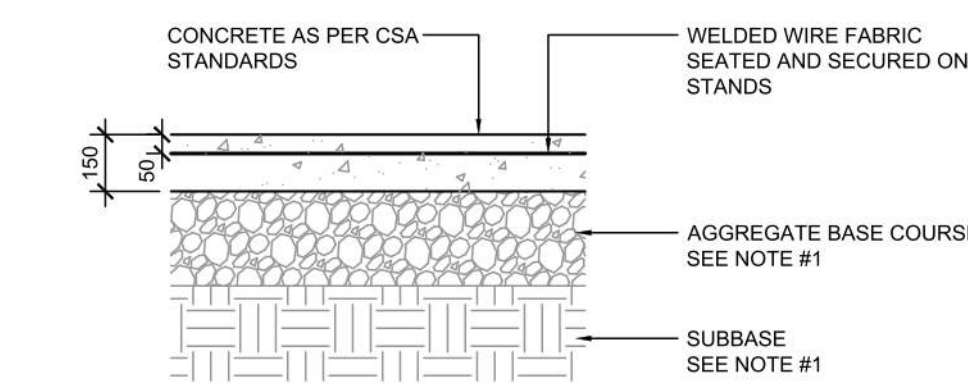

- NOTE:
- GENERAL CONTRACTOR SHALL REFERENCE GEOTECHNICAL REPORT FOR PAVEMENT SECTION REQUIREMENTS.
 - MINIMUM PAVEMENT THICKNESS SHALL BE 6" CONCRETE, 4" AGGREGATE BASE.

13 CONCRETE PAVING DRIVE-THRU LANE 2
A104 N.T.S.

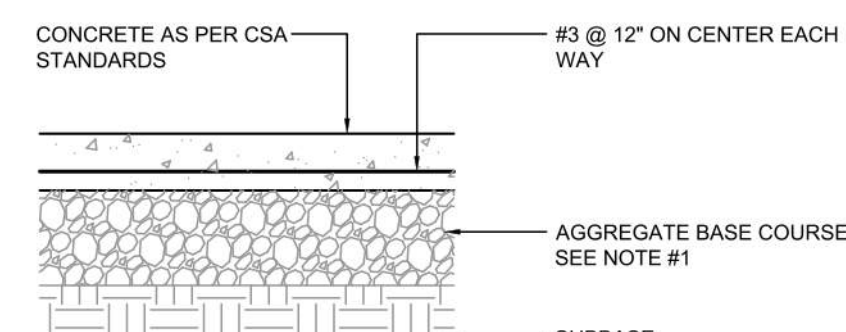

- NOTE:
- GENERAL CONTRACTOR SHALL REFERENCE GEOTECHNICAL REPORT FOR PAVEMENT SECTION REQUIREMENTS.
 - MINIMUM PAVEMENT THICKNESS SHALL BE 6" CONCRETE, 4" AGGREGATE BASE.

3 CONCRETE PAVING PARKING LOT
A104 N.T.S.

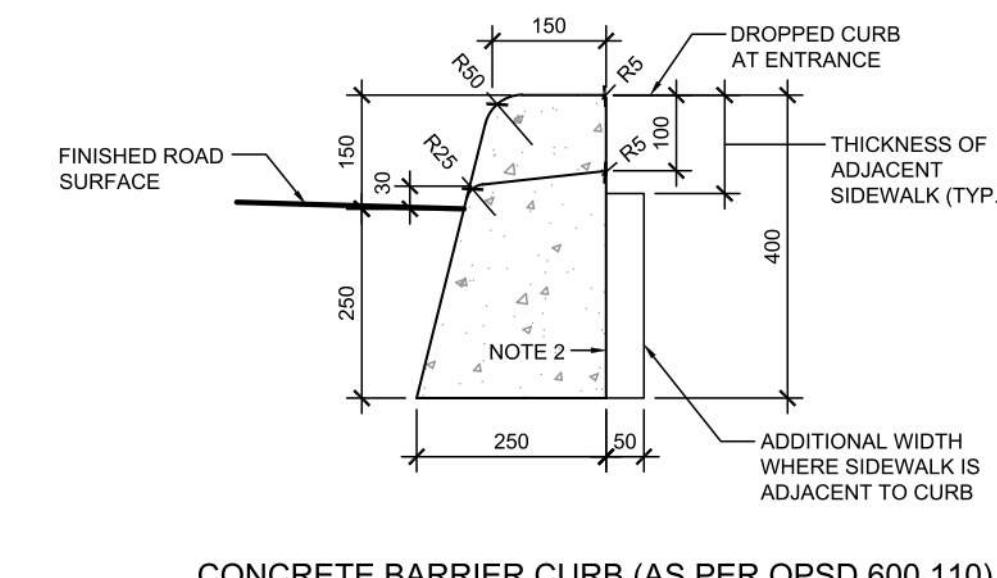

CONCRETE BARRIER CURB (AS PER OPSD 600.110)

- NOTES:
- WHERE SIDEWALK IS CONTINUOUSLY ADJACENT, REDUCE THE DROPPED CURB AT ENTRANCES TO 75mm.
 - FOR SLIPFORMING PROCEDURE, A 5% BATTER IS ACCEPTABLE.
 - TREATMENT AT ENTRANCES SHALL CONFORM WITH OPSD-351.010.
 - OUTLET TREATMENT SHALL CONFORM WITH OPSD-610 SERIES.
 - THE LENGTH OF TRANSITION FROM ONE CURB TYPE TO ANOTHER SHALL BE 3.0m, EXCEPT IN CONJUNCTION WITH GUIDE RAIL, IT SHALL CONFORM TO OPSD-900 SERIES.
 - ALL DIMENSIONS ARE IN MILLIMETRES UNLESS OTHERWISE SHOWN.

7 CONCRETE CURB DETAILS
A104 1: N.T.S.

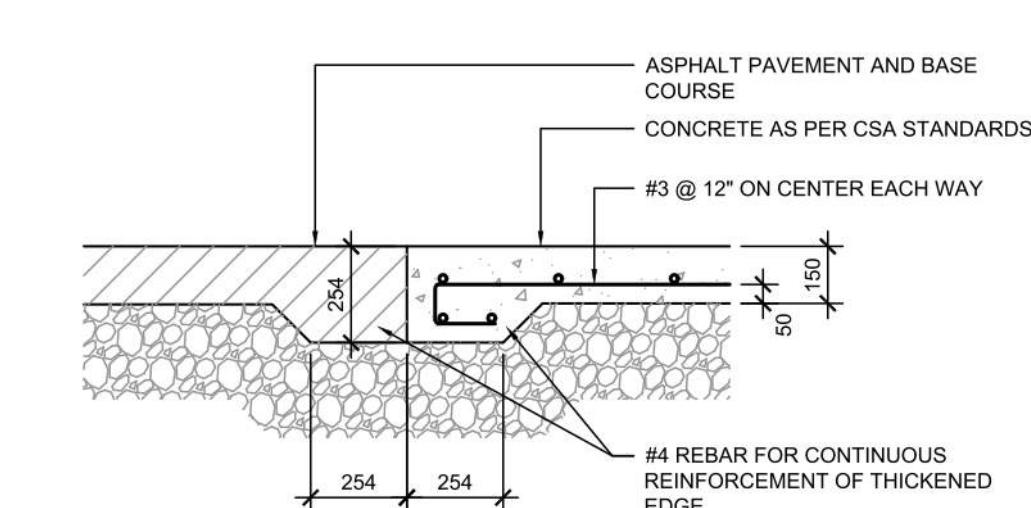

11 CONCRETE APRON AT GARBAGE ENCLOSURE
A104 N.T.S.

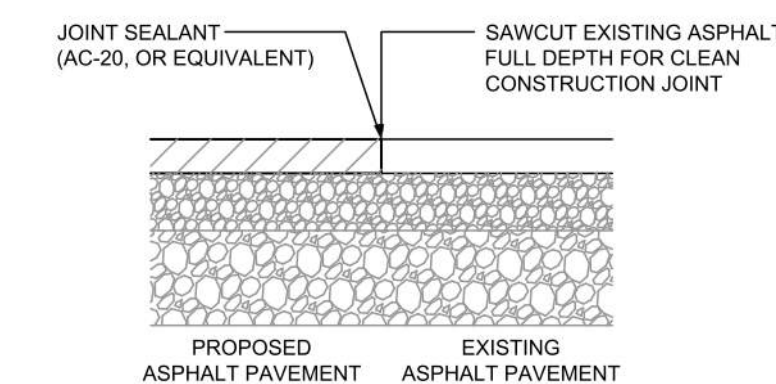

14 BUTT JOINT
A104 N.T.S.

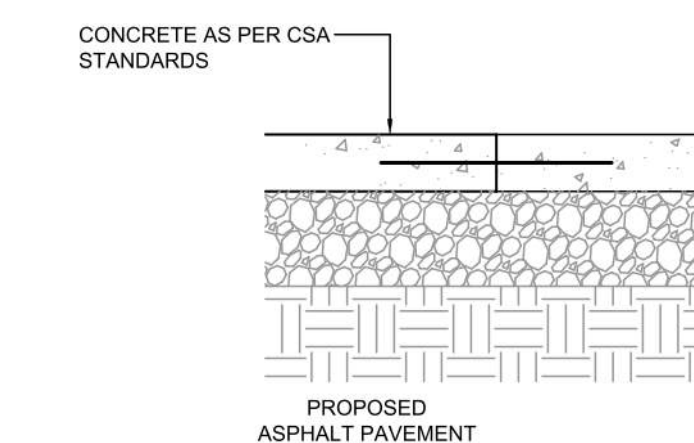

15 TRANSVERSE & LONGITUDINAL DOWELLED CONSTRUCTION JOINT
A104 N.T.S.

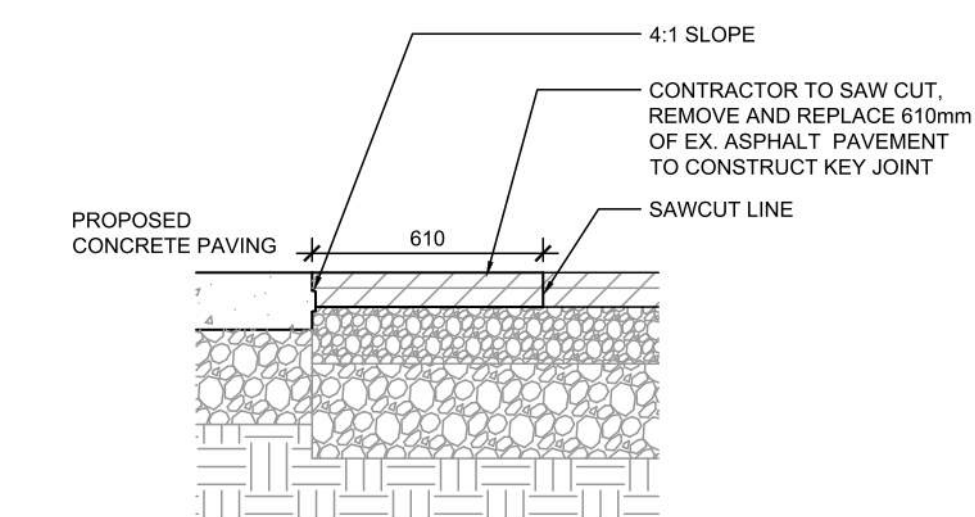

4 KEYED CONSTRUCTION JOINT
A104 N.T.S.

| # | DATE | DESCRIPTION | BY |
|---|------------|----------------------------|-----|
| 7 | 2023-08-03 | ISSUE FOR SPA SUBMISSION 3 | MHB |
| 6 | 2023-07-18 | ISSUE FOR SPA SUBMISSION 3 | MHB |
| 5 | 2023-07-13 | ISSUE FOR SPA SUBMISSION 2 | MHB |
| 4 | 2023-06-30 | ISSUE FOR SPA SUBMISSION 2 | MHB |
| 2 | 2023-08-14 | ISSUE FOR SPA SUBMISSION 2 | MHB |
| 1 | 2023-03-07 | ISSUE FOR REVIEW | MHB |

RIOCAN

PROJECT
CHECK-FIL TANGER OUTLETS OTTAWA

3000 PALLADIUM DRIVE, STITTSVILLE, ON K2S 1B9

DRAWING
SITE DETAILS

| | |
|--------------------------|----------------------------|
| PROJECT NO. 12-258P01 | PROJECT DATE 2023-02-14 |
| DRAWN BY Author | CHECKED BY Checker |
| SCALE N.T.S. | |

DRAWING NO. **A104** REV. **7**

Allison Hamlin

ALLISON HAMLIN
MANAGER (A), DEVELOPMENT REVIEW WEST
PLANNING, REAL ESTATE & ECONOMIC DEVELOPMENT
DEPARTMENT, CITY OF OTTAWA

APPROVED
By Allison Hamlin at 1:54 pm, Sep 19, 2023

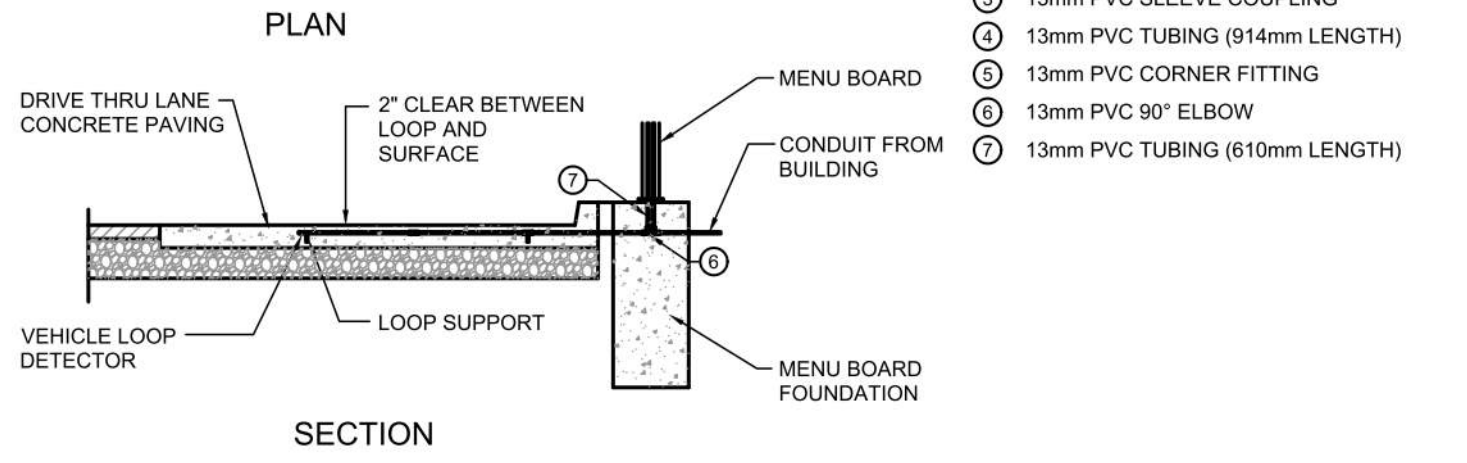
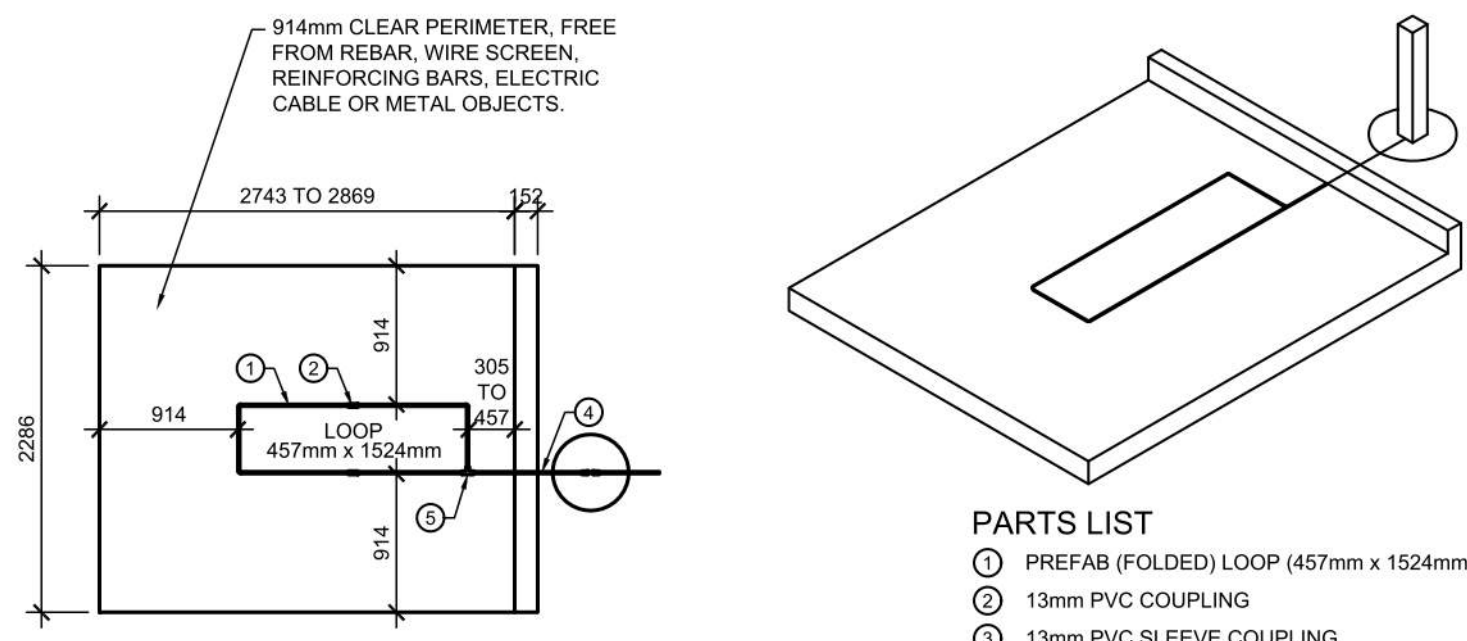

- PARTS LIST**
- ① PREFAB (FOLDED) LOOP (457mm x 1524mm)
 - ② 13mm PVC COUPLING
 - ③ 13mm PVC SLEEVE COUPLING
 - ④ 13mm PVC TUBING (914mm LENGTH)
 - ⑤ 13mm PVC CORNER FITTING
 - ⑥ 13mm PVC 90° ELBOW
 - ⑦ 13mm PVC TUBING (610mm LENGTH)

- NOTES:**
1. LOOP DETECTOR IS MODEL NO. VDL100 VEHICLE DETECTION LOOP MANUFACTURED BY MH ELECTRONICS, INC.
 2. FOLLOWING MANUFACTURER'S RECOMMENDATIONS FOR INSTALLATION.

1 MENU BOARD LOOP SYSTEM
A105 N.T.S.

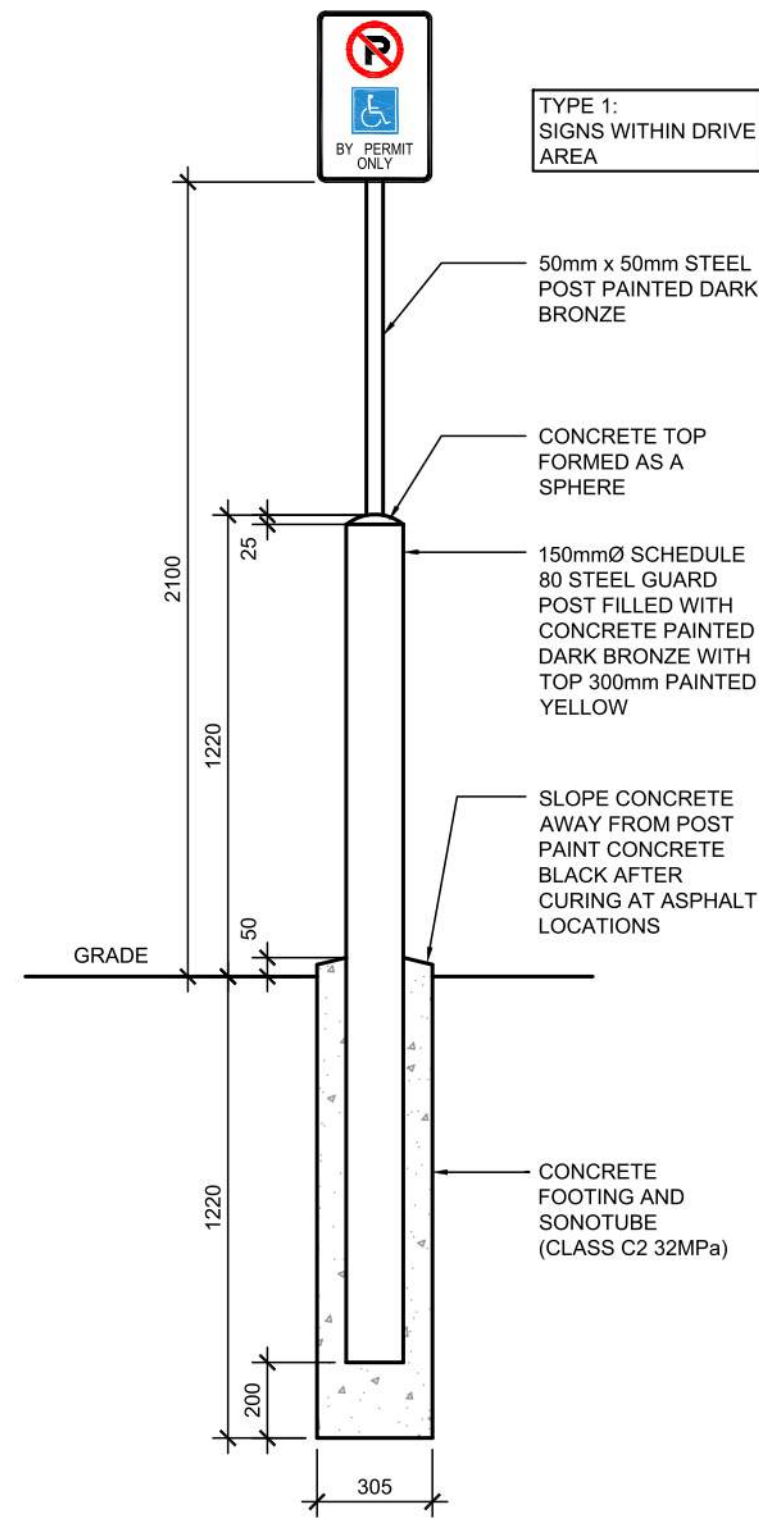

NOTE:
SIGNS PROVIDED AND INSTALLED BY CFA SIGNAGE CONTRACTOR

3 POLE MOUNTED DIRECTIONAL SIGNAGE 1
A105 N.T.S.

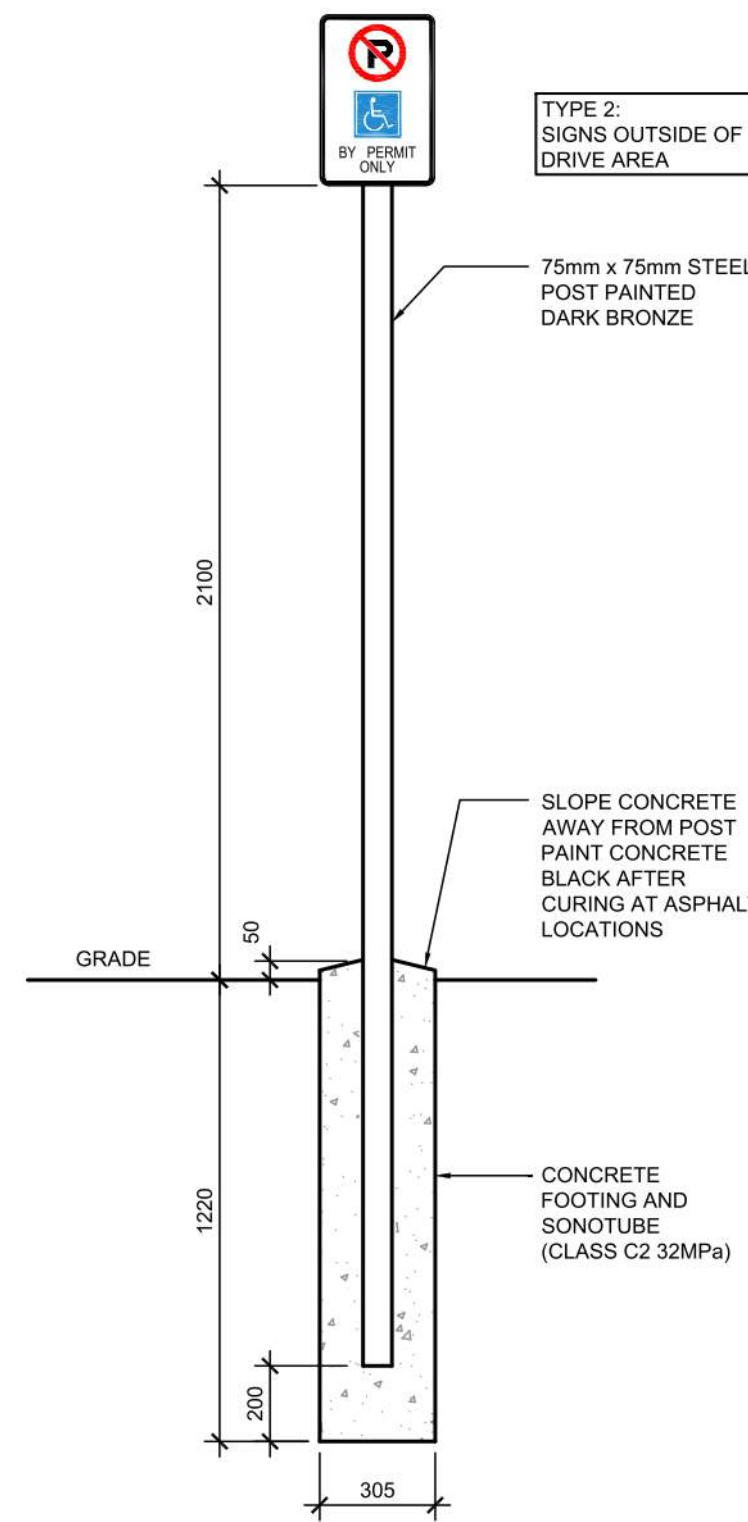

NOTE:
SIGNS PROVIDED AND INSTALLED BY CFA SIGNAGE CONTRACTOR

7 POLE MOUNTED DIRECTIONAL SIGNAGE 2
A105 N.T.S.

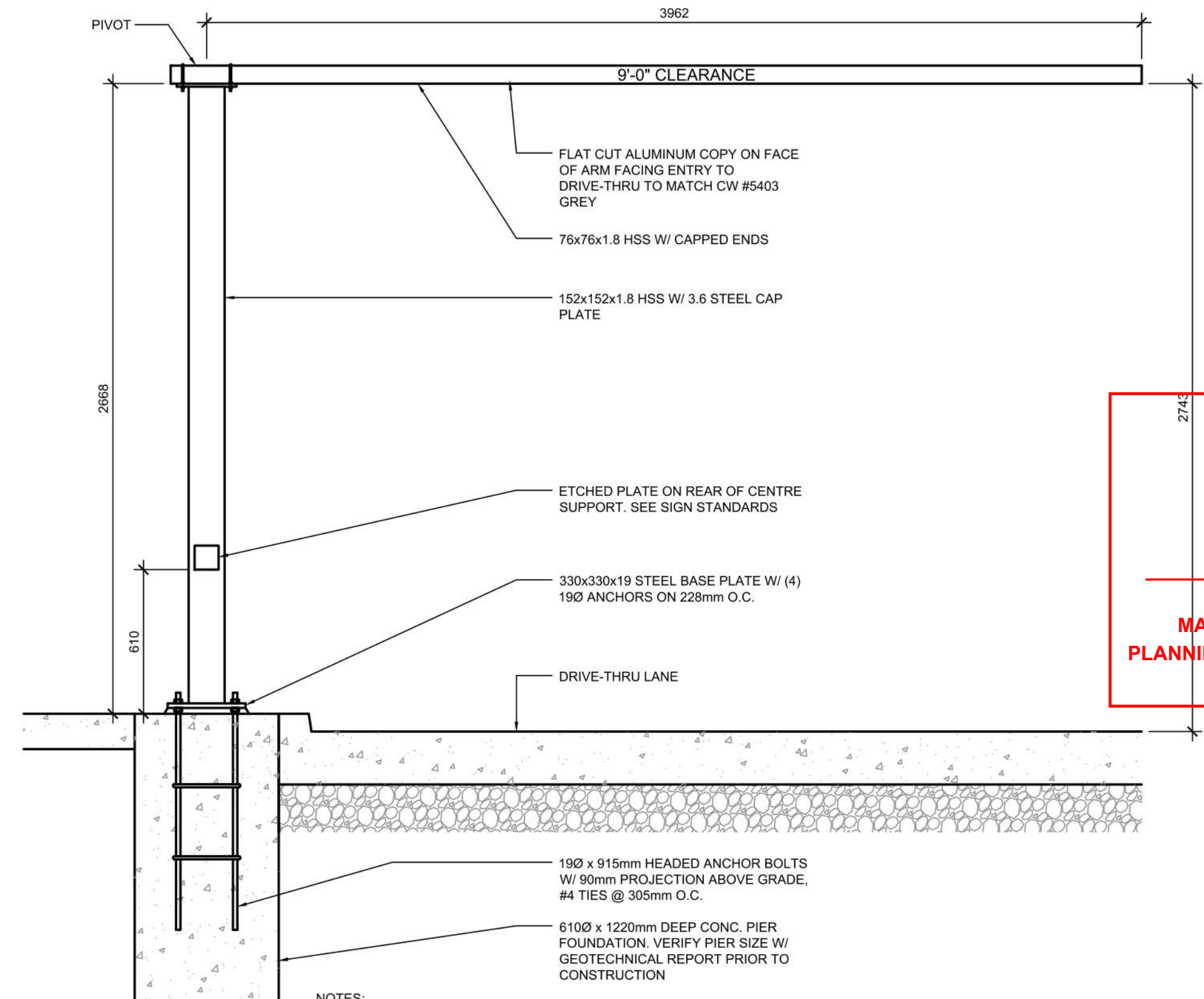

- NOTES:**
1. ENTIRE CLEARANCE BAR & HARDWARE TO BE POWDER COATED QPC P-820 MATTE BLACK FINISH.
 2. CLEARANCE BAR ARM TO ROTATE WHEN STRUCK & RETURN TO ORIGINAL POSITION. COORDINATE W/ ARCHITECT & STRUCTURAL ENGINEER.
 - 3.

5 DRIVE-THRU CLEARANCE BAR
A105 N.T.S.

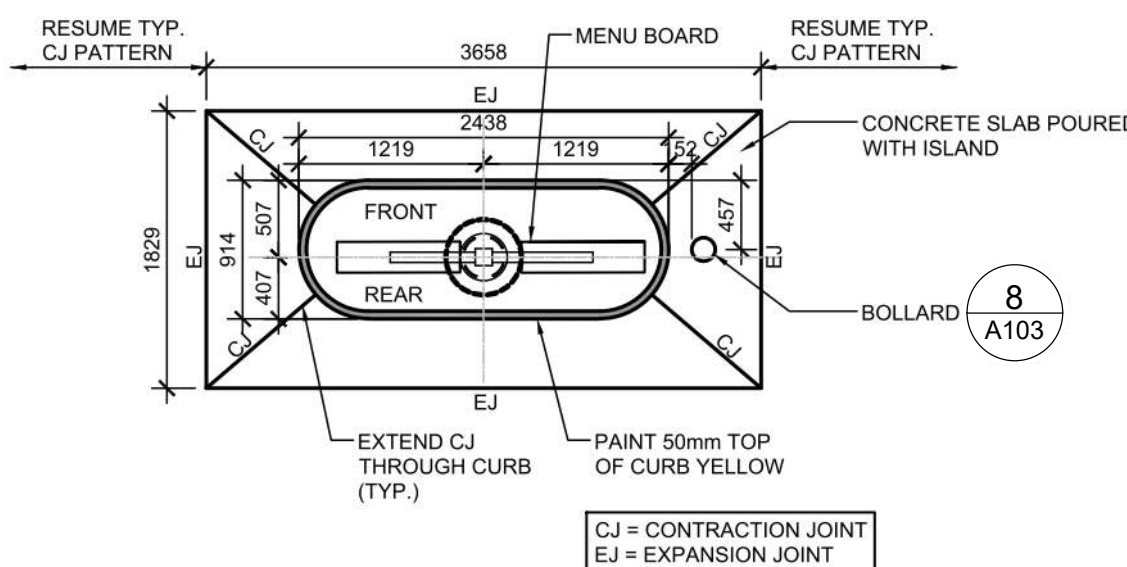

ISLAND CURB PLAN

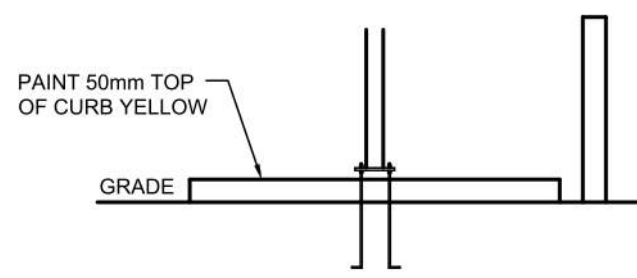

ISLAND CURB SECTION

2 DRIVE-THRU ORDER POINT ISLAND CURB
A105 N.T.S.

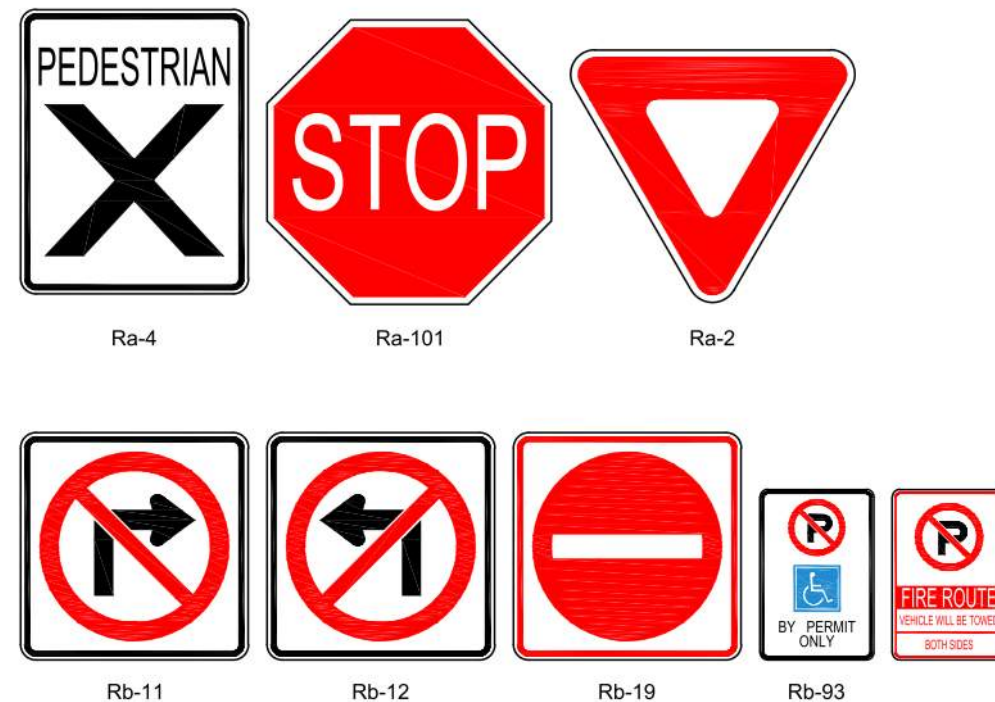

NOTE:
ALL DIRECTIONAL SIGNAGE TO COMPLY WITH THE ONTARIO TRAFFIC MANUAL AND LOCAL STANDARDS.

6 DIRECTIONAL SIGNAGE
A105 N.T.S.

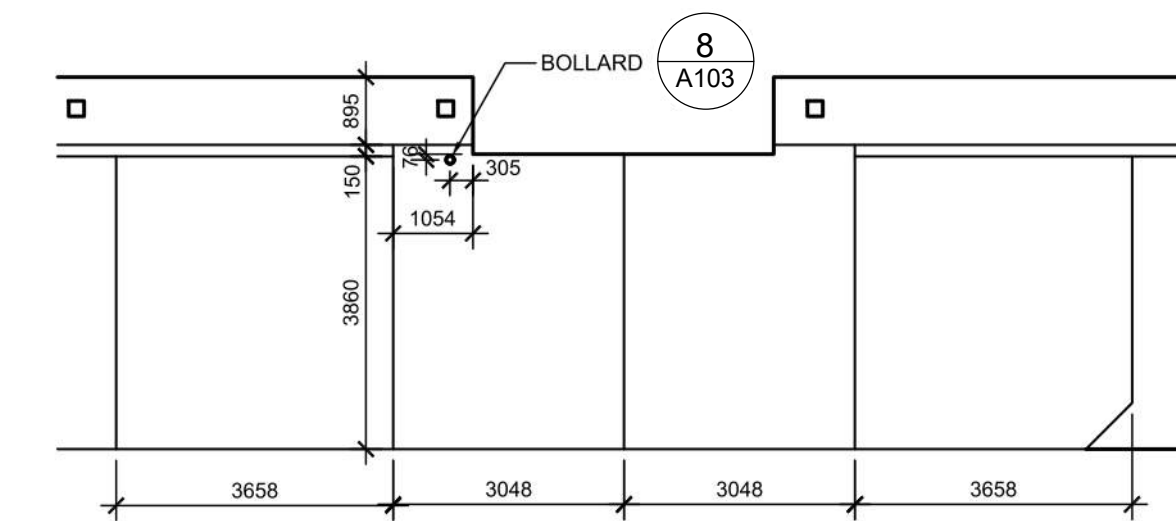

8 DRIVE-THRU DETAILS
A105 N.T.S.

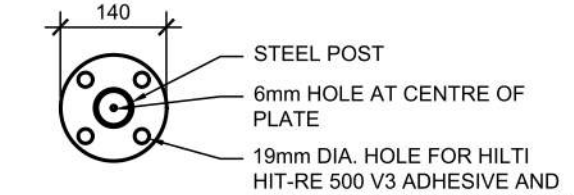
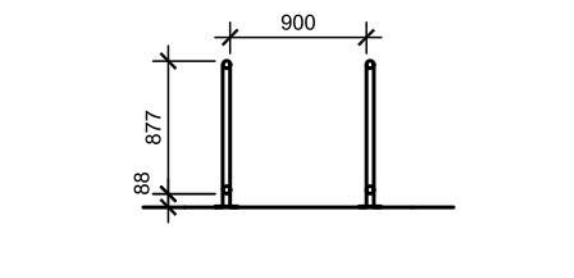
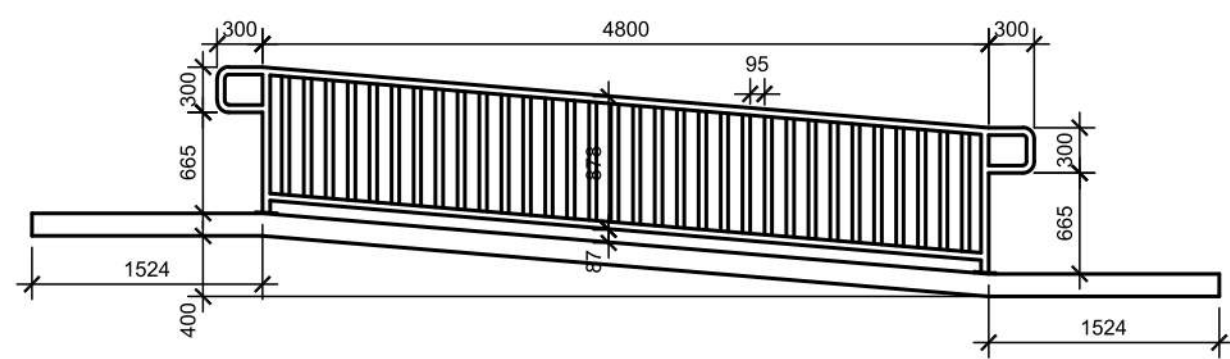

RAMP SECTION 405
ANY PART OF AN ACCESSIBLE ROUTE WITH A SLOPE GREATER THAN 1:20 SHALL BE CONSIDERED A RAMP AND SHALL COMPLY WITH 405
THE LEAST POSSIBLE SLOPE SHALL BE USED FOR ANY RAMP.
***THE MINIMUM CLEAR WIDTH OF A RAMP SHALL BE 36\"/>

LANDINGS SECTION 405.7
*LEVEL LANDINGS WILL BE PROVIDED AT TOP AND BOTTOM OF EACH RAMP. LANDING LENGTH SHALL BE MIN. 60\"/>

HANDRAILS SECTION 505
*IF A RAMP HAS A SLOPE GREATER THAN 5% AND A RISE GREATER THAN 6\"/>

CROSS SLOPE SECTION 405.3
*THE CROSS SLOPE OF RAMP SURFACES SHALL BE NO GREATER THAN 1:50.
*NOWHERE SHALL THE CROSS SLOPE OF AN ACCESSIBLE ROUTE EXCEED 1:50.

7 BARRIER FREE RAMP & HANDRAIL DETAIL
C9.3 SCALE 1:50

4 BARRIER FREE RAMP & HANDRAIL DETAIL
A105 N.T.S.

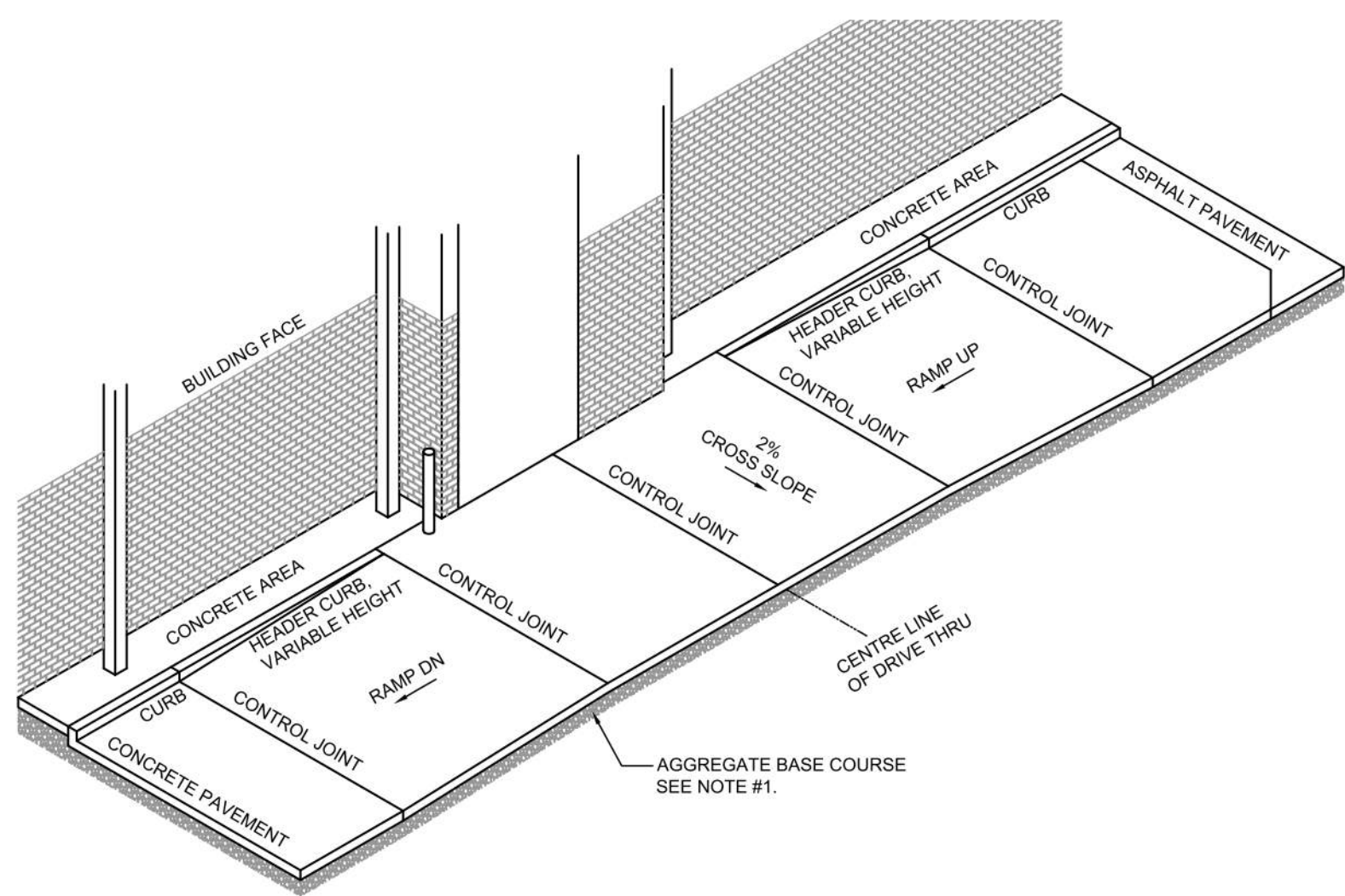

| # | DATE | DESCRIPTION | BY |
|---|------------|----------------------------|-----|
| 7 | 2023-08-03 | ISSUE FOR SPA SUBMISSION 3 | MHB |
| 6 | 2023-07-18 | ISSUE FOR SPA SUBMISSION 3 | MHB |
| 5 | 2023-07-13 | ISSUE FOR SPA SUBMISSION 2 | MHB |
| 4 | 2023-06-30 | ISSUE FOR SPA SUBMISSION 2 | MHB |
| 2 | 2023-03-14 | ISSUE FOR SPA SUBMISSION 2 | MHB |
| 1 | 2023-03-07 | ISSUE FOR REVIEW | MHB |



PROJECT
CHECK-FIL TANGER OUTLETS OTTAWA

3000 PALLADIUM DRIVE, STITTSVILLE, ON K2S 1B9

SITE DETAILS

| | |
|--------------------------|----------------------------|
| PROJECT NO. 12-258P01 | PROJECT DATE 2023-02-14 |
| DRAWN BY Author | CHECKED BY Checker |
| SCALE N.T.S. | REV |

A105 7

Allison Hamlin
ALLISON HAMLIN
MANAGER (A), DEVELOPMENT REVIEW WEST
PLANNING, REAL ESTATE & ECONOMIC DEVELOPMENT
DEPARTMENT, CITY OF OTTAWA

APPROVED
By Allison Hamlin at 1:54 pm, Sep 19, 2023

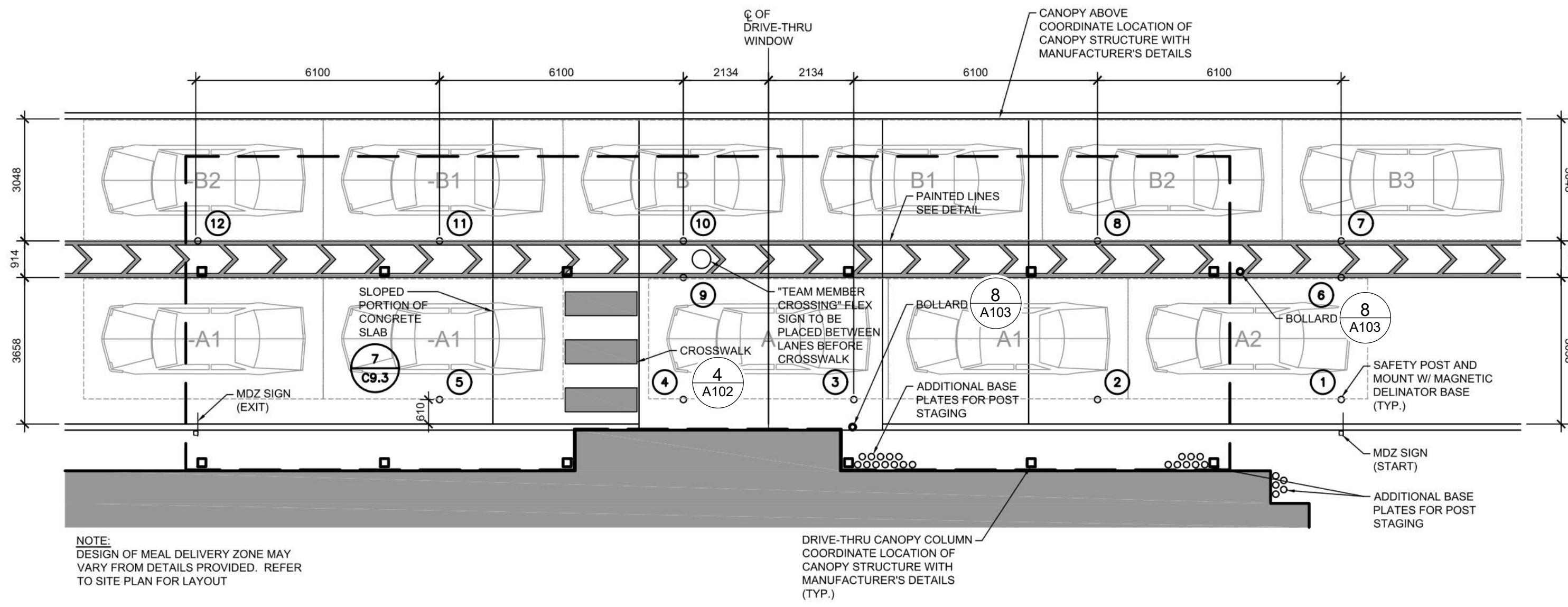

4 MEAL DELIVERY ZONE - DUAL LANE CANOPY LAYOUT
A106 N.T.S.

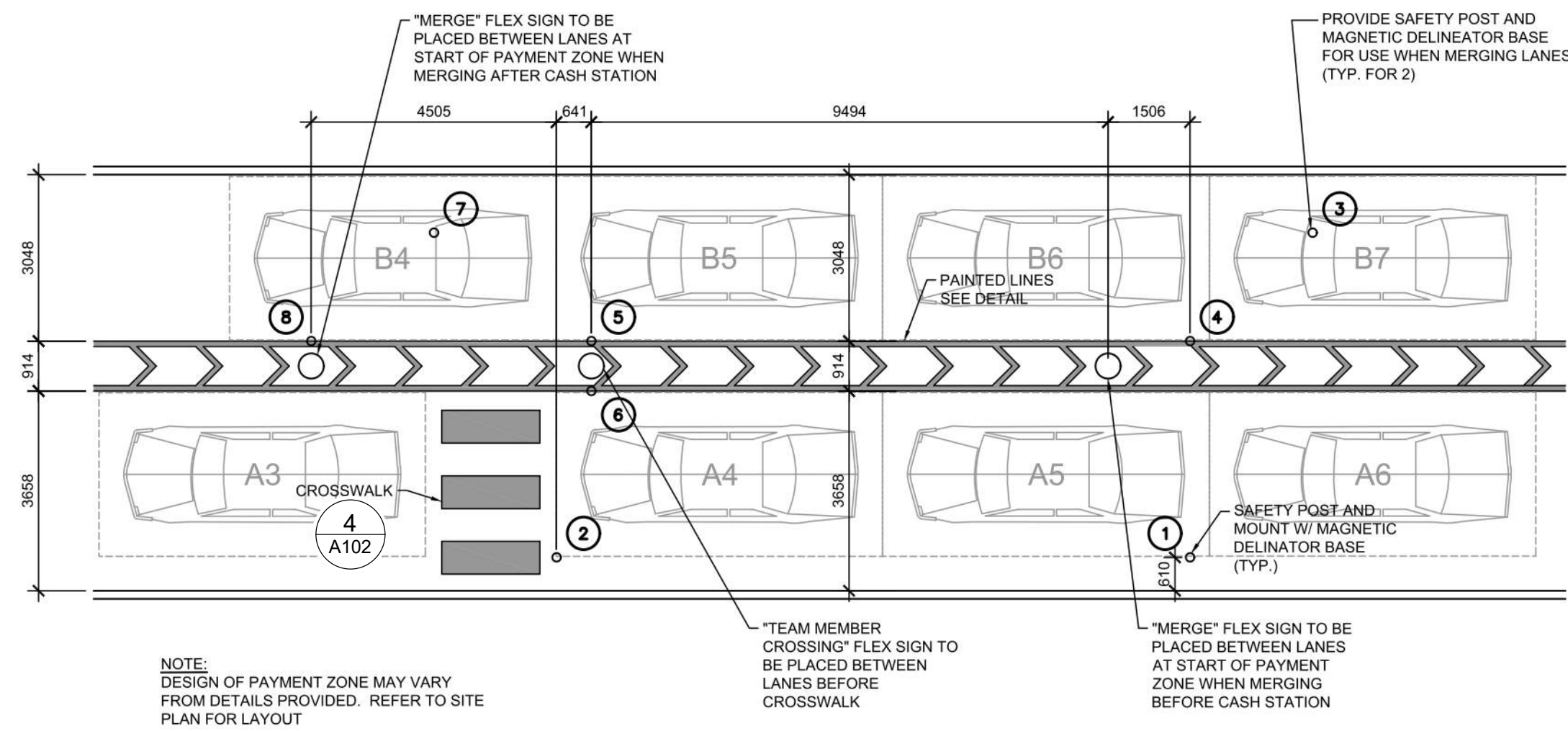

1 PAYMENT ZONE LAYOUT
A106 N.T.S.

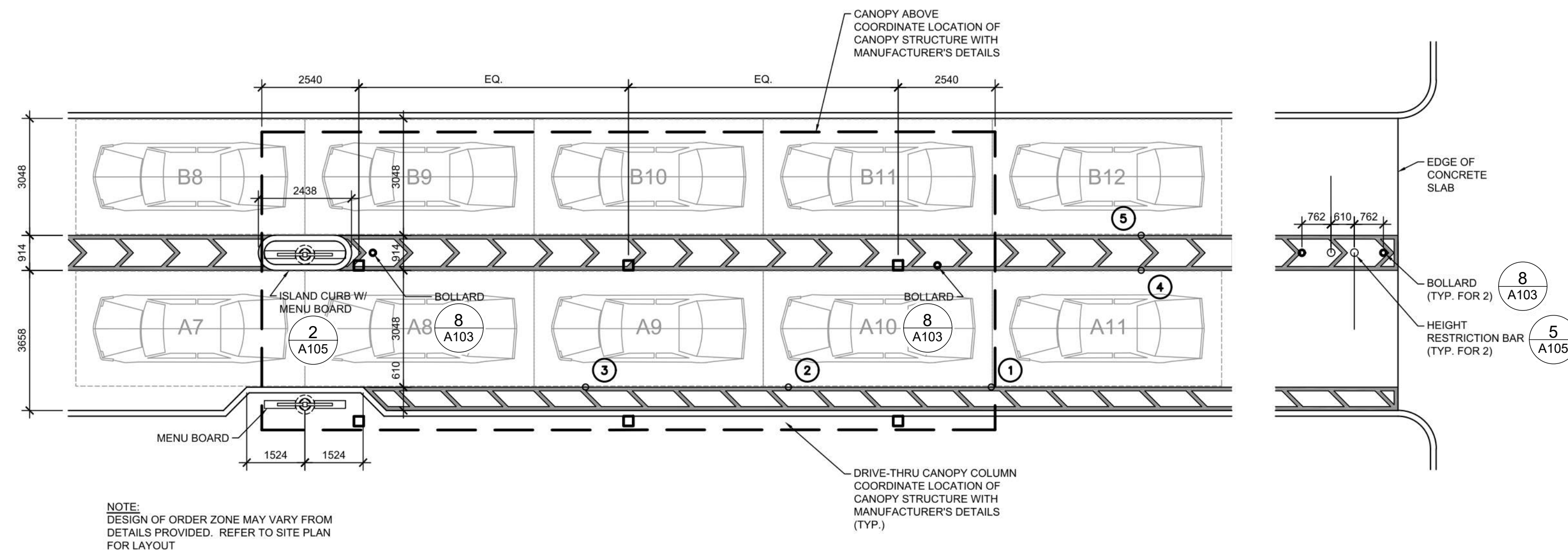

2 ORDER ZONE LAYOUT
A106 N.T.S.

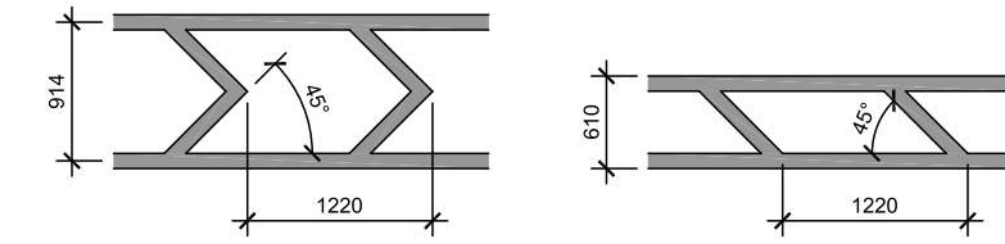

NOTES:
1. CONTRACTOR SHALL USE 100mm WIDE YELLOW REFLECTIVE PAINT FOR STRIPING ON CONCRETE DRIVE-THRU.

3 DRIVE-THRU PAINTED LINES
A106 N.T.S.

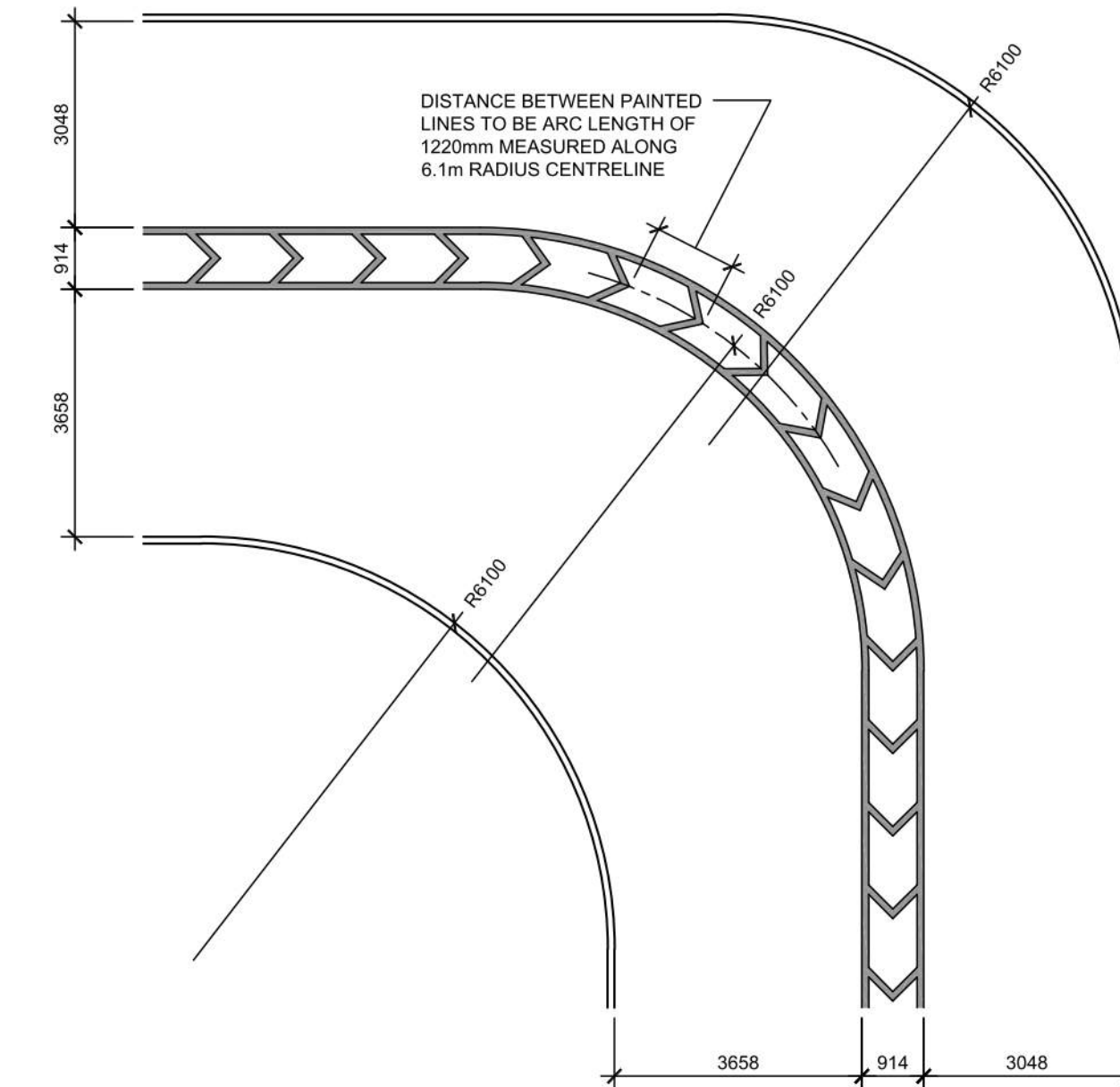

5 DRIVE-THRU BEND DESIGN
A106 N.T.S.

**6000 LITRES (1319 GAL) OIL AND GREASE INTERCEPTOR
2 PIECE 3 COMPARTMENTS**

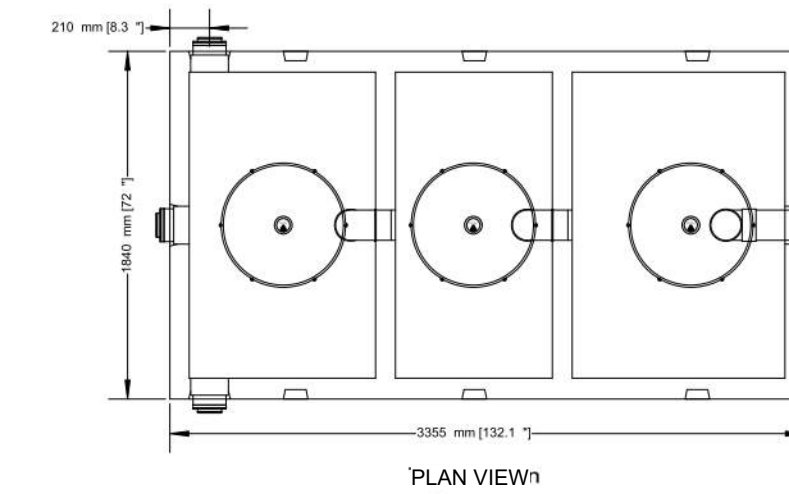

- PRECAST INTERCEPTOR IS DELIVERED AS A ONE PIECE UNIT
- INDIVIDUAL ACCESS LIDS TO EACH COMPARTMENT FOR CLEANOUT
- THREE COMPARTMENTS SEPARATE WATER FROM ANY INSOLUBLE LIQUID OF SOLIDS HAVING A SPECIFIC GRAVITY LESS THAN THAT OF WATER
- UNIT MUST BE VENTED IN REGULATION WITH PLUMBING CODES
- TANKS ARE CAST WITH 35 MPA STRENGTH CONCRETE AT 7 DAYS WITH 5-7% AIR
- STEEL REINFORCED WITH 10M REBAR, SPACED AT 400MM IN EACH DIRECTION
- REBAR COVER IS 25MM
- INTERCEPTORS ARE USED TO PREVENT OIL WASTE FROM ENTERING THE SANITARY SEWER SYSTEM

TOP HALF WEIGHT.....3157KG (6960LBS)
BOTTOM HALF WEIGHT.....2784KG (6160LB)
TOTAL TANK WEIGHT.....5951KG (13120LB)

NOTES

1. 150MM FLOW THROUGH PIPES EXTENDING 600MM DOWN
2. STANDARD THREE 150MM INLETS AS WELL AS ONE OUTLET BAFFLE CONSISTING OF 150MM TEE AND 150 MM PIPE (710MM IN LENGTH) THAT IS READILY ADAPTABLE FOR FILTER
3. CAST IN PLACE 610MM ID PLASTIC RISER WITH PLASTIC LID SECURED WITH STAINLESS STEEL FASTENERS EXTENDING 100MM ABOVE TOP

DESIGNED FOR UP TO ONE METRE BURIAL OVER TOP OF TANK -VEHICLE TRAFFIC AND UP TO TWO METRE BURIAL TANKS ARE AVAILABLE UPON REQUEST.

WWW.NEWMARKETPRECAST.COM | 905-852-6111 | 1-800-283-1297

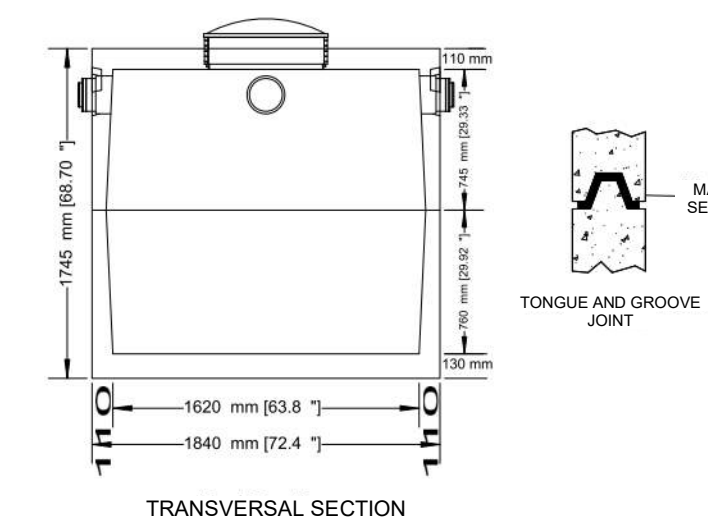
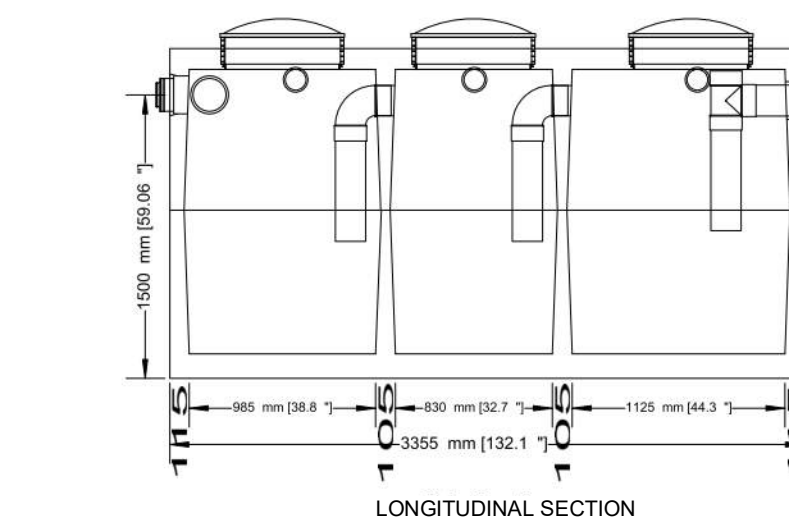

6 OIL & GREASE INTERCEPTOR DETAIL
A106 N.T.S.

| # | DATE | DESCRIPTION | BY |
|---|------------|----------------------------|-----|
| 7 | 2023-08-03 | ISSUE FOR SPA SUBMISSION 3 | MHB |
| 6 | 2023-07-18 | ISSUE FOR SPA SUBMISSION 3 | MHB |
| 5 | 2023-07-13 | ISSUE FOR SPA SUBMISSION 2 | MHB |
| 4 | 2023-06-30 | ISSUE FOR SPA SUBMISSION 2 | MHB |
| 3 | 2023-06-14 | ISSUE FOR SPA SUBMISSION 2 | MHB |
| 2 | 2023-03-07 | ISSUE FOR REVIEW | MHB |



CHICK-FIL TANGER OUTLETS OTTAWA

3000 PALLADIUM DRIVE, STITTSVILLE, ON K2S 1B9

SITE DETAILS

| | |
|--------------------------|----------------------------|
| PROJECT NO. 12-258P01 | PROJECT DATE 2023-02-14 |
| DRAWN BY Author | CHECKED BY Checker |
| SCALE N.T.S. | |

DRAWING NO. **A106** REV. **7**

Allison Hamlin

ALLISON HAMLIN
MANAGER (A), DEVELOPMENT REVIEW WEST
PLANNING, REAL ESTATE & ECONOMIC DEVELOPMENT
DEPARTMENT, CITY OF OTTAWA

APPROVED
By Allison Hamlin at 1:55 pm, Sep 19, 2023

NOTES

1. TAKE ALL FOUNDATIONS DOWN TO ORIGINAL UNDISTURBED CLAYEY SILT OR SILT SOIL OR ENGINEERED FILL CAPABLE OF SAFELY SUSTAINING A BEARING PRESSURE OF 150 kPa (3.5 lb/ft²) & 275 kPa (6.0 lb/ft²). ENSURE THAT THE MINIMUM FROST DEPTH AS SPECIFIED IN THE SOIL REPORT IS ATTAINED FOR ALL EXTERIOR AND BUILDING PERIMETER FOUNDATIONS, AND ALL INTERIOR FOUNDATIONS IN UNHEATED AREAS. SEE REPORT No. P06671-11 PREPARED BY PATERSON GROUP, DATED MARCH 5, 2023.
2. REFER TO SITE SERVICES PLAN, ELECTRICAL, MECHANICAL DRAWINGS FOR ALL INCOMING SERVICES.
3. ALL FOOTING EXCAVATIONS SHALL BE INSPECTED AND APPROVED BY A COMPETENT SOIL ENGINEER BEFORE PLACING CONCRETE.
4. CENTRE ALL BASE PLATES, PIERS, AND FOOTINGS UNDER COLUMN UNLESS NOTED OTHERWISE ON PLANS.
5. STRUCTURAL STEEL IN CONTACT WITH EARTH SHALL BE PROTECTED WITH MINIMUM 75mm OF CONCRETE OR EQUIVALENT WATERPROOFING.
6. DENOTES INCOMING GAS SERVICE. (G)
7. DENOTES INCOMING ELECTRICAL SERVICE. (E)
8. DENOTES RAIN WATER LEADER. (X)

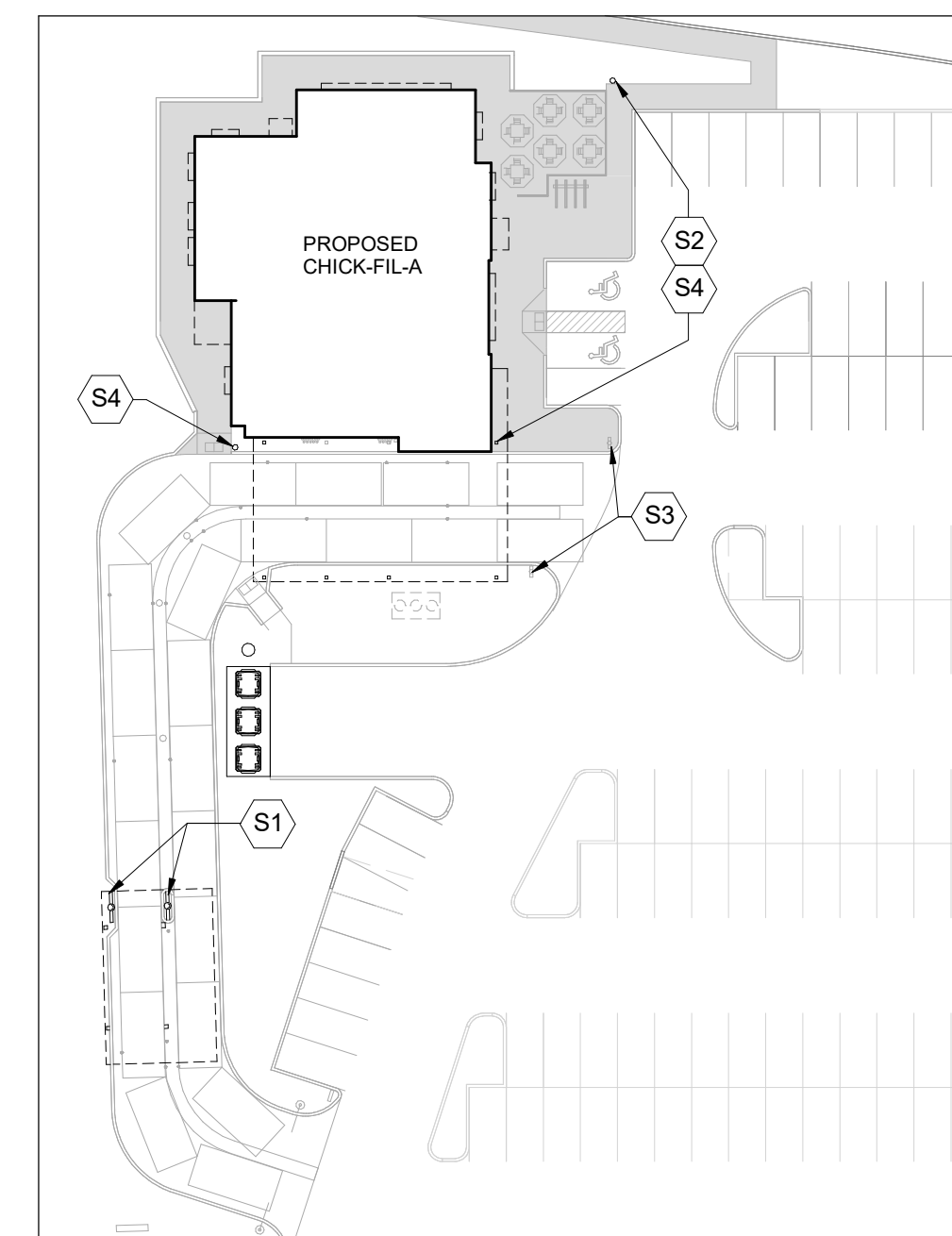

2 KEY PLAN - OPC CANOPY
A107 N.T.S.

| COLUMN SCHEDULE | | |
|-----------------|---------------|---------------------|
| TYPE MARK | SIZE | BASEPLATE THICKNESS |
| C1 | HSS127x127x13 | 1" THK |
| C2 | HSS152x152x13 | 1" THK |
| C3 | HSS294x294x13 | 1" THK |

⊂ DENOTES FOOTING

SITE KEYNOTES:

| | |
|----|--|
| S1 | ORDER MENU SIGN. REFER TO ARCH. AND CIVIL DWGS. SEE 2 / S-701 |
| S2 | FLAG POLE. SEE COORD. EXACT LOCATION WITH CIVIL DWGS. SEE 3 / S-701 |
| S3 | DRIVE THRU ENTRANCE SIGN. REFER TO ARCH. AND CIVIL DWGS. SEE 5 / S-701 |
| S4 | SIGNAGE REFER TO ARCH. AND CIVIL DWGS. SEE 4 / S-701 |

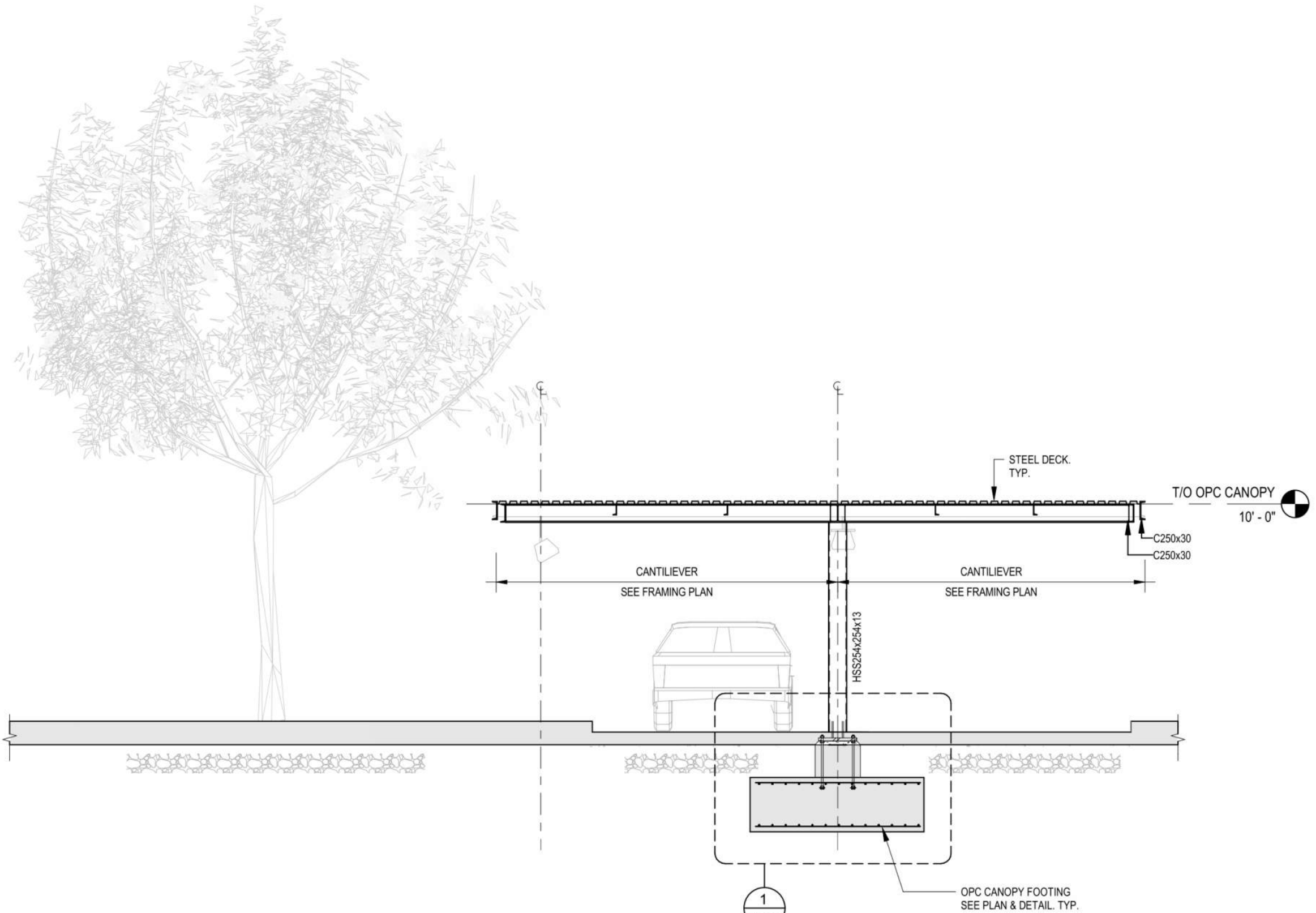

3 FRAMING SECTION
A107 N.T.S.

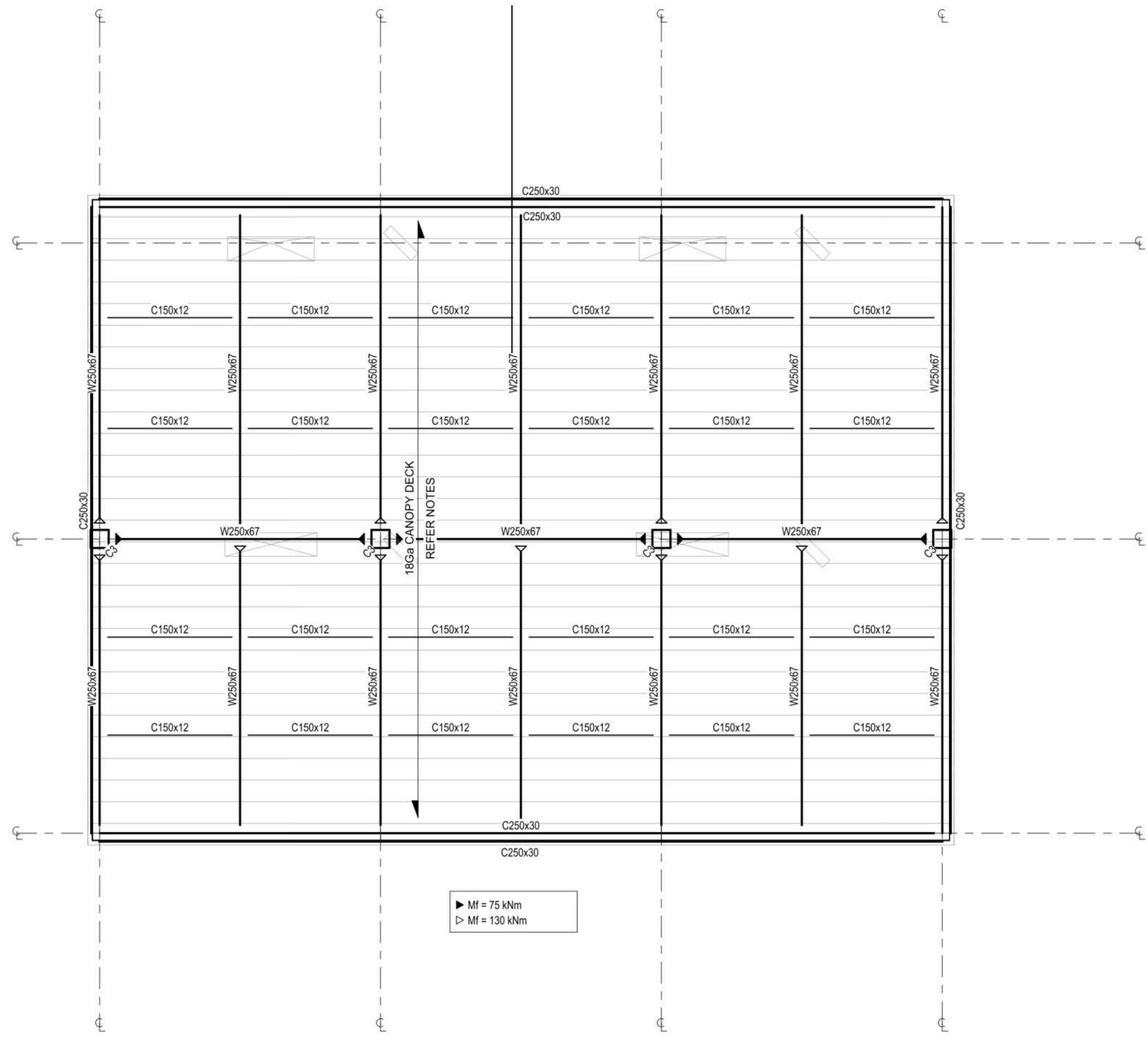

1 OPC CANOPY - FRAMING PLAN
A107 N.T.S.

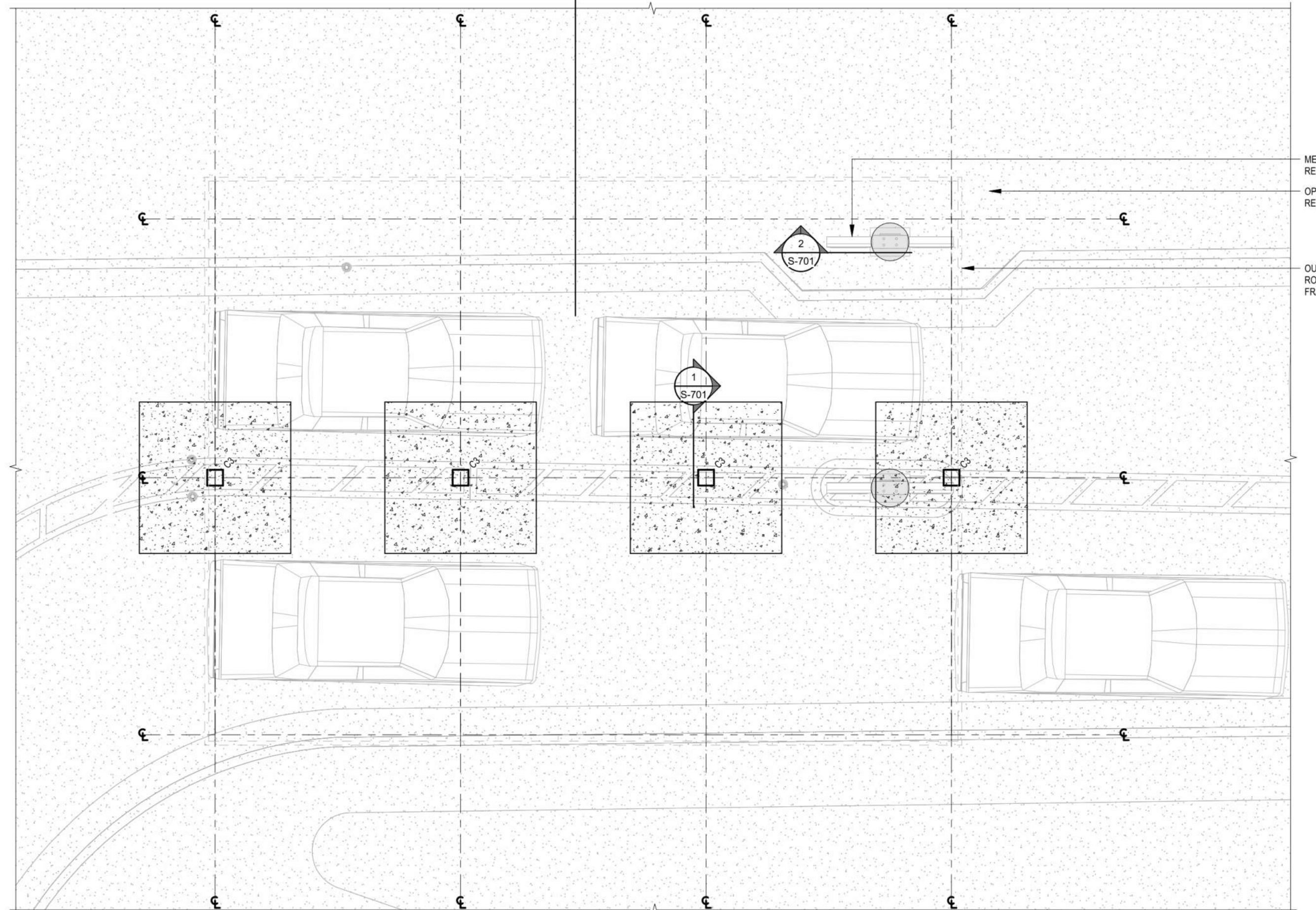

4 OPC CANOPY - FOUNDATION PLAN
A107 N.T.S.

ALL GRADE ELEVATIONS ARE APPROXIMATE AND MUST BE VERIFIED WITH CIVIL DRAWINGS

REFER TO CIVIL, SITE PLAN & ARCHITECTURAL DRAWINGS FOR MORE DETAILS & LOCATIONS OF SIGNAGE

TOP OF CANOPY FOOTINGS TO BE MIN. 16" BELOW TOP OF OPC SLAB ELEVATION REFER TO CIVIL DWGS FOR MORE INFORMATION

| # | DATE | DESCRIPTION | BY |
|---|------------|----------------------------|-----|
| 7 | 2023-08-03 | ISSUE FOR SPA SUBMISSION 3 | MHB |
| 6 | 2023-07-18 | ISSUE FOR SPA SUBMISSION 3 | MHB |
| 5 | 2023-07-13 | ISSUE FOR SPA SUBMISSION 2 | MHB |
| 4 | 2023-06-30 | ISSUE FOR SPA SUBMISSION 2 | MHB |
| 3 | 2023-05-30 | ISSUE FOR COORDINATION | MHB |



PROJECT
CHICK-FIL TANGER OUTLETS OTTAWA
3000 PALLADIUM DRIVE, STITTSVILLE, ON K2S 1B9

DRAWING
SITE DETAILS

| | |
|--------------|------------|
| PROJECT NO. | 12-258P01 |
| PROJECT DATE | 2023-02-14 |
| DRAWN BY | Author |
| CHECKED BY | Checker |
| SCALE | AS NOTED |

| | | | |
|-------------|------|-----|---|
| DRAWING NO. | A107 | REV | 7 |
|-------------|------|-----|---|