

1 TREE CONSERVATION REPORT & LANDSCAPE PLAN
L.1 SCALE 1:300

- GENERAL NOTES:**
- IT IS THE RESPONSIBILITY OF THE APPROPRIATE CONTRACTOR OR OFFICIAL TO REPORT ANY ERRORS, OMISSIONS OR DISCREPANCIES ON THIS PLAN WITH ACTUAL SITE CONDITIONS TO THE LANDSCAPE ARCHITECT BEFORE PROCEEDING WITH CONSTRUCTION.
 - THE CONTRACTOR IS TO NOTIFY ALL UTILITY COMPANIES AND AUTHORITIES PRIOR TO ANY EXCAVATION AND ASCERTAIN LOCATIONS OF UNDERGROUND SERVICES.
 - THE CONTRACTOR IS TO REINSTATE ALL AREAS AND ITEMS DAMAGED AS A RESULT OF CONSTRUCTION ACTIVITY.
 - THE CONTRACTOR IS TO COMPLY WITH ALL PERTINENT CODES AND BY-LAWS.
 - THE CONTRACTOR IS TO MAINTAIN A POSITIVE SURFACE RUN-OFF THROUGHOUT THE ENTIRE CONSTRUCTION PERIOD.
 - THE LANDSCAPE ARCHITECT IS NOT RESPONSIBLE FOR SUBSURFACE CONDITIONS.
 - THE CONTRACTOR IS TO IDENTIFY ALL EXISTING TREES TO REMAIN ON SITE WITH THE LANDSCAPE ARCHITECT PRIOR TO CONSTRUCTION.
 - THE CONTRACTOR IS TO STAKE THE PROPOSED LOCATION OF ALL PLANT MATERIAL IN CONJUNCTION WITH THE LANDSCAPE ARCHITECT PRIOR TO EXCAVATION.
 - MINIMUM DISTANCES FOR SELECTED DECIDUOUS TREES ARE AS FOLLOWS:
 - BUILDING FOUNDATIONS - 7.5M
 - SIDEWALKS - 1.5M
 - PUBLIC STREETS - 2.5M
 - UNDERGROUND INFRASTRUCTURE - 2.0M
 - ALL TREES WITHIN 1M OF UNDERGROUND UTILITY TRENCHES ARE TO BE EXCAVATED BY HAND.
 - REMOVE ALL PROTECTIVE WRAPPING FROM TREE TRUNKS AFTER INSTALLATION.
 - STAKING OF TREES SHALL ONLY BE PERFORMED IF NECESSARY.
 - ENSURE THAT MULCH IS PULLED BACK A MINIMUM DISTANCE OF 75MM FROM BASE OF TREE TRUNK.

EXISTING TREE LIST						QTY.	KEY
KEY	QTY.	BOTANICAL NAME	COMMON NAME	SIZE	CONDITION	REMARKS	OWNERSHIP
AG	3	Acer ginnala	Amur Maple	100-200mm DBH	GOOD	To be removed	265 CENTRUM
AN	1	Acer negundo	Manitoba Maple	4x250-300mm DBH	FAIR	To be removed	265 CENTRUM
AP	5	Acer platanoides	Columnar Norway Maple	200-230mm DBH	GOOD	To be removed	265 CENTRUM
FR	1	Fraxinus spp. 'Multi-Stem'	Multi-Stem Ash	100-200mm DBH	DEAD	To be removed	265 CENTRUM
GT	3	Gleditsia triacanthos	Honey Locust	250-280mm DBH	GOOD	To be removed	265 CENTRUM
HL	4	Gleditsia triacanthos	Honey Locust	250-400mm DBH	GOOD	See plan	CITY OF OTTAWA
HO	9	Gleditsia triacanthos	Honey Locust	240-300mm DBH	GOOD	See plan	CITY & 265 CENTRUM
PD	1	Populus deltoides	Eastern Cottonwood	300mm DBH	GOOD	To remain	CITY OF OTTAWA
PI	3	Picea pungens	Colorado Spruce	200-300mm DBH	GOOD	To be removed	265 CENTRUM
PP	9	Picea pungens	Colorado Spruce	200-300mm DBH	GOOD	To remain	CITY OF OTTAWA
QM	1	Quercus macrocarpa	Honey Locust	250mm DBH	GOOD	To be removed	265 CENTRUM
SR	2	Syringa reticulata	Japanese Tree Lilac	100mm DBH	GOOD	To be removed	265 CENTRUM
TF	3	Thuja occidentalis 'Fastigiata'	Columnar White Cedar	100mm DBH	FAIR	To remain	CITY OF OTTAWA

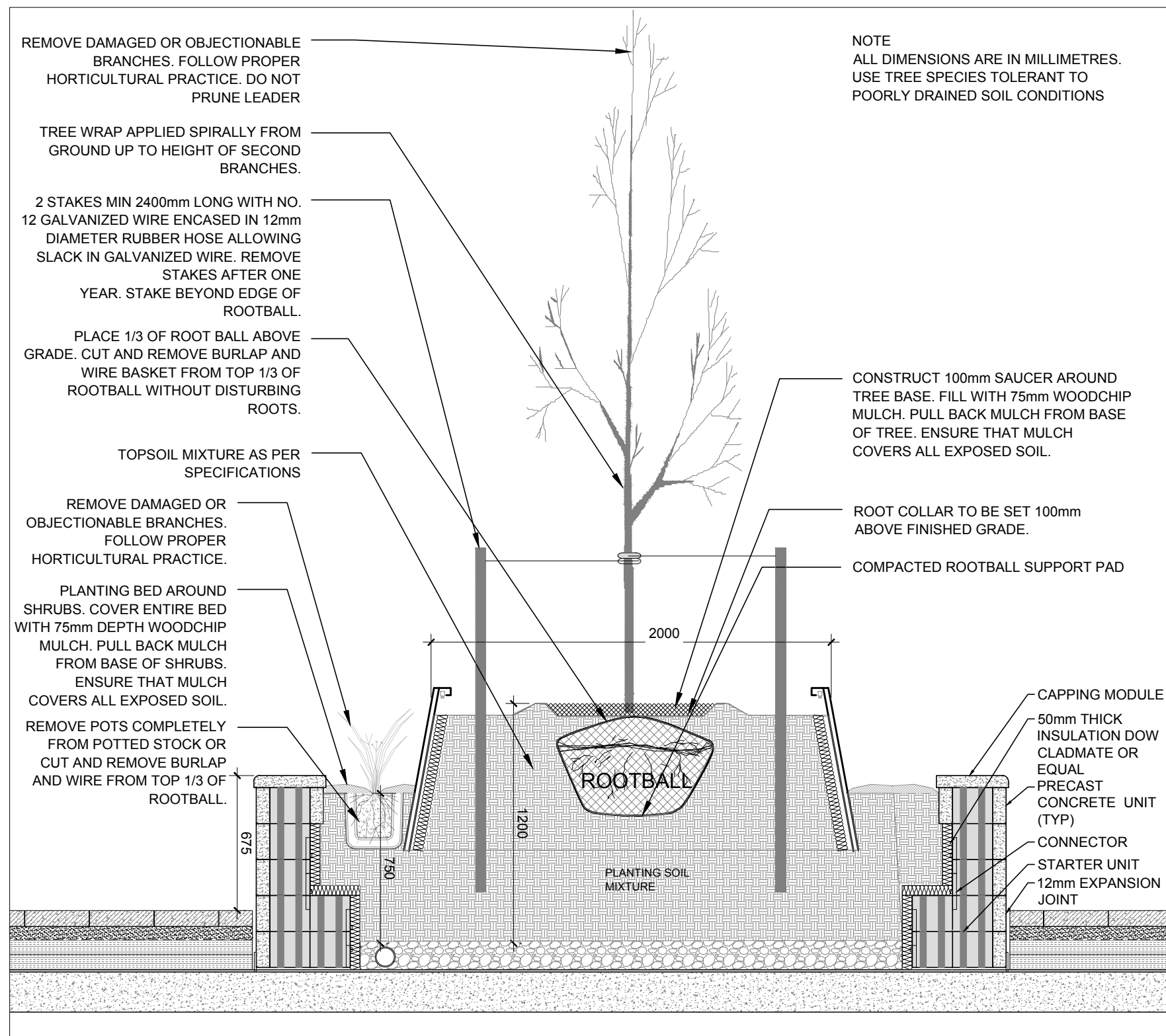

2 RAISED PLANTER & ILLUMINATED TREE PIT DETAIL
L.1 SCALE 1:25

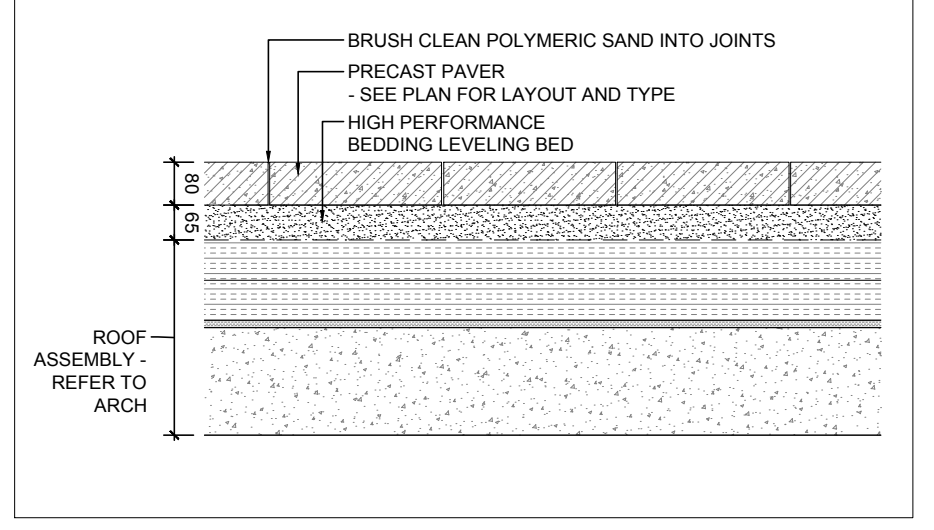

3 PRECAST CONCRETE UNIT PAVERS
L.1 SCALE NTS

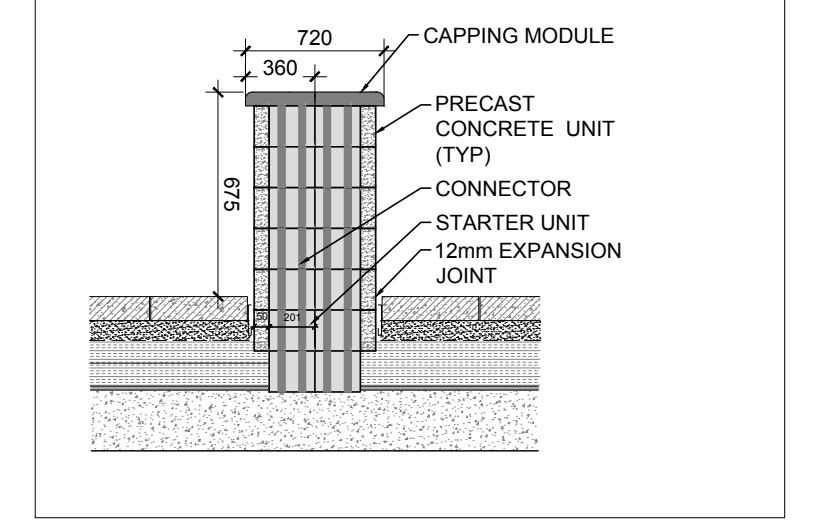

4 DOUBLESIDED PRECAST SEATED WALL
L.1 SCALE NTS

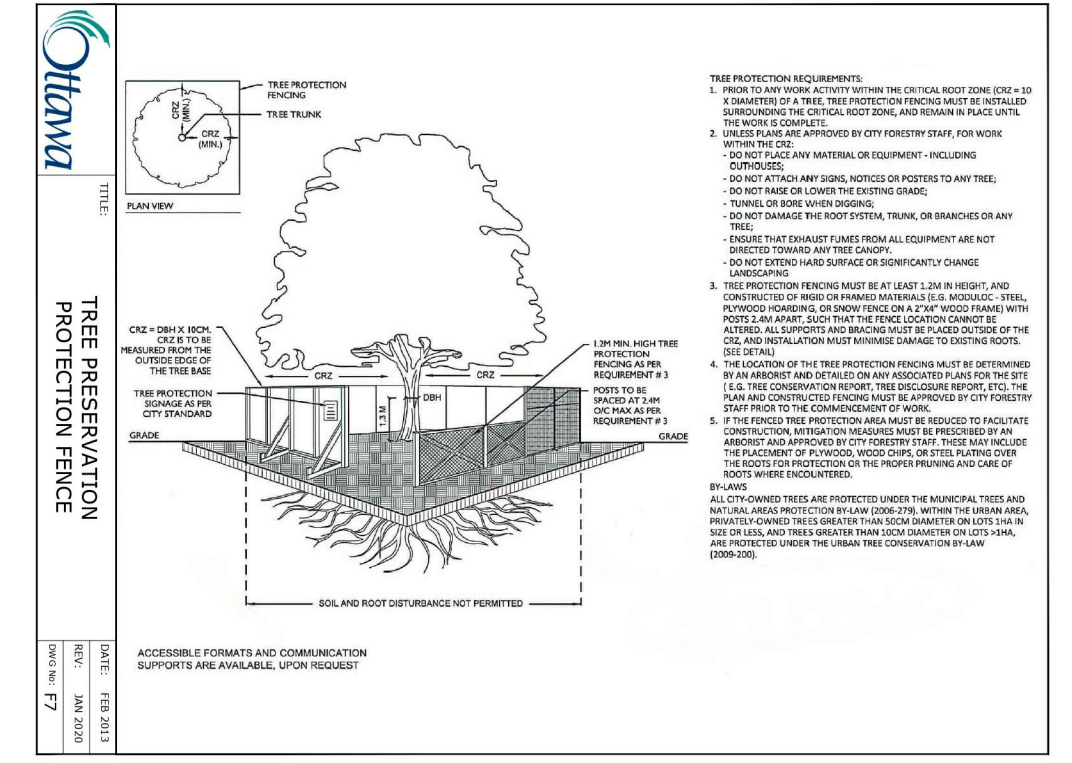

5 TREE PROTECTION FENCE
L.1 SCALE NTS

CLIENT
BAYVIEW ORLEANS INC.

CONSULTANTS
ARCHITECTS: **B+H**
320 Bay St. #200
Toronto, ON M5H 4A6
Tel: (416) 596-2299

SURVEYORS:
ANNIS, O'SULLIVAN, VOLLEBECK LTD.
14 Concourse Gate, Suite 500
Newport, Ont. K2E 7R6
Phone: (613) 727-0850 / Fax: (613) 727-1079

CIVIL ENGINEERS:
McINTOSH PERRY
115 Walgreen Rd.
Carp, ON K0A 1L0
Tel: (613) 836-2184

LEGEND

- EXISTING TREE TO REMAIN
- EXISTING TREE TO BE REMOVED
- TREE PROTECTION FENCING
- PROPOSED DECIDUOUS TREE
- PROPOSED DECIDUOUS TREE IN RAISED ILLUMINATED PLANTER (REFER TO 2L.1)
- PROPOSED DECIDUOUS & CONIFEROUS SHRUBS
- PROPOSED 3 RING BIKE RACK
- PROPOSED PERGOLA W/ STRING LIGHTS & LOUNGE SEATING
- PROPOSED AMENITY TABLE
- OUTDOOR BBQ KITCHEN
- PROPOSED BENCH
- PROPOSED GRASS
- PROPOSED GREENROOF
- PROPOSED ARTIFICIAL TURF
- PROPOSED PRECAST UNIT PAVING TO MATCH CENTRUM STREETSCAPE
- PROPOSED ROOF TOP PAVERS
- PROPOSED PRIVATE PATIO PAVERS
- PROPOSED CONCRETE SIDEWALK
- PROPOSED PLANTER/ SEATWALL
- PROPOSED GUARDRAIL
- PROPOSED GRADE (REFER TO GRADING PLAN)
- PROPOSED TACTILE WALKING SURFACE INDICATOR (TWS)
- FIRE HYDRANT REFER TO ARCH & CIVIL

4	ISSUED FOR SPA	03/24/2023	SL	JL
3	ISSUED FOR REVIEW & COMMENT	03/21/2023	SL	JL
2	ISSUED FOR REVIEW & COMMENT	03/15/2023	SL	JL
1	ISSUED FOR PROGRESS REVIEW	03/10/2023	SL	JL
No.	Issue	Date	DR	CK

JAMES B. LENNOX & ASSOCIATES INC. LANDSCAPE ARCHITECTS
3332 CARLING AVE. OTTAWA, ONTARIO K2H 5A8
Tel: (613) 722-5168 Fax: (866) 343-3942

PROJECT
265 CENTRUM, OTTAWA ON

DRAWING
TREE CONSERVATION REPORT & LANDSCAPE PLAN CONCEPT

STAMP
ASSOCIATION OF LANDSCAPE ARCHITECTS
MEMBER
JBL

SCALE
AS SHOWN

START DATE
FEBRUARY 2023

PROJECT NO.
23MIS2323

DRAWING NO.
L.1

PLOT SIZE ARCH-D