

CONSULTANTS
 ARCHITECTS
CSV ARCHITECTS
 sustainable design - conception écologique
 613.564.8118 190 O'Connor Street, Suite 100
 www.csv.ca Ottawa, Ontario K2P 2K3
 SURVEYORS
 ANNIS, O'SULLIVAN, VOLLEBEKK LTD.
 14 Concourse Gate, Suite 500
 Nepean, Ont. K2E 7R6
 Phone: (613) 727-0850 / Fax: (613) 727-1079
 Email: nepean@ovsintl.com

- LEGEND**
- EXISTING TREE TO REMAIN
 - EXISTING TREE TO BE REMOVED
 - PROPOSED DECIDUOUS TREE
 - PROPOSED SHRUBS / PERENNIALS
 - PROPOSED VINE
 - PROPOSED SOD
 - PROPOSED TYPE 1 PRECAST CONCRETE PAVERS
 - PROPOSED TYPE 2 PRECAST CONCRETE PAVERS
 - PROPOSED MULCH
 - PROPOSED TREE PROTECTION FENCE
 - PROPOSED 1.5m BLACK VINYL CHAIN LINK FENCE

Issue	Date	By	DR	CK
5 REVISED PER NEW SITE PLAN	03/28/2024	ML	JL	
4 REVISED PER CIVIL DRAWING	01/31/2024	ML	JL	
3 REVISED PER NEW SITE PLAN	01/22/2024	ML	JL	
2 REVISED PER CITY COMMENTS	10/06/2023	ML	JL	
1 ISSUED FOR SITE PLAN CONTROL	05/12/2023	ML	JL	

JAMES B. LENNOX & ASSOCIATES INC.
 LANDSCAPE ARCHITECTS
 3332 CARLING AVE. OTTAWA, ONTARIO K2H 5A8
 Tel. (613) 722-8168 Fax. (613) 722-8168

PROJECT
PROPOSED DEVELOPMENT
 3745 ST. JOSEPH BLVD, OTTAWA ON

DRAWING
TREE CONSERVATION REPORT & LANDSCAPE PLAN

STAMP	SCALE
	AS SHOWN
	START DATE
	MARCH 2023
	PROJECT NO.
	23MIS2327

PROJECT NORTH	DRAWING NO.
	L.1

PLOT SIZE ARCH-D

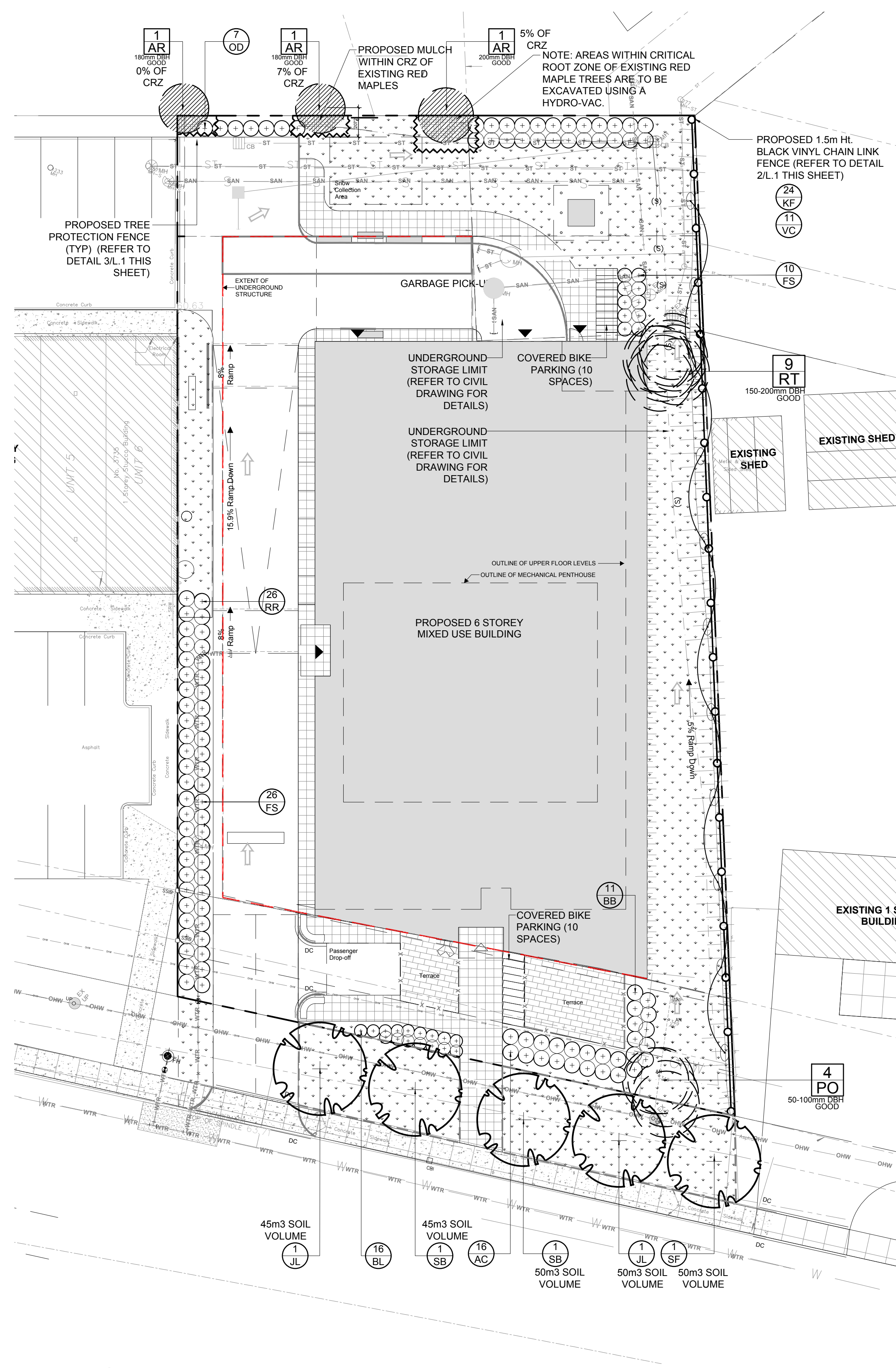

1 TREE CONSERVATION REPORT & LANDSCAPE PLAN
 SCALE: 1:200

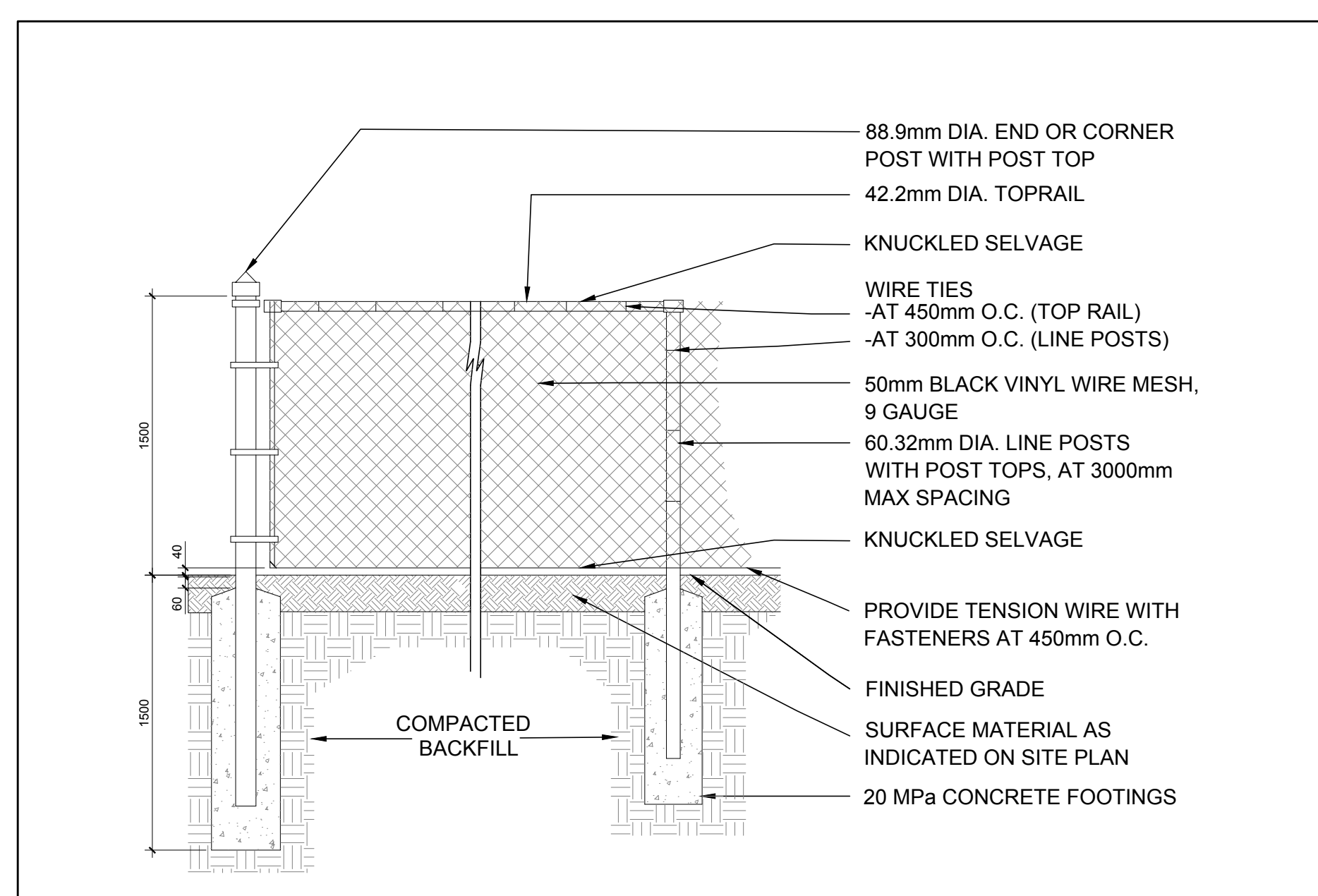

2 1.5m Ht. BLACK VINYL CHAIN LINK FENCE
 SCALE: NTS

- GENERAL NOTES:**
- It is the responsibility of the appropriate contractor or official to report any errors, omissions or discrepancies on this plan with actual site conditions to the Landscape Architect before proceeding with construction.
 - The contractor is to notify all utility companies and authorities prior to any excavation and ascertain locations of underground services.
 - The contractor is to reinstaate all areas and items damaged as a result of construction activity.
 - The contractor is to comply with all pertinent codes and by-laws.
 - The contractor is to maintain a positive surface run-off throughout the entire construction period.
 - The Landscape Architect is not responsible for subsurface conditions.
 - The contractor is to identify all existing trees to remain on site with the Landscape Architect prior to construction.
 - The contractor is to stake the proposed location of all plant material in conjunction with the Landscape Architect prior to excavation.
 - Minimum distances for selected deciduous trees are as follows:
 - Building Foundations 7.5m
 - Sidewalks 1.5m
 - Public Streets 2.5m
 - Underground Infrastructure 2.0m
 - All trees within 1m of underground utility trenches are to be excavated by hand.
 - Remove all protective wrapping from tree trunks after installation.
 - Staking of trees shall only be performed if necessary.
 - Ensure that mulch is pulled back a min. distance of 75mm from base of tree trunk.

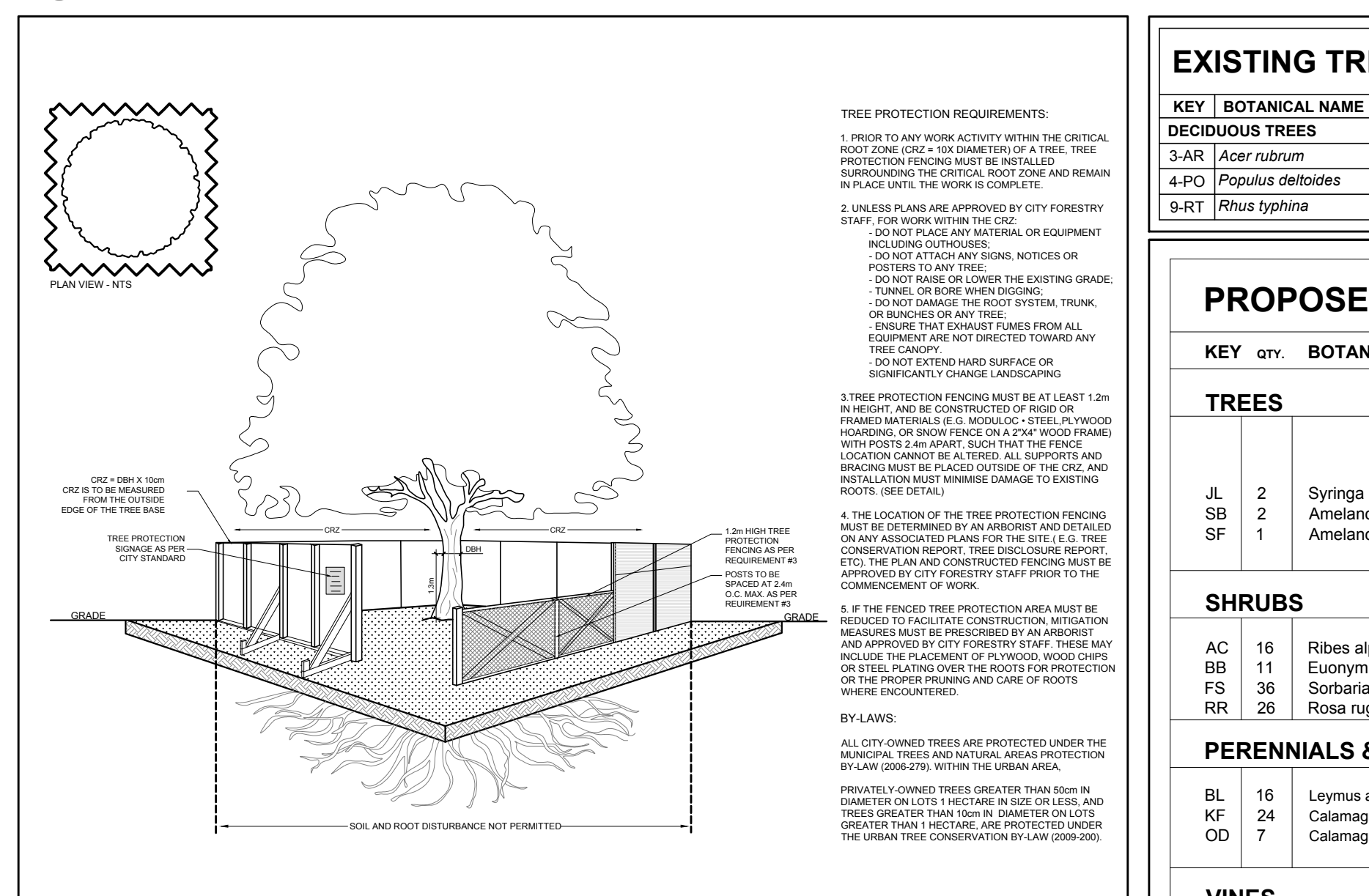

3 TREE PROTECTION FENCING
 SCALE: NTS

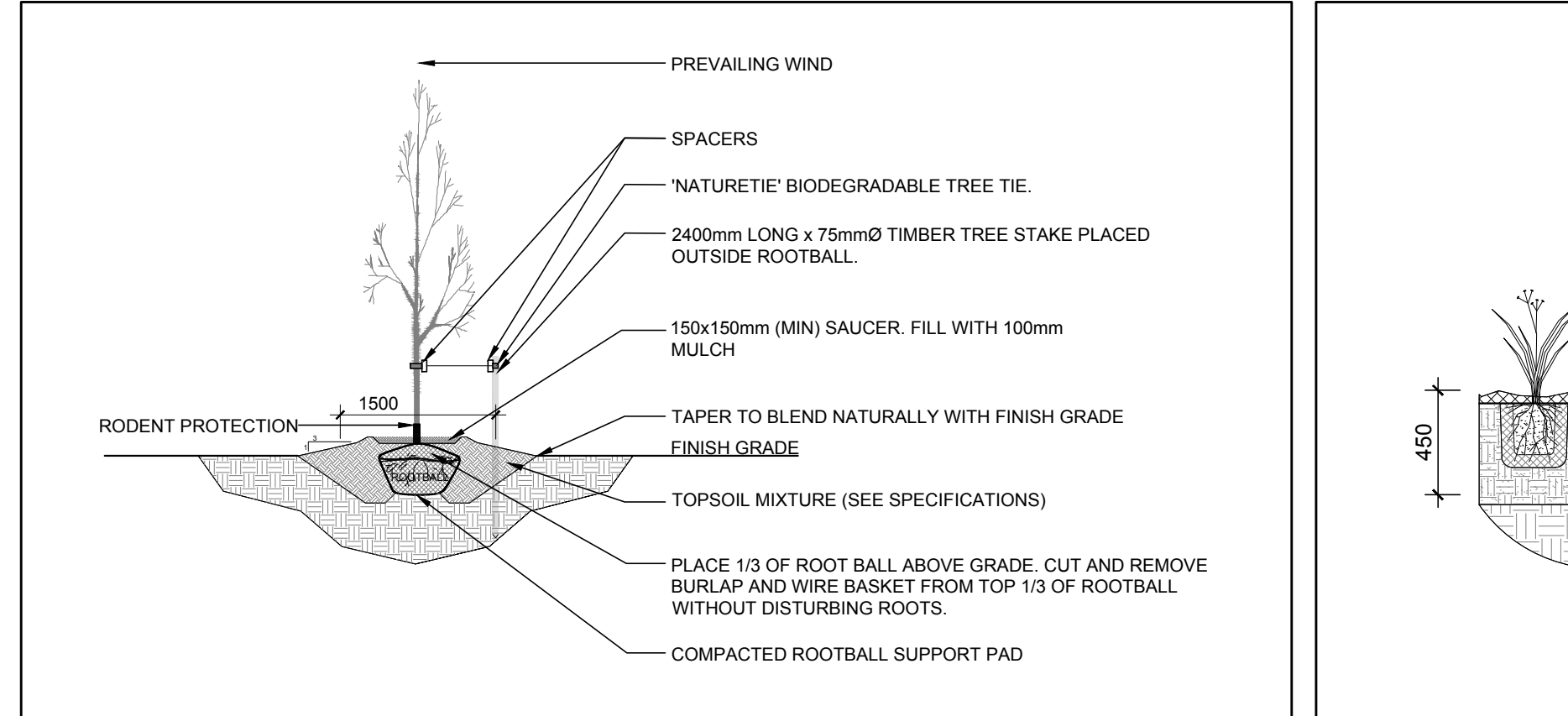

4 DECIDUOUS TREE PLANTING
 SCALE: NTS

EXISTING TREE LIST

KEY	BOTANICAL NAME	COMMON NAME	SIZE	OWNERSHIP	CONDITION	ACTION
DECIDUOUS TREES						
3-AR	<i>Acer rubrum</i>	Red Maple	180-200mm DBH	530 Lacolle Way	GOOD	TO REMAIN
4-PO	<i>Populus deltoides</i>	Eastern Cottonwood	50-100mm DBH	3745 St. Joseph Blvd	GOOD	TO BE REMOVED
9-RT	<i>Rhus typhina</i>	Staghorn Sumac	150-200mm DBH	3745 St. Joseph Blvd	GOOD	TO BE REMOVED

PROPOSED PLANT LIST

KEY	QTY	BOTANICAL NAME	COMMON NAME	SIZE	CONDITION	REMARKS
TREES						
JL	2	<i>Syringa reticulata</i>	Japanese Tree Lilac	50mm ø	B&B	Single leader
SB	2	<i>Amelanchier canadensis</i>	Serviceberry	50mm ø	B&B	Single leader
SF	1	<i>Amelanchier laevis 'JFS-ARB'</i>	Spring Flurry Serviceberry	50mm ø	B&B	Single leader
SHRUBS						
AC	16	<i>Ribes alpinum</i>	Alpine Currant	600mm ht.	Potted	800mm o.c.
BB	11	<i>Euonymus alatus 'Compactus'</i>	Dwarf Burning Bush	600mm ht.	Potted	800mm o.c.
FS	36	<i>Sorbaria sorbifolia 'Sem'</i>	Sem False Spirea	600mm ht.	Potted	1000mm o.c.
RR	26	<i>Rosa rugosa</i>	Rugosa Rose	600mm ht.	Potted	1000mm o.c.
PERENNIALS & ORNAMENTAL GRASSES						
BL	16	<i>Leymus arenarius 'Blue Dune'</i>	Blue Dune Grass	250mm pot	Potted	800mm o.c.
KF	24	<i>Calamagrostis 'Karl Foerster'</i>	Feather Reed Grass	250mm pot	Potted	800mm o.c.
OD	7	<i>Calamagrostis 'Overdam'</i>	Overdam Grass	250mm pot	Potted	800mm o.c.
VINES						
VC	11	<i>Parthenocissus quinquefolia</i>	Virginia Creeper	1 gallon pot	Potted	Train up fence

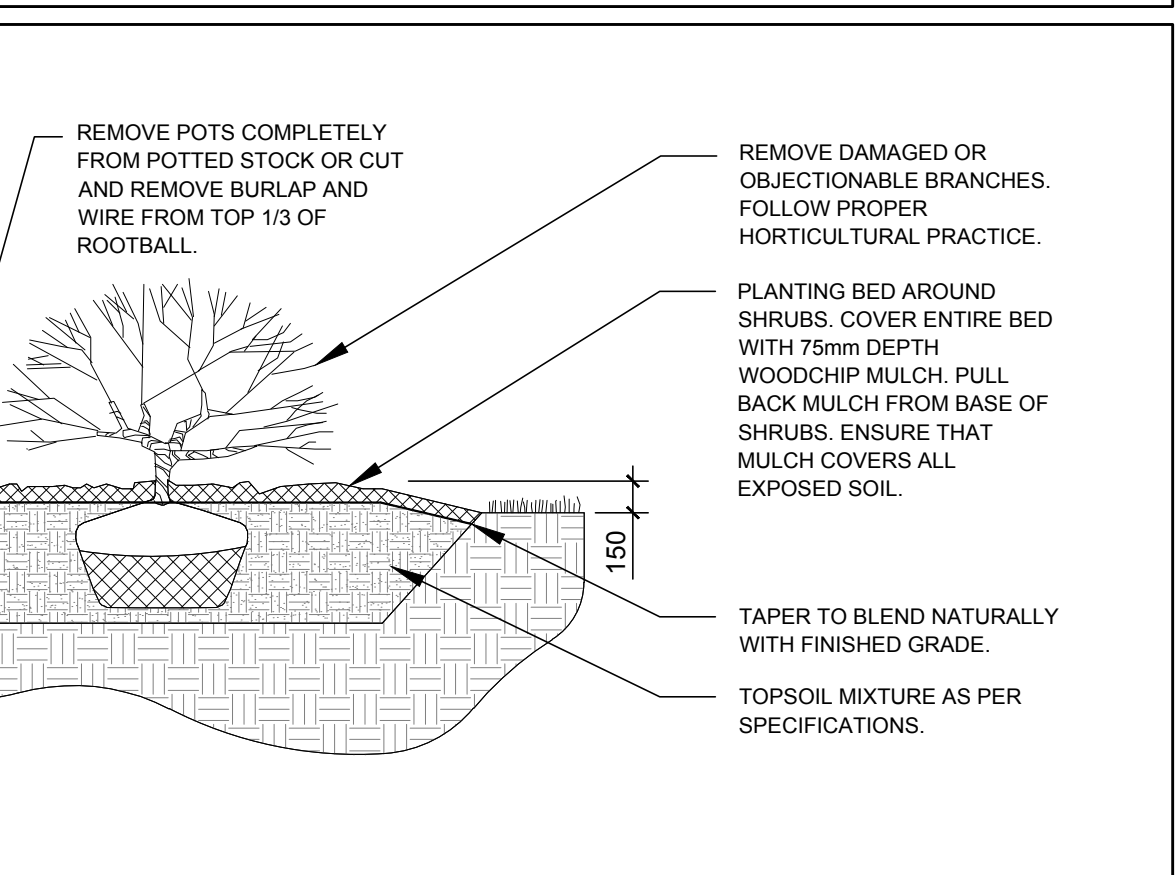

5 SHRUB / ORNAMENTAL GRASS / PERENNIAL PLANTING
 SCALE: NTS

D07-12-23-0059