

DRAWING No. ROOF DRAINAGE

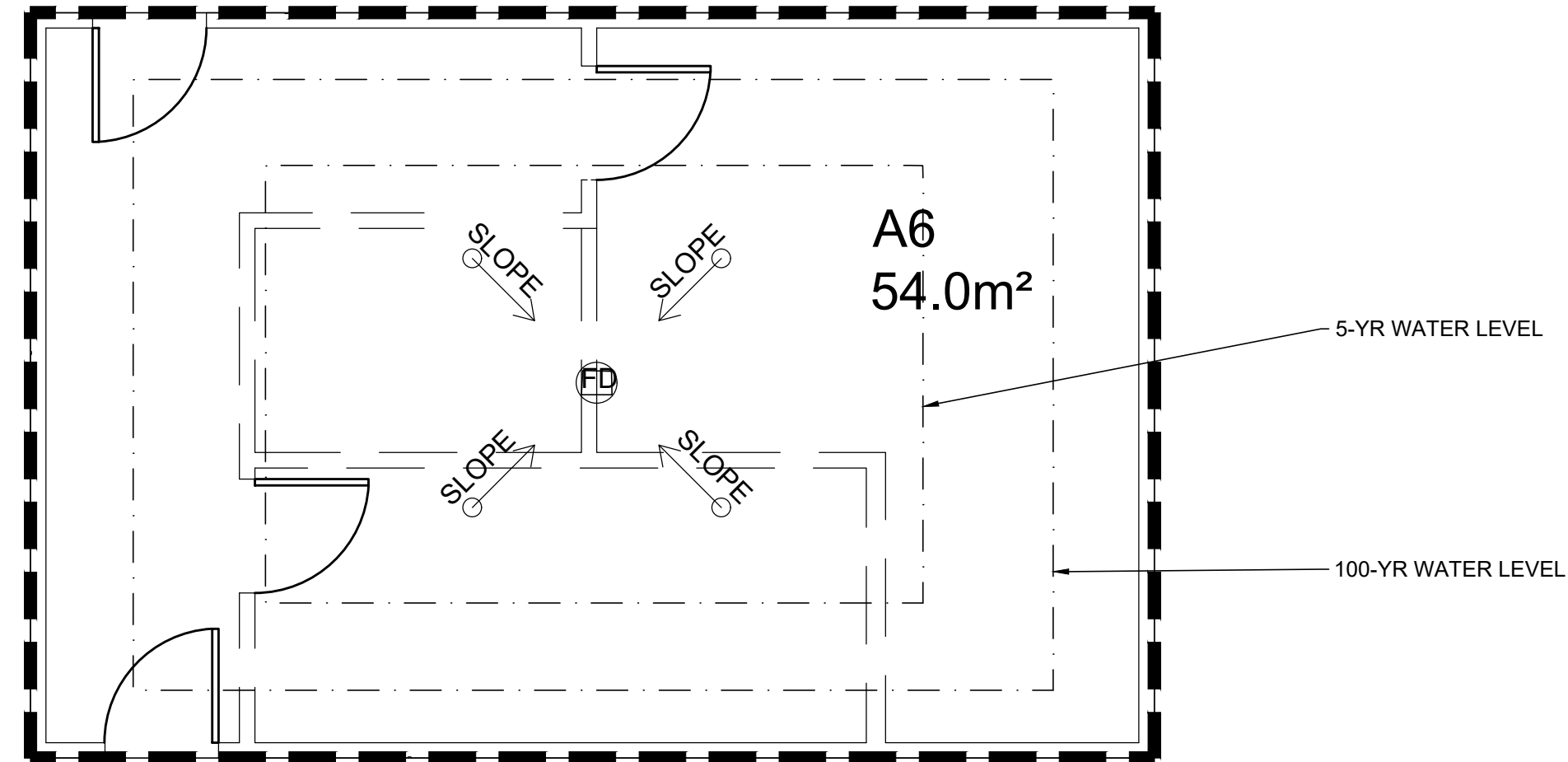

*Andrew McCreight*  
**ANDREW MCCREIGHT**  
 MANAGER, DEVELOPMENT REVIEW CENTRAL  
 PLANNING, DEVELOPMENT & BUILDING SERVICES  
 DEVELOPMENT DEPARTMENT, CITY OF OTTAWA

**APPROVED**  
 By Andrew McCreight at 2:05 pm, Aug 14, 2024

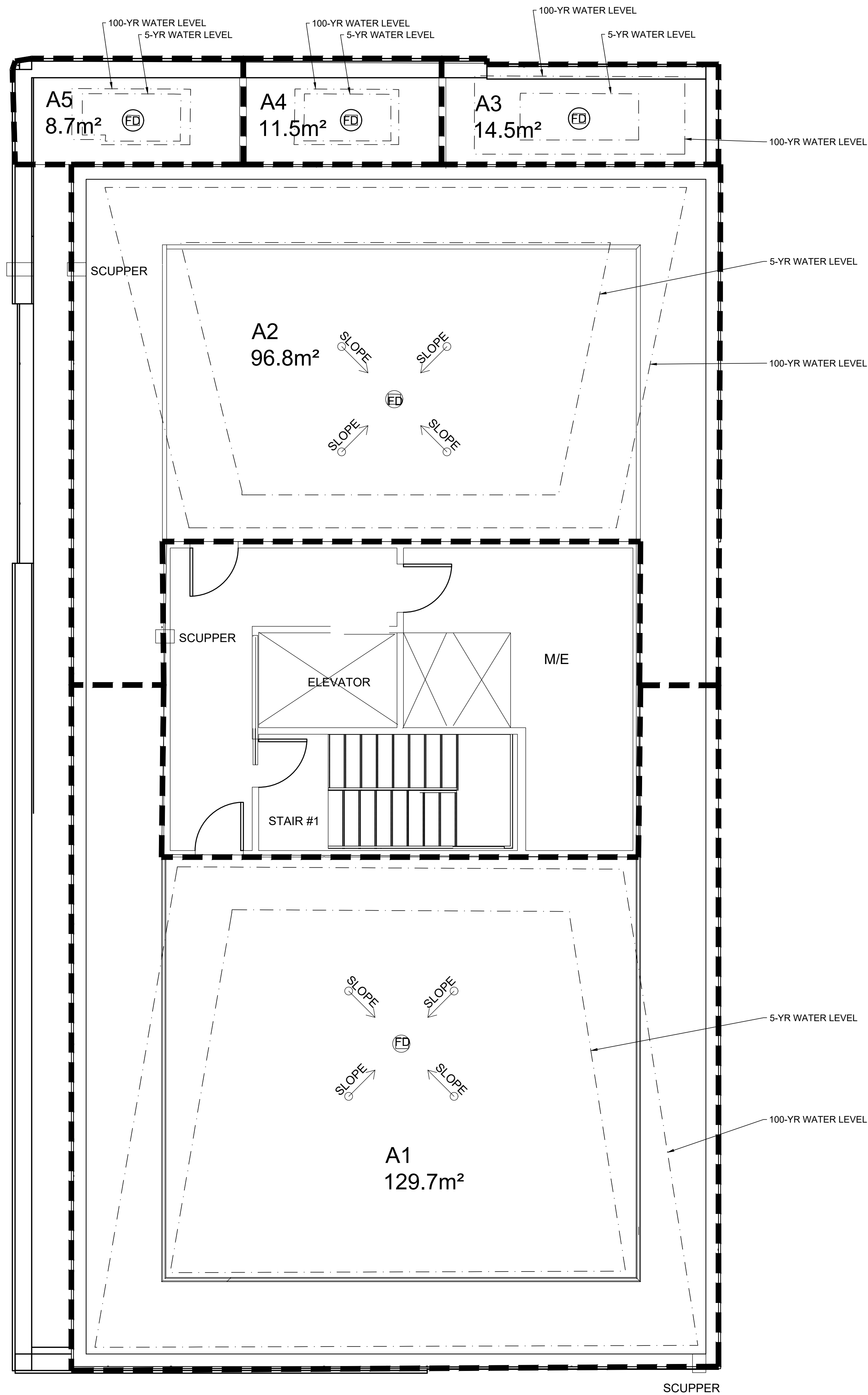
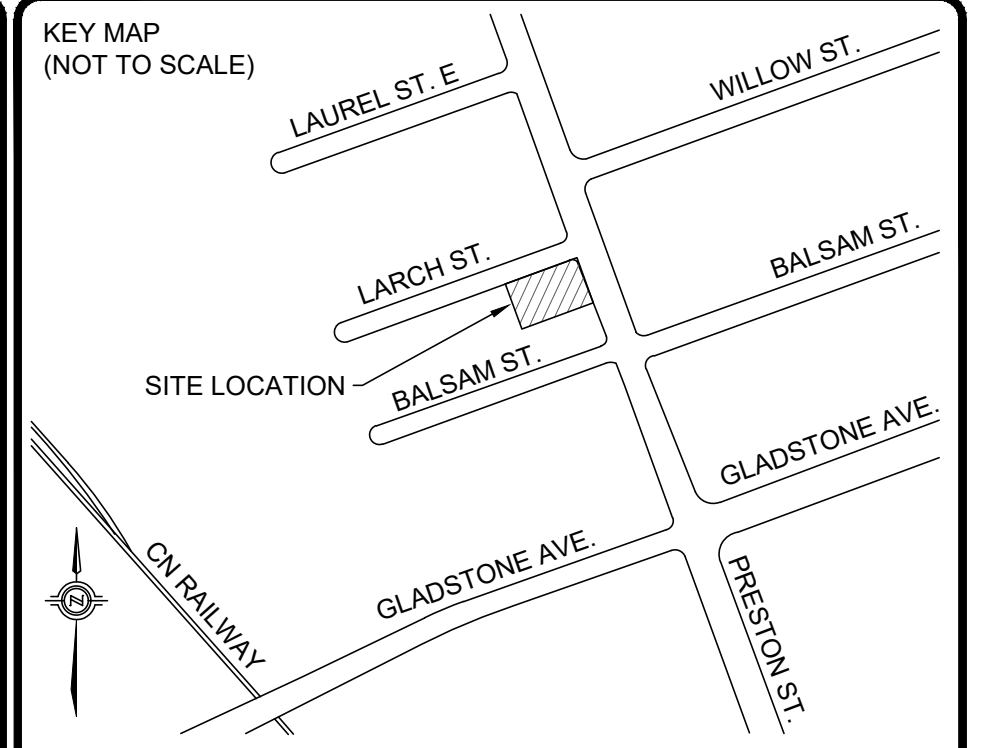

No.	REVISIONS	Date	By	App.
3	RE-ISSUED PER CITY COMMENTS	FEB, 2024	Y.A.	B.T.
2	RE-ISSUED PER CITY COMMENTS	OCT, 2023	Y.A.	B.T.
1	ISSUED FOR SITE PLAN CONTROL APPROVAL	APR, 2023	Y.A.	C.C.

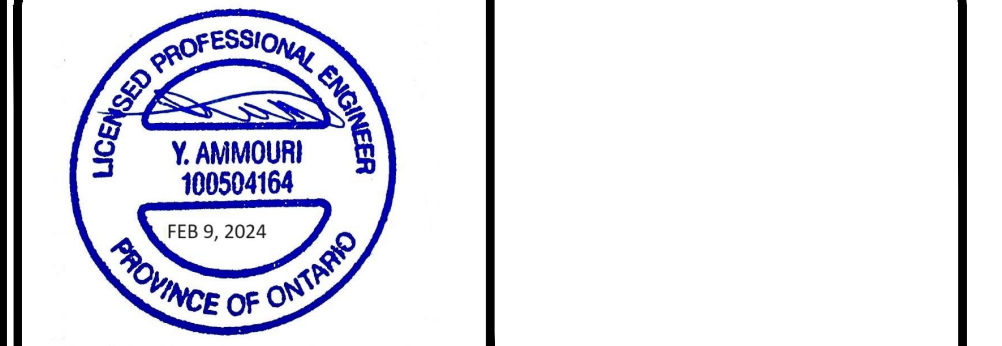

**exp Services Inc.**  
 t: +1.613.688.1899 | f: +1.613.225.7330  
 2650 Queensview Drive, Unit 100  
 Ottawa, ON K2B 8H6  
 Canada  
 www.exp.com

**exp.**

• BUILDINGS • EARTH & ENVIRONMENT • ENERGY •  
 • INDUSTRIAL • INFRASTRUCTURE • SUSTAINABILITY •

Owner/Client:  
**224 ON PRESTON INC.**

Location:  
**224 PRESTON STREET  
 OTTAWA, ONTARIO**

Title:  
**ROOF DRAINAGE PLAN**

Designed By: Y.A. | Drawn By: B.P. | Checked By: C.C.  
 Scale: NOT TO SCALE | Date: APR, 2023 | Drawing No.:  
 Project No.: OTT-22019695-AO

Area #	Number of Roof Drains	Roof Drain Model	Roof Drain Opening Setting	Controlled Flow per Drain L/s		Ponding Depth (mm)		Storage Volume (m3)		Max Available Storage m3
				5-Yr	100-Yr	5-Yr	100-Yr	5-Yr	100-Yr	
A1	1	Watts RD-100 with Accutrol ADJ	3-1/4 open	0.80	0.91	105	140	3.63	4.84	5.2
A2	1	Watts RD-100 with Accutrol ADJ	3-1/4 open	0.79	0.90	99	135	2.56	3.48	3.9
A3	1	Watts RD-100 with Accutrol ADJ	2-Closed	0.32	0.32	60	112	0.23	0.43	0.6
A4	1	Watts RD-100 with Accutrol ADJ	3-1/4 open	0.66	0.71	59	74	0.18	0.23	0.5
A5	1	Watts RD-100 with Accutrol ADJ	3-1/4 open	0.66	0.71	60	74	0.14	0.17	0.4
A6	2	Watts RD-100 with Accutrol ADJ	3-1/4 open	0.74	0.86	86	122	1.24	1.76	2.2
Total								7.98	10.92	12.6

DOT-12-23-0060 #18968