

DRAWING No. Erosion And Sediment Control FILE: E:\OTT\OTT-22019695-A0160 Execution\65 Drawings\22019695-04-C300.dwg

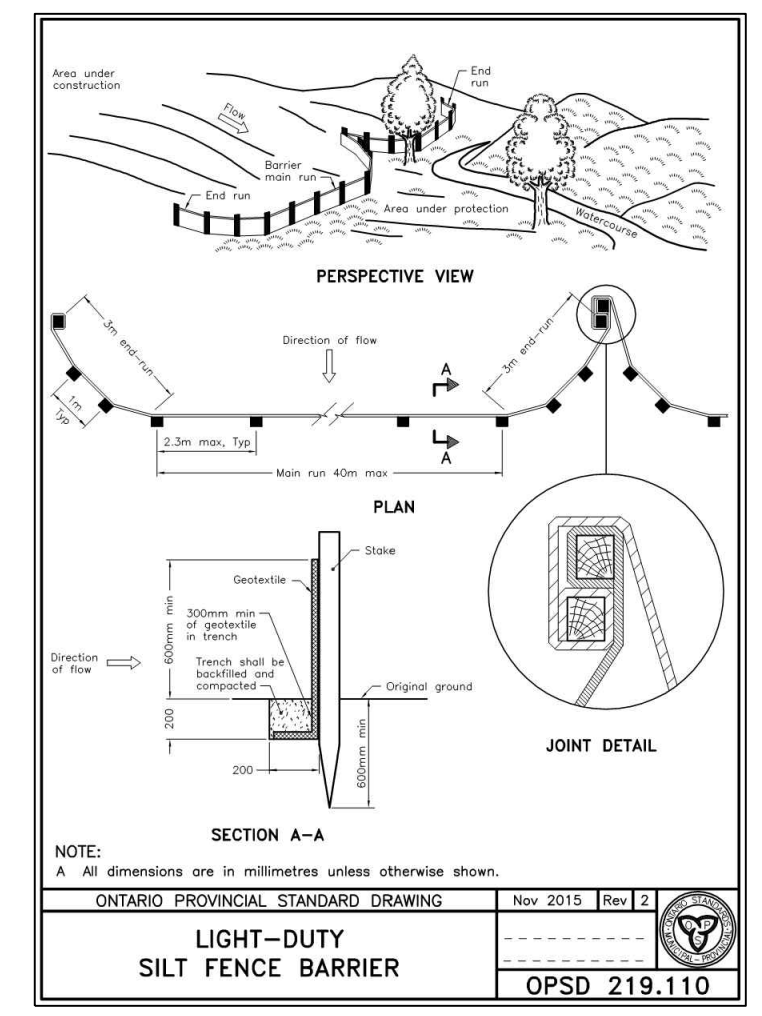

- NOTES:
1. WOVEN WIRE FENCE TO BE FASTENED SECURELY TO WOOD POSTS WITH WIRE TIES OR STAPLES.
 2. POSTS TO BE SPACED AT 2.3 METRES CENTRE TO CENTRE.
 3. WHEN TWO SECTIONS OF FILTER CLOTH ADJOIN EACH OTHER THEY SHALL BE OVERLAPPED BY A MINIMUM OF 500mm.
 4. MAINTENANCE SHALL BE PERFORMED AS NEEDED AND MATERIAL REMOVED WHEN "BULGES" DEVELOP IN THE SILT FENCE.
 5. WOOD POSTS TO BE HARDWOOD TYPE (50mm x 50mm).
 6. GEOTEXTILE TO BE EMBEDDED 200mm INTO GROUND.
 7. GEOTEXTILE TO CONFORM TO OPSS 805 STANDARDS.
 8. SILT FENCE MUST BE INSTALLED BEFORE COMMENCEMENT OF CONSTRUCTION AND IN ACCORDANCE WITH DETAIL. SILT FENCE CAN BE REMOVED AFTER LANDSCAPING IS COMPLETE.
 9. SEDIMENTS MUST BE CLEARED AWAY WHEN THEY REACH HALF THE HEIGHT OF THE FENCE.

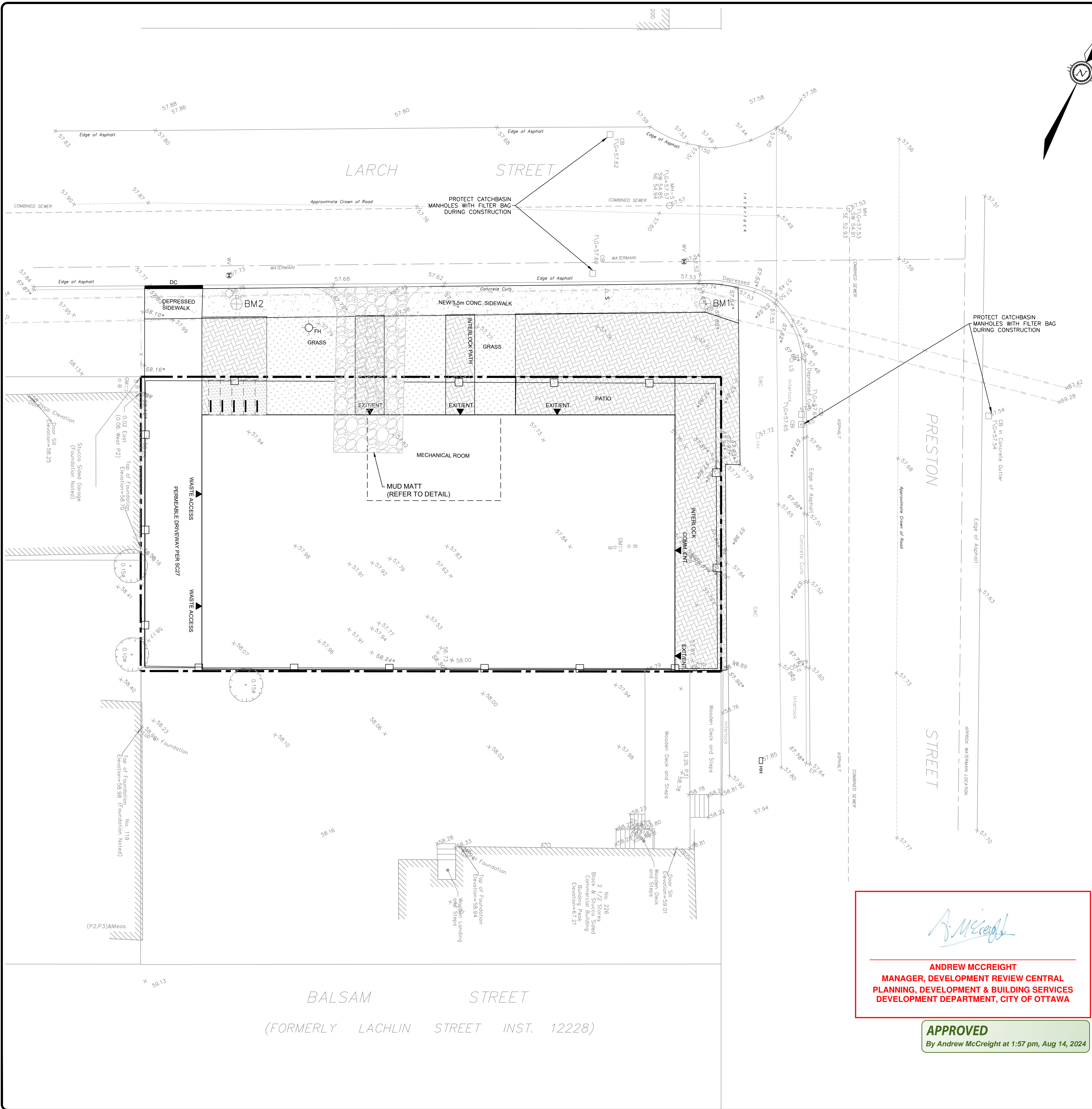
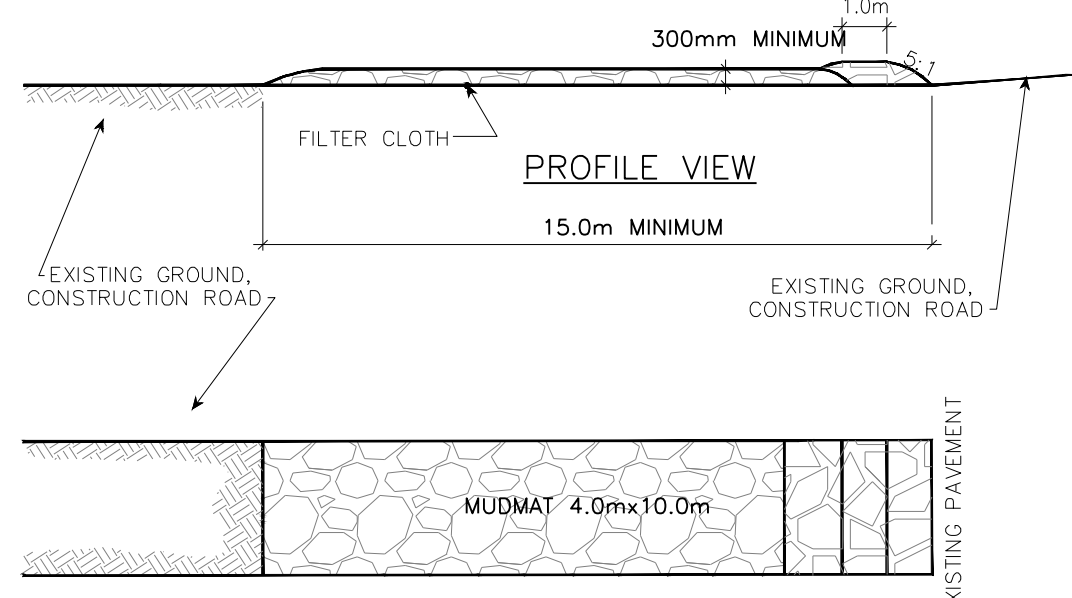

- NOTES:
1. STONE - USE CLEAR CRUSHED 100mm STONE.
 2. LENGTH - AS REQUIRED BUT NOT LESS THAN 15.0m.
 3. THICKNESS - NOT LESS THAN 300mm.
 4. WIDTH - 7.0m MINIMUM, NOT LESS THAN THE WIDTH AT POINTS WHERE INGRESS OR EGRESS OCCURS.
 5. FILTER CLOTH - WILL BE PLACED OVER THE ENTIRE AREA PRIOR TO PLACING STONE.
 6. MAINTENANCE - THE ENTRANCE SHALL BE MAINTAINED IN A CONDITION WHICH WILL PREVENT TRACKING OR FLOWING OF SEDIMENT ONTO PUBLIC RIGHT-OF-WAY. THIS MAY REQUIRED PERIODIC TOP DRESSING WITH ADDITIONAL STONE AS CONDITIONS DEMAND AND REPAIR AND/OR CLEAN OUT OF ANY MEASURES USED TO TRAP SEDIMENT. ALL SEDIMENT SPILLED, DROPPED OR TRACKED ONTO THE PUBLIC RIGHT-OF-WAY MUST BE REMOVED IMMEDIATELY.
 7. PERIODIC INSPECTION AND NEEDED MAINTENANCE SHALL BE PROVIDED AFTER EACH RAIN.

MUD MAT DETAIL
 N.T.S.

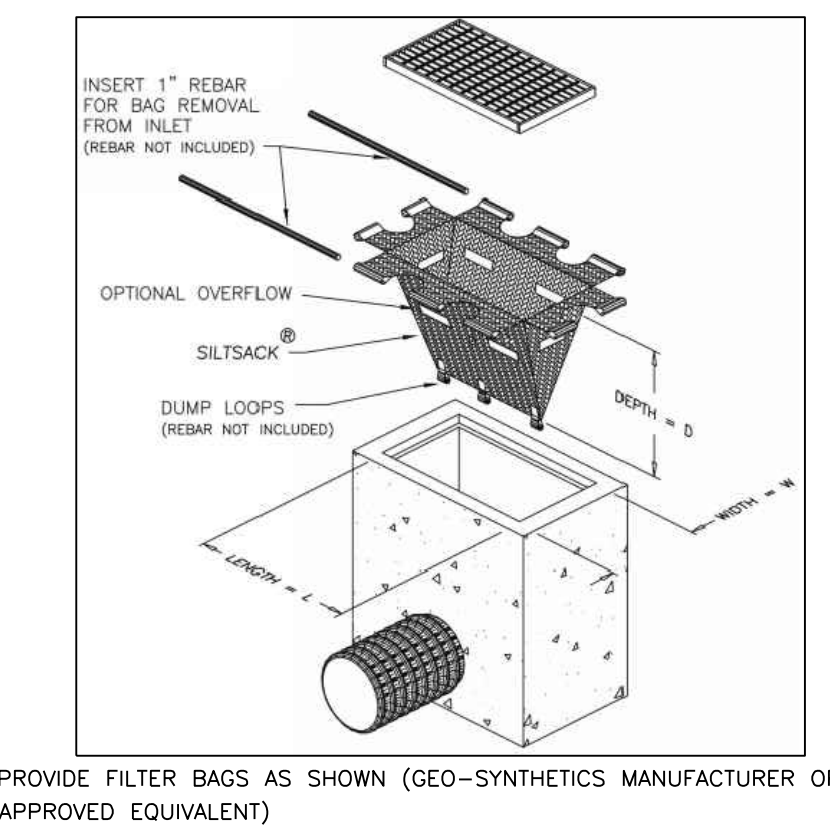

Andrew McCreight

ANDREW MCCREIGHT
MANAGER, DEVELOPMENT REVIEW CENTRAL
PLANNING, DEVELOPMENT & BUILDING SERVICES
DEVELOPMENT DEPARTMENT, CITY OF OTTAWA

APPROVED
 By Andrew McCreight at 1:57 pm, Aug 14, 2024

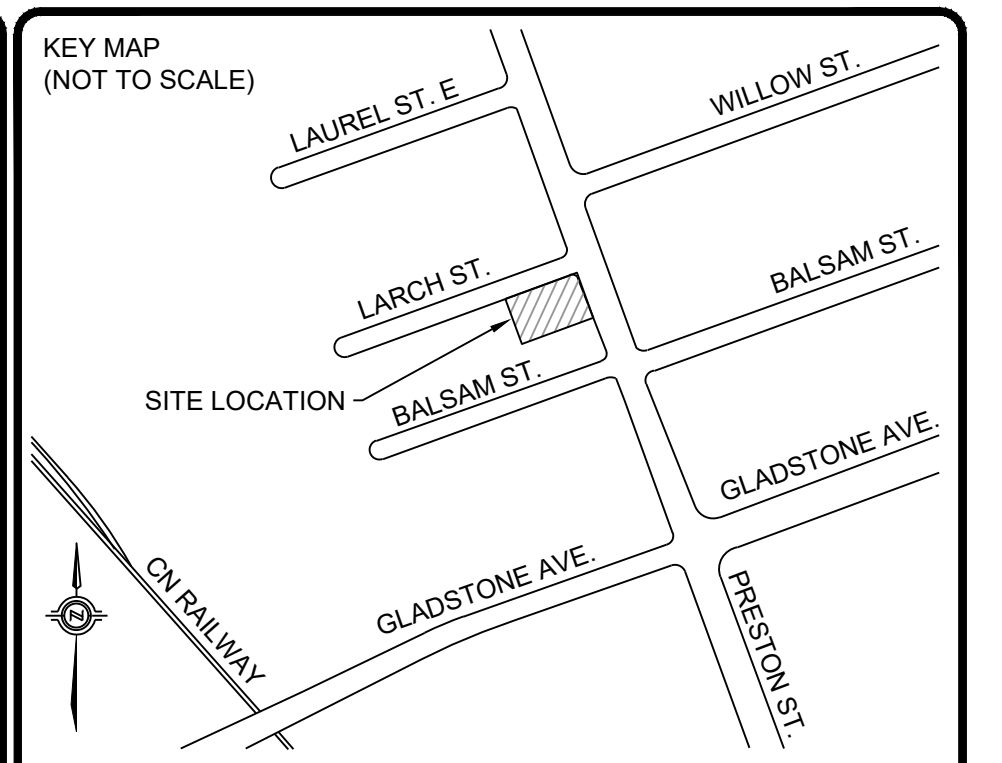

LEGEND

	PROPERTY LINE
	PROPOSED SILT FENCE
	EXISTING OVERHEAD UTILITY
	EXISTING LIGHT STANDARD
	EXISTING UTILITY POLE
	PROPOSED BUILDING ENTRANCE
	EXISTING WATER VALVE

No.	REVISIONS	Date	By	App.
3	RE-ISSUED PER CITY COMMENTS	FEB. 2024	Y.A.	B.T.
2	RE-ISSUED PER CITY COMMENTS	OCT. 2023	Y.A.	B.T.
1	ISSUED FOR SITE PLAN CONTROL APPROVAL	APR. 2023	Y.A.	Y.A.



exp Services Inc.
 t: +1 613 688 1899 | f: +1 613 225 7330
 2650 Queensview Drive, Unit 100
 Ottawa, ON K2B 8H6
 Canada
 www.exp.com



- BUILDINGS • EARTH & ENVIRONMENT • ENERGY •
- INDUSTRIAL • INFRASTRUCTURE • SUSTAINABILITY •

Owner/Client:
224 ON PRESTON INC.

Location:
224 PRESTON STREET
OTTAWA, ONTARIO

Title:
EROSION AND SEDIMENT CONTROL PLAN

Designed By: Y.A.	Drawn By: B.P.	Checked By: C.C.
Scale: 1:100	Date: APR. 2023	Drawing No.:
Project No.: OTT-22019695-AO		C300

DOT-12-23-0060 #18968