

EXISTING TREE LIST

KEY	BOTANICAL NAME	COMMON NAME	SIZE	CRITICAL ROOT ZONE	OWNERSHIP	CONDITION	ACTION
1-AF	<i>Acer x freemanii</i>	Freeman's Maple	90mm DBH	900mm	City of Ottawa	POOR	TO REMAIN
1-AN	<i>Acer negundo</i>	Manitoba Maple	90mm DBH	1500mm	226 Preston	GOOD	TO REMAIN
1-RC	<i>Rhamnus cathartica</i>	Common Buckthorn	150mm DBH	1000mm	119 Balsam	GOOD	TO REMAIN
1-SR	<i>Syringa reticulata</i>	Japanese Tree Lilac	900mm	900mm	119 Balsam	GOOD	TO REMAIN
1-UW	<i>Ulmus wilsoniana 'Prospector'</i>	Prospector Elm	110mm DBH	1100mm	City of Ottawa	POOR	TO REMAIN

PROPOSED PLANT LIST

KEY	QTY.	BOTANICAL NAME	COMMON NAME	SIZE	CONDITION	REMARKS
TREES						
JL	1	<i>Syringa reticulata</i>	Japanese Tree Lilac	60mm cal.	B&B	Single leader
SB	1	<i>Amelanchier canadensis</i>	Serviceberry	60mm cal.	B&B	Single leader
PERENNIALS AND ORNAMENTAL GRASSES						
BL	3	<i>Leymus arenarius 'Blue Dune'</i>	Blue Lyrne Grass	250mm pot.	Potted	Space 800mm o.c.
KF	5	<i>Calamagrostis acutiflora 'Karl Foerster'</i>	Karl Foerster Grass	250mm pot.	Potted	Space 800mm o.c.
MF	20	<i>Hemerocallis 'Moses Fire'</i>	Moses Fire Daylily	100mm pot.	Potted	Space 400mm o.c.
OD	5	<i>Calamagrostis acutiflora 'Overdam'</i>	Overdam Grass	250mm pot.	Potted	Space 800mm o.c.
PD	14	<i>Hemerocallis 'Purple D'Oro'</i>	Purple D'Oro Daylily	100mm pot.	Potted	Space 400mm o.c.
SD	10	<i>Hemerocallis 'Stella D'Oro'</i>	Stella D'Oro Daylily	100mm pot.	Potted	Space 400mm o.c.

GENERAL NOTES:

- It is the responsibility of the appropriate contractor or official to report any errors, omissions or discrepancies on this plan with actual site conditions to the Landscape Architect before proceeding with construction.
- The contractor is to notify all utility companies and authorities prior to any excavation and ascertain locations of underground services.
- The contractor is to reinstate all areas and items damaged as a result of construction activity.
- The contractor is to comply with all pertinent codes and by-laws.
- The contractor is to maintain a positive surface run-off throughout the entire construction period.
- The Landscape Architect is not responsible for subsurface conditions.
- The contractor is to identify all existing trees to remain on site with the Landscape Architect prior to construction.
- The contractor is to stake the proposed location of all plant material in conjunction with the Landscape Architect prior to excavation.
- Minimum distances for selected deciduous trees are as follows:
 - Building Foundations 7.5m
 - Sidewalks 1.5m
 - Public Streets 2.5m
 - Underground Infrastructure 2.0m
- All trees within 1m of underground utility trenches are to be excavated by hand.
- Remove all protective wrapping from tree trunks after installation.
- Staking of trees shall only be performed if necessary.
- Ensure that mulch is pulled back a min. distance of 75mm from base of tree trunk.

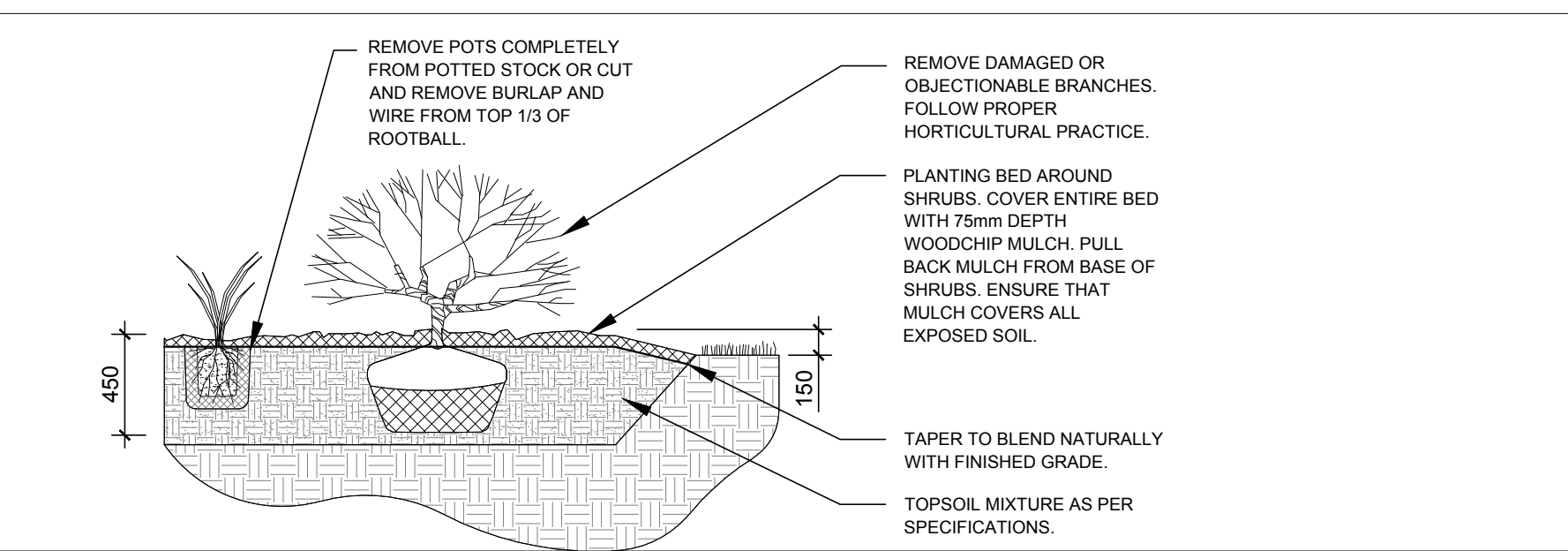

2 ORNAMENTAL GRASS / PERENNIAL PLANTING
SCALE: NTS

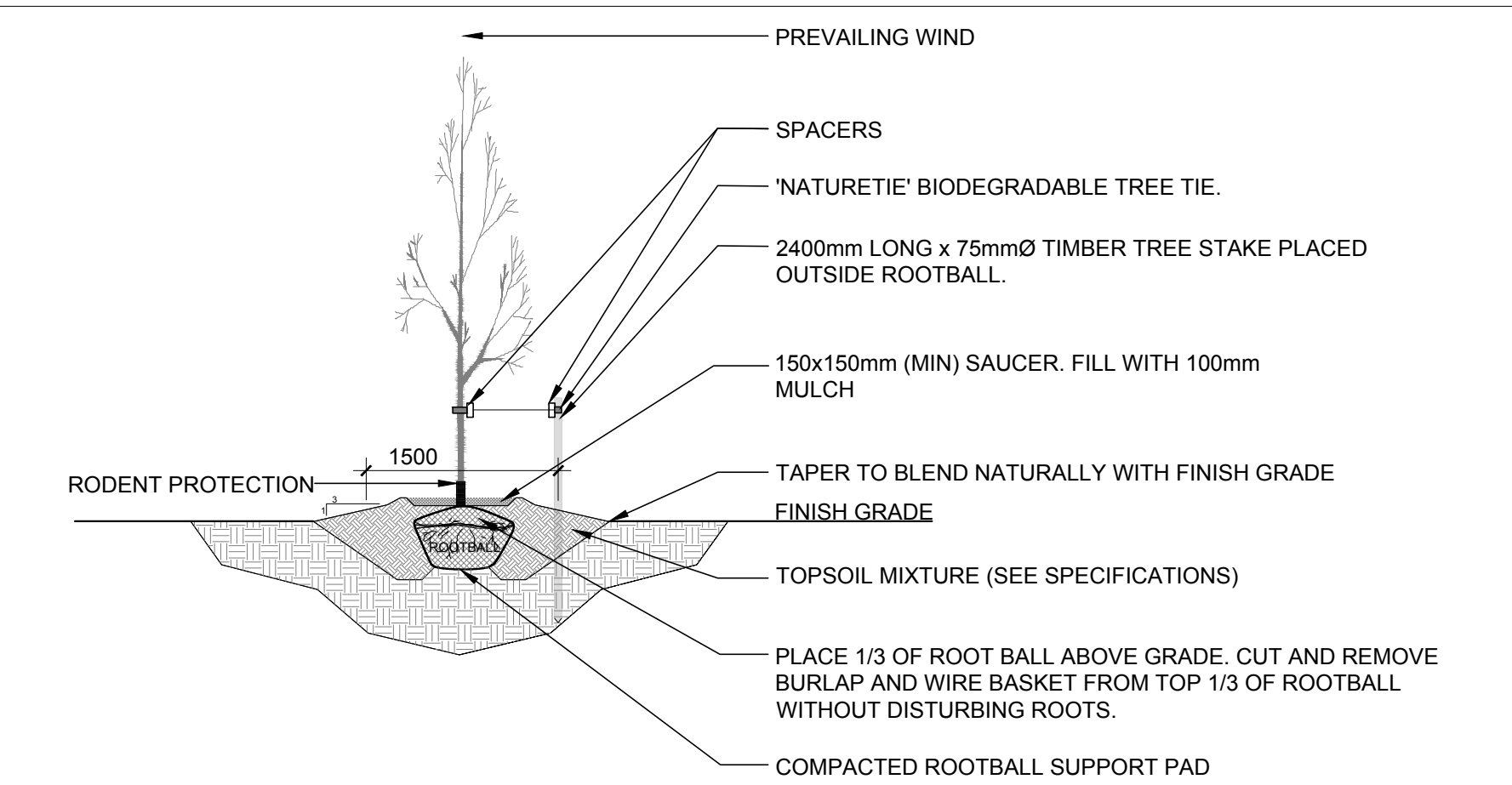

3 DECIDUOUS TREE PLANTING
SCALE: NTS

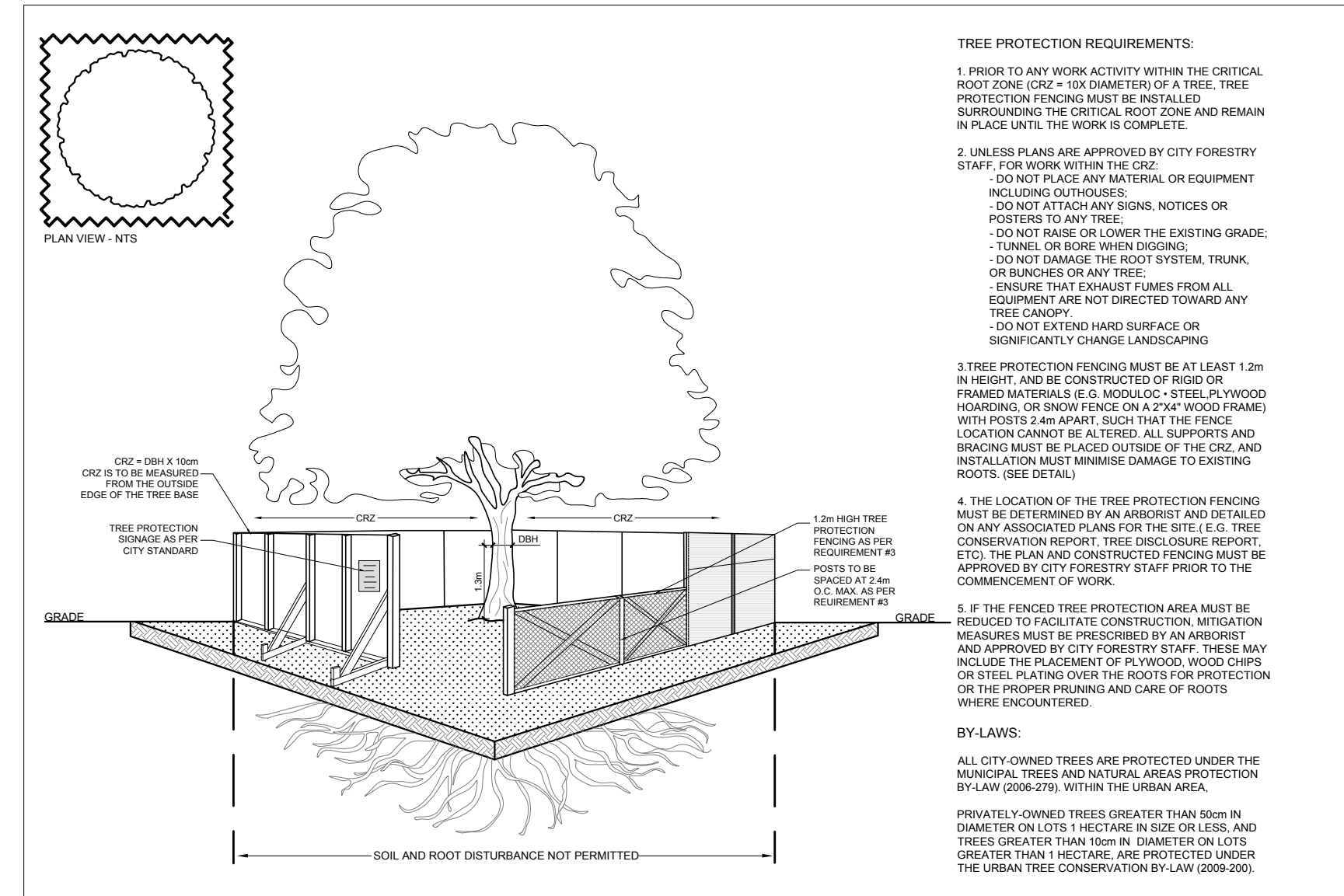

4 TREE PROTECTION FENCE
SCALE: NTS

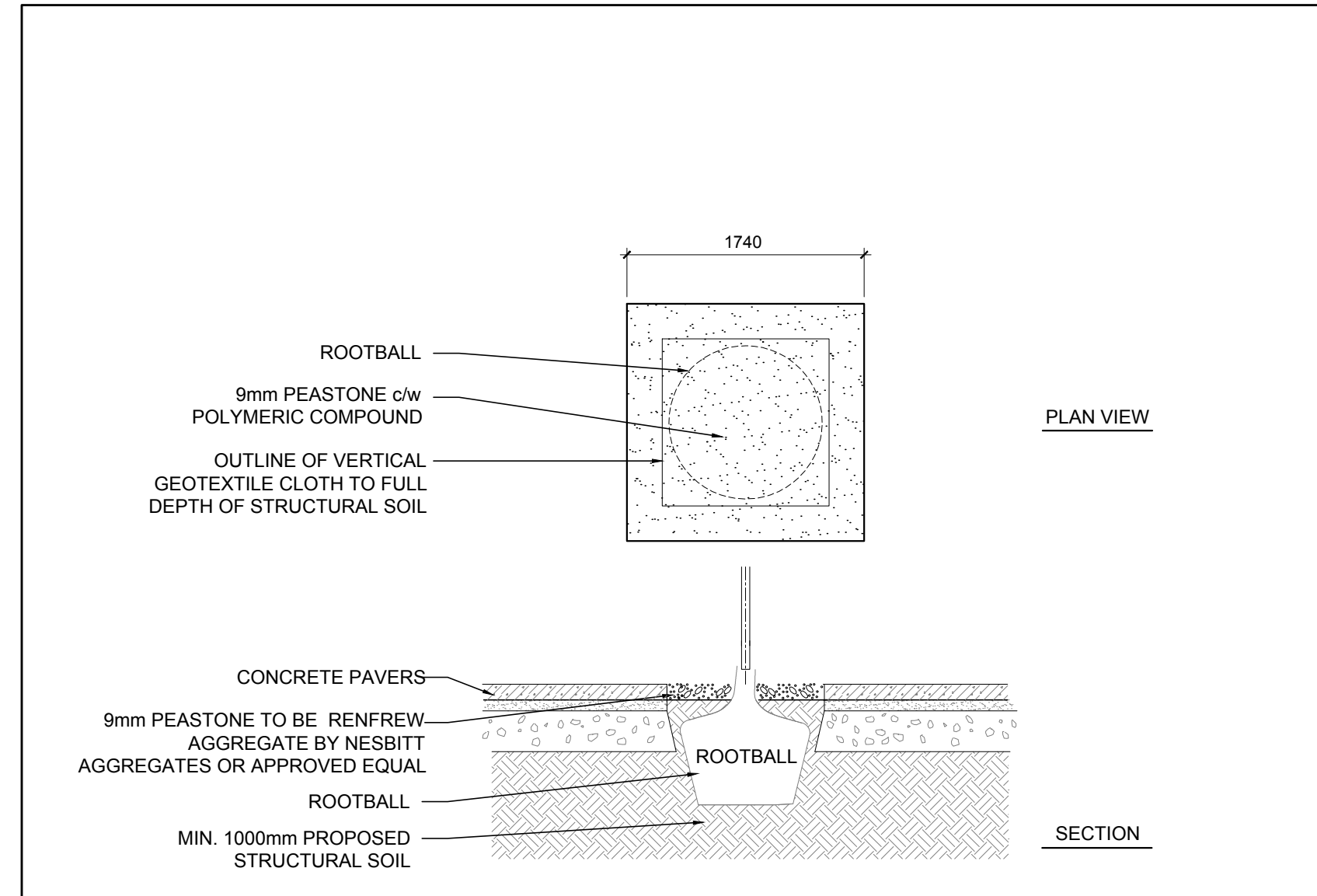

5 DECIDUOUS TREE PLANTING DETAIL IN STRUCTURAL SOIL
SCALE: NTS

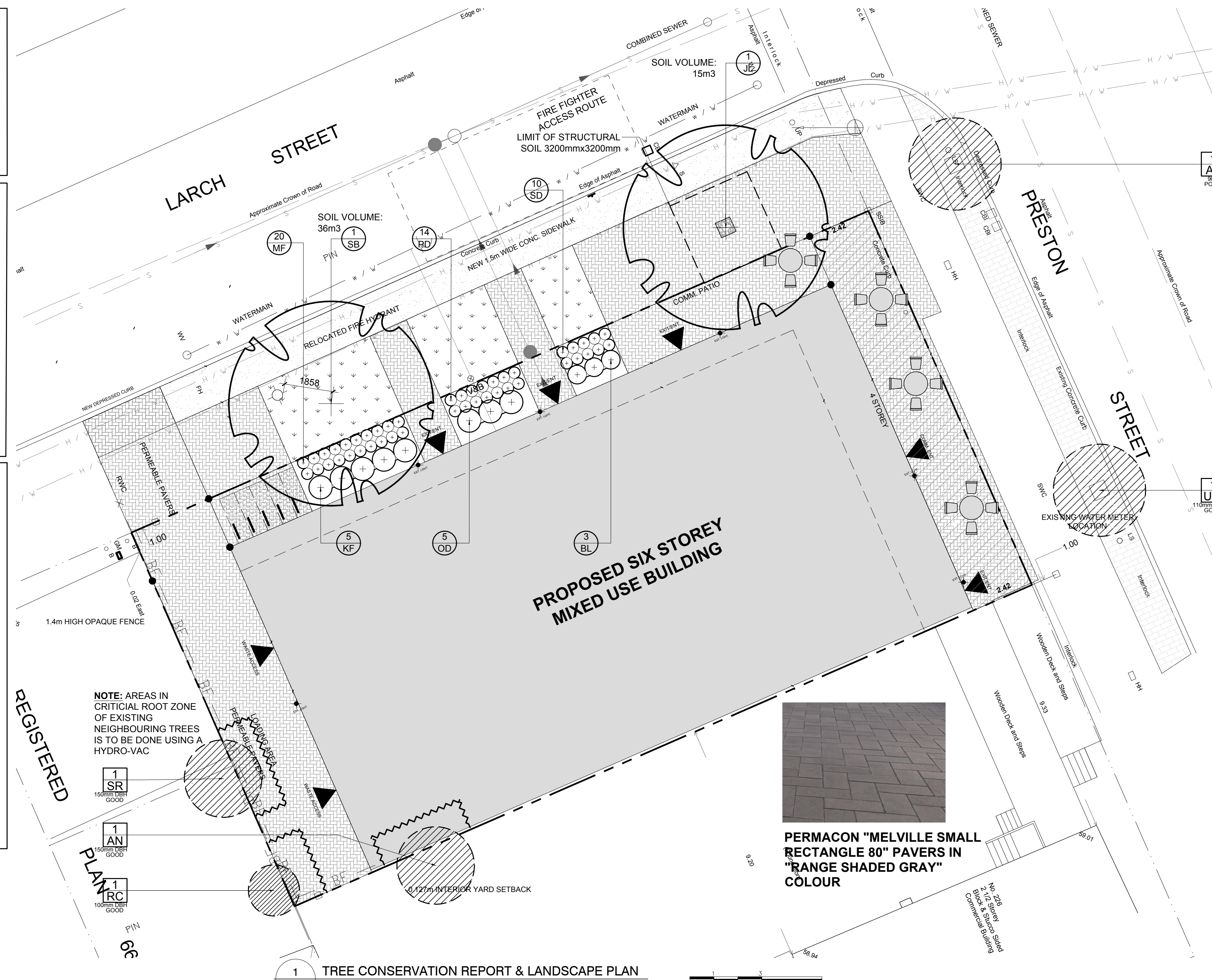

1 TREE CONSERVATION REPORT & LANDSCAPE PLAN
SCALE 1:100

CLIENT:
224 ON PRESTON INC.

CONSULTANTS
ARCHITECTS:
RAI REDLINE ARCHITECTURE

SURVEYORS:
ANNIS, O'SULLIVAN, VOLLEBECK LTD.
14 Concourse Gate, Suite 505
Nepean, Ont. K2E 7S6
Phone: (613) 727-0850 Fax: (613) 727-1079
Email: neaen@annis.com

CIVIL ENGINEERS:
exp Services Inc.
E +1 813 888-1899 | E +1 613 225-7330
2650 Queensview Drive, Unit 100
Ottawa, ON K2B 9H6
Canada
www.exp.com

LEGEND

- EXISTING TREE TO REMAIN
- EXISTING PRECAST CONCRETE PAVERS TO REMAIN
- PROPOSED DECIDUOUS TREE
- PROPOSED PERENNIALS / ORNAMENTAL GRASSES
- PROPOSED SOD
- PROPOSED PERMACON "MELVILLE SMALL RECTANGLE 80" PAVERS IN "RANGE SHADED GRAY" COLOUR
- TREE PROTECTION FENCE
- PROPOSED TABLE WITH CHAIRS

No.	Issue	Date	DR	CK
4	REVISED PER CITY COMMENTS	01/30/2024	ML	JL
3	REVISED PER CITY COMMENTS	08/08/2023	ML	JL
2	REVISED PER NEW SITE PLAN	03/15/2023	ML	JL
1	ISSUED FOR DISCUSSION & REVIEW	11/16/2022	ML	JL

JAMES B. LENNOX & ASSOCIATES INC.
LANDSCAPE ARCHITECTS
3332 CARLING AVE. OTTAWA, ONTARIO K2H 5A8
TEL: (613) 722-5168 FAX: (866) 343-3942

PROJECT
PROPOSED SIX STOREY MIXED USE BUILDING
224 PRESTON STREET, OTTAWA ON

DRAWING
TREE CONSERVATION REPORT & LANDSCAPE PLAN

STAMP

SCALE
AS SHOWN

START DATE
NOVEMBER 2022

PROJECT NO.
23MIS2308

PROJECT NORTH

DRAWING NO.
L.1

PLOT SIZE ARCH-D