

LEGEND

- PROPERTY LINE
- POST-DEVELOPMENT DRAINAGE AREA (ha)
- POST-DEVELOPMENT AREA ID
- 1.5 YEAR WEIGHTED RUNOFF COEFFICIENT
- DRAINAGE AREA LIMITS
- MAXIMUM 3:1 SIDESLOPE
- EMERGENCY OVERLAND FLOW ROUTE
- PROPOSED BUILDING ENTRANCE
- PROPOSED SILT FENCING (OPSD 219.110)
- PROPOSED CATCHBASIN MANHOLE & STORM SEWER
- PROPOSED STORM MANHOLE & SEWER
- PROPOSED CATCHBASIN C/W LEAD
- PROPOSED BARRIER CURB
- DEPRESSED BARRIER CURB
- PROPOSED FINISHED FLOOR ELEVATION
- PROPOSED UNDERSIDE OF FOOTING ELEVATION
- PROPOSED SITE LIGHTING (REFER TO ELEC)
- APPROXIMATE PONDING LIMITS
- PROPOSED TWSI
- EXISTING CONCRETE CURB
- EXISTING CATCHBASIN MANHOLE
- EXISTING STORM MANHOLE
- EXISTING CATCHBASIN
- EXISTING HYDRANT & VALVE
- EXISTING TREES / VEGETATION
- EXISTING FENCE
- EXISTING LIGHT STANDARD

- GENERAL NOTES:**
- COORDINATE AND SCHEDULE ALL WORK WITH OTHER TRADES AND CONTRACTORS.
 - DETERMINE THE EXACT LOCATION, SIZE, MATERIAL AND ELEVATION OF ALL EXISTING UTILITIES PRIOR TO COMMENCING CONSTRUCTION. PROTECT AND ASSUME RESPONSIBILITY FOR ALL EXISTING UTILITIES WHETHER OR NOT SHOWN ON THIS DRAWING.
 - ALL ELEVATIONS ARE GEODETIC.
 - REFER TO GEOTECHNICAL REPORT (NO. 02211293.000, DATED MAY 10, 2023), PREPARED BY ENGBLOBE CORP., FOR SUBSURFACE CONDITIONS, CONSTRUCTION RECOMMENDATIONS, AND GEOTECHNICAL INSPECTION REQUIREMENTS. THE GEOTECHNICAL CONSULTANT IS TO REVIEW ON-SITE CONDITIONS AFTER EXCAVATION PRIOR TO PLACEMENT OF THE GRANULAR MATERIAL.
 - REFER TO THE DEVELOPMENT SERVICING STUDY & STORMWATER MANAGEMENT REPORT (R-2023-014) PREPARED BY NOVATECH.

- BENCHMARK NOTES:**
- ELEVATIONS SHOWN ON THIS PLAN ARE RELATED TO GEODETIC DATUM (CGVD2878) AND ARE DERIVED FROM PUBLISHED CONTROL MONUMENT 00119883075 HAVING A PUBLISHED ELEVATION OF 90.612 METRES.
 - IT IS THE RESPONSIBILITY OF THE USER OF THIS INFORMATION TO VERIFY THAT THE SITE BENCHMARK HAS NOT BEEN ALTERED OR DISTURBED AND THAT ITS RELATIVE ELEVATION AND DESCRIPTION AGREES WITH THE INFORMATION SHOWN ON THIS DRAWING.
 - BENCHMARK WAS PROVIDED ON PLAN OF SURVEY SHOWING TOPOGRAPHIC DETAIL OF PART OF BLOCK 2, REGISTERED PLAN 4M-1012, CITY OF OTTAWA, SURVEYED BY J.D. BARNES LIMITED.

ICD TABLE (AREAS A-1a TO A-1h, R-1 & R-2)

DESIGN EVENT	TYPE OF ICD	DIAMETER OF OUTLET PIPE (mm)	DESIGN FLOW (L/s)	DESIGN HEAD (m)	PONDING ELEV. (m)	VOLUME (m ³)
1.2 YR	TEMPEST MHF VORTEX 106mm	300	29.9	2.06	94.80	79
1.5 YR			28.8	2.15	94.89	147
1.100 YR			24.8	2.36	95.10	336

SITE FLOWS & STORMWATER MANAGEMENT TABLE

DESIGN EVENT	PRE-DEVELOPMENT CONDITIONS		POST-DEVELOPMENT CONDITIONS			
	UNCONTROLLED FLOW (L/s)	ALLOWABLE RELEASE RATE (L/s)	A-0a & A-0b DIRECT RUNOFF (L/s)	A-1a TO A-1h, R-1 & R-2 FLOW (L/s)	TOTAL FLOW (L/s)	REDUCTION IN FLOW (L/s or %)
1.2 YR	34.7	40.7	5.7	29.9	35.7	-1.0 or -3%
1.5 YR	47.1		7.8	28.8	36.6	10.5 or 22%
1.100 YR	100.9		15.5	24.8	40.3	60.6 or 60%

* REDUCED FLOW COMPARED TO PRE-DEVELOPMENT UNCONTROLLED CONDITIONS

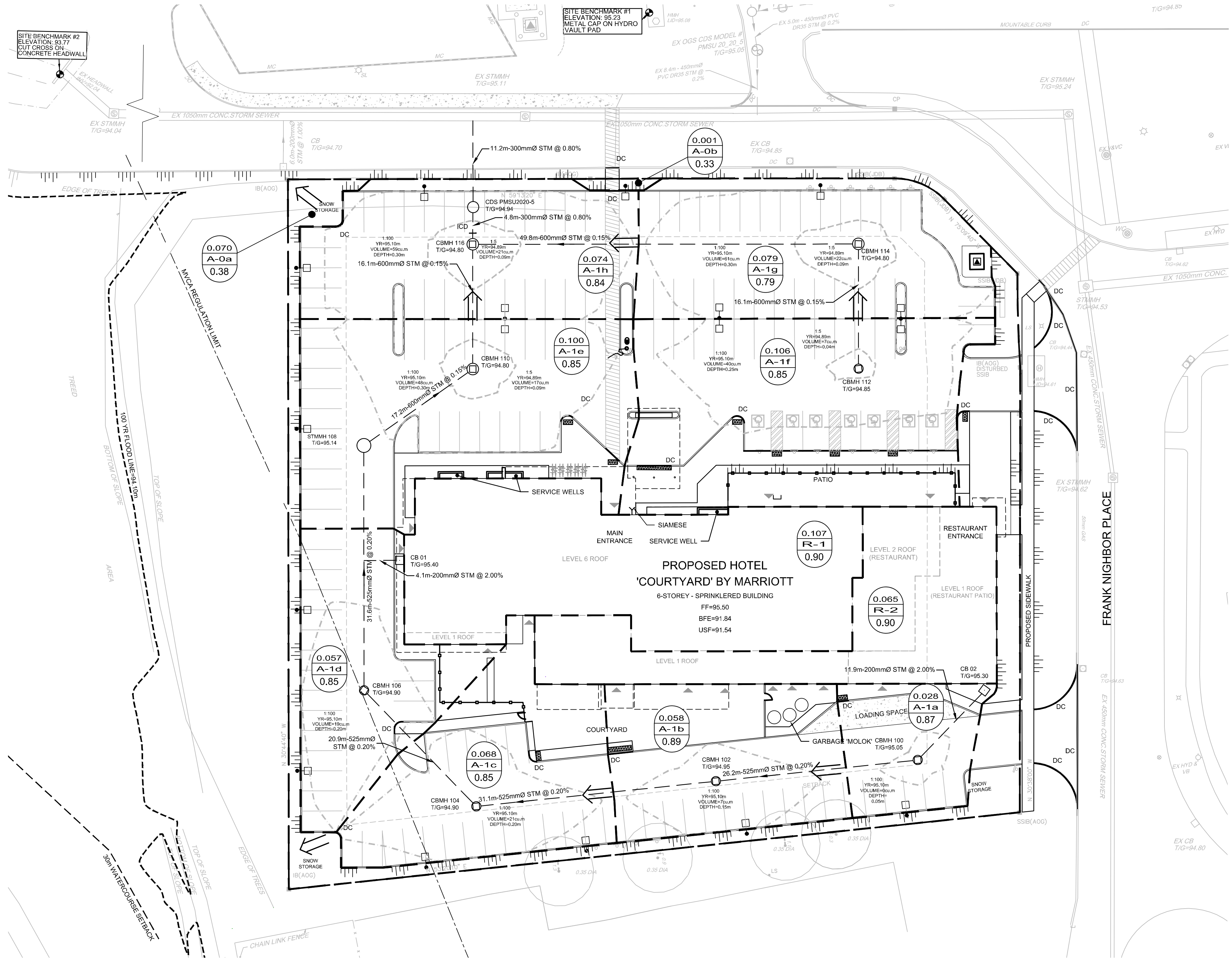

NOTE:
THE POSITION OF ALL POLE LINES, CONDUITS, WATERMANS, SEWERS AND OTHER UNDERGROUND AND OVERGROUND UTILITIES AND STRUCTURES IS NOT NECESSARILY SHOWN ON THE CONTRACT DRAWINGS, AND WHERE SHOWN, THE ACCURACY OF THE POSITION OF SUCH UTILITIES AND STRUCTURES IS NOT GUARANTEED. BEFORE STARTING WORK, DETERMINE THE EXACT LOCATION OF ALL SUCH UTILITIES AND STRUCTURES AND ASSUME ALL LIABILITY FOR DAMAGE TO THEM.

OWNER INFORMATION
401 REAL ESTATE TRUST INC.
2225 EAGLE STREET N.
CAMBRIDGE, ONTARIO, N3H 4R7
TED LANCASTER
PHONE: (705) 816-6355
ted.lancaster@401auto.ca

SCALE: 1:300

1 ISSUED FOR SITE PLAN CONTROL APPROVAL MAY 11/23 FST

No.	REVISION	DATE	BY
1	ISSUED FOR SITE PLAN CONTROL APPROVAL	MAY 11/23	FST

FOR REVIEW ONLY

DESIGN: ZA
CHECKED: FST
DRAWN: ZA
CHECKED: CV
APPROVED: FST

PROFESSIONAL ENGINEER
F.S. THAUVETTE
100041299
MAY 11, 2023
PROVINCE OF ONTARIO

NOVATECH
Engineers, Planners & Landscape Architects
Suite 200, 240 Michael Cowpland Drive
Ottawa, Ontario, Canada K2M 1P6
Telephone: (613) 254-9643
Facsimile: (613) 254-5867
Website: www.novatech-eng.com

LOCATION
CITY OF OTTAWA
40 FRANK NIGHBOR PLACE

DRAWING NAME
POST-DEVELOPMENT STORM DRAINAGE AREA PLAN

PROJECT No. 123002
REV #1
DRAWING No. 123002-STM2

M:\2023\123002\CAD\CH1\123002-STM2.dwg, STWZ, May 11, 2023, 1:10pm, aal