

LEGEND

- PROPERTY LINE
- - - EXISTING BOTTOM OF SLOPE
- EXISTING TOP OF SLOPE
- - - EXISTING CENTER LINE OF DITCH
- EXISTING GATE
- - - EXISTING CHAIN LINK FENCE
- - - EXISTING OVERHEAD HYDRO LINE
- EXISTING UTILITY POLE
- PROPOSED SLOPE MAX. 3:1
- X 100.00 PROPOSED GRADES
- PROPOSED DRAINAGE PATTERN
- AREA A PROPOSED SOIL DUMP AREA
- PROPOSED LANDSCAPING (GRASS)
- PROPOSED 50mm DIA. CLEAR STONE

EROSION AND SEDIMENT CONTROL NOTE:

- PROVIDE TEMPORARY EROSION CONTROL BLANKET ON PROPOSED SLOPES GREATER THAN 7% UNTIL SUFFICIENT LANDSCAPE COVER HAS BEEN ESTABLISHED.
- THE PRODUCT SHOULD BE RATED FOR SLOPES UP TO 3H:1V.
- ADDITIONAL EROSION AND SEDIMENT CONTROL MEASURES TO BE PROVIDED AS PER DRAWING C300.

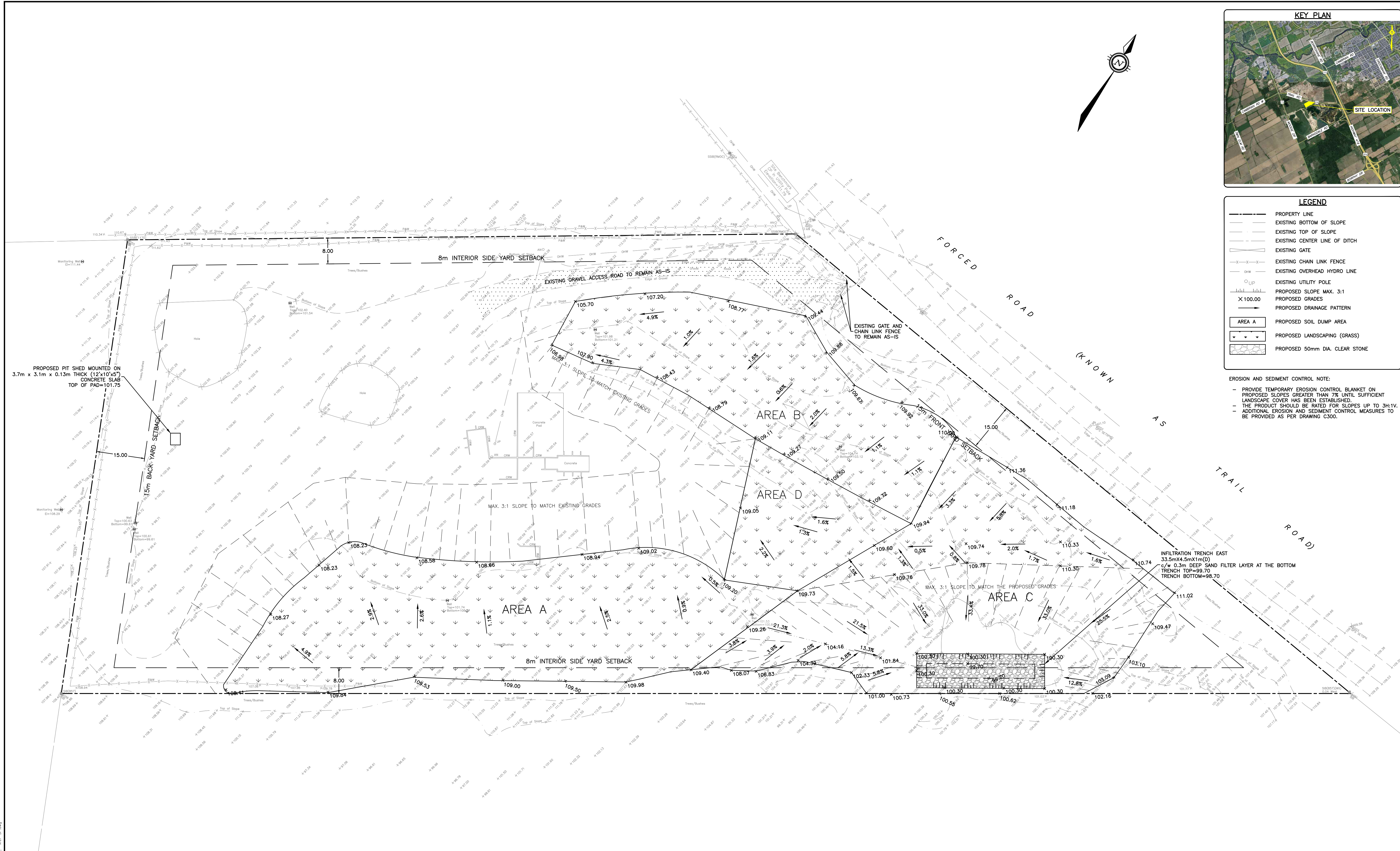

CAUTION
 THE POSITION OF ALL POLE LINES, CONDUITS, WATERMANS, SEWERS AND OTHER UNDERGROUND AND OVERGROUND UTILITIES AND STRUCTURES IS NOT NECESSARILY SHOWN ON THE CONTRACT DRAWINGS, AND WHERE SHOWN, THE ACCURACY OF THE POSITION OF SUCH UTILITIES AND STRUCTURES IS NOT GUARANTEED. BEFORE STARTING WORK, DETERMINE THE EXACT LOCATION OF ALL SUCH UTILITIES AND STRUCTURES AND ASSUME ALL LIABILITY FOR DAMAGE TO THEM.

NOT FOR CONSTRUCTION

REV	REVISION DESCRIPTION	DATE	BY	APPD
2	ISSUED FOR SPA	23/06/23	AJ	AA
1	ISSUED FOR CLIENT REVIEW	20/10/22	AJ	AA

SCALE
 0 5m 10m 20m
 HORIZONTAL 1:500

DESIGNED BY

REVIEWED BY

exp.

exp Services Inc.
 1-813-688-1899 | 1-613-225-7330
 3025 Casselman Drive, Unit 100
 Ottawa, ON K2B 8H6
 Canada
 www.exp.com
 • BUILDINGS • EARTH & ENVIRONMENT • ENERGY •
 • INDUSTRIAL • INFRASTRUCTURE • SUSTAINABILITY •

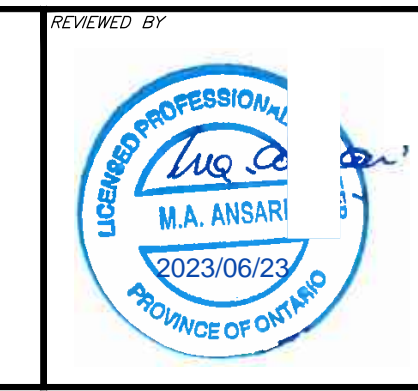

CLIENT
DRAIN-ALL LTD
 3385 HAWTHORNE ROAD, OTTAWA, ON.
 K1G 4G2 613.739.1070

PROJECT
 ENGINEERING SERVICES FOR
 4380 TRAIL ROAD,
 OTTAWA, ONTARIO.

TITLE
 SITE GRADING AND EROSION
 CONTROL PLAN AREA C & D

PROJECT No.	OTT-21023795-AG
SURVEY	FSD
DATE	27/04/2022
DRAWING No.	C200-3