

LEGEND

- PROPERTY LINE
- - - EXISTING BOTTOM OF SLOPE
- - - EXISTING TOP OF SLOPE
- - - EXISTING CENTER LINE OF DITCH
- - - EXISTING GATE
- - - EXISTING CHAIN LINK FENCE
- - - EXISTING OVERHEAD HYDRO LINE
- - - EXISTING UTILITY POLE
- AN UTILITY POLE ANCHOR
- MW EXISTING MONITORING WELL
- E EXISTING ELEVATIONS
- ▨ EXISTING GRAVEL ACCESS ROAD
- ▨ PROPOSED SLOPE MAX. 3:1 C/W EROSION CONTROL BLANKET
- ×100.00 PROPOSED GRADES
- 2% PROPOSED DRAINAGE PATTERN
- ▨ AREA A PROPOSED SOIL DUMP AREA
- ▨ PROPOSED LANDSCAPING (GRASS)
- - - PROPOSED BOTTOM OF SLOPE
- T PROPOSED TEMPORARY LIGHT-DUTY SILT FENCE

EROSION AND SEDIMENT CONTROL NOTE:

- PROVIDE TEMPORARY EROSION CONTROL BLANKETS AT ALL TIMES ON SLOPES GREATER THAN 7% UNTIL SUFFICIENT LANDSCAPE COVER HAS BEEN ESTABLISHED.
- THE PRODUCT SHOULD BE RATED FOR SLOPES UP TO OR STEEPER THAN 3H:1V. PRODUCT SHALL BE TERRAFIX™ - DOUBLE NET S200 OR APPROVED EQUIVALENT
- ADDITIONAL EROSION AND SEDIMENT CONTROL MEASURES TO BE PROVIDED AS PER DRAWING C300.

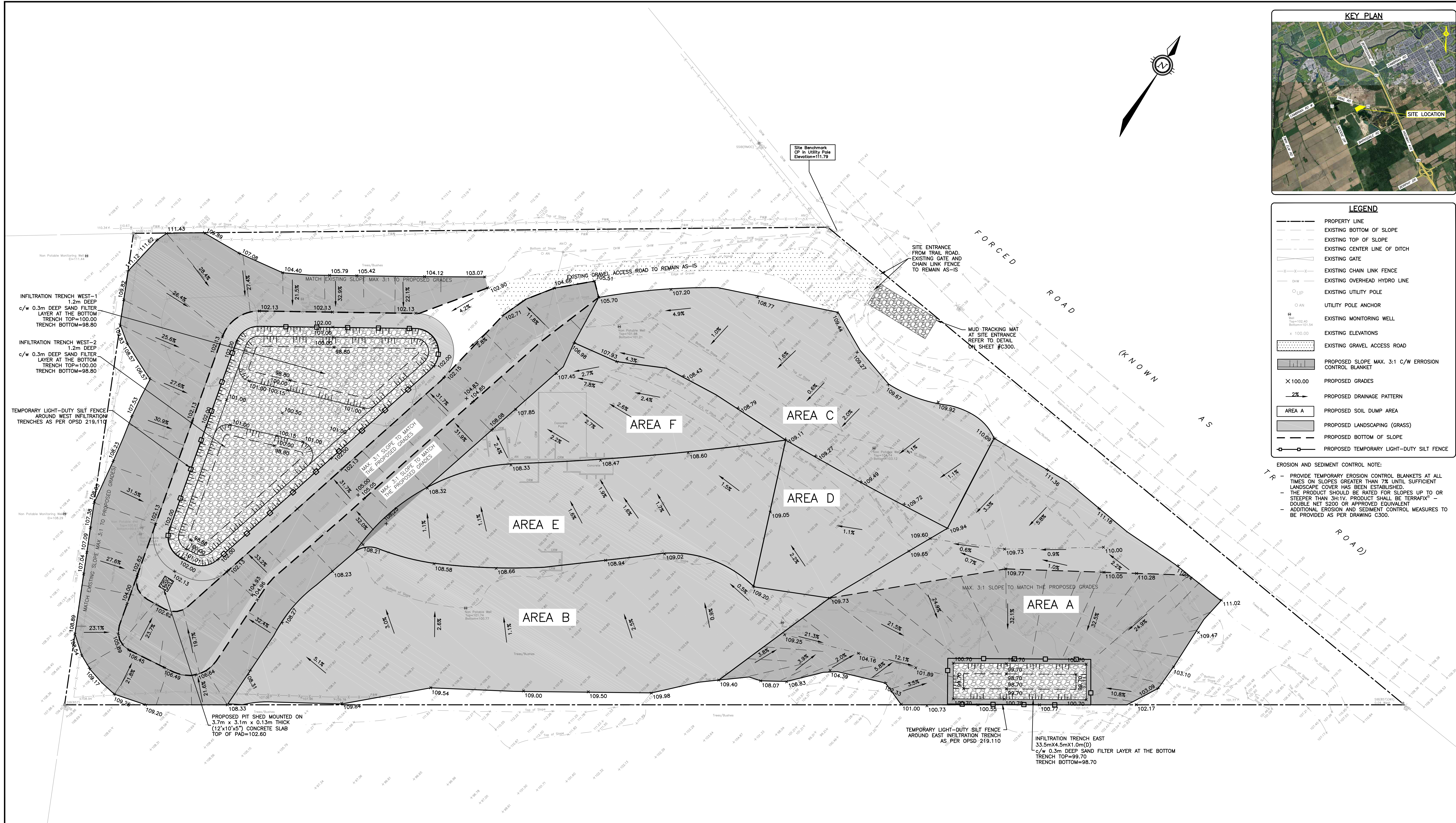

NOT FOR CONSTRUCTION

CAUTION
THE POSITION OF ALL POLE LINES, CONDUITS, WATERMANS, SEWERS AND OTHER UNDERGROUND AND OVERGROUND UTILITIES AND STRUCTURES IS NOT NECESSARILY SHOWN ON THE CONTRACT DRAWINGS, AND WHERE SHOWN, THE ACCURACY OF THE POSITION OF SUCH UTILITIES AND STRUCTURES IS NOT GUARANTEED. BEFORE STARTING WORK, DETERMINE THE EXACT LOCATION OF ALL SUCH UTILITIES AND STRUCTURES AND ASSUME ALL LIABILITY FOR DAMAGE TO THEM.

JOB BENCH MARK
CP IN UTILITY POLE ELEVATION = 111.79

TOPOGRAPHIC INFORMATION
PART OF LOT 8, CONCESSION 4 (RIDEAU FRONT), GEOGRAPHIC TOWNSHIP OF NEPEAN, CITY OF OTTAWA.

Bearing Note
Bearings hereon are grid bearings derived from the Can-Net Real Time Network and are referred to the Central Meridian of MTM Zone 9 (76°30' West Longitude) Nad-83 (Original).

Elevation Notes
Elevations shown are geodetic and are referred to Geodetic Datum CGVD-1928:1978. (Monument No. 1977066)

| REV | REVISION DESCRIPTION | DATE | BY | APPD |
|-----|--------------------------|----------|-----|------|
| 3 | RE-ISSUED FOR SPA | 19/12/23 | AGJ | AA |
| 2 | ISSUED FOR SPA | 23/06/23 | AJ | AA |
| 1 | ISSUED FOR CLIENT REVIEW | 20/10/22 | AJ | AA |

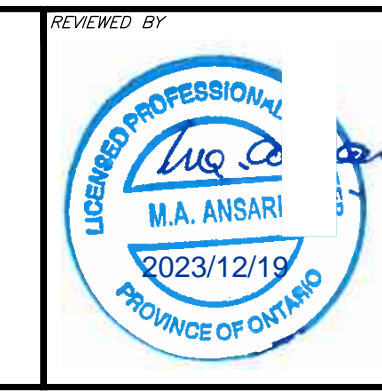
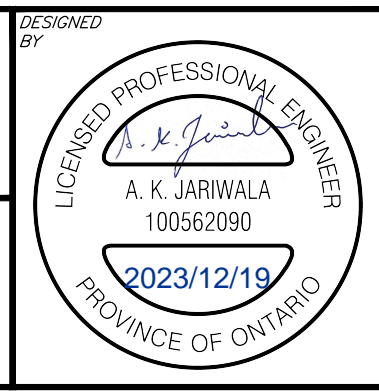
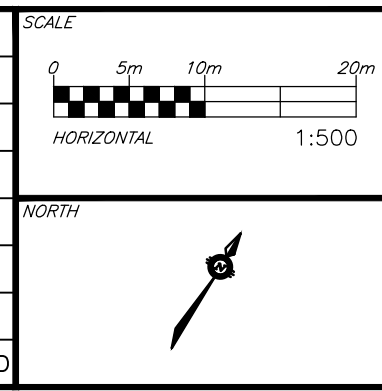

CLIENT
DRAIN-ALL LTD
3385 HAWTHORNE ROAD, OTTAWA, ON.
K1G 4G2 613.739.1070

exp.
exp Services Inc.
1-813-688-1899 | +1-613-225-7330
2025 Queen Street East, Unit 100
Ottawa, ON K2B 8H6
Canada
www.exp.com

• BUILDINGS • EARTH & ENVIRONMENT • ENERGY •
• INDUSTRIAL • INFRASTRUCTURE • SUSTAINABILITY •

| DESIGN | PROJECT |
|--------|---------------------------|
| AJ | ENGINEERING SERVICES FOR |
| AJ | 4380 TRAIL ROAD, |
| AA | OTTAWA, ONTARIO. |
| AA | ULTIMATE SITE GRADING AND |
| AA | EROSION CONTROL PLAN |

| PROJECT No. | DATE | DRAWING No. |
|-----------------|------------|-------------|
| OTT-21023795-A0 | FSD | C200-3 |
| | 27/04/2022 | |

DOT-12-23-0066 #7777