

ROGER PHARAND STREET
(BY-LAW 2018-343 INST. 20BB222)
PART 1 3 PLAN 4 R

NOELLA
LECLAIR WAY
(BY-LAW 2018-343
INST. 20BB222)
PART 12
3 1 3 2 6

ELEVATION NOTES
1. Elevations shown are geodetic and are referred to the CGVD28 geodetic datum.
2. It is the responsibility of the user of this information to verify that the job benchmark has not been altered or disturbed and that its relative elevation and description agrees with the information shown on this drawing.

TOPOGRAPHIC PLAN OF SURVEY OF
PART OF THE NORTHERLY LIMIT,
THE WESTERLY LIMIT AND PART
OF THE SOUTHERLY LIMIT OF
PIN 14563-3947

Being
PART OF LOT 1
CONCESSION 11
GEOGRAPHIC TOWNSHIP OF CUMBERLAND
CITY OF OTTAWA
Surveyed by Annis, O'Sullivan, Vollebek Ltd.

Scale 1 : 300
12 9 6 3 0 6 12 Metres

Metric
DISTANCES AND COORDINATES SHOWN ON THIS PLAN
ARE IN METRES AND CAN BE CONVERTED TO FEET BY
DIVIDING BY 0.3048.

Surveyor's Certificate
I CERTIFY THAT:
1. This survey and plan are correct and in accordance with the Surveys
Act and the Surveyors Act and the regulations made under them.
2. The survey was completed on the 5th day of January, 2023.

January 6, 2023
Date
J. E. Anderson
Ontario Land Surveyor

Notes & Legend

| Denotes | |
|---------|----------------------------------|
| —□— | Survey Monument Planted |
| —■— | Survey Monument Found |
| SIB | Standard Iron Bar |
| SSIB | Short Standard Iron Bar |
| (WIT) | Witness |
| Meas. | Measured |
| (AOG) | Annis, O'Sullivan, Vollebek Ltd. |
| (P1) | Plan 4R-34739 |
| (P2) | Plan 4R-27317 |
| + 65.00 | Location of Elevations |
| CL | Centreline |
| TOS | Top of Slope |
| BOS | Bottom of Slope |
| BH | Borehole |
| LS | Light Standard |

Bearings are grid, derived from Can-Net 2016 Real Time Network
GPS observations, MTM Zone 9 (76°30' West Longitude) NAD-83
(original).

Job Benchmark
Cul Cross on Concrete
Base of Light Standard
Elevation = 90.57

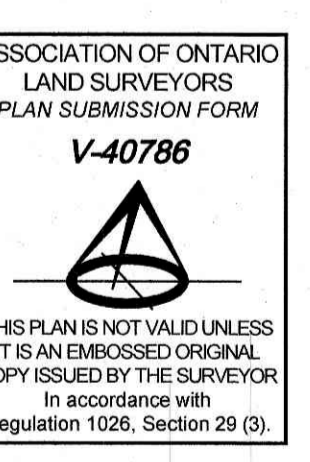

THIS PLAN IS NOT VALID UNLESS
IT IS AN UNREVISED ORIGINAL
COPY ISSUED BY THE SURVEYOR
IN ACCORDANCE WITH
REGULATION 1026, SECTION 29 (3).

PART 10 PLAN 4R 26747