

NAME	RIM ELEV.	INVERT IN	INVERT OUT	DESCRIPTION
MH1A	96.40	S90.317	NW90.280	STRUC: OPSD 701.010 FRAME: CITY S25 COVER: CITY S24

NAME	RIM ELEV.	INVERT IN	INVERT OUT	DESCRIPTION
CB1	92.80	SW90.580	N90.549	STRUC: OPSD 705.010 FRAME: CITY S19 COVER: CITY S19 C/W CB SHIELD
CB6	95.85		S94.854	STRUC: OPSD 705.010 FRAME: CITY S19 COVER: CITY S19
CB7	91.84		NW90.093	STRUC: OPSD 705.010 FRAME: CITY S19 COVER: CITY S19
CB8	93.98		NW90.636	STRUC: OPSD 705.010 FRAME: CITY S19 COVER: CITY S19
CB12	91.89		E90.574	STRUC: OPSD 705.010 FRAME: CITY S19 COVER: CITY S19
CBM2	91.83	S90.330	N90.300	STRUC: OPSD 701.010 FRAME: CITY S25 COVER: CITY S24.1
CBM4	96.29	S94.090	NE90.810	STRUC: OPSD 701.010 FRAME: CITY S25 COVER: CITY S24.1 C/W EXTERNAL DROP STRUCTURE PER OPSD 1003.010
LSCB9	95.11		E94.228	PER CITY STANDARD S31
LSCB10	95.06		E94.545	PER CITY STANDARD S31
LSCB11	95.68		E94.907	PER CITY STANDARD S31
MH3	92.43	SE90.512 SW90.491	NE90.380	STRUC: OPSD 701.010 FRAME: CITY S25 COVER: CITY S24.1
MH5	91.45	SW90.109	NE90.082	STRUC: OPSD 701.010 FRAME: CITY S25 COVER: CITY S24.1

LOCATION	DESCRIPTION	SEPARATION
1	150mm WTR SERVICE TOP 92.24 250mm STM SEWER INV 95.68	2.37
2	150mm WTR SERVICE TOP 93.31 250mm STM SEWER INV 95.56	2.25
3	200mm STM SERVICE INV 90.68 150mm SAN SERVICE TOP 90.36	0.32

SITE SERVICING PLAN
1:200

GENERAL NOTES

- THE ORIGINAL TOPOGRAPHY, GROUND ELEVATION AND SURVEY DATA SHOWN ARE SUPPLIED FOR INFORMATION PURPOSES ONLY, AND IMPLY NO GUARANTEE OF ACCURACY. IT SHALL BE THE RESPONSIBILITY OF THE CONTRACTOR TO VERIFY ALL INFORMATION SHOWN.
- THIS PLAN IS NOT A CADASTRAL SURVEY SHOWING LEGAL PROPERTY BOUNDARIES AND EASEMENTS. THE PROPERTY BOUNDARIES SHOWN HEREON HAVE BEEN DERIVED FROM INFORMATION SUPPLIED BY (OR SHOWN ON) J.D. BARNES DRAWING 22-10-111-00 AND CANNOT BE RELIED UPON TO BE ACCURATE OR COMPLETE. THE PRECISE LOCATION OF THE CURRENT PROPERTY BOUNDARIES AND EASEMENTS CAN ONLY BE DETERMINED BY AN UP-TO-DATE LAND TITLES SEARCH AND A SUBSEQUENT CADASTRAL SURVEY PERFORMED AND CERTIFIED BY AN ONTARIO LAND SURVEYOR.
- THE CONTRACTOR IS TO OBTAIN AND PAY FOR ALL NECESSARY PERMITS AND APPROVALS FROM THE CITY BEFORE COMMENCING CONSTRUCTION.
- THE CONTRACTOR IS RESPONSIBLE FOR ALL LAYOUT.
- THE CONTRACTOR IS TO DETERMINE THE EXACT LOCATION, SIZE, MATERIAL AND ELEVATION OF ALL EXISTING UTILITIES PRIOR TO COMMENCING CONSTRUCTION. PROTECT AND ASSUME ALL RESPONSIBILITY FOR EXISTING UTILITIES WHETHER OR NOT SHOWN ON THESE DRAWINGS. IF THERE IS ANY DISCREPANCY THE CONTRACTOR IS TO NOTIFY THE ENGINEER PROMPTLY.
- RESTORE ALL TRENCHES AND SURFACES OF PUBLIC ROAD ALLOWANCES TO CONDITION EQUAL OR BETTER THAN ORIGINAL CONDITION AND TO THE SATISFACTION OF THE CITY AUTHORITIES.
- EXCAVATE AND DISPOSE OF ALL EXCESS EXCAVATED MATERIAL, SUCH AS ASPHALT, CURBING AND DEBRIS, OFF SITE AS DIRECTED BY THE ENGINEER AND THE CITY.
- TOPSOIL TO BE STRIPPED AND STOCKPILED FOR REHABILITATION. CLEAN FILL TO BE PLACED IN FILL AREAS AND COMPACTED TO 95% STANDARD PROCTOR DENSITY.
- ALL DISTURBED AREAS TO BE RESTORED TO ORIGINAL CONDITION OR BETTER UNLESS OTHERWISE SPECIFIED.
- THE CONTRACTOR SHALL BE RESPONSIBLE FOR ALL TRAFFIC CONTROL AND SAFETY MEASURES DURING THE CONSTRUCTION PERIOD, INCLUDING THE SUPPLY,

WATERMAIN NOTES

- DO NOT ALTER GRADING OF THE SITE WITHOUT PRIOR APPROVAL OF THE ENGINEER/CITY.
- ALL ROADWAY, PARKING LOT, AND GRADING WORKS TO BE UNDERTAKEN IN ACCORDANCE WITH CITY STANDARDS AND SPECIFICATIONS. THE CONTRACTOR IS TO PROVIDE POSITIVE DRAINAGE AWAY FROM THE BUILDING.
- CONTACT THE CITY FOR INSPECTION OF ROUGH GRADING OF PARKING LOTS, ROADWAYS AND LANDSCAPED AREAS PRIOR TO PLACEMENT OF ASPHALT AND TOPSOIL. ALL DEFICIENCIES NOTED SHALL BE RECTIFIED TO THE CITY'S SATISFACTION PRIOR TO PLACEMENT OF ANY ASPHALT, TOPSOIL, SEED & MULCH AND/OR SOIL.
- ALL DIMENSIONS AND INVERTS MUST BE VERIFIED PRIOR TO CONSTRUCTION. IF THERE IS ANY DISCREPANCY THE CONTRACTOR IS TO NOTIFY THE ENGINEER PROMPTLY.
- ELECTRICAL, GAS, TELEPHONE AND TELEVISION SERVICE LOCATIONS ARE SUBJECT TO THE INDIVIDUAL AGENCY.
 - ELECTRICAL SERVICE - HYDRO ONE.
 - GAS SERVICE - ENBRIDGE.
 - TELEPHONE SERVICE - BELL CANADA.
 - TELEVISION SERVICE - ROGERS.
- INSTALLATION TO BE IN ACCORDANCE WITH CURRENT CODES AND STANDARDS OF APPLICABLE AGENCIES AND TO BE COMPLETED BY CONTRACTOR.
- CONTRACTOR TO ENSURE ALL APPROVABLE OPS SPECIFICATIONS ARE FOLLOWED DURING CONSTRUCTION.
- ALL PROPOSED CURB TO BE CONCRETE BARRIER CURB UNLESS OTHERWISE SPECIFIED.
- THIS PLAN MUST BE READ IN CONJUNCTION WITH THE GEOTECHNICAL INVESTIGATION COMPLETED BY PATERSON GROUP, DATED MAY 16, 2023.
- CONCRETE THRESH BLOCKS TO CONFORM TO OPSD 1103.010 AND OPSD 1103.020.
- ALL WATERMAIN TO BE CLASS 150 DR-18 OR APPROVED EQUIVALENT.
- ALL WATERMAIN TO BE EQUIPPED WITH TRACER WIRE.
- ALL SERVICES BENEATH PRIVATE ENTRANCES, WALKWAYS, AND STRUCTURES ARE TO BE SLEEVED.

SEWER NOTES:

- CONSTRUCT ALL SEWERS, CATCH BASINS, MANHOLES AND APPURTENANCES IN ACCORDANCE WITH OPSD STANDARDS AND SPECIFICATIONS, AS WELL AS CITY STANDARDS.
- SEWER TRENCHING AND BEDDING SHALL CONFORM TO OPSD 801.010 AND 801.013 UNLESS NOTED OTHERWISE.
- SEWERS SHALL BE A MINIMUM 150mm OF STANDARD PROCTOR DRY DENSITY. CLEAR STONE BEDDING SHALL NOT BE PERMITTED.
- SUB-BEDDING, IF REQUIRED SHALL CONSIST OF 450mm OF COMPACTED GRANULAR "B" TYPE 1.
- BACKFILL TO AT LEAST 300mm ABOVE TOP OF PIPE WITH GRANULAR "A" OR GRANULAR "B" TYPE 1.
- TO MINIMIZE DIFFERENTIAL FROST HEAVING, TRENCH BACKFILL FROM PAVEMENT SUBGRADE TO 2.0 METERS BELOW FINISHED GRADE SHALL MATCH EXISTING SOIL CONDITIONS.
- SANITARY SEWERS AND CONNECTIONS 150mm AND SMALLER TO BE PVC SDR-28.
- SEWERS AND CONNECTIONS 200mm AND LARGER TO BE PVC SDR-35. BEDDING TO BE TYPE "B" EXCEPT AT RISERS, UNLESS NOTED OTHERWISE.
- INSULATE ALL STORM AND SANITARY SEWERS/SERVICES THAT HAVE LESS THAN 2.0m OF COVER WITH THERMAL INSULATION AS PER OPSD 1109.030.
- SEWER CONNECTIONS ARE TO BE MADE ABOVE THE SPRINGLINE OF THE SEWER MAINS AS PER CITY OF OTTAWA STANDARD DRAWING S11.511.1 & S11.2.
- SUPPLY AND INSTALL ALL PIPING AND APPURTENANCES AS SHOWN AND DETAILED TO WITHIN 1.0m OF BUILDING. ALL ENDS OF SERVICES TO BE PROPERLY CAPPED AND LOCATED WITH 2"x4"x8' LONG MARKER.
- CONTRACTOR TO TELEVIEW (CCTV) ALL PROPOSED SEWERS ON SITE, OUTLET CONNECTION TO THE MAIN AND PIPES 150mm OR GREATER PRIOR TO BASE COURSE ASPHALT. UPON COMPLETION OF CONTRACT, THE CONTRACTOR IS RESPONSIBLE TO FLUSH AND CLEAN ALL SEWERS & APPURTENANCES.
- DYE TESTING IS TO BE COMPLETED ON SANITARY SEWERS TO CONFIRM PROPER CONNECTION TO SANITARY SEWER MAIN.
- ALL SERVICES BENEATH PRIVATE ENTRANCES, WALKWAYS, AND STRUCTURES ARE TO BE SLEEVED.

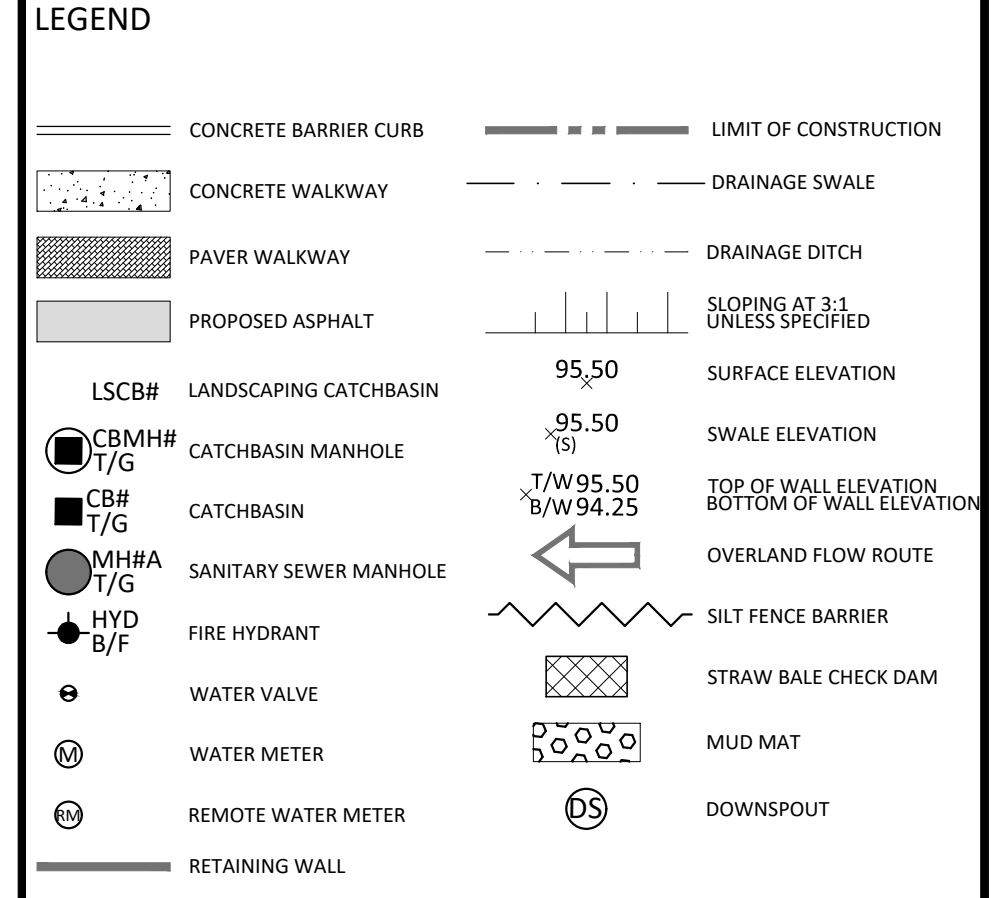
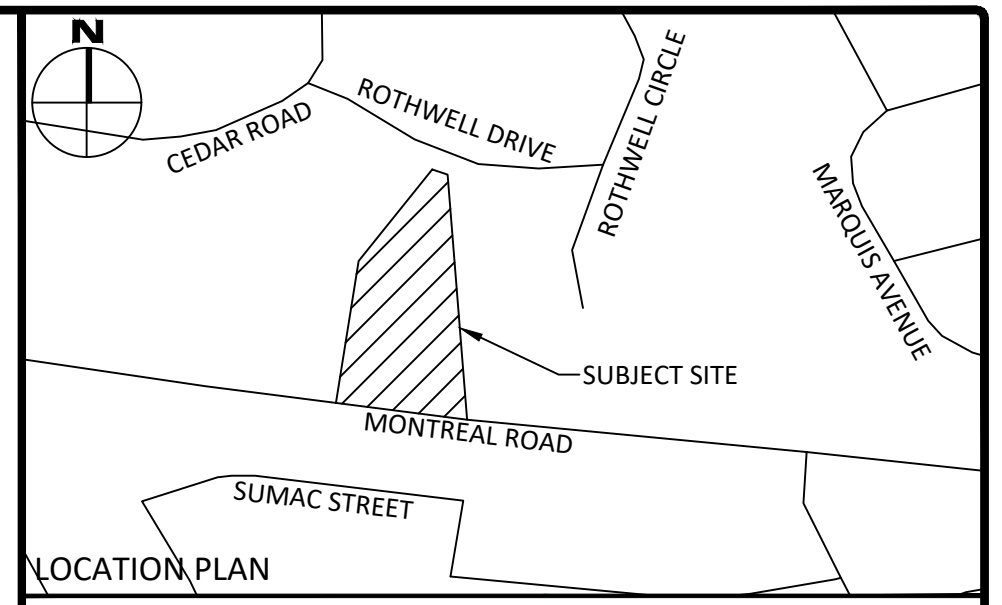

No.	Revisions	Date
3	ISSUED FOR SITE PLAN CONTROL	JAN. 05, 2024
2	ISSUED FOR SITE PLAN CONTROL	OCT. 05, 2023
1	ISSUED FOR SITE PLAN CONTROL	MAY 30, 2023

Check and verify all dimensions before proceeding with the work. Do not scale drawings.

SCALE 1:200

McINTOSH PERRY
115 Walgreen Road, RR3, Carp, ON K0A 1L0
Tel: 613-836-2184 Fax: 613-836-3742
www.mcintoshperry.com

Stamp:

Client: **CSV ARCHITECTS**
190 O'CONNOR STREET, SUITE 100
OTTAWA, ON K2P 2R3

Project: **9-STOREY APARTMENT BUILDING**
1815 MONTREAL ROAD

Drawing Title:	
SITE SERVICING PLAN	
Scale: 1:200	Project Number: CCO-23-3469
Drawn By: FV	Checked By: JH
Designed By: FV	Drawing Number: C102

FILENAME: U:\Drawings\01 Project - Proposed 2023\1815 Montreal Road\11 - Drawing\CCO-23-3469 - Project\01.dwg
 LAST SAVED: Friday, January 05, 2024 10:52:45 AM (LAST SAVED BY: F.Vanant)
 LAST PLOTTED: Friday, January 05, 2024 10:52:45 AM (PLOTTER: HP-DesignJet 500)

SITE SERVICING PLAN
1:200

D02-02-23-0043 & D07-12-23-0071