



**PRECEDENT IMAGE:
STOCK TANK PLANTER**

GALVANIZED STOCK TANKS ARE A DURABLE AND SIMPLE OPTION FOR PLANTER BEDS. THEY REQUIRE NO INSTALLATION AND COME IN VARIOUS SIZES. THEY CAN ALSO OFTEN BE COST-EFFECTIVE WHEN COMPARED TO LESS-DURABLE ALTERNATIVES THAT REQUIRE ASSEMBLY.

GENERAL NOTES:

- It is the responsibility of the appropriate contractor or official to report any errors, omissions or discrepancies on this plan with actual site conditions to the Landscape Architect before proceeding with construction.
- The contractor is to notify all utility companies and authorities prior to any excavation and ascertain locations of underground services.
- The contractor is to reinstate all areas and items damaged as a result of construction activity.
- The contractor is to comply with all pertinent codes and by-laws.
- The contractor is to maintain a positive surface run-off throughout the entire construction period.
- The Landscape Architect is not responsible for subsurface conditions.
- The contractor is to identify all existing trees to remain on site with the Landscape Architect prior to construction.
- The contractor is to stake the proposed location of all plant material in conjunction with the Landscape Architect prior to excavation.
- Minimum distances for selected deciduous trees are as follows:
 - Building Foundations 7.5m
 - Sidewalks 1.5m
 - Public Streets 2.5m
 - Underground Infrastructure 2.0m
- All trees within 1m of underground utility trenches are to be excavated by hand.
- Remove all protective wrapping from tree trunks after installation.
- Staking of trees shall only be performed if necessary.
- Ensure that mulch is pulled back a min. distance of 75mm from base of tree trunk.

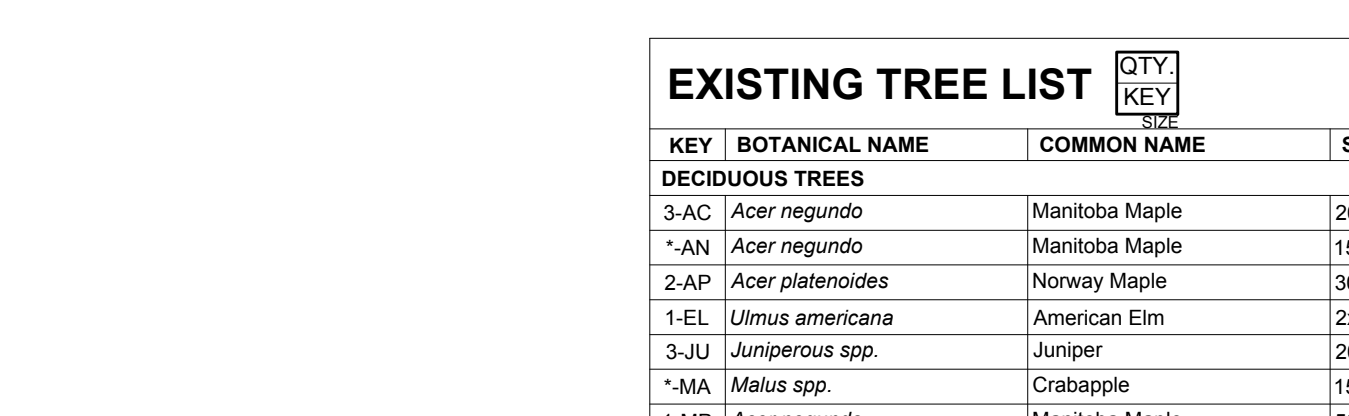
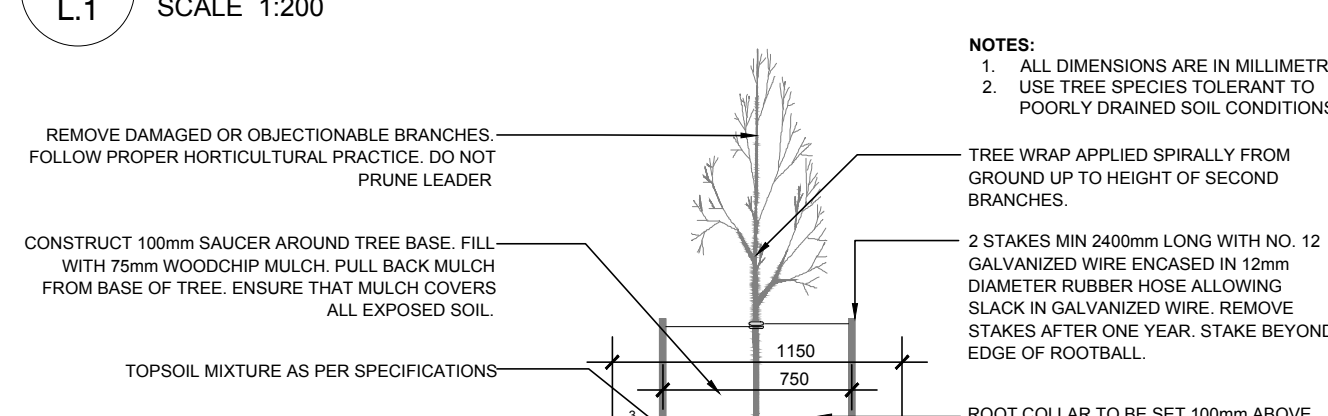
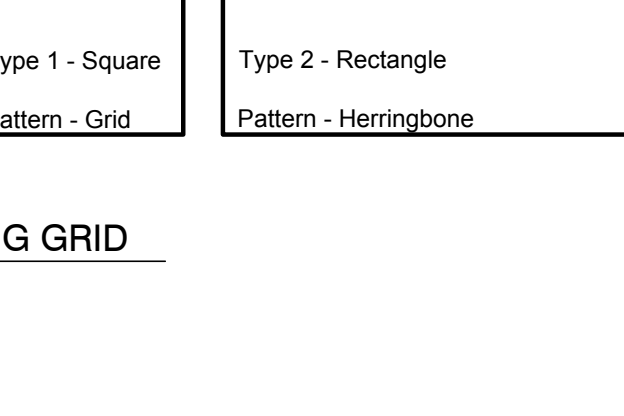
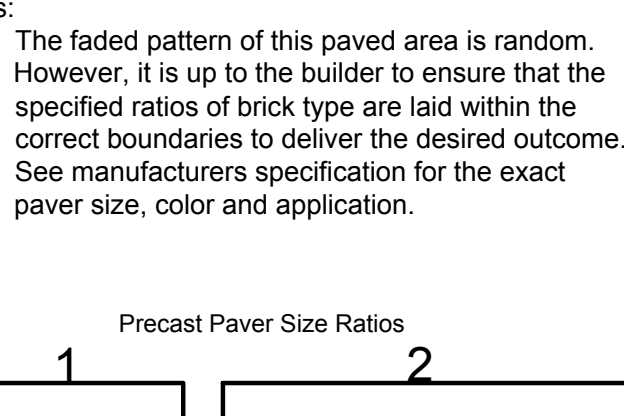
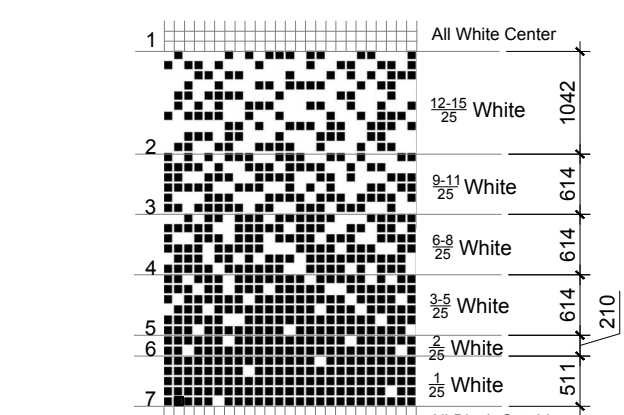
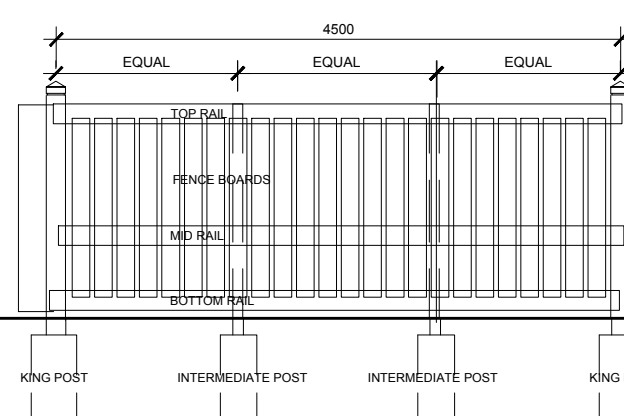
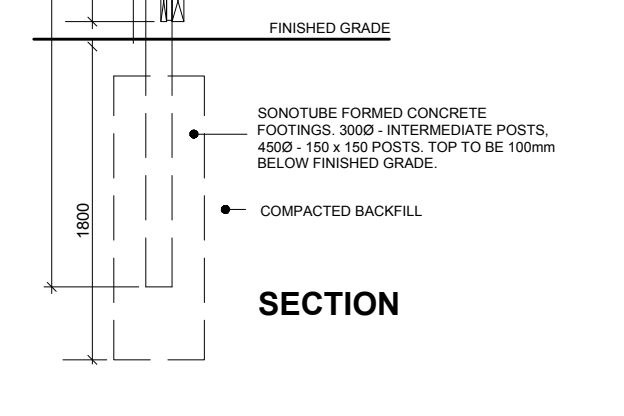
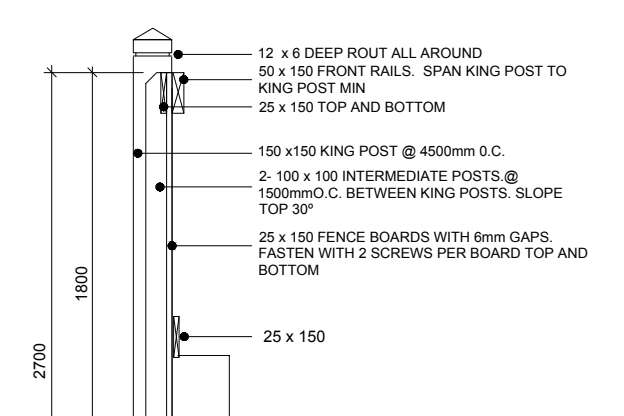
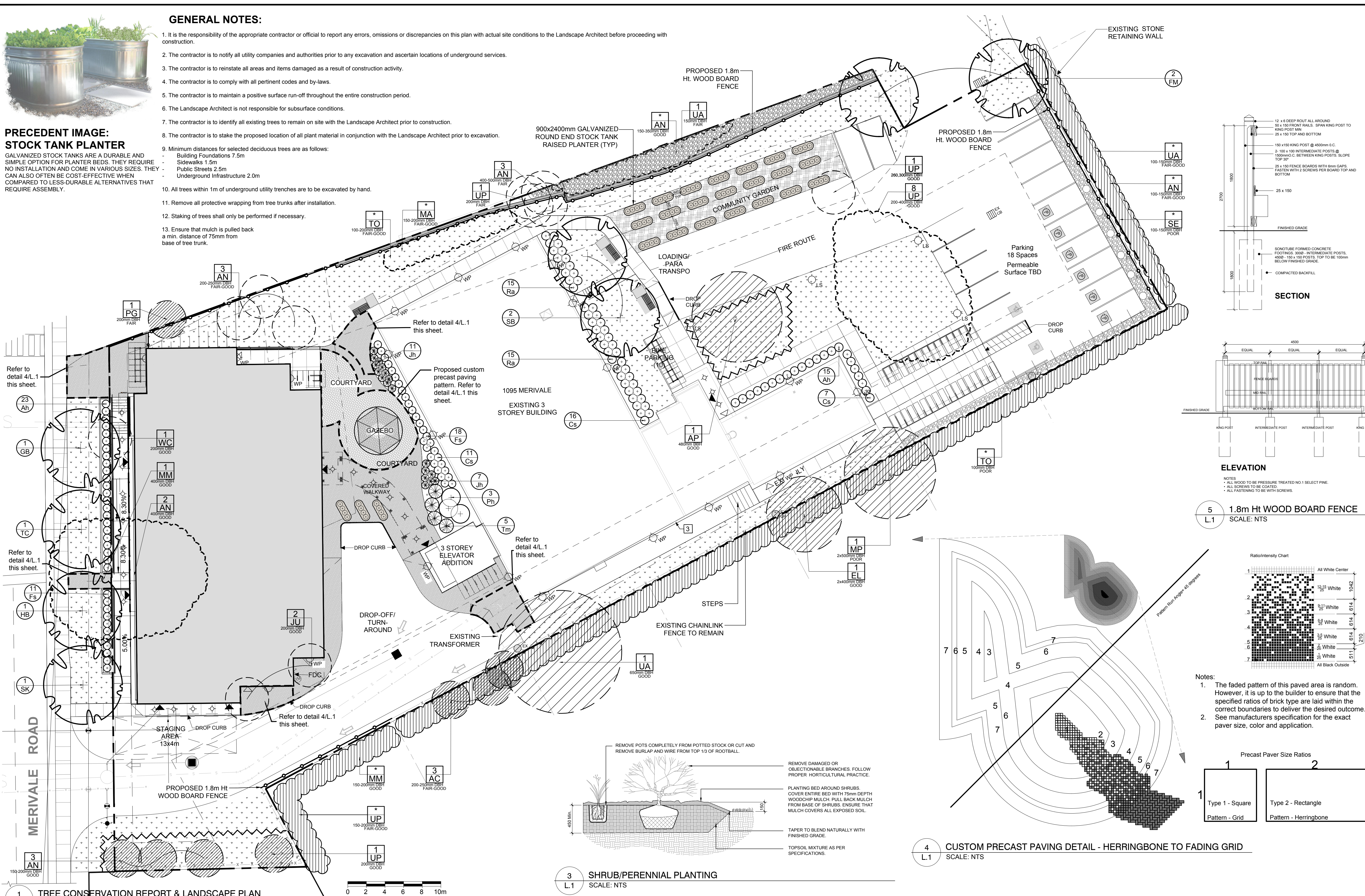

EXISTING TREE LIST

KEY	BOTANICAL NAME	COMMON NAME	SIZE	CRITICAL ROOT ZONE	OWNERSHIP	CONDITION	ACTION
DECIDUOUS TREES							
3-AC	<i>Acer negundo</i>	Manitoba Maple	200-250mm DBH	2000-3500mm	1347 Dorchester	FAIR-GOOD	TO REMAIN
*-AN	<i>Acer negundo</i>	Manitoba Maple	150-500mm DBH	1500-5000mm	1083 Merivale Ave	FAIR-GOOD	SEE PLAN
2-AP	<i>Acer platanoides</i>	Norway Maple	300-350mm DBH	3000-3500mm	1083 Merivale Ave	GOOD	SEE PLAN
1-EL	<i>Ulmus americana</i>	American Elm	2x400mm DBH	4000mm	1335 Dorchester	GOOD	SEE PLAN
3-JU	<i>Juniperus spp.</i>	Juniper	200mm DBH	2000mm	1083 Merivale Ave	GOOD	TO BE REMOVED
*-MA	<i>Malus spp.</i>	Crabapple	150-200mm DBH	1500-2000mm	1083 Merivale Ave	FAIR-GOOD	SEE PLAN
1-MP	<i>Acer negundo</i>	Manitoba Maple	500mm DBH	5000mm	1335 Dorchester	FAIR-GOOD	SEE PLAN
1-PG	<i>Picea glauca</i>	White Spruce	200mm DBH	2000mm	1077 Merivale Ave	FAIR	TO REMAIN
*-SE	<i>Ulmus pumila</i>	Siberian Elm	100-200mm DBH	2000-4000mm	1314 Emperor	GOOD	TO REMAIN
*-TO	<i>Thuja occidentalis</i>	Siberian Cedar Hedge	100-200mm DBH	1000-2000mm	Numerous	GOOD	TO REMAIN
1-UA	<i>Ulmus americana</i>	American Elm	650mm DBH	6500mm	1343 Dorchester	GOOD	SEE PLAN
*-UP	<i>Ulmus pumila</i>	Siberian Elm	300-350mm DBH	2000-4000mm	1083 Merivale Ave	FAIR-GOOD	SEE PLAN

PROPOSED PLANT LIST

KEY	QTY	BOTANICAL NAME	COMMON NAME	SIZE	CONDITION	REMARKS
DECIDUOUS TREES						
FM	2	<i>Acer x freemanii</i>	Freeman's Maple	60mm dia.	B&B	
HB	1	<i>Celtis occidentalis</i>	Hackberry	60mm dia.	B&B	
GB	1	<i>Ginkgo biloba 'Princeton Sentry'</i>	Princeton Sentry Ginkgo	60mm dia.	B&B	Male tree
SB	2	<i>Amelanchier canadensis</i>	Serviceberry	60mm dia.	B&B	Single leader
SK	1	<i>Gleditsia triacanthos var. inermis 'Draves'</i>	Street Keeper Honeylocust	60mm dia.	B&B	
TC	1	<i>Tilia cordata</i>	Littleleaf Linden	60mm dia.	B&B	
SHRUBS						
An	38	<i>Hydrangea arborescens 'Annabelle'</i>	Annabelle Hydrangea	3 gal pot	Potted	Space 800mm o.c.
Cs	34	<i>Cornus sericea 'Farrow' Arctic Fire</i>	Red Twig Dogwood	600mm ht	Potted	Space 800mm o.c.
Fs	29	<i>Sorbaria sorbifolia 'Sem'</i>	Sem False Spirea	600mm ht	Potted	Space 800mm o.c.
Jh	18	<i>Juniperus horizontalis 'Bar Harbor'</i>	Bar Harbor Juniper	600mm spr	Potted	Space 800mm o.c.
Ph	3	<i>Hydrangea paniculata 'Peegee'</i>	Peegee Hydrangea	1200mm ht	Potted	Space 2000mm o.c.
Ra	30	<i>Ribes alpinum</i>	Alpine Currant	600mm ht	Potted	Space 800mm o.c.
Tm	5	<i>Taxus media 'Hicksii'</i>	Hick's Yew	1000mm ht	Potted	Space 1500mm o.c.

CLIENT
Shepherds of Good Hope
OTTAWA ONTARIO, CANADA

CONSULTANTS
ARCHITECTS:
CSV ARCHITECTS
sustainable design - conception écologique
613.564.8118 190 O'Connor Street, Suite 100
www.csv.ca Ottawa, Ontario, K2P 2R3

SURVEYORS:
ANNIS, O'SULLIVAN, VOLLEBEKK LTD.
14 Concourse Gate, Suite 500
Nepean, Ont. K2E 7S8
Phone: (613) 727-0850 / Fax: (613) 727-1079
Email: nepean@osvltd.com

- LEGEND**
- EXISTING TREE TO REMAIN
 - GROUP OF EXISTING TREES TO REMAIN
 - EXISTING TREE TO BE REMOVED
 - GROUP OF EXISTING TREES TO BE REMOVED
 - PROPOSED DECIDUOUS TREE
 - PROPOSED SHRUBS / PERENNIALS
 - PROPOSED SODDED GRASS AREA
 - PROPOSED PRECAST TYPE 1 CONCRETE PAVERS
 - PROPOSED PRECAST TYPE 2 CONCRETE PAVERS
 - PROPOSED RIVERSTONE MULCH
 - PROPOSED STONEDUST
 - PROPOSED STOCK TANK PLANTER
 - PROPOSED TREE PROTECTION FENCING
 - PROPOSED 1.8m HT WOOD BOARD FENCE
 - PROPOSED BENCH

No.	Issue	Date	ML	JL
1	ISSUED FOR SITE PLAN CONTROL	06/02/2023	ML	JL

JAMES B. LENNOX & ASSOCIATES INC.
LANDSCAPE ARCHITECTS
3332 CARLING AVE. OTTAWA, ONTARIO K2H 5A8
Tel. (613) 722-5168 Fax. (613) 343-3942

PROJECT
SGH 1083 MERIVALE
1083 MERIVALE ROAD, OTTAWA ON K1Z 6A9

DRAWING
TREE CONSERVATION REPORT & LANDSCAPE PLAN

STAMP

SCALE
AS SHOWN

START DATE
NOVEMBER 2022

PROJECT NO.

PROJECT NORTH

DRAWING NO.
L.1

PLOT SIZE ARCH-D