

OLD SECOND LINE ROAD

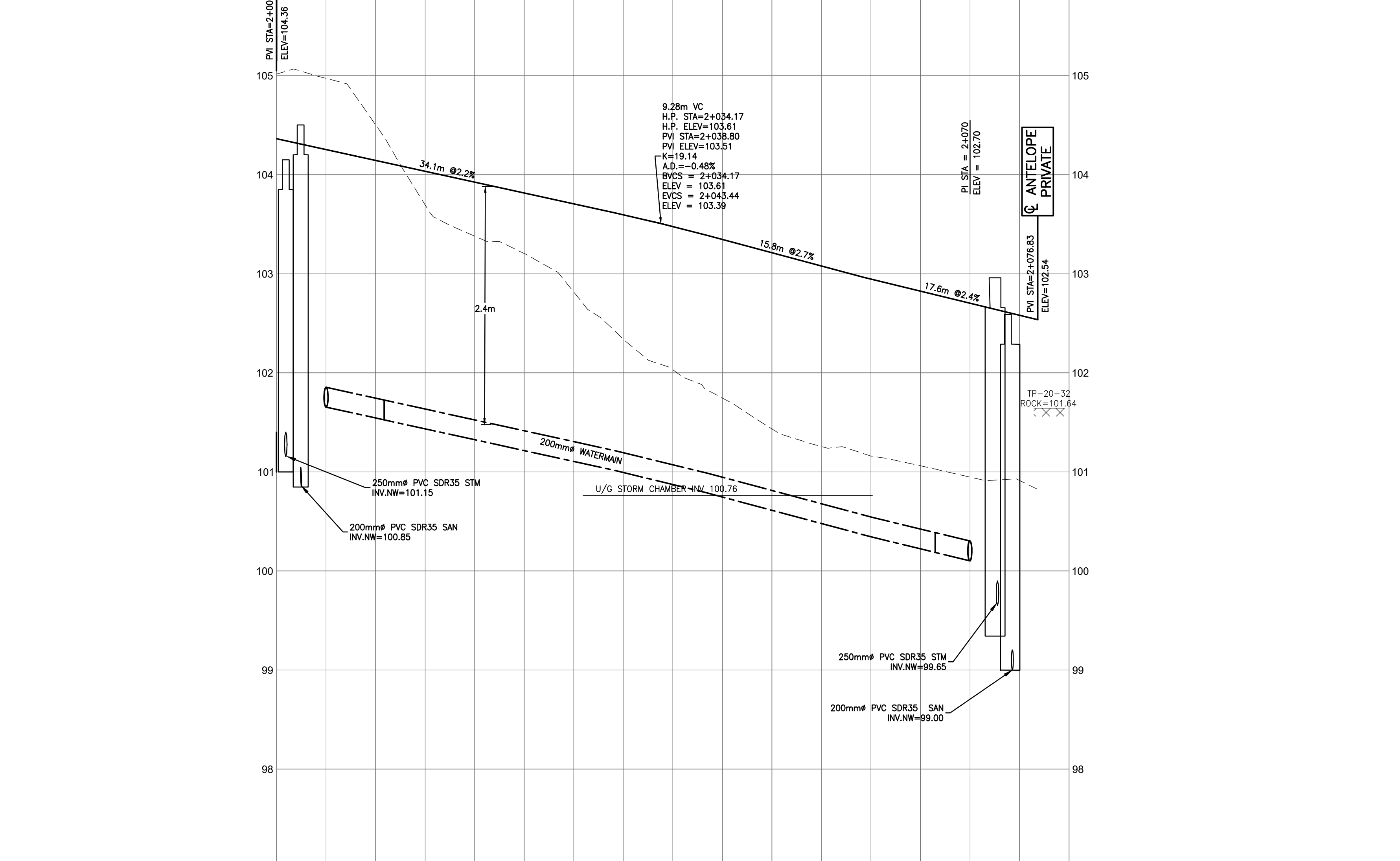
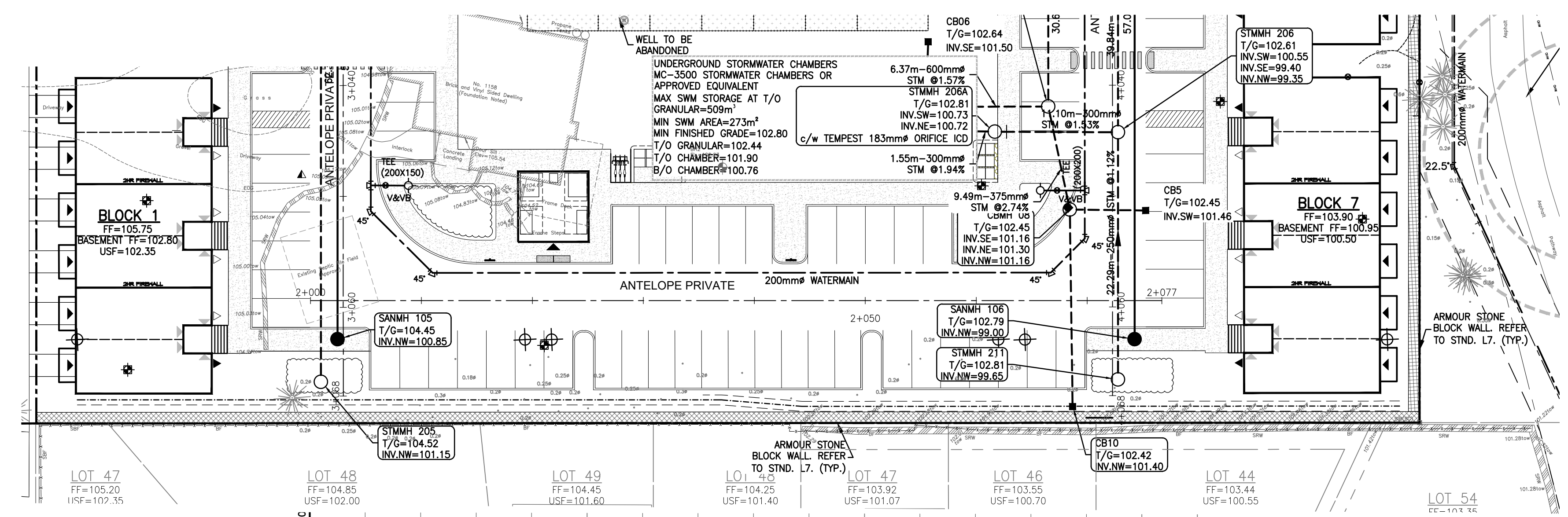

STATION	PROPOSED ELEVATION	EXISTING ELEVATION	TOP OF WATERMAIN ELEVATION	STORM SEWER INVERTS	SANITARY SEWER INVERTS	CHAINAGE
2+000	104.25	104.14	101.86			2+000
2+005.0	104.14	104.03	101.72			2+005.0
2+010.9	104.03	103.93	101.51			2+010.9
2+021.8	103.93	103.82	101.29			2+021.8
2+025	103.82	103.71	101.13			2+025
2+031.5	103.71	103.60	100.89			2+031.5
2+037.9	103.60	103.48	100.72			2+037.9
2+047.6	103.48	103.35	100.54			2+047.6
2+050	103.35	103.21	100.39			2+050
2+053.8	103.21	103.08	100.30			2+053.8
2+060.0	103.08	102.95	100.15			2+060.0
2+066.5	102.95	102.82	100.00			2+066.5
2+070.0	102.82	102.70	99.85			2+070.0
2+075	102.70	102.58	99.70			2+075
2+080	102.58	102.46	99.55			2+080

CAUTION
THE POSITION OF ALL POLE LINES, CONDUITS, WATERMANS, SEWERS AND OTHER UNDERGROUND AND OVERGROUND UTILITIES AND STRUCTURES IS NOT NECESSARILY SHOWN ON THE CONTRACT DRAWINGS, AND WHERE SHOWN, THE ACCURACY OF THE POSITION OF SUCH UTILITIES AND STRUCTURES IS NOT GUARANTEED. BEFORE STARTING WORK, DETERMINE THE EXACT LOCATION OF ALL SUCH UTILITIES AND STRUCTURES AND ASSUME ALL LIABILITY FOR DAMAGE TO THEM.

REV	REVISION DESCRIPTION	DATE	BY	APPD
2	REVISED PER CITY COMMENTS	17/11/23	AAS	BMT
1	ISSUED FOR APPROVAL	14/06/23	SAB	BMT

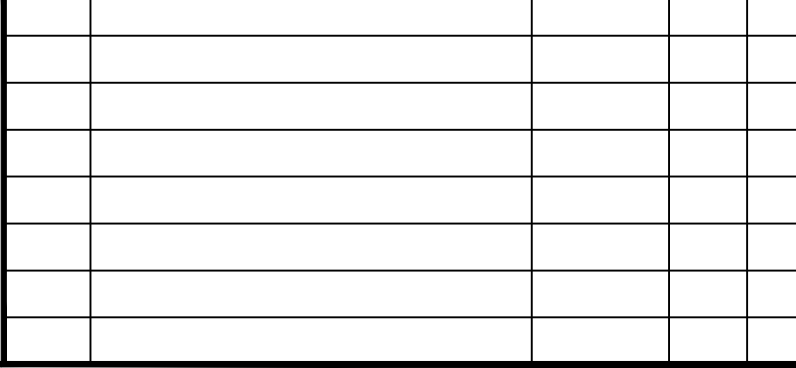

DESIGNED BY: B. M. THOMAS
 REVIEWED BY: B. M. THOMAS
 DEVELOPER: THEBERGE HOMES
 1600 LAPERRIERE AVENUE, SUITE 205
 OTTAWA, ON. K1Z 8P5
 613.421.1515

exp Services Inc.
 1-813-688-1899 | +1-613-225-7330
 3050 St. Lawrence Drive, Unit 100
 Ottawa, ON K2H 8H6
 Canada
 www.exp.com
 BUILDINGS • EARTH & ENVIRONMENT • ENERGY • INDUSTRIAL • INFRASTRUCTURE • SUSTAINABILITY

PROFESSIONAL ENGINEER
 B. M. THOMAS
 2023-11-17
 PROVINCE OF ONTARIO

DESIGN	AS
CHECKED	
CAD	SAB
PROJECT MANAGER	BMT
APPROVED	

PROJECT	SECOND LINE ROAD 1158 OLD SECOND LINE ROAD KANATA, ONTARIO.
TITLE	PROFILE ANTELOPE PRIVATE STA. 2+000 TO STA. 2+080

PROJECT No.	OTT-00245003-A1
SURVEY	FSD
DATE	JUNE 2023
DRAWING No.	C06

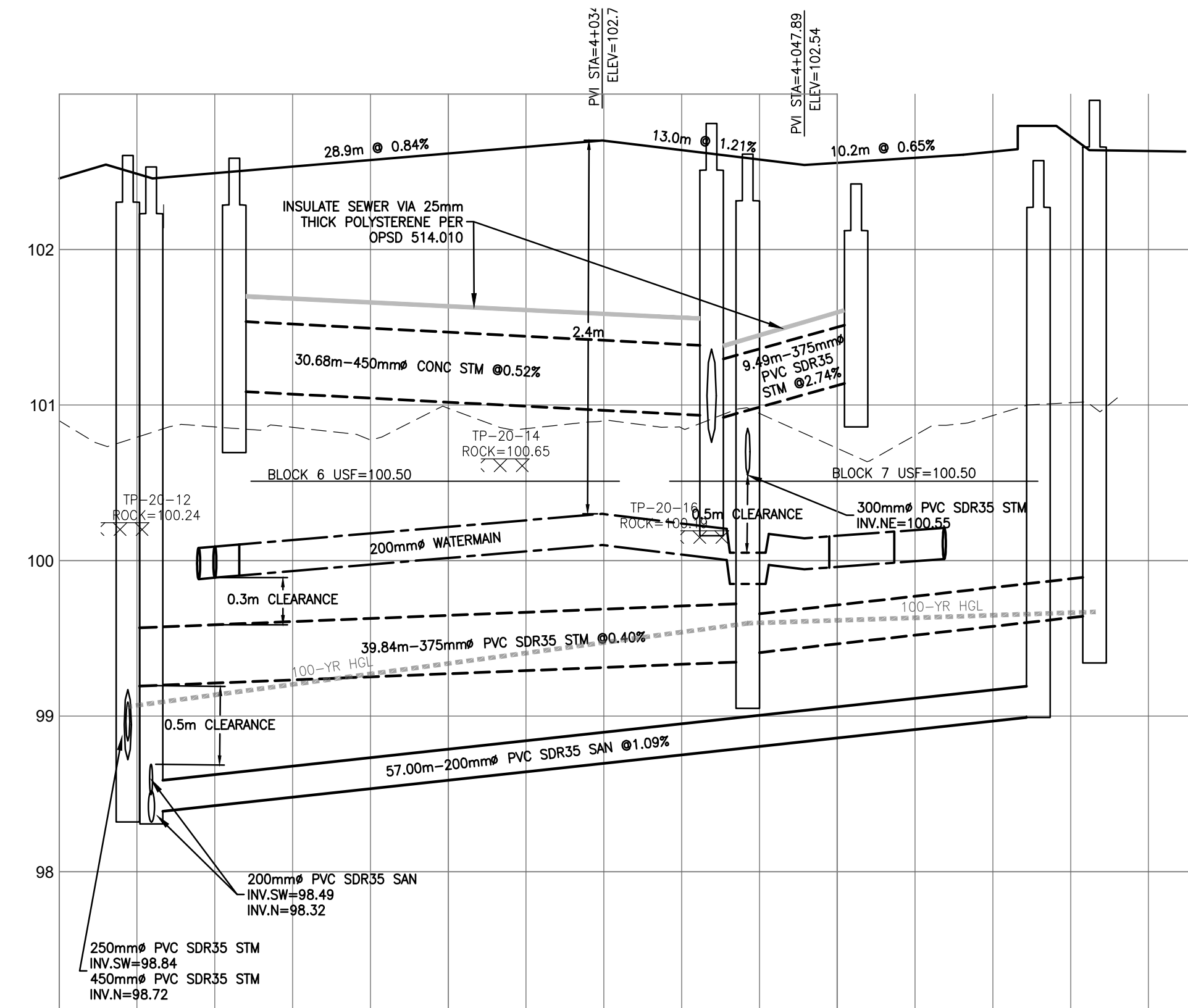
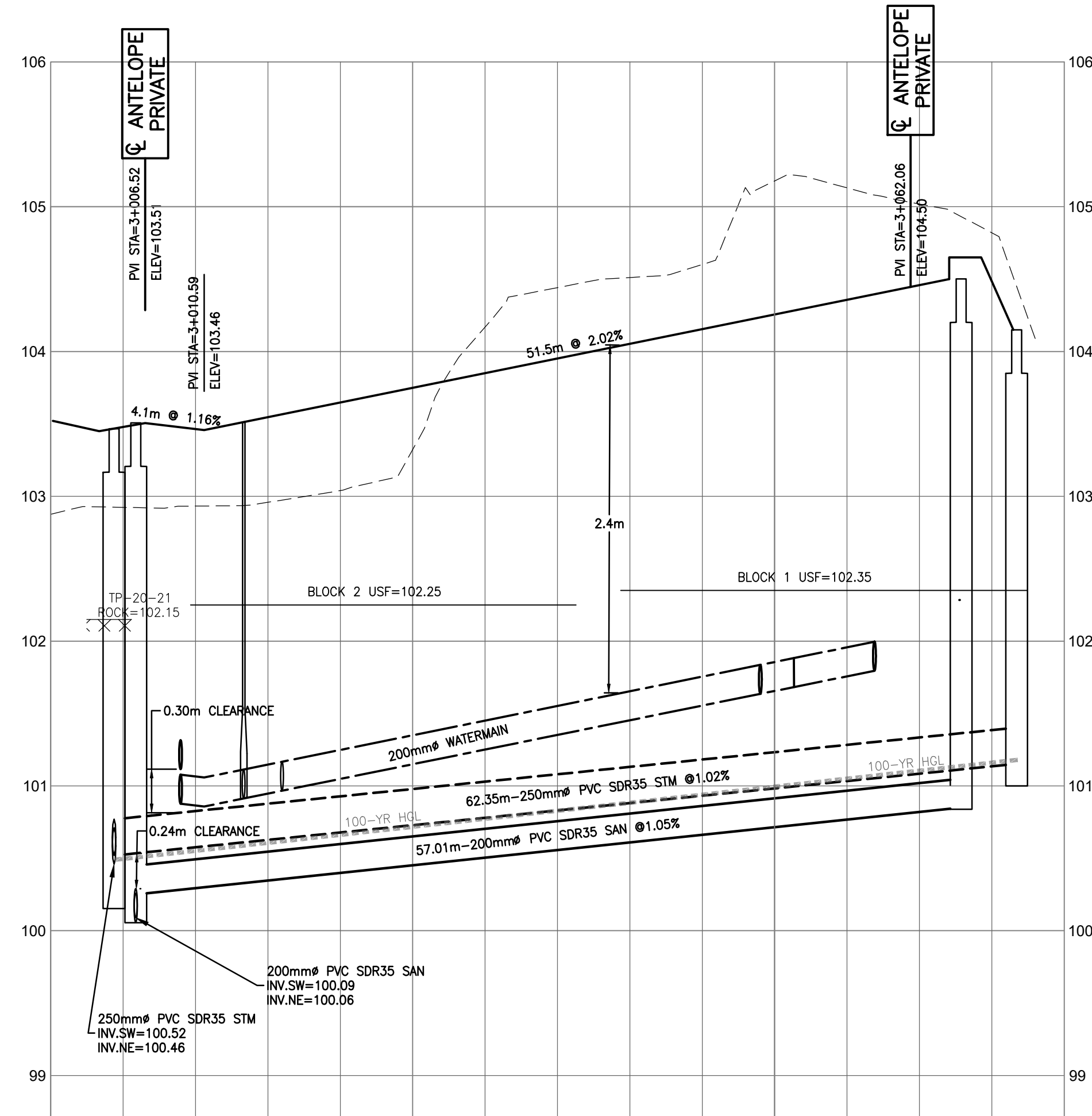
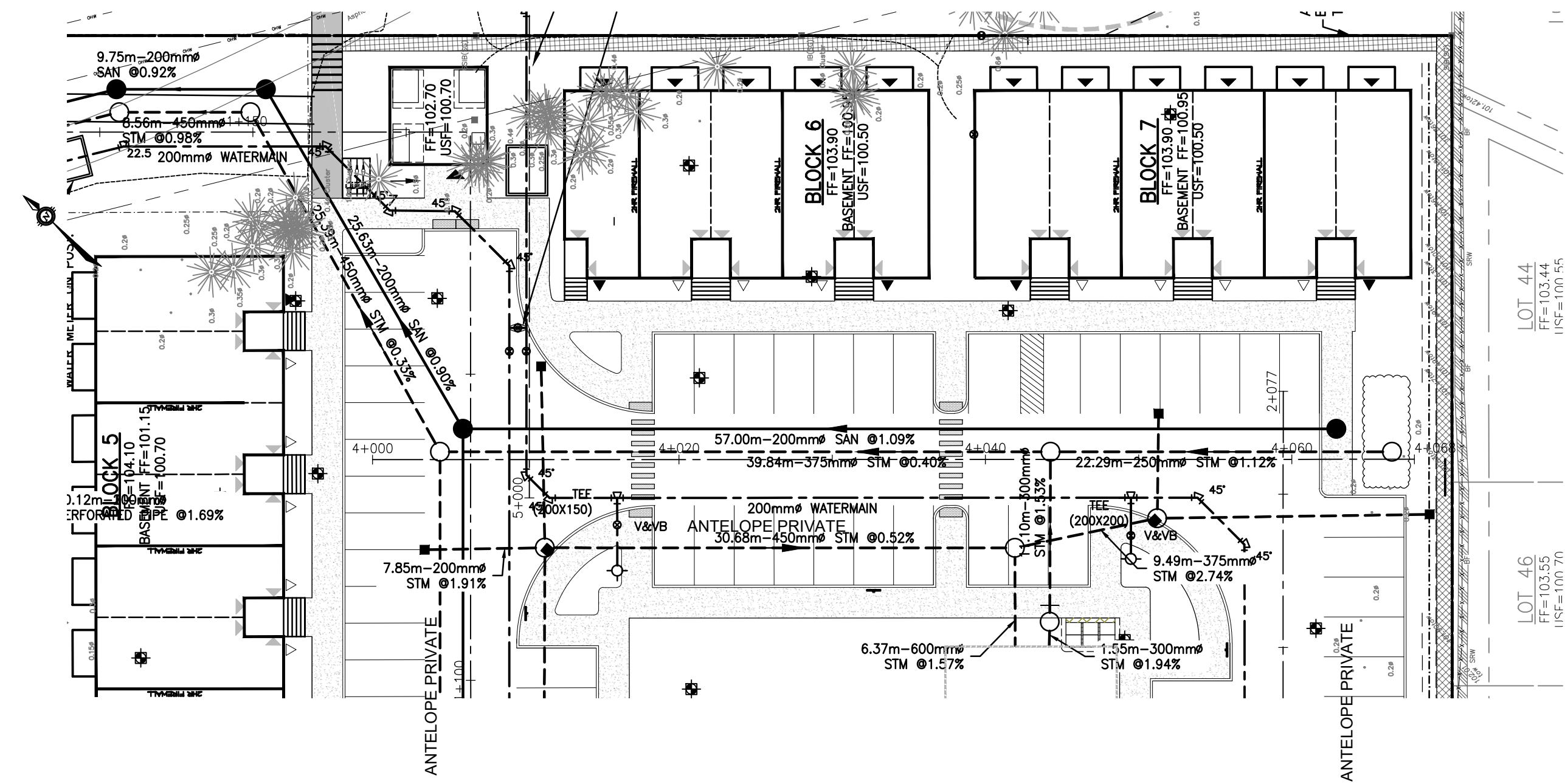
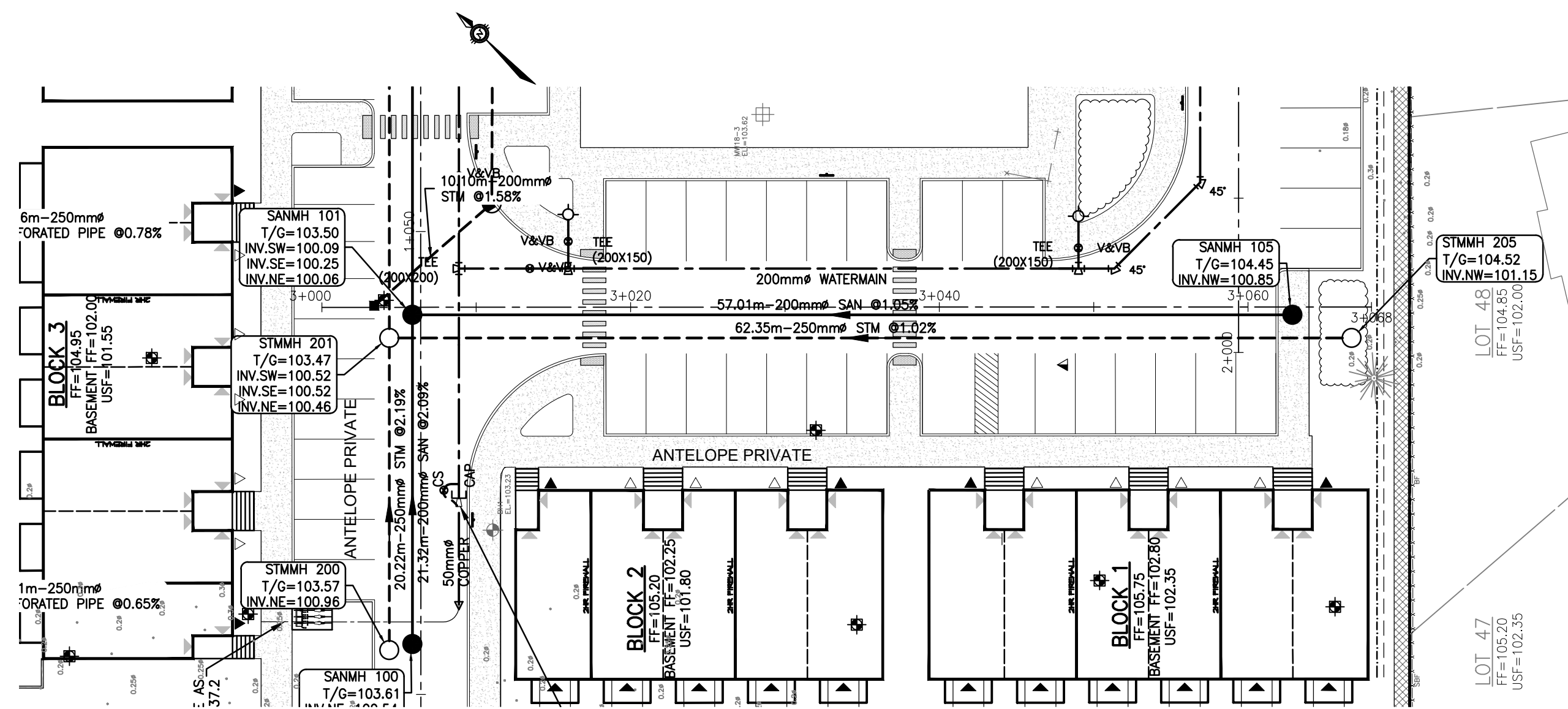

CHAINAGE	103.49	103.46	103.55	103.65	103.75	103.85	103.95	104.05	104.15	104.28	104.36	104.46	104.57
TOP OF WATERMAIN ELEVATION		103.11	103.17	103.67		101.45		101.65		101.80	102.00		
STORM SEWER INVERTS													
SANITARY SEWER INVERTS													
CHAINAGE	3+000	3+011.4	3+016.0	3+025	3+030.0	3+039.7	3+047.3	3+050.8	3+056.3	3+060	3+063	3+070	3+075

CHAINAGE	102.46	102.49	102.49	102.53	102.57	102.62	102.66	102.70	102.64	102.58	102.56	102.59	102.62	102.67
TOP OF WATERMAIN ELEVATION		100.08	100.10	100.14	100.26			100.25		100.15	100.19	100.21		
STORM SEWER INVERTS														
100-YR STORM SEWER INVERTS														
SANITARY SEWER INVERTS														
CHAINAGE	4+000	4+008.0	4+010.0	4+011.6	4+015.9	4+025	4+030.0	4+039.7	4+049.5	4+056.9	4+060	4+063	4+070	4+075

CAUTION
THE POSITION OF ALL POLE LINES, CONDUITS, WATERMANS, SEWERS AND OTHER UNDERGROUND AND OVERGROUND UTILITIES AND STRUCTURES IS NOT NECESSARILY SHOWN ON THE CONTRACT DRAWINGS, AND WHERE SHOWN, THE ACCURACY OF THE POSITION OF SUCH UTILITIES AND STRUCTURES IS NOT GUARANTEED. BEFORE STARTING WORK, DETERMINE THE EXACT LOCATION OF ALL SUCH UTILITIES AND STRUCTURES AND ASSUME ALL LIABILITY FOR DAMAGE TO THEM.

File: \\exp\projects\11102023\11102023_11102023_11102023_11102023.dwg
 User: jthomas
 Date: 11/11/2023 11:11:11 AM
 Plot: 11/11/2023 11:11:11 AM
 Plotter: HP DesignJet T1100e
 Scale: 1:300
 Title: PROFILE ANTELOPE PRIVATE
 Author: jthomas
 Application: AutoCAD 2023

REV	REVISION DESCRIPTION	DATE	BY	APPD
2	REVISED PER CITY COMMENTS	17/11/23	AAS	BMT
1	ISSUED FOR APPROVAL	14/06/23	SAB	BMT

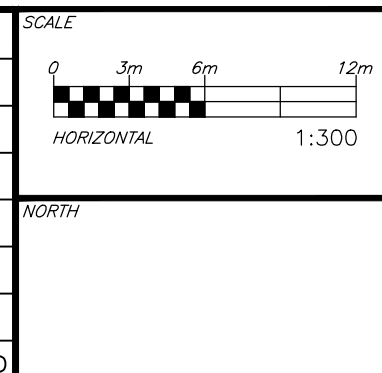

DESIGNED BY: B. M. THOMAS
 REVIEWED BY: B. M. THOMAS
 DEVELOPER: THEBERGE HOMES
 1600 LAPERIERRE AVENUE, SUITE 205
 OTTAWA, ON. K1Z 8P5
 613.421.1515
 exp. SERVICES INC.
 1-813-688-1899 | 1-613-225-7330
 3600 St. Lawrence Blvd., Unit 100
 Ottawa, ON K2B 8K6
 Canada
 www.exp.com
 BUILDINGS • EARTH & ENVIRONMENT • ENERGY • INDUSTRIAL • INFRASTRUCTURE • SUSTAINABILITY

PROJECT	BASEPLAN	TITLE
OTT-00245003-A1	SAB	PROFILE ANTELOPE PRIVATE
SURVEY	AS	STA. 3+000 TO STA. 3+070
DATE		STA. 4+000 TO STA. 4+075
JUNE 2023		
DRAWING No.		C07

PROJECT: SECOND LINE ROAD
 1158 OLD SECOND LINE ROAD
 KANATA, ONTARIO.
 TITLE: PROFILE ANTELOPE PRIVATE
 STA. 3+000 TO STA. 3+070
 STA. 4+000 TO STA. 4+075
 DRAWING No.: C07

CAUTION: OF ALL POLE LINES, CONDUITS, WATERMANS, SEWERS AND OTHER UNDERGROUND AND OVERGROUND UTILITIES SHOWN ON THIS DRAWING. THE EXISTING AND PROPOSED UTILITIES ARE NOT RESEARCHED AND WHERE SHOWN, THE ACCURACY OF THE POSITION OF SUCH UTILITIES AND DEPTHS THEREOF IS NOT GUARANTEED. BEFORE STARTING WORK, DETERMINE THE EXACT LOCATION OF ALL SUCH UTILITIES AND DAMAGE TO THEM.

CHAINAGE	± ELEVATIONS EXISTING	± ELEVATION PROPOSED	TOP OF WATERMAIN ELEVATION
5+060	98.88 98.86 98.85	100.04	100.11 100.10 100.18 200x200 TEL
5+021.0	98.33	100.51	100.29 METER CHAMBER
5+030.2	98.98	100.53	98.33
5+031.8	98.98	100.53	22.5 BEND
5+033.7	98.37	100.69	98.37 22.5 BEND
5+050	98.19	100.68	98.19
5+069.4	98.17	100.05	98.17 22.5 BEND
5+075	98.14	100.61	98.14
5+095.0	98.18	100.65	98.18 11.25 BEND
5+100	98.19	100.66	98.19
5+125	98.27	100.79	98.27
5+150	98.31	100.79	98.31
5+171.5	98.78	101.69	98.78 5% B
5+172.8	98.78	101.72	98.78 5% B & V&V
5+175	98.78	102.10	98.78 5% B
5+182.3	99.57	102.02	99.57 5% B & V&V
5+184.5	98.85	102.02	98.85 5% B & V&V
5+190	98.85	102.02	98.85 5% B & V&V
5+190	98.85	102.02	98.85 5% B & V&V

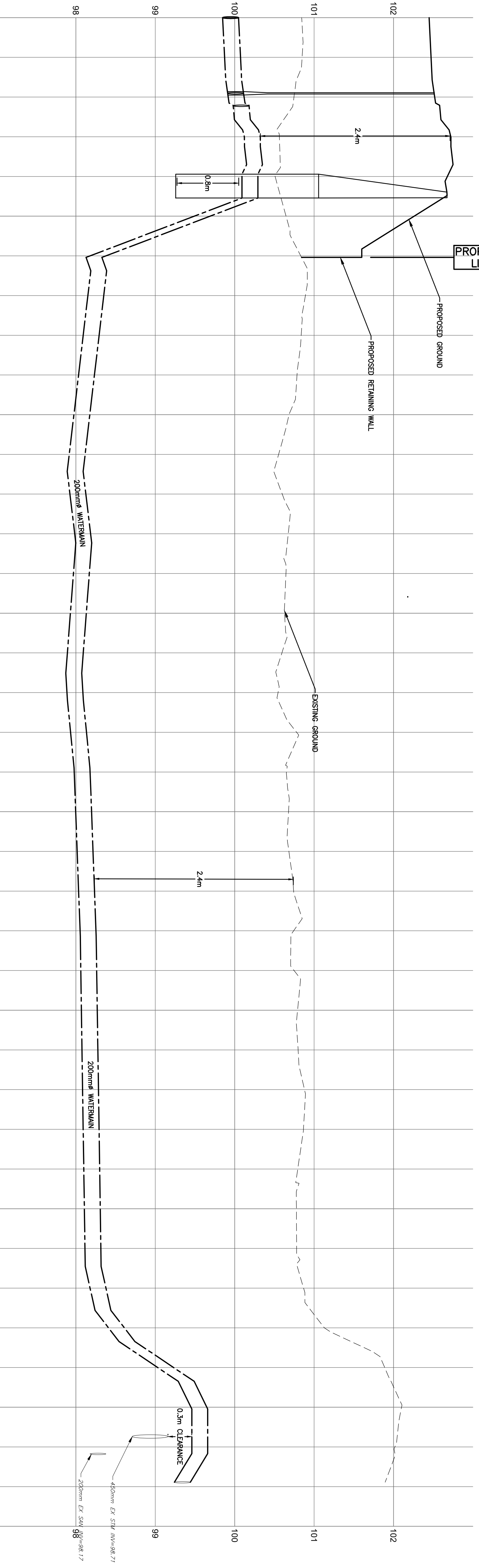

PROPERTY LINE

PROPOSED GROUND

PROPOSED REMAINING WALL

EXISTING GROUND

2.4m

0.3m CLEARANCE

2.4m

2.4m

2.4m

2.4m

2.4m

2.4m

2.4m

2.4m

2.4m

2.4m

2.4m

2.4m

2.4m

2.4m

2.4m

2.4m

2.4m

2.4m

2.4m

2.4m

2.4m

2.4m

2.4m

2.4m

2.4m

2.4m

2.4m

2.4m

2.4m

2.4m

2.4m

2.4m

2.4m

2.4m

2.4m

2.4m

2.4m

2.4m

2.4m

2.4m

2.4m

2.4m

2.4m

2.4m

2.4m

2.4m

2.4m

2.4m

2.4m

2.4m

2.4m

2.4m

2.4m

2.4m

2.4m

2.4m

2.4m

2.4m

2.4m

2.4m

2.4m

2.4m

2.4m

2.4m

2.4m

2.4m

2.4m

2.4m

2.4m

2.4m

2.4m

2.4m

2.4m

2.4m

2.4m

2.4m

2.4m

2.4m

2.4m

2.4m

2.4m

2.4m

2.4m

2.4m

2.4m

2.4m

2.4m

2.4m

2.4m

2.4m

2.4m

2.4m

2.4m

2.4m

2.4m

2.4m

2.4m

2.4m

2.4m

2.4m

2.4m

2.4m

2.4m

2.4m

2.4m

2.4m

2.4m

2.4m

2.4m

2.4m

2.4m

2.4m

2.4m

2.4m

2.4m

2.4m

2.4m

2.4m

2.4m

2.4m

2.4m

2.4m

2.4m

2.4m

2.4m

2.4m

2.4m

2.4m

2.4m

2.4m

2.4m

2.4m

2.4m

2.4m

2.4m

2.4m

2.4m

2.4m

2.4m

2.4m

2.4m

2.4m

2.4m

2.4m

2.4m

2.4m

2.4m

2.4m

2.4m

2.4m

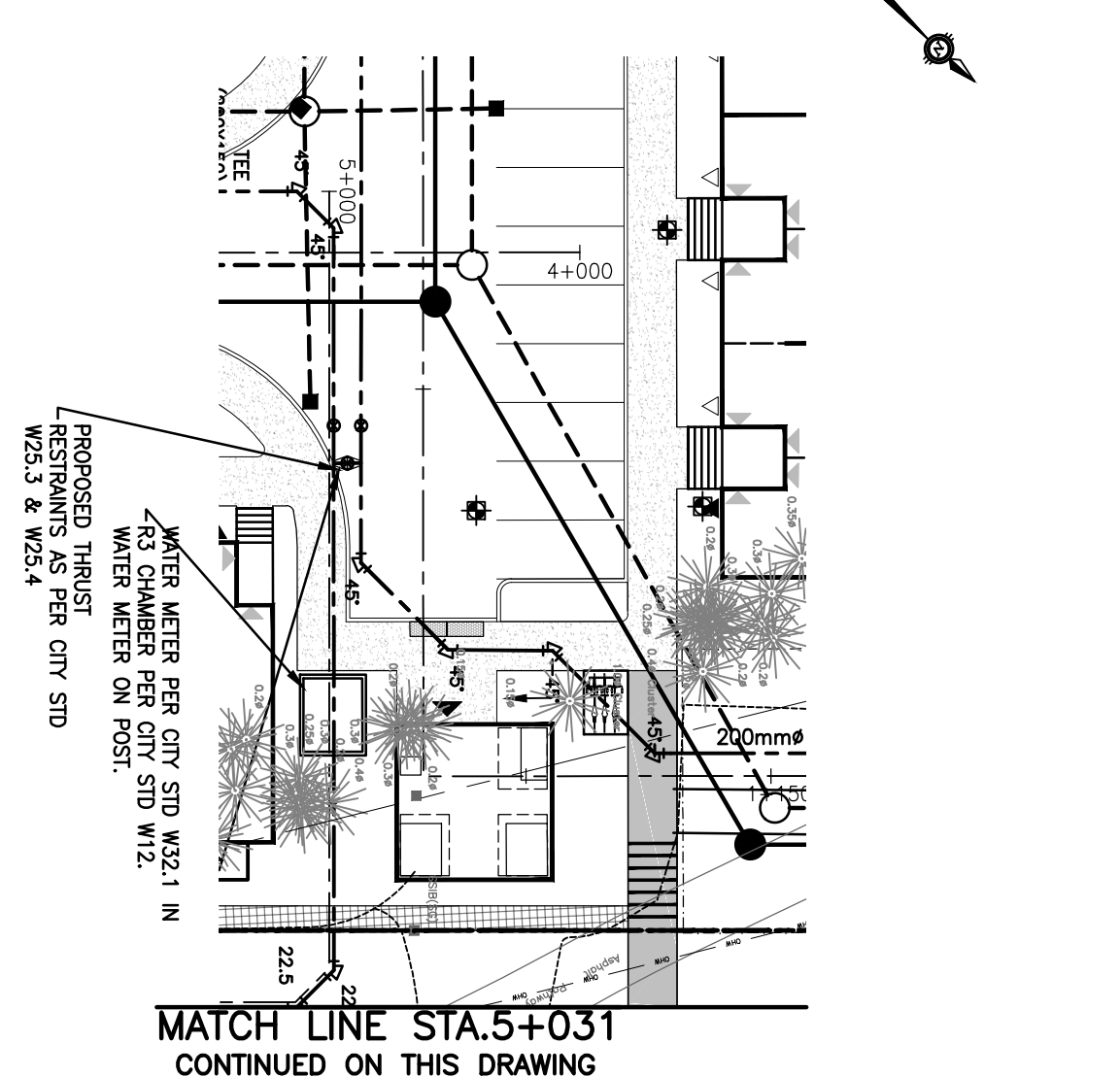

MATCH LINE STA. 5+031
CONTINUED ON THIS DRAWING

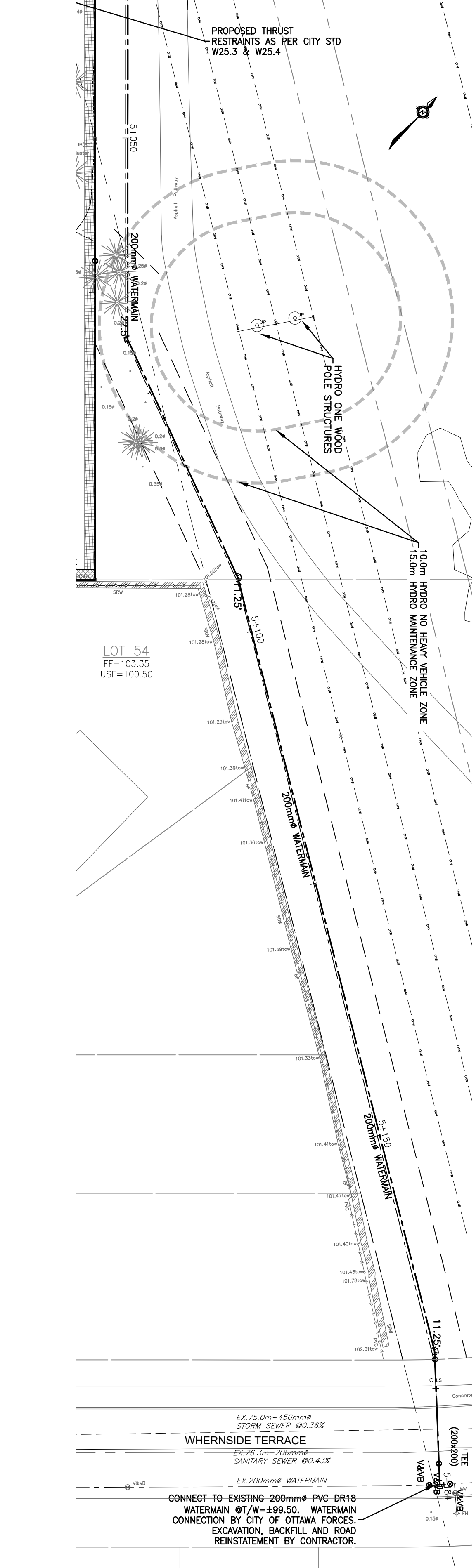

WHERSIDE TERRACE
 EX. 75.0m - 450mm# STORM SEWER @0.36%
 EX. 76.3m - 200mm# SANITARY SEWER @0.43%
 EX. 200mm# WATERMAIN
 CONNECT TO EXISTING 200mm# PVC DR18 WATERMAIN @T/W=±99.50. WATERMAIN CONNECTION BY CITY OF OTTAWA FORCES. EXCAVATION, BACKFILL AND ROAD REINSTATEMENT BY CONTRACTOR.

1800 LAPERIERE AVENUE, SUITE 205
 OTTAWA, ON, K1Z 8P5
 613.421.1515

THEBERGE HOMES
 1158 OLD SECOND LINE ROAD
 KANATA, ONTARIO
 STA. 5+000 TO STA. 5+190

PROJECT NO. OTT-0245003-AN
 SHEET NO. FSD
 DATE: JUNE 2023

PROJECT NO. C07-B

DATE: JUNE 2023

DATE: JUNE 2023

DATE: JUNE 2023

DATE: JUNE 2023

DATE: JUNE 2023

DATE: JUNE 2023

DATE: JUNE 2023