

- NOTES:**
1. THE CONTRACTOR SHALL IMPLEMENT BEST MANAGEMENT PRACTICES TO PROVIDE FOR PROTECTION OF THE AREA DRAINAGE SYSTEM AND THE ULTIMATE RECEIVING WATERCOURSE DURING CONSTRUCTION ACTIVITIES. THE CONTRACTOR ACKNOWLEDGES THAT FAILURE TO IMPLEMENT APPROPRIATE EROSION AND SEDIMENT CONTROL MEASURES MAY BE SUBJECT TO PENALTIES IMPOSED BY ANY APPLICABLE REGULATORY AGENCY.
 2. LIMIT THE EXTENT OF EXPOSED SOILS AT ANY GIVEN TIME.
 3. EROSION AND SEDIMENT CONTROL MEASURES SHALL BE MAINTAINED UNTIL VEGETATION HAS BEEN RE-ESTABLISHED IN ALL DISTURBED AREAS. RE-VEGETATE DISTURBED AREAS AS SOON AS POSSIBLE.
 4. STOCKPILE SOIL AWAY (15 METRES OR GREATER) FROM WATERCOURSES, DRAINAGE FEATURES AND TOP OF STEEP SLOPES.
 5. SILT SACKS ARE TO BE PLACED UNDERNEATH THE FRAME AND COVER OF ALL PROPOSED AND EXISTING CATCH BASIN AND OPEN COVER STORM MANHOLES UNTIL CONSTRUCTION IS COMPLETED.
 6. A SILT FENCE BARRIER SHALL BE INSTALLED AS PER OPSD 219.110 WHERE INDICATED AND MAINTAINED AS REQUIRED.
 7. INSTALL MUD MATS AT ALL CONSTRUCTION ENTRANCES.
 8. DURING ACTIVE CONSTRUCTION PERIODS, VISUAL INSPECTIONS SHALL BE UNDERTAKEN ON A WEEKLY BASIS AND AFTER MAJOR STORM EVENTS (>25mm RAIN IN 24 HOUR PERIOD) ON SEDIMENT CONTROL BARRIERS AND ANY DAMAGE REPAIRED IMMEDIATELY.
 9. EROSION AND SEDIMENT CONTROL BARRIERS SHALL ALSO BE ASSESSED (AND REPAIRED AS REQUIRED) FOLLOWING SIGNIFICANT SNOWMELT EVENTS.
 10. VISUAL INSPECTIONS SHALL ALSO BE UNDERTAKEN IN ANTICIPATION OF LARGE STORM EVENTS (OR A SERIES OF RAINFALL AND/OR SNOWMELT DAYS) THAT COULD POTENTIALLY YIELD SIGNIFICANT RUNOFF VOLUMES.
 11. CARE SHALL BE TAKEN TO PREVENT DAMAGE TO EROSION AND SEDIMENT CONTROLS DURING CONSTRUCTION OPERATIONS.
 12. IN SOME CASES, BARRIERS MAY BE REMOVED TEMPORARILY TO ACCOMMODATE THE CONSTRUCTION OPERATIONS. THE AFFECTED BARRIERS SHALL BE REINSTITATED IMMEDIATELY AFTER CONSTRUCTION OPERATIONS ARE COMPLETED.
 13. EROSION AND SEDIMENT CONTROL MEASURES SHALL BE ADJUSTED AS REQUIRED AS THE SITE BECOMES DEVELOPED.
 14. SEDIMENT CONTROL DEVICES SHALL BE CLEANED OF ACCUMULATED SEDIMENTATION AS REQUIRED AND REPLACED AS NECESSARY.
 15. DURING THE COURSE OF CONSTRUCTION, IF THE ENGINEER BELIEVES THAT ADDITIONAL PREVENTION METHODS ARE REQUIRED TO CONTROL EROSION AND SEDIMENTATION, THE CONTRACTOR SHALL IMPLEMENT ADDITIONAL MEASURES, AS REQUIRED, TO THE SATISFACTION OF THE ENGINEER.
 16. CONSTRUCTION AND MAINTENANCE REQUIREMENTS FOR EROSION AND SEDIMENT CONTROLS ARE TO COMPLY WITH OPS 805.
- INFILTRATION GALLERY NOTES:**
1. INFILTRATION GALLERY SHALL BE CONSTRUCTED TOWARDS THE END OF THE DEVELOPMENT CONSTRUCTION PERIOD IN ORDER TO NOT CONTAMINATE THE PRACTICE.
 2. SMEARING OF THE NATIVE MATERIAL AT THE INTERFACE WITH THE GALLERY FLOOR MUST BE AVOIDED AND/OR CORRECTED BY RAKING OR ROTO-TILLING.
 3. COMPACTION OF THE GALLERY BOTTOM MUST BE MINIMIZED.

NOTES

THE POSITION OF ALL POLE LINES, CONDUITS, WATERMANS, SEWERS AND OTHER UNDERGROUND AND OVERGROUND UTILITIES AND STRUCTURES IS NOT NECESSARILY SHOWN ON THE CONTRACT DRAWINGS, AND WHERE SHOWN, THE ACCURACY OF THE POSITION OF SUCH UTILITIES AND STRUCTURES IS NOT GUARANTEED. BEFORE STARTING WORK, DETERMINE THE EXACT LOCATION OF ALL SUCH UTILITIES AND STRUCTURES AND ASSUME ALL LIABILITY FOR DAMAGE TO THEM.

PROPERTY BOUNDARIES ARE DERIVED FROM PLAN OF SURVEY BLOCKS 1 AND 14 REGISTERED PLAN 4M-1566 CITY OF OTTAWA, STANTEC GEOMATICS LTD., ONTARIO LAND SURVEYORS. ELEVATIONS SHOWN ARE GEODETIC (CGVD-1928/1978) AND ARE DERIVED FROM THE CAN-NET VRS NETWORK MONUMENT; OTTAWA ELEVATION=95.230.

NO.	REVISION DESCRIPTION	DATE	BY
3	REVISED PER COMMENTS	07/03/24	BLM
2	REVISED PER COMMENTS	16/11/23	BLM
1	ISSUED FOR SITE PLAN APPLICATION	19/06/23	BLM

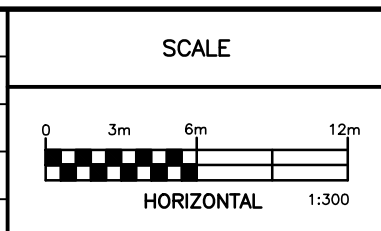

Robinson
Land Development

350 Palladium Drive
Ottawa, ON K2V 1A8
(613) 592-6060 roii.com

DESIGN	BLM
CHECKED	CC
DRAWN	BLM
CHECKED	CC
APPROVED	BLM

3095 PALLADIUM GP INC.
3095 PALLADIUM DRIVE
CITY OF OTTAWA

EROSION AND SEDIMENT CONTROL PLAN

PROJECT No.	23021
SURVEY	STANTEC
DATED	MARCH 2024
DWG. No.	23021-ESC1
PLAN No.	19021

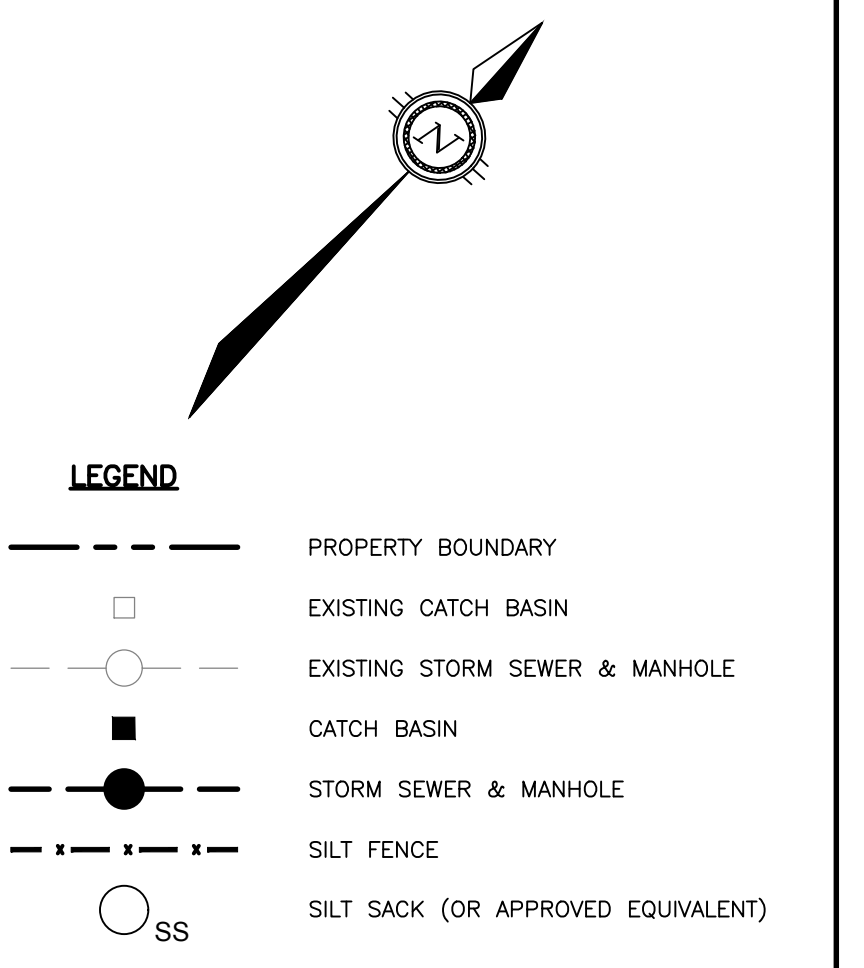
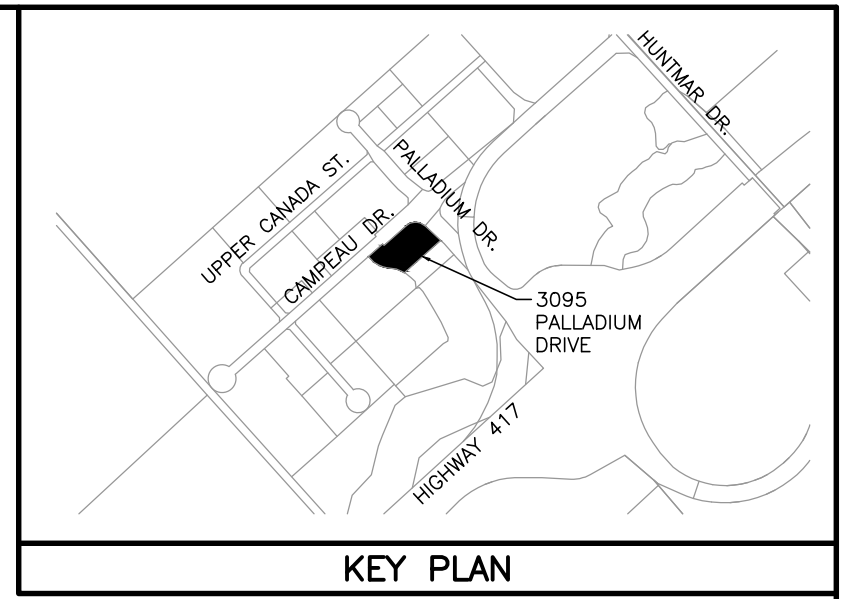
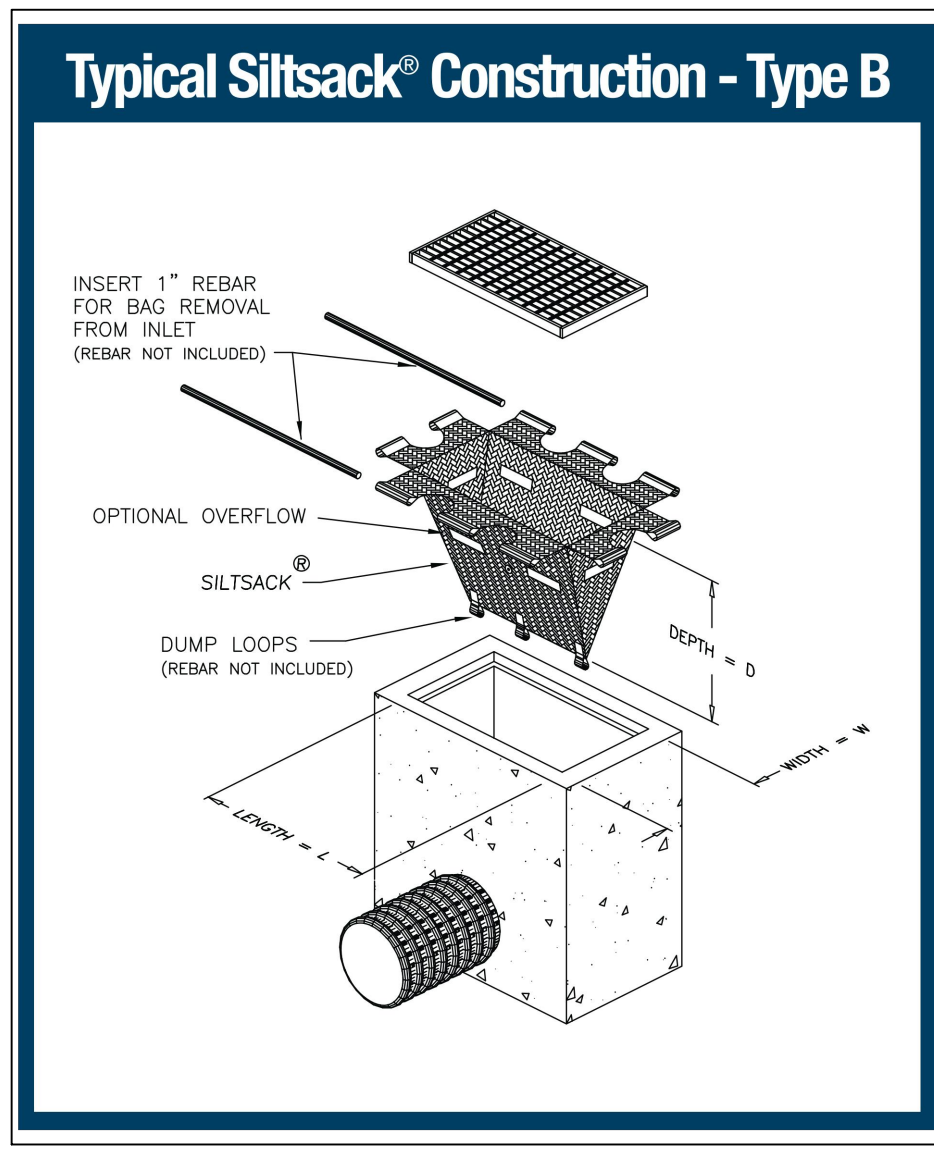
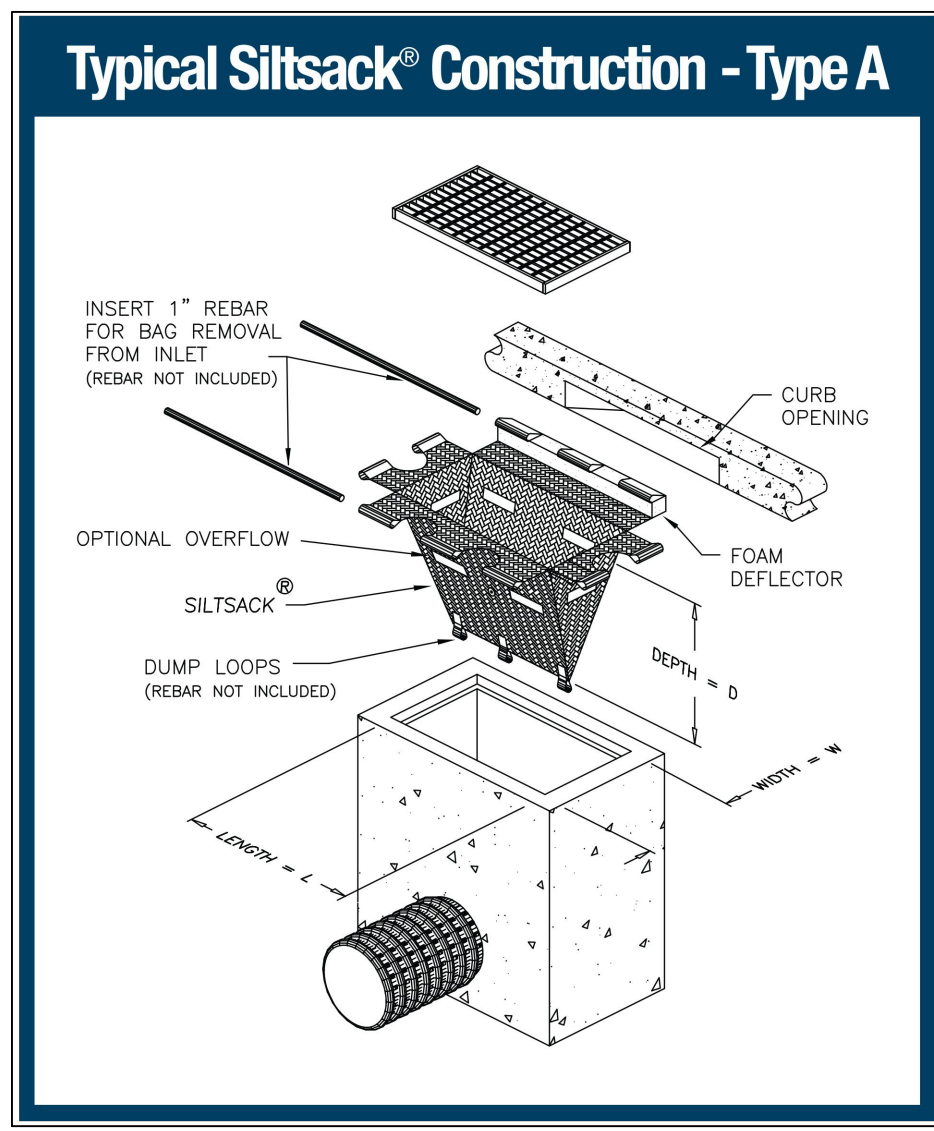

APPROVED
By Kersten Nitsche at 12:35 pm, Aug 06, 2024

Kersten Nitsche
KERSTEN NITSCHKE, MCIP RPP
MANAGER (A), DEVELOPMENT REVIEW WEST
PLANNING, DEVELOPMENT AND BUILDING SERVICES
DEPARTMENT, CITY OF OTTAWA

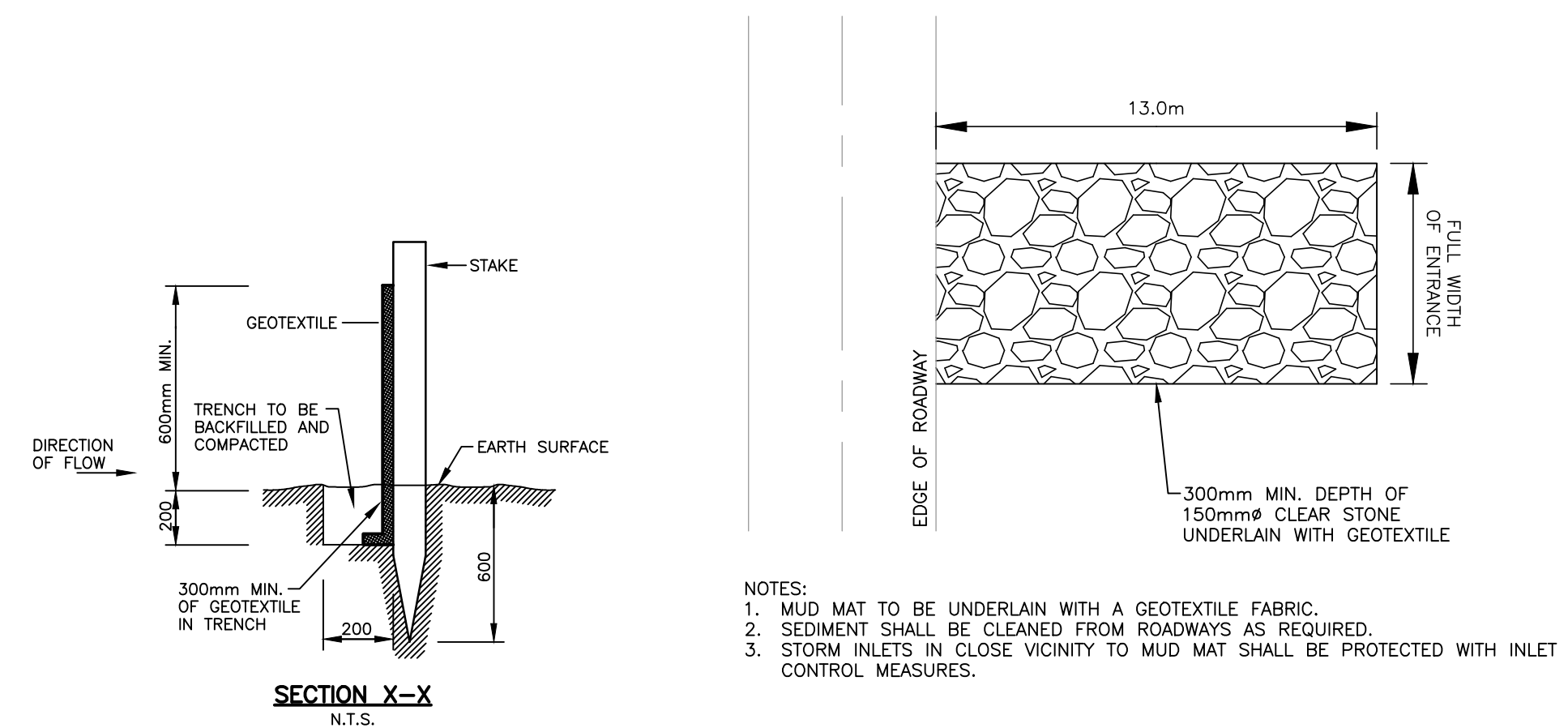

NOT FOR CONSTRUCTION

FILE No. D02-02-23-00568/D07-12-23-0092