



2023079 Innes Road - Electrical Drawing List
 INNES ROAD, OTTAWA, ONTARIO

DESCRIPTION	DRAWING NO.	SHEET NO.
Electrical Cover Page	E0.0	1
Electrical Legend, Single Line Diagram, Schedules & Details	E0.1	2
Electrical Site Lighting Photometrics	E1.0	3
Electrical Site Lighting Plan	E1.1	4



Design Works
Engineering

P: 780 244 0252 F: 780 244 0252
 Suite 1250 10130 103 St NW
 Edmonton, AB T5J 3N9
 info@designworksend.com
 www.designworksend.com

COPYRIGHT 2024
 DESIGN WORKS ENGINEERING LTD.

COPYRIGHT RESERVED

THESE DRAWINGS AND DESIGN ARE THE EXCLUSIVE PROPERTY OF DESIGN WORKS ENGINEERING LTD. AND MAY NOT BE REPRODUCED IN ANY WAY OR FORM WITHOUT THE DIRECT WRITTEN PERMISSION OF DESIGN WORKS ENGINEERING LTD.

NOTES

THIS DRAWING IS NOT TO BE USED FOR CONSTRUCTION UNLESS IT IS SIGNED AND SEALED, AND DRAWINGS HAVE BEEN ISSUED FOR CONSTRUCTION IN THE TABLE BELOW.

DO NOT SCALE THIS DRAWING.

No.	Description	Date
1	ISSUED FOR REVIEW 30%	2023-05-30
2	ISSUED FOR REVIEW 50%	2023-07-28
3	ISSUED FOR REVIEW 75%	2024-01-03
4	ISSUED FOR SPA REV.2	2024-02-22

ARCHITECT

CLIENT

	<small>PERMIT</small>
---	-----------------------

DRAWN BY: ACF

CHECKED BY: SHERRY KALDAS

ENGINEER: MOSES NORGA, P.ENG.

PROJECT #: 2023079

SCALE: AS NOTED

PROJECT

Innes Road

INNES ROAD, OTTAWA, ONTARIO

DESCRIPTION

**Electrical
Cover Page**

<small>DRAWING NO.</small> E0.0	<small>SHEET</small> 1 4
---	---------------------------------------

ELECTRICAL SYMBOL LEGENDS

LIGHTING / SWITCHING

Table with 2 columns: Symbol and Description. Includes various lighting fixtures like Surface Ceiling Mounted Luminaire, Wall Mounted Luminaire, and switches like Single Pole Switch, Three Way Switch, etc.

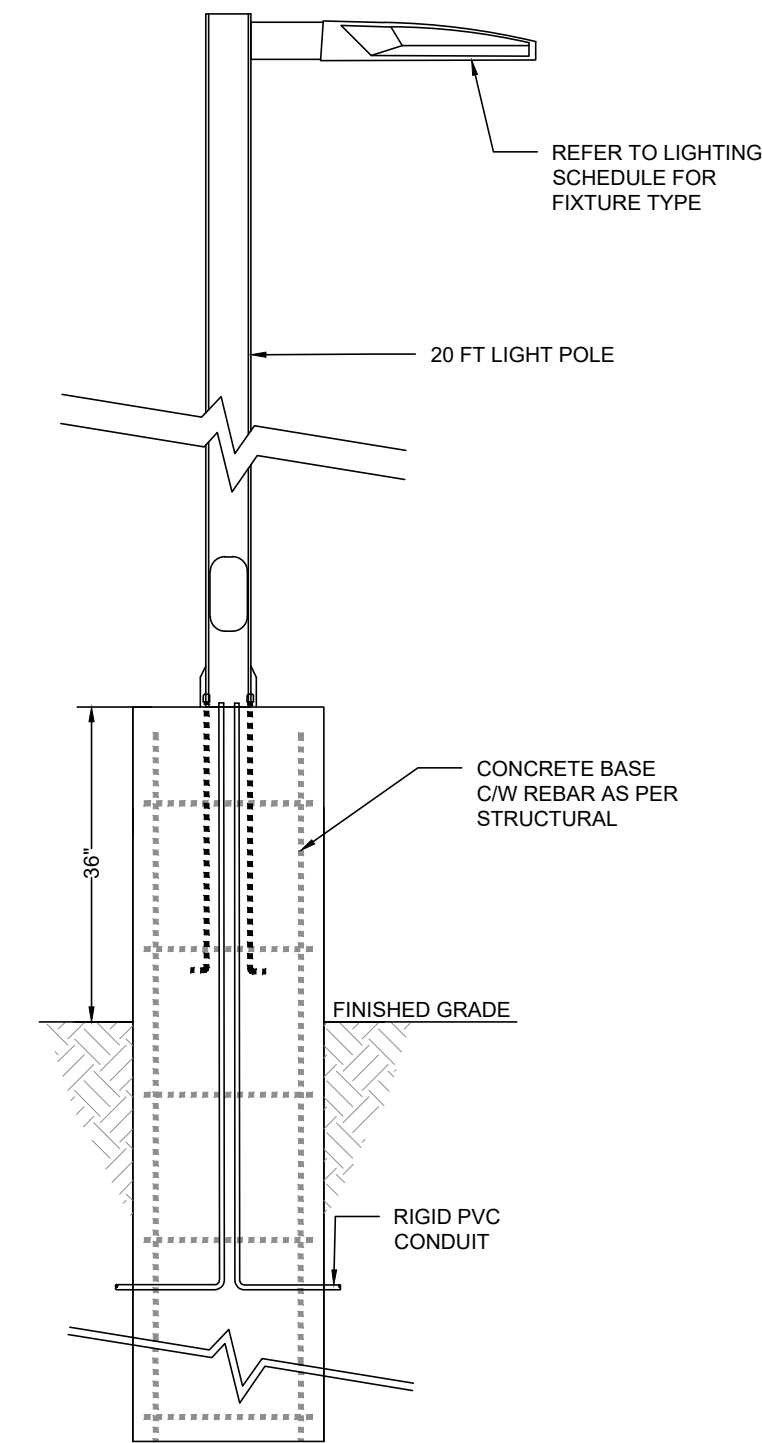

NOTE:
REFER TO STRUCTURAL DRAWINGS FOR STRUCTURAL REINFORCING AND ALL DIMENSIONS RELATED TO THE CONCRETE BASES.

2 Pole Mounted Luminaire Base Detail
E0.1 Scale NTS

Table with 2 columns: Component and Specification. Includes: LUMINAIRE: CROSSTOUR WALL MOUNT LED; LAMP: LED, 4000K; LUMENS: 6037 LM; BALLAST: LED DRIVER; HOUSING: -; LENS: -; INPUT WATTAGE: 58 W; MOUNTING: EXTERIOR WALL SURFACE; SPECIAL REQUIREMENTS: -; ACCEPTABLE PRODUCTS: LUMARK - XTOR8B-W (OR APPROVED EQUIVALENT); LUMINAIRE TYPE: 104.



Table with 2 columns: Component and Specification. Includes: LUMINAIRE: GALLEON AREA AND ROADWAY LUMINAIRE; LAMP: LED, 4000K; LUMENS: 14372 LM; BALLAST: -; HOUSING: -; LENS: -; INPUT WATTAGE: 113 W; MOUNTING: 20FT POLE; SPECIAL REQUIREMENTS: -; ACCEPTABLE PRODUCTS: McGRW-EDISON - GLEON-SA2C-740-U-T4W (OR APPROVED EQUIVALENT); LUMINAIRE TYPE: 110.



Table with 2 columns: Component and Specification. Includes: LUMINAIRE: CROSSTOUR WALL MOUNT LED; LAMP: LED, 5000K; LUMENS: 2134 LM; BALLAST: LED DRIVER; HOUSING: -; LENS: -; INPUT WATTAGE: 18.2 W; MOUNTING: EXTERIOR WALL SURFACE; SPECIAL REQUIREMENTS: -; ACCEPTABLE PRODUCTS: LUMARK - XTOR2B (OR APPROVED EQUIVALENT); LUMINAIRE TYPE: 111.



Table with 2 columns: Component and Specification. Includes: LUMINAIRE: GALLEON AREA AND ROADWAY LUMINAIRE; LAMP: LED, 4000K; LUMENS: 10490 LM; BALLAST: -; HOUSING: -; LENS: -; INPUT WATTAGE: 113 W; MOUNTING: 20FT POLE; SPECIAL REQUIREMENTS: -; ACCEPTABLE PRODUCTS: McGRW-EDISON - GLEON-SA2C-740-U-T4W-HSS (OR APPROVED EQUIVALENT); LUMINAIRE TYPE: 114.



3 Luminaire Schedules
E0.1 Scale NTS

DesignWorks Engineering logo and contact information: P: 780 244 0252 F: 780 244 0252, Suite 1250 10130 103 St NW, Edmonton, AB T5J 3N9, info@designworksend.com, www.designworksend.com. Copyright 2024, Design Works Engineering Ltd.

COPYRIGHT RESERVED
THESE DRAWINGS AND DESIGN ARE THE EXCLUSIVE PROPERTY OF DESIGN WORKS ENGINEERING LTD. AND MAY NOT BE REPRODUCED IN ANY WAY OR FORM WITHOUT THE DIRECT WRITTEN PERMISSION OF DESIGN WORKS ENGINEERING LTD.

NOTES
THIS DRAWING IS NOT TO BE USED FOR CONSTRUCTION UNLESS IT IS SIGNED AND SEALED, AND DRAWINGS HAVE BEEN ISSUED FOR CONSTRUCTION IN THE TABLE BELOW.
DO NOT SCALE THIS DRAWING.

Revision table with columns: No., Description, Date. Contains 4 revision entries.

ARCHITECT

CLIENT

Professional Engineer Seal: W. TOUMEH, 100604333, PROVINCE OF ONTARIO, Feb. 22 2024.

DRAWN BY: ACF
CHECKED BY: SHERRY KALDAS
ENGINEER: MOSES NORGA, P.ENG.
PROJECT #: 2023079
SCALE: AS NOTED

PROJECT
Innes Road
INNES ROAD, OTTAWA, ONTARIO

DESCRIPTION
Electrical Legend, Single Line Diagram, Schedules & Details

DRAWING NO. E0.1 SHEET 2/4



P: 780 244 0252 F: 780 244 0252
 Suite 1250 10130 103 St NW
 Edmonton, AB T5J 3N9
 info@designworksend.com
 www.designworksend.com
 COPYRIGHT 2024
 DESIGN WORKS ENGINEERING LTD.

COPYRIGHT RESERVED
 THESE DRAWINGS AND DESIGN ARE THE EXCLUSIVE PROPERTY OF DESIGN WORKS ENGINEERING LTD. AND MAY NOT BE REPRODUCED IN ANY WAY OR FORM WITHOUT THE DIRECT WRITTEN PERMISSION OF DESIGN WORKS ENGINEERING LTD.

NOTES
 THIS DRAWING IS NOT TO BE USED FOR CONSTRUCTION UNLESS IT IS SIGNED AND SEALED, AND DRAWINGS HAVE BEEN ISSUED FOR CONSTRUCTION IN THE TABLE BELOW.
 DO NOT SCALE THIS DRAWING.

No.	Description	Date
1	ISSUED FOR REVIEW 30%	2023-05-30
2	ISSUED FOR REVIEW 50%	2023-07-28
3	ISSUED FOR REVIEW 75%	2024-01-03
4	ISSUED FOR SPA REV.2	2024-02-22

ARCHITECT

CLIENT

SEAL

 PERMIT

DRAWN BY: ACF
 CHECKED BY: SHERRY KALDAS
 ENGINEER: MOSES NORGA, P.ENG.
 PROJECT #: 2023079
 SCALE: AS NOTED

PROJECT
Innes Road
 INNES ROAD, OTTAWA, ONTARIO

DESCRIPTION
Electrical Site Lighting Photometrics
 DRAWING NO. **E1.0** SHEET **3** OF **4**

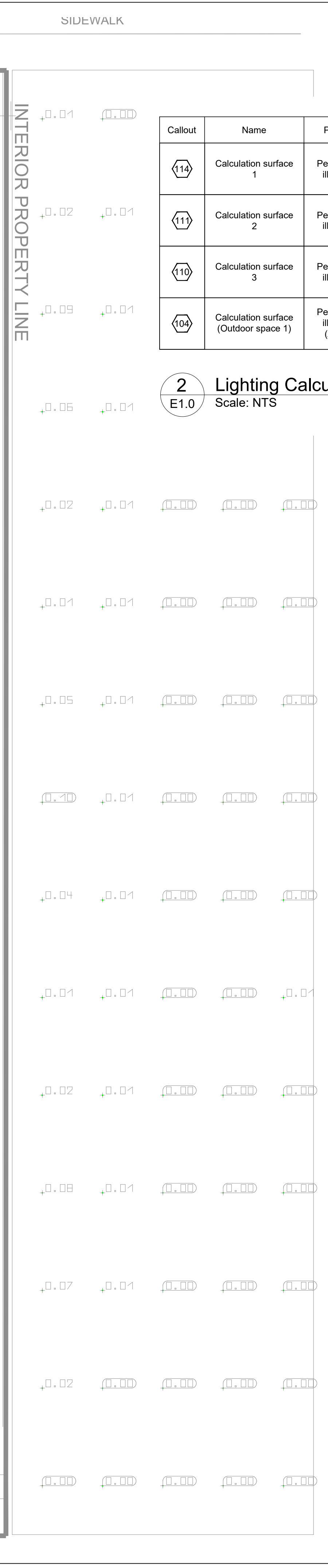
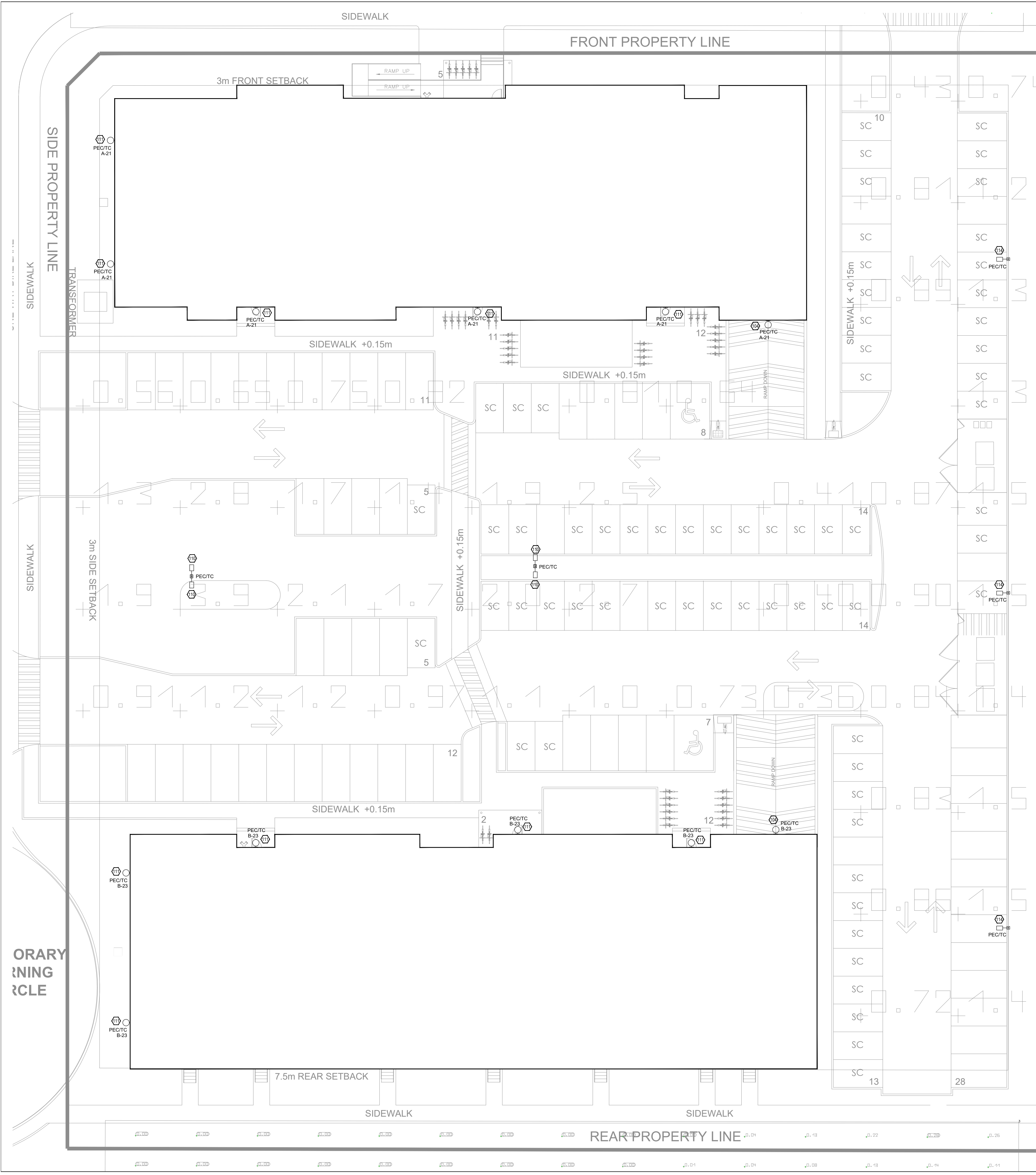

Callout	Name	Parameter	Min	Max	Average	Min/Average	Min/Max
114	Calculation surface 1	Perpendicular illuminance	0.001 fc	0.10 fc	0.011 fc	0.103	0.11
111	Calculation surface 2	Perpendicular illuminance	0.000 fc	0.12 fc	0.011 fc	0.00	0.00
110	Calculation surface 3	Perpendicular illuminance	0.000 fc	0.28 fc	0.026	0.00	0.00
104	Calculation surface (Outdoor space 1)	Perpendicular illuminance (Adaptive)	0.20 fc	5.30 fc	1.37 fc	0.142	0.037

2 Lighting Calculations
 Scale: NTS

1 Electrical Site Lighting Photometrics
 Scale: 1/16"=1'-0"

DOT-12-23-0095 #19033



P: 780 244 0252 F: 780 244 0252
 Suite 1250 10130 103 St NW
 Edmonton, AB T5J 3N9
 info@designworksend.com
 www.designworksend.com
 COPYRIGHT 2024
 DESIGN WORKS ENGINEERING LTD.

COPYRIGHT RESERVED

THESE DRAWINGS AND DESIGN ARE THE EXCLUSIVE PROPERTY OF DESIGN WORKS ENGINEERING LTD. AND MAY NOT BE REPRODUCED IN ANY WAY OR FORM WITHOUT THE DIRECT WRITTEN PERMISSION OF DESIGN WORKS ENGINEERING LTD.

NOTES

THIS DRAWING IS NOT TO BE USED FOR CONSTRUCTION UNLESS IT IS SIGNED AND SEALED, AND DRAWINGS HAVE BEEN ISSUED FOR CONSTRUCTION IN THE TABLE BELOW.
 DO NOT SCALE THIS DRAWING.

No.	Description	Date
1	ISSUED FOR REVIEW 30%	2023-05-30
2	ISSUED FOR REVIEW 50%	2023-07-28
3	ISSUED FOR REVIEW 75%	2024-01-03
4	ISSUED FOR SPA REV.2	2024-02-22

ARCHITECT

CLIENT

SEAL:

DRAWN BY: ACF
 CHECKED BY: SHERRY KALDAS
 ENGINEER: MOSES NORGA, P.ENG.
 PROJECT #: 2023079
 SCALE: AS NOTED

PROJECT
 Innes Road
 INNES ROAD, OTTAWA, ONTARIO

DESCRIPTION
 Electrical Site Lighting Plan
 DRAWING NO. **E1.1** SHEET **4** OF **4**

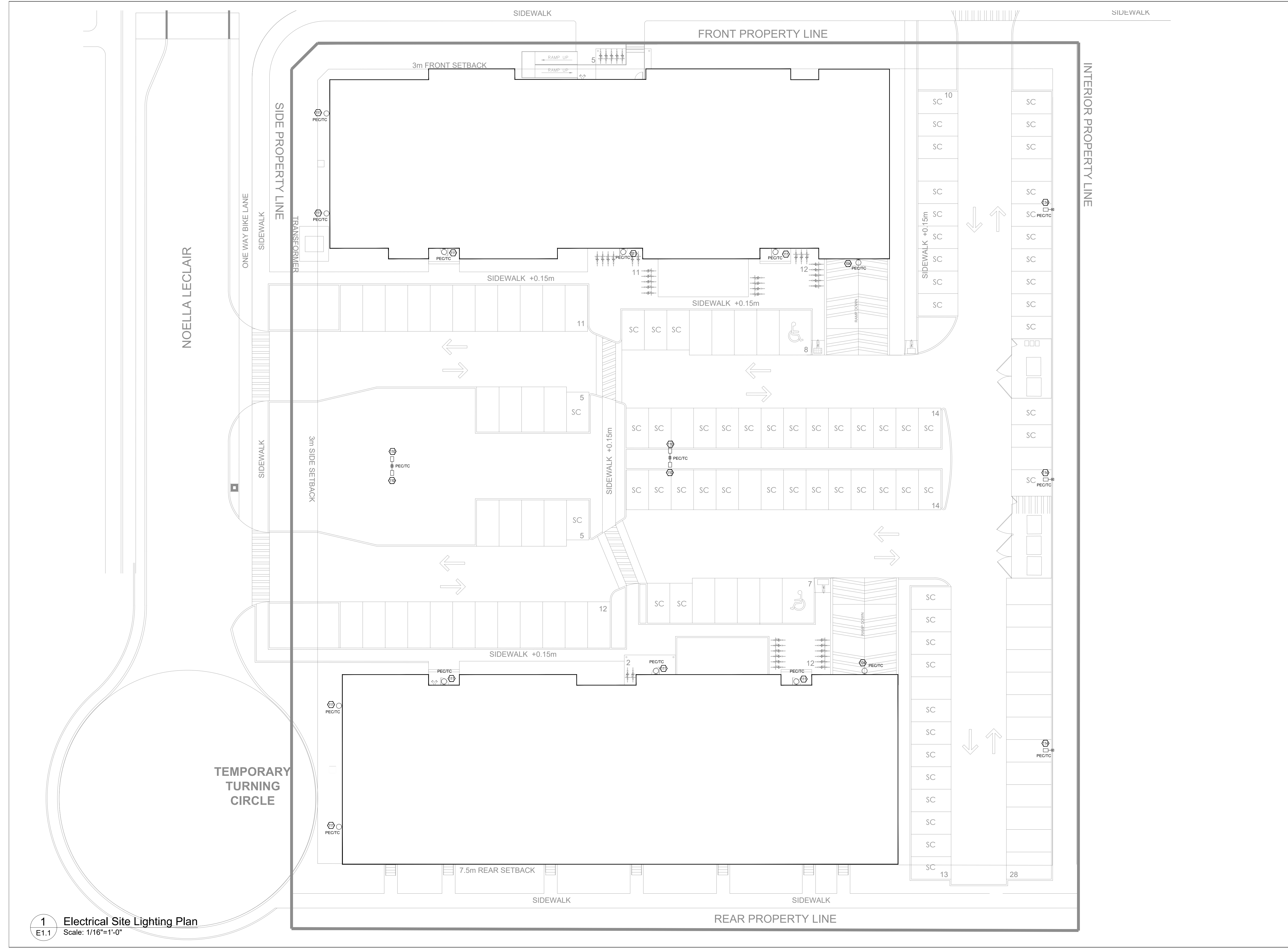

1 Electrical Site Lighting Plan
 Scale: 1/16"=1'-0"