



**SITE PLAN CONTROL APPLICATION  
DELEGATED AUTHORITY REPORT  
PLANNING, REAL ESTATE AND ECONOMIC DEVELOPMENT DEPARTMENT**

---

Site Location: 1095 Noëlla Leclair Street / 600 Lady Pellatt Street File

No.: D07-12-23-0095

Date of Application: June 23, 2023

---

This SITE PLAN CONTROL application submitted by Ironclad Developments Incorporated (c/o Michael Kubasiewicz), on behalf of Innes Shopping Centres Limited, is APPROVED as shown on the following plan(s):

1. **Site Plan**, DP02, prepared by Robert Garvey, Ironclad Developments Inc., dated 23.06.22, revision 3 dated 24.01.11.
2. **General Project Info**, DP01, prepared by Robert Garvey, Ironclad Developments Inc., dated 23.06.22, revision 2 dated 24.01.03.
3. **Site Servicing Plan**, C-1, prepared by D.B. Gray Engineering Inc., dated June 12-23, revision 3 dated Dec 15-23.
4. **Grading Plan**, C-2, prepared by D.B. Gray Engineering Inc., dated June 12-23, revision 3 dated Dec 15-23.
5. **Erosion & Sediment Control Plan**, C-3, prepared by D.B. Gray Engineering Inc., dated June 12-23, revision 3 dated Dec 15-23.
6. **Notes**, C-4, prepared by D.B. Gray Engineering Inc., dated June 12-23, revision 3 dated Dec 15-23.
7. **Details & Schedules**, C-5, prepared by D.B. Gray Engineering Inc., dated June 12-23, revision 3 dated Dec 15-23.
8. **Drainage Plan**, C-6, prepared by D.B. Gray Engineering Inc., dated June 12-23, revision 3 dated Dec 15-23.
9. **Ramp Section Typical**, Drawing No. DP18, Project Number: 2133, prepared by Rob Garvey Architecture 77 inc., Revision 2, dated February 29, 2024
10. **Building A-Elevations**, DP08, prepared by Robert Garvey, Ironclad Developments Inc., dated 23.06.22, revision 2 dated 24.01.03.
11. **Building B-Elevations**, DP09, prepared by Robert Garvey, Ironclad Developments Inc., dated 23.06.22, revision 2 dated 24.01.03.

12. **Landscape / Planting Plan**, L-01, prepared by Ruhland & Associates Limited, dated 23/06/21, revision 2 dated 23/12/21.
13. **Details**, L-02, prepared by Ruhland & Associates Limited, dated 23/06/21, revision 2 dated 23/12/21.
14. **Details**, L-03, prepared by Ruhland & Associates Limited, dated 23/06/21, revision 2 dated 23/12/21.

And as detailed in the following report(s):

1. **Site Servicing& Stormwater Management Report**, prepared by D.B. Gray Engineering Inc., dated December 15, 2023.
2. **Phase One Environmental Site Assessment**, prepared by EXP Services Inc., dated 2023-10-05.
3. **Environmental Noise Control Study**, prepared by Paterson Group, dated June 21, 2023.
4. **Geotechnical Investigation – Proposed Multi-Storey Apartment Buildings**, prepared by Paterson Group, dated July 29, 2022.
5. **Transportation Impact Assessment**, prepared by Dillon Consulting, dated June 2023.
6. **Planning Rationale & Design Brief**, prepared by Ironclad Developments Inc., dated June 22, 2023.

And subject to the following Requirements, General and Special Conditions:

## **Requirements**

1. The Owner shall submit a certificate of insurance in a form satisfactory to the City. The certificate of insurance must be issued in favor of the City of Ottawa in an amount not less than five million dollars per occurrence, must contain an endorsement naming the City as an additional insured and an unconditional thirty days notice of any material change or cancellation of the policy.

## **General Conditions**

### 1. **Execution of Agreement Within One Year**

The Owner shall enter into this Site Plan Control Agreement, including all standard and special conditions, financial and otherwise, as required by the City. In the event that the Owner fails to sign this Agreement and complete the conditions to be satisfied prior to the signing of this Agreement within one (1) year of Site Plan approval, the approval shall lapse.

## **2. Barrier Curbs**

The Owner acknowledges and agrees that the parking areas and entrances shall have barrier curbs and shall be constructed in accordance with the drawings of a design professional, such drawings to be approved by the General Manager, Planning, Development and Building Services Department.

## **3. Water Supply for Fire Fighting**

The Owner shall provide adequate water supply for fire fighting for every building. Water supplies may be provided from a public water works system, automatic fire pumps, pressure tanks or gravity tanks.

## **4. Reinstatement of City Property**

The Owner shall reinstate, at its expense and to the satisfaction of the General Manager, Planning, Development and Building Services Department, any property of the City, including, but not limited to, sidewalks, curbs and boulevards, which is damaged as a result of the subject development.

## **5. Construction Fencing**

The Owner acknowledges and agrees to install construction fencing, at its expense, in such a location as may be determined by the General Manager, Planning, Development and Building Services Department.

## **6. Construct Sidewalks**

The Owner shall design and construct sidewalk(s) within public rights-of-way or on other City owned lands to provide a pedestrian connection from or to the site as may be determined by the General Manager, Planning, Development and Building Services Department. Such sidewalk(s) shall be constructed to City Standards.

## **7. Extend Internal Walkway**

The Owner shall extend internal walkways beyond the limits of the subject lands to connect to existing or proposed public sidewalks, at the sole expense of the Owner, to the satisfaction of the General Manager, Planning, Development and Building Services Department.

## **8. Completion of Works**

The Owner acknowledges and agrees that no new building will be occupied on the lands until all requirements with respect to completion of the Works as identified in this Agreement have been carried out and received Approval by the General Manager, Planning, Development and Building Services Department, including the installation of municipal numbering provided in a permanent location visible during both day and night and the installation of any street name sign on relevant streets. Notwithstanding the non-completion of the foregoing Works, occupancy of a lot or

structure may otherwise be permitted, if in the sole opinion of the General Manager, Planning, Development and Building Services Department, the aforesaid Works are proceeding satisfactorily toward completion. The Owner shall obtain the prior consent of the General Manager, Planning, Development and Building Services Department for such occupancy in writing.

Until all requirements with respect to completion of the Works as identified in this Agreement have been carried out and received Approval by the General Manager, Planning, Development and Building Services Department, the Owner shall give notice to the City of a proposed conveyance of title to any building at least thirty (30) days prior to any such conveyance. No conveyance of title to any building shall be effective unless the Owner has complied with this provision.

Nothing in this clause shall be construed as prohibiting or preventing the approval of a consent for severance and conveyance for the purposes of obtaining financing.

#### **9. Development Charges**

The Owner shall pay development charges to the City in accordance with the by laws of the City.

### **Special Conditions**

#### **10. Professional Engineering Inspection**

The Owner shall have competent Professional Engineering inspection personnel on-site during the period of construction, to supervise the Works, and the General Manager, Planning, Real Estate and Economic Development, shall have the right at all times to inspect the installation of the Works. The Owner acknowledges and agrees that should it be found in the sole opinion of the General Manager, Planning, Real Estate and Economic Development, that such personnel are not on-site or are incompetent in the performance of their duties, or that the said Works are not being carried out in accordance with the approved plans or specifications and in accordance with good engineering practice, then the General Manager, Planning, Real Estate and Economic Development, may order all Work in the project to be stopped, altered, retested or changed to the satisfaction of the General Manager, Planning, Real Estate and Economic Development.

### **Access**

#### **11. Private Approach Detail**

The Owner acknowledges and agrees that all private approaches serving the proposed development shall be designed and constructed, at the sole expense of the Owner, in accordance with the City's "Curb Return Entrances – Uncontrolled Intersections" Plan, Drawing No. SC7.1, dated March 2007 and revised March 2021, and the Owner shall comply with the City's Private Approach By-law, being No. 2003-447, as amended.

12. **Private Access**

The Owner acknowledges and agrees that all private accesses to Roads shall comply with the City's Private Approach By-Law being By-Law No. 2003-447 as amended, or as approved through the Site Plan control process.

**Noise**

13. **Notice on Title – Noise Control Attenuation Measures**

The Owner acknowledges and agrees that a notice shall be registered on title to the subject lands, at the Owner's expense. The Owner further acknowledges and agrees that such notice on title, or the clauses as written directly below, shall be included in all agreements of purchase and sale and lease agreements to inform prospective purchasers and tenants of these matters. The notice on title shall include, but not be limited to, the following:

The Owner, or any subsequent owner of the whole or any part of the subject lands, acknowledges and agrees that all agreements of purchase and sale or lease agreements shall contain the following clauses, which shall be covenants running with the subject lands:

**To be applied to each unit along the southern elevation of Building B.**

Type C – Forced Air Heating System and Ducting

"The purchaser/lessee for themselves, their heirs, executors, administrators, successors and assigns, acknowledges being advised that this dwelling unit has been fitted with a forced air heating system and the ducting, etc. was sized to accommodate central air conditioning. Installation of central air conditioning by the purchaser/lessee will allow windows and exterior doors to remain closed, thereby ensuring that the indoor sound levels are within the City of Ottawa's and the Ministry of the Environment, Conservation and Parks' noise criteria."

"The purchaser/lessee for themselves, their heirs, executors, administrators, successors and assigns, acknowledges and agrees it shall identify the location and install any outdoor air conditioning device(s) so as to comply with the noise criteria of the Ministry of the Environment, Conservation and Parks' Publication NPC-216, dated 1993, and the Environmental Noise Guidelines for Installation of Residential Air Conditioning Devices, dated September 1994, as amended, in order to minimize the noise impacts both on and off the immediate vicinity of the subject lands."

Ending Paragraph

"The purchaser/lessee covenants with the vendor/lessor that the above clauses, verbatim, shall be included in all subsequent agreements of purchase and sale and lease agreements for the lands described herein, which covenant shall run with the said lands."

**ENGINEERING**

## **Geotechnical Engineering and Soils**

### **14. Geotechnical Investigation**

The Owner acknowledges and agrees that it shall retain the services of a geotechnical engineer, licensed in the Province of Ontario, to ensure that the recommendations of the **Geotechnical Investigation** (the "Report"), referenced in Schedule "E" herein, are fully implemented. The Owner further acknowledges and agrees that it shall provide the General Manager, Planning, Development and Building Services Department with confirmation issued by the geotechnical engineer that the Owner has complied with all recommendations and provisions of the Report, prior to construction of the foundation and at the completion of the Works, which confirmation shall be to the satisfaction of the General Manager, Planning, Development and Building Services Department.

### **15. Notice on Title – Below Grade Parking Areas and Depressed Driveways**

The Owner acknowledges and agrees that a notice shall be registered on title to the subject lands, at the Owner's expense. The Owner further acknowledges and agrees that such notice on title, or the clauses as written directly below, shall be included in all agreements of purchase and sale and lease agreements to inform prospective purchasers and tenants of these matters. The notice on title shall include, but not be limited to, the following:

The Owner, or any subsequent owner of the whole or any part of the subject lands, acknowledges and agrees that all agreements of purchase and sale or lease agreements shall contain the following clauses, which shall be covenants running with the subject lands:

"The purchaser/lessee for themselves, their heirs, executors, administrators, successors and assigns, acknowledges being advised that during major storm events, depressed driveways and below grade parking areas may be subject to flooding due to drainage from the road allowance. The purchaser/lessee further acknowledges being advised that the City of Ottawa shall not be liable for flooding claims. Backwater valves are recommended for installation on catch basins located in depressed driveways."

"The purchaser/lessee covenants with the vendor/lessor that the above clauses, verbatim, shall be included in all subsequent agreements of purchase and sale and lease agreements for the lands described herein, which covenant shall run with the said lands."

### **16. Protection of City Sewers**

[Prior to the issuance of a building permit, the Owner shall, at its expense:

- (i) obtain a video inspection of the City Sewer System within Noella Leclair Way and Lady Pellatt Street prior to any construction to determine the condition of the existing City Sewer System prior to construction on

the lands and to provide said video inspection to the General Manager, Planning, Development and Building Services Department.

(b) Upon completion of construction on the lands, the Owner shall, at its expense and to the satisfaction of the General Manager, Planning, Development and Building Services Department:

- (i) obtain a video inspection of the existing City Sewer System within Noella Leclair Way and Lady Pellatt Street to determine if the City Sewer System sustained any damages as a result of construction on the lands; and
- (ii) assume all liability for any damages caused to the City Sewer System within Noella Leclair Way and Lady Pellatt Street and compensate the City for the full amount of any required repairs to the City Sewer System.

17. **Stormwater Works Certification**

Upon completion of all stormwater management Works, the Owner acknowledges and agrees to retain the services of a Professional Engineer, licensed in the Province of Ontario, to ensure that all measures have been implemented in conformity with the approved Plans and Reports, referenced in Schedule "E" herein. The Owner further acknowledges and agrees to provide the General Manager, Planning, Development and Building Services Department with certificates of compliance issued by a Professional Engineer, licensed in the Province of Ontario, confirming that all recommendations and provisions have been implemented in accordance with the approved Plans and Reports referenced in Schedule "E" herein.

18. **Inlet Control Devices (ICDs)**

The Owner acknowledges and agrees to install and maintain in good working order the required in-ground stormwater inlet control devices, as recommended in the approved Site Servicing & Stormwater Management Report, referenced in Schedule "E" herein. The Owner further acknowledges and agrees it shall assume all maintenance and replacement responsibilities in perpetuity. The Owner shall keep all records of inspection and maintenance in perpetuity, and shall provide said records to the City upon its request.

**Private Systems**

19. **Water Plant**

The Owner acknowledges and agrees that the water plant within the lands is a private watermain. The Owner further acknowledges and agrees that the private watermain and appurtenances thereto are to be maintained by the Owner at its own expense, in perpetuity. The Owner performing maintenance on critical infrastructure, such as private watermains and private fire hydrants, shall maintain adequate records as proof of having done so in accordance with applicable regulations, and

that the records shall be retained for review by the City and or the Ottawa Fire Services when requested.

20. **Private Storm Sewer Connection to City Sewer System**

The Owner acknowledges and agrees that any new storm sewers to be installed as part of this development shall not be connected to the City's existing storm sewer system until such time as either:

- (a) a certificate of conformance and As-built Drawings have been received from a Professional Engineer, licensed in the Province of Ontario, certifying that all required inlet control devices have been properly installed to City Standards or Specifications, and that the storm sewer system has been installed in accordance with the approved engineering drawings for site development and City Sewer Design Guidelines. The inlet control devices shall be free of any debris; or
- (b) a flow limiting orifice plate, designed by a Professional Engineer licensed in the Province of Ontario and to the satisfaction of the City, has been installed at the storm water outlet prior to connecting any upstream storm sewers. Such orifice plate shall not be removed until subsection (a) above has been satisfied and approved by the General Manager, Planning, Development and Building Services Department.

21. **Leak Survey**

The Owner acknowledges and agrees that the Water Plant and sewer service within the lands is a private system, including Private Services and sewer services and appurtenances, and the Owner acknowledges and agrees that it is responsible for the operation, maintenance and/or replacement, in perpetuity, of the Private Services and sewer system, including private sanitary and storm sewer infrastructure (collectively the "private system") which are located on the lands and that the Owner will retain copies of all the associated Work and maintenance contracts, and make said contracts available for inspection upon demand by the City.

Further, the Owner acknowledges and agrees to have a Professional Engineer, licensed in the Province of Ontario, conduct regular inspections of the sewer system, which includes and a video of the sanitary sewer system to check for major water infiltration into the private system. Copies of the inspection reports and videos shall be provided to the General Manager, Infrastructure. The Owner further acknowledges and agrees that as part of the Owner's ongoing maintenance responsibility for the private system, repairs to the system must be completed immediately to correct any deficiencies which contribute to leakage of infiltration within the private system. Any deficiencies shall be immediately reported to the City. The Owner acknowledges and agrees to notify the General Manager, Infrastructure and Water Services when such repairs have been completed.



22. **Site Dewatering**

The Owner acknowledges and agrees that while the site is under construction, any water discharged to the sanitary sewer due to dewatering shall meet the requirements of the City's Sewer Use By-law No. 2003-514, as amended.

**Blasting**

23. **Use of Explosives and Pre-Blast Survey**

The Owner acknowledges and agrees that all blasting activities will conform to the City's Standard S.P. No. F-1201 entitled Use of Explosives, as amended. Prior to any blasting activities, a pre-blast survey shall be prepared as per S.P. No. F-1201, at the Owner's expense, for all buildings, utilities, structures, water wells and facilities likely to be affected by the blast based on the location where explosives are to be used. In particular, a pre-blast survey shall be completed in accordance with Table 1 of S.P. No. F-1201. The standard inspection procedure shall include the provision of an explanatory letter to the owner or occupant and owner with a formal request for permission to carry out an inspection.

**Site Lighting**

24. **Site Lighting Certificate**

- (a) In addition to the requirements contained in Clause 19 of Schedule "C" hereto, the Owner acknowledges and agrees, prior to the issuance of a building permit, to provide the City with a certificate from an acceptable professional engineer, licensed in the Province of Ontario, which certificate shall state that the exterior site lighting has been designed to meet the following criteria:
  - (i) it must be designed using only fixtures that meet the criteria for full cut-off (sharp cut-off) classification, as recognized by the Illuminating Engineering Society of North America (IESNA or IES); and
  - (ii) it must result in minimal light spillage onto adjacent properties. As a guideline, 0.5 fc is normally the maximum allowable spillage.
- (b) The Owner acknowledges and agrees that, upon completion of the lighting Works and prior to the City releasing any associated securities, the Owner shall provide certification satisfactory to the General Manager, Planning, Development and Building Services Department, from a Professional Engineer, licensed in the Province of Ontario, that the site lighting has been constructed in accordance with the Owner's approved design plan.

**PLANNING AND OTHER**

**Planning and Design**

25. **Exterior Elevations Drawings**

The Owner acknowledges and agrees to construct the proposed building in accordance with the approved Building Elevations, referenced in Schedule "E" herein. The Owner further acknowledges and agrees that any subsequent proposed

changes to the approved plans shall be filed with the General Manager, Planning, Development and Building Services Department and agreed to by both the Owner and the City prior to the implementation of such changes. No amendment to this Agreement shall be required.

26. **Maintenance and Liability Agreement for Landscaping**

The Owner acknowledges and agrees it shall be required to enter into a Maintenance and Liability Agreement with the City, for those elements which are to be located in the City's Noella Leclair Way and Lady Pellatt Street rights-of-way, as shown on the approved Landscape Plan referenced in Schedule "E" herein, including all plant and landscaping material (except municipal trees), and precast pavers. The Maintenance and Liability Agreement shall be registered on title, at the Owner's expense, immediately after the registration of this Agreement. The Owner shall assume all maintenance and replacement responsibilities in perpetuity.

**Waste Collections**

27. **Waste Collection**

The Owner acknowledges and agrees that residential cart (and/or container) garbage, recycling, and organic waste collection will be provided by the City from a centralized refuse room or area. The Owner shall provide, at its own expense, adequate storage for the containers and carts and acknowledges it is recommended that they be placed on a concrete floor. The Owner shall provide an adequately constructed road for direct access to the garbage/recycling/organic waste storage room or area suitable for garbage/recycle/organic waste collection vehicles. Any additional services (i.e. winching of containers) may result in extra charges.

**Signs**

28. **Street Name and Signs**

- (a) The Owner acknowledges and agrees it shall provide for, install and maintain, at its own expense, all regulatory traffic signage, in accordance with the City's Municipal Addressing By-law 2014-78, as amended, for any private road within the area controlled by this Agreement and as shown on the approved Site Plan, referenced in Schedule "E" herein.
- (b) The Owner acknowledges and agrees it shall provide for, install and maintain, at its own expense, all temporary street name signs, in accordance with the City's Municipal Addressing By-law 2014-78, as amended, for any private road within the area controlled by this Agreement and the approved Site Plan, referenced in Schedule "E" herein.

**Community Benefits Charge**

29. **Community Benefits Charge**

The Owner acknowledges that the development is subject to payment of a Community Benefits Charge estimated to be \$128,000, payable at the time of building permit issuance, calculated in accordance with the Community Benefits

Charge By-law 2022-307 (as amended from time to time) and the Planning Act (the “CBC Estimate”).

For the purposes of calculating the CBC Estimate, the City has utilized a property valuation which has an effective date of the date of the site plan approval and the currently proposed area subject to development or redevelopment. The Owner acknowledges that the City will collect the CBC Estimate amount at the time of building permit issuance provided (a) the first building permit is issued within twenty-four months of the date of the present site plan approval and (b) the land area subject to development or redevelopment has not changed.

Should the first building permit not be issued within twenty-four months, an updated valuation of the land that is the subject of development or redevelopment will be provided by the City prior to building permit issuance, or earlier if requested by the Owner. The Owner further acknowledges that if the land area shown in any subsequent building permit application(s) as being subject to development or redevelopment differs from the land area shown in the Site Plan as being subject to development or redevelopment, the above-indicated amount may be recalculated based on the land area shown in the building permit application(s).

## **CONVEYANCES TO CITY**

### **30. Pedestrian Easement**

Prior to the registration of this Agreement, the Owner shall grant to the City, at no cost to the City, an unencumbered 3.0 metre easement for Pedestrian access along southern edge of the site, as shown on the approved Site Plan referenced in Schedule “E” hereto, if applicable, to the satisfaction of the City. The Owner shall provide a Reference Plan for registration, indicating the Pedestrian easement, to the City Surveyor for review and approval prior to its deposit in the Land Registry Office. Such reference plan must be tied to the Horizontal Control Network in accordance with the municipal requirements and guidelines for referencing legal surveys. The Owner acknowledges and agrees to provide an electronic copy of the Transfer and a copy of the deposited reference plan to the City Solicitor prior to registration of the easement. All costs shall be borne by the Owner.

## **AGENCIES**

### **School**

### **31. Notice on Title – School Accommodation**

The Owner acknowledges and agrees that a notice shall be registered on title to the subject lands, at the Owner’s expense. The Owner further acknowledges and agrees that such notice on title, or the clauses as written directly below, shall be included in all agreements of purchase and sale and lease agreements to inform prospective purchasers and tenants of these matters. The notice on title shall include, but not be limited to, the following:

The Owner, or any subsequent owner of the whole or any part of the subject lands, acknowledges and agrees that all agreements of purchase and sale or lease agreements shall contain the following clauses, which shall be covenants running with the subject lands:

“The purchaser/lessee for themselves, their heirs, executors, administrators, successors and assigns, acknowledges being advised that the Ottawa-Carleton District School Board has pupil accommodation concerns for this dwelling unit. The purchaser/lessee agrees to inform prospective purchasers or tenants in all subsequent agreements of purchase and sale and lease agreements that school accommodation pressures exist in the Ottawa-Carleton District School Board, which are currently being addressed by the utilization of portable classrooms and/or by directing students to school outside their community.”

“The purchaser/lessee covenants with the vendor/lessor that the above clauses, verbatim, shall be included in all subsequent agreements of purchase and sale and lease agreements for the lands described herein, which covenant shall run with the said lands.”

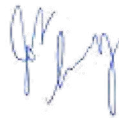

May 22, 2024

Date

\_\_\_\_\_  
John Sevigny  
Manager, Development Review East,  
Planning, Development and Building Services  
Department

Enclosure: Site Plan Control Application approval – Supporting Information



## SITE PLAN CONTROL APPROVAL APPLICATION SUPPORTING INFORMATION

---

**File Number:** D07-12-23-0095

### **SITE LOCATION**

The site is located at the southeast corner of Noëlla Leclair Street and Lady Pellatt Street, as shown on Document 1.

### **SYNOPSIS OF APPLICATION**

The 0.92-hectare site is currently vacant and relatively flat. The property is part of a larger subdivision (File No. D07-16-18-0006). This area is being redeveloped with a mix of residential and commercial uses.

Surrounding land uses include vacant lands to the north and west zoned Arterial Mainstreet and designated Mixed-Use Area designation under the East Urban Community Phase 3 Secondary Plan. There are undeveloped lands to the south zoned Industrial and designated Employment Lands designation. At the northwest corner of Lady Pellatt Street and the future extension of Vanguard Drive to the east of the site is a triangular parcel to be rezoned and dedicated to the City as public park under the Plan of Subdivision mentioned above (D07-16-18-0006). The site is south-east of the intersection of Innes Road and Mer Bleue Road, and the wider area context includes large-format retail south of Innes Road and the Queenswood Heights residential subdivision further north of Innes. Noëlla Leclair Street will end in a temporary turning circle adjacent to the site's south-east corner until development proceeds further south of the site.

The proposed development consists of two six-storey, mid-rise residential buildings containing a total of 157 dwelling units. Each residential building includes a mix of bachelor (12 between Buildings A and B), one-bedroom (48), two-bedroom (75), and three-bedroom units (22). Private balconies are provided for private amenity spaces for each unit. The residential buildings are oriented east-west on the perimeter of the subject site. There will be a landscaped outdoor amenity area facing Noëlla LeClair Way and surface parking provided between the two buildings.

Building A will present a front façade to Lady Pellatt Street with the elevation articulated by strong vertical elements to break up the perceived width of the building mass, and the main entrance highlighted by a prominent canopy. A similar treatment is reflected for the main entrance of Building B, which faces the courtyard between the two buildings. The south elevation of Building B, facing the pedestrian corridor along the southern part of the site, includes ground-floor units with patios and individual entrances from the

sidewalk. This pedestrian walkway is part of a public pathway system that will connect Noella Leclair Way with the future park to the east. This walkway will have a pedestrian easement but will not be cleared or maintained in the winter months. Waste management is provided through screened garbage and recycling bins external to the buildings and located near the eastern property line.

The developer received permission for a minor variance (File No. D08-02-24/A-00021) from the Committee of Adjustment on March 15, 2024 to permit a reduced parking space rate of 1.04 per dwelling unit for a total of 164 parking spaces. The Zoning By-law normally requires 1.2 parking spaces per dwelling units for mid-rise apartment buildings within Area C of Schedule 1A, which in this circumstance would have required 188 vehicle parking spaces. The variance was granted on the basis that the reduction in parking was in line with the wider development of a mixed-use subdivision and the Official Plan policies that encourage a shift away from automobile-centred development and an increase in soft landscaped areas and tree canopy. Given this variance, a total of 195 vehicle parking spaces are provided on the site. There are 127 surface level vehicle parking spaces and then 68 vehicle parking spaces divided equally in two underground parkades located underneath Buildings A and B. Four of the provided vehicle parking spaces are considered accessible, 31 spaces are for visitors and 73 parking spaces are designed for small vehicles.

Further, a total of 82 bicycle parking spaces are provided: there are 42 surface level bicycle parking spaces throughout the site and 18 wall mounted bicycle stalls in Building A's parkade and 22 wall mounted bicycle stalls Building B's parkade.

Both buildings will be serviced through the existing Noella Leclair Way municipal watermain and an existing municipal sanitary sewer on Lady Pellatt Street. The proposed development is expected to have an acceptable impact on the Lady Pellatt Street municipal storm sewer.

### **Residential Units and Types**

<b>Dwelling Type</b>	<b>Number of Units</b>
Apartment	157

### **Related Applications**

The following application is related to this proposed development:

- Plan of Subdivision – D07-16-18-0006.

### **DECISION AND RATIONALE**

This application is approved for the following reasons:

- The proposed development is in conformity with the relevant policies of the Official Plan (2022) and the East Urban Community Phase 3 Secondary Plan. The site is

designated Neighbourhood and is within the Evolving Neighbourhood Overlay of the Official Plan. The site is further designated Mixed Used Area under the East Urban Community Phase 3 Secondary Plan and related Community Design Plan.

- The proposed development conforms to the provisions of the Arterial Mainstreet (Exception 2414) Height 40 Zone (AM[2414]H(40)).
- The proposed site design represents good planning for this future mixed-use community.

## **PARKLAND DEDICATION**

Parkland dedication, in accordance with By-law 2022-280, was previously satisfied through the related plan of subdivision approval.

## **CONSULTATION DETAILS Councillor's**

### **Comments**

Councillor Catherine Kitts indicated the following comments:

“After constructive discussions with the applicant about the lack of critical transportation infrastructure in my ward and the broader context of the cumulative impact of development on the existing network, the applicant has agreed to introduce a commendable initiative aimed at promoting public transit usage among residents, given this development has a unique and exciting opportunity to leverage public transit given its proximity to Innes Road. Specifically, tenants who purchase monthly transit passes will receive a credit against their rent, covering 50% of the pass cost for the first six months of their tenancy.

This incentive, amounting to over \$400 for each recipient, represents a meaningful step towards encouraging alternative modes of transportation and reducing reliance on personal vehicles in suburban communities like mine. I believe this approach not only benefits residents financially but also contributes to the broader goal of achieving a more balanced modal split within Orléans South-Navan.”

### **Public Comments**

This application was subject to public circulation under the Public Notification and Consultation Policy. There was no public comment received online.

### **Technical Agency/Public Body Comments**

#### Summary of Comments – Technical

N/A.

## **APPLICATION PROCESS TIMELINE STATUS**

This Site Plan application was not processed by the On Time Decision Date. due to the complexity of the issues.

**Contact:** Steve Belan Tel: 613-580-2424, ext. 27591 or e-mail: [steve.belan@ottawa.ca](mailto:steve.belan@ottawa.ca)



# Document 1 – Location Map

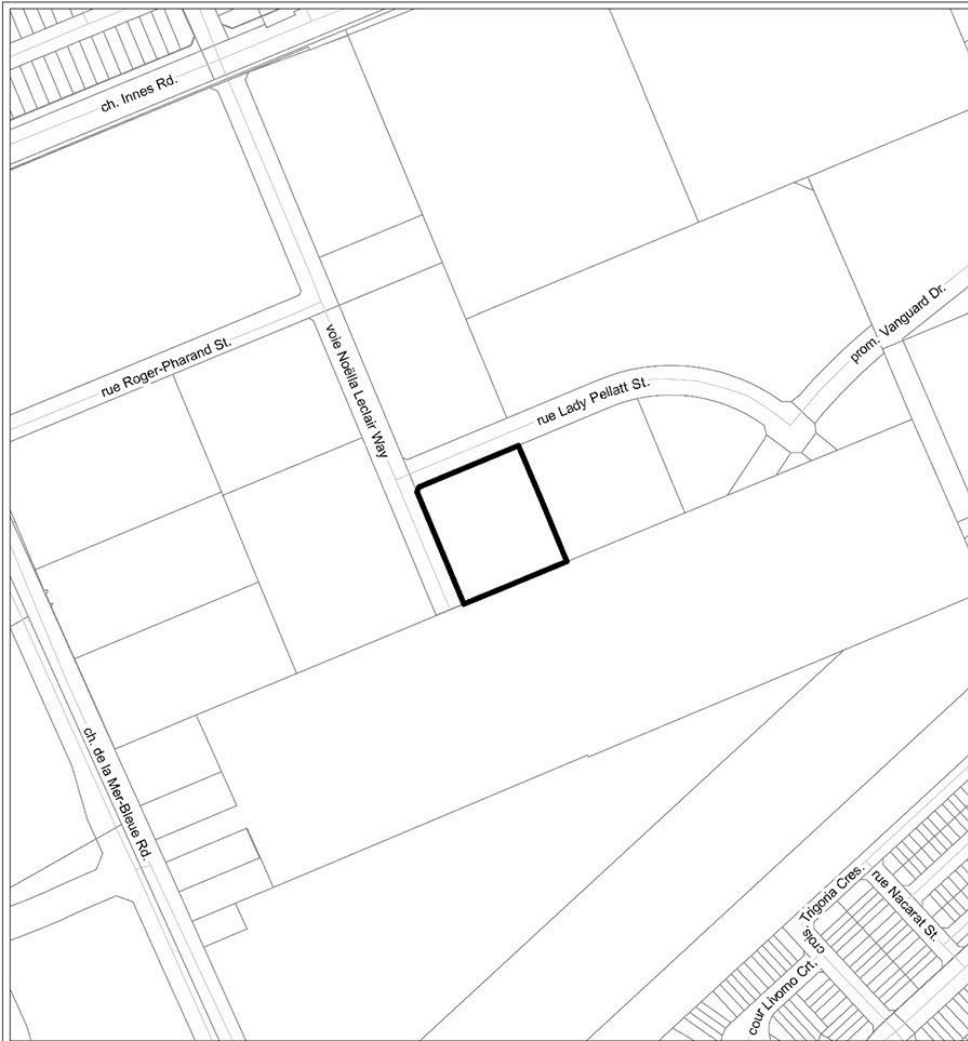

		LOCATION MAP / PLAN DE LOCALISATION SITE PLAN / PLAN D'EMPLACEMENT	
D07-12-23-0095	24-0521-L		<b>1095 rue Noella Leclair St.                  600 rue Lady Pellatt St.</b>
I:\CO\2023\Site_Plan\NoellaLeclair_1001\RA			
<small>                     ©Parcel data is owned by Teranel Enterprises Inc. and its suppliers.                      All rights reserved. May not be produced without permission.                      THIS IS NOT A PLAN OF SURVEY.                 </small>			
<small>                     ©Les données de parcelles appartiennent à Teranel Enterprises Inc. et à ses fournisseurs. Tous droits réservés. Ne peut être reproduit sans autorisation. CECI N'EST PAS UN PLAN D'ARPENTAGE.                 </small>			
REVISION / RÉVISION - 2024 / 05 / 13			