

GENERAL NOTES:

- IT IS THE RESPONSIBILITY OF THE APPROPRIATE CONTRACTOR OR OFFICIAL TO REPORT ANY ERRORS, OMISSIONS OR DISCREPANCIES ON THIS PLAN WITH ACTUAL SITE CONDITIONS TO THE LANDSCAPE ARCHITECT BEFORE PROCEEDING WITH CONSTRUCTION.
- THE CONTRACTOR IS TO NOTIFY ALL UTILITY COMPANIES AND AUTHORITIES PRIOR TO ANY EXCAVATION AND ASCERTAIN LOCATIONS OF UNDERGROUND SERVICES.
- THE CONTRACTOR IS TO REINSTATE ALL AREAS AND ITEMS DAMAGED AS A RESULT OF CONSTRUCTION ACTIVITY.
- THE CONTRACTOR IS TO COMPLY WITH ALL PERTINENT CODES AND BY LAWS.
- THE CONTRACTOR IS TO MAINTAIN A POSITIVE SURFACE RUN-OFF THROUGHOUT THE ENTIRE CONSTRUCTION PERIOD.
- THE LANDSCAPE ARCHITECT IS NOT RESPONSIBLE FOR SUBSURFACE CONDITIONS.
- THE CONTRACTOR IS TO IDENTIFY ALL EXISTING TREES TO REMAIN ON SITE WITH THE LANDSCAPE ARCHITECT PRIOR TO CONSTRUCTION.
- THE CONTRACTOR IS TO STAKE THE PROPOSED LOCATION OF ALL PLANT MATERIAL IN CONJUNCTION WITH THE LANDSCAPE ARCHITECT PRIOR TO EXCAVATION.
- MINIMUM DISTANCES FOR SELECTED DECIDUOUS TREES ARE AS FOLLOWS:
 - BUILDING FOUNDATIONS - 7.5M
 - SIDEWALKS - 1.5M
 - PUBLIC STREETS - 2.5M
 - UNDERGROUND INFRASTRUCTURE - 2.0M
- ALL TREES WITHIN 1M OF UNDERGROUND UTILITY TRENCHES ARE TO BE EXCAVATED BY HAND.
- REMOVE ALL PROTECTIVE WRAPPING FROM TREE TRUNKS AFTER INSTALLATION.
- STAKING OF TREES SHALL ONLY BE PERFORMED IF NECESSARY.
- ENSURE THAT MULCH IS PULLED BACK A MINIMUM DISTANCE OF 75MM FROM BASE OF TREE TRUNK.

PROPOSED PLANT LIST

KEY	QTY	BOTANICAL NAME	COMMON NAME	SIZE	CONDITION	SPACING
DECIDUOUS TREES						
CA	4	Cornus alternifolia	Alternatleaf Dogwood	2000mm ht.	Stringball	
HB	1	Celtis occidentalis	Hackberry	60mm dia.	B&B	
HL	1	Gleditsia triacanthos 'Skyline'	Skyline Honey Locust	60mm dia.	B&B	
JL	1	Syringa reticulata	Japanese Tree Lilac	60mm dia.	B&B	
LL	2	Syringa meyeri 'Palibin'	Dwarf Korean Lilac	Tree Form	B&B	
RM	1	Acer rubrum	Red Maple	60mm dia.	B&B	
SV	1	Syringa vulgaris 'Charles Joly'	Charles Joly Lilac	2000mm ht.	Stringball	
SHRUBS, ORNAMENTAL GRASSES AND PERENNIALS						
DW	10	Cornus sericea	Red Osier Dogwood	800mm ht.	Potted	1200 mm o.c.
FS	10	Sorbaria sorbifolia 'Sem'	Sem False Spirea	600mm ht.	Potted	800 mm o.c.
GS	9	Spiraea x arguta	Garland Spirea	800mm spr.	Potted	1000 mm o.c.
KF	7	Calamagrostis 'Karl Foerster'	Karl Foerster Grass	250mm pot	Potted	800 mm o.c.

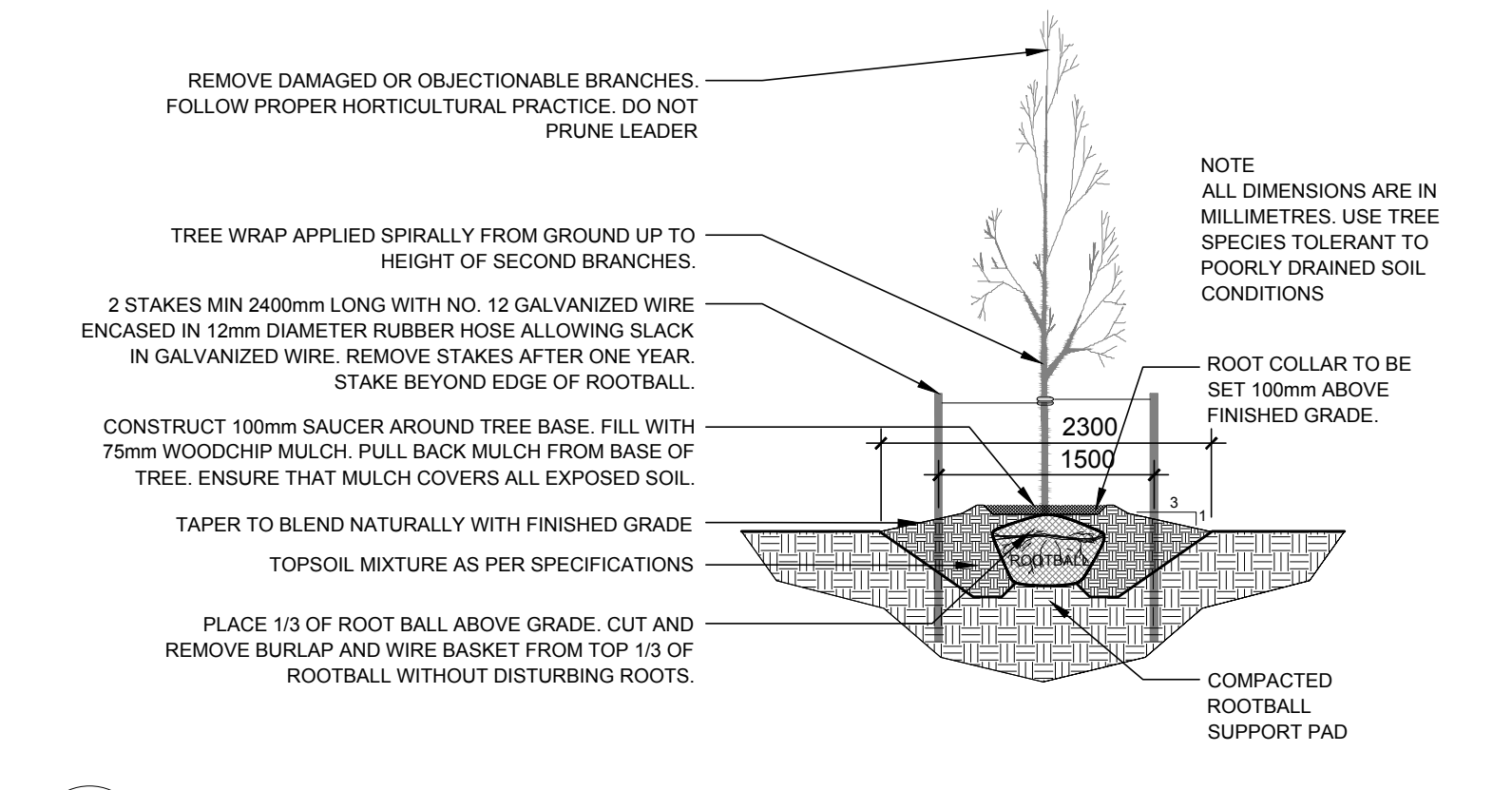

2 DECIDUOUS TREE PLANTING
 L.1 N.T.S.

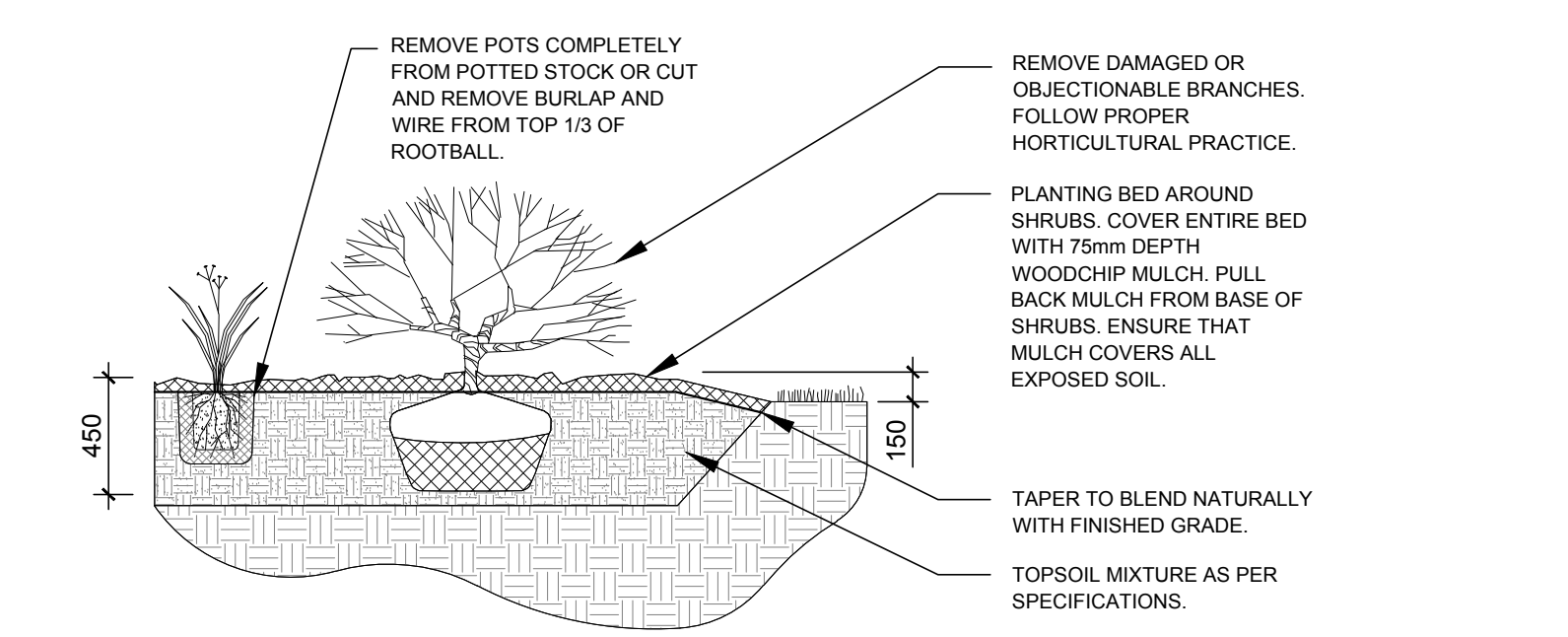

3 SHRUB AND PERENNIAL PLANTING
 L.1 N.T.S.

CLIENT
 CAVANAGH DEVELOPMENTS

CONSULTANTS
 ARCHITECTS: M. David Blakey Architect Inc.
 2200 Prince of Wales Dr. - Suite 101, Ottawa, ON K2E 6Z9
 Tel: (613) 228-8811

CIVIL ENGINEERS: Stertek Consulting Ltd.
 490-131 Cope Avenue, Ottawa, ON
 Tel: (613) 722-4420

LEGEND

 PROPOSED DECIDUOUS TREE
 7.5m SETBACK FROM BUILDING FOUNDATION
 PROPOSED SMALL TREE
 PROPOSED DECIDUOUS SHRUBS

1	ISSUED FOR SITE PLAN CONTROL	06/28/2023	LC	JL
No.	Issue	Date	DR	CK

JAMES B. LENNOX & ASSOCIATES INC.
 LANDSCAPE ARCHITECTS
 3332 CARLING AVE. OTTAWA, ONTARIO K2J 5A8
 Tel: (613) 722-5168 Fax: (613) 722-5168

PROJECT
 110 COPE DRIVE
 BLOCK 43
 OTTAWA, ONTARIO

DRAWING
 LANDSCAPE PLAN

STAMP

 SCALE
 AS SHOWN
 START DATE
 NOVEMBER, 2022
 PROJECT NO.
 23-MIS-2314

PROJECT NORTH

 DRAWING NO.
L.1
 PLOT SIZE ARCH-D

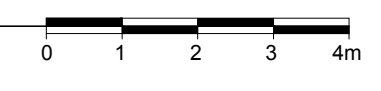

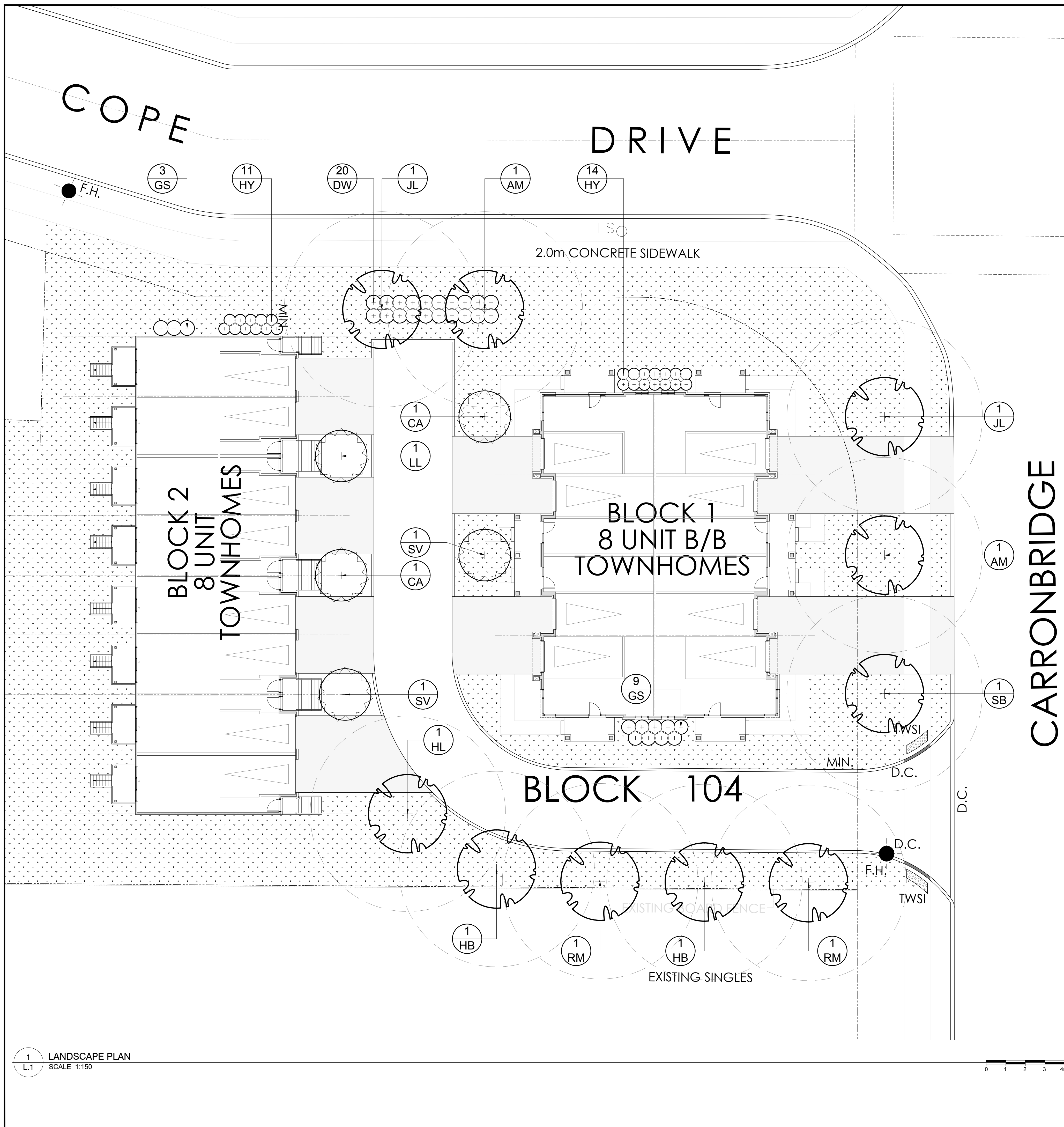

GENERAL NOTES:

- IT IS THE RESPONSIBILITY OF THE APPROPRIATE CONTRACTOR OR OFFICIAL TO REPORT ANY ERRORS, OMISSIONS OR DISCREPANCIES ON THIS PLAN WITH ACTUAL SITE CONDITIONS TO THE LANDSCAPE ARCHITECT BEFORE PROCEEDING WITH CONSTRUCTION.
- THE CONTRACTOR IS TO NOTIFY ALL UTILITY COMPANIES AND AUTHORITIES PRIOR TO ANY EXCAVATION AND ASCERTAIN LOCATIONS OF UNDERGROUND SERVICES.
- THE CONTRACTOR IS TO REINSTATE ALL AREAS AND ITEMS DAMAGED AS A RESULT OF CONSTRUCTION ACTIVITY.
- THE CONTRACTOR IS TO COMPLY WITH ALL PERTINENT CODES AND BY LAWS.
- THE CONTRACTOR IS TO MAINTAIN A POSITIVE SURFACE RUN-OFF THROUGHOUT THE ENTIRE CONSTRUCTION PERIOD.
- THE LANDSCAPE ARCHITECT IS NOT RESPONSIBLE FOR SUBSURFACE CONDITIONS.
- THE CONTRACTOR IS TO IDENTIFY ALL EXISTING TREES TO REMAIN ON SITE WITH THE LANDSCAPE ARCHITECT PRIOR TO CONSTRUCTION.
- THE CONTRACTOR IS TO STAKE THE PROPOSED LOCATION OF ALL PLANT MATERIAL IN CONJUNCTION WITH THE LANDSCAPE ARCHITECT PRIOR TO EXCAVATION.
- MINIMUM DISTANCES FOR SELECTED DECIDUOUS TREES ARE AS FOLLOWS:
 - BUILDING FOUNDATIONS - 7.5M
 - SIDEWALKS - 1.5M
 - PUBLIC STREETS - 2.5M
 - UNDERGROUND INFRASTRUCTURE - 2.0M
- ALL TREES WITHIN 1M OF UNDERGROUND UTILITY TRENCHES ARE TO BE EXCAVATED BY HAND.
- REMOVE ALL PROTECTIVE WRAPPING FROM TREE TRUNKS AFTER INSTALLATION.
- STAKING OF TREES SHALL ONLY BE PERFORMED IF NECESSARY.
- ENSURE THAT MULCH IS PULLED BACK A MINIMUM DISTANCE OF 75MM FROM BASE OF TREE TRUNK.

PROPOSED PLANT LIST

KEY	QTY	BOTANICAL NAME	COMMON NAME	SIZE	CONDITION	SPACING
DECIDUOUS TREES						
AM	2	Acer ginnala	Amur Maple	60mm dia.	B&B	
CA	2	Cornus alternifolia	Alternatleaf Dogwood	2000mm ht.	Stringball	
HB	2	Celtis occidentalis	Hackberry	60mm dia.	B&B	
HL	1	Gleditsia triacanthos 'Skyline'	Skyline Honey Locust	60mm dia.	B&B	
JL	2	Syringa reticulata	Japanese Tree Lilac	60mm dia.	B&B	
LL	1	Syringa meyeri 'Palibin'	Dwarf Korean Lilac	Tree Form	B&B	
RM	2	Acer rubrum	Red Maple	60mm dia.	B&B	
SB	1	Amelanchier canadensis	Shadblow Serviceberry	60mm dia.	B&B	
SV	2	Syringa vulgaris 'Charles Joly'	Charles Joly Lilac	2000mm ht.	Stringball	
SHRUBS, ORNAMENTAL GRASSES AND PERENNIALS						
DW	10	Cornus sericea	Red Osier Dogwood	800mm ht.	Potted	1200 mm o.c.
GS	12	Spiraea x arguta	Garland Spiraea	800mm spr.	Potted	1000 mm o.c.
HY	25	Hydrangea arborescens 'Annabelle'	Annabelle Hydrangea	3 gal. pot	Potted	800 mm o.c.

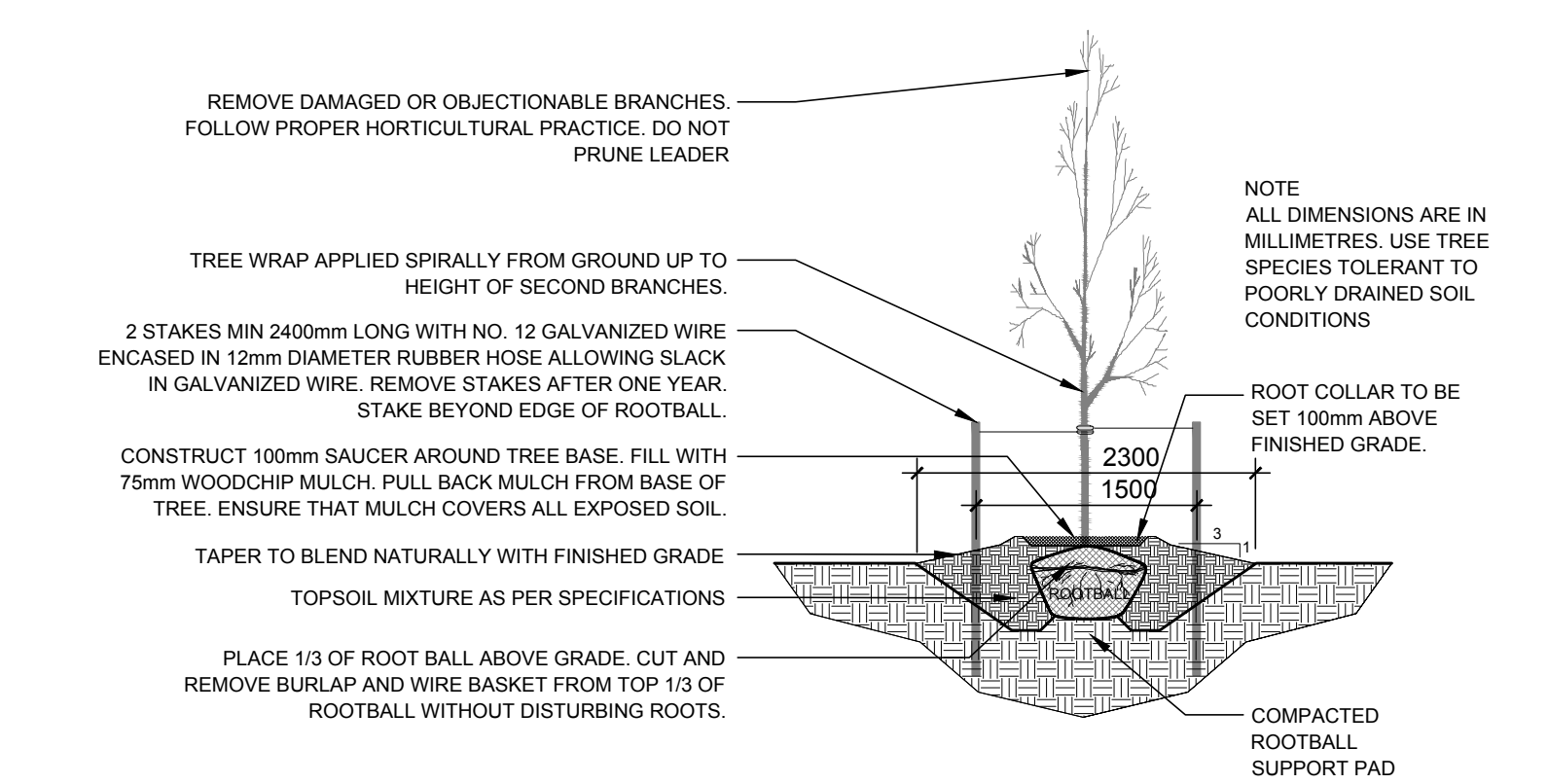

2 DECIDUOUS TREE PLANTING
L.1 N.T.S.

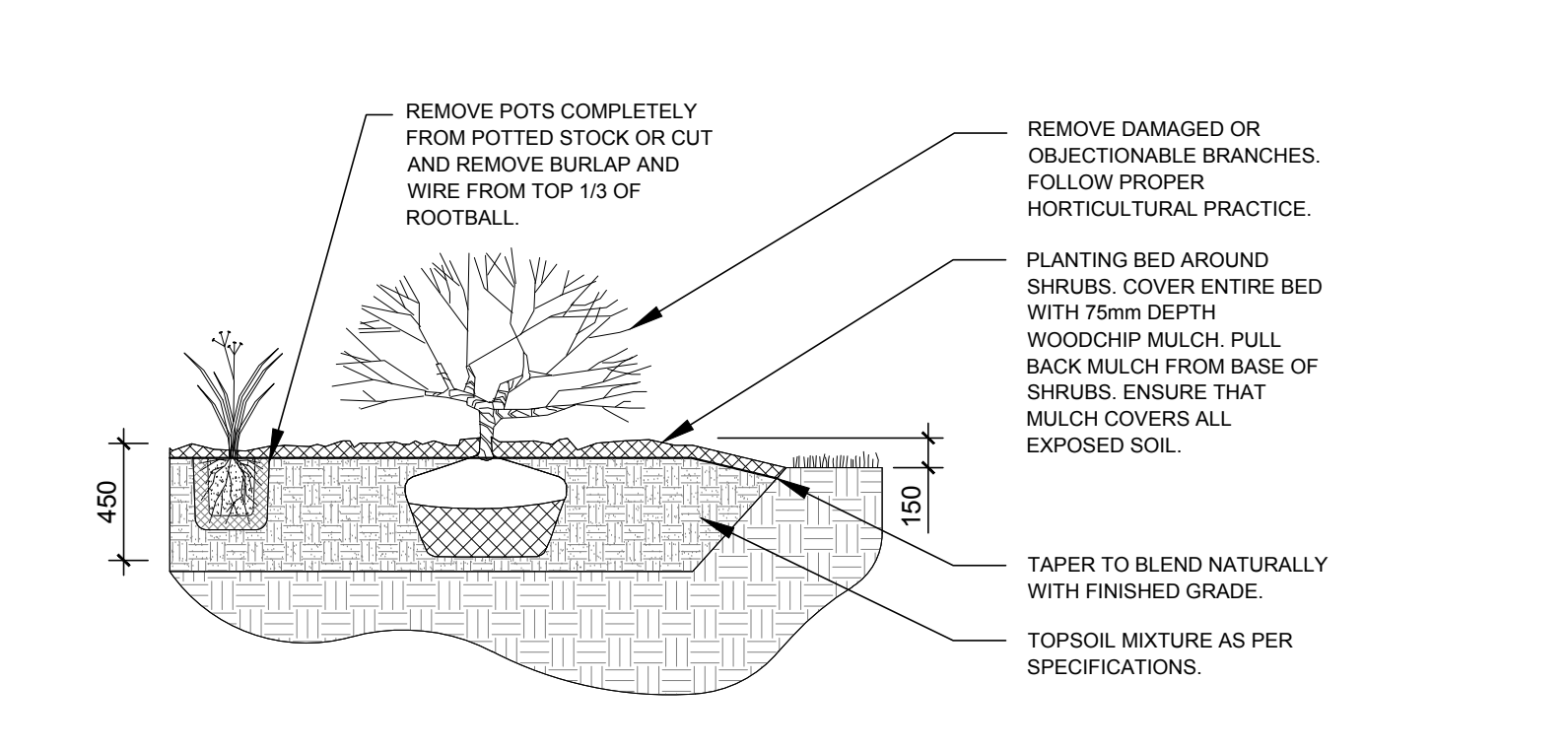

3 SHRUB AND PERENNIAL PLANTING
L.1 N.T.S.

CLIENT
CAVANAGH DEVELOPMENTS

CONSULTANTS
ARCHITECTS: M. David Blakey Architect Inc.
2200 Prince of Wales Dr. - Suite 101, Ottawa, ON K2E 6Z9
Tel: (613) 228-8811
CIVIL ENGINEERS: Stantec Consulting Ltd.
490-1311 Coyle Avenue, Ottawa, ON
Tel: (613) 722-4420

LEGEND
PROPOSED DECIDUOUS TREE
7.5m SETBACK FROM BUILDING FOUNDATION
PROPOSED SMALL TREE
PROPOSED DECIDUOUS SHRUBS

1	ISSUED FOR SITE PLAN CONTROL	06/28/2023	LC	JL
No.	Issue	Date	DR	CK

JAMES B. LENNOX & ASSOCIATES INC.
LANDSCAPE ARCHITECTS
3332 CARLING AVE. OTTAWA, ONTARIO K2J 5A8
Tel: (613) 722-5168 Fax: (613) 722-5162

PROJECT
80 COPE DRIVE
BLOCK 104
OTTAWA, ONTARIO

DRAWING
LANDSCAPE PLAN

STAMP
ASSOCIATION OF LANDSCAPE ARCHITECTS OF ONTARIO
MEMBER
JBL

SCALE
AS SHOWN
START DATE
NOVEMBER, 2022
PROJECT NO.
23-MIS-2314
DRAWING NO.
L.1
PLOT SIZE ARCH-D

1 LANDSCAPE PLAN
L.1 SCALE 1:150

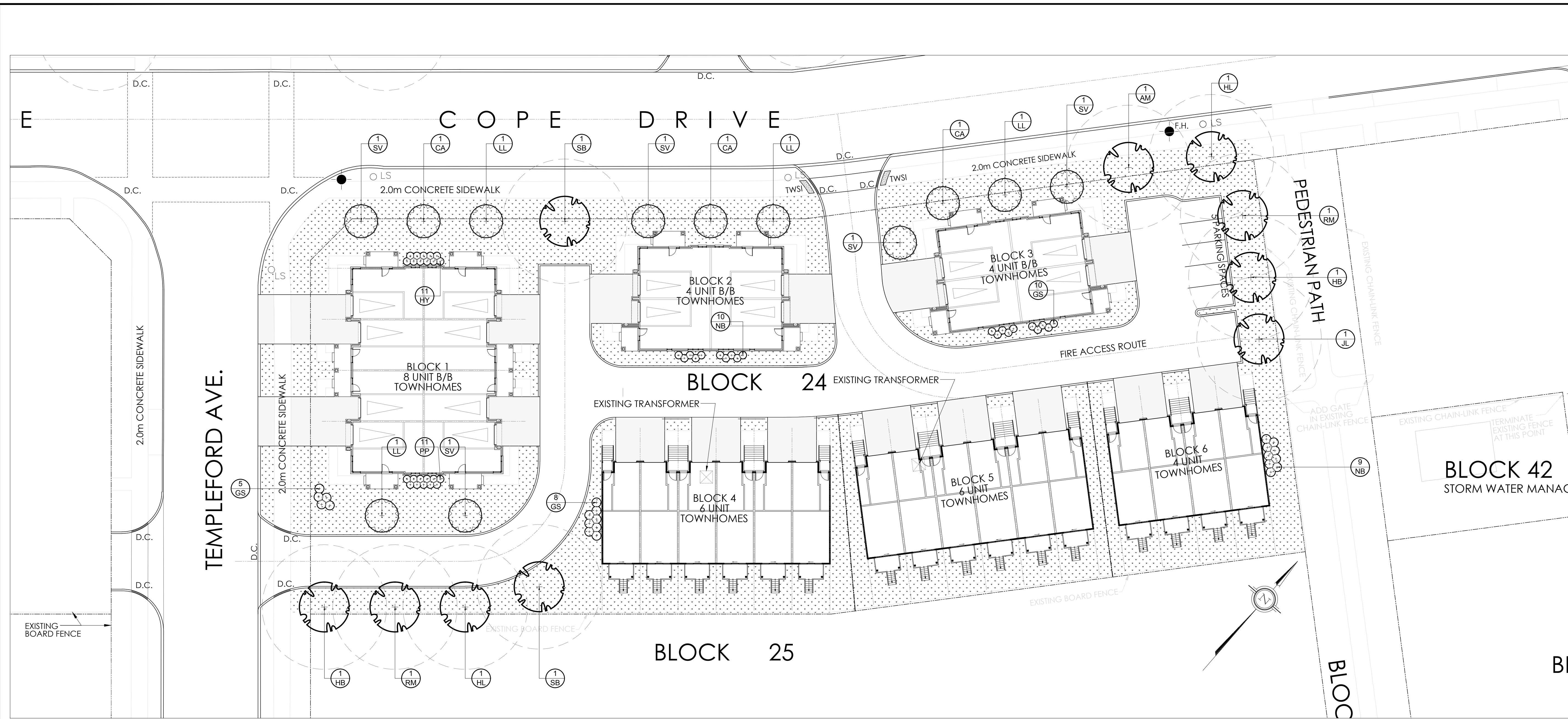

1 LANDSCAPE PLAN
L.1 SCALE 1:150

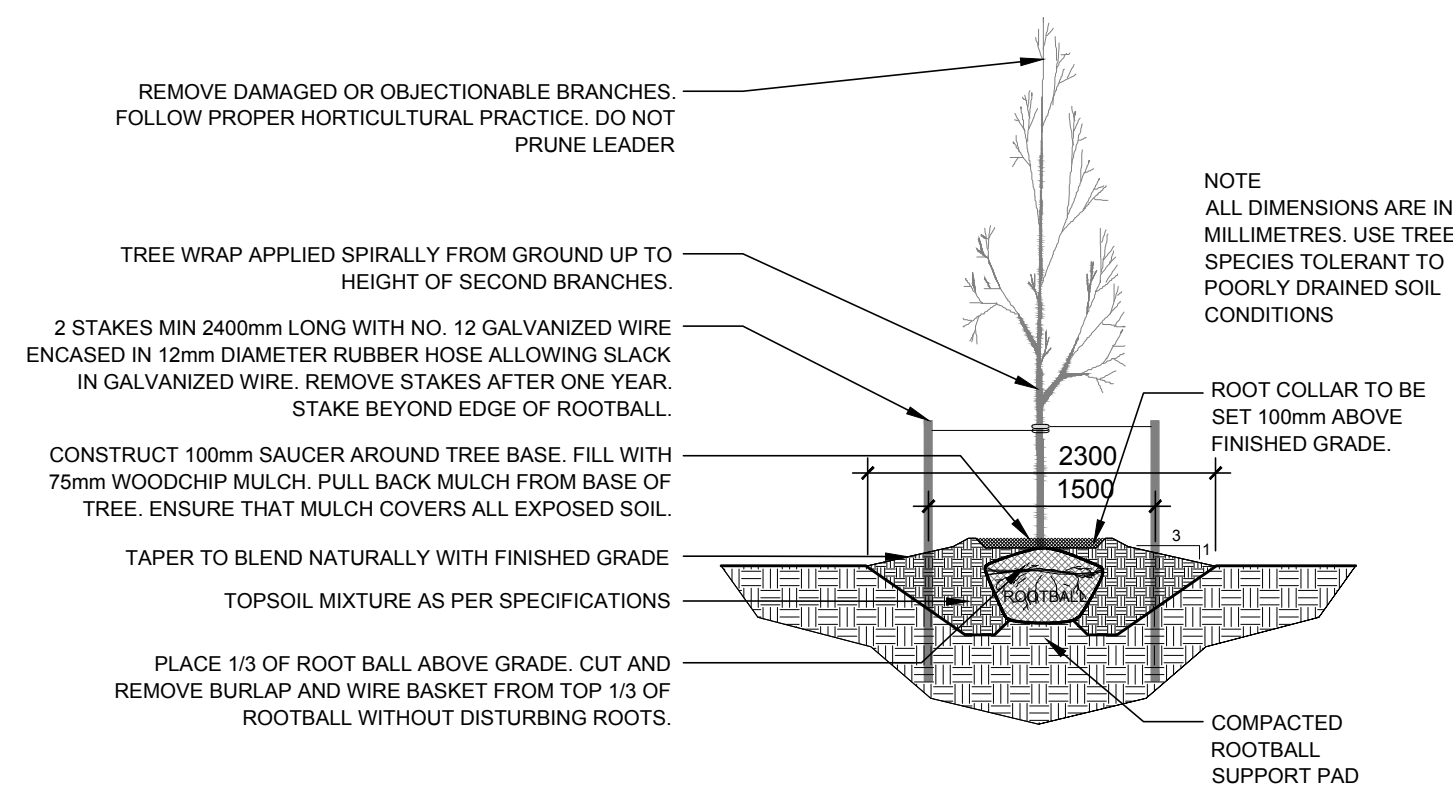

2 DECIDUOUS TREE PLANTING
L.1 N.T.S.

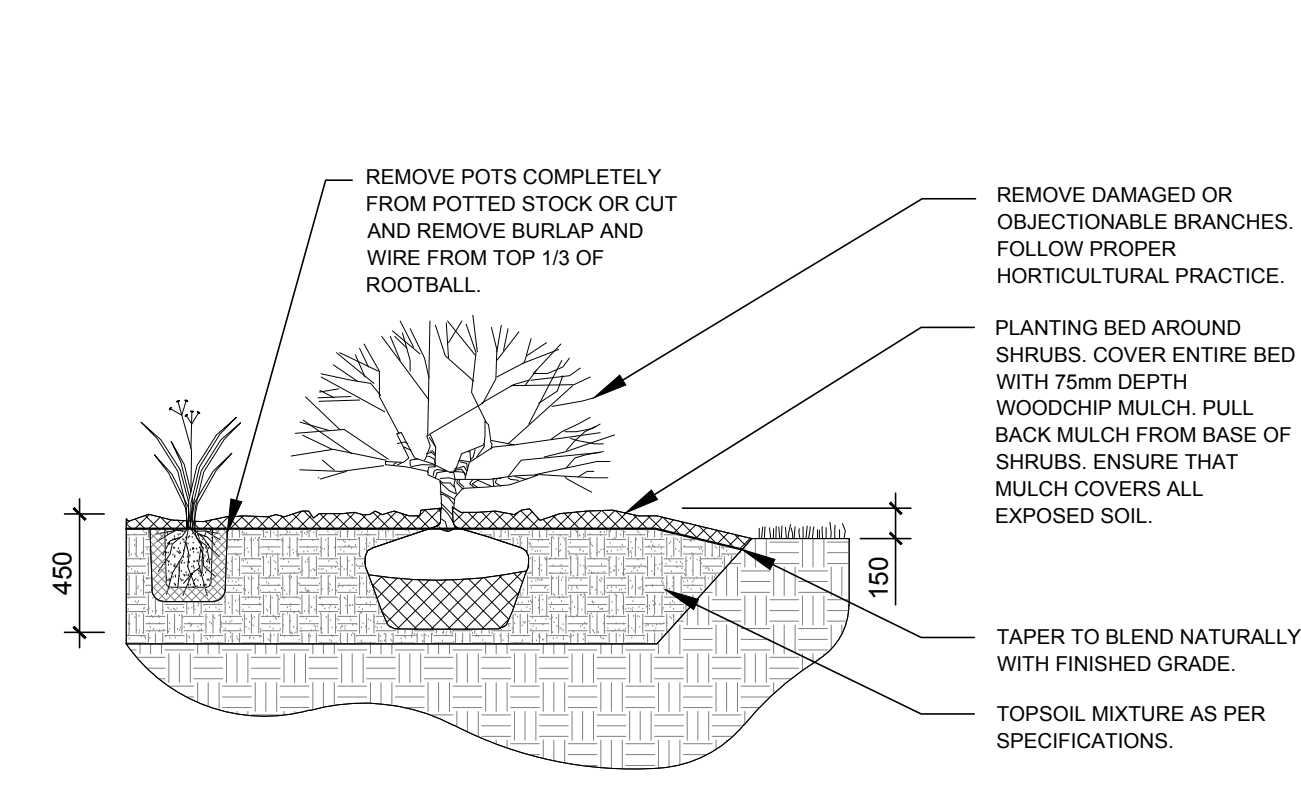

3 SHRUB AND PERENNIAL PLANTING
L.1 N.T.S.

PROPOSED PLANT LIST						
KEY	QTY	BOTANICAL NAME	COMMON NAME	SIZE	CONDITION	SPACING
DECIDUOUS TREES						
AM	2	<i>Acer ginnala</i>	Amur Maple	60mm dia.	B&B	
CA	7	<i>Cornus alternifolia</i>	Alternanthera Dogwood	2000mm ht.	Stringball	
HB	2	<i>Celtis occidentalis</i>	Hackberry	60mm dia.	B&B	
HL	1	<i>Gleditsia triacanthos 'Skyline'</i>	Skyline Honey Locust	60mm dia.	B&B	
JL	2	<i>Syringa reticulata</i>	Japanese Tree Lilac	60mm dia.	B&B	
LL	6	<i>Syringa meyeri 'Palibin'</i>	Dwarf Korean Lilac	Tree Form	B&B	
RM	1	<i>Acer rubrum</i>	Red Maple	60mm dia.	B&B	
SB	4	<i>Amelanchier canadensis</i>	Shadblow Serviceberry	60mm dia.	B&B	
SV	5	<i>Syringa vulgaris 'Charles Joly'</i>	Charles Joly Lilac	2000mm ht.	Stringball	
SHRUBS, ORNAMENTAL GRASSES AND PERENNIALS						
GS	28	<i>Spiraea x arguta</i>	Garland Spirea	800mm spr.	Potted	1000 mm o.c.
HY	22	<i>Hydrangea arborescens 'Annabelle'</i>	Annabelle Hydrangea	3 gal. pot	Potted	800 mm o.c.
KF	3	<i>Calamagrostis 'Karl Foerster'</i>	Karl Foerster Grass	250mm pot	Potted	800 mm o.c.
NB	19	<i>Physocarpus opulifolius 'Little Devil'</i>	Little Devil Ninebark	600mm pot	Potted	1000 mm o.c.
PP	11	<i>Spiraea japonica 'Little Princess'</i>	Little Princess Spirea	600mm pot	Potted	800 mm o.c.
SR	3	<i>Phalaris arundinacea 'Strawberries & Cream'</i>	Strawberries & Cream Ribbon Grass	250mm pot	Potted	600 mm o.c.

- GENERAL NOTES:**
- IT IS THE RESPONSIBILITY OF THE APPROPRIATE CONTRACTOR OR OFFICIAL TO REPORT ANY ERRORS, OMISSIONS OR DISCREPANCIES ON THIS PLAN WITH ACTUAL SITE CONDITIONS TO THE LANDSCAPE ARCHITECT BEFORE PROCEEDING WITH CONSTRUCTION.
 - THE CONTRACTOR IS TO NOTIFY ALL UTILITY COMPANIES AND AUTHORITIES PRIOR TO ANY EXCAVATION AND ASCERTAIN LOCATIONS OF UNDERGROUND SERVICES.
 - THE CONTRACTOR IS TO REINSTATE ALL AREAS AND ITEMS DAMAGED AS A RESULT OF CONSTRUCTION ACTIVITY.
 - THE CONTRACTOR IS TO COMPLY WITH ALL PERTINENT CODES AND BY-LAWS.
 - THE CONTRACTOR IS TO MAINTAIN A POSITIVE SURFACE RUN-OFF THROUGHOUT THE ENTIRE CONSTRUCTION PERIOD.
 - THE LANDSCAPE ARCHITECT IS NOT RESPONSIBLE FOR SUBSURFACE CONDITIONS.
 - THE CONTRACTOR IS TO IDENTIFY ALL EXISTING TREES TO REMAIN ON SITE WITH THE LANDSCAPE ARCHITECT PRIOR TO CONSTRUCTION.
 - THE CONTRACTOR IS TO STAKE THE PROPOSED LOCATION OF ALL PLANT MATERIAL IN CONJUNCTION WITH THE LANDSCAPE ARCHITECT PRIOR TO EXCAVATION.
 - MINIMUM DISTANCES FOR SELECTED DECIDUOUS TREES ARE AS FOLLOWS:
 - BUILDING FOUNDATIONS - 7.5M
 - SIDEWALKS - 1.5M
 - PUBLIC STREETS - 2.5M
 - UNDERGROUND INFRASTRUCTURE - 2.0M
 - ALL TREES WITHIN 1M OF UNDERGROUND UTILITY TRENCHES ARE TO BE EXCAVATED BY HAND.
 - REMOVE ALL PROTECTIVE WRAPPING FROM TREE TRUNKS AFTER INSTALLATION.
 - STAKING OF TREES SHALL ONLY BE PERFORMED IF NECESSARY.
 - ENSURE THAT MULCH IS PULLED BACK A MINIMUM DISTANCE OF 75MM FROM BASE OF TREE TRUNK.

CLIENT
CAVANAGH DEVELOPMENTS

CONSULTANTS
ARCHITECTS: M. David Blakely Architect Inc.
2200 Prince of Wales Dr. - Suite 101, Ottawa, ON K2E 6Z9
Tel: (613) 228-8811

CIVIL ENGINEERS: Stentec Consulting Ltd.
490-131 Cope Avenue, Ottawa, ON
Tel: (613) 722-4420

LEGEND
 PROPOSED DECIDUOUS TREE
 7.5m SETBACK FROM BUILDING FOUNDATION
 PROPOSED SMALL TREE
 PROPOSED DECIDUOUS SHRUBS

1	ISSUED FOR SITE PLAN CONTROL	06/28/2023	LC	JL
No.	Issue	Date	DR	CK

JAMES B. LENNOX & ASSOCIATES INC.
LANDSCAPE ARCHITECTS
3332 CARLING AVE. OTTAWA, ONTARIO K2H 5A8
Tel: (613) 722-5168 Fax: (866) 343-3942

PROJECT
140 COPE DRIVE
BLOCK 24
OTTAWA, ONTARIO

DRAWING
LANDSCAPE PLAN

STAMP

SCALE
AS SHOWN

START DATE
NOVEMBER, 2022

PROJECT NO.
23-MIS-2314

PROJECT NORTH

DRAWING NO.
L.1

PLOT SIZE ARCH-D

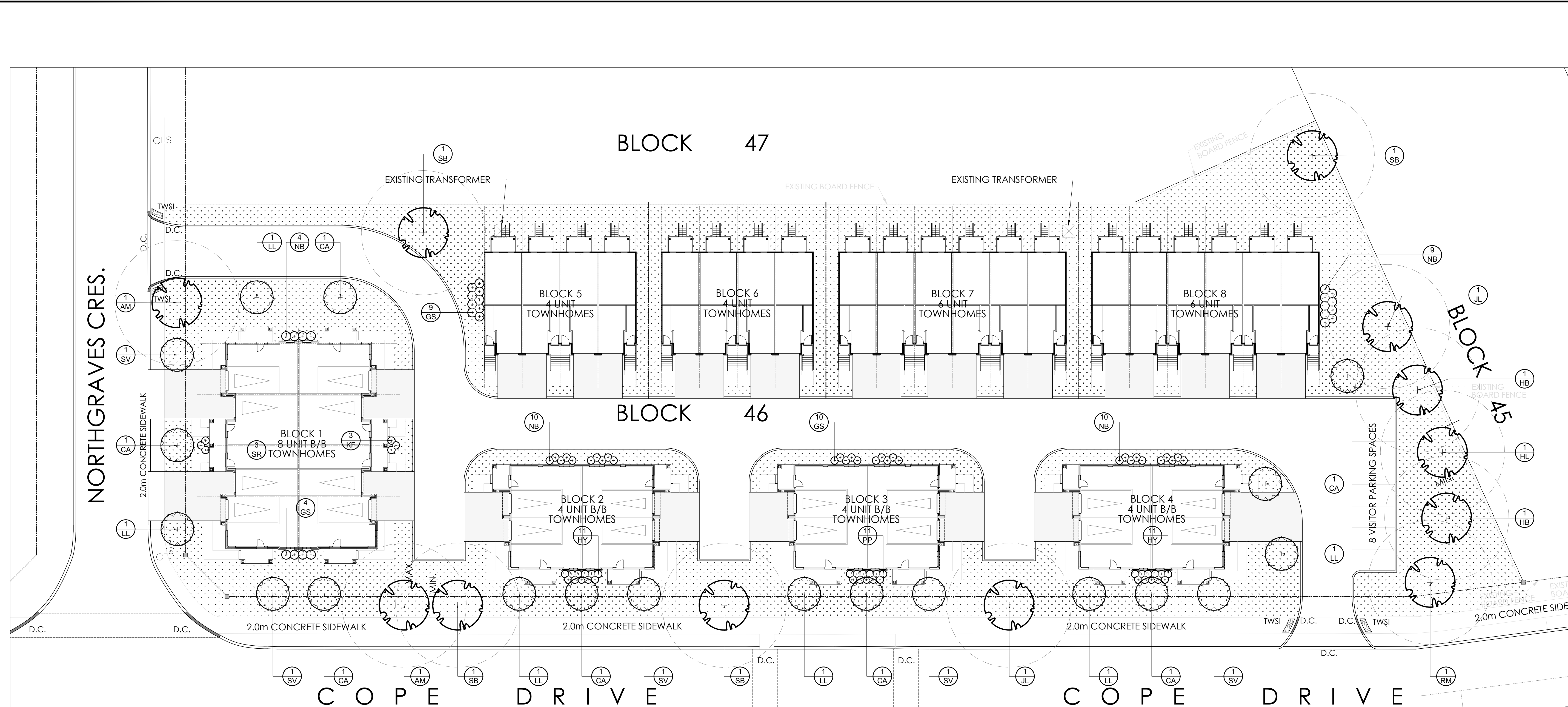

1 LANDSCAPE PLAN
L.1 SCALE 1:150

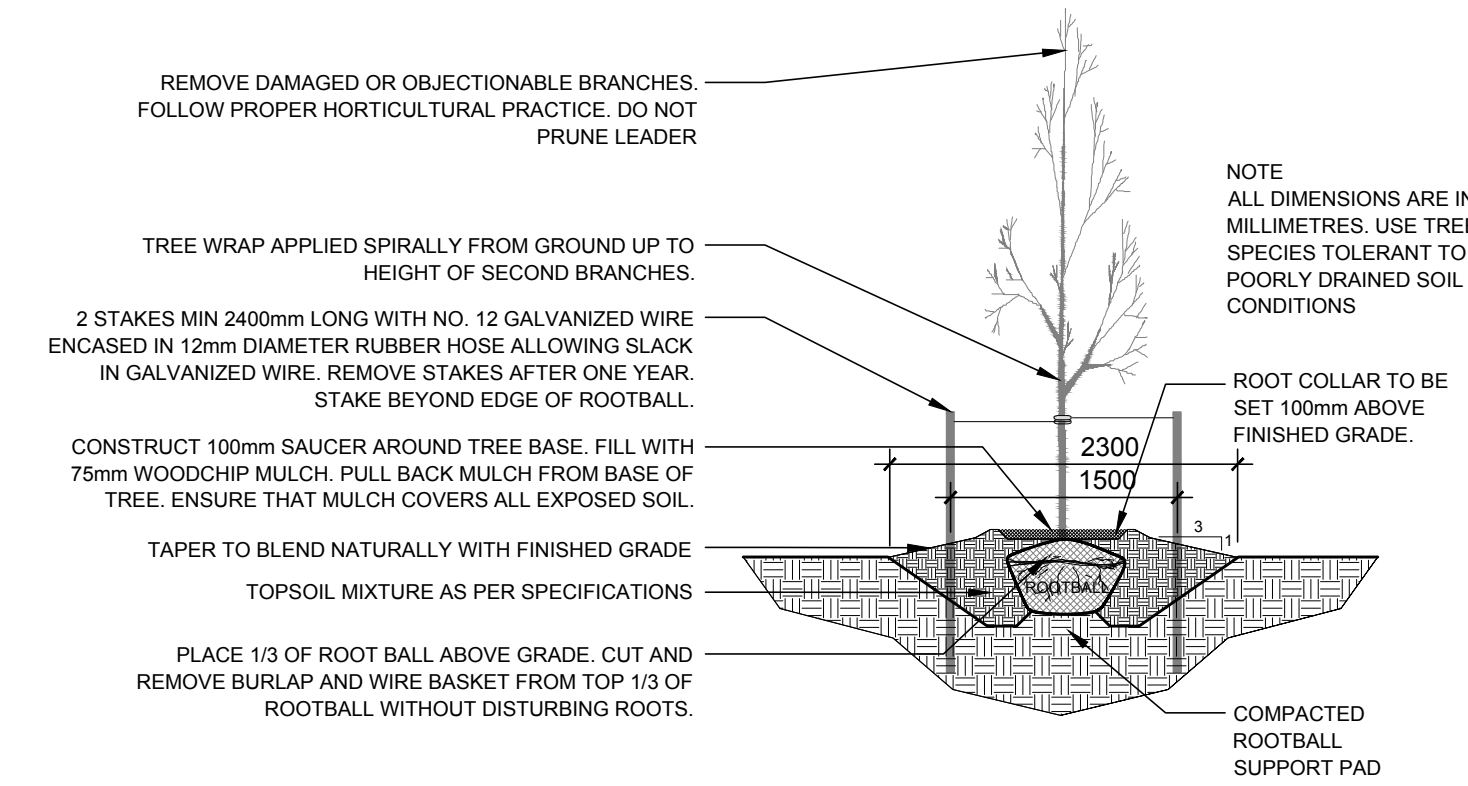
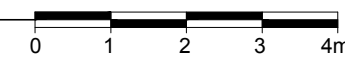

2 DECIDUOUS TREE PLANTING
L.1 N.T.S.

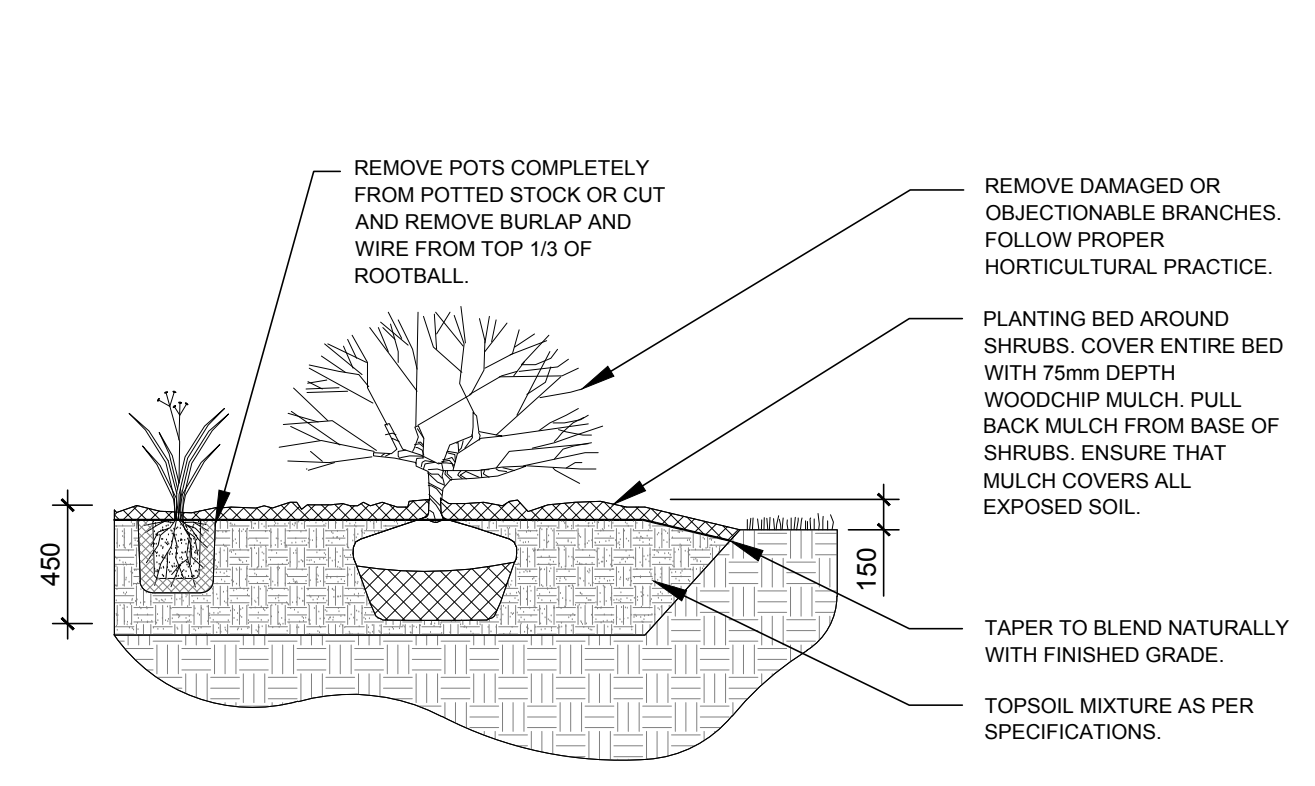

3 SHRUB AND PERENNIAL PLANTING
L.1 N.T.S.

KEY	QTY	BOTANICAL NAME	COMMON NAME	SIZE	CONDITION	SPACING
DECIDUOUS TREES						
AM	2	<i>Acer ginnata</i>	Amur Maple	60mm dia.	B&B	
CA	3	<i>Cornus alternifolia</i>	Alternatleaf Dogwood	2000mm ht.	Stringball	
HB	2	<i>Celtis occidentalis</i>	Hackberry	60mm dia.	B&B	
HL	2	<i>Gleditsia triacanthos</i> 'Skyline'	Skyline Honey Locust	60mm dia.	B&B	
JL	1	<i>Syringa reticulata</i>	Japanese Tree Lilac	60mm dia.	B&B	
LL	4	<i>Syringa meyeri</i> 'Palibin'	Dwarf Korean Lilac	Tree Form	B&B	
RM	2	<i>Acer rubrum</i>	Red Maple	60mm dia.	B&B	
SB	2	<i>Amelanchier canadensis</i>	Shadblow Serviceberry	60mm dia.	B&B	
SV	5	<i>Syringa vulgaris</i> 'Charles Joly'	Charles Joly Lilac	2000mm ht.	Stringball	
SHRUBS, ORNAMENTAL GRASSES AND PERENNIALS						
GS	18	<i>Spiraea x arguta</i>	Garland Spiraea	800mm spr.	Potted	1000 mm o.c.
HY	11	<i>Hydrangea arborescens</i> 'Annabelle'	Annabelle Hydrangea	3 gal. pot.	Potted	800 mm o.c.
NB	19	<i>Physocarpus opulifolius</i> 'Little Devil'	Little Devil Ninebark	600mm pot.	Potted	1000 mm o.c.
PP	11	<i>Spiraea japonica</i> 'Little Princess'	Little Princess Spiraea	600mm pot.	Potted	800 mm o.c.

- GENERAL NOTES:**
- IT IS THE RESPONSIBILITY OF THE APPROPRIATE CONTRACTOR OR OFFICIAL TO REPORT ANY ERRORS, OMISSIONS OR DISCREPANCIES ON THIS PLAN WITH ACTUAL SITE CONDITIONS TO THE LANDSCAPE ARCHITECT BEFORE PROCEEDING WITH CONSTRUCTION.
 - THE CONTRACTOR IS TO NOTIFY ALL UTILITY COMPANIES AND AUTHORITIES PRIOR TO ANY EXCAVATION AND ASCERTAIN LOCATIONS OF UNDERGROUND SERVICES.
 - THE CONTRACTOR IS TO REINSTATE ALL AREAS AND ITEMS DAMAGED AS A RESULT OF CONSTRUCTION ACTIVITY.
 - THE CONTRACTOR IS TO COMPLY WITH ALL PERTINENT CODES AND BY-LAWS.
 - THE CONTRACTOR IS TO MAINTAIN A POSITIVE SURFACE RUN-OFF THROUGHOUT THE ENTIRE CONSTRUCTION PERIOD.
 - THE LANDSCAPE ARCHITECT IS NOT RESPONSIBLE FOR SUBSURFACE CONDITIONS.
 - THE CONTRACTOR IS TO IDENTIFY ALL EXISTING TREES TO REMAIN ON SITE WITH THE LANDSCAPE ARCHITECT PRIOR TO CONSTRUCTION.
 - THE CONTRACTOR IS TO STAKE THE PROPOSED LOCATION OF ALL PLANT MATERIAL IN CONJUNCTION WITH THE LANDSCAPE ARCHITECT PRIOR TO EXCAVATION.
 - MINIMUM DISTANCES FOR SELECTED DECIDUOUS TREES ARE AS FOLLOWS:
 - BUILDING FOUNDATIONS - 7.5M
 - SIDEWALKS - 1.5M
 - PUBLIC STREETS - 2.5M
 - UNDERGROUND INFRASTRUCTURE - 2.0M
 - ALL TREES WITHIN 1M OF UNDERGROUND UTILITY TRENCHES ARE TO BE EXCAVATED BY HAND.
 - REMOVE ALL PROTECTIVE WRAPPING FROM TREE TRUNKS AFTER INSTALLATION.
 - STAKING OF TREES SHALL ONLY BE PERFORMED IF NECESSARY.
 - ENSURE THAT MULCH IS PULLED BACK A MINIMUM DISTANCE OF 75MM FROM BASE OF TREE TRUNK.

CLIENT
CAVANAGH DEVELOPMENTS

CONSULTANTS
ARCHITECTS: M. David Blakely Architect Inc.
2200 Prince of Wales Dr. - Suite 101, Ottawa, ON K2E 6Z9
Tel: (613) 228-8811

CIVIL ENGINEERS: Stentec Consulting Ltd.
490-1311 Oryx Avenue, Ottawa, ON
Tel: (613) 722-4420

LEGEND
 PROPOSED DECIDUOUS TREE
 7.5m SETBACK FROM BUILDING FOUNDATION
 PROPOSED SMALL TREE
 PROPOSED DECIDUOUS SHRUBS

1	ISSUED FOR SITE PLAN CONTROL	06/28/2023	LC	JL
No.	Issue	Date	micro	DR CK

JAMES B. LENNOX & ASSOCIATES INC.
LANDSCAPE ARCHITECTS
3332 CARLING AVE. OTTAWA, ONTARIO K2H 5A8
Tel: (613) 722-5168 Fax: (866) 343-3942

PROJECT
151 COPE DRIVE
BLOCK 46
OTTAWA, ONTARIO

DRAWING
LANDSCAPE PLAN

STAMP

SCALE
AS SHOWN

START DATE
NOVEMBER, 2022

PROJECT NO.
23-MIS-2314

PROJECT NORTH

DRAWING NO.
L.1

PLOT SIZE ARCH-D