

- LEGEND**
- 3-D1 DETAIL SHEET # NOVATECH OR CITY
 - PROPERTY LIMIT
 - PROPOSED RIPRAP
 - SEED MIX B - RETENTION AREA SEE MIX APPLICATION NOTE
 - PROPOSED DRY SHRUB MIX REFER TO SHEET L2
 - PROPOSED DECIDUOUS TREE
 - PROPOSED CONIFEROUS TREE
 - EXISTING TREE TO REMAIN
 - SPECIES (SEE PLANT LIST)
 - QUANTITY
 - NATURALIZATION MIX AREA
 - TREE PROTECTION FENCE
 - SILT FENCE
 - BOLLARD
- GENERAL**
- Read and interpret this drawing/drawing set in conjunction with all the contract details and specifications, including related civil, utility, structural, architectural, mechanical, electrical, environmental, geotechnical, and survey information.
 - The Contractor is to determine the exact location, size, material, and elevation of all existing utilities prior to commencing construction. Protect and assume responsibility for all existing utilities regardless of being shown on the drawings.
 - It is essential to use the plans and details in conjunction with the specifications and notes.
 - Do not scale drawings. Work to dimensions only.
 - Protect all existing and retained vegetation for the duration of construction according to the contract details and specifications.
 - Reinstatement of areas and items damaged or disturbed, beyond the Limit of Work, because of construction activities, including but not limited to construction staging areas, haul roads, stockpile areas, etc. to the satisfaction of the Consultant. Unless otherwise noted, Contractor is to restate all areas to pre-construction condition or better to the satisfaction of the Contract Administrator.
- PLANTING**
- Plant material to be No. 1 Grade and is to comply with Canadian Standards for Nursery Stock (latest edition) published by the Canadian Nursery Landscape Association.
 - Use structurally sound plant material with strong fibrous root system free of disease, defects, and injuries. Use trees with straight trunks, well and characteristically branched for species. Obtain approval from consultant of plant material at source prior to digging. All trees and shrubs to be container grown, potted, W/B or B/B, as indicated on Plant List. Bare root plants are only acceptable for certain species and as approved by the Landscape Architect.
 - Plant material installations are not to be permitted without the written approval from the Consultant, with 48 hours notice, prior to shipping plant material.
 - Plant locations are schematic; approximate only. Contractor is to stake out locations on site for approval by the Landscape Architect prior to installation. Contractor will assume full responsibility if no Landscape Architect is notified.
 - The illustrated number of plants shown in the Planting Plan supersedes the estimated number in the Plant List. Contractor to report any discrepancies to the Landscape Architect prior to installation. Contractor will assume full responsibility if no Landscape Architect is notified.
 - Ensure trees are thoroughly watered following planting. Monitor material and ensure adequate moisture until acceptance.
 - In heavy clay or poorly drained soils, set root ball with root collar 75-100mm higher than finished grade.
 - Plant Beds - 400mm continuous depth. Applies to shrubs, perennials, vines, and groundcovers.
 - Sod Seed Areas - 100mm depth.
 - Restoration - 300mm depth.
 - Sod to be No. 1 Kentucky Bluegrass Sod grown from minimum mixture of 3 Kentucky Bluegrass cultivars. Quality and source are to comply with Canadian Standards for Nursery Stock, Section 17, (latest edition) published by the Canadian Nursery Landscape Association.
 - Plant Beds - (8-32-16), i.e. 8% Nitrogen, 32% Phosphorus, 16% Potash per manufacturer specifications.
 - Sod Areas - (8-32-16), i.e. 8% Nitrogen, 32% Phosphorus, 16% Potash at a rate of 350g/ha.
 - Where applicable, for any plant areas with a mix of species/cultivar notes, Contractor is to cluster the plants in groups of 3-5 and evenly distribute these in the noted area.

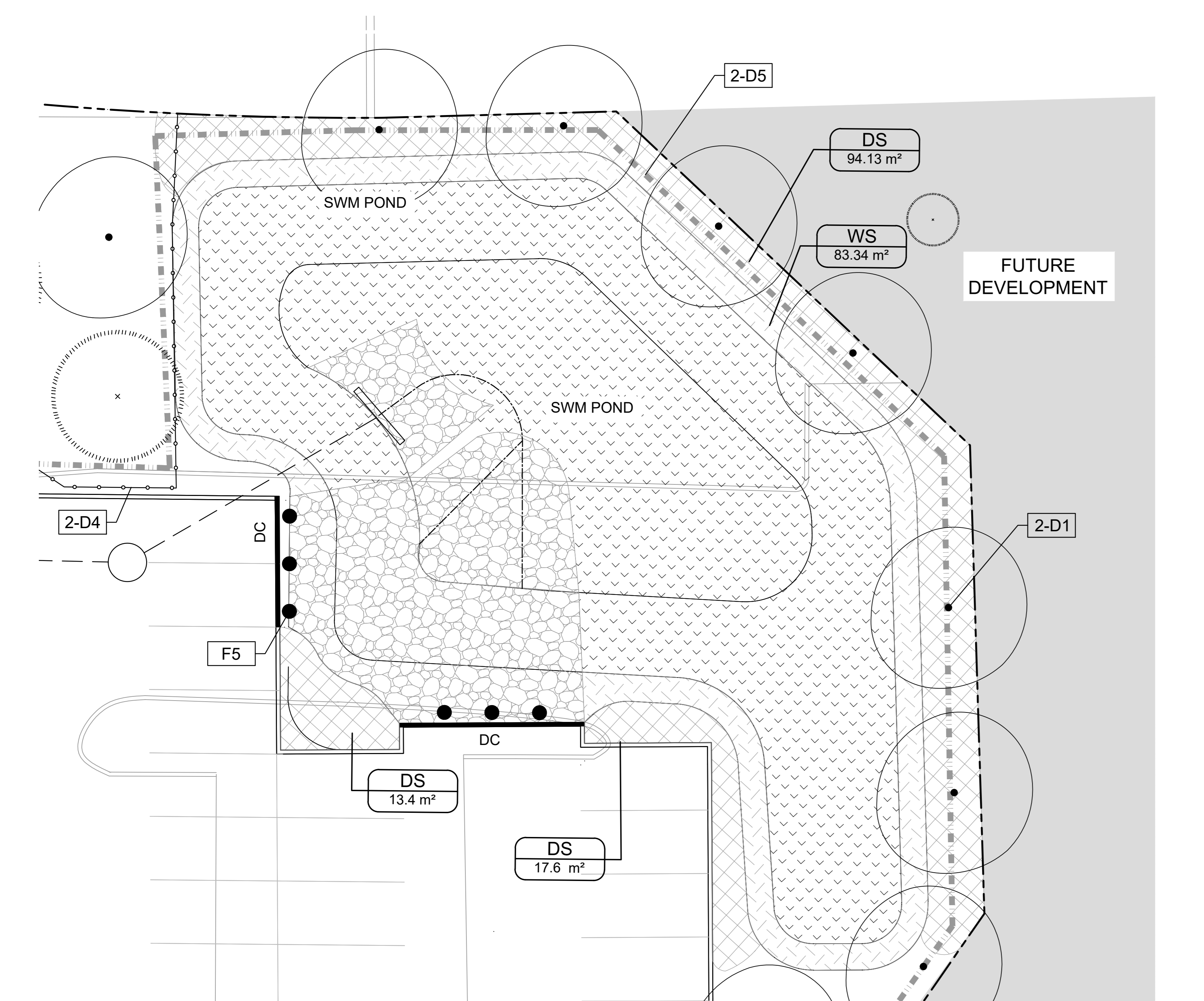

ENLARGEMENT A - SWM POND
SCALE 1:100

PLANT LIST

Dry Shrub Mix (DS)			
Area	Plant	Quantity	Notes
125 m ²		1500 mm O.C.	0.51 pcs/m ²
25%	<i>Ceanothus americanus</i>	New Jersey Tea	0.60m Ht BR 1.5m O.C.
20%	<i>Diervilla lonicera</i>	Bush Honeysuckle	0.60m Ht BR 1.5m O.C.
5%	<i>Physocarpus opulifolius</i>	Common Ninebark	0.60m Ht BR 1.5m O.C.
5%	<i>Rhus aromatica</i>	Fragrant Sumac	0.60m Ht BR 1.5m O.C.
25%	<i>Rubus odoratus</i>	Flowering Raspberry	0.60m Ht BR 1.5m O.C.
20%	<i>Symphoricarpos alba</i>	Snowberry	0.60m Ht BR 1.5m O.C.

Wet Shrub Mix (WS)			
Area	Plant	Quantity	Notes
84 m ²		1500 mm O.C.	0.51 pcs/m ²
20%	<i>Aronia melanocarpa</i>	Black Chokeberry	0.60m Ht BR 1.5m O.C.
15%	<i>Cephalanthus occidentalis</i>	Buttonbush	0.60m Ht BR 1.5m O.C.
20%	<i>Cornus sericea</i>	Red Osier Dogwood	0.60m Ht BR 1.5m O.C.
5%	<i>Myrica gale</i>	Sweet Gale	0.60m Ht BR 1.5m O.C.
5%	<i>Salix petiolaris</i>	Slender Willow	0.60m Ht BR 1.5m O.C.
20%	<i>Spiraea alba</i>	White Meadowsweet	0.60m Ht BR 1.5m O.C.
15%	<i>Rosa palustris</i>	Swamp Rose	0.60m Ht BR 1.5m O.C.

APPROVED
By Krishon Walker at 9:46 am, Mar 05, 2024

KRISHON WALKER
PLANNER
PLANNING, REAL ESTATE & ECONOMIC DEVELOPMENT
DEPARTMENT, CITY OF OTTAWA

NOT FOR CONSTRUCTION

NOTE: THE POSITION OF ALL POLE LINES, CONDUITS, WATERMANS, SEWERS AND OTHER UNDERGROUND AND OVERGROUND UTILITIES AND STRUCTURES IS NOT GUARANTEED. BEFORE STARTING WORK, DETERMINE THE EXACT LOCATION OF ALL SUCH UTILITIES AND STRUCTURES AND ASSUME ALL LIABILITY FOR DAMAGE TO THEM.

OWNER INFORMATION
COLLIERS
191 BAY STREET
TORONTO, ONTARIO, M5J 2V1
AARON CLODD
PHONE: (647) 798-9534
EMAIL: Aaron.Clodd@colliers.com

No.	REVISION	DATE	BY
5.	REVISED PER CITY COMMENTS	FEB 08/24	RGJ
4.	ADDRESS INSERTION ON TITLEBLOCK	DEC 21/23	RGJ
3.	REVISED PER CITY COMMENTS	DEC 05/23	RGJ
2.	REVISED PER CITY COMMENTS	NOV 08/23	RGJ
1.	ISSUED FOR CITY REVIEW	OCT 02/23	RGJ

SCALE: TCB
FOR REVIEW ONLY
NOVATECH
Engineers, Planners & Landscape Architects
3400 140th Avenue, Suite 100
Ottawa, Ontario, Canada K2M 1P6
Telephone: (613) 254-9643
Facsimile: (613) 254-9887
Website: www.novatech-eng.com

LOCATION: CITY OF OTTAWA
600 MARCH ROAD - NOKIA PARKING LOT EXPANSION
DRAWING NAME: LANDSCAPE ENLARGEMENTS AND DETAILS
PROJECT NO.: 121334-00
REV: 6
DRAWING NO.: 121334-L2