

LOCATION PLAN N.T.S.

**TREE CANOPY COVER DATA**  
 (PROJECTION ASSUMED AT 40 YR. MATURITY)

LARGE DECIDUOUS TREES: 10m Dia. Spread  
 78m<sup>2</sup> per x 6 = 468m<sup>2</sup>

CONIFEROUS TREES: 4.5m Dia. Spread  
 16m<sup>2</sup> per x 3 = 48m<sup>2</sup>

TOTAL TREE CANOPY COVER: 516m<sup>2</sup>

DEVELOPMENT SITE AREA minus  
 BLDG. FOOTPRINT: 1597m<sup>2</sup>

**% TREE CANOPY COVER: 32.3**

- GENERAL NOTES**
- This drawing shall be read in conjunction with all relevant Architectural, Engineering and related Drawings and Documents.
  - Refer to Engineering Drawings for Grading and Servicing.
  - Refer to Architectural Drawings for Site layout.
  - Contractor shall provide the location(s) of all services/utilities by consulting Municipal Authorities and Utility companies and shall be responsible for adequate protection from damage during construction.
  - Plant material shall be No.1 Grade and shall comply with the Metric Guide Specifications For Nursery Stock (latest edition), published by the Canadian Nursery Trades Association.
  - Plant Material locations are Schematic / Approximate only. Contractor shall stake out locations on site prior to work.
  - Contractor shall guarantee all plant material for a period of one (1) full year from the date of Completion.
  - Shrubs shall be planted in a continuous prepared bed of 450mm depth planting soil mix covered over with a woven polypropylene weed control fabric (LANDSCAPE FABRIC-Green-Line by Thrace-LINO) and 75mm depth composted pine mulch to finish grade, as specified.
  - Perennials and Ornamental Grasses shall be planted in a continuous prepared bed of 450mm depth planting soil mix covered over with 75mm depth composted pine mulch to finish grade as specified. (NO WEED CONTROL FABRIC)
  - Sod areas to receive 125mm topsoil. Sod shall be No. 1 quality conforming to the Canadian Nursery Sod Growers Specification.
  - Reinstate all areas damaged or disturbed beyond the limit of Work.
  - Plant Material substitutions shall not be permitted without written approval from the Consultant.
  - Contractor shall advise Consultant a minimum of 48hrs. prior to proceeding landscape work and any required Field Reviews.
  - THIS PLAN HAS BEEN PREPARED FOR MUNICIPAL SITE PLAN APPROVAL ONLY AND MAY NOT BE USED FOR ANY OTHER PURPOSE.**

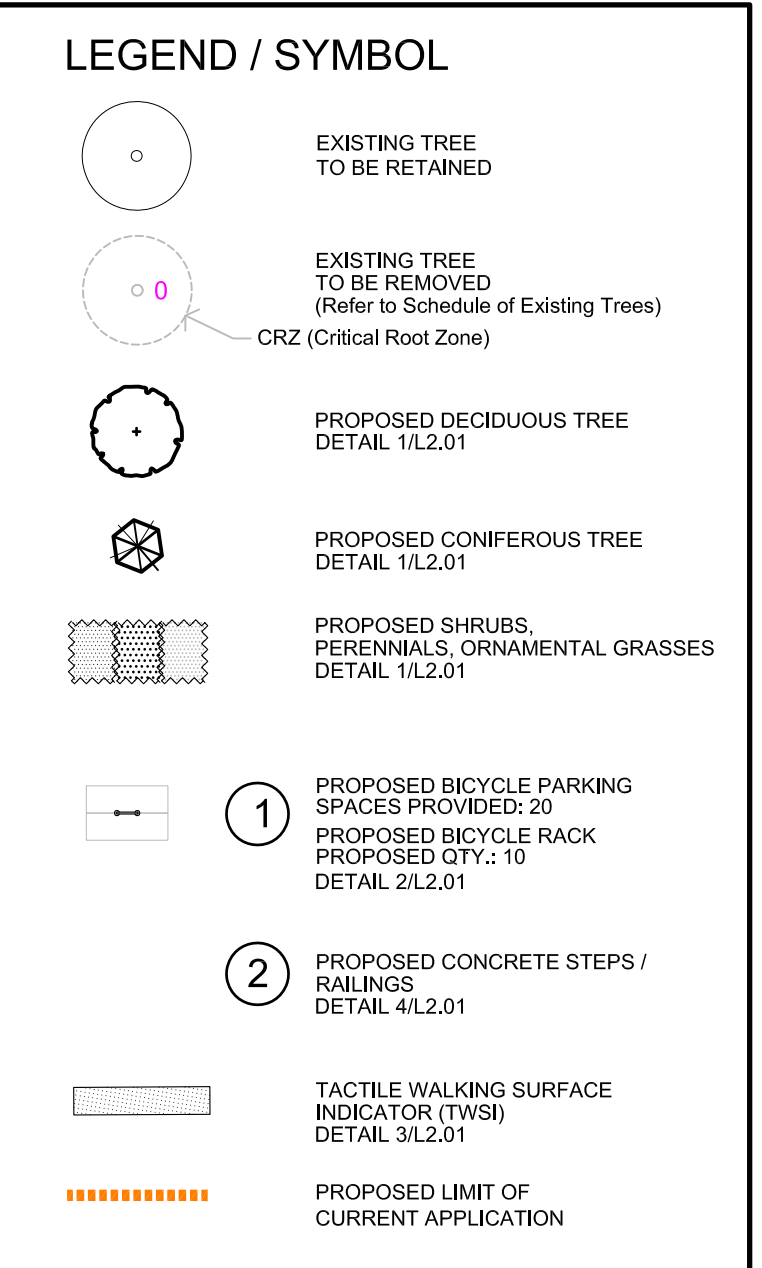

**OWNER:**  
 WOODVALE PENTECOSTAL CHURCH  
 205 Greenbank Rd., Ottawa, ON K2H 8K9

**ARCHITECT:**  
 HOBIN ARCHITECTURE INC.  
 63 Pamilla St., Ottawa, ON K1S 3K7

**CIVIL ENGINEER:**  
 D.B. GRAY ENGINEERING  
 700 Longpoint Circle, Ottawa, ON K1T 4E9

**STRUCTURAL ENGINEER:**  
 WSP  
 2611 Queensview Dr., Ottawa, ON K2B 8K2

**MECHANICAL / ELECTRICAL:**  
 GOODKEY WEEDMARK  
 1688 Woodward Dr., Ottawa, ON K2C 3R8

**LANDSCAPE ARCHITECT**  
 LEVSTEK CONSULTANTS INC.  
 5871 Hugh Cresc., Ottawa, ON K0A 2W0

**LEGAL DESCRIPTION:**  
 Part 1, Plan of, Part of North Half of Lot 31 and Concession 2 (Rideau Front), Geographic Township of Nepean, City of Ottawa.

**APPROVED**  
 By Kersten Nitsche at 2:11 pm, Jun 11, 2024

*Kersten Nitsche*

**KERSTEN NITSCHÉ, MCIP RPP**  
 MANAGER (A), DEVELOPMENT REVIEW WEST  
 PLANNING, DEVELOPMENT AND BUILDING SERVICES  
 DEPARTMENT, CITY OF OTTAWA

**PLANT MATERIAL SCHEDULE**

CODE	BOTANICAL NAME	COMMON NAME	QTY.	SIZE	REMARKS / (N) NATIVE
<b>DECIDUOUS TREES</b>					
CO	CELTIS OCCIDENTALIS	COMMON HACKBERRY	3	50mm cal	B&B, single-stem / N
GT	GLEDITSIA TRIACANTHOS SKYLINE	SKYLINE HONEYLOCUST	3	50mm cal	B&B, single-stem
<b>CONIFEROUS TREES</b>					
PC	PICEA GLAUCA	WHITE SPRUCE	3	200 cm ht	B&B / N
<b>SHRUBS</b>					
PFG	POTENTILLA FRUTICOSA GOLDFINGER	GOLDFINGER CINQUEFOIL	34	50cm ht	potted, 100cm o/c
PO	PHYSCOCARPUS OPULIFOLIUS	COMMON NINEBARK	30	50cm ht	potted, 100cm o/c / N
RB	ROSA BLANDA	SHRUB ROSE	40	50cm ht	potted, 100cm o/c / N
<b>ORNAMENTAL GRASSES</b>					
Cal	CALAMAGROSTIS canadensis	CANADA BLUEJOINT	32	15cm pot	plant 75cm o/c / N

**SCHEDULE OF EXISTING TREES**  
 (Inventory conducted Oct. 1, 2021)

CODE	SPECIES	CONDITION	DBH <sup>1</sup> (cm)	OWNERSHIP	ACTION NOTES
1	Honeylocust	good	22	Private (Owner)	REMOVE / Development conflict;
2	Spruce	good	23	Private (Owner)	REMOVE / Development conflict;
3	Spruce	good	22	Private (Owner)	REMOVE / Development conflict;
4	Spruce	good	20	Private (Owner)	REMOVE / Development conflict;
5	Linden	good	18	Private (Owner)	REMOVE / Development conflict;
6	Linden	good	23	Private (Owner)	REMOVE / Development conflict;

**NOTE:**

- No tree species at risk, as identified under the Province of Ontario Endangered Species Act (ESA), were found on subject property or within 25m of adjacent properties.
- In conformance to the guidelines outlined in the City of Ottawa Protocol for Wildlife Protection During Construction, no clearing of vegetation shall occur between April 15 and August 15, unless a qualified biologist has determined that no bird nesting is occurring within 5 days prior to clearing. A pre-clearing survey for active stick nests and cavity nests shall also be conducted between April 1 and April 15 in order to identify and protect early nesting owls and raptors.

**FOR APPROVAL ONLY**

5.	MAR.28/24	PER CITY COMMENTS (3)
4.	FEB.29/24	PER CITY COMMENTS (2)
3.	NOV.28/23	PER CITY COMMENTS (1)
2.	AUG.31/23	ISSUE FOR SITE PLAN APPROVAL
1.	OCT.19/21	ISSUE FOR REVIEW
no.	date	revision

Contractor shall check and verify all dimensions on site and report all errors and/or omissions to the Consultant.  
 Work to be done in accordance with all applicable codes and by-laws.  
 Do not scale Drawing.  
 This Drawing shall not be used for construction until signed by the Consultant.  
 Copyright reserved. This Drawing is the exclusive property of Levstek Consultants Inc. and shall not be used without consent.



**WOODVALE PENTECOSTAL CHURCH ADDITION PHASE 2**  
 205 GREENBANK ROAD

**LANDSCAPE / TCR PLAN**

Drawn	Project No.	Drawing No.
Scale	1:400	1199
		L1.01