

--

MATERIAL:  
100mm PVC PRESSURE CLASS 150 DR18

STATION	DESCRIPTION	GRADE ELEVATION	TOP OF PIPE	DEPTH OF COVER	NOTES
A+00.0	400mm x 100mm TEE CONNECTION IN 400mm MUNICIPAL WATERMAIN TO CITY OF OTTAWA STANDARDS	75.18	±72.60	±2.58	START OF 50mm THICK, 1200mm WIDE INSULATION
A+02.3	100mm VALVE & VALVE BOX TO CITY OF OTTAWA STANDARDS	75.30	72.60	2.70	ON PROPERTY LINE
A+06.7	5' HORIZONTAL BEND	75.30	72.60	2.70	—
A+12.4 B+00.0	CONNECTION TO 50mm WATERMAIN	75.30	72.60	2.70	
A+14.5	—	75.30	72.60	2.70	CROSSING 150 SAN INV 73.14 WM TOP 72.60 – 540mm CLEARANCE (MIN. 500mm REQ'D)
A+15.0 C+00.0	CONNECTION TO 50mm WATERMAIN	75.30	72.60	2.70	—
A+15.3	—	75.30	72.60	2.70	CROSSING 150 ST INV 73.14 WM TOP 72.60 – 540mm CLEARANCE (MIN. 500mm REQ'D)
A+16.3	100mm END CAP TO CITY OF OTTAWA STANDARDS	75.30	72.60	2.70	—

MATERIAL:  
50mm PEX TUBING TO AWWA C-904 SDR 9 (CTS)

STATION	DESCRIPTION	GRADE ELEVATION	TOP OF PIPE	DEPTH OF COVER	NOTES
B+00.0 A+12.4	CONNECTION TO 100mm WATERMAIN	75.30	72.60	2.70	—
B+03.1	—	75.30	72.22	3.08	CROSSING 200 ST INV 72.72 WM TOP 72.22 — 500mm CLEARANCE (MIN. 500mm REQ'D)
B+04.2	—	75.30	72.10	3.20	CROSSING 300 ST INV 72.60 WM TOP 72.10 — 500mm CLEARANCE (MIN. 500mm REQ'D)
B+06.0	—	75.45	72.41	3.04	CROSSING 200 SAN TOP 72.15 WM U/S 72.40 — 250mm CLEARANCE (MIN. 250mm REQ'D)
B+6.8	50mm CURB STOP & SERVICE POST TO CITY OF OTTAWA STANDARDS	75.47	72.80	2.67	—
B+07.8	—	75.48	72.80	2.68	ENTRY INTO BUILDING
A+00.0 C+15.0	CONNECTION TO 100mm WATERMAIN	75.30	72.60	2.70	—
C+01.0	50mm CURB STOP & SERVICE POST TO CITY OF OTTAWA STANDARDS	75.46	72.83	2.63	—
C+02.0	—	75.48	72.99	2.49	ENTRY INTO BUILDING

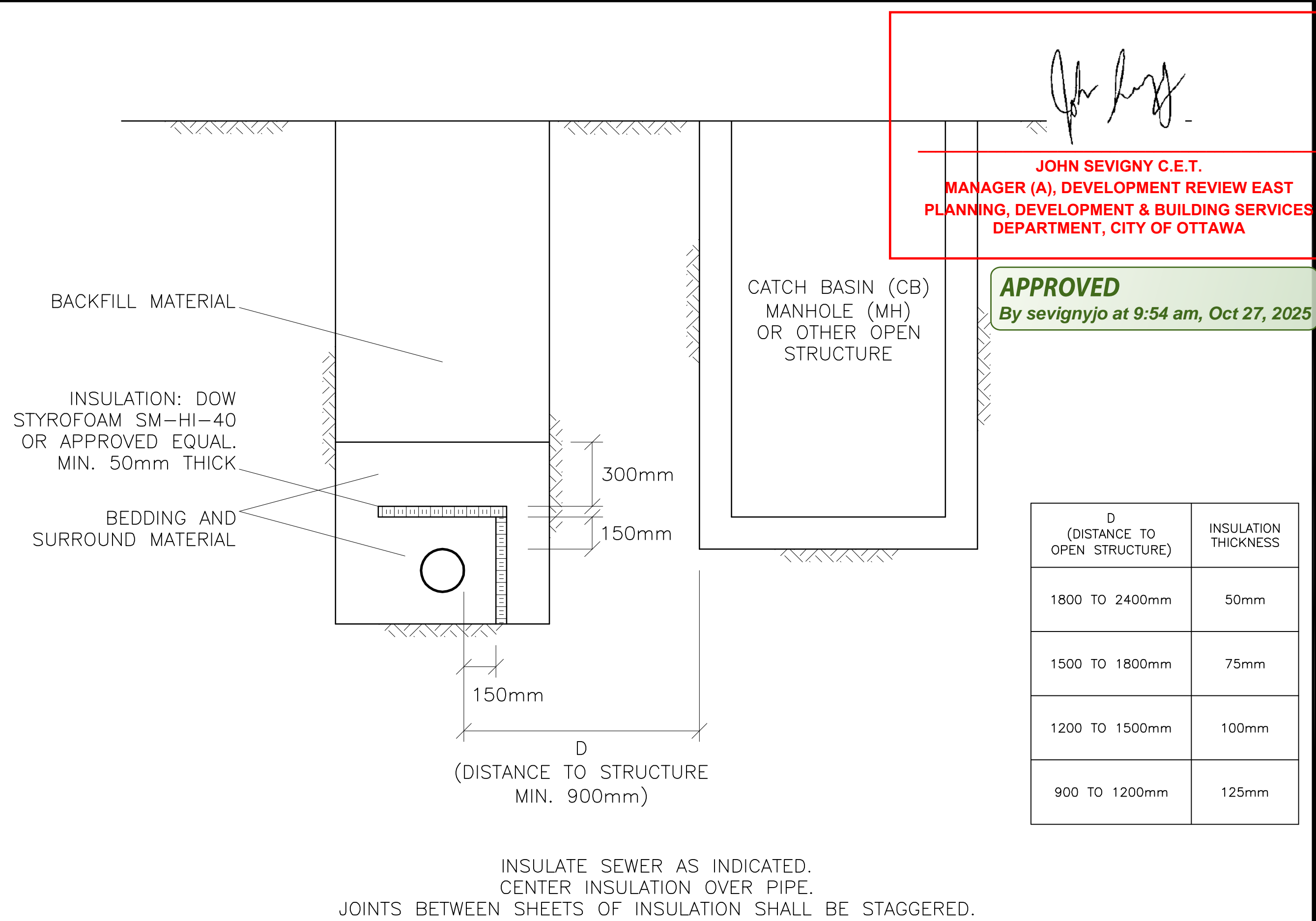

INSULATION OF WATERMAINS &  
WATER SERVICE CONNECTIONS  
AT OPEN STRUCTURES  
AS PER CITY OF OTTAWA DRAWING No. W23  
N.T.S

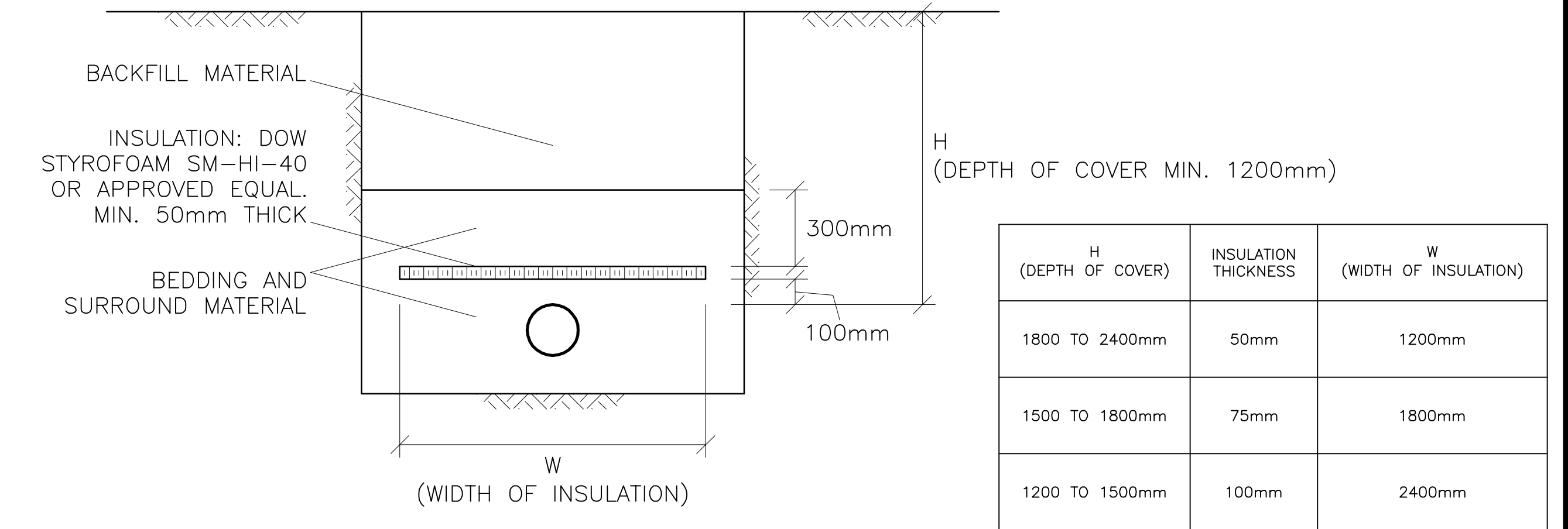

INSULATE WATERMAIN AS INDICATED AND WHERE DEPTH OF COVER  
IS LESS THAN 2400mm. PROVIDE A MINIMUM 1200mm COVER.  
CENTER INSULATION OVER PIPE.  
JOINTS BETWEEN SHEETS OF INSULATION SHALL BE STAGGERED.

INSULATION OF WATERMAINS &  
WATER SERVICE CONNECTIONS  
IN SHALLOW TRENCHES  
N.T.S

  
JOHN SEVIGNY C.E.T.  
MANAGER (A), DEVELOPMENT REVIEW EAST  
PLANNING, DEVELOPMENT & BUILDING SERVICES  
DEPARTMENT, CITY OF OTTAWA

**APPROVED**  
By sevignyjo at 9:54 am, Oct 27, 2025

D (DISTANCE TO OPEN STRUCTURE)	INSULATION THICKNESS
1800 TO 2400mm	50mm
1500 TO 1800mm	75mm
1200 TO 1500mm	100mm
900 TO 1200mm	125mm

## KEY PLAN



4	JUN 4-25	RE-ISSUED FOR APPROVAL
3	SEP 12-24	ISSUED FOR APPROVAL
2	MAY 6-24	ISSUED FOR APPROVAL
1	MAY 2-24	ISSUED FOR COORDINATION
No.	DATE	REVISION

**D. B. GRAY ENGINEERING INC.**  
*Stormwater Management - Grading & Drainage - Storm & Sanitary Sewers - Watermain*

700 Long Point Circle 613-425-8044  
 Ottawa, Ontario d.gray@dbgrayengineering.com

Project

STACKED TOWNS  
BUILDING A – 20 UNITS  
BUILDING B – 24 UNITS  
2506 INNES ROAD  
OTTAWA, ONTARIO

Drawing Title

**SCHEDULES**  
(WATER SERVICE)

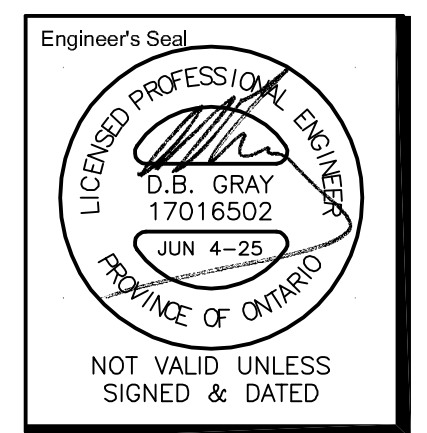

Drawn	D.B.G
H. Scale	
V. Scale	
Date	Dec 20-23
Job No.	23087

Drawing No.  
C-10  
of 12