

TREE SCHEDULE	788 MARCH ROAD MULTI UNIT RESIDENTIAL		BOTANICAL NAME	COMMON NAME	B&B SPECIMEN	NATIVE TO CANADA	FORECASTED SPREAD		Canopy Cover Contribution/Tree in Square Metres	TOTAL Canopy Cover Contribution in Square Metres		EXISTING Canopy Cover PRIVATE
	CODE	QUANTITY					DIA/M	RADIUS		PRIVATE	PUBLIC	
AC	0	1	Amelanchier canadensis	Tree Serviceberry	50mm cal	YES	4M	2m	12.5	0	12.5	
AR	0	2	Acer rubrum	Red Maple	60mm cal	YES	12M	6m	113	0	226	
AS	4	0	Acer saccharum	Sugar Maple	60mm cal	YES	15M	7.5m	175	700	0	
AG	1	2	Aesculus glabra	Ohio Buckeye	50mm cal	YES	10M	5m	78.5	157	0	
BP	6	0	Betula papyrifera	Paper Birch	50mm cal	YES	10M	5m	78.5	471	0	
CO	2	2	Celtis occidentalis	Common Hackberry	50mm cal	YES	18M	9m	250	500	500	
GB	0	6	Ginkgo biloba Princeton Sentry	Princeton Sentry Ginkgo	60mm cal	N/A	3M	2.5m	19.5	0	117	
GD	0	3	Gymnocladia dioica	Kentucky Coffee Tree	50mm cal	YES	12M	6m	113	0	339	
QM	0	4	Quercus macrocarpa	Bur Oak	50mm cal	YES	20M	10m	315	0	1260	
QR	0	2	Quercus rubra	Red Oak	50mm cal	YES	15M	7.5m	175	0	350	
TA	2	1	Tilia americana	Basowood	50mm cal	YES	13M	6.5m	135	270	135	
TOTALS	13	23							2019.5	3084	4500	

SITE AREA: 12 210 SQ. M.
ROW AREA +/- 1 700 SQ. M.
CANOPY COVER:
CURRENT APPROX FROM GEO
OTTAWA 4 500 SQ. M.
ADDITIONAL PROVIDED: 5 000 SQ. M.

Code	Qty.	Botanical Name	Common Name	Size	Condition	NATIVE
ac	TBD	Amelanchier canadensis	Serviceberry	60cm Ht.	Pot	YES
au	TBD	Arctostaphylos Uva Ursi	Bearberry	30cm spr	Pot	YES
cr	TBD	Cornus racemosa	Grey Dogwood	60cm Ht.	Pot	YES
hk	TBD	Hypericum kalmianum	Kalm St. John's Wort	30cm Ht.	Pot	YES
hk	TBD	Hypericum prolificum	Shrubby St. John's Wort	40cm Ht.	Pot	YES
PF	TBD	Potentilla fruticosa 'Abbotswood'	Abbotswood Potentilla	30cm Ht.	Pot	NO
RP	TBD	Rosa palustris	Swamp Rose	50cm Ht.	Pot	YES
RT	TBD	Rhus typhina	Staghorn Sumac	30cm Ht.	Pot	YES
SA	TBD	Symphoricarpos albus	Snowberry	50cm Ht.	Pot	YES
SA	TBD	Spiraea alba	Meadowsweet	50cm Ht.	Pot	YES
SB	TBD	Spiraea bumalda 'Dart's Red'	Dart's Red Spirea	40cm Ht.	Pot	NO
vi	TBD	Viburnum lentago	Nannyberry	60cm Ht.	Pot	YES
JCO	TBD	Juniperus chinensis 'Ontario Green'	Ontario Green Juniper	30cm spr	Pot	NO
PM	TBD	Pinus mugo var. pumilio	Mugho Pine	30cm spr	Pot	NO
TCm	TBD	Taxus cuspidata 'Monloo'	Emerald Spreader Yew	30cm spr	Pot	NO
TC	TBD	Sambucus canadensis	Elderberry	50cm Ht.	Pot	YES

Code	Qty.	Botanical Name	Common Name	Condition
GM	TBD	Geranium macrorrhizum	Bigroot Geranium	9cm Pot
GR	TBD	Geranium psilostemon 'Gerwat'	Rozanne Geranium	9cm Pot
PV	TBD	Panicum virgatum	Switch Grass	9cm Pot

TOTAL OF ABOVE SHRUBS 1250.

Code	Qty.	Botanical Name	Common Name	Condition
GM	TBD	Geranium macrorrhizum	Bigroot Geranium	9cm Pot
GR	TBD	Geranium psilostemon 'Gerwat'	Rozanne Geranium	9cm Pot
PV	TBD	Panicum virgatum	Switch Grass	9cm Pot

TOTAL OF 3 ITEMS ABOVE - 750

*****ADDITIONAL LANDSCAPE PLAN NOTES*****

LANDSCAPING ON CITY OF OTTAWA PROPERTY TO BE TO CITY OF OTTAWA DETAILS / STANDARDS. ADHERE TO TREE PLANTING DETAIL L3. TREES ON CITY OF OTTAWA PROPERTY TO CARRY A 2 YEAR WARRANTY. REFER TO SITE PLAN FOR LOCATIONS AND DIMENSIONS OF BUILDING, ROADS, PARKING, CURBS, SETBACKS, EASEMENTS, LEGAL DESCRIPTION. EXISTING AND PROPOSED SITE SERVICING IS SHOWN ON THE LANDSCAPE PLAN TO PROVIDE AN AWARENESS TO REVIEWERS AND CONTRACTORS OF THEIR INTENDED LOCATION AND SEPARATION OF TREES/SERVICES/PROPOSED LANDSCAPING. DETERMINE AS BUILT LOCATIONS OF SERVICES PRIOR TO PLANTING AND ADJUST ACCORDINGLY TO RESPECT REQUIRED SETBACKS

Planner
FOTENN
 396 Cooper Street, Suite 300, Ottawa, ON K2P 2H7
 T 613 750 5709 fotenn.com
 Transportation Engineering
PARSONS
 1223 Metcal Street, Suite 100, Ottawa, ON K1J 7T2
 T 613 738 4160 parsons.com
 Civil
McINTOSH PERRY
 115 Walgreen Road RR 3 Carp, Ottawa, ON K0A 1L0
 T 613 836 2184 mcintoshperry.com
 Architect
NEUF architect(e)s
 630 boul. René-Lévesque O. 32e étage, Montréal, QC H3B 1S6
 T 514 847 1117 neuf.ca

LIMIT OF CONSTRUCTION ON KLONDIKE AND MARCH REFER TO CIVIL SERVICING PLANS - MINIMUM FACE OF EXISTING CURB.

Code	Qty.	Botanical Name	Common Name	Size	Condition	NATIVE
15	Amelanchier canadensis	Serviceberry	1.0m Ht.	Pot	YES	
15	Acer pensylvanicum	Striped Maple	1.0m Ht.	Pot	YES	
10	Acer rubrum	Red Maple	1.0m Ht.	Pot	YES	
10	Acer saccharum	Sugar Maple	1.0m Ht.	Pot	YES	
10	Betula papyrifera	Paper Birch	1.0m Ht.	Pot	YES	
5	Carya ovata	Shagbark Hickory	1.0m Ht.	Pot	YES	
5	Carya cordiformis	Bittersweet Hickory	1.0m Ht.	Pot	YES	
15	Celtis occidentalis	Common Hackberry	1.0m Ht.	Pot	YES	
15	Cornus alternifolia	Pagoda Dogwood	1.0m Ht.	Pot	YES	
25	Cornus racemosa	Grey Dogwood	1.0m Ht.	Pot	YES	
15	Ostrya virginiana	Hophornbeam Ironwood	1.0m Ht.	Pot	YES	
15	Pinus pensylvanica	Pin Cherry	1.0m Ht.	Pot	YES	
15	Pinus serotina	Black Cherry	1.0m Ht.	Pot	YES	
15	Quercus alba	White Oak	1.0m Ht.	Pot	YES	
15	Quercus bicolor	Swamp White Oak	1.0m Ht.	Pot	YES	
15	Quercus macrocarpa	Bur Oak	1.0m Ht.	Pot	YES	
15	Quercus rubra	Red Oak	1.0m Ht.	Pot	YES	
25	Viburnum lentago	Nannyberry	1.0m Ht.	Pot	YES	
255						
15	Abies balsamea	Balsam Fir	50cm Ht.	Pot	YES	
5	Juniperus virginiana	Eastern Red Cedar	50cm Ht.	Pot	YES	
15	Larix laricina	Eastern Larch / Tamarack	50cm Ht.	Pot	YES	
5	Picea glauca	White Spruce	50cm Ht.	Pot	YES	
5	Picea mariana	Black Spruce	50cm Ht.	Pot	YES	
5	Pinus strobus	White Pine	50cm Ht.	Pot	YES	
15	Taxus canadensis	Canadian Hemlock	50cm Ht.	Pot	YES	
75	Rhus typhina	Staghorn Sumac	30cm Ht.	Pot	YES	

Spacing to Vary 1.0 to 2.1m / 3' to 7" On Centre

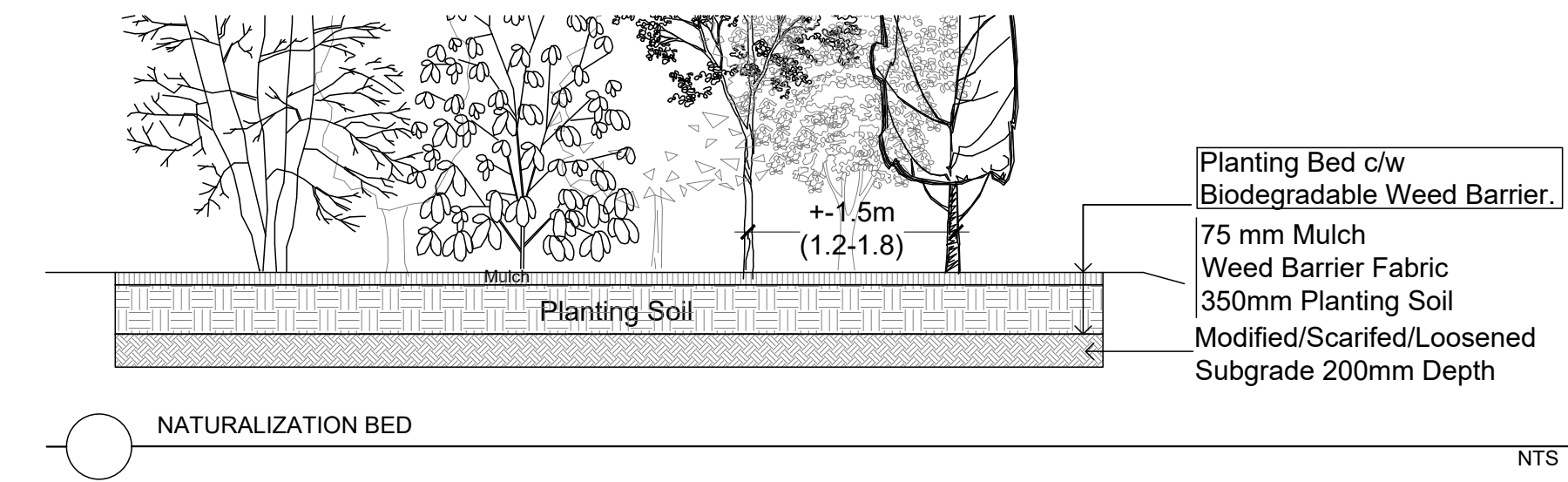
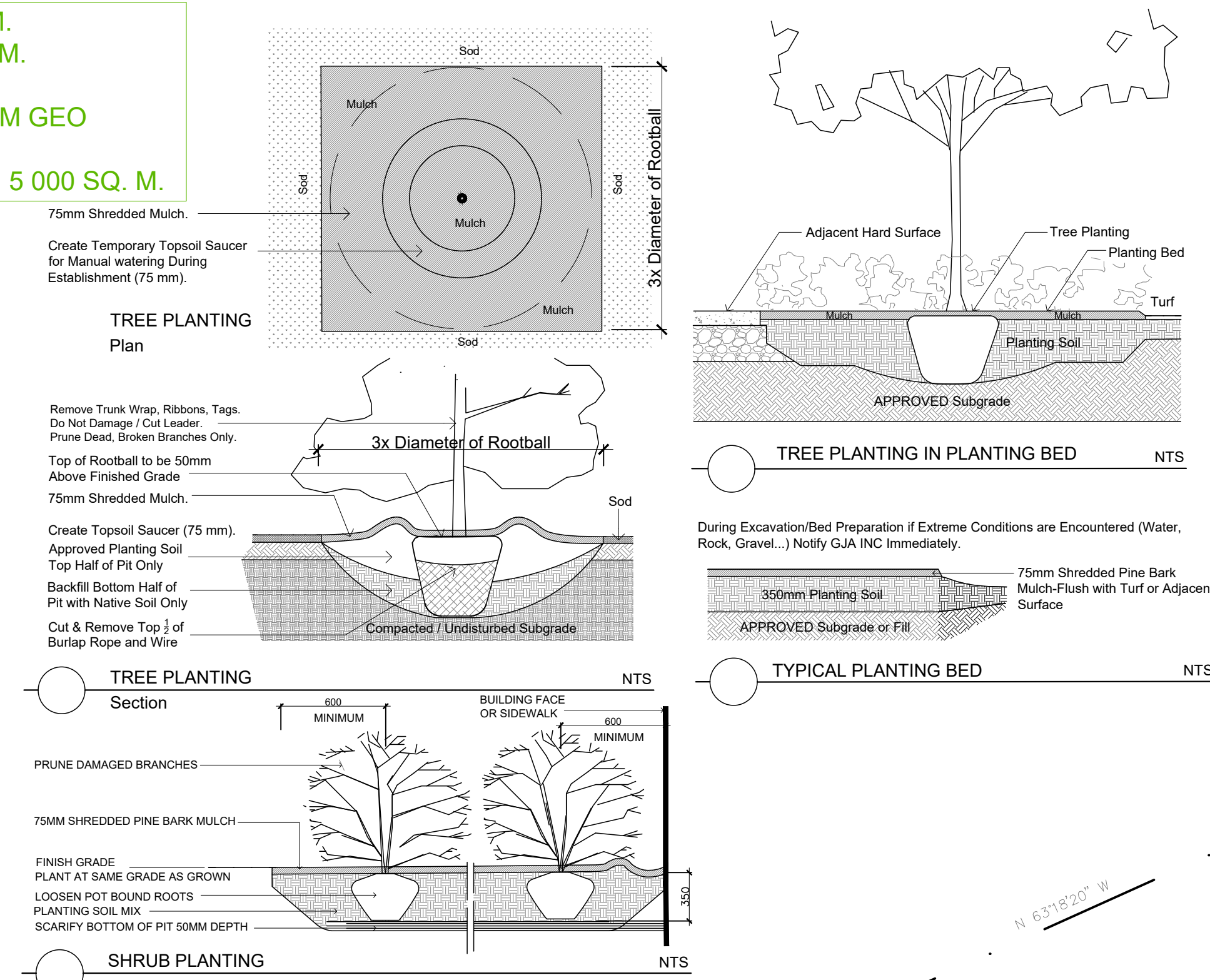

Drawing Remains the Property of Copyright Reserved by Gino J. Aiello Landscape Architect. Do Not Use or Reproduce Without Approval of Gino J. Aiello.
NOT To Be Used For Construction Unless indicated by Revision: "FOR LANDSCAPE CONSTRUCTION"
 Contractor is Responsible for Verification of Site Locations of all Utilities. Report any Discrepancies Between Site and Drawing Immediately to Gino J. Aiello. Do NOT Proceed Until Clarified.
 TURF AREAS TO BE SOD CW 150MM DEPTH TOPSOIL ON APPROVED SUBGRADE | SOD TO BE #1 GRADE TURF GRASS NURSE SOD per NSGA - Fine Fescue/Kentucky Bluegrass Sod | PLANTING MIX TO BE APPROVED BY LANDSCAPE ARCHITECT | PLANT MATERIAL TO MEET CNLA STANDARDS/BE APPROVED BY LANDSCAPE ARCHITECT PRIOR TO PLANTING ALL MATERIALS & WORK TO BE MAINTAINED UNTIL FINAL ACCEPTANCE, (MOWING TURF, WEEDING BEDS, WATERING TURF & PLANTS) & INCLUDE 1 YEAR WARRANTY FROM DATE OF FINAL ACCEPTANCE | PROVIDE WATERING OF ALL PLANT MATERIAL AS REQUIRED FOR PROPER ESTABLISHMENT, UNTIL END OF WARRANTY PERIOD | REFER TO CIVIL ENGINEER'S DRAWING FOR ELEVATIONS / GRADING |
 The Landscape Plan is to be read in conjunction with the grading, servicing, site and survey plan | Bare root material to be planted in season only | All plant material locations to be staked on site by the landscape contractor and checked by the landscape architect prior to planting | All trees to be preserved on or directly adjacent to the site will be protected | Plant material are to be installed a minimum of 3.0m away from any part of any hydro transformer, 3.0m corridor between a fire hydrant and the curb, a 2.5m radius beside or behind a fire hydrant, 2.0m from any service/utility line or structure |

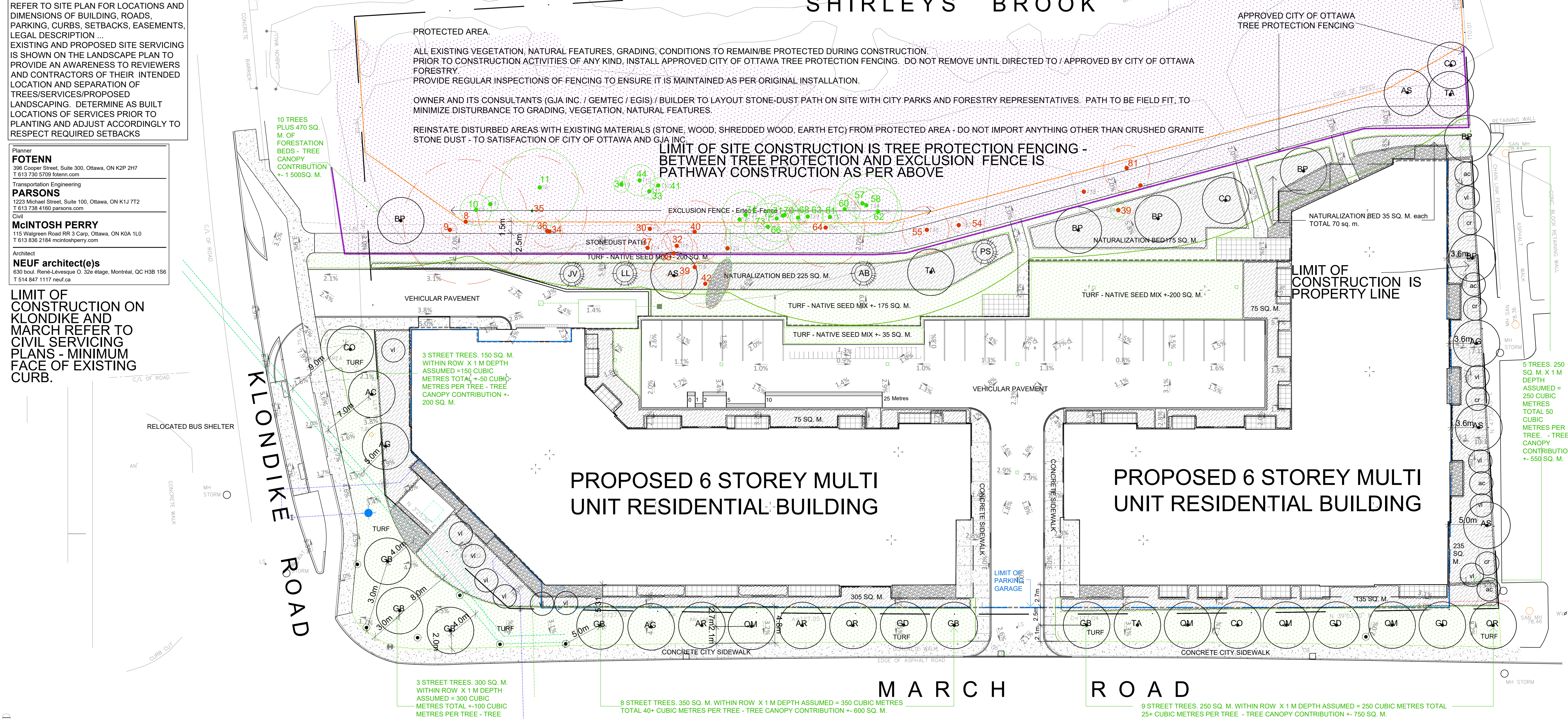
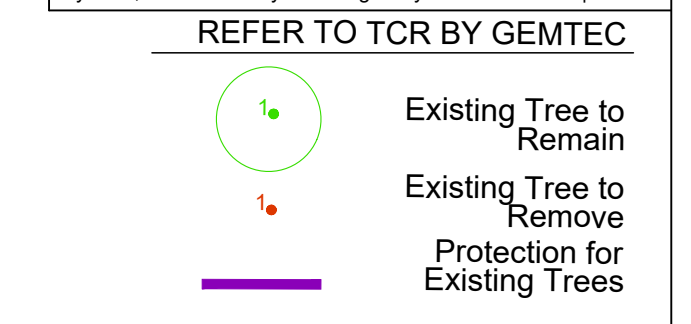

Revision	Description	Date
4	per CIVIL SERVICING	2024 09 25
3	3RD SUBMISSION SPC	2024 06 19
2	2ND SUBMISSION SPC	2024 03 19
1	1ST SUBMISSION SPC	2023 11 17
0	REVIEW/COORDINATION	2023 09 29

#	Revision	Date
1	REVISION	2023 09 29

SINA
 3030 Carrefour Blvd, Office 1200, Laval, Quebec, H7T 2P5 514.565.7462

GJA INC.
 GINO J. AIELLO | LANDSCAPE ARCHITECT
 GJALA.COM | 613 298 5130 | GINO@GJALA.COM
 115 WALGREEN ROAD UNIT # 1 OTTAWA ONTARIO K0A 1L0

PROPOSED 6 STOREY RESIDENTIAL BUILDING
 788 MARCH ROAD KANATA

Landscape Plan L1
 Scale: 1:250