

TREE SCHEDULE 788 MARCH ROAD MULTI UNIT RESIDENTIAL						
CODE	QUANTITY	BOTANICAL NAME	COMMON NAME	B&B SPECIMEN	SPREAD	NATIVE
AC	0	Amelanchier canadensis	Tree Serviceberry	50mm cal	4M	YES
AR	0	Acer rubrum	Red Maple	60mm cal	12M	YES
AS	4	Acer saccharum	Sugar Maple	60mm cal	15M	YES
AG	1	Aesculus glabra	Ohio Buckeye	50mm cal	10M	YES
BP	6	Betula papyrifera	Paper Birch	50mm cal	10M	YES
CO	2	Celtis occidentalis	Common Hackberry	50mm cal	18M	YES
GB	0	Ginkgo biloba Princeton Sentry	Princeton Sentry Ginkgo	60mm cal	5M	N/A
GD	0	Gymnocladus dioicus	Kentucky Coffee Tree	50mm cal	12M	YES
QM	0	Quercus macrocarpa	Bur Oak	50mm cal	20M	YES
QR	0	Quercus rubra	Red Oak	50mm cal	15M	YES
TA	2	Tilia americana	Basewood	50mm cal	13M	YES
TOTALS	15	23				
AB	1	Abies balsamea	Balsam Fir	1.5m Ht.	N/A	YES
JV	1	Juniperus virginiana	Eastern Red Cedar	1.5m Ht.	N/A	YES
LL	1	Larix laricina	Eastern Larch / Tamarack	1.5m Ht.	N/A	YES
PS	1	Pinus strobus	White Pine	1.5m Ht.	N/A	YES

SHRUBS 788 MARCH ROAD KANATA - SINA - 750 SQ. M.						
Code	Qty.	Botanical Name	Common Name	Size	Condition	NATIVE
ac	TBD	Amelanchier canadensis	Serviceberry	60cm Ht.	Pot	YES
au	TBD	Arctostaphylos Uva Ursi	Bearberry	30cm spr	Pot	YES
cr	TBD	Cornus racemosa	Grey Dogwood	60cm Ht.	Pot	YES
hk	TBD	Hypericum kalmianum	Kalm St. John's Wort	30cm Ht.	Pot	YES
hk	TBD	Hypericum proflifum	Shrubby St. John's Wort	40cm Ht.	Pot	YES
pf	TBD	Potentilla fruticosa 'Abbotswood'	Abbotswood Potentilla	30cm Ht.	Pot	NO
rp	TBD	Rosa palustris	Swamp Rose	50cm Ht.	Pot	YES
rt	TBD	Rhus typhina	Staghorn Sumac	30cm Ht.	Pot	YES
sa	TBD	Symphoricarpos albus	Snowberry	50cm Ht.	Pot	YES
sa	TBD	Spiraea alba	Meadowsweet	50cm Ht.	Pot	YES
sb	TBD	Spiraea bumalda 'Dart's Red'	Dart's Red Spirea	40cm Ht.	Pot	NO
vl	TBD	Viburnum lentago	Nannyberry	60cm Ht.	Pot	YES
jco	TBD	Juniperus chinensis 'Ontario Green'	Ontario Green Juniper	30cm spr	Pot	NO
pm	TBD	Pinus mugo var. pumilio	Mugho Pine	30cm spr	Pot	NO
tcm	TBD	Taxus cuspidata 'Monlo'	Emerald Spreader Yew	30cm spr	Pot	NO
sc	TBD	Sambucus canadensis	Elderberry	50cm Ht.	Pot	YES

TOTAL OF ABOVE SHRUBS 1250.				
Code	Qty.	Botanical Name	Common Name	Condition
GM	TBD	Geranium macrorrhizum	Bigroot Geranium	9cm Pot
GR	TBD	Geranium psilostemon 'Gerwat'	Rozanne Geranium	9cm Pot
PV	TBD	Panicum virgatum	Switch Grass	9cm Pot

*******ADDITIONAL LANDSCAPE PLAN NOTES**
 LANDSCAPING ON CITY OF OTTAWA PROPERTY TO BE TO CITY OF OTTAWA DETAILS / STANDARDS. ADHERE TO TREE PLANTING DETAIL L3. TREES ON CITY OF OTTAWA PROPERTY TO CARRY A 2 YEAR WARRANTY.
 REFER TO SITE PLAN FOR LOCATIONS AND DIMENSIONS OF BUILDING, ROADS, PARKING, CURBS, SETBACKS, EASEMENTS, LEGAL DESCRIPTION ...
 EXISTING AND PROPOSED SITE SERVICING IS SHOWN ON THE LANDSCAPE PLAN TO PROVIDE AN AWARENESS TO REVIEWERS AND CONTRACTORS OF THEIR INTENDED LOCATION AND SEPARATION OF TREES/SERVICES/PROPOSED LANDSCAPING. DETERMINE AS BUILT LOCATIONS OF SERVICES PRIOR TO PLANTING AND ADJUST ACCORDINGLY TO RESPECT REQUIRED SETBACKS

NATURALIZATION BED 1				
475 sq. m.	Botanical Name	Common Name	Size	Condition
15	Amelanchier canadensis	Serviceberry	1.0m Ht	Pot
15	Acer pensylvanicum	Striped Maple	1.0m Ht	Pot
10	Acer rubrum	Red Maple	1.0m Ht	Pot
10	Acer saccharum	Sugar Maple	1.0m Ht	Pot
10	Betula papyrifera	Paper Birch	1.0m Ht	Pot
5	Carya ovata	Shagbark Hickory	1.0m Ht	Pot
5	Carya cordiformis	Bitternut Hickory	1.0m Ht	Pot
15	Celtis occidentalis	Common Hackberry	1.0m Ht	Pot
15	Cornus alternifolia	Pagoda Dogwood	1.0m Ht	Pot
25	Cornus racemosa	Grey Dogwood	1.0m Ht	Pot
15	Ostrya virginiana	Hophornbeam Ironwood	1.0m Ht	Pot
15	Prunus pensylvanica	Pin Cherry	1.0m Ht	Pot
15	Prunus serotina	Black Cherry	1.0m Ht	Pot
15	Quercus alba	White Oak	1.0m Ht	Pot
15	Quercus bicolor	Swamp White Oak	1.0m Ht	Pot
15	Quercus macrocarpa	Bur Oak	1.0m Ht	Pot
15	Quercus rubra	Red Oak	1.0m Ht	Pot
25	Viburnum lentago	Nannyberry	1.0m Ht	Pot
255				
15	Abies balsamea	Balsam Fir	50cm Ht.	Pot
5	Juniperus virginiana	Eastern Red Cedar	50cm Ht.	Pot
15	Larix laricina	Eastern Larch / Tamarack	50cm Ht.	Pot
5	Picea glauca	White Spruce	50cm Ht.	Pot
5	Picea mariana	Black Spruce	50cm Ht.	Pot
5	Pinus strobus	White Pine	50cm Ht.	Pot
15	Tsuga canadensis	Canadian Hemlock	50cm Ht.	Pot
50				
75	Rhus typhina	Staghorn Sumac	30cm Ht.	Pot

SITE AREA: 12 210 SQ. M.
ROW AREA +- 1 700 SQ. M.
CANOPY COVER:
CURRENT APPROX FROM GEO OTTAWA 5 000 SQ. M.
ADDITIONAL PROVIDED: 3800 SQ. M.

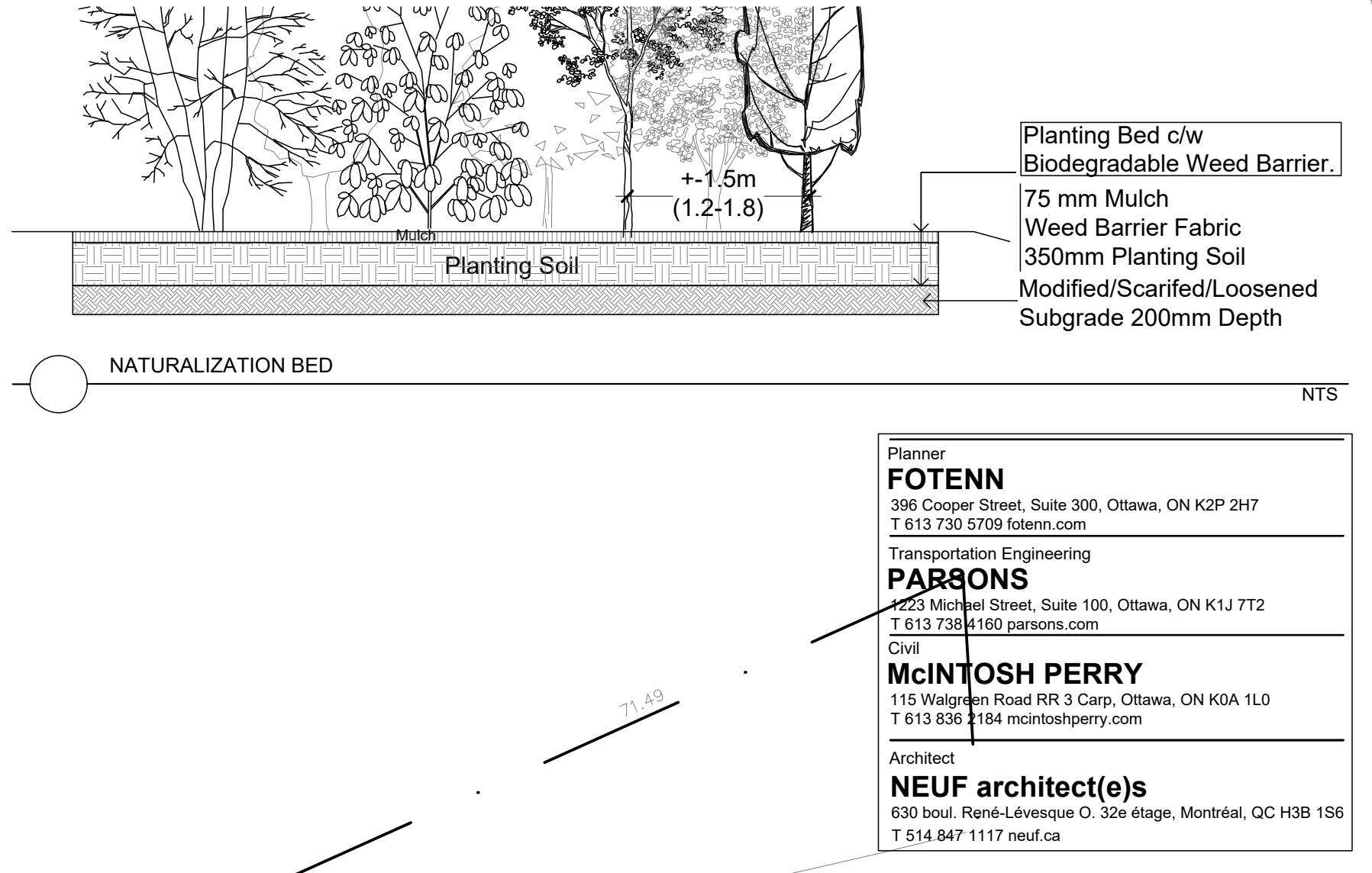
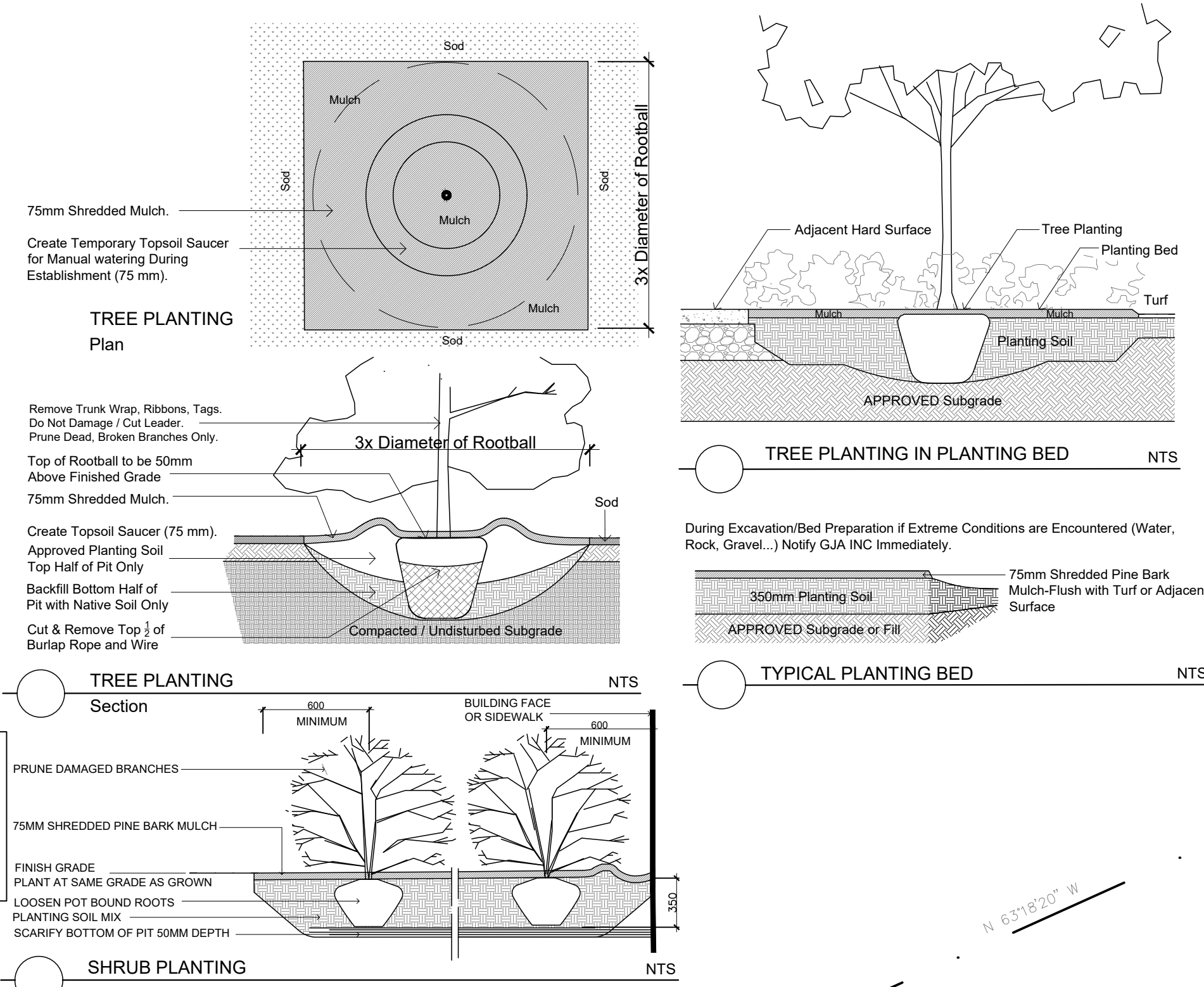

Planner
FOTENN
 396 Cooper Street, Suite 300, Ottawa, ON K2P 2H7
 T 613 730 5709 fotenn.com
 Transportation Engineering

PARSONS
 1223 Michael Street, Suite 100, Ottawa, ON K1J 7T2
 T 613 738 4160 parsons.com
 Civil

McINTOSH PERRY
 115 Wellington Road RR 3 Camp, Ottawa, ON K0A 1L0
 T 613 836 1184 mcintoshperry.com

Architect
NEUF architect(e)s
 630 boul. René-Lévesque O. 32e étage, Montréal, QC H3B 1S6
 T 514 847 1117 neuf.ca

Drawing Remains the Property of Copyright Reserved by Gino J. Aiello Landscape Architect. Do Not Use or Reproduce Without Approval of Gino J. Aiello.
NOT TO BE USED FOR CONSTRUCTION UNLESS INDICATED BY REVISION: "FOR LANDSCAPE CONSTRUCTION"
 Contractor is Responsible for Verification of Site Locations of all Utilities. Report any Discrepancies Between Site and Drawing Immediately to Gino J. Aiello. Do NOT Proceed Until Clarified.
 TURF AREAS TO BE SOD CW 150MM DEPTH TOPSOIL ON APPROVED SUBGRADE | SOD TO BE #1 GRADE TURF GRASS NURSERY SOD per NSGA - Fine Fescue/Kentucky Bluegrass Sod | PLANTING MIX TO BE APPROVED BY LANDSCAPE ARCHITECT | PLANT MATERIAL TO MEET CNLA STANDARDS/BE APPROVED BY LANDSCAPE ARCHITECT PRIOR TO PLANTING ALL MATERIALS & WORK TO BE MAINTAINED UNTIL FINAL ACCEPTANCE, (MOWING TURF, WEEDING BEDS, WATERING TURF & PLANTS), & INCLUDE 1 YEAR WARRANTY FROM DATE OF FINAL ACCEPTANCE | PROVIDE WATERING OF ALL PLANT MATERIAL AS REQUIRED FOR PROPER ESTABLISHMENT, UNTIL END OF WARRANTY PERIOD | REFER TO CIVIL ENGINEER'S DRAWING FOR ELEVATIONS / GRADING |
 The Landscape Plan is to be read in conjunction with the grading, servicing, site and survey plan | Bare root material to be stocked on site by the landscape contractor and checked by the landscape architect prior to planting | All trees to be preserved on or directly adjacent to the site will be protected | Plant material are to be installed a minimum of 3.0m away from any part of any hydro transformer, 3.0m corridor between a fire hydrant and the curb, a 2.5m radius beside or behind a fire hydrant, 2.0m from any servicing/utility line or structure |

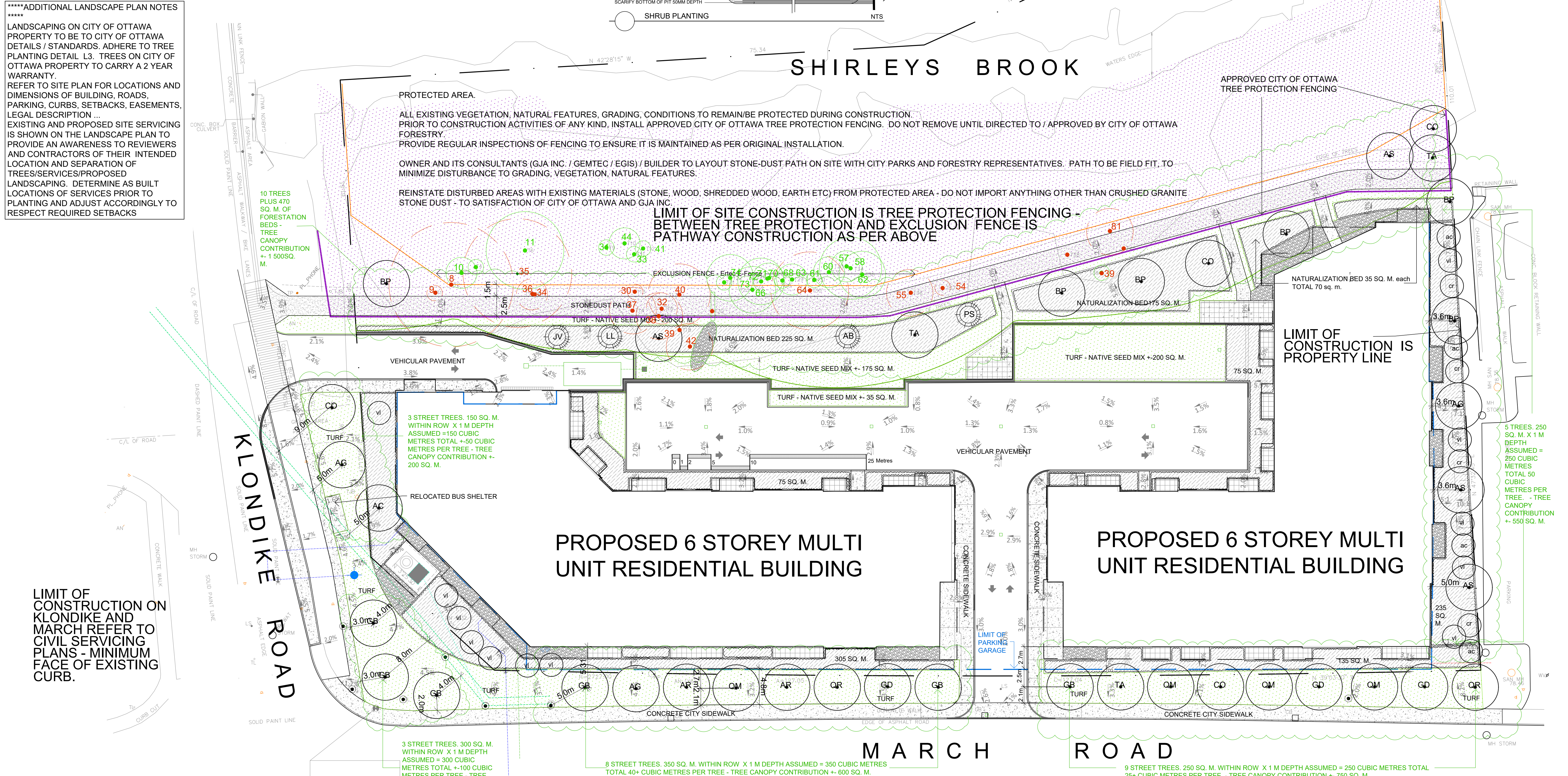
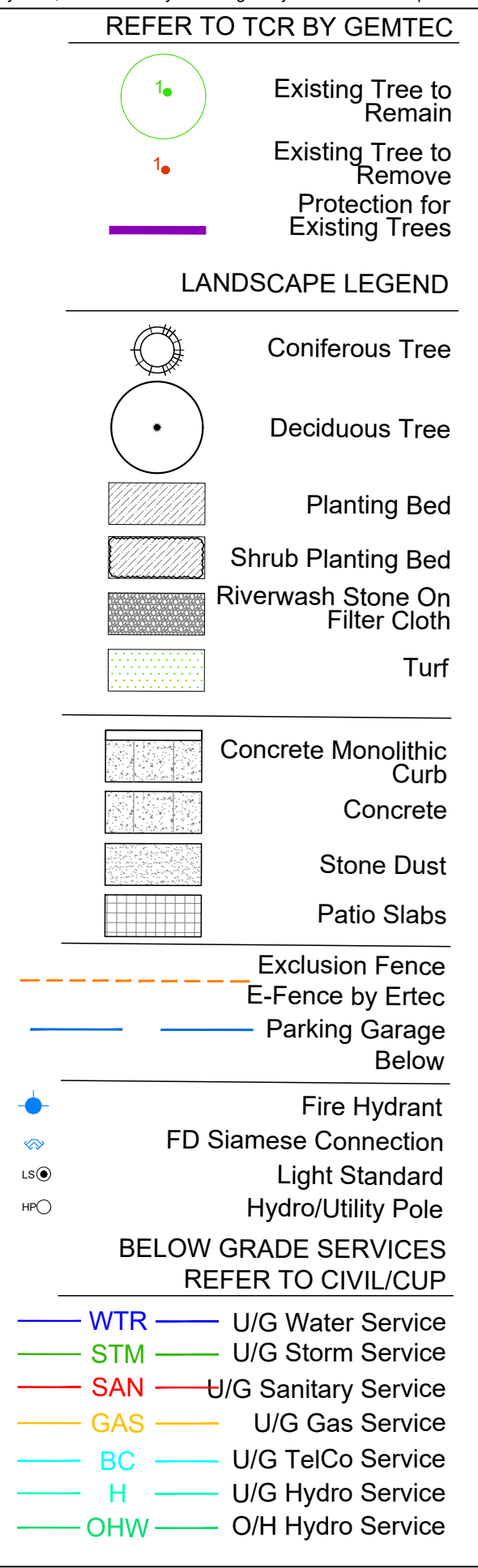

PROPOSED 6 STOREY RESIDENTIAL BUILDING
 788 MARCH ROAD KANATA

LANDSCAPE PLAN L1
 Scale: 1:250

#	Revision	Date
3	3RD SUBMISSION SPC	2024 06 19
2	2ND SUBMISSION SPC	2024 03 19
1	1ST SUBMISSION SPC	2023 11 17
0	REVIEW/COORDINATION	2023 09 29

SINA
 3030 Carrefour Blvd, Office 1200, Laval, Quebec, H7T 2P5 514.565.7462

GJA INC.
 GINO J. AIELLO | LANDSCAPE ARCHITECT
 GJALA.COM | 613 298 5130 | GINO@GJALA.COM
 115 GERRARD ROAD UNIT #1 | OTTAWA, ONTARIO | K1P 6Z