

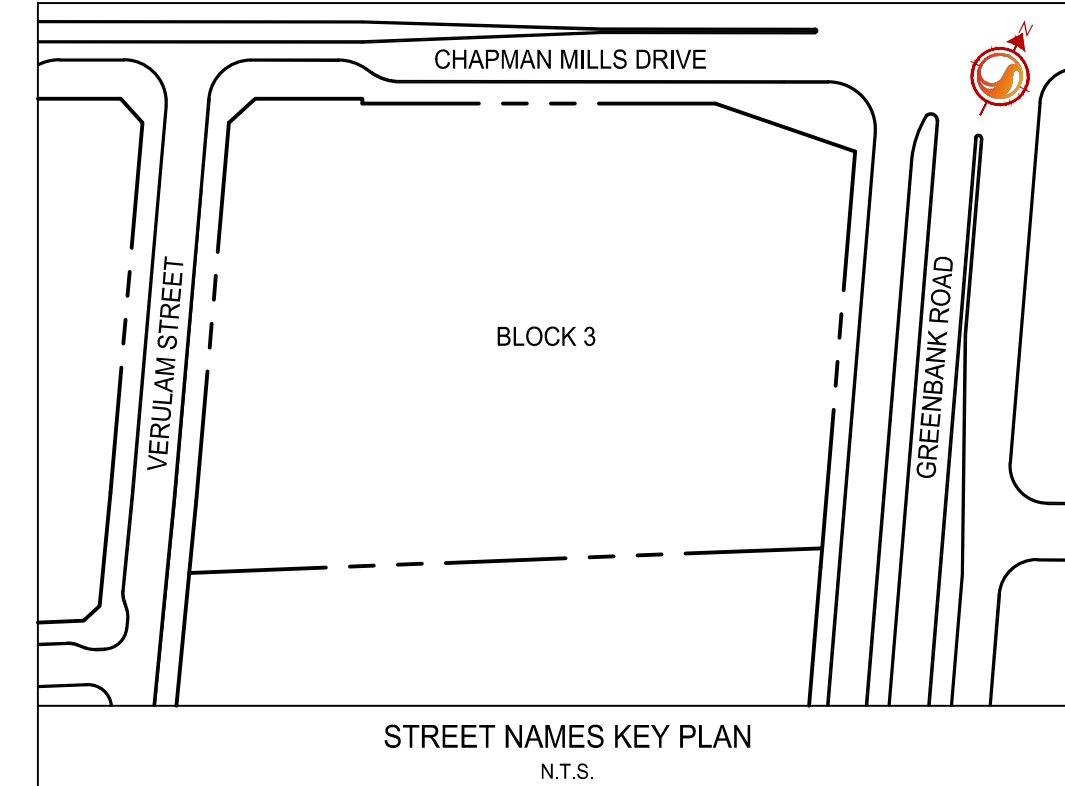

CHAPMAN MILLS DRIVE

FUTURE FINAL DESIGN AND CONSTRUCTION OF CHAPMAN MILLS DRIVE BY OTHERS.

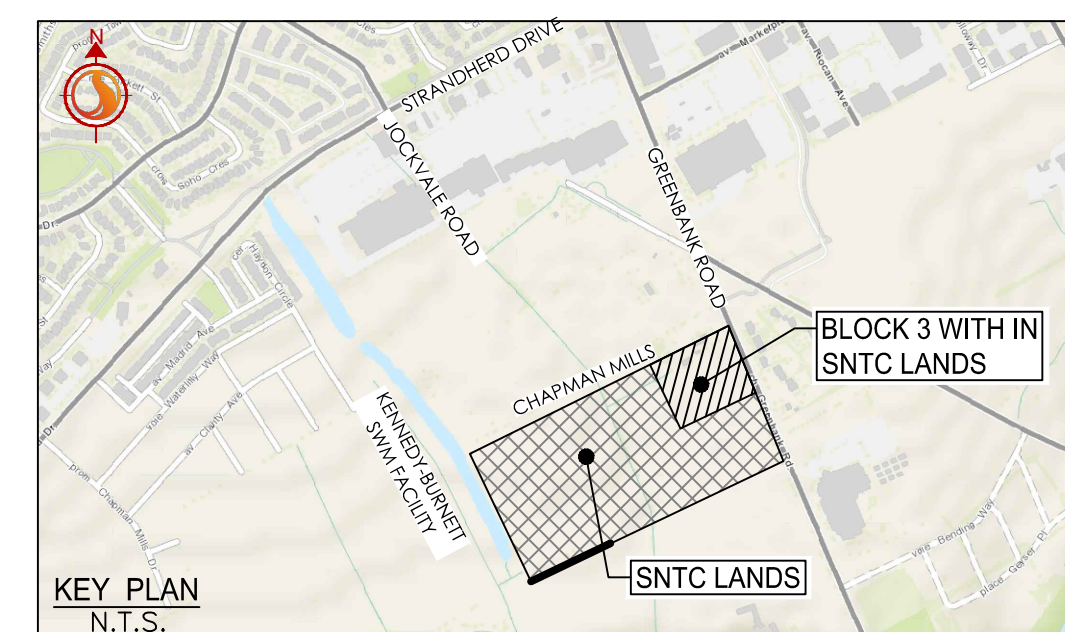
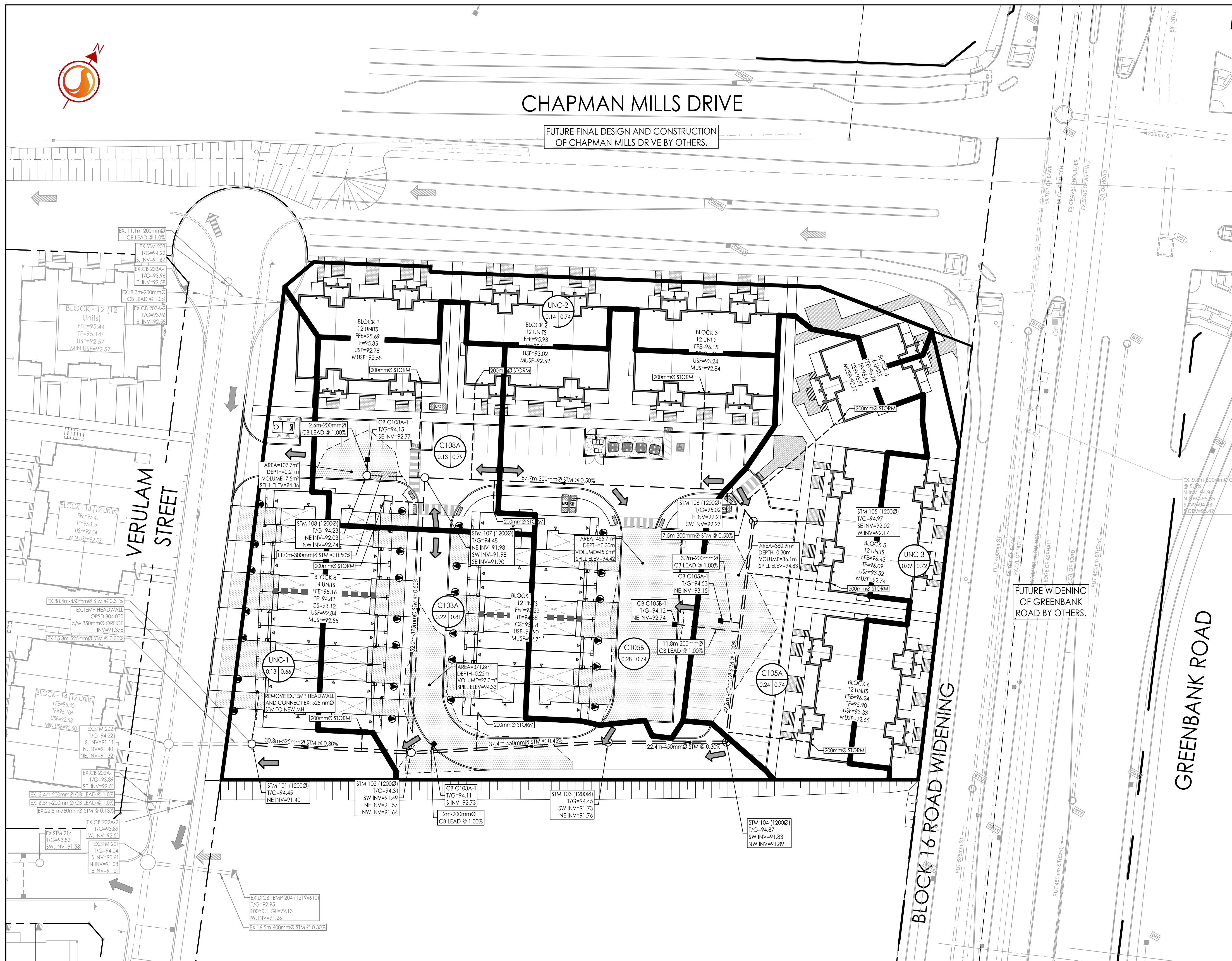

ICD TABLE					
STRUCTURE ID	TRIBUTARY AREA ID	ICD TYPE	2YR HEAD (m)	100YR HEAD (m)	100YR FLOW (L/s)
CB C103A-1	C103A	127mm ORFICE	1.41	1.58	37.30
CB C105A-1	C105A	121mm ORFICE	1.41	1.61	33.89
CB C105B-1	C105B	152mm ORFICE	1.31	1.62	51.10
CB C108A-1	C108A	121mm ORFICE	0.71	1.58	23.49



Stantec Consulting Ltd.
400 - 1331 Clyde Avenue
Ottawa ON
Tel. 613.722.4420
www.stantec.com

Copyright Reserved
The Contractor shall verify and be responsible for all dimensions. DO NOT scale the drawing - any errors or omissions shall be reported to Stantec without delay.
The Copyrights to all designs and drawings are the property of Stantec. Reproduction or use for any purpose other than that authorized by Stantec is forbidden.

- Legend**
- AREA ID
 - RUNOFF COEFFICIENT
 - STORM DRAINAGE AREA ha.
 - STORM DRAINAGE BOUNDARY
 - DIRECTION OF OVERLAND FLOW
 - PROPOSED STORM SEWER
 - PROPOSED CATCHBASIN MANHOLE
 - PROPOSED CATCHBASIN
 - EXISTING STORM SEWER
 - EXISTING CATCHBASIN
 - THERMAL INSULATION ON STORM SEWER WHERE COVER IS LESS THAN 2.0m
 - CIRCULAR ORFICE

Notes

Revision	By	Appd.	YY.MM.DD	
5	REVISED AS PER SITE PLAN	ZW	KS	24.10.03
4	ISSUED FOR APPROVAL	ZW	KS	24.08.26
3	REVISED AS PER SITE PLAN AND CITY COMMENTS	MJS	KS	24.04.26
2	REVISED AS PER SITE PLAN	MJS	KS	24.03.19
1	ISSUED FOR SPA	WAJ	KS	23.09.28

File Name: 160401845 BLK3 DB.dwg

Permit-Seal



Client/Project
NEPEAN TOWN CENTRE DEVELOPMENT CORPORATION
2934 BASELINE ROAD, SUITE 302, OTTAWA, ON, K2H 1B2
PH: (613) 518-1864
SNTC LANDS
BLOCK 3
OTTAWA, ON

Title
STORM DRAINAGE PLAN

Project No. 160401845
Scale 1:400
Drawing No. SD-1
Sheet 6 of 7
Revision 4

APPROVED
By Lily Xu at 3:34 pm, Oct 21, 2024

LILY XU, MCIP, RPP
MANAGER, DEVELOPMENT REVIEW SOUTH
PLANNING, DEVELOPMENT, AND BUILDING SERVICES
DEPARTMENT, CITY OF OTTAWA