

APPROVED
By Lily Xu at 3:56 pm, Nov 14, 2024

Lily Xu
LILY XU, MCIP, RPP
MANAGER, DEVELOPMENT REVIEW SOUTH
PLANNING, DEVELOPMENT, AND BUILDING SERVICES
DEPARTMENT, CITY OF OTTAWA

ONTARIO ASSOCIATION
OF ARCHITECTS
DAVID T. PARKER
LICENCE
4593

REVISIONS		
1	SITE PLAN APPLICATION	JUNE 28/23
2	SPA REVIEW COMMENTS	OCT 04/23
3	SPA REVIEW COMMENTS	OCT 30/23
4	SPA REVIEW COMMENTS	JAN 02/24
5	SPA REVIEW COMMENTS	APR 29/24
6	GARAGE + CANOPY CHANGES	JUNE 04/24
7	SPA REVIEW COMMENTS	SEPT 11/24

OTTAWA KOREAN COMMUNITY CHURCH
3555 BORRISOKANE ROAD
OTTAWA, ONTARIO

Parker
Architects
Inc.
156 St. Paul Street
St. Catharines, ON, L2R 3M2
tel: 905-687-6681
email: info@parkerarchitects.ca

drawing SITE PLAN	
drawn DTP	
checked -	
scale 1:400	
NL 22 - 106	date JUNE 28, 2023

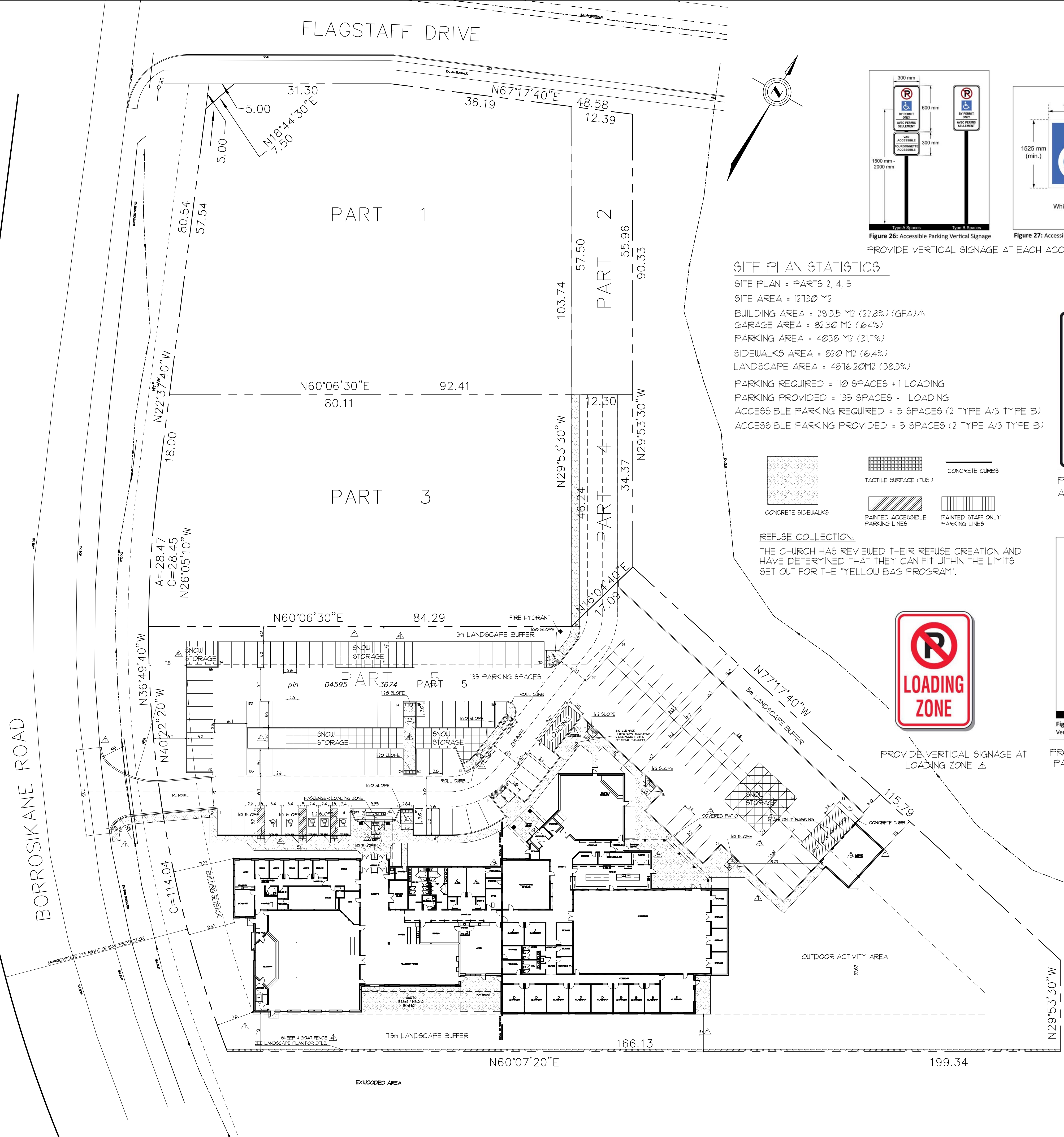

SITE PLAN STATISTICS

SITE PLAN = PARTS 2, 4, 5
 SITE AREA = 12130 M²
 BUILDING AREA = 29135 M² (22.8%) (GFA) Δ
 GARAGE AREA = 8230 M² (6.4%)
 PARKING AREA = 4038 M² (31.1%)
 SIDEWALKS AREA = 820 M² (6.4%)
 LANDSCAPE AREA = 487620 M² (38.3%)
 PARKING REQUIRED = 110 SPACES + 1 LOADING
 PARKING PROVIDED = 135 SPACES + 1 LOADING
 ACCESSIBLE PARKING REQUIRED = 5 SPACES (2 TYPE A/3 TYPE B)
 ACCESSIBLE PARKING PROVIDED = 5 SPACES (2 TYPE A/3 TYPE B)

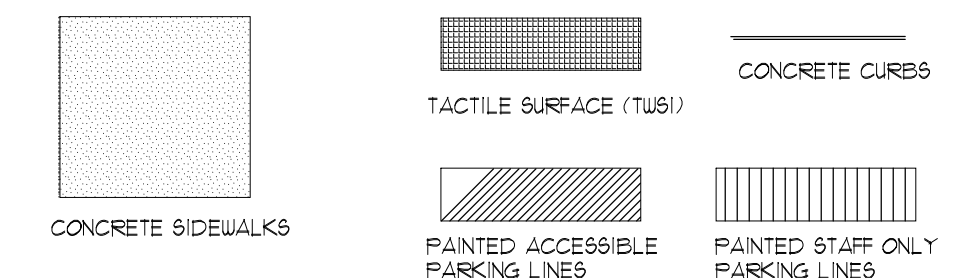

REFUSE COLLECTION:
 THE CHURCH HAS REVIEWED THEIR REFUSE CREATION AND HAVE DETERMINED THAT THEY CAN FIT WITHIN THE LIMITS SET OUT FOR THE "YELLOW BAG PROGRAM".

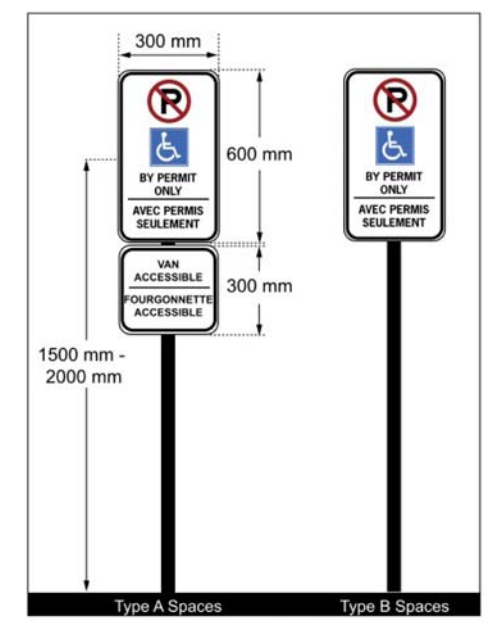

Figure 26: Accessible Parking Vertical Signage
 PROVIDE VERTICAL SIGNAGE AT EACH ACCESSIBLE PARKING SPACE

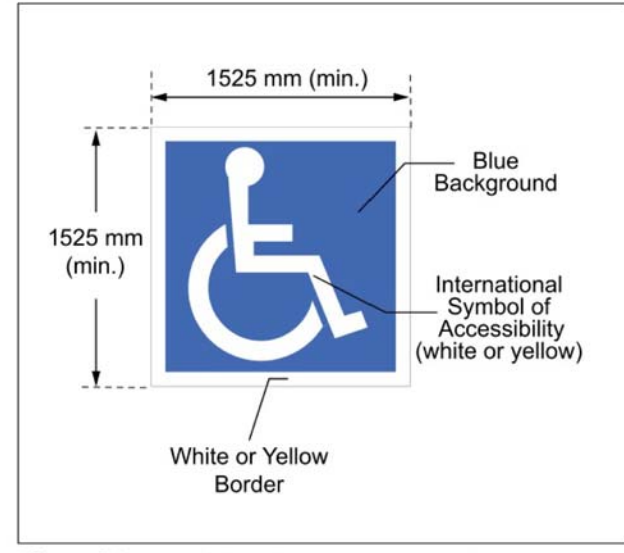

Figure 27: Accessible Parking Pavement Marking



Figure 28: Fire Route Vertical Signage
 PROVIDE VERTICAL SIGNAGE AT 25 m SPACING MAXIMUM



Figure 29: Accessible Loading Zone Vertical Signage
 PROVIDE VERTICAL SIGNAGE AT LOADING ZONE Δ

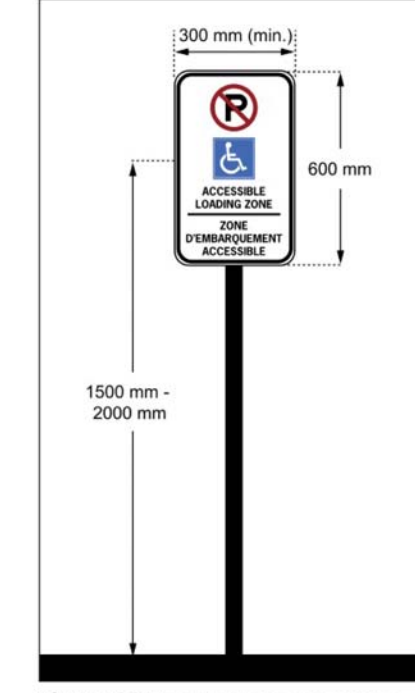

Figure 30: Accessible Passenger Loading Zone Vertical Signage
 PROVIDE VERTICAL SIGNAGE AT PASSENGER LOADING ZONE

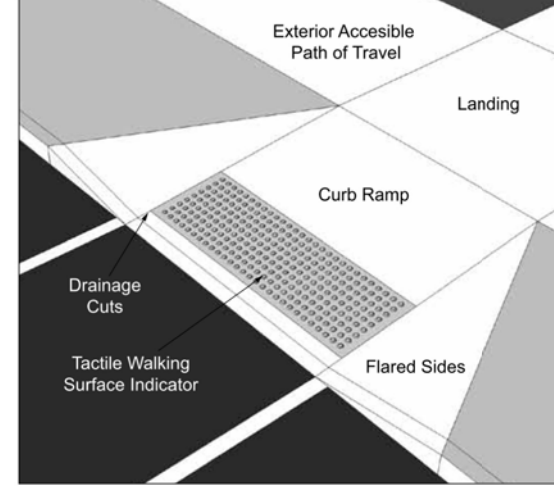

Figure 33a: Typical Curb Ramp

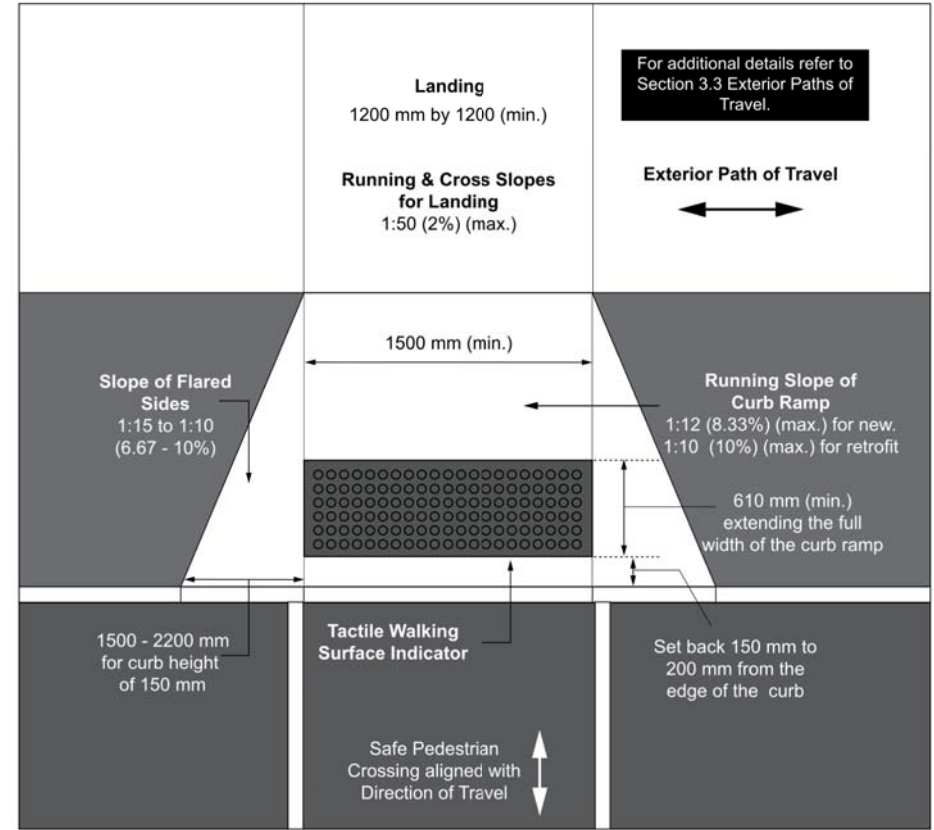
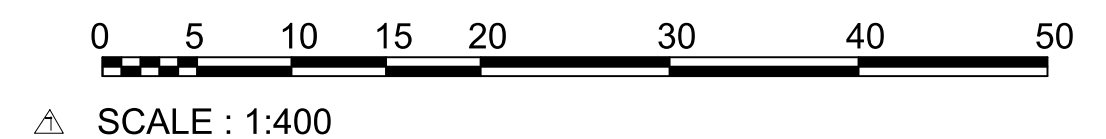

Figure 33b: Typical Curb Ramp Design - Plan View



Figure 33c: 5-Loop Wave Style Bike Rack - 7 Bike Capacity
 Refer manufacturers specifications for installation detail



TOPOGRAPHICAL PLAN OF SURVEY OF
 PART OF LOT 11
 CONCESSION 3 (RIDEAU FRONT)
 Geographic Township of Nepean
 CITY OF OTTAWA
 Surveyed by Annis, O'Sullivan, Vollebakk Ltd.
 PARTS 4 & 5 OF PLAN 4R-34600

FILE NUMBER D07-12-24-0063
 PLAN NUMBER #18788

COPYRIGHTED - This design is the exclusive property of the architect and shall not be reproduced without the architect's written permission. These drawings are to be read in conjunction with the structural, mechanical and electrical drawings as well as the specifications. The drawing set not be used. All dimensions, data and details shall be verified before construction and alterations or omissions reported immediately to the architect.