

VIA RAIL CANADA INC. (FORMERLY CANADIAN NATIONAL RAILWAY)

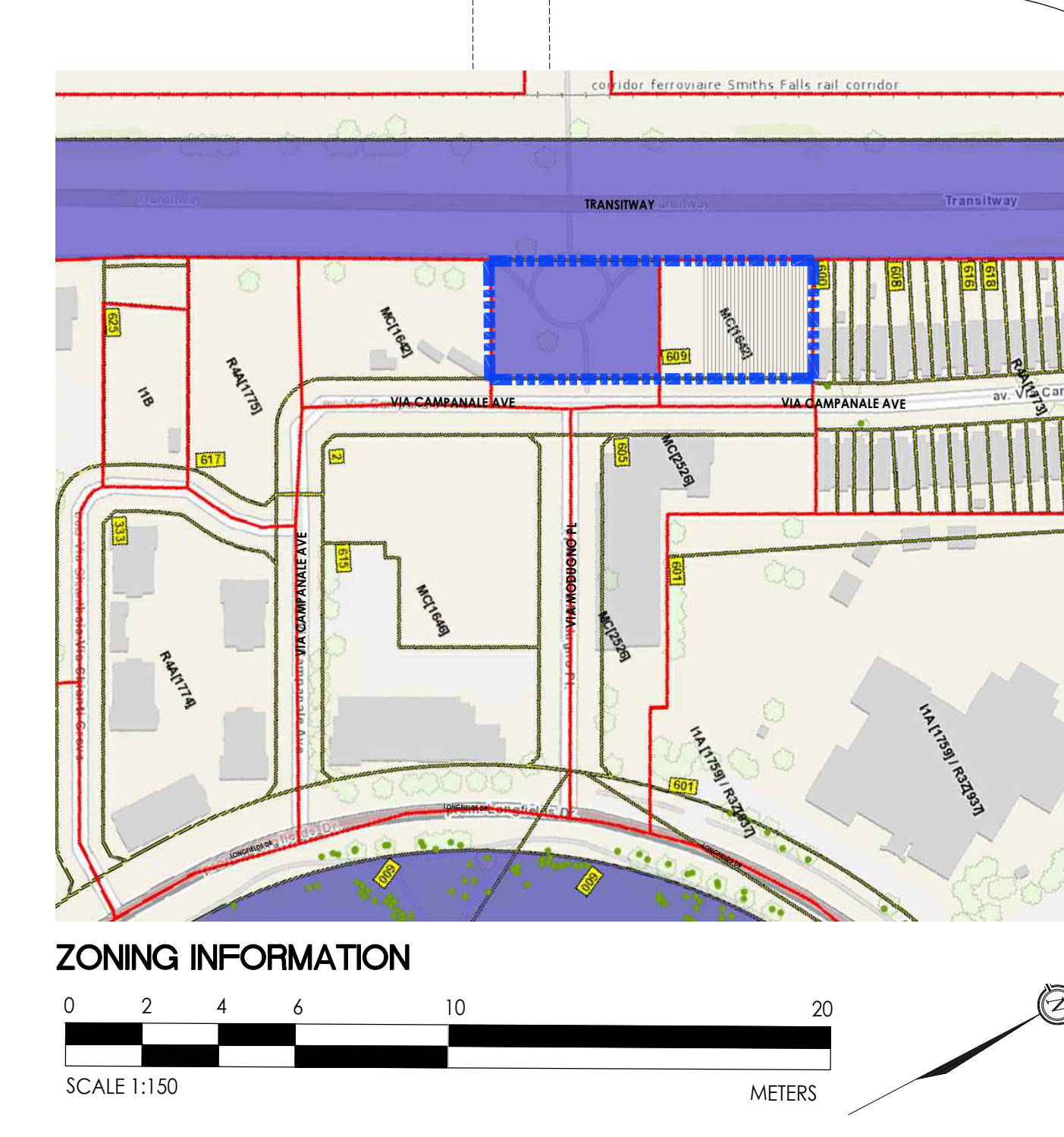

LEGEND

MATERIAL LEGEND		MATERIAL LEGEND	
	NEW SOD		WASTE RECEPTACLES
	CONCRETE		COLUMN LIGHT (TYP.) 1.06 m. h. REF. TO
	ASPHALT		WALL MOUNTED LIGHT
	BRICK INTERLOCK		FIRE HYDRANT
	BUILDING ENTRANCE / EXIT		SIAMESE CONNECTION
	PROPERTY BOUNDARY		DIRECTIONAL ARROW
	SETBACKS		1.5m HI. IRON FENCE TO BE SUPPLIED
	PROPOSED HYDRO POLE		RAILING
	BENCH		ALUMINUM POST FOR FLAG

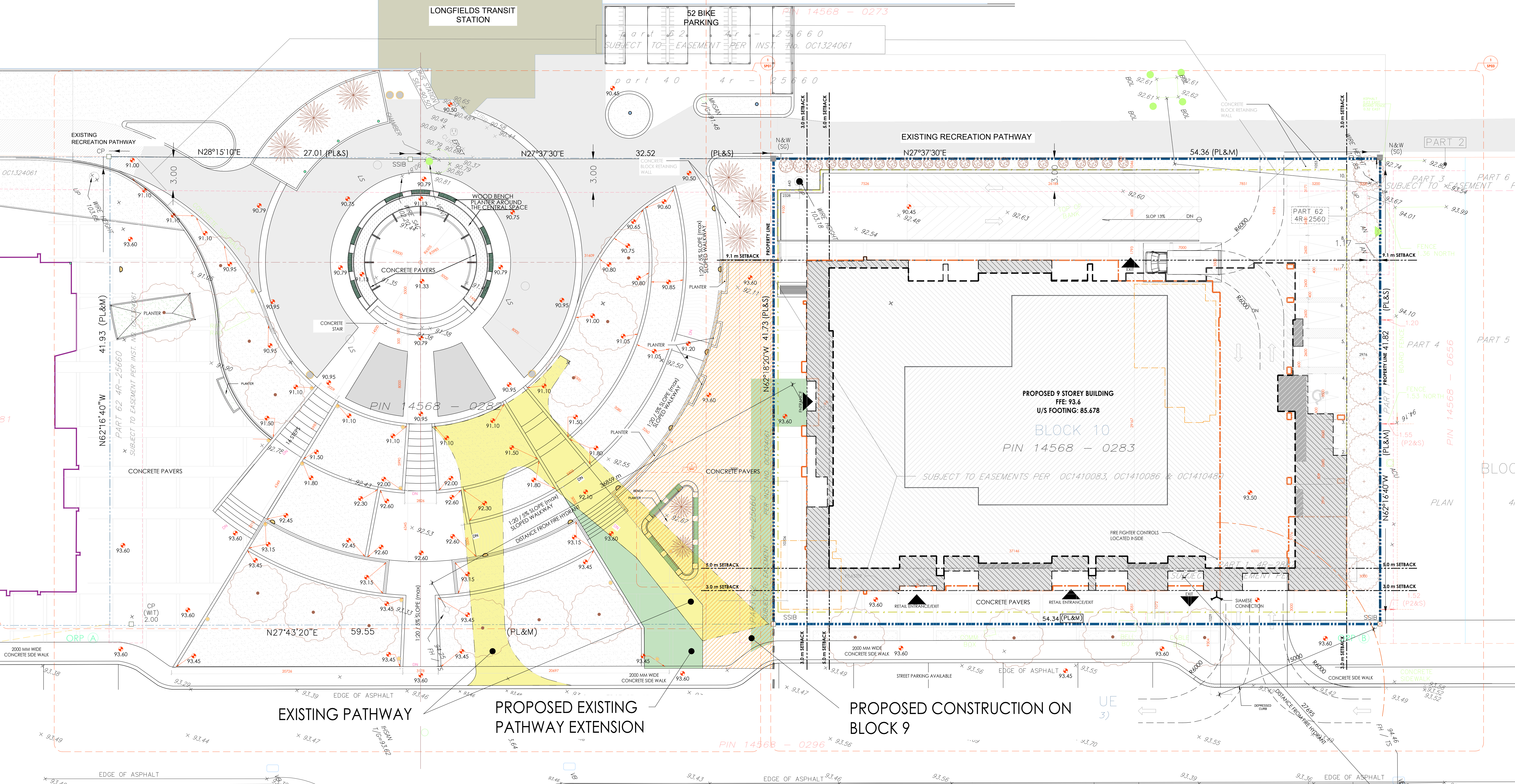
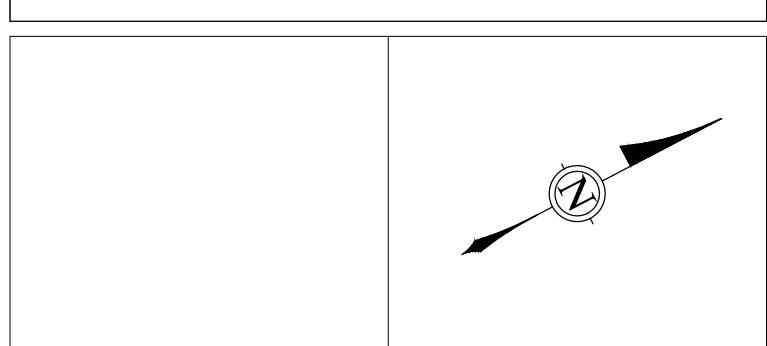
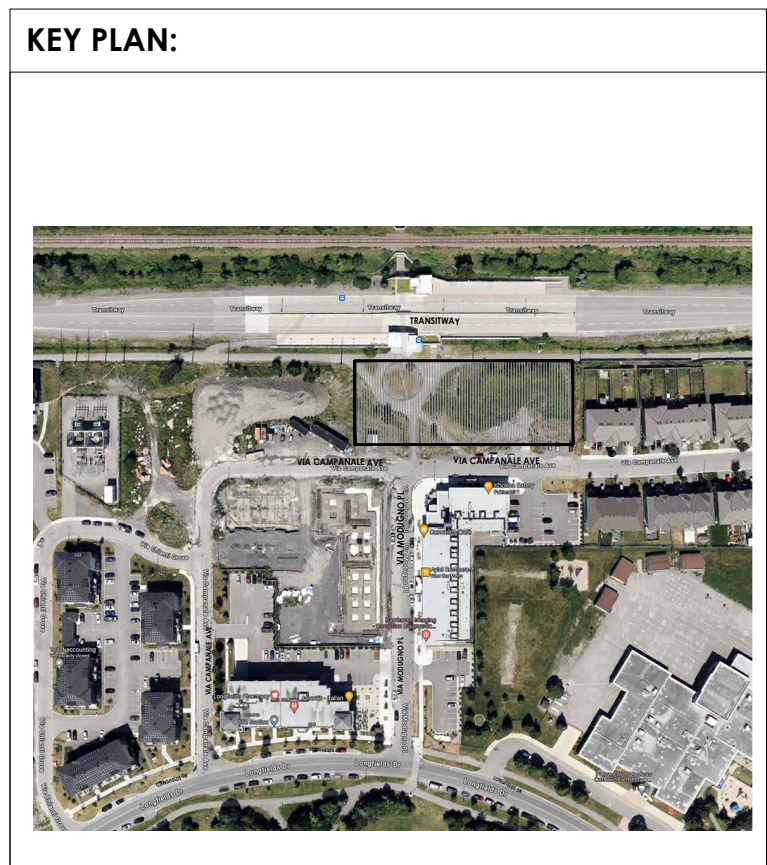

GENERAL NOTES:
 SURVEY INFORMATION IS AS PER THE DRAWINGS PROVIDED BY THE CLIENT.
 SURVEY INFORMATION IS ONLY FOR REPRESENTATION.
 ALL CONTRACTORS TO VERIFY ALL DIMENSIONS ON SITE AND TO REPORT ALL ERRORS AND/OR OMISSIONS TO THE ARCHITECT.
 ALL CONTRACTORS MUST COMPLY WITH ALL CODES AND BYLAWS AND OTHER AUTHORITIES HAVING JURISDICTION OVER THE WORK.
 DO NOT SCALE DRAWINGS.
 THIS DRAWING MAY NOT BE USED FOR CONSTRUCTION UNTIL SIGNED BY THE ARCHITECT.
 COPYRIGHT RESERVED.

NO.	REVISION	DD/MM/YY	DATE
07	FOR REVIEW		16/12/24
06	FOR REVIEW		12/07/24
05	FOR REVIEW		09/07/24
04	FOR REVIEW		07/05/24
03	FOR REVIEW		23/04/24
02	FOR REVIEW		18/04/24
01	FOR REVIEW		01/03/24
	REVISION		DD/MM/YY



201-4 BEECHWOOD AVENUE, OTTAWA, ONTARIO, CANADA K1B1B9
 TEL: 613 228 9850, FAX: 613 228 9848, mailbox@woodmanarchitect.com

CONSULTANTS:
 STRUCTURAL - D+W Structural Ltd
 MECHANICAL - Jain Consultants
 CIVIL - Stantec
 ELECTRICAL - Jain Consultants
 NOISE - Gradient Wind Engineering Inc.
 LANDSCAPE - Theatrical Associates Design Consultants
 INFRASTRUCTURE - Parsons

PROJECT:
BLOCK 9&10
609 LONGFIELDS DR.
 NEPEAN, BARRHAVEN EAST - OTTAWA

DRAWING:
SITE PLAN

DATE	23/11/2023	JOB NO.	2314A
SCALE	1:150	DRAWING NO.	
DRAWN BY	JG		
REVIEWED BY	RW		