

*G. Wildman*

**GERALDINE WILDMAN**  
MANAGER, DEVELOPMENT REVIEW SOUTH  
PLANNING, DEVELOPMENT AND BUILDING SERVICES  
DEPARTMENT, CITY OF OTTAWA

**APPROVED**  
By Geraldine Wildman at 2:13 pm, Oct 01, 2025

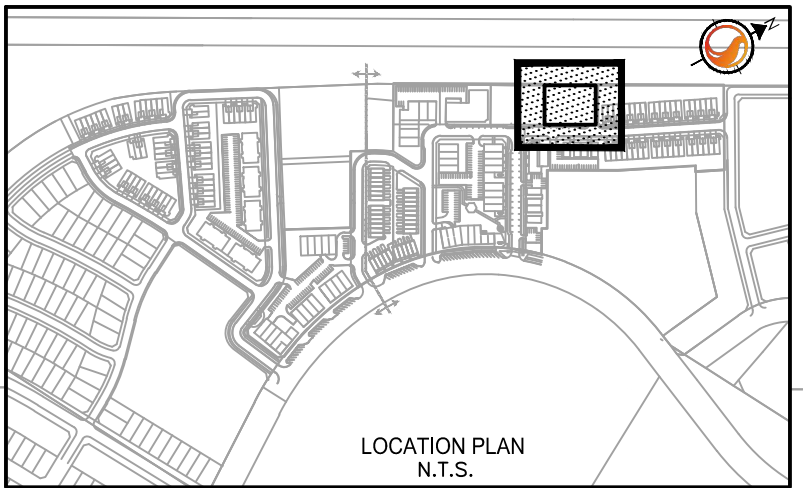

Stantec Consulting Ltd.  
400 - 1331 Clyde Avenue  
Ottawa ON  
Tel. 613.722.4420  
www.stantec.com

Copyright Reserved  
The Contractor shall verify and be responsible for all dimensions. DO NOT scale the drawing - any errors or omissions shall be reported to Stantec without delay.  
The Copyrights to all designs and drawings are the property of Stantec. Reproduction or use for any purpose other than that authorized by Stantec is forbidden.

- Legend
- R100A**  
0.31 50  
SANITARY DRAINAGE AREA ID#  
POPULATION COUNT  
SANITARY DRAINAGE AREA ha.
  - G100A**  
0.11 INFL  
SANITARY DRAINAGE AREA ID#  
INFILTRATION FLOW RATE  
0.33 L/s/ha APPLIED  
SANITARY DRAINAGE AREA ha.
  - C100A**  
0.11 COM  
SANITARY DRAINAGE AREA ID#  
COMMERCIAL FLOW RATE  
28 000 L/ha/day APPLIED  
SANITARY DRAINAGE AREA ha.
  - SANITARY DRAINAGE AREA**  
PROPOSED SANITARY MH AND SEWER  
EXISTING SANITARY MH AND SEWER

Notes

SANITARY STATS			
10 - BACHELOR UNITS @ 1.4 PPU = 14 PEOPLE			
15 - 1 BEDROOM UNITS @ 1.4 PPU = 21 PEOPLE			
33 - 1 BEDROOM + DEN UNITS @ 2.1 PPU = 69 PEOPLE			
32 - 2 BEDROOM UNITS @ 2.1 PPU = 67 PEOPLE			
2 - 3 BEDROOM UNITS @ 3.1 PPU = 6 PEOPLE			
TOTAL POPULATION = 177			

6	REVISED PER CITY COMMENT	JP	D/SGG	25.09.09
5	REVISED SITE PLAN	JP	D/SGG	25.07.02
4	SHIFTED SIEMSE 1m	JP	D/SGG	25.06.05
3	ISSUED FOR CITY REVIEW	JP	D/SGG	25.04.03
2	ISSUED FOR CITY REVIEW	JP	D/SGG	25.01.14
1	ISSUED FOR CITY REVIEW	JP	DT	24.07.15
Revision		By	Appd.	YY.MM.DD

File Name:	160401885-D81.dwg	JP	SGG/MW	JP	24.07.10
		Dwn.	Chkd.	Dsgn.	YY.MM.DD



Client/Project  
CAMPANALE HOMES  
200 - 1187 Bank Street, Ottawa, ON  
  
609 LONGFIELDS DRIVE  
BLOCK 10  
Ottawa, ON

Title  
  
SANITARY DRAINAGE PLAN

Project No. 160401885	Scale 1:150 0 1.5 4.5 7.5m
Drawing No. SA-1	Sheet 7 of 7
	Revision 6