

G. Wildman

GERALDINE WILDMAN
MANAGER, DEVELOPMENT REVIEW SOUTH
PLANNING, DEVELOPMENT AND BUILDING SERVICES
DEPARTMENT, CITY OF OTTAWA

APPROVED

By Geraldine Wildman at 2:11 pm, Oct 01, 2025

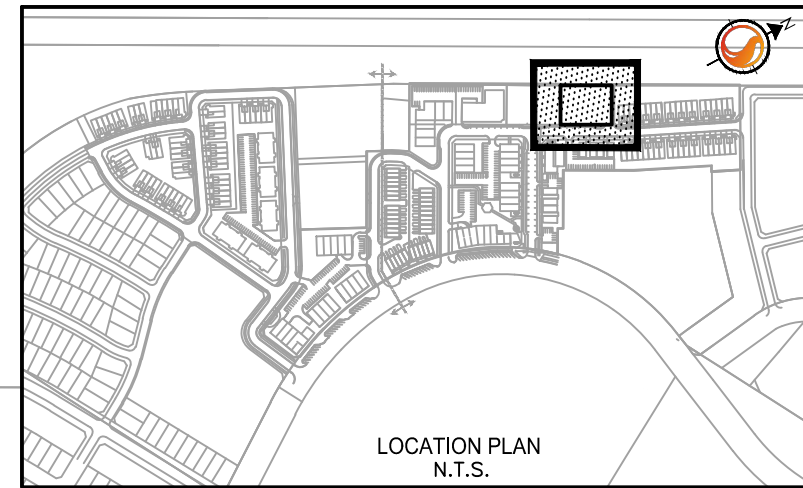

Stantec Consulting Ltd.
400 - 1331 Clyde Avenue
Ottawa ON
Tel. 613.722.4420
www.stantec.com

Copyright Reserved

The Contractor shall verify and be responsible for all dimensions. DO NOT scale the drawing - any errors or omissions shall be reported to Stantec without delay.
The Copyrights to all designs and drawings are the property of Stantec. Reproduction or use for any purpose other than that authorized by Stantec is forbidden.

Legend

- ORIGINAL GROUND ELEVATIONS
- PROPOSED ELEVATION
- PROPOSED ELEVATION
- EXISTING ELEVATION
- FLOW DIRECTION AND GRADE
- FINISHED FIRST FLOOR ELEVATION
- TERRACING 3:1 SLOPE MAXIMUM (UNLESS OTHERWISE SHOWN)
- PROPOSED SWALE
- DIRECTION OF OVERLAND FLOW
- EXISTING VALVE AND VALVE BOX
- EXISTING FIRE HYDRANT
- EXISTING SANITARY SEWER
- EXISTING STORM SEWER
- EXISTING CATCHBASIN
- PROPOSED VALVE BOX
- PROPOSED SANITARY SEWER MANHOLE
- PROPOSED STORM SEWER MANHOLE
- PROPOSED CATCHBASIN
- PROPOSED DEPRESSED CURB LOCATIONS
- PROPOSED RETAINING WALL, RETAINING WALLS GREATER THAN 1.0m IN HEIGHT TO BE DESIGN BY A PROFESSIONAL ENGINEER LICENSED IN THE PROVINCE OF ONTARIO. RAILINGS REQUIRED WHEN WALL IS 0.6m IN HEIGHT OR GREATER.
- PROPOSED BUILDING ENTRANCE

NOTES:

- CONTRACTOR TO LOCATE EXISTING SERVICES AND ANY CONFLICTS WITH EXISTING SERVING MUST BE REPORTED TO THE ENGINEER PRIOR TO CONTINUING WITH CONSTRUCTION.
- SITE PLAN PREPARED BY WOODMAN ARCHITECT INC. DATED: JUNE 11, 2025
- AS-BUILT INFORMATION FROM STANTEC CONSULTING, DATED DEC 11, 2012

6	REVISED PER CITY COMMENT	JP	D1/SGG	25.09.09
5	REVISED SITE PLAN	JP	D1/SGG	25.07.02
4	SHIFTED SIAMESE 1m	JP	D1/SGG	25.06.05
3	ISSUED FOR CITY REVIEW	JP	D1/SGG	25.04.03
2	ISSUED FOR CITY REVIEW	JP	D1/SGG	25.01.14
1	ISSUED FOR CITY REVIEW	JP	DT	24.07.15

Revision By Appd. YY.MM.DD

File Name:	160401885-D81.dwg	JP	SGG/MW	JP	24.07.10
		Dwn.	Chkd.	Dsgn.	YY.MM.DD

Permit-Seal

Client/Project

CAMPANALE HOMES
200 - 1187 Bank Street, Ottawa, ON

609 LONGFIELDS DRIVE
BLOCK 10
Ottawa, ON

Title

GRADING PLAN

Project No.
160401885

Drawing No.

GP-1

Scale
1:150

Sheet

Revision

4 of 7

6

DWG# 19161

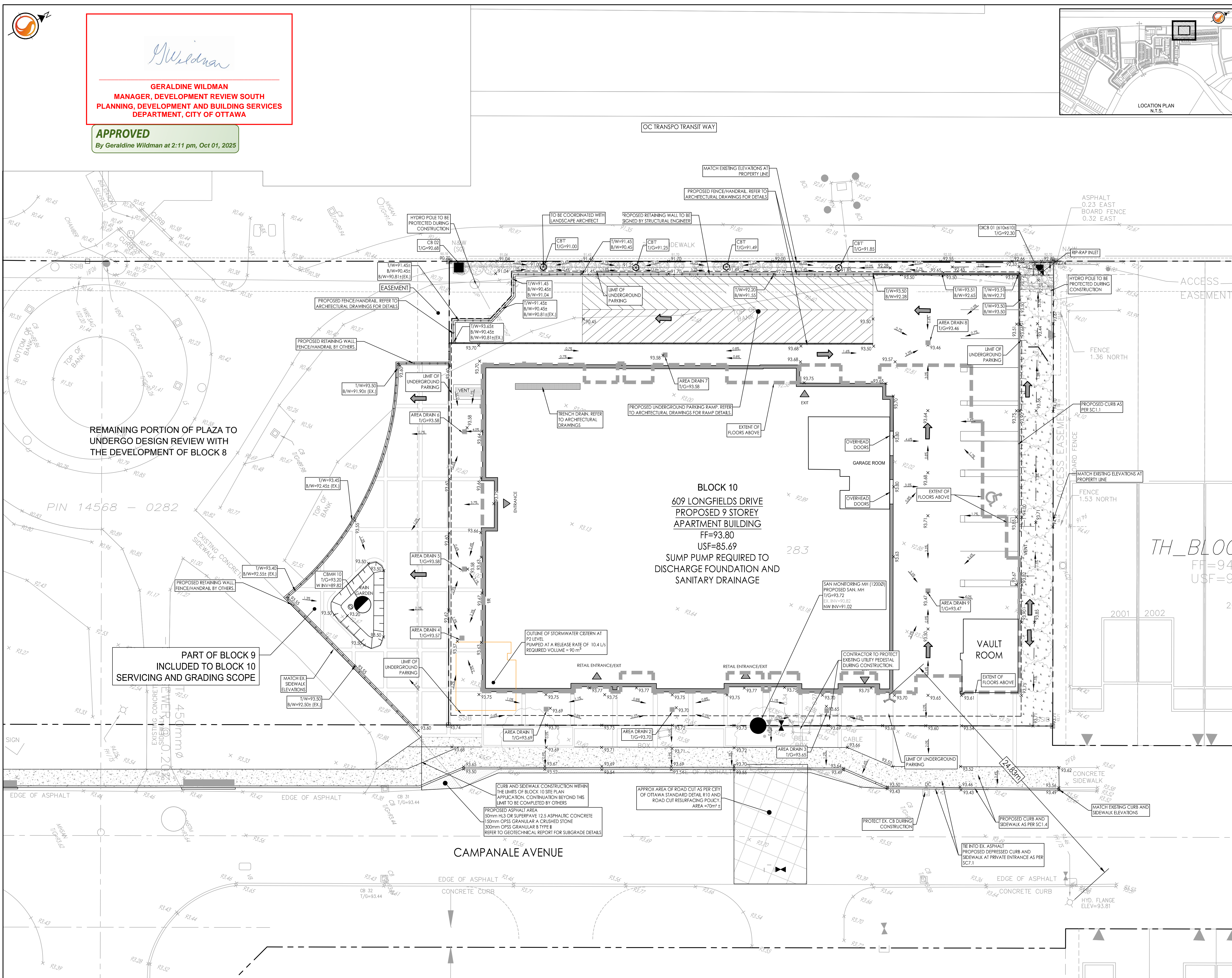

\\s01\apps\160401885\160401885-D81.dwg
2025/09/10 10:52:49 AM J. WILDMAN

ORIGINAL SHEET - ARCH 0