

Proposed Plant Material List

KEY	QNTY	BOTANICAL NAME	COMMON NAME	HT/CAL	SPREAD	ROOT	DROUGHT TOLERANT	NATIVE	REMARKS
STREET TREES									
ORB	1	Quercus rubra	Red Oak	70 mm		B.&B.	High	Yes	Full Form
DECIDUOUS SHRUBS									
CNF	1	Cornus sericea "Farrow"	Arctic Fire Dogwood	80 cm		C.G.	High	Yes	Full Form
SCA	1	Sambucus canadensis	Elderberry	80 cm		C.G.	High	Yes	Full Form
ORNAMENTAL GRASSES									
SCS	5	Schizochyrium scoparium	Little Bluestem			2 Gal.	High	Yes	Full Form - Native
PERENNIALS									
EPP	6	Echinacea pallida	Pale Purple Coneflower			2 Gal.	High	Yes	Full Form
FVR	3	Fragaria virginiana	Wild Strawberry			2 Gal.	High	Yes	Full Form
MDF	5	Monarda fistulosa	Bergamot			2 Gal.	High	Yes	Full Form
GROUND COVER									
COB	40	Cornus canadensis	Bunchberry			2 Gal.	High	Yes	Full Form

ALL QUANTITIES IN THE LIST OF PLANT MATERIALS ARE TO BE CHECKED BY THE LANDSCAPE CONTRACTOR. ANY DISCREPANCIES ARE TO BE REPORTED TO THE LANDSCAPE ARCHITECT. THE QUANTITIES INDICATED ON THE DRAWINGS SUPERCEDE THE TOTAL QUANTITIES

Legend

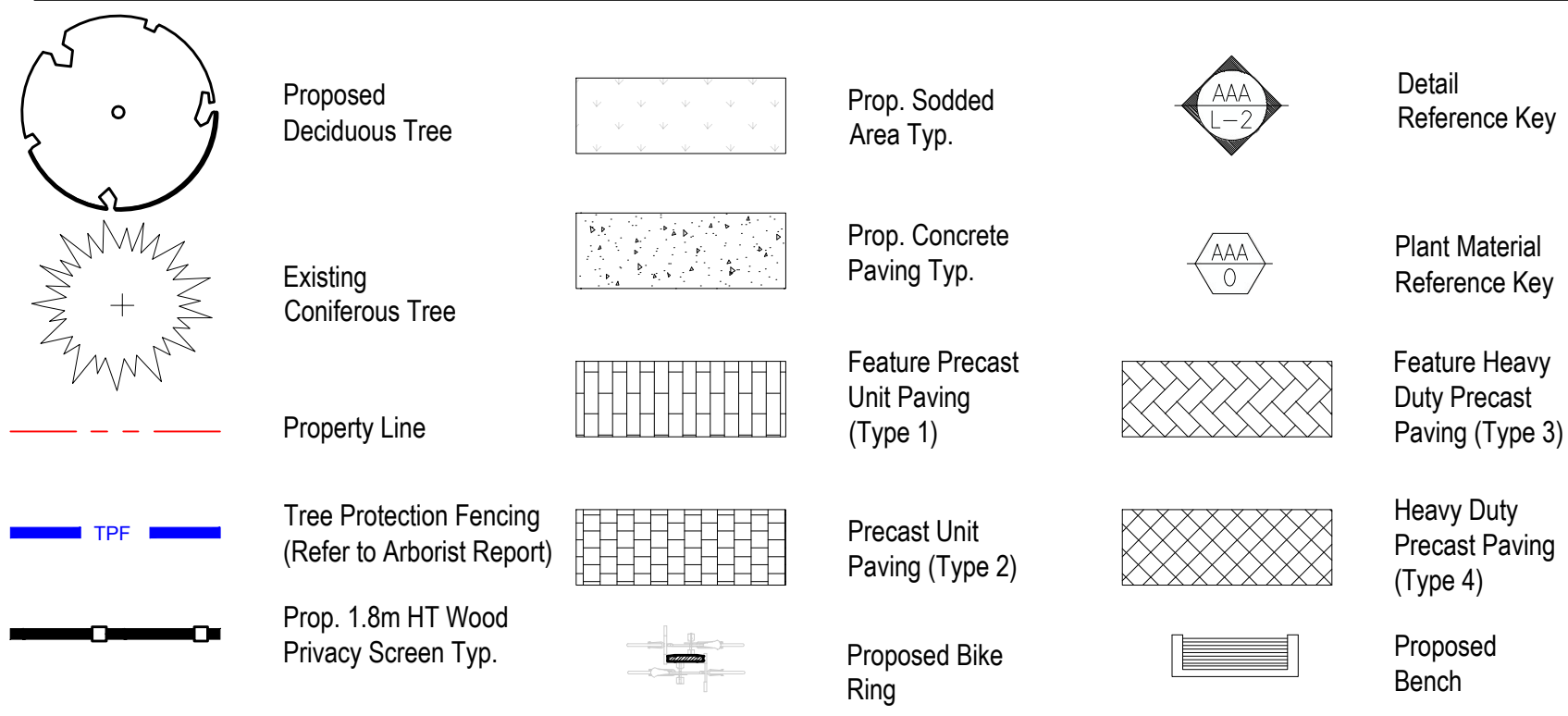

Key Map

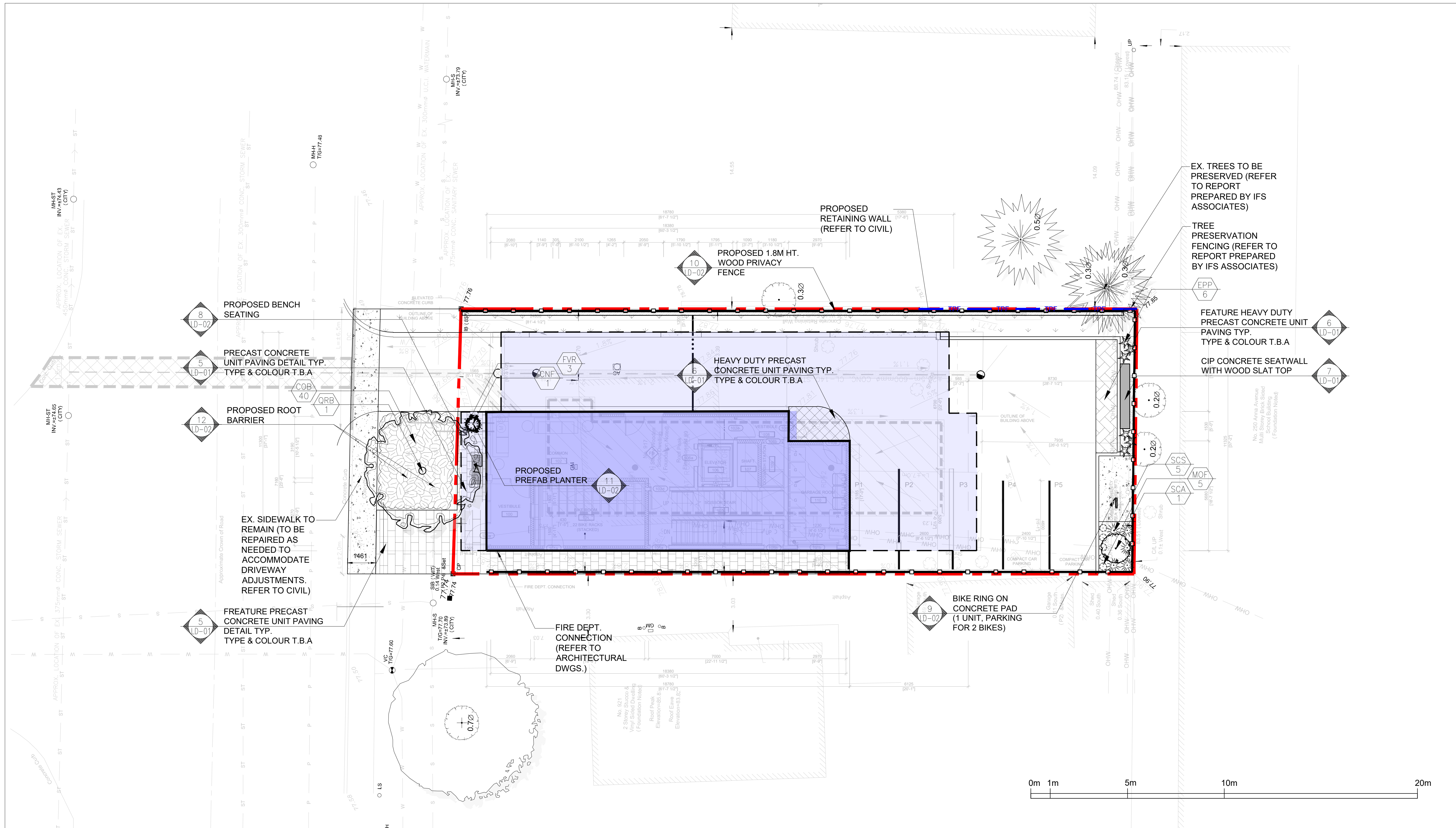

MARTON SMITH LANDSCAPE ARCHITECTS

170 The Donway W Suite 206,
Toronto, Ontario, Canada. M3C 2G3
tel. 416.492.9966 | email. info@msla.ca

Architect:



Owner:

Marc Amyot
Assera Property Group
389 Hepatica Way,
Orleans, Ontario,
K4A0Z1
613-614-3992
marc@assera.ca

Municipality:



Notes:

SNOW REMOVAL NOTE:
Excess snow to be trucked off site.

08	Issued for Resubmission	12/09/24
07	Issued for Coordination	11/15/24
06	Issued for Coordination	10/24/24
05	Issued for SPA #1	07/15/24
04	Revised per Amenity	07/12/24
03	Issued for Coordination	07/09/24
02	Issued for Coordination	05/08/24
01	Issued for Coordination	04/26/24
No.	Revision	Date

North:

Stamp:



Project:
Proposed Landscape and Site Upgrades
917 Merivale Road,
Ottawa, Ontario,
File Number: D07-12-24-0067

Scale: **1:100** Date: **APRIL 2024**

Drawn By: **A.L.** Checked By: **L.M.**

Drawing Title:

Landscape Plan

Project No. **24120** Sheet No. **L1-01**

All information contained in these plans shall be checked by the contractor. All discrepancies shall be reported to the Landscape Architect (L.A.) before commencing with construction. All drawings have copyright and shall remain the property of the Landscape Architect. Copying or any reproduction in part or whole shall only be permitted with written consent of L.A. Drawings shall not be used for construction unless sealed & SIGNED.
 NOTE FOR ANY AND ALL GRADING INFORMATION REFER TO SITE GRADING ENGINEERING DRAWINGS. NO SLOPES ARE TO EXCEED 3:1. PROPERTY LINES AND SETBACKS MUST BE COVERED BY CONTRACTOR PRIOR TO CONSTRUCTION. ANY AND ALL RETAINING WALLS MUST BE APPROVED BY STRUCTURAL ENGINEER PRIOR TO CONSTRUCTION.
 DO NOT SCALE DRAWINGS • PRELIMINARY NOT FOR CONSTRUCTION • THESE DRAWINGS ARE NOT TO BE USED FOR CONSTRUCTION UNTIL COUNTERSIGNED BY L. ARCHITECT • SIGNED _____ DATE _____

Legend

- Proposed Deciduous Tree
- Existing Coniferous Tree
- Property Line
- Tree Protection Fencing (Refer to Arborist Report)
- Prop. 1.8m HT Wood Privacy Screen Typ.
- Prop. Sodded Area Typ.
- Prop. Concrete Paving Typ.
- Feature Precast Unit Paving (Type 1)
- Precast Unit Paving (Type 2)
- Prop. Soil Area
- Potential Tree Canopy Cover

Soil Volume Chart

	Location (City ROW, private property)	Soil Area (m ²)	Soil Depth (m*)	Soil Volume (m ³)	Tree Quantity	Soil Volume per tree (m ³)
1	R.O.W.	21.0	1.5	31.5	1	31.5
Totals		21.0		31.5	1	

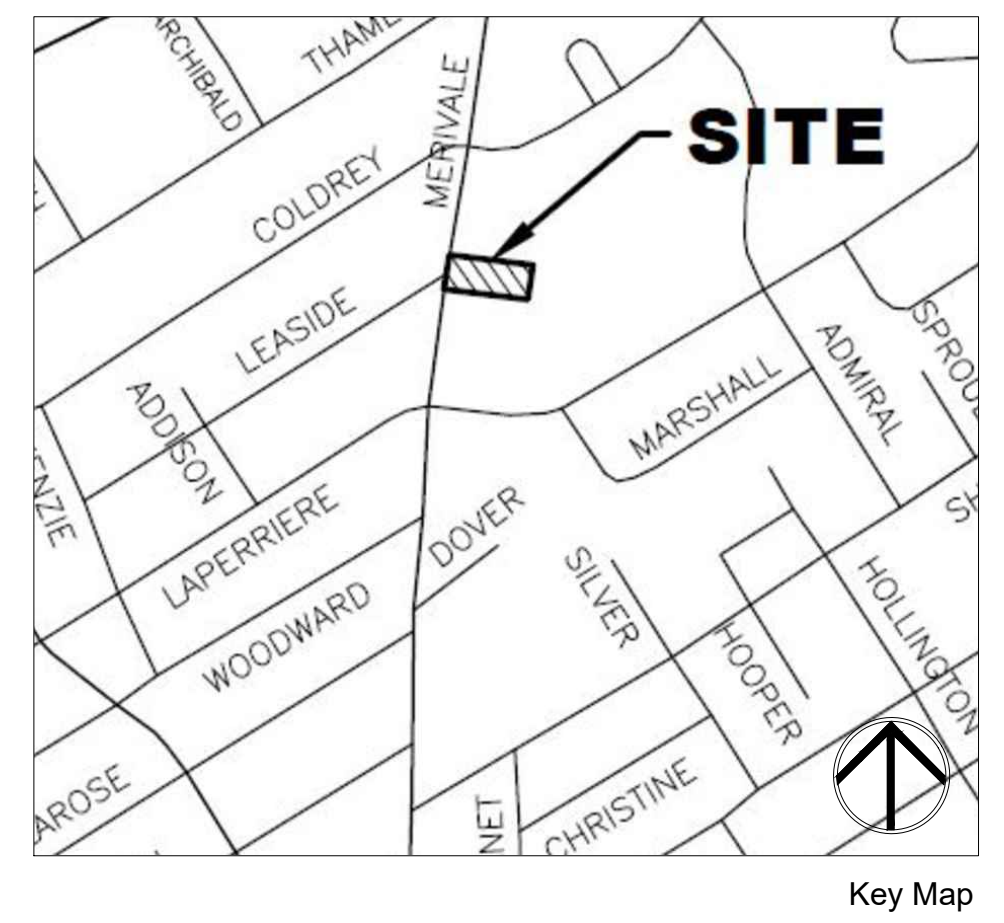

msla
MARTON SMITH LANDSCAPE ARCHITECTS
 170 The Donway W Suite 206,
 Toronto, Ontario, Canada, M3C 2G3
 tel. 416.492.9966 | email. info@msla.ca

Architect:
BIOSIS DESIGNS

Owner:
 Marc Amyot
 Assera Property Group
 389 Hepatica Way,
 Orleans, Ontario,
 K4A0Z1
 613-614-3992
 marc@assera.ca

Municipality:
Ottawa

Notes:
SNOW REMOVAL NOTE:
 Excess snow to be trucked off site.

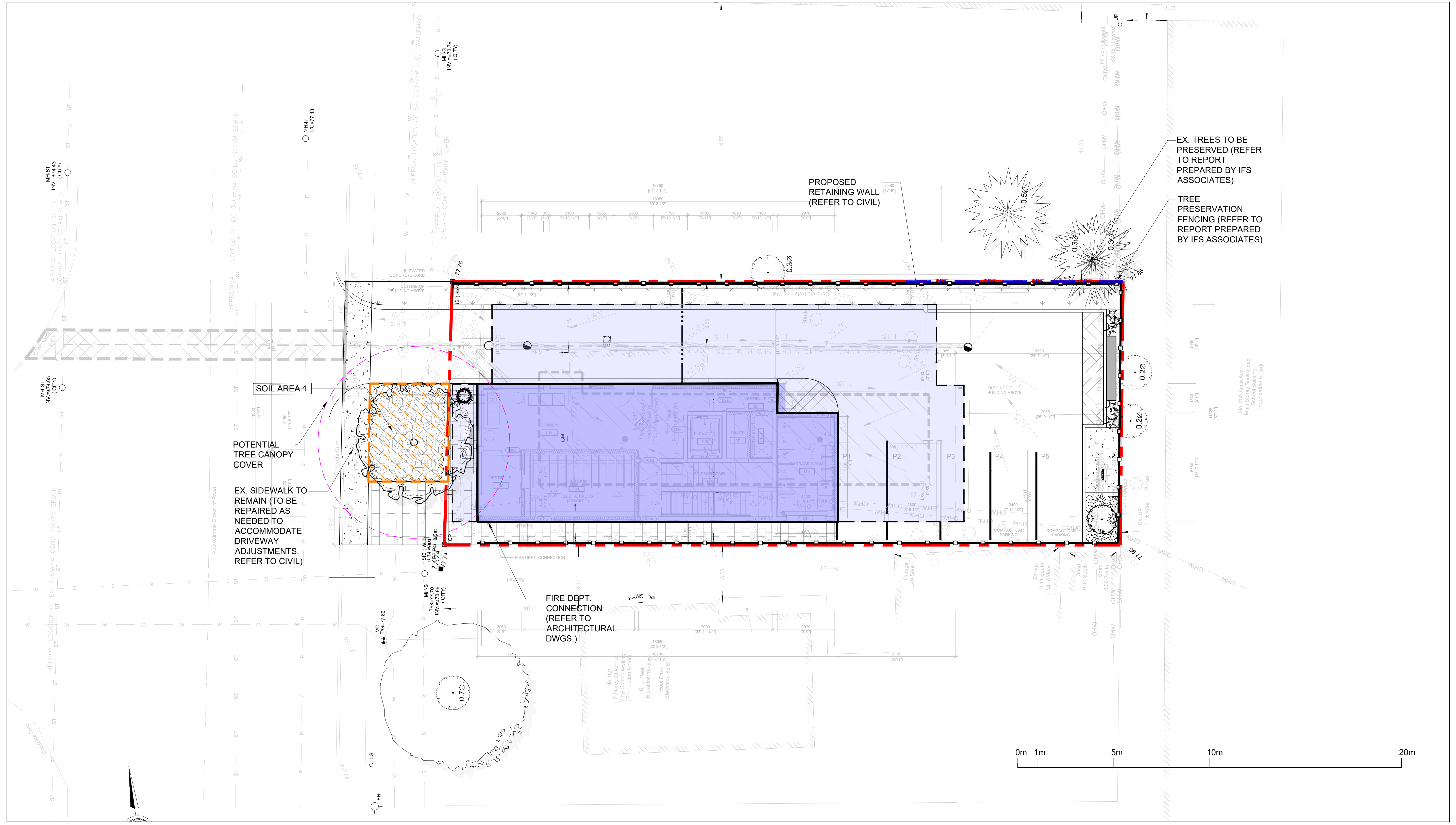

Notes:
SNOW REMOVAL NOTE:
 Excess snow to be trucked off site.

Revision Table:

No.	Revision	Date
08	Issued for Resubmission	12/09/24
07	Issued for Coordination	11/15/24
06	Issued for Coordination	10/24/24
05	Issued for SPA #1	07/15/24
04	Revised per Amenity	07/12/24
03	Issued for Coordination	07/09/24
02	Issued for Coordination	05/08/24
01	Issued for Coordination	04/26/24

North: [North Arrow] Stamp: [Professional Engineer Stamp]

Project:
Proposed Landscape and Site Upgrades
 917 Merivale Road,
 Ottawa, Ontario,
 File Number: D07-12-24-0067

Scale: **1:100** Date: **APRIL 2024**

Drawn By: **A.L.** Checked By: **L.M.**

Drawing Title:
Soil Volume Plan

Project No. **24120** Sheet No. **L2-01**

DO NOT SCALE DRAWINGS • PRELIMINARY NOT FOR CONSTRUCTION • THESE DRAWINGS ARE NOT TO BE USED FOR CONSTRUCTION UNTIL COUNTERSIGNED BY L. ARCHITECT • SIGNED DATE

Architect:



Owner:

Marc Amyot
Assera Property Group
389 Hepatica Way,
Orleans, Ontario,
K4A0Z1
613-614-3992
marc@assera.ca

Municipality:



Notes:

SNOW REMOVAL NOTE:
Excess snow to be trucked off site.

LANDSCAPE SPECIFICATIONS

CONTRACTOR MUST CONTACT ALL UTILITY COMPANIES FOR STAKE OUTS PRIOR TO ANY EXCAVATION OR PLANTING.

ROUGH GRADING

ROUGH GRADE AND FILL AREAS TO ESTABLISH SUBGRADE AS REQUIRED. PROVIDE DRAINAGE PATTERN AS INDICATED ON DRAWINGS. ROUND SMOOTHLY ALL TOPS AND SIDES OF SLOPES. COMPACT ALL AREAS TO 95% STANDARD PROCTOR DENSITY UNLESS SPECIFIED OTHERWISE. EXISTING TREES TO REMAIN ON SITE ARE TO BE PROTECTED AS DETAILED.

FINE GRADING

FINE GRADE ALL AREAS TO FINISHED GRADES AS SHOWN ON LAYOUT OR GRADING PLAN OR ARCHITECT'S SITE PLAN. PROVIDE UNIFORM SLOPES AWAY FROM THE BUILDING, UNLESS SPECIFIED OTHERWISE. SLOPES MAY NOT EXCEED 33 1/3% (3:1).

SPREADING OF TOPSOIL

SCARIFY THE SUBSOIL PRIOR TO THE SPREADING OF THE TOPSOIL. REMOVE ALL DEBRIS AND LEAVE A FINE-TEXTURED EVEN SURFACE. ALL TOPSOIL TO BE IMPORTED UNLESS PREVIOUSLY APPROVED BY LANDSCAPE ARCHITECT. OBTAIN APPROVAL FOR THE QUALITY OF ANY IMPORTED TOPSOIL BEFORE DELIVERY TO THE SITE. TOPSOIL IS TO BE COMPACTED TO CREATE A FIRM AND EVEN SURFACE.

SOD

USE NO. 1 GRADE TURFGRASS NURSERY SOD WHICH CONFORMS WITH THE SPECIFICATIONS OF THE NURSERY SOD GROWERS ASSOCIATION OF ONTARIO. ALL LAWN AREAS SHALL RECEIVE A MINIMUM OF 100MM (4") OF COMPACTED TOPSOIL, AND SHALL BE SOODED WITH #1 KENTUCKY BLUEGRASS - FESCUE. NO SOD SLOPES ARE TO EXCEED 3:1. SLOPE IN EXCESS OF 4:1 TO BE PEGGED.

MINERAL FERTILIZER

APPLY THE FOLLOWING MINERAL FERTILIZER UNLESS SOILS TESTS SHOW OTHER REQUIREMENTS:

1. SOODED AREAS - 1% NITROGEN, 8% PHOSPHORUS AND 4% POTASH (11-8-4) AT THE RATE OF 4.5 KG OVER M2 (10 LBS OVER 1000 SQ. FT.).

2. PLANTING BEDS - 7% NITROGEN, 7% PHOSPHORUS AND 7% POTASH (7-7-7) AT THE RATE OF 40 GRAMS (4 OZ.) FOR EVERY BUSHEL OF TOPSOIL.

PREPARATION OF PLANTING BEDS

ALL PLANT BEDS TO BE CONTINUOUS. EXCAVATE ALL PLANTING BEDS TO THE DEPTH AS INDICATED ON THE DRAWINGS AND DETAILS. MIN 400mm (16"). BACKFILL ALL PLANTING BEDS WITH A SOIL MIXTURE CONSISTING OF SIX (6) PARTS OF SAND LOAM, ONE (1) PART OF FINELY FULFORIZED PEAT MOSS, TWO (2) PARTS OF WELL-ROTTED MANURE AND THE MINERAL FERTILIZER AS SPECIFIED ABOVE. ALSO ADD 58 KILOS BONE MEAL/CUBIC METER OF PLANTING SOIL (1 LB./CUBIC YARD). PREPARE THE PLANTING BEDS FOR PLANTING BEFORE THE DELIVERY OF THE PLANT MATERIAL TO THE JOB SITE.

NOTE: IF THE EXISTING SOIL CONDITIONS ARE CLAY OR WET IN NATURE, CONTACT THE LANDSCAPE ARCHITECT FOR INSTRUCTIONS OF A SUITABLE SOIL MIXTURE. FAILURE TO DO THIS MAY RESULT IN DELAY OF APPROVAL AND ACCEPTANCE.

PLANT MATERIALS

ALL PLANT MATERIAL SHALL CONFORM TO THE STANDARDS OF THE CANADIAN NURSERY TRADES ASSOCIATION FOR SIZE AND SPECIES.

ALL SHRUB AND TREE MATERIAL SHALL BE CONTAINER GROWN, POTTED, SB OR BB, UNLESS OTHERWISE NOTED. BARE ROOT PLANTING SHALL BE ACCEPTABLE FOR CERTAIN SPECIES DURING EARLY SPRING OR LATE FALL PLANTING SEASON. CONTRACTOR SHALL MAKE REQUESTS FOR ROOT CONDITION SUBSTITUTION IN WRITING TO THE LANDSCAPE ARCHITECT PRIOR TO COMMENCEMENT OF PLANTING OPERATIONS. ALL PLANT MATERIAL TO BE CLAY GROWN STOCK UNLESS OTHERWISE NOTED.

LANDSCAPE SPECIFICATIONS
SCALE: N.T.S. DATE: **1** LD-01

PLANT MATERIAL INSTALLATION

ALL TREES, SHRUBS AND GROUNDCOVERS SHALL BE PLANTED AS DETAILED & AS SHOWN ON THE PLANTING PLAN. ALL BEDS TO RECEIVE A COVER OF CLEAN MULCH TO A DEPTH OF 100mm (4"). FOR GUYING AND STAKING TREES, REFER TO PLANTING DETAILS. WRAP ALL DECIDUOUS TREES UNDER EXPERIENCED SUPERVISION ONLY TO THE SPECIFICATIONS OF THE ONTARIO LANDSCAPE CONTRACTORS ASSOCIATION.

PLANT MATERIAL SIZES AND CONDITIONS ARE TO BE AS INDICATED ON THE LANDSCAPE DRAWING.

THE INDIVIDUAL PLANT GROUPING TOTAL AS ILLUSTRATED ON THE PLANTING PLAN SUPERSEDES THE ESTIMATED QUANTITY ON THE MASTER PLANT LIST. CONTRACTOR MUST REPORT ANY DISCREPANCIES TO THE LANDSCAPE ARCHITECT IN WRITING BEFORE COMMENCING ANY WORK. CONTRACTOR WILL ASSUME FULL RESPONSIBILITY IF LANDSCAPE ARCHITECT IS NOT NOTIFIED OF DISCREPANCIES.

* MULCH - SHREDDED PINE MULCH BY "GRO BARK" OR APPROVED EQUAL. LANDSCAPE ARCHITECT TO APPROVE MULCH BEFORE INSTALLATION.

GENERAL MAINTENANCE

PROPER MAINTENANCE PROCEDURES ARE TO BE FULLY ADMINISTERED FOR ALL NEWLY CONSTRUCTED LANDSCAPE WORK, IN ACCORDANCE WITH LANDSCAPE ONTARIO SPECIFICATIONS (SECTION 1E - MAINTENANCE WORK). THIS SHALL APPLY ONLY DURING THE CONSTRUCTION PERIOD, UNLESS OTHERWISE SPECIFIED. CONTRACTOR IS RESPONSIBLE FOR MAINTENANCE OF SOD AND PLANTING UNTIL FINAL ACCEPTANCE BY LANDSCAPE ARCHITECT.

RODENT PROTECTION

THE CONTRACTOR SHALL BE RESPONSIBLE FOR THE PROTECTION OF ALL TREES AND SHRUBS FOR WINTER PROTECTION AND FROM RODENT INJURY FOR THE DURATION OF GUARANTY PERIOD. PROTECTIVE GUARDS SHALL BE EMPLOYED AROUND ALL DECIDUOUS TREES. GUARDS TO BE 150MM DIA. PVC PIPE OR AS MUNICIPAL GUIDELINES. GUARDS SHALL BE INSTALLED PRIOR TO THE APPLICATION OF THE MULCH AND SHOULD BE PLACED A MINIMUM OF 50MM (2") OUT FROM THE TREE TRUNK ON ALL SIDES.

ALL SHRUBS AND CONIFEROUS TREES SHALL HAVE AN APPLICATION OF "3000T" OR APPROVED EQUIVALENT RODENT FORMULA TO BE APPLIED AT THE END OF OCTOBER. FOLLOW MANUFACTURER'S DIRECTIONS FOR APPLICATION.

GENERAL REQUIREMENTS

USE ABOVE SPECIFICATIONS IN CONJUNCTION WITH THE GENERAL LANDSCAPE SPECIFICATIONS OF THE ONTARIO LANDSCAPE CONTRACTORS ASSOCIATION, THE NURSERY SOD GROWERS ASSOCIATION OF ONTARIO AND WITH THE GUIDE SPECIFICATIONS FOR NURSERY STOCK OF THE CANADIAN NURSERY TRADES ASSOCIATION. USE ONLY PLANT MATERIAL, TREE TO NAME, SIZE AND GRADE AS SPECIFIED ON PLANTING PLAN. PROVIDE SUFFICIENT LABELS OR MARKINGS TO INDICATE CLEARLY THE VARIETY, SIZE AND GRADE OF EACH SPECIMEN OR BUNDLE.

OBTAIN APPROVAL FOR SUBSTITUTIONS AS TO VARIETY, SIZE OR GRADE FROM THE LANDSCAPE ARCHITECT. USE ONLY NURSERY STOCK GROWN UNDER PROPER HORTICULTURAL PRACTICES, VIABLE, FREE FROM PEST AND DISEASE AND UNDAMAGED. CHECK LOCATIONS AND OBTAIN STAKEOUTS OF ALL UTILITY LINES BEFORE EXCAVATION. OBTAIN ALL NECESSARY PERMITS BEFORE COMMENCEMENT OF CONSTRUCTION. REPORT IN WRITING ANY DISCREPANCIES IN THE DRAWINGS, SPECIFICATIONS AND CONTRACT DOCUMENTS TO THE LANDSCAPE ARCHITECT BEFORE THE END OF THE BIDDING PROCESS AND COMMENCEMENT OF CONSTRUCTION. THESE SPECIFICATIONS MAY BE SUPERSEDED BY ADDITIONAL SPECIFICATIONS SET OUT IN THE TENDER DOCUMENTS. CONTRACTOR TO REVIEW ALL DOCUMENTS.

GUARANTEE PERIOD

PROVIDE ONE FULL YEAR GUARANTEE ON ALL LANDSCAPE WORK FROM DATE OF FINAL ACCEPTANCE BY LANDSCAPE ARCHITECT. GUARANTEE PERIOD MAY BE EXTENDED TO TWO FULL YEARS DEPENDING ON MUNICIPAL STANDARDS. CONTRACTOR TO VERIFY WITH OWNER AND LANDSCAPE ARCHITECT.

PLANT MATERIAL INSTALLATION
SCALE: N.T.S. DATE: **2** LD-01

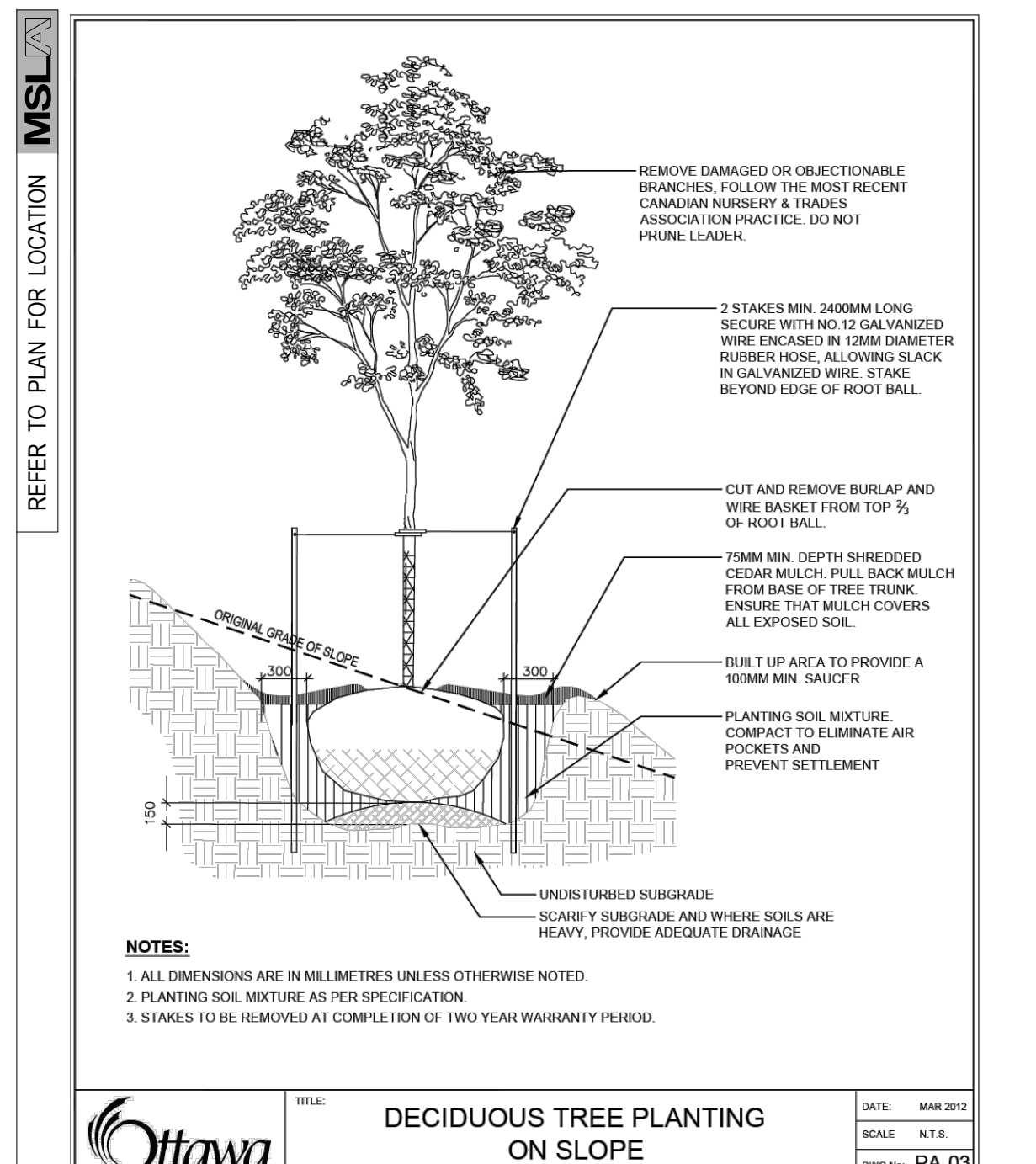

OTTAWA - DECIDUOUS TREE PLANTING (PA-03)
SCALE: N.T.S. DATE: **3** LD-01

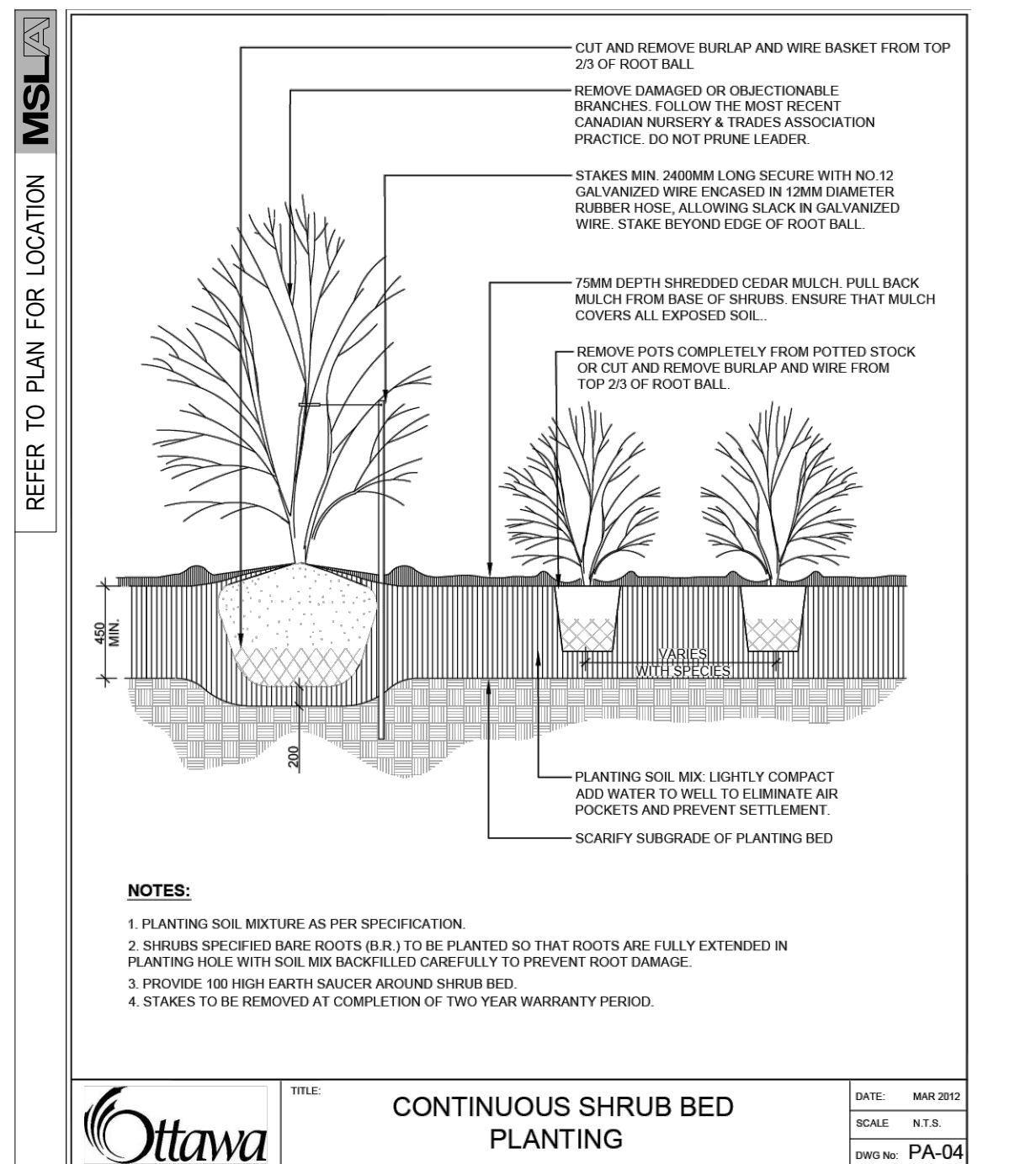

OTTAWA - CONTINUOUS SHRUB BED PLANTING (PA-04)
SCALE: N.T.S. DATE: **4** LD-01

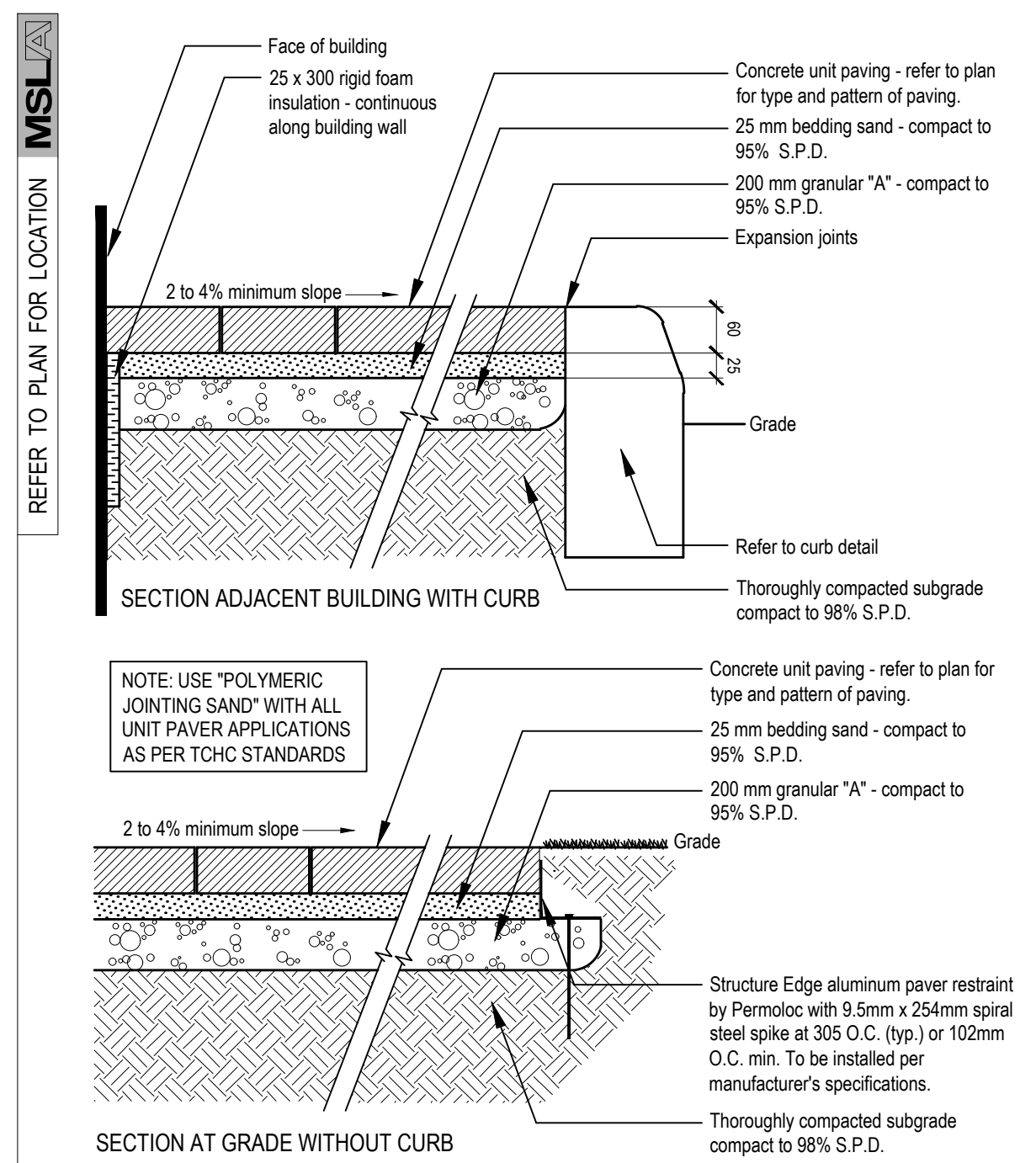

PEDESTRIAN PRECAST CONC. PAVER DETAIL
SCALE: N.T.S. WITH ALUMINUM EDGE RESTRAINT DATE: **5** LD-01

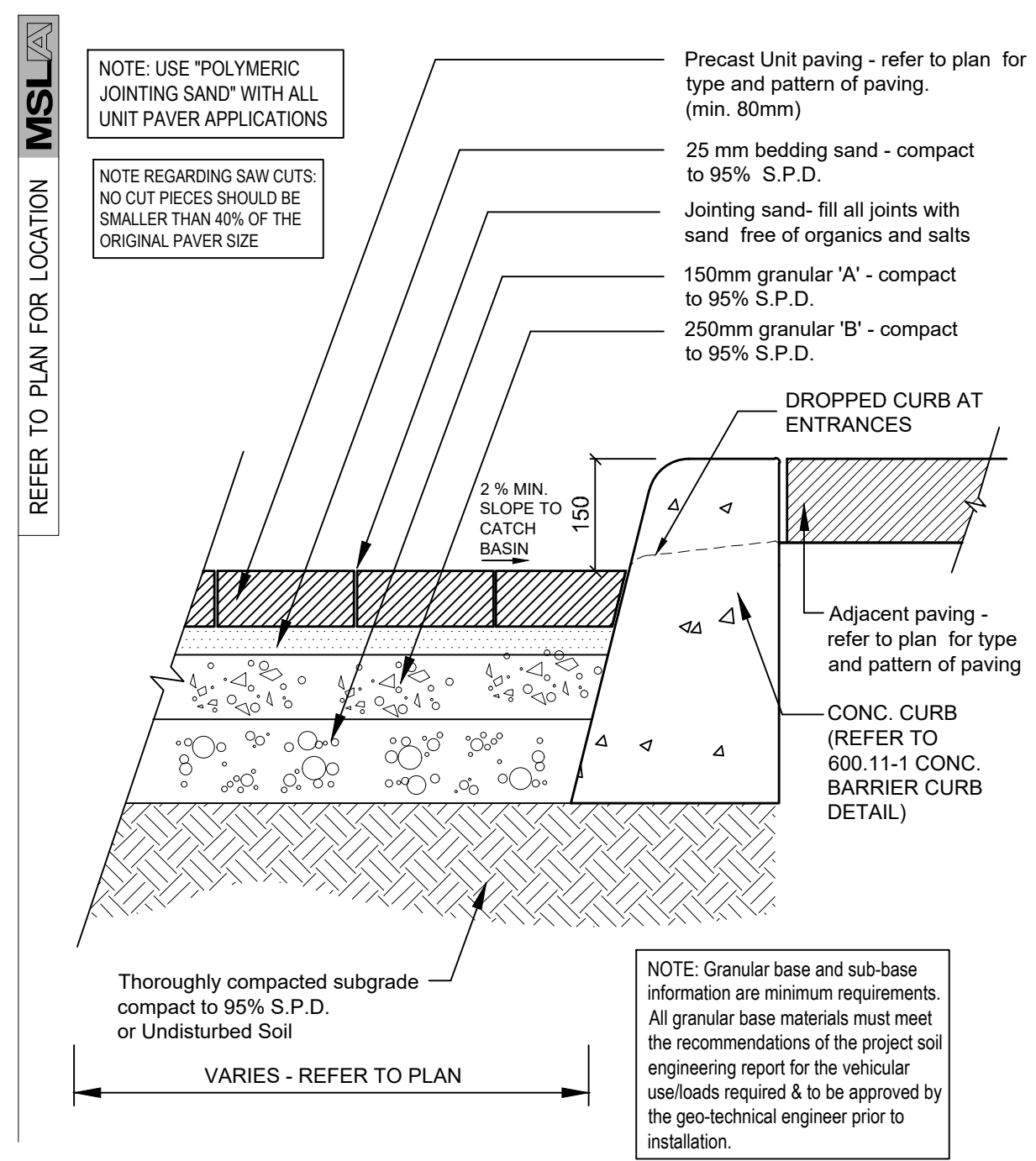

HEAVY DUTY (VEHICULAR) PRECAST CONCRETE UNIT PAVER INSTALLATION DETAIL
SCALE: N.T.S. Vehicular Detail to be approved by Civil or Geotechnical Engineer prior to construction. DATE: **6** LD-01

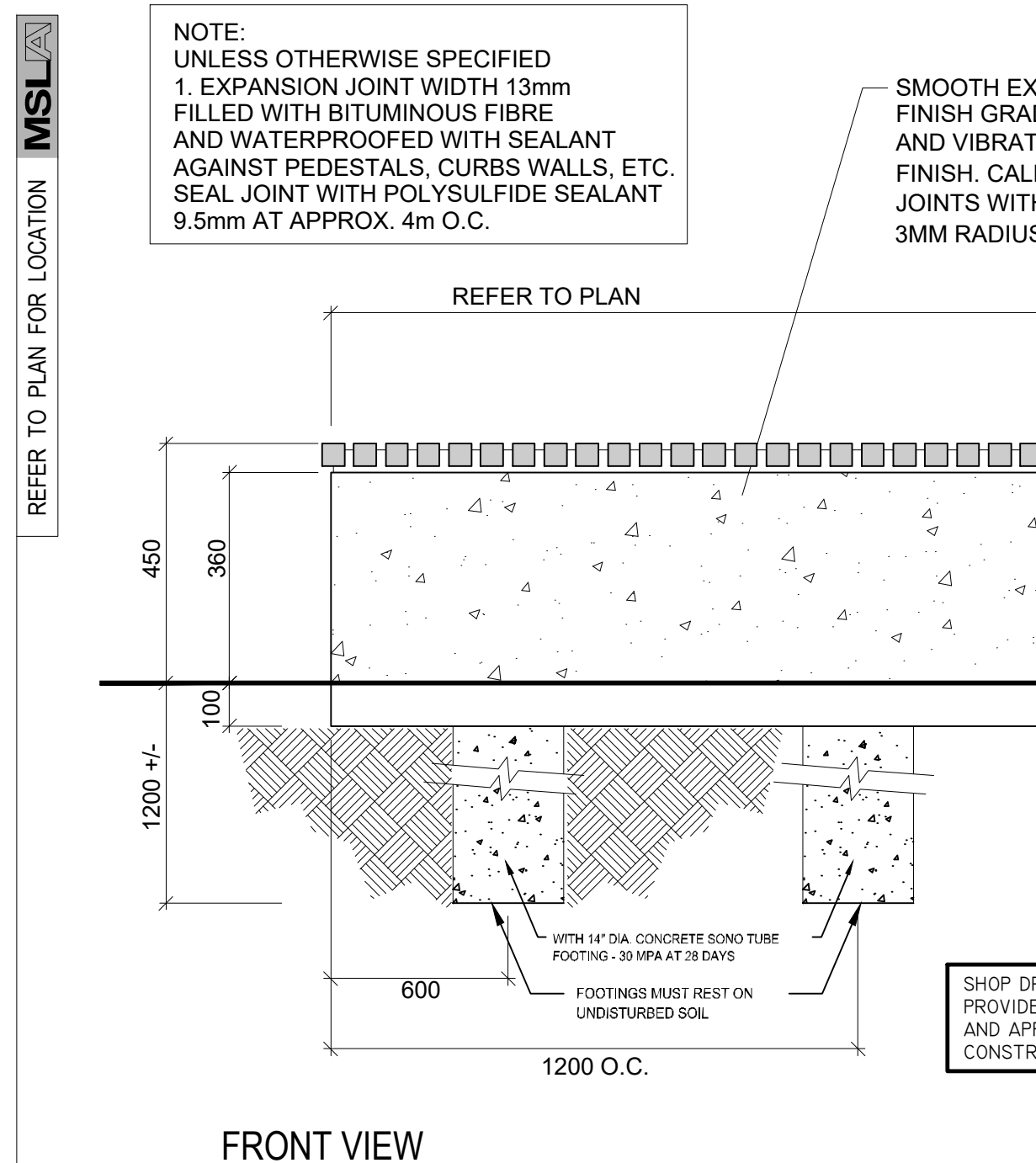

500 mm HT CONCRETE SEATWALL DETAIL WITH WOOD SLAT TOP
SCALE: N.T.S. DATE: **7** LD-01

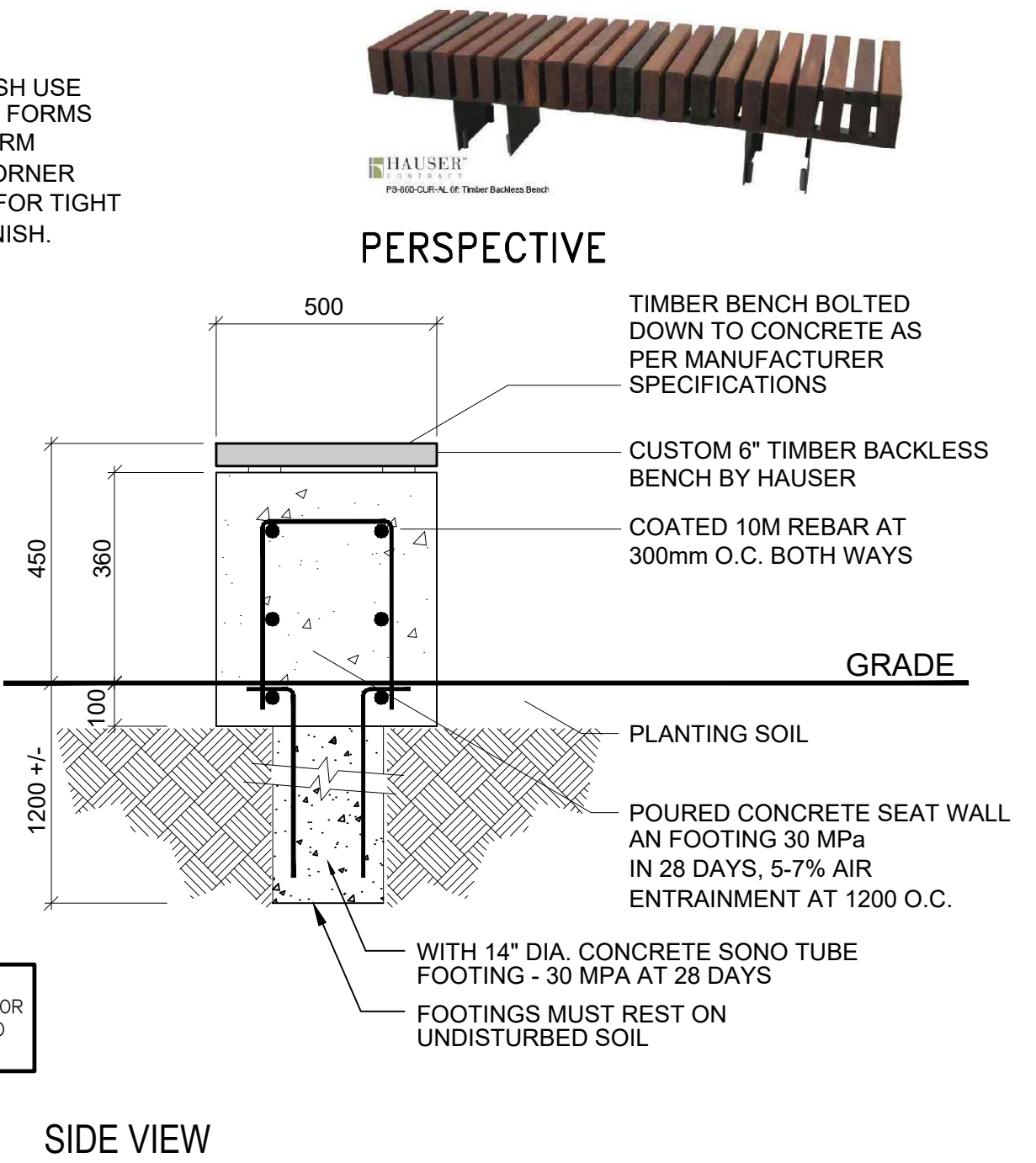

500 mm HT CONCRETE SEATWALL DETAIL WITH WOOD SLAT TOP
SCALE: N.T.S. DATE: **7** LD-01

No.	Revision	Date
08	Issued for Resubmission	12/09/24
07	Issued for Coordination	11/15/24
06	Issued for Coordination	10/24/24
05	Issued for SPA #1	07/15/24
04	Revised per Amenity	07/12/24
03	Issued for Coordination	07/09/24
02	Issued for Coordination	05/08/24
01	Issued for Coordination	04/26/24

North: Stamp:

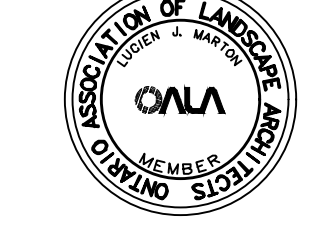

Project:
Proposed Landscape and Site Upgrades
917 Merivale Road,
Ottawa, Ontario,
File Number: D07-12-24-0067

Scale: **As Shown** Date: **APRIL 2024**

Drawn By: **A.L.** Checked By: **L.M.**

Drawing Title:

Landscape Details

Project No. **24120** Sheet No. **LD-01**

All information contained in these plans shall be checked by the contractor. All discrepancies shall be reported to the Landscape Architect (L.A.) before commencing with construction. All drawings have copyright and shall remain the property of the Landscape Architect. Copying or any reproduction in part or whole that only be permitted with written consent of L.A. Drawings shall not be used for construction unless sealed & stamped. NOTE FOR ANY AND ALL GRADING INFORMATION REFER TO SITE GRADING ENGINEERING DRAWINGS. NO SLOPES ARE TO EXCEED 3:1. PROPERTY LINES AND SETBACKS MUST BE COVERED BY CONTRACTOR PRIOR TO CONSTRUCTION. * ANY AND ALL RETAINING WALLS MUST BE APPROVED BY STRUCTURAL ENGINEER PRIOR TO CONSTRUCTION. * ANY AND ALL RETAINING WALLS MUST BE APPROVED BY ARCHITECT. * SIGNED DATE:

Architect:



Owner:

Marc Amyot
Assera Property Group
389 Hepatica Way,
Orleans, Ontario,
K4A0Z1
613-614-3992
marc@assera.ca

Municipality:



Notes:

SNOW REMOVAL NOTE:
Excess snow to be trucked off site.

DATE

REFER TO PLAN FOR LOCATION

Esplanade Bench
PS-840 Esplanade WD-W

Width: 77" (192.9 cm)
Depth: 27.25" (69.2 cm)
Height: 31" (78.7 cm)
Seat Height: 18" (45.7 cm)



sales@hauser.ca | 1-800-268-7328 | hauser.ca

HAUSER ESPLANADE BENCH

SCALE: N.T.S. SURFACE MOUNT MODEL

8 LD-02

REFER TO PLAN FOR LOCATION

Circum Bicycle Rack
PB-750-101-EX - Circum Bike Rack

Our Circum Bicycle Rack features a welded tubular and flat bar steel construction. It is available in your choice of HauserKOTE® powdercoat finishes.



sales@hauser.ca | 1-800-268-7328 | hauser.ca

HAUSER CIRCUM BIKE RING

SCALE: N.T.S. DIRECT BURIAL MODEL

9 LD-02

REFER TO PLAN FOR LOCATION

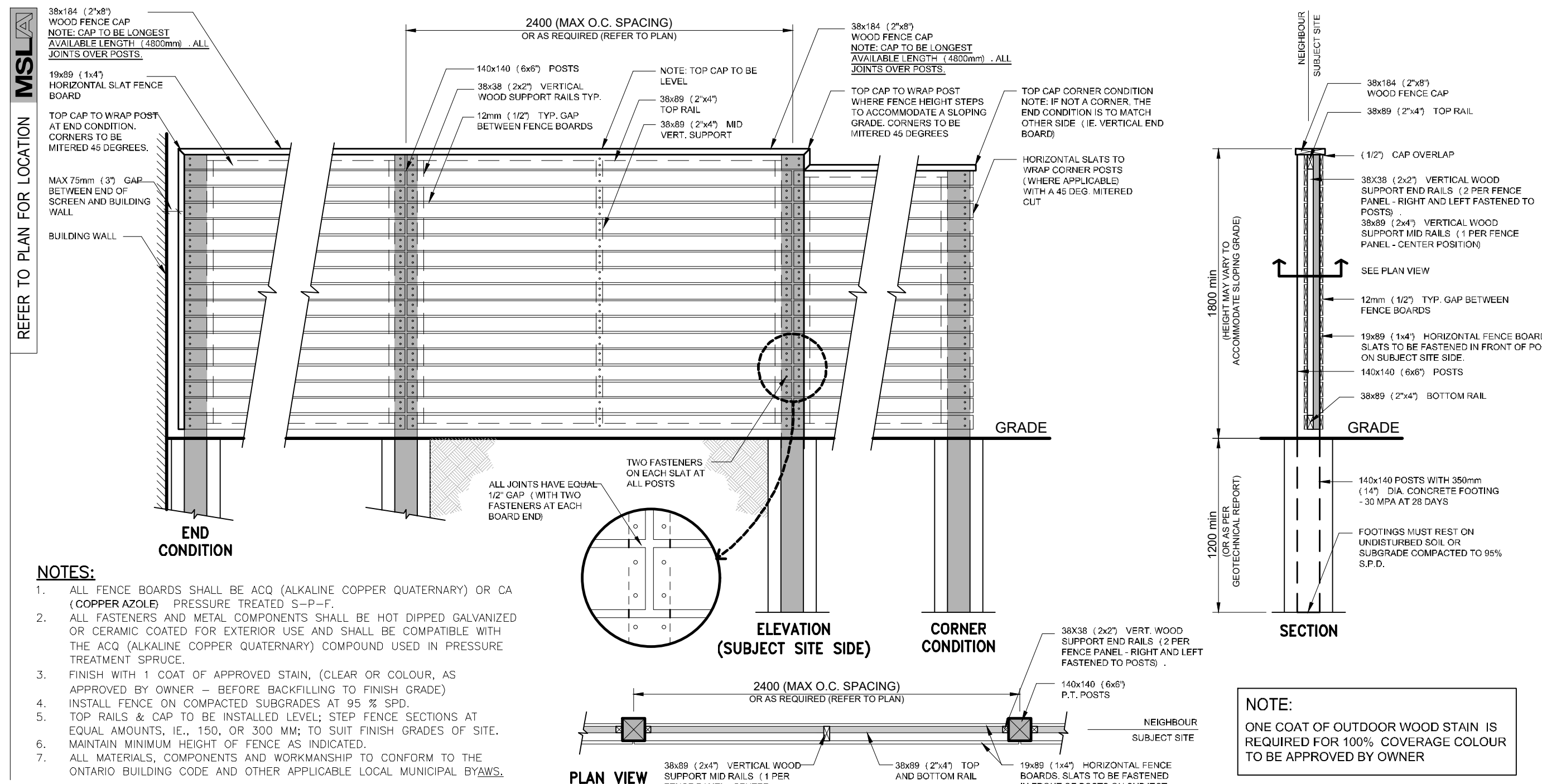

1800 HT. WOOD PRIVACY FENCE DETAIL

SCALE: N.T.S. 1/2" (12mm) GAP BETWEEN BOARDS

10 LD-01

REFER TO PLAN FOR LOCATION

Tapered Groove Planter

HSV02730-PLYBK

Special Order - Product Lead Time 4 weeks

Soften curves and textures. Like the feeling you get after doing a morning yoga flow in the sun, the Tapered Groove Planter has grooved walls and a round shape will add a relaxed, calming glow to your plants and arrangements.

PRODUCT SPECS

Capacity	36 Gal / 136.5 L
General Dimensions	27" Dia X 30 1/4"
Weight	24 Lbs
Materials	Polypropylene
Colour	Black



HAUSER
DESIGN GROUP

info@hauserstones.com
800-268-7328 ext. 232
hauserstones.com

HAUSER PLANTER

SCALE: N.T.S. DIRECT BURIAL MODEL

11 LD-02

REFER TO PLAN FOR LOCATION

UB 12-2 Specifications
12" DeepRoot® Tree Root Barrier

Specified tree root barrier is a mechanical barrier and root deflector used to prevent tree roots from damaging landscapes and foundations. Assembled in 24" (609 mm) long modules to create varying lengths for their application, or perimeter around applications in varying sizes.

4. Materials
1. The contractor shall furnish and install tree root barrier as specified.
2. The tree root barrier shall be either product 409-12-2 as manufactured by DeepRoot® Green Infrastructure, LLC, 530 Washington Street, San Francisco, CA, www.deeproot.com (800-458-7668).

3. Root barrier shall be recyclable, black, injection molded panels with 0.87" (22.25 mm) wall thickness in modules 24" (609 mm) long and 12" (305 mm) deep.

4. Root barrier shall be manufactured with 70% recycled polypropylene with added ultraviolet inhibitors.

5. Root barrier shall have a Double Top Edge consisting of two parallel, integral, horizontal ribs at the top of the panel at 0.067" (1.72 mm) thickness, 3.08" (78.3 mm) wide and 1.41" (35.8 mm) apart with the lower rib attached to the vertical Root Directing Ribs (See Detail A).

6. Root barrier shall have a minimum of three (3) Anti-Lift Ground Lock Tabs consisting of integral horizontal ridges of minimum 0.067" (1.72 mm) thickness in the shape of a segment of an oblong, the 2" (50.8 mm) end of the segment joining the panel wall and the segment, protruding 1/2" (12.7 mm) from the panel. The ground locks on each panel shall be about equally spaced between each of the vertical root directing ribs (See Details B & C).

7. Root barrier shall have an integrated zipper joining system for assembly by sliding one panel into another (See Detail D).

U.S. Patents: 5,305,540; and 5,528,873. Other Patents Pending.

Property	Typical Value	ASTM Test Method
Tensile strength @ yield - Wall	2,283 PSI	D638
Tensile strength @ yield - Ridge	2,483 PSI	D638
Yield Elongation - Wall	7.72%	D638
Yield Elongation - Ridge	7.58%	D638
Flexural Modulus	120,780 PSI	D790B
Notched Izod Impact - Wall	2.54 (B-Notch)	D256A
Notched Izod Impact - Ridge	84.1	D256A

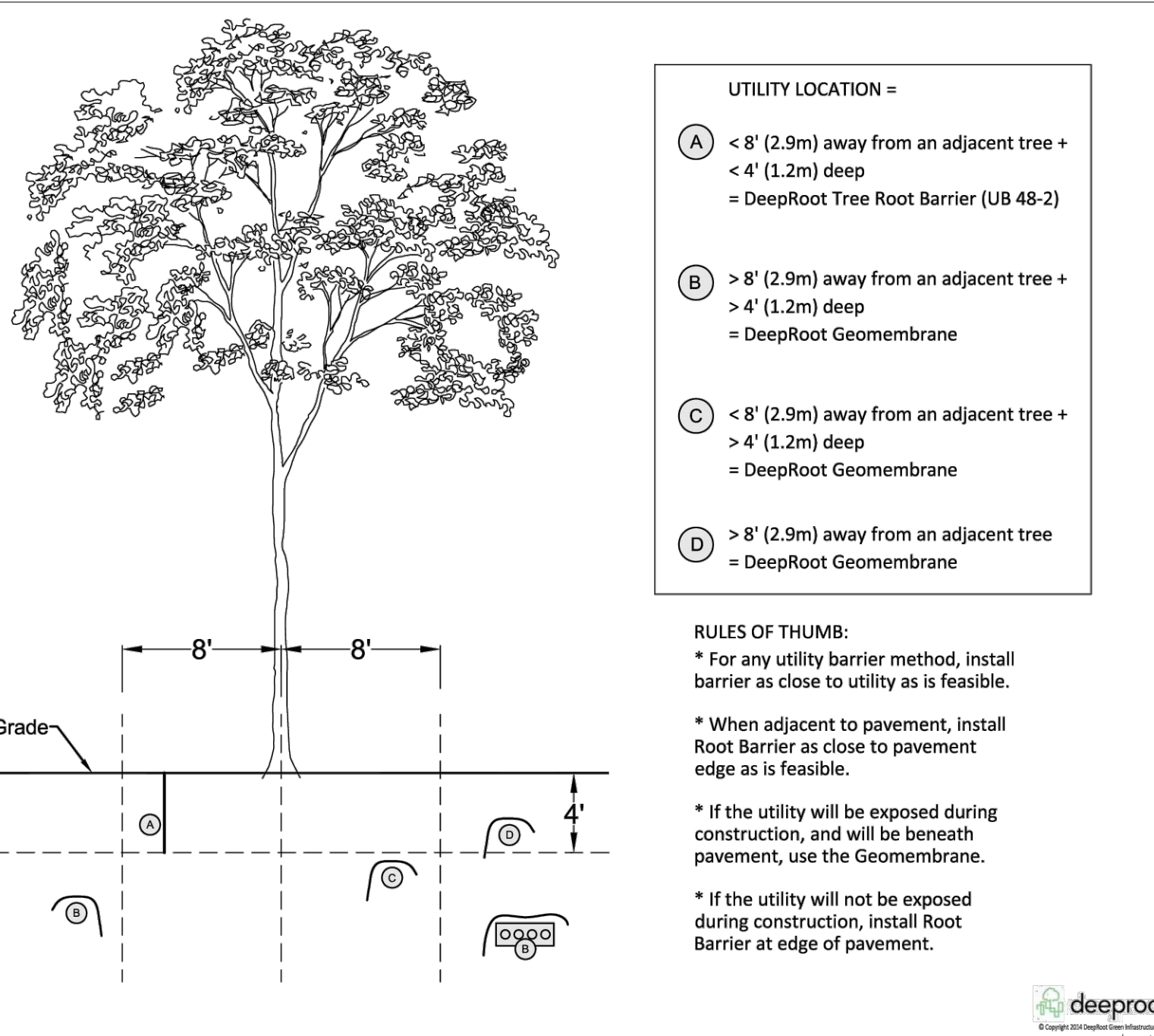
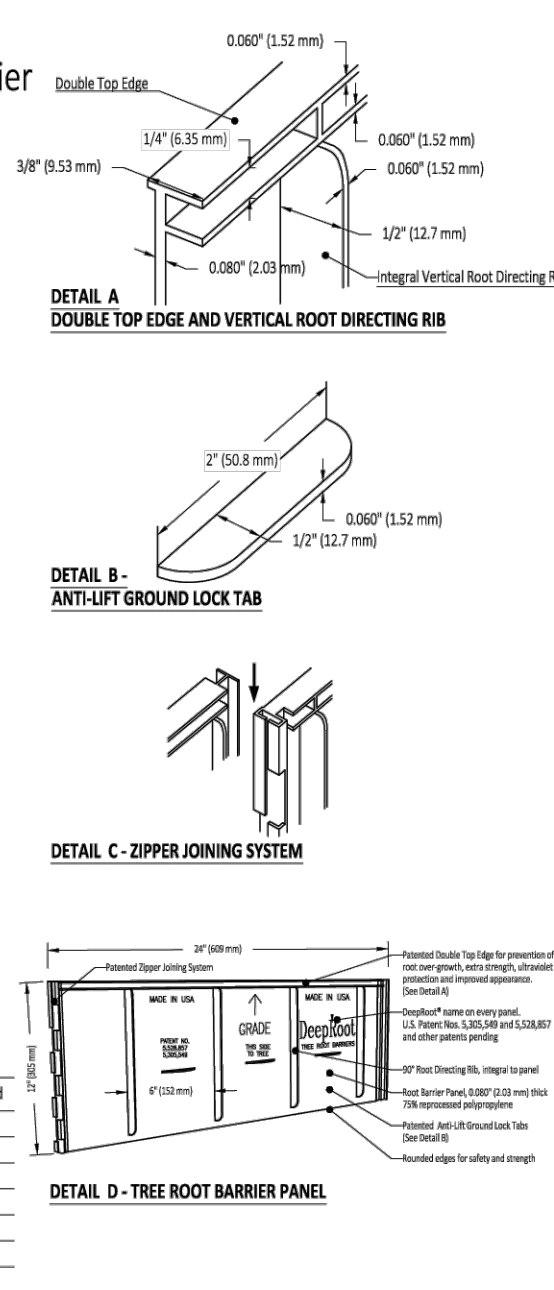

deeproot
www.deeproot.com

12 LD-02

08	Issued for Resubmission	12/09/24
07	Issued for Coordination	11/15/24
06	Issued for Coordination	10/24/24
05	Issued for SPA #1	07/15/24
04	Revised per Amenity	07/12/24
03	Issued for Coordination	07/09/24
02	Issued for Coordination	05/08/24
01	Issued for Coordination	04/26/24

No. Revision Date

North: Stamp:

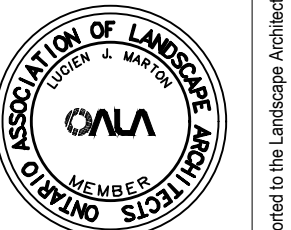

Project:
Proposed Landscape and Site Upgrades
917 Merivale Road,
Ottawa, Ontario,
File Number: D07-12-24-0067

Scale: As Shown Date: APRIL 2024

Drawn By: A.L. Checked By: L.M.

Drawing Title:

Landscape Details

Project No. Sheet No.
24120 LD-02

All information contained in these plans shall be checked by the contractor. All discrepancies shall be reported to the Landscape Architect (L.A.) before commencing with construction. All drawings have copyright and shall remain the property of the Landscape Architect. Copying or any reproduction in part or whole that only be permitted with written consent of L.A. Drawings shall not be used for construction unless sealed & signed. NOTE FOR ANY AND ALL GRADING INFORMATION REFER TO SITE GRADING ENGINEERING DRAWINGS. NO SLICES ARE TO EXCEED 3:1. PROPERTY LINES AND SETBACKS MUST BE COVERED BY CONTRACTOR PRIOR TO CONSTRUCTION. ANY AND ALL RETAINING WALLS MUST BE APPROVED BY STRUCTURAL ENGINEER PRIOR TO CONSTRUCTION. DO NOT SCALE DRAWINGS. PRELIMINARY NOT FOR CONSTRUCTION UNTIL COUNTERSIGNED BY L. ARCHITECT. SIGNED