

LEGEND:	
	PROPOSED ROADWAY MODIFICATION
	PROPOSED DEVELOPMENT AREA
	EXISTING SIGNALIZED INTERSECTION



PLANNING DEVELOPMENT &  
BUILDING SERVICES  
DEPARTMENT

**KEYPLAN**  
**OR174 EB ON RAMP**  
**NORTH OF ST JOSEPH**  
**BOULEVARD**

Transportation Engineering Services



Approved By:	
Completed By: NOVATECH	
Scale: N.T.S.	Date: DECEMBER 2024

Drawing No.:  
**RMA-2024**  
**-TPD-035A**

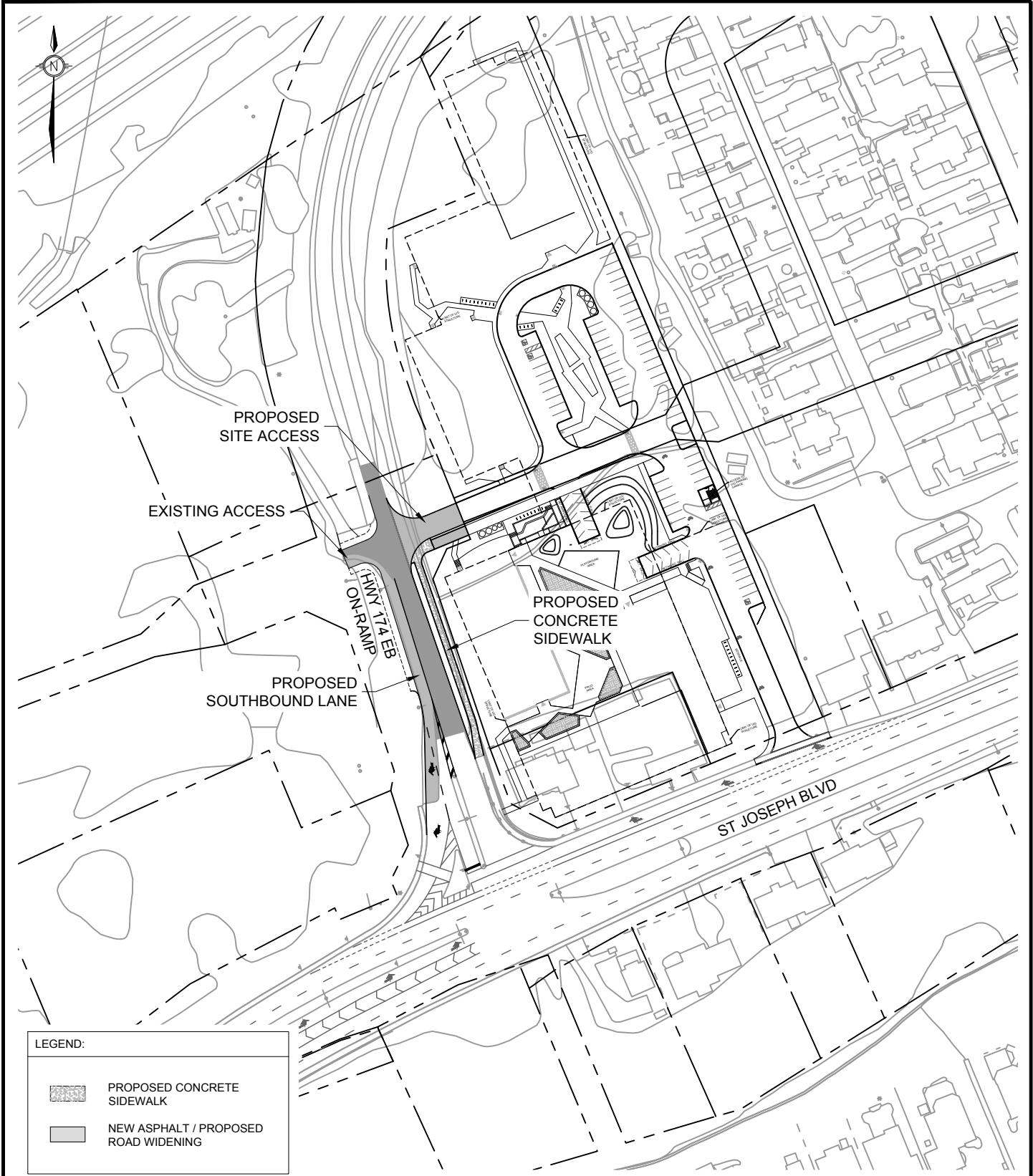
C:\temp\AcPublisher\_19912113020-FD.dwg, RMA-DET, Nov 20, 2024 - 3:36pm, rthiller



**LEGEND:**

-  PROPOSED CONCRETE SIDEWALK
-  NEW ASPHALT / PROPOSED ROAD WIDENING



PLANNING DEVELOPMENT &  
BUILDING SERVICES  
DEPARTMENT

**PROPOSED ROADWAY  
MODIFICATION**  
**OR174 EB ON RAMP  
NORTH OF ST JOSEPH  
BOULEVARD**

Transportation Engineering Services

Approved By:		Drawing No.:
Completed By: NOVATECH		
Scale: N.T.S.	Date: DECEMBER 2024	

**RMA-2024  
-TPD-035B**



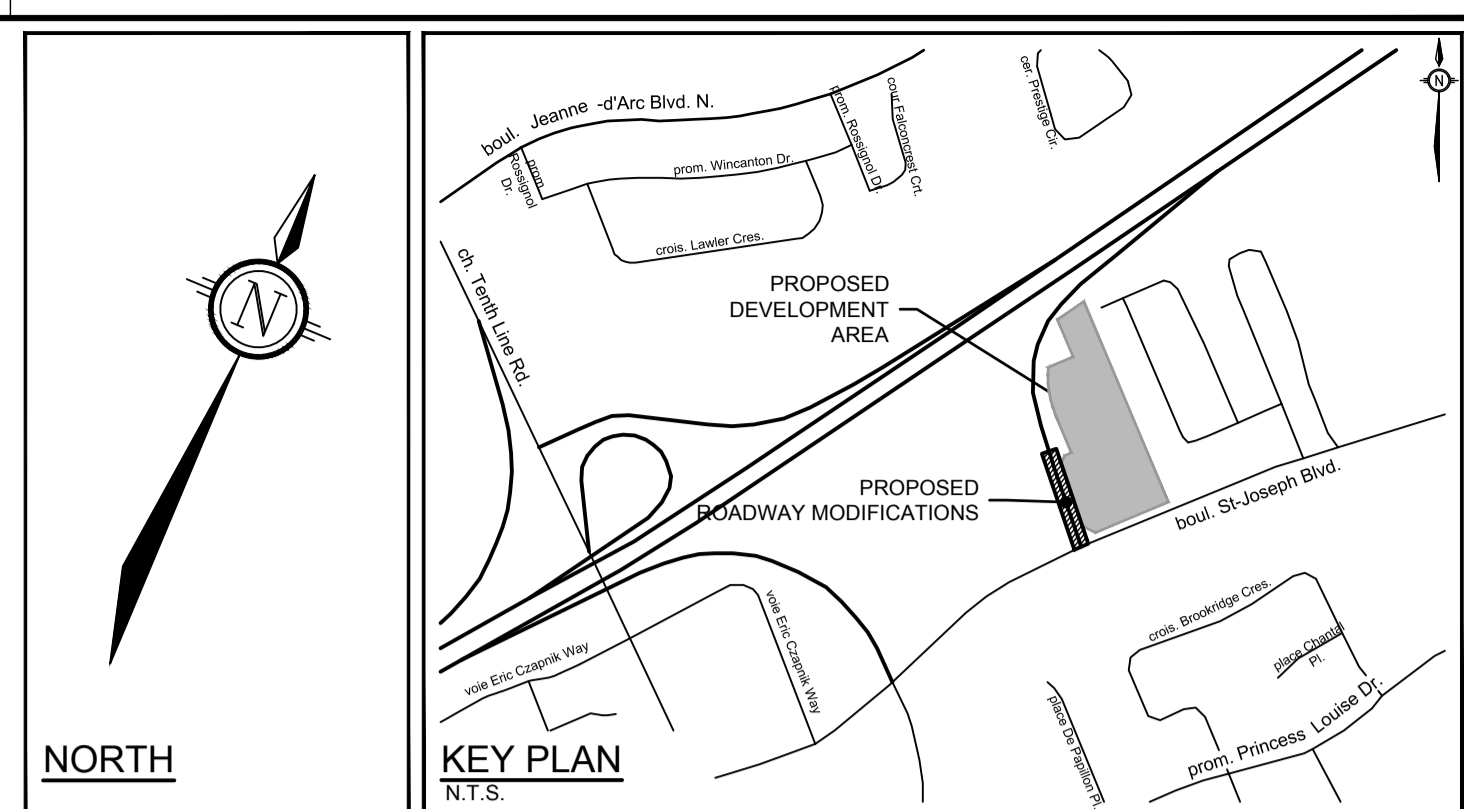
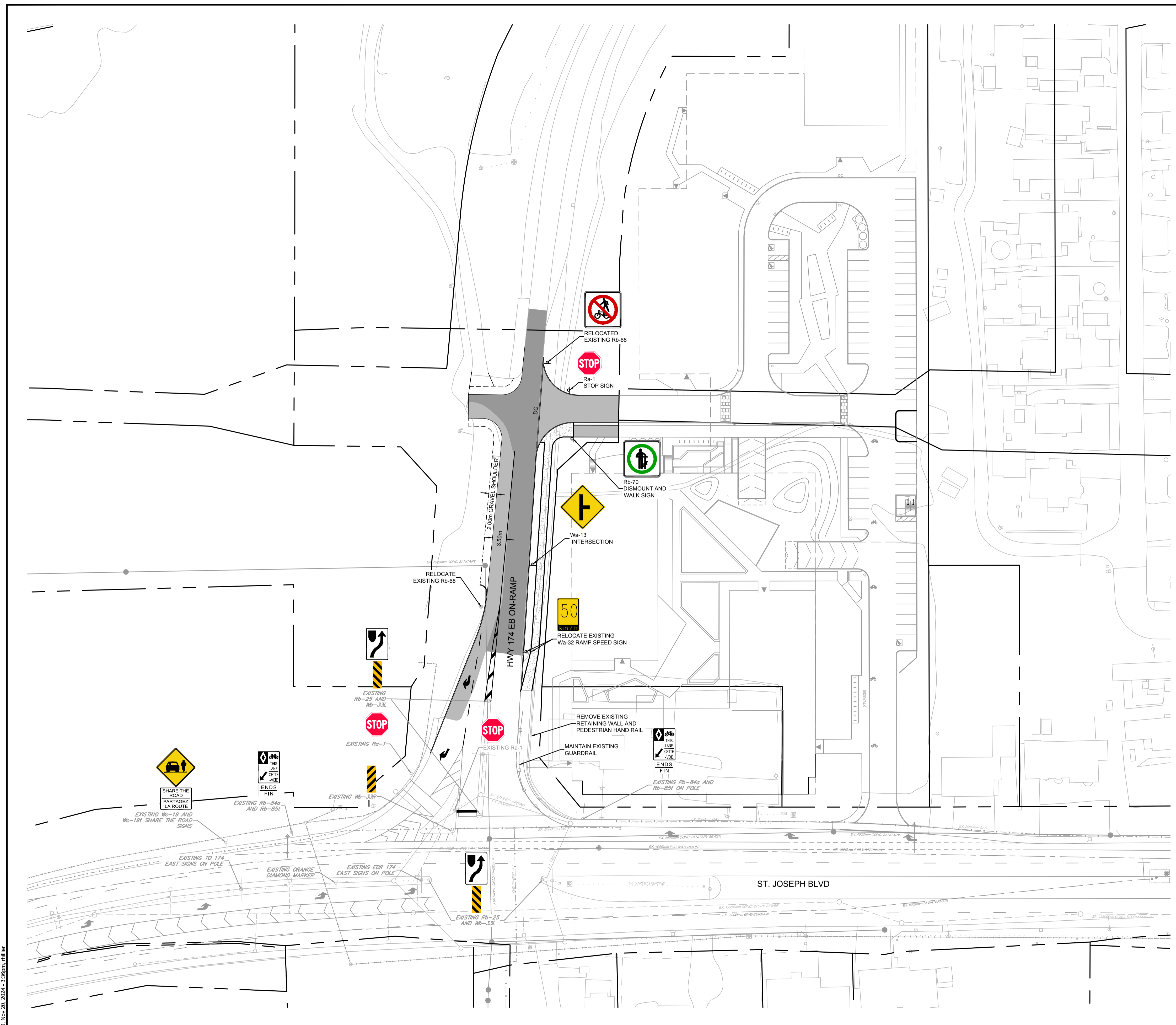

- LEGEND**
- PROPOSED ASPHALT WIDENING
  - PROPOSED ASPHALT REMOVAL AND REGRADING
  - PROPOSED CONCRETE
  - DC**
  - PROPOSED DEPRESSED CURB
  - EXISTING LIGHT STANDARD
  - EXISTING SANITARY MANHOLE
  - EXISTING STORM MANHOLE
  - EXISTING TRAFFIC MANHOLE
  - EXISTING CATCHBASIN
  - EXISTING TREE
  - EXISTING HYDRO DUCT
  - EXISTING BELL DUCT
  - EXISTING ROGERS DUCT
  - EXISTING GAS MAIN
  - EXISTING WATERMAIN
  - EXISTING STREET LIGHT DUCT
  - EXISTING GUIDERAIL

**NOTE:**  
 THE POSITION OF ALL POLE LINES, CONDUITS, WATERMANS, SEWERS AND OTHER UNDERGROUND AND OVERGROUND UTILITIES AND STRUCTURES IS NOT NECESSARILY SHOWN ON THE CONTRACT DRAWINGS, AND WHERE SHOWN, THE ACCURACY OF THE POSITION OF SUCH UTILITIES AND STRUCTURES IS NOT GUARANTEED. BEFORE STARTING WORK, DETERMINE THE EXACT LOCATION OF ALL SUCH UTILITIES AND STRUCTURES AND ASSUME ALL LIABILITY FOR DAMAGE TO THEM.

No.	REVISION	DATE	BY
2.	REVISED PER CITY COMMENTS	NOV 20/24	BJB
1.	ISSUED FOR REVIEW	JUL 12/24	BJB

SCALE	
1:500	

DESIGN	
CHECKED	RCH
DRAWN	JRA
CHECKED	RCH
APPROVED	JRA
	BJB

FOR REVIEW ONLY	

**NOVATECH**  
 Engineers, Planners & Landscape Architects  
 Suite 200, 240 Michael Cowpland Drive  
 Ottawa, Ontario, Canada K2M 1P6  
 Telephone: (613) 254-9643  
 Facsimile: (613) 254-5867  
 Website: www.novatech-eng.com

REFER TO \_\_\_\_\_ FOR ADDITIONAL NOTES

LOCATION	
CITY OF OTTAWA CHARTRO	
DRAWING NAME	
FUNCTIONAL DESIGN	
PROJECT No.	113020
REV	REV # 2
DRAWING No.	113020-FD