

CAUTION: OF ALL POLE LINES, CONDUITS, WATERMANS, SEWERS AND OTHER UNDERGROUND AND OVERGROUND UTILITIES SHOWN HEREON. THE CONTRACTOR SHALL VERIFY THE LOCATION AND DEPTH OF ALL SUCH UTILITIES AND BEFORE STARTING WORK, DETERMINE THE EXACT LOCATION OF ALL SUCH UTILITIES AND DAMAGE TO THEM.

SITE BENCHMARK
 FIRE HOIST TOP OF SPINDLE
 ELEVATION=86.896

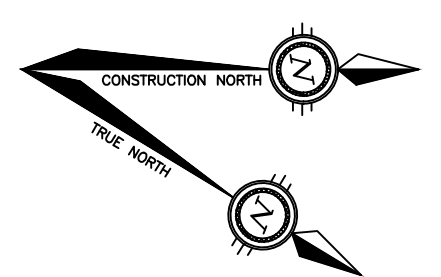
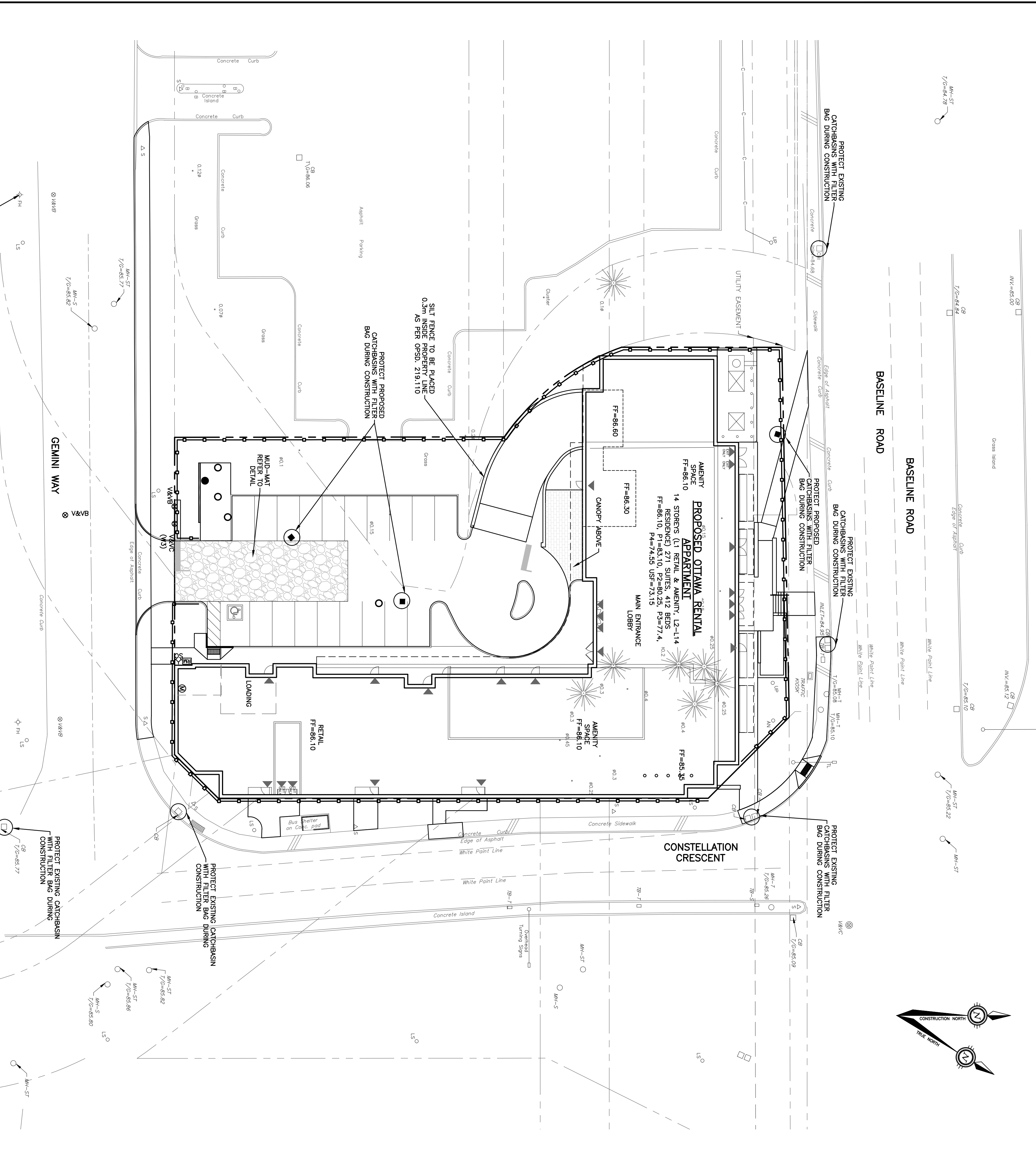

REV	REVISION DESCRIPTION	DATE	BY	APP'D
1	REVISION DESCRIPTION	18/12/18	SAB	BMT
2	REVISION DESCRIPTION	28/03/19	SAB	BMT
3	REVISION DESCRIPTION	14/06/19	SAB	BMT
4	REVISION DESCRIPTION	02/08/19	SAB	BMT
5	REVISION DESCRIPTION	12/13/19	MZG	BMT
6	ISSUED FOR BUILDING PERMIT	25/06/20	SAB	BMT
7	REMOVED SEATING WALL ALONG CONSTELLATION CRESCENT	17/12/20	SAB	BMT
8	PROPERTY LINE/PARKING UPDATES	24/11/23	SAB	BMT
9	ISSUES FOR APPROVAL	24/05/24	SAB	BMT

REV	REVISION DESCRIPTION	DATE	BY	APP'D
1	REVISION DESCRIPTION	18/12/18	SAB	BMT
2	REVISION DESCRIPTION	28/03/19	SAB	BMT
3	REVISION DESCRIPTION	14/06/19	SAB	BMT
4	REVISION DESCRIPTION	02/08/19	SAB	BMT
5	REVISION DESCRIPTION	12/13/19	MZG	BMT
6	ISSUED FOR BUILDING PERMIT	25/06/20	SAB	BMT
7	REMOVED SEATING WALL ALONG CONSTELLATION CRESCENT	17/12/20	SAB	BMT
8	PROPERTY LINE/PARKING UPDATES	24/11/23	SAB	BMT
9	ISSUES FOR APPROVAL	24/05/24	SAB	BMT

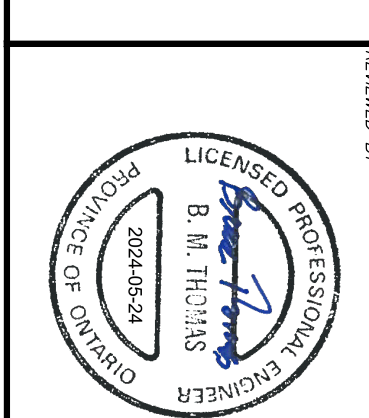
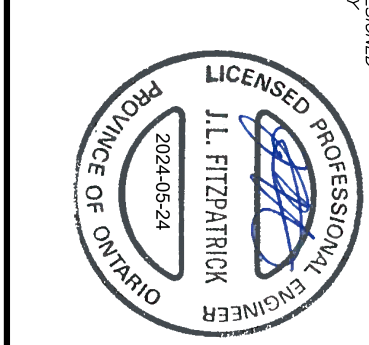
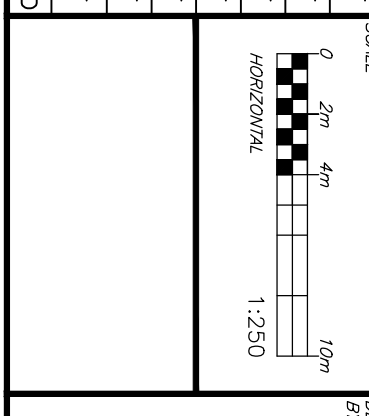

exp.
 BASELINE CONSTELLATION PARTNERSHIP INC.
 HERBERT HOMES
 804 LADY ELLER PLACE
 OTTAWA, ON. K1Z 5J5

MSTERCHART STRAWOOD
 115 CHAMPAINE AVE. SOUTH
 OTTAWA, ON. K1S 5R5

PROJ. NO.	PROJ. NAME	DATE
OTT-00245012-AD	OTTAWA RENTAL APARTMENT	APRIL 2018
OTT-00245012-AD	OTTAWA RENTAL APARTMENT	APRIL 2018

EROSION AND SEDIMENT CONTROLS DURING CONSTRUCTION

- DURING ALL CONSTRUCTION ACTIVITIES, EROSION AND SEDIMENTATION SHALL BE CONTROLLED BY THE FOLLOWING TECHNIQUES:
1. LIMITING THE EXTENT OF EXPOSED SOILS AT ANY GIVEN TIME.
 2. REGENERATION OF EXPOSED AREAS AS SOON AS POSSIBLE.
 3. MINIMIZATION OF AREA TO BE CLEARED AND DISRUPTION TO ADJACENT AREAS.
 4. INSTALLATION OF FILTER CLOTH BETWEEN FRAME AND COVER ON ALL PROPOSED CATCH BASINS AND CATCH BASIN MANHOLES.
 5. A SILT FENCE TO BE INSTALLED 0.3m INSIDE THE SITE PROPERTY LINE AT LOCATIONS SHOWN ON THIS DRAWING.
 6. A VISUAL INSPECTION SHALL BE COMPLETED DAILY ON SEDIMENT CONTROL BARRIERS AND ANY DAMAGE REPAIRED IMMEDIATELY. CARE WILL BE TAKEN TO PREVENT DAMAGE DURING CONSTRUCTION OPERATIONS.
 7. IN SOME CASES SOME BARRIERS MAY BE REMOVED TEMPORARILY TO PERMIT ACCESS TO ADJACENT AREAS. SUCH REMOVALS SHALL BE APPROVED BY THE ENGINEER.
 8. THE SEDIMENT CONTROL PROGRAMS WILL BE DESIGNED OF AS PER THE REQUIREMENTS OF THE CONTRACT.
 9. DURING THE COURSE OF CONSTRUCTION IF THE ENGINEER BELIEVES THAT ADDITIONAL PREVENTION METHODS ARE REQUIRED TO CONTROL EROSION AND SEDIMENTATION, THE CONTRACTOR WILL INSTALL THE ADDITIONAL PREVENTION METHODS AS REQUIRED TO THE SATISFACTION OF THE ENGINEER.
 10. CONSTRUCTION AND MAINTENANCE REQUIREMENTS FOR EROSION AND SEDIMENT CONTROLS TO COMPLY WITH ONTARIO PROVINCIAL STANDARD SPECIFICATIONS (OPSS) OPSS 805, AND CITY OF OTTAWA SPECIFICATIONS.
 11. SEDIMENT AND EROSION CONTROL MEASURES MAY BE MODIFIED IN THE FIELD AT THE DISCRETION OF THE CITY OF OTTAWA SITE INSPECTOR OR CONSERVATION AUTHORITIES.

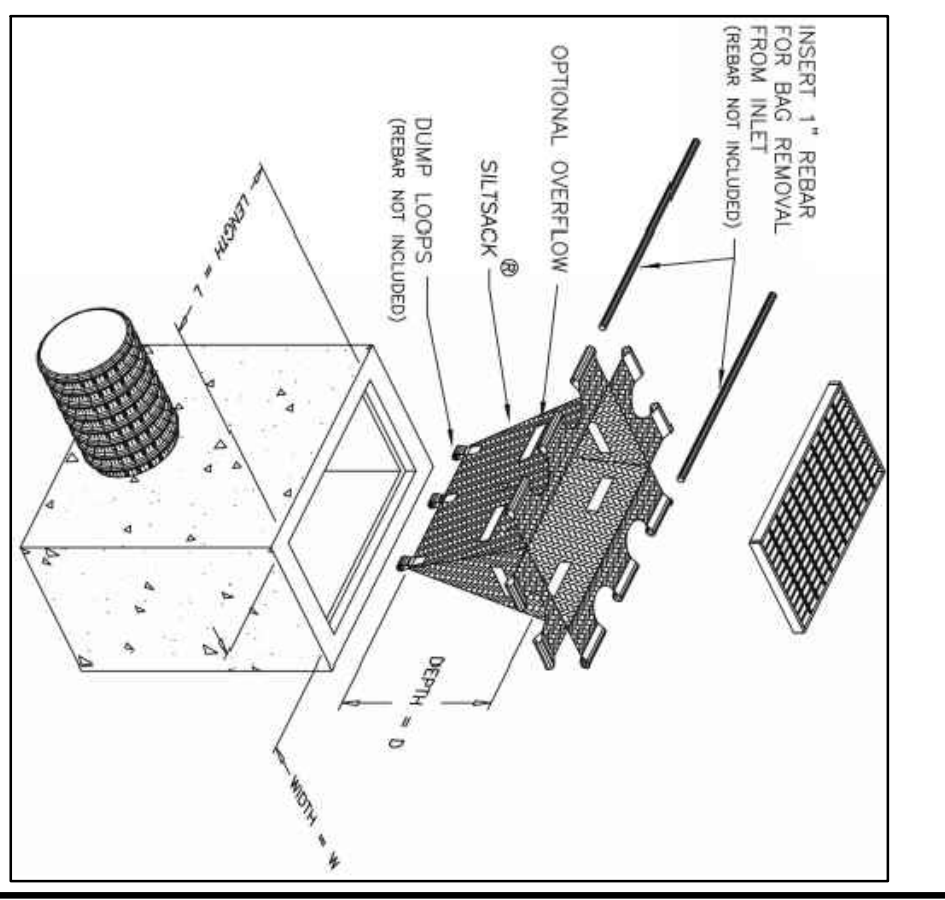
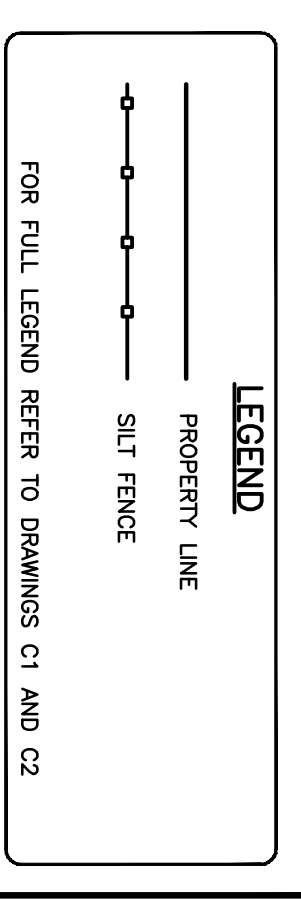
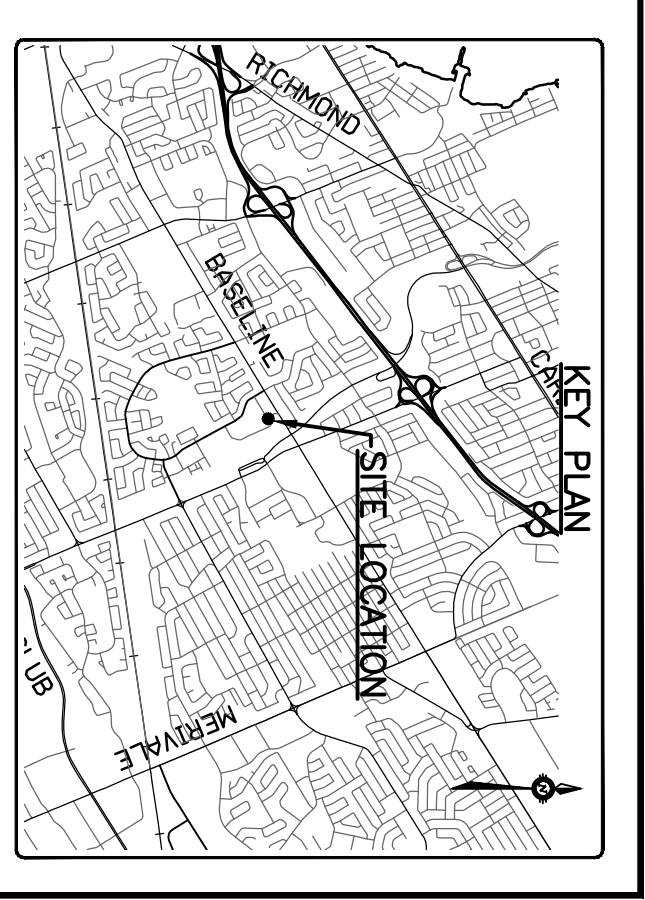

PROFILE VIEW

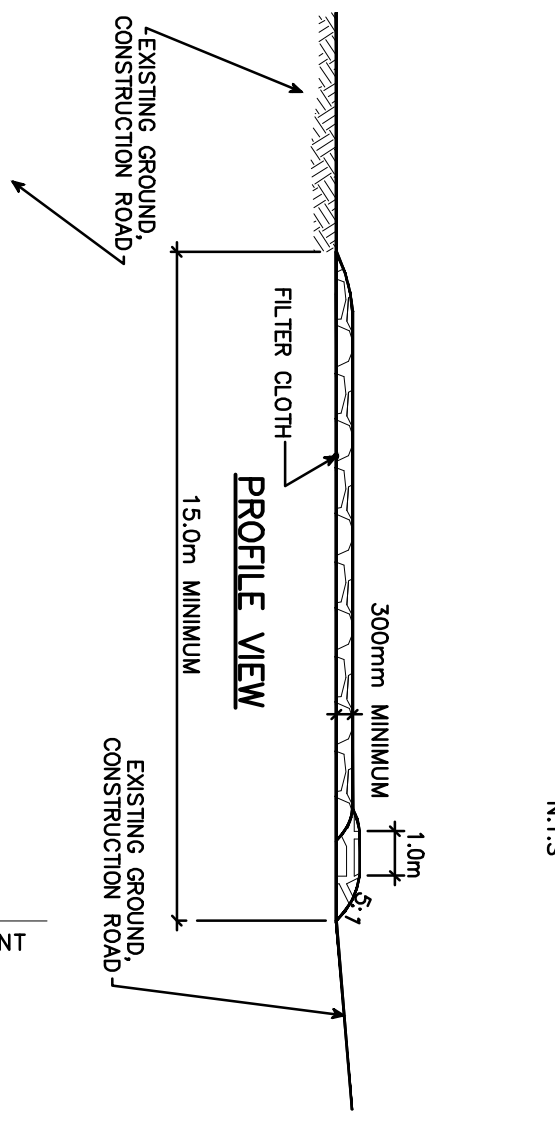

PLAN VIEW

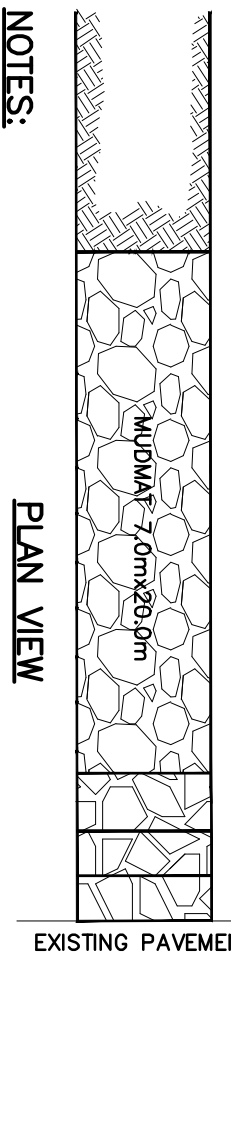

MUD MAT DETAIL

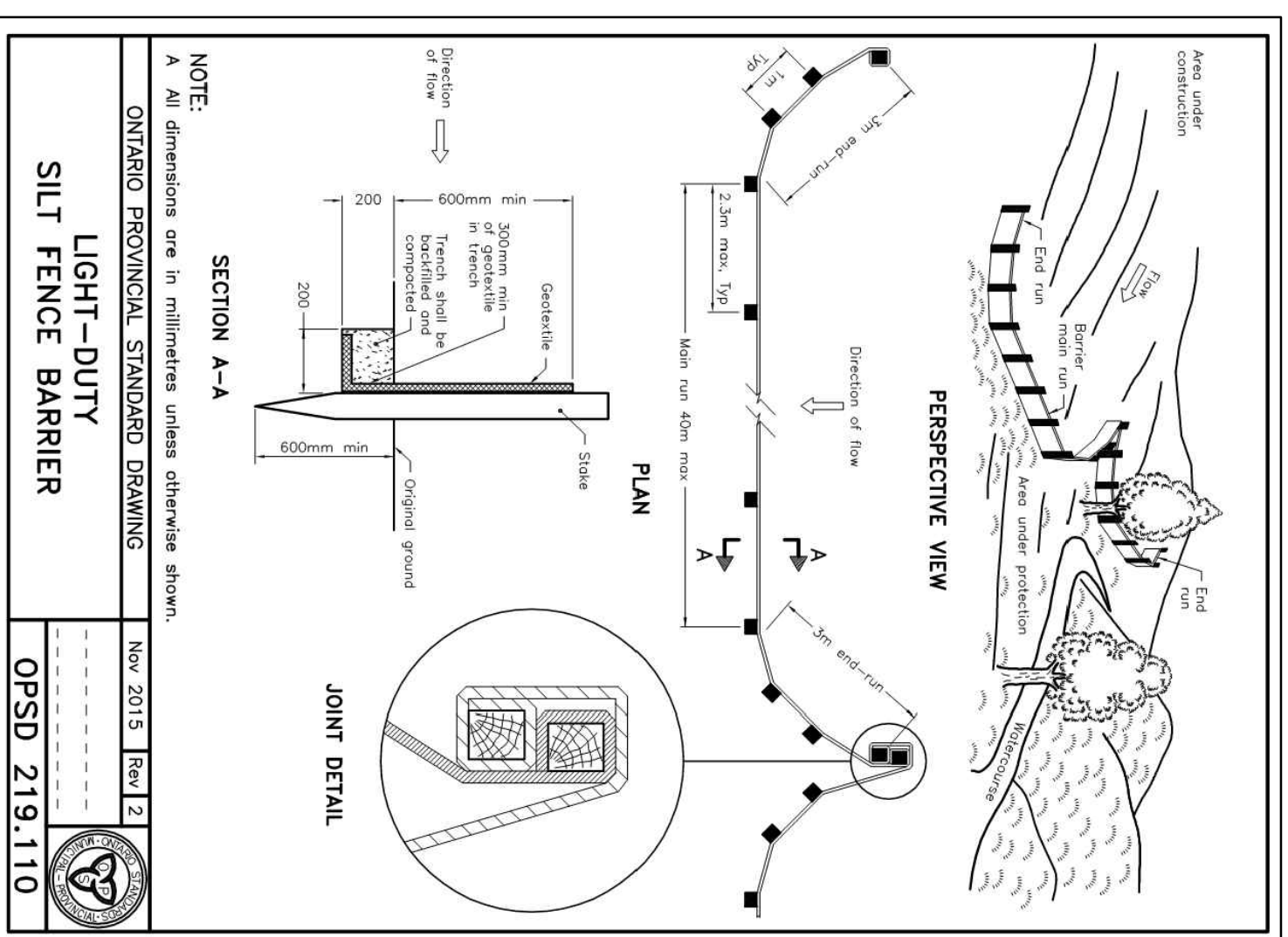

- NOTES:**
1. WOVEN WIRE FENCE TO BE FASTENED SECURELY TO WOOD POSTS WITH WIRE TIES
 2. POSTS TO BE SPACED AT 2.3 METRES CENTRE TO CENTRE.
 3. WHEN TWO SECTIONS OF FILTER CLOTH ADJOIN EACH OTHER THEY SHALL BE OVERLAPPED SHALL MINIMUM OVERLAP REQUIRED AND MATERIAL REMOVED WHEN BULGES DEVELOP IN THE SILT FENCE.
 4. WOOD POSTS TO BE HARDWOOD TYPE (50mm x 50mm).
 5. WOOD POSTS TO BE SPACED AT 2.3 METRES CENTRE TO CENTRE.
 6. SILT FENCE TO BE REMOVED TO EXPOSE ROAD SURFACING.
 7. SILT FENCE MUST BE INSTALLED BEFORE COMMENCEMENT OF CONSTRUCTION AND IN ACCORDANCE WITH DETAIL. SILT FENCE CAN BE REMOVED AFTER LANDSCAPING IS COMPLETED.
 8. SEDIMENTATION AND MAINTENANCE REQUIREMENTS FOR EROSION AND SEDIMENT CONTROLS TO COMPLY WITH ONTARIO PROVINCIAL STANDARD SPECIFICATIONS (OPSS) OPSS 805, AND CITY OF OTTAWA SPECIFICATIONS.
 9. SEDIMENT AND EROSION CONTROL MEASURES MAY BE MODIFIED IN THE FIELD AT THE DISCRETION OF THE CITY OF OTTAWA SITE INSPECTOR OR CONSERVATION AUTHORITIES.