

| TREE SCHEDULE 2140 BASELINE ROAD MULTI UNIT RESIDENTIAL | | | | | | | | | |
|---|----------|----------------|--------------------------------|-------------------------|------------------|---|--------|---|--------------|
| CODE | QUANTITY | BOTANICAL NAME | COMMON NAME | B&B SPECIMEN | NATIVE TO CANADA | FORECASTED SPREAD as per City Ottawa Forestry | | Canopy Cover Contribution/Tree in Square Metres | |
| | PRIVATE | PUBLIC | | | | DIAMETER | RADIUS | | |
| AC | 0 | 3 | Amelanchier canadensis | Tree Serviceberry | 50mm cal | YES | 3.0 m | 1.5m | 7.0 sq. m. |
| AR | 1 | 0 | Acer rubrum | Red Maple | 60mm cal | YES | 10.0 m | 5.0m | 78.5 sq. m. |
| AS | 1 | 0 | Acer saccharum | Sugar Maple | 60mm cal | YES | 14.0 m | 7.0m | 154.0 sq. m. |
| CO | 0 | 1 | Celtis occidentalis | Common Hackberry | 50mm cal | YES | 14.0 m | 7.0m | 154.0 sq. m. |
| GB | 2 | 0 | Ginkgo biloba Princeton Sentry | Princeton Sentry Ginkgo | 60mm cal | YES | 10.0 m | 5.0m | 78.5 sq. m. |
| QM | 0 | 1 | Quercus macrocarpa | Bur Oak | 50mm cal | YES | 14.0 m | 7.0m | 154.0 sq. m. |
| SR | 0 | 3 | Syringa reticulata | Japanese Tree Lilac | 50mm cal | YES | 3.0 m | 1.5m | 7.0 sq. m. |
| VL | 0 | 3 | Viburnum lentago | Nannyberry | 50mm cal | YES | 3.0 m | 1.5m | 7.0 sq. m. |
| TOTALS | | | | | | | | | |
| AB | 1 | 0 | Abies balsamea | Balsam Fir | 1.5m Ht. | YES | 5.0m | 2.5m | 20.0 sq. m. |
| PG | 1 | 0 | Picea glauca | White Spruce | 1.5m Ht. | YES | 5.0m | 2.5m | 20.0 sq. m. |
| PS | 1 | 0 | Pinus strobus | White Pine | 1.5m Ht. | YES | 10.0m | 5.0m | 78.5 sq. m. |

TREE CANOPY CALCULATION AS PER EVOLVING CITY OF OTTAWA REQUIREMENTS:

TOTAL SITE AREA: 3 180 SQ. M.

CALCULATIONS FOR TREE CANOPY

Proposed Trees (Areas of Polygons Hatched in Green, Excluding Overlap.)

TOTAL CANOPY COVER 750 + 42 = 792 SQ. M.

CANOPY COVER AS % OF SITE 792/ 3180 = 25 %

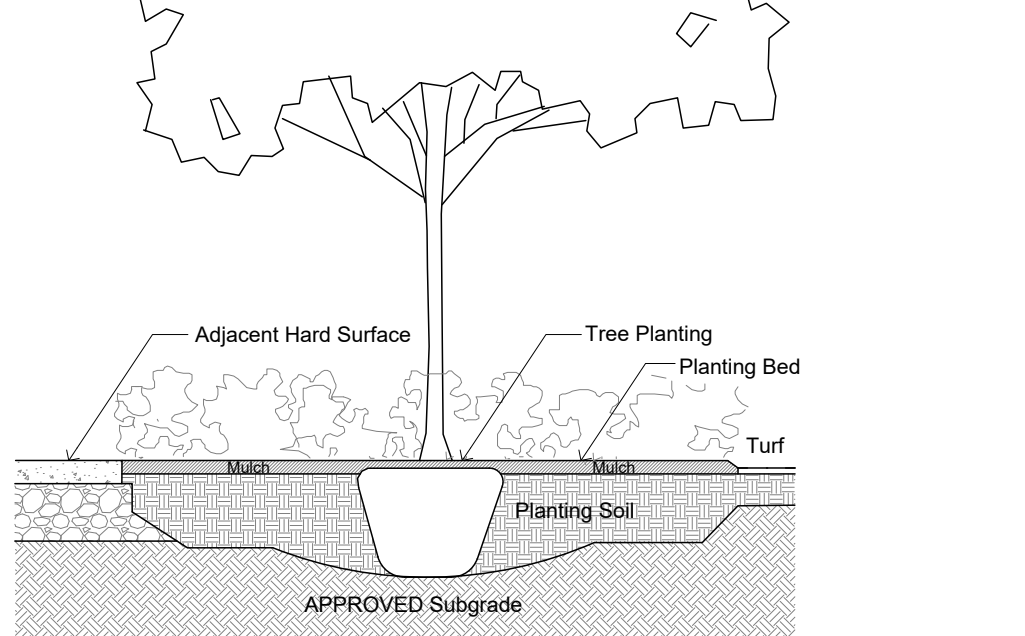

TREE PLANTING IN PLANTING BED NTS

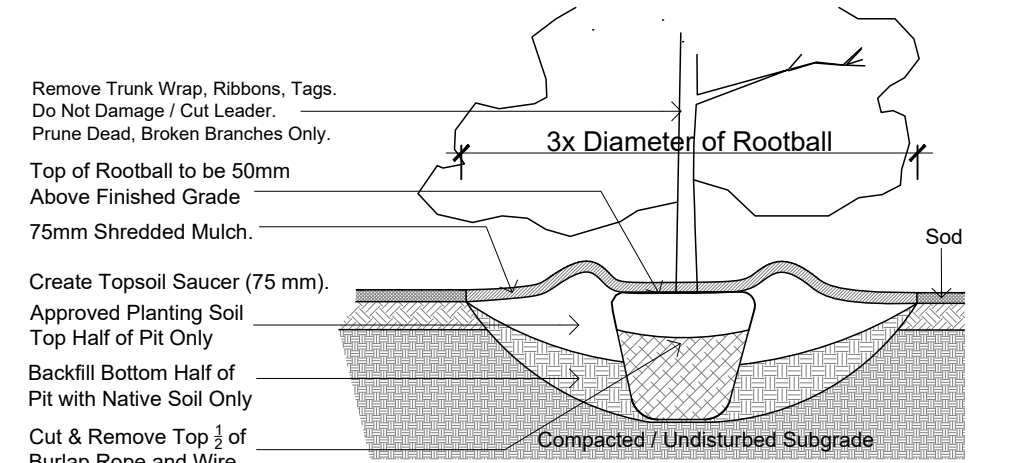
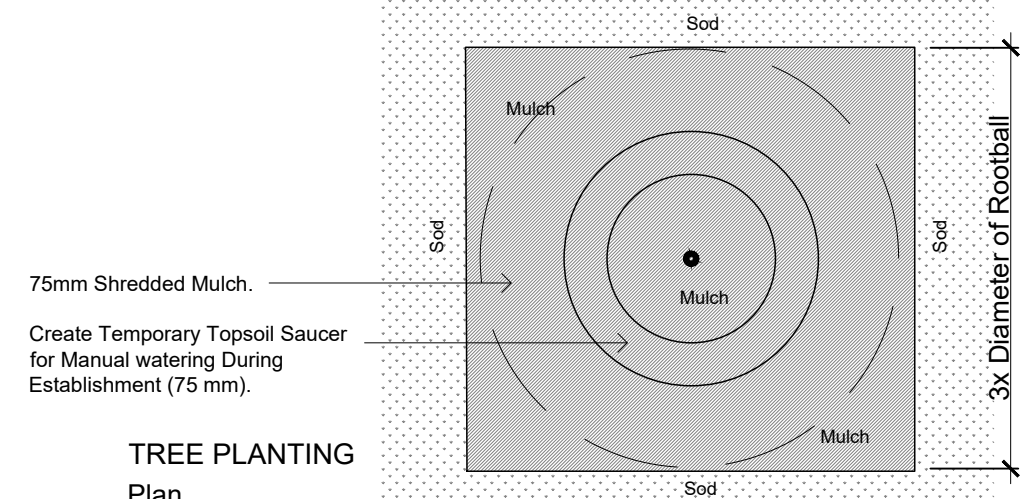

TREE PLANTING Section NTS

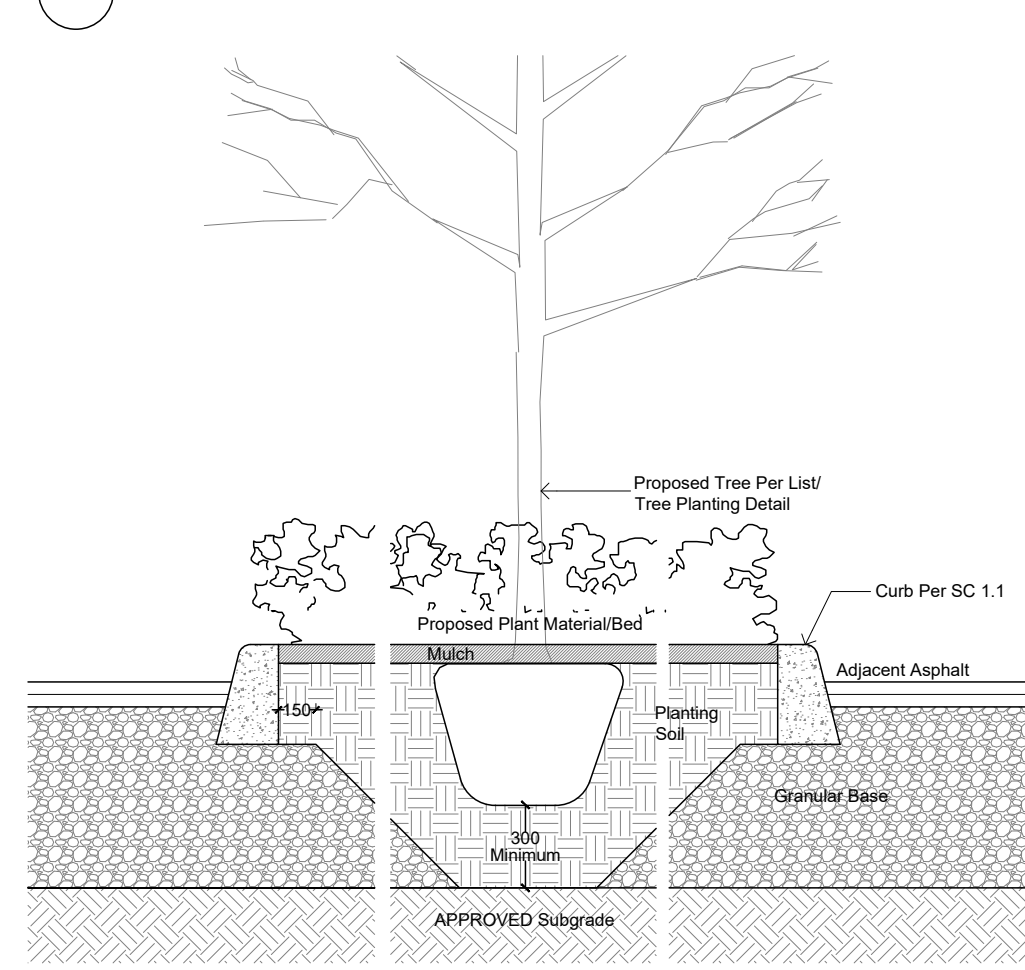

| Plant List - Shrubs - Apartment Building 2140 Baseline Road | | | | |
|---|------|---------------------|-----------------|-----------|
| Code | Qty. | Botanical Name | Common Name | Condition |
| HK | 365 | Hypericum kalmianum | St. John's Wort | Pot |
| SA | 215 | Spiraea alba | Meadowsweet | Pot |

During Excavation/Bed Preparation if Extreme Conditions are Encountered (Water, Rock, Gravel...) Notify GJA INC Immediately.

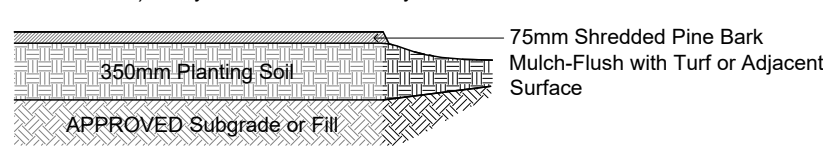

TYPICAL PLANTING BED NTS

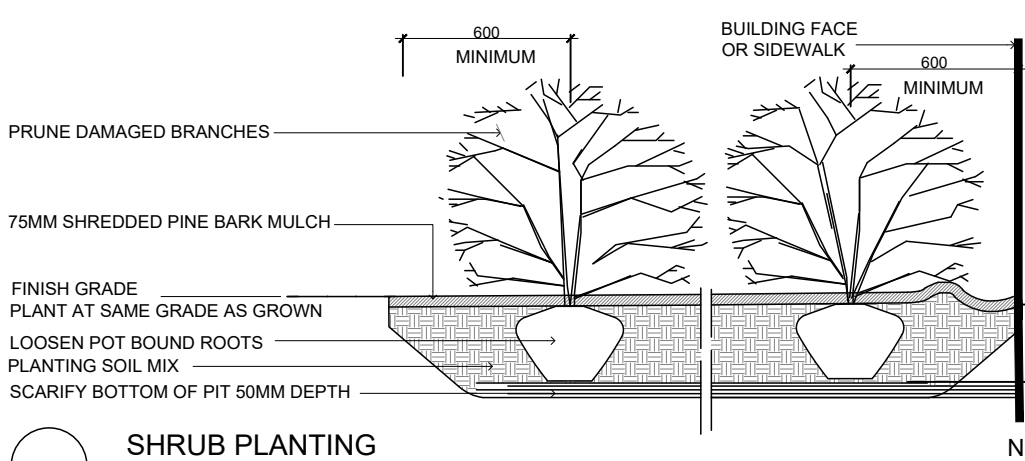

SHRUB PLANTING NTS

APPROVED
By Kersten Nitsche at 11:10 am, Nov 08, 2024

Kersten Nitsche

**KERSTEN NITSCHKE, MCIP RPP
MANAGER (A), DEVELOPMENT REVIEW WEST
PLANNING, DEVELOPMENT AND BUILDING SERVICES
DEPARTMENT, CITY OF OTTAWA**

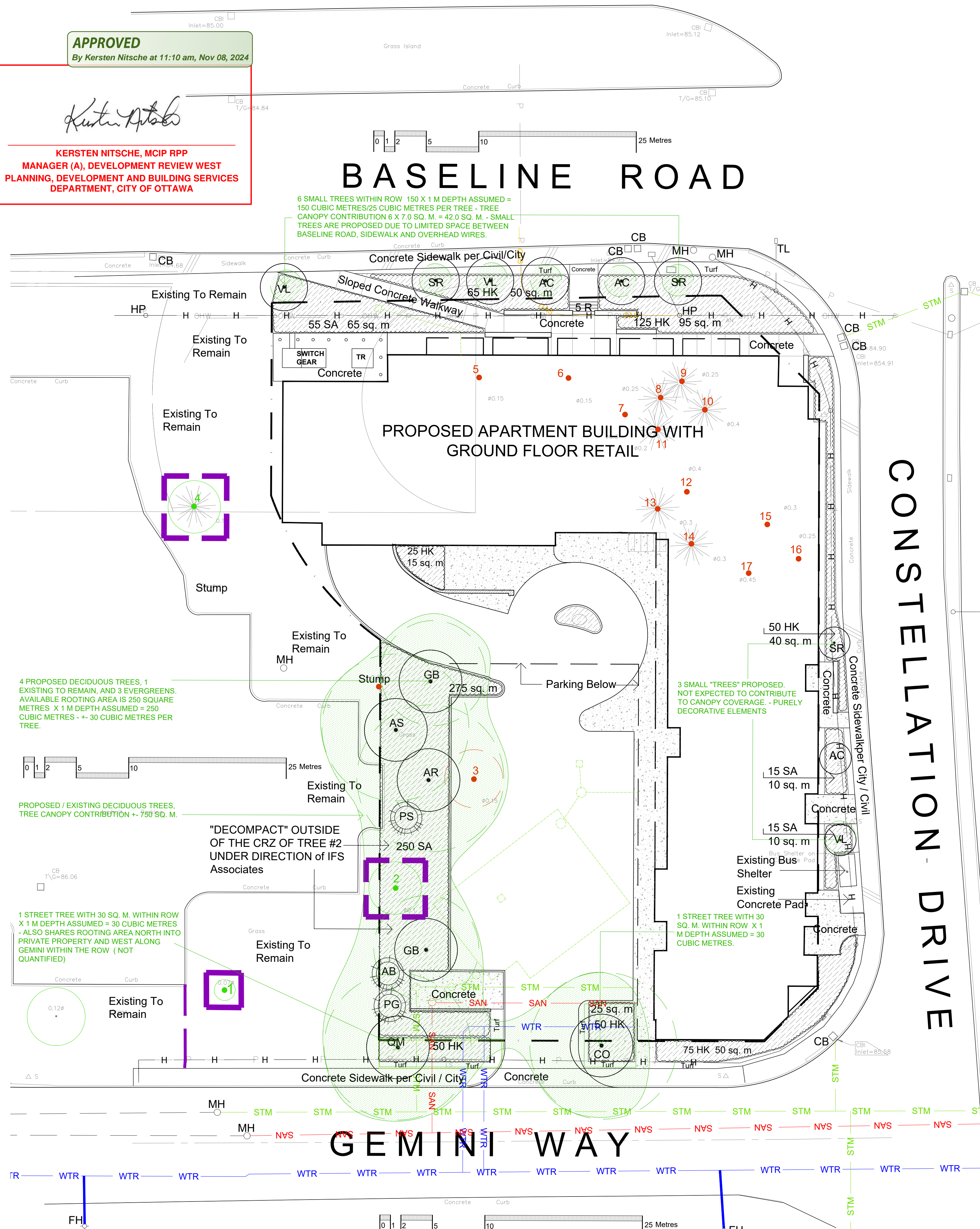

6 SMALL TREES WITHIN ROW 150 X 1 M DEPTH ASSUMED = 150 CUBIC METRES/25 CUBIC METRES PER TREE - TREE CANOPY CONTRIBUTION 6 X 7.0 SQ. M. = 42.0 SQ. M. - SMALL TREES ARE PROPOSED DUE TO LIMITED SPACE BETWEEN BASELINE ROAD, SIDEWALK AND OVERHEAD WIRES.

**PROPOSED APARTMENT BUILDING WITH
GROUND FLOOR RETAIL**

4 PROPOSED DECIDUOUS TREES, 1 EXISTING TO REMAIN, AND 3 EVERGREENS. AVAILABLE ROOTING AREA IS 250 SQUARE METRES X 1 M DEPTH ASSUMED = 250 CUBIC METRES - 30 CUBIC METRES PER TREE.

3 SMALL "TREES" PROPOSED. NOT EXPECTED TO CONTRIBUTE TO CANOPY COVERAGE - PURELY DECORATIVE ELEMENTS

PROPOSED / EXISTING DECIDUOUS TREES. TREE CANOPY CONTRIBUTION + 750 SQ. M.

"DECOMPACT" OUTSIDE OF THE CRZ OF TREE #2 UNDER DIRECTION OF IFS Associates

1 STREET TREE WITH 30 SQ. M. WITHIN ROW X 1 M DEPTH ASSUMED = 30 CUBIC METRES - ALSO SHARES ROOTING AREA NORTH INTO PRIVATE PROPERTY AND WEST ALONG GEMINI WITHIN THE ROW (NOT QUANTIFIED)

1 STREET TREE WITH 30 SQ. M. WITHIN ROW X 1 M DEPTH ASSUMED = 30 CUBIC METRES.

Drawing Remains the Property of/Copyright Reserved by Gino J. Aiello Landscape Architect. Do Not Use or Reproduce Without Approval of Gino J. Aiello.
NOT To Be Used For Construction Unless Indicated by Revision: "FOR LANDSCAPE CONSTRUCTION"
Contractor is Responsible for Verification of Site Locations of all Utilities. Report any Discrepancies Between Site and Drawing Immediately to Gino J. Aiello. Do Not Proceed Until Clarified.
TURF AREAS TO BE SOD CW 150MM DEPTH TOPSOIL ON APPROVED SUBGRADE | SOD TO BE #1 GRADE TURFGRASS NURSERY SOD per NSGA - Fine Fescue/Kentucky Bluegrass Sod | PLANTING MIX TO BE APPROVED BY LANDSCAPE ARCHITECT | PLANT MATERIAL TO MEET CNLA STANDARDS/BE APPROVED BY LANDSCAPE ARCHITECT PRIOR TO PLANTING ALL MATERIALS & WORK TO BE MAINTAINED UNTIL FINAL ACCEPTANCE, (MOWING, TURF WEEDING BEDS, WATERING TURF & PLANTS) & INCLUDE 1 YEAR WARRANTY FROM DATE OF FINAL ACCEPTANCE | PROVIDE WATERING OF ALL PLANT MATERIAL AS REQUIRED FOR PROPER ESTABLISHMENT, UNTIL END OF WARRANTY PERIOD | REFER TO CIVIL ENGINEER'S DRAWING FOR ELEVATIONS / GRADING |
The Landscape Plan is to be read in conjunction with the grading, servicing, site and survey plan | Bare root material to be planted in season only | All plant material locations to be staked on site by the landscape contractor and checked by the landscape architect prior to planting | All trees to be preserved on or directly adjacent to the site will be protected | Plant material are to be installed a minimum of 3.0m away from any part of any hydro transformer, 3.0m corridor between a fire hydrant and the curb, a 2.5m radius beside or behind a fire hydrant, 2.0m from any servicing utility line or structure |

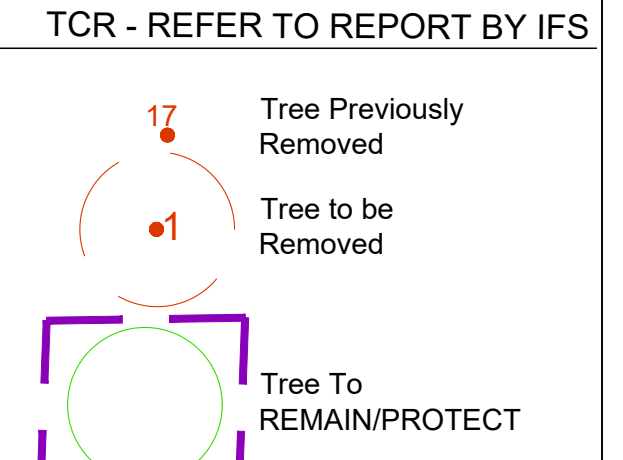

LANDSCAPE PLAN LEGEND

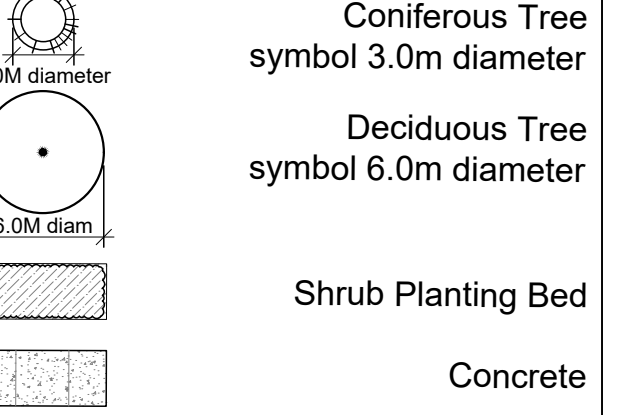

TCR - REFER TO REPORT BY IFS

| # | Revision | Date |
|---|--------------------------------|------------|
| 5 | per CITY Forestry Comments | 2024 10 21 |
| 4 | per CITY Forestry Comments | 2024 10 15 |
| 3 | per CITY COMMENTS | 2024 10 03 |
| 2 | per Latest TCR JULY 15 2024 | 2024 08 02 |
| 1 | per Latest Site/Civil/Boundary | 2024 05 14 |

Baseline Constellation Property Inc.

GJA INC.
GINO J. AIELLO | LANDSCAPE ARCHITECT
GJALA.COM | 613 298 5130 | GINO@GJALA.COM
100 DEBBY ROAD UNIT # 11 OTTAWA ONTARIO K1P 1G2

APARTMENT BUILDING
2140 BASELINE ROAD

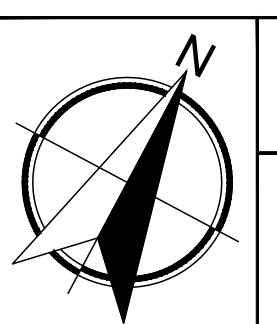

Landscape Plan
L1
Scale: 1:200

D07-12-18-0084