

SURVEYOR'S REAL PROPERTY REPORT
PART 1 Plan of
PART OF LOTS 49 AND 50
REGISTERED PLAN 86
CITY OF OTTAWA

Surveyed by Annis, O'Sullivan, Vollebakk Ltd.

Scale 1 : 200
8.0 6.0 4.0 2.0 0 4 8 Metres

Metric
DISTANCES SHOWN ON THIS PLAN ARE IN METRES AND
CAN BE CONVERTED TO FEET BY DIVIDING BY 0.3048

Surveyor's Certificate
I CERTIFY THAT :
1. This survey and plan are correct and in accordance with the Surveys
Act and the Surveyors Act and the regulations made under them.
2. The survey was completed on the 13th day of July, 2023.

July 27, 2023
Date
E. H. Henveyer
Ontario Land Surveyor

PART 2
THIS PLAN MUST BE READ IN CONJUNCTION WITH
SURVEY REPORT DATED: July 27, 2023

ANNIS, O'SULLIVAN, VOLLEBEKK LTD. grants to
2701292 Ontario Ltd. ("The Client"), their solicitors,
mortgagees, and other related parties, permission to use original, signed, sealed
copies of the Surveyor's Real Property Report in transactions involving The Client.

Notes & Legend

Denotes	
□	Survey Monument Planted
■	Survey Monument Found
SIB	Standard Iron Bar
SSIB	Short Standard Iron Bar
IB	Iron Bar
WIT	Witness
Meas.	Measured
Calc	Calculated
(AOG)	Annis, O'Sullivan, Vollebakk Ltd.
(PI)	Registered Plan 86
(P2)	(AOG) Plan Dated August 25, 2016
(P3)	Plan 5R-1540
(P4)	Plan 5R-1141
(P5)	(647) Plan Dated August 7, 1963
(P6)	(647) Plan Dated July 30, 1969
(P7)	(990) Plan Dated August 24, 1973
(NI)	(647) Notes Dated December 2, 1969
(DI)	Inst. CT116213
○ MH-ST	Maintenance Hole (Storm Sewer)
○ MH-S	Maintenance Hole (Sanitary)
— ST —	Underground Storm Sewer
— S —	Underground Sanitary Sewer
— W —	Underground Water
— G —	Underground Gas
— OHW —	Overhead Wires
○ UP	Utility Pole
CSP	Corrugated Steel Pipe
⊗ WV	Water Valve
Inv.	Invert
T/G	Top of Grate
⊗	Gas Meter
⊗	Hydro Meter
⊗ AC	Air Conditioner
CLF	Chain Link Fence
PWF	Post and Wire
TOS	Top of Slope
C/L	Centreline
Δ S	Sign
Ø	Diameter
+ 65.00	Location of Elevations
EG	Edge of Gravel
T/P	Top of Pipe

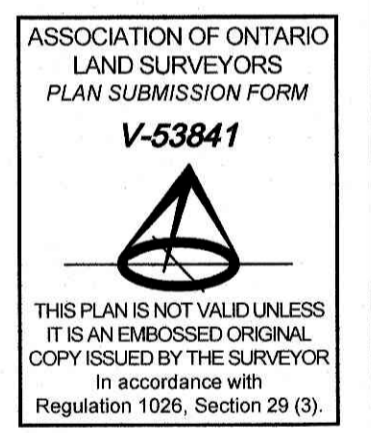

SITE AREA = 862.6 m²

Bearings are grid, derived from Can-Net 2016 Real Time Network
GPS observations, and are referenced to specified control points
01919680184 and 019198434761, MTM Zone 9 (76°30' West
Longitude) NAD-83 (original).

For bearing comparison, a rotation of 0°01'10" clockwise was applied
to bearings on P3 and a rotation of 0°01'25" clockwise was applied to
bearings on P4.

UTILITY NOTES

1. This drawing cannot be accepted as acknowledging all of the utilities
and it will be the responsibility of the user to contact the respective
utility authorities for confirmation.
2. Only visible surface utilities were located.
3. A field location of underground plant by the pertinent utility authority
is mandatory before any work involving breaking ground, probing,
excavating etc.
4. Underground Utility information compiled from City of Ottawa Utility
sheet reference: C-31-24, C-31-18, Drawing No. 70-1677-01-12 and
Drawing No. 98082-P2.

ELEVATION NOTES

1. Elevations shown are derived from City of Ottawa monument No.
2016-0027 having an elevation of 61.165 metres referred to the
CGVD28 geodetic datum.
2. It is the responsibility of the user of this information to verify that the
job benchmark has not been altered or disturbed and that its relative
elevation and description agrees with the information shown on this
drawing.