

Copyright Reserved

The Contractor shall verify and be responsible for all dimensions. DO NOT scale the drawing - any errors or omissions shall be reported to Stantec without delay. The Copyrights to all designs and drawings are the property of Stantec. Reproduction or use for any purpose other than that authorized by Stantec is forbidden.

Legend

Notes

GENERAL NOTES AND SPECIFICATIONS

- ALL MATERIALS AND CONSTRUCTION METHODS TO BE IN ACCORDANCE WITH OPS AND CITY OF OTTAWA STANDARD SPECIFICATIONS AND DRAWINGS AND OPSD SUPPLEMENT. ONTARIO PROVINCIAL STANDARDS WILL APPLY WHERE NO CITY STANDARDS ARE AVAILABLE.
- THE CONTRACTOR IS RESPONSIBLE FOR OBTAINING ALL PERMITS REQUIRED AND BEAR COST OF SAME INCLUDING WATER PERMIT AND ASSOCIATED COSTS.
- SERVICE AND UTILITY LOCATIONS ARE APPROXIMATE. CONTRACTOR TO VERIFY LOCATION AND ELEVATION OF EXISTING SERVICES AND UTILITIES PRIOR TO CONSTRUCTION. CONTRACTOR SHALL BE RESPONSIBLE FOR OBTAINING LOCATES FROM ALL UTILITY COMPANIES TO LOCATE EXISTING UTILITIES PRIOR TO EXCAVATION. THE CONTRACTOR IS RESPONSIBLE FOR PROTECTION AND REINSTATEMENT.
- ALL DISTURBED AREAS SHALL BE REINSTATED TO EQUAL OR BETTER CONDITION TO THE SATISFACTION OF THE ENGINEER & THE CITY. PAVEMENT REINSTATEMENT FOR SERVICE AND UTILITY CUTS SHALL BE IN ACCORDANCE WITH OPSD 509.010, OPS5 310, AND CITY OF OTTAWA R10.
- ALL WORK SHALL BE COMPLETED IN ACCORDANCE WITH THE "OCCUPATIONAL HEALTH AND SAFETY ACT AND REGULATION FOR CONSTRUCTION PROJECTS". THE GENERAL CONTRACTOR SHALL BE DEEMED TO BE THE CONSTRUCTOR AS DEFINED IN THE ACT.
- WHERE EC PLANS ARE NOT FOLLOWED, OR ARE FOUND TO PROVIDE INSUFFICIENT PROTECTION, THE CONTRACTOR SHALL SUBMIT AN EROSION AND SEDIMENTATION CONTROL PLAN THAT WILL IMPLEMENT BEST MANAGEMENT PRACTICES TO PROVIDE PROTECTION FOR RECEIVING STORM SEWERS OR DRAINAGE DURING CONSTRUCTION ACTIVITIES. THIS PLAN SHALL INCLUDE BUT NOT BE LIMITED TO CATCH BASIN INSERTS, STRAW BALE CHECK DAMS AND SEDIMENT CONTROLS AROUND ALL DISTURBED AREAS. DEWATERING SHALL BE PUMPED INTO SEDIMENT TRAPS.
- SITE PLAN PREPARED BY: NEUF ARCHITECTS, DRAWING TITLED SITE PLAN, DATED 2024-01-01 REV 1 DATED 2024.07.19, PROJECT No. 13264.
- TOPOGRAPHIC SURVEY SUPPLIED BY J.D.BARNES LIMITED. TOPOGRAPHIC DETAIL OF PART OF LOT 14, CONCESSION 3 (RIDEAU FRONT) CITY OF OTTAWA.
- REFER TO LANDSCAPE ARCHITECTURE PLAN FOR ALL LANDSCAPING FEATURES (e. TREES, WALKWAYS, PARK DETAILS, NOISE BARRIERS, FENCES etc.)
- GEOTECHNICAL INVESTIGATION PREPARED BY PATERSON GROUP, DATED MARCH 6, 2019, TITLED PROPOSED RESIDENTIAL DEVELOPMENT, 3288 GREENBANK ROAD- OTTAWA, REPORT No. PG2745 REVISION 2. GEOTECHNICAL INFORMATION PRESENTED ON THESE DRAWINGS MAY BE INTERPOLATED FROM THE ORIGINAL REPORT. REFER TO ORIGINAL GEOTECHNICAL REPORT FOR ADDITIONAL DETAILS AND TO VERIFY ASSUMPTIONS MADE HEREIN.
- STREET LIGHTING TO CITY OF OTTAWA STANDARDS.
- ALL DIMENSIONS ARE IN METRES UNLESS OTHERWISE STATED. DIMENSIONS SHALL BE CHECKED AND VERIFIED IN THE FIELD BY THE CONTRACTOR PRIOR TO THE START OF CONSTRUCTION. ANY DISCREPANCIES TO BE REPORTED IMMEDIATELY TO ENGINEER.
- THERE WILL BE NO SUBSTITUTION OF MATERIALS UNLESS PRIOR WRITTEN APPROVAL BY THE CONTRACT ADMINISTRATOR AND PROJECT ENGINEER HAS BEEN OBTAINED.
- HERITAGE OPERATIONS UNIT OF THE ONTARIO MINISTRY OF CULTURE TO BE NOTIFIED IF DEEPLY BURIED ARCHEOLOGICAL REMAINS ARE FOUND ON THE PROPERTY DURING CONSTRUCTION ACTIVITIES.

ROADWORKS

- ALL TOPSOIL AND ORGANIC MATERIAL TO BE STRIPPED FROM WITHIN THE FULL RIGHT OF WAY PRIOR TO CONSTRUCTION.
- SUB-EXCAVATE SOFT AREAS & FILL WITH GRANULAR 'B' COMPACTED IN 0.30m LAYERS.
- ALL GRANULAR FOR ROADS SHALL BE COMPACTED TO A MINIMUM OF 98% STANDARD PROCTOR MAXIMUM DRY DENSITY (SPMDD).
- ROAD SUBDRAINS SHALL BE CONSTRUCTED AS PER CITY OF OTTAWA STANDARD R1.
- ASPHALT WEAR COURSE SHALL NOT BE PLACED UNTIL THE VIDEO INSPECTION OF SEWERS & NECESSARY REPAIRS HAVE BEEN CARRIED OUT TO THE SATISFACTION OF THE CONSULTANT.
- CONTRACTOR TO OBTAIN A ROAD OCCUPANCY PERMIT 48 HOURS PRIOR TO COMMENCING ANY WORK WITHIN THE MUNICIPAL ROAD ALLOWANCE IF REQUIRED BY THE MUNICIPALITY. ALL WORK ON THE MUNICIPAL RIGHT OF WAY AND EASEMENTS TO BE INSPECTED BY THE MUNICIPALITY PRIOR TO BACKFILLING.
- PAVEMENT REINSTATEMENT FOR SERVICE AND UTILITY CUTS SHALL BE IN ACCORDANCE WITH CITY OF OTTAWA STANDARD R10, AND OPSD 509.010, AND OPS5 310.
- CONCRETE CURBS SHALL BE CONSTRUCTED AS PER CITY STANDARD SC1.1 AND SC1.3 (BARRIER OR MOUNTABLE CURB AS SHOWN ON DRAWINGS).
- CONCRETE SIDEWALKS SHALL BE CONSTRUCTED AS PER CITY STANDARDS SC3 AND SC1.4.

PAVEMENT CONSTRUCTION AS PER GEOTECHNICAL INVESTIGATION BY PATERSON GROUP, TITLED PROPOSED RESIDENTIAL DEVELOPMENT 3288 GREENBANK ROAD - OTTAWA, DATED MARCH 6, 2019, REPORT No. PG2743-2.

LOCAL RESIDENTIAL ROADWAYS

- 40mm SUPERPAVE 12.5
- 50mm SUPERPAVE 19.0 BINDER COURSE
- 150 OPSS GRANULAR 'A' BASE
- 400 OPSS GRANULAR 'B' TYPE II

ROADWAYS WITH BUS TRAFFIC

- 40mm SUPERPAVE 12.5
- 50mm SUPERPAVE 19.0 UPPER BINDER COURSE
- 50mm SUPERPAVE 19.0 LOWER BINDER COURSE
- 150mm OPSS GRANULAR 'A' BASE
- 600mm OPSS GRANULAR 'B' TYPE II

CAR PARKING AREAS

- 50mm WEAR COURSE - HL 3 OR SP 12.5 ASPHALTIC CONCRETE
- 150mm OPSS GRANULAR 'A' BASE
- 300mm OPSS GRANULAR 'B' TYPE II

WATER SUPPLY SERVICING

- THE CONTRACTOR SHALL CONSTRUCT WATERMAIN, WATER SERVICES, CONNECTIONS & APPURTENANCES AS PER CITY OF OTTAWA SPECIFICATIONS & SHALL CO-ORDINATE AND PAY ALL RELATED COSTS INCLUDING THE COST OF CONNECTION, INSPECTION & DISINFECTION BY CITY PERSONNEL.

- WATERMAIN PIPE MATERIAL SHALL BE PVC CL.150 DR18. DEFLECTION OF WATERMAIN PIPE IS NOT TO EXCEED 1/2 OF THAT SPECIFIED BY THE MANUFACTURER. PVC WATERMANS TO BE INSTALLED WITH TRACER WIRE IN ACCORDANCE WITH CITY OF OTTAWA STANDARD W36.
- WATER SERVICES ARE TO BE PEX TUBING AS PER CITY OF OTTAWA STANDARD W26 UNLESS OTHERWISE NOTED. WATER SERVICE TO EXTEND 2.0m BEYOND PROPERTY LINE. STAND POST TO BE INSTALLED AT PROPERTY LINE. ROLL OF PEX MIN 8m LONG TO BE LEFT. NOTE: 20mm INSIDE DIAMETER REQUIRED
- FIRE HYDRANTS TO BE INSTALLED AS PER CITY OF OTTAWA STANDARDS W18 AND W19.
- WATER VALVES TO BE INSTALLED AS PER CITY OF OTTAWA STANDARD W24.
- WATERMAIN TRENCH AND BEDDING SHALL BE IN ACCORDANCE WITH CITY OF OTTAWA STD. W17 UNLESS OTHERWISE SPECIFIED. BEDDING AND COVER MATERIAL TO BE SPECIFIED BY PROJECT GEOTECHNICAL CONSULTANT.
- SERVICE CONNECTIONS SHALL BE INSTALLED A MINIMUM OF 2400mm FROM ANY CATCH-BASIN, MANHOLE, OR OBJECT THAT MAY CONTRIBUTE TO FREEZING. THERMAL INSULATION SHALL BE INSTALLED ON ALL PROPOSED CBS ON THE W/M STREET SIDE WHERE 2400mm SEPARATION CANNOT BE ACHIEVED (AS PER CITY OF OTTAWA W22 & W23)
- CATHODIC PROTECTION TO BE SUPPLIED ON METALLIC FITTINGS AS PER CITY OF OTTAWA W40 AND W42.
- THRUST BLOCKS TO BE INSTALLED AS PER CITY OF OTTAWA STANDARDS W25.3 AND W25.4.
- WATERMAIN TO HAVE MIN. 2.4m COVER. WHERE WATERMAIN COVER IS LESS THAN 2.4m, INSULATION TO BE SUPPLIED IN ACCORDANCE WITH CITY STANDARD W22.
- WATERMAIN CROSSINGS ABOVE AND BELOW SEWERS TO BE INSTALLED AS PER CITY OF OTTAWA STANDARD W25 AND W25.2.
- PRESSURE REDUCING VALVES (PRV'S) ON ALL UNITS TO BE INSTALLED AS PER ONTARIO PLUMBING CODE.

STORM AND SANITARY SEWERS

- STORM AND SANITARY SEWERS 375mm DIA. OR SMALLER SHALL BE PVC SDR35. SANITARY SEWERS LARGER THAN 375mm SHALL BE CONCRETE CSA A 257.2 CLASS 1000 AS PER OPSD 807.010.
- ALL STORM AND SANITARY SEWER BEDDING SHALL BE INSTALLED AS PER CITY OF OTTAWA STANDARDS S6 AND S7, CLASS 'B' BEDDING, UNLESS OTHERWISE NOTED. SUITABLE BEDDINGS AND COVER MATERIAL TO BE SPECIFIED BY GEOTECHNICAL CONSULTANT.
- STORM AND SANITARY MANHOLES SHALL BE 1200mm DIAMETER IN ACCORDANCE WITH OPSD-701.01 (UNLESS OTHERWISE NOTED) c/w FRAME AND COVER AS PER CITY OF OTTAWA S24, S24.1, AND S25 WHERE APPLICABLE. CATCH BASIN MANHOLE FRAME AND COVERS PER S19, S28, AND S28.1 WHERE APPLICABLE. ALL STORM MANHOLES WITH SEWERS 900mm DIA SEWERS AND OVER IN SIZE SHALL BE BENCHED. ALL OTHER STORM MANHOLES SHALL BE COMPLETED WITH 300mm SUMPS AS PER CITY STANDARDS. SANITARY MANHOLES SHALL NOT HAVE SUMPS.
- ALL SEWERS CONSTRUCTED WITH GRADES 0.50% OR LESS TO BE INSTALLED WITH LASER AND CHECKED WITH LEVEL INSTRUMENT PRIOR TO BACKFILLING.
- FOR STORM SEWER INSTALLATION (EXCLUDING CB LEADS) THE MINIMUM DEPTH OF COVER OVER THE CROWN OF THE SEWER IS 2.0m. FOR SANITARY SEWERS THE MINIMUM DEPTH OF COVER IS 2.5m OVER PIPE OBVERT.
- ALL STORM AND SANITARY SERVICES TO BE EQUIPPED WITH APPROVED BACKWATER VALVES AS PER CITY STANDARD (S14, S14.1, AND S14.2).
- STORM AND SANITARY SERVICE LATERALS TO BE SDR 28 INSTALLED AT MIN. 1.0% SLOPE. SINGLE STORM SERVICES TO BE 100mmØ, SINGLE SANITARY SERVICES TO BE 135mmØ. (SERVICES TO EXTEND 2.0m BEYOND PROPERTY LINE)
- CATCH BASINS SHALL BE INSTALLED IN ACCORDANCE WITH CITY STANDARDS S1, S2, S3 c/w FRAME AND GRATE AS PER S19, CURB INLET FRAME AND GRATE PER S22 AND S23. PROVIDE 150mm ADJUSTED SPACERS. ALL CATCH BASINS SHALL HAVE SUMPS (600mm DEEP). STREET CATCH BASIN LEADS SHALL BE 200mm DIA. (MIN) PVC SDR 35 AT 1.0% GRADE WHERE NOT OTHERWISE SHOWN ON PLAN. CATCH BASINS WILL BE INSTALLED WITH INLET CONTROL DEVICES (ICD) AS PER ICD SCHEDULE ON STORM DRAINAGE PLAN.
- STREET CATCH BASINS TO BE INSTALLED c/w SUBDRAINS 3m LONG IN FOUR ORTHOGONAL DIRECTIONS OR LONGITUDINALLY WHEN PLACED ALONG A CURB, AND AT AN ELEVATION OF 300mm BELOW SUBGRADE LEVEL.
- REAR LOT PERFORATED PIPE TO BE INSTALLED AS PER CITY OF OTTAWA STANDARDS S29. REAR LOT STRUCTURES TO BE INSTALLED AS PER CITY OF OTTAWA STANDARD W30 AND W31.
- CLAY SEALS TO BE INSTALLED AS PER CITY STANDARD DRAWING S8. THE SEALS SHOULD BE AT LEAST 1.5m LONG (IN THE TRENCH DIRECTION) AND SHOULD EXTEND FROM TRENCH WALL TO TRENCH WALL. GENERALLY, THE SEALS SHOULD EXTEND FROM THE FROST LINE AND FULLY PENETRATE THE BEDDING, SUBBEDDING AND COVER MATERIAL. THE BARRIERS SHOULD CONSIST OF RELATIVELY DRY AND COMPACTABLE BROWN SILTY CLAY PLACED IN MAXIMUM 225mm THICK LOOSE LAYERS COMPACTED TO A MINIMUM OF 95% OF THE MATERIAL'S SPMDD. THE CLAY SEALS SHOULD BE PLACED AT THE SITE BOUNDARIES AND AT STRATEGIC LOCATIONS AT NO MORE THAN 60m INTERVALS IN THE SERVICE TRENCHES. FOR DETAILS REFER TO GEOTECHNICAL INVESTIGATION.
- GRANULAR 'A' SHALL BE PLACED TO A MINIMUM THICKNESS OF 300 mm AROUND ALL STRUCTURES WITHIN PAVEMENT AREA AND COMPACTED TO A MINIMUM OF 98% STANDARD PROCTOR DENSITY.
- CONTRACTOR SHALL PERFORM LEAKAGE TESTING, IN THE PRESENCE OF THE CONSULTANT, FOR SANITARY SEWERS IN ACCORDANCE WITH OPS5 410 AND OPS5 407. CONTRACTOR SHALL PERFORM VIDEO INSPECTION OF ALL STORM AND SANITARY SEWERS. A COPY OF THE VIDEO AND INSPECTION REPORT SHALL BE SUBMITTED TO THE CONSULTANT FOR REVIEW.
- ANY SEWER ABANDONMENT TO BE CONDUCTED ACCORDING TO CITY OF OTTAWA STANDARD S11.4

GRADING

- ALL GRANULAR BASE & SUB BASE COURSE MATERIALS SHALL BE COMPACTED TO 98% STANDARD PROCTOR MAX. DRY DENSITY.
- SUB-EXCAVATE SOFT AREAS & FILL WITH GRANULAR 'B' COMPACTED IN 0.30m LAYERS.
- ALL DISTURBED GRASSSED AREAS SHALL BE RESTORED TO ORIGINAL CONDITION OR BETTER. WITH 500 ON MIN. 100mm TOPSOIL. THE RELOCATION OF TREES AND SHRUBS SHALL BE SUBJECT TO APPROVAL BY THE PROJECT LANDSCAPE ARCHITECT OR ENGINEER.

- 100 YEAR PONDING DEPTH TO BE 0.35m (MAXIMUM).
- EMBANKMENTS TO BE SLOPED AT MIN. 3:1, UNLESS OTHERWISE SPECIFIED.
- ALL SWALES TO BE CONSTRUCTED AS PER CITY STANDARD S29.
- ALL ROOF DOWNSPOUTS TO DISCHARGE TO THE GROUND ONTO SPLASH PADS AND SHALL NOT BE DIRECTED TO THE STORM SEWER, OR THE BUILDING FOUNDATION DRAIN.
- TOP OF GRATE (TIG) ELEVATIONS FOR ALL STREET CATCHBASINS SHOWN ON PLANS. REFER TO THE ELEVATION AT EDGE OF PAVEMENT, OR GUTTERLINE WHERE APPLICABLE.
- ALL RETAINING WALLS GREATER THAN 1.0m IN HEIGHT ARE TO BE DESIGNED, APPROVED, AND STAMPED BY STRUCTURAL ENGINEER.
- FENCES OR RAILINGS ARE REQUIRED FOR RETAINING WALLS GREATER THAN 0.60m IN HEIGHT.
- EXCESS EXCAVATED MATERIAL SHALL BE REMOVED FROM THE SITE.
- ALL NECESSARY CLEARING AND GRUBBING SHALL BE COMPLETED BY THE CONTRACTOR. REVIEW WITH CONTRACT ADMINISTRATOR AND THE CITY OF OTTAWA PRIOR TO TREE CUTTING.
- REFER TO DRAWING EC-1 FOR EROSION AND SEDIMENT CONTROL DETAILS.

Best Management Practices

CONTRACTOR TO PROVIDE EROSION AND SEDIMENT CONTROLS (BEST MANAGEMENT PRACTICES) DURING CONSTRUCTION OF THIS PROJECT. THE CONTRACTOR SHALL IMPLEMENT BEST MANAGEMENT PRACTICES, TO PROVIDE FOR PROTECTION OF THE AREA DRAINAGE SYSTEM AND THE RECEIVING WATERCOURSE, DURING CONSTRUCTION ACTIVITIES. THE CONTRACTOR ACKNOWLEDGES THAT FAILURE TO IMPLEMENT APPROPRIATE EROSION AND SEDIMENT CONTROL MEASURES MAY BE SUBJECT TO PENALTIES IMPOSED BY ANY APPLICABLE REGULATORY AGENCY.

EROSION MUST BE MINIMIZED AND SEDIMENTS MUST BE REMOVED FROM CONSTRUCTION SITE RUN-OFF IN ORDER TO PROTECT DOWNSTREAM AREAS. DURING ALL CONSTRUCTION, EROSION AND SEDIMENTATION SHOULD BE CONTROLLED BY THE FOLLOWING TECHNIQUES:

- LIMIT THE EXTENT OF EXPOSED SOILS AT ANY GIVEN TIME.
- REVEGETATE EXPOSED AREAS AND SLOPES AS SOON AS POSSIBLE.
- MINIMIZE AREA TO BE CLEARED AND GRUBBED.
- PROTECT EXPOSED SLOPES WITH PLASTIC OR SYNTHETIC MULCHES.
- INSTALL CATCH BASIN INSERTS OR EQUIVALENT IN ALL PROPOSED CATCH BASINS AND CATCH BASIN MANHOLES AND IN ALL EXISTING CATCH BASINS THAT WILL RECEIVE RUN-OFF FROM THE SITE.
- A SILT FENCE SHALL BE INSTALLED AROUND THE PERIMETER OF ALL AND ANY STOCKPILES OF MATERIAL TO BE USED OR REMOVED FROM SITE. (LOCATION TO BE DETERMINED)
- A VISUAL INSPECTION SHALL BE DONE DAILY ON SEDIMENT CONTROL MEASURES AND CLEANED OF ANY ACCUMULATED SILT AS REQUIRED. THE DEPOSITS WILL BE DISPOSED OFF SITE AS PER THE REQUIREMENTS OF THE CONTRACT.
- SEDIMENT CONTROL BARRIERS MAY ONLY BE REMOVED TEMPORARILY WITH APPROVAL OF CONTRACT ADMINISTRATOR TO ACCOMMODATE CONSTRUCTION OPERATIONS. ALL AFFECTED BARRIERS MUST BE REINSTATED AT NIGHT WHEN CONSTRUCTION IS COMPLETED. NO REMOVAL WILL OCCUR IF THERE IS A SIGNIFICANT RAINFALL EVENT ANTICIPATED (≥10mm) UNLESS A NEW DEVICE HAS BEEN INSTALLED TO PROTECT EXISTING STORM AND SANITARY SEWER SYSTEMS, OR DOWNSTREAM WATERCOURSES.
- NO REFUELING OR CLEANING OF EQUIPMENT IS PERMITTED NEAR ANY EXISTING WATERWAY.
- CONTRACTOR SHALL REMOVE SEDIMENT CONTROL MEASURES WHEN, IN THE OPINION OF THE CONTRACT ADMINISTRATOR, THE MEASURES IS NO LONGER REQUIRED. NO CONTROL MEASURES SHALL BE PERMANENTLY REMOVED WITHOUT PRIOR WRITTEN AUTHORIZATION FROM THE CONTRACT ADMINISTRATOR.
- THE CONTRACTOR SHALL PERIODICALLY, OR WHEN REQUESTED BY THE CONTRACT ADMINISTRATOR, CLEAN OUT ACCUMULATED SEDIMENTS AS REQUIRED.
- THE CONTRACTOR SHALL IMMEDIATELY REPORT TO THE ENGINEER ANY ACCIDENTAL DISCHARGES OF SEDIMENT MATERIAL INTO THE WATERCOURSE. APPROPRIATE RESPONSE MEASURES, INCLUDING ANY REPAIRS TO EXISTING CONTROL MEASURES OR THE IMPLEMENTATION OF ADDITIONAL CONTROL MEASURES, SHALL BE CARRIED OUT BY THE CONTRACTOR WITHOUT DELAY.
- CONTRACTOR SHALL INSTALL MUD MATS AT ALL CONSTRUCTION ENTRANCES TO THE SITE.
- STORMWATER SWALES TO BE COVERED WITH HYDRO-SEED AND MULCH.

LEGEND

EXISTING CONDITIONS

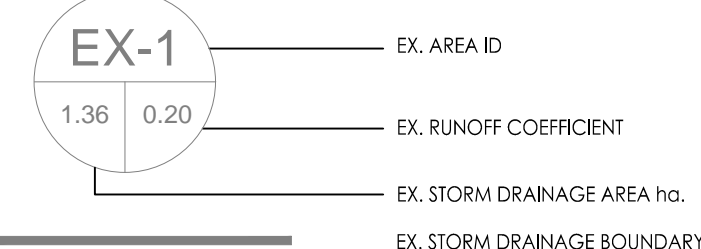
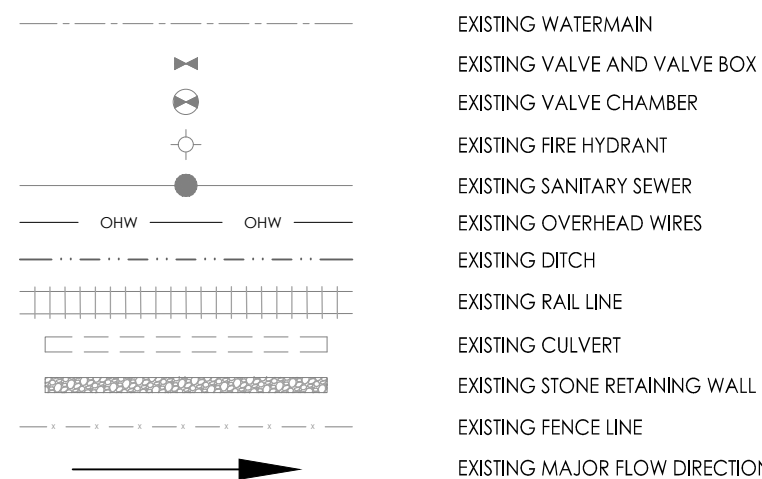

SANITARY DRAINAGE

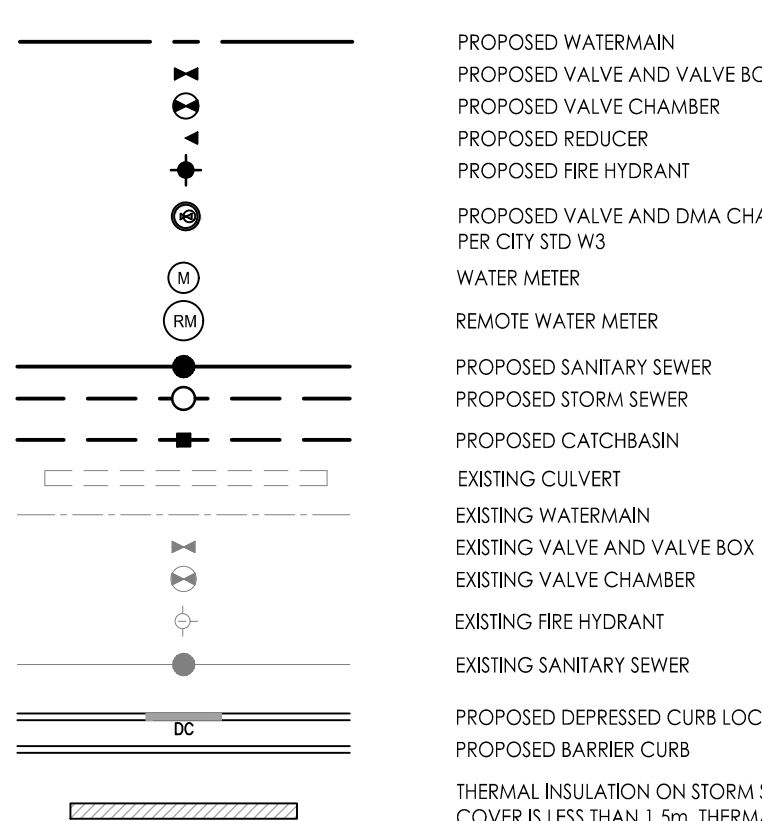

COMPOSITE UTILITY

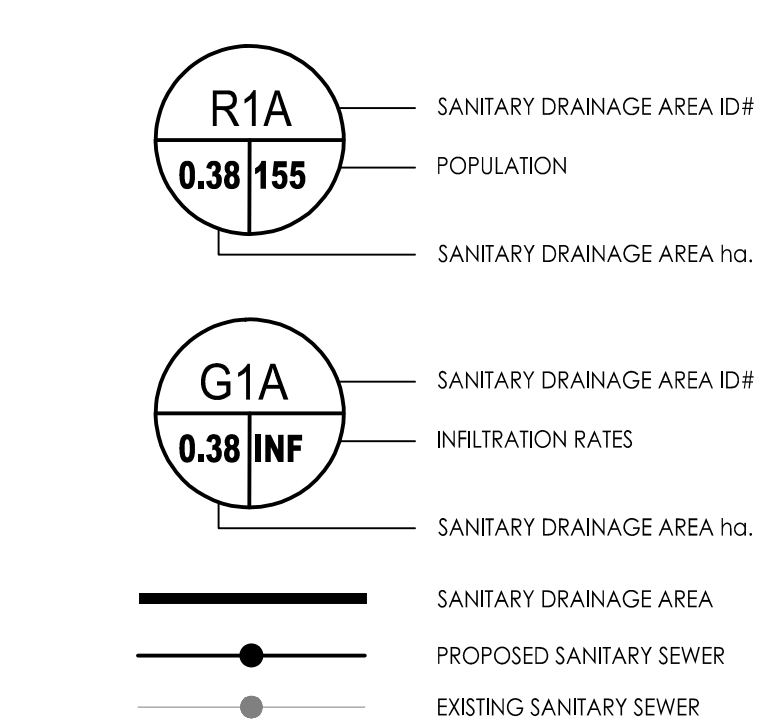

EROSION CONTROL

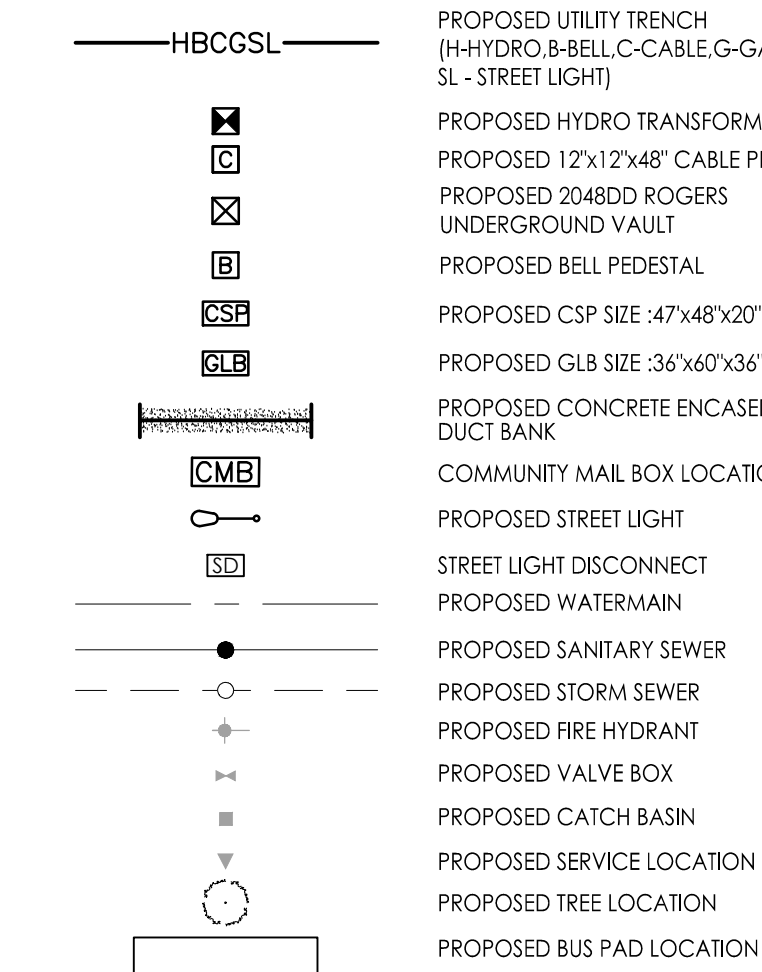

GRADING

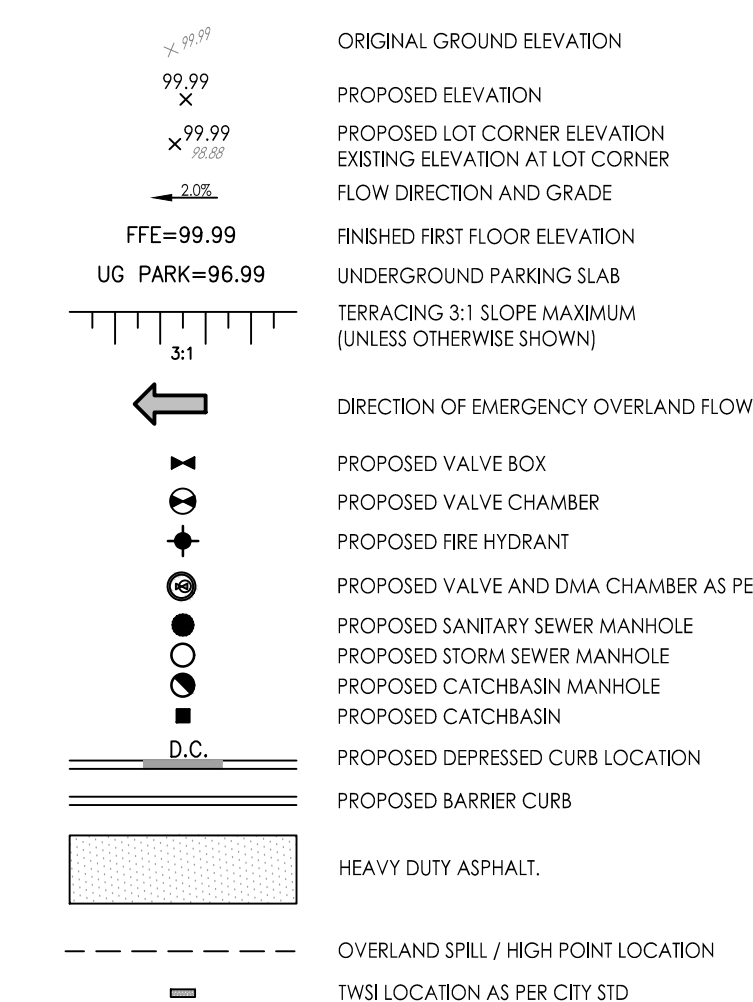

STORM DRAINAGE

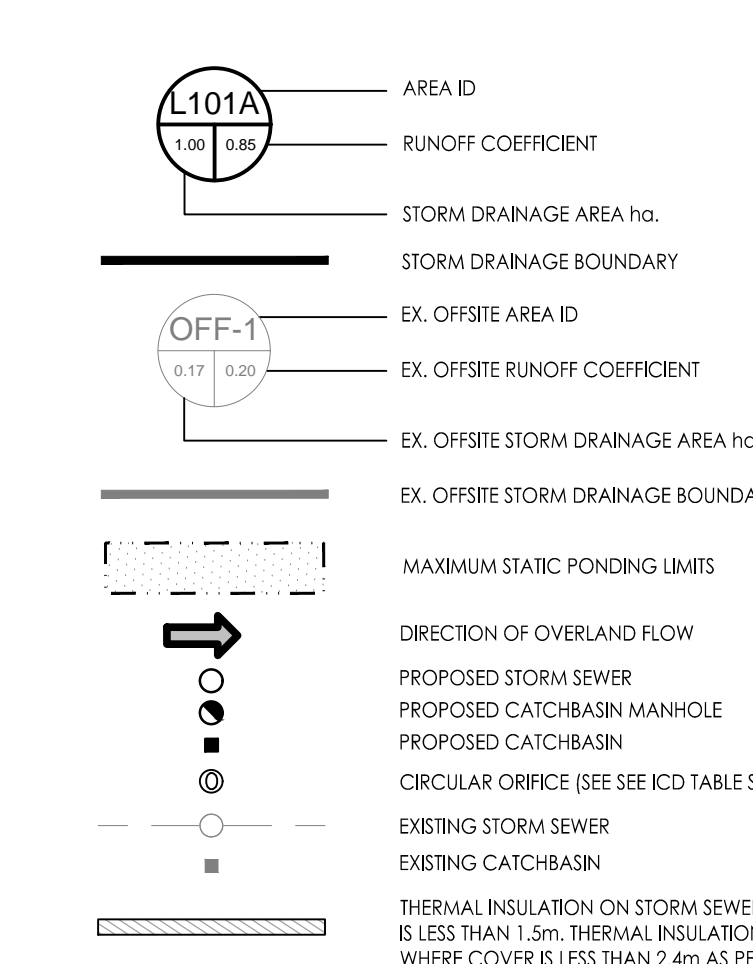

STORM DRAINAGE

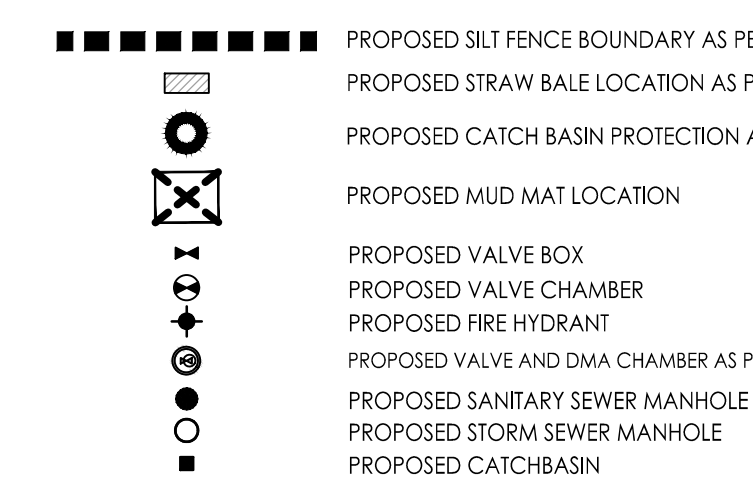

EROSION CONTROL



Rev	Description	MJS	DT	Date
5	REVISED AS PER SITE PLAN AND CITY COMMENTS	MJS	DT	24.08.06
4	REVISED AS PER SITE PLAN AND CITY COMMENTS	MJS	DT	24.04.08
3	REVISED WATERMAIN SIZE	MJS	DT	22.04.08
2	REVISED AS PER CITY COMMENTS	MJS	TR	21.05.07
1	ISSUED FOR REVIEW	MJS	TR	20.11.23

File Name:	MJS	ANP	MJS	Date
16401570.DB	MJS	ANP	MJS	20.08.17
	Dwn.	Chkd.	Dsgn.	YY.MM.DD

Permit-Seal

Client/Project

BRIGIL

100 STEACIE DRIVE

OTTAWA, ON

Title

NOTES AND LEGEND PLAN

Project No.	Scale	Sheet	Revision
160401570	1:500	1 of 9	5
Drawing No.			Revision

NL-1

1 of 9

5

PLAN# 18327

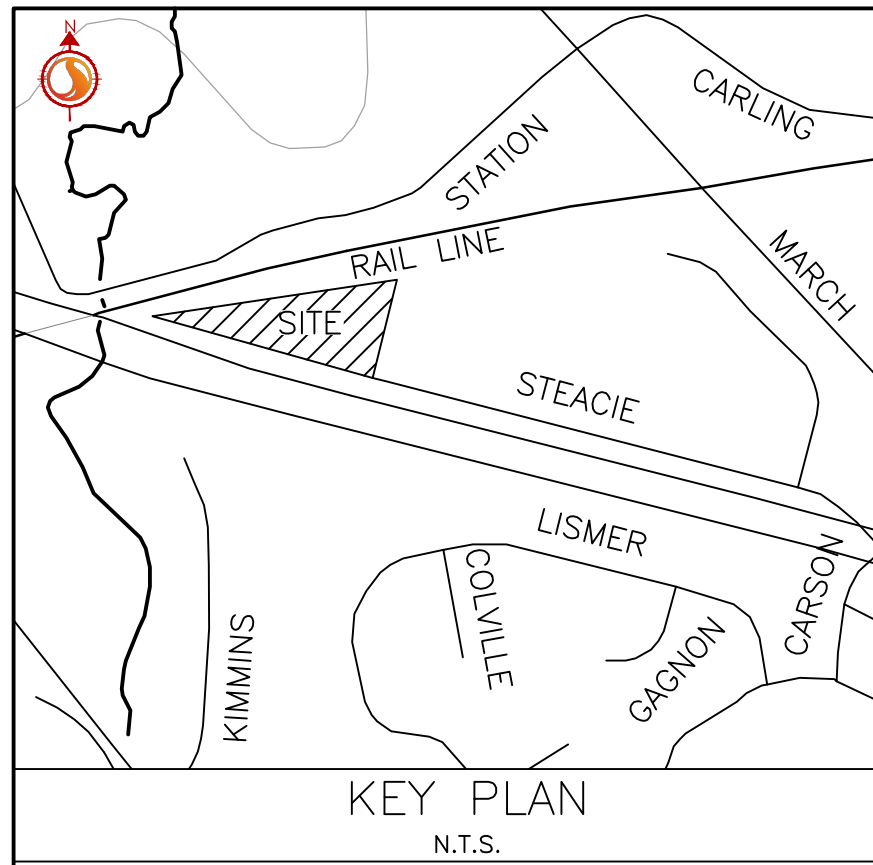

Copyright Reserved

The Contractor shall verify and be responsible for all dimensions. DO NOT scale the drawing - any errors or omissions shall be reported to Stantec without delay.  
The Copyrights to all designs and drawings are the property of Stantec. Reproduction or use for any purpose other than that authorized by Stantec is forbidden.

Legend

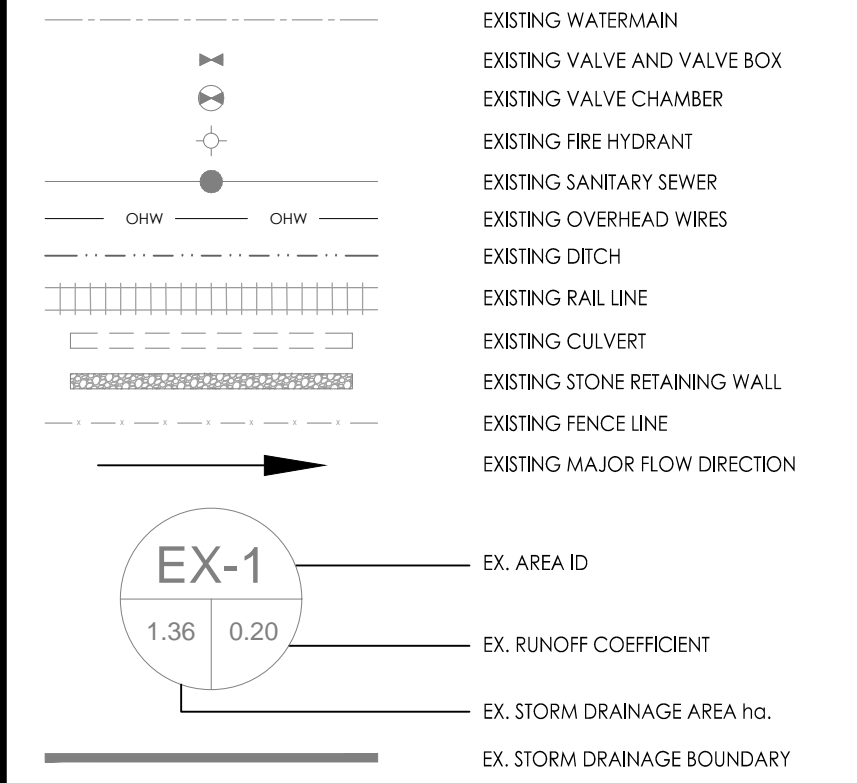

Notes

5	REVISED AS PER SITE PLAN AND CITY COMMENTS	MJS	DT	24.08.06
4	REVISED AS PER SITE PLAN AND CITY COMMENTS	MJS	DT	24.04.08
3	REVISED WATERMAIN SIZE	MJS	DT	22.04.08
2	REVISED AS PER CITY COMMENTS	MJS	TR	21.05.07
1	ISSUED FOR REVIEW	MJS	TR	20.11.23

Revision	By	Appd.	YY.MM.DD
----------	----	-------	----------

File Name:	160401570 DB	MJS	AMP	MJS	20.08.17
		Dwn.	Chkd.	Dgn.	YY.MM.DD

Permit-Seal

Client/Project

BRIGIL  
  
100 STEACIE DRIVE  
  
OTTAWA, ON

Title

EXISTING CONDITIONS AND DRAINAGE PLAN

Project No.	160401570	Scale	0 5 15 25m
Drawing No.	Sheet	Revision	





Copyright Reserved

The Contractor shall verify and be responsible for all dimensions. DO NOT scale the drawing - any errors or omissions shall be reported to Stantec without delay. The Copyrights to all designs and drawings are the property of Stantec. Reproduction or use for any purpose other than that authorized by Stantec is forbidden.

Legend

	PROPOSED WATERMAIN
	PROPOSED VALVE AND VALVE BOX
	PROPOSED VALVE CHAMBER
	PROPOSED REDUCER
	PROPOSED FIRE HYDRANT
	PROPOSED VALVE AND DMA CHAMBER AS PER CITY STD W3
	WATER METER
	REMOTE WATER METER
	PROPOSED SANITARY SEWER
	PROPOSED STORM SEWER
	PROPOSED CATCH-BASIN
	EXISTING CULVERT
	EXISTING WATERMAIN
	EXISTING VALVE AND VALVE BOX
	EXISTING VALVE CHAMBER
	EXISTING FIRE HYDRANT
	EXISTING SANITARY SEWER
	PROPOSED DEPRESSED CURB LOCATIONS
	PROPOSED BARRIER CURB
	THERMAL INSULATION ON STORM SEWER WHERE COVER IS LESS THAN 1.5m. THERMAL INSULATION ON WATERMAIN WHERE COVER IS LESS THAN 2.4m AS PER W22.

Notes

SCHEDULE OF INLET CONTROL DEVICES				
AREA ID	STRUCTURE ID	ICD TYPE (CORED INTO WEB)	100YR HEAD (m)	100YR FLOW (L/s)
POND 1	MH 1006	150mmØ ORBICE 200mmØ ORBICE	1.27	125.84

SCHEDULE OF ROOF RELEASE RATES				
BUILDING	DRAIN TYPE	# DRAINS	100YR Head (m)	100YR RELEASE RATE (L/s)
BUILDING A	WATTS ACCUFLOW	8	0.15	10.04
BUILDING B	WATTS ACCUFLOW	6	0.15	7.56

Revision	By	Appd.	YY.MM.DD	
5	REVISD AS PER SITE PLAN AND CITY COMMENTS	MJS	DT	24.08.06
4	REVISD AS PER SITE PLAN AND CITY COMMENTS	MJS	DT	24.04.08
3	REVISD WATERMAIN SEE	MJS	DT	22.04.08
2	REVISD AS PER CITY COMMENTS	MJS	TR	21.05.07
1	ISSUED FOR REVIEW	MJS	TR	20.11.23

Revision

File Name:	MJS	ANP	MJS	20.08.17
160401570 DB	Dwn.	Chkd.	Dsgn.	YY.MM.DD

Permit-Seal

Client/Project

BRIGIL  
100 STEACIE DRIVE  
OTTAWA, ON

Title

SITE SERVICING PLAN

Project No. 160401570	Scale 1:500	Sheet 4 of 9	Revision 5
--------------------------	----------------	-----------------	---------------

Drawing No. SSP-2  
Revision 5  
PLAN# 18327

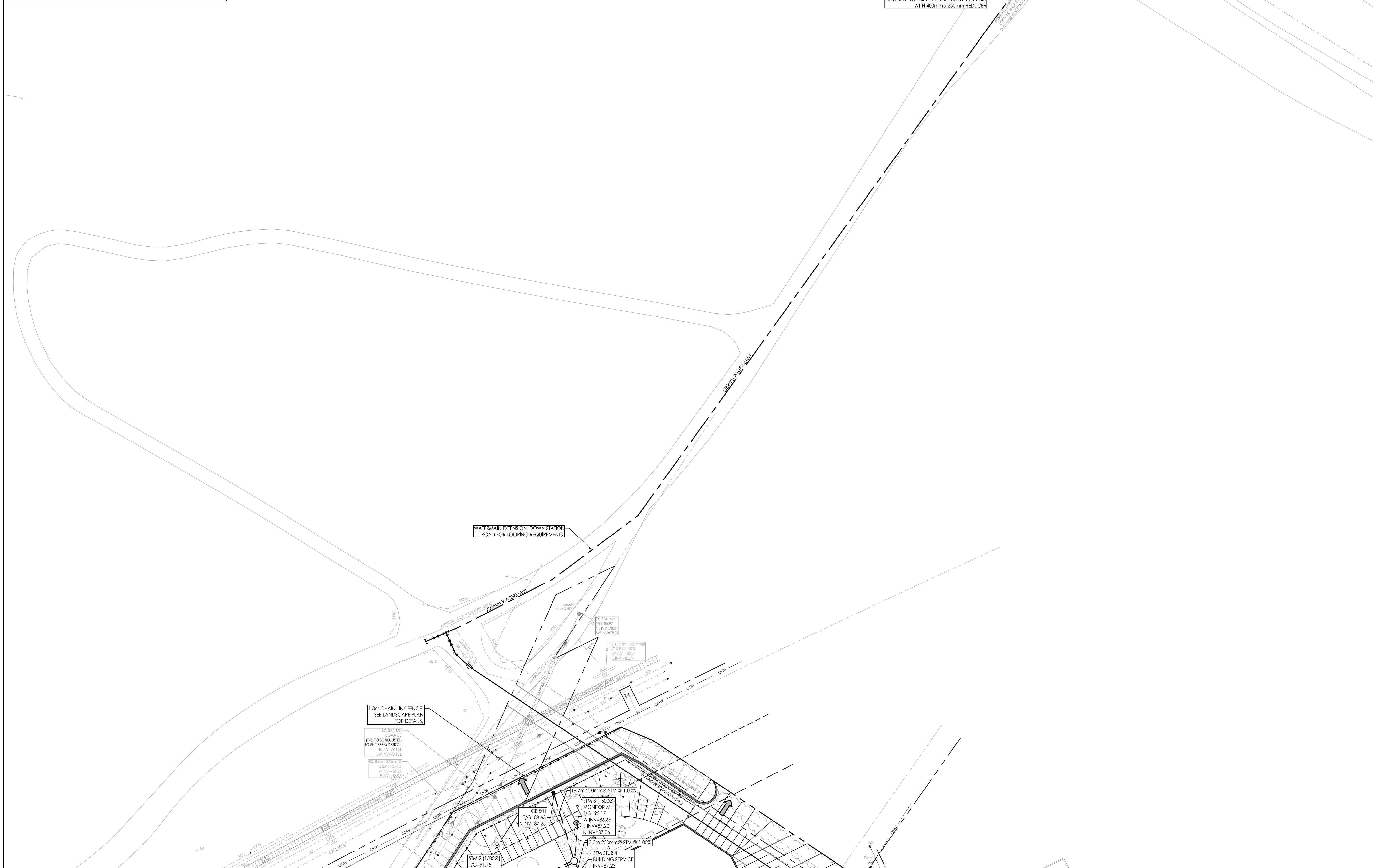
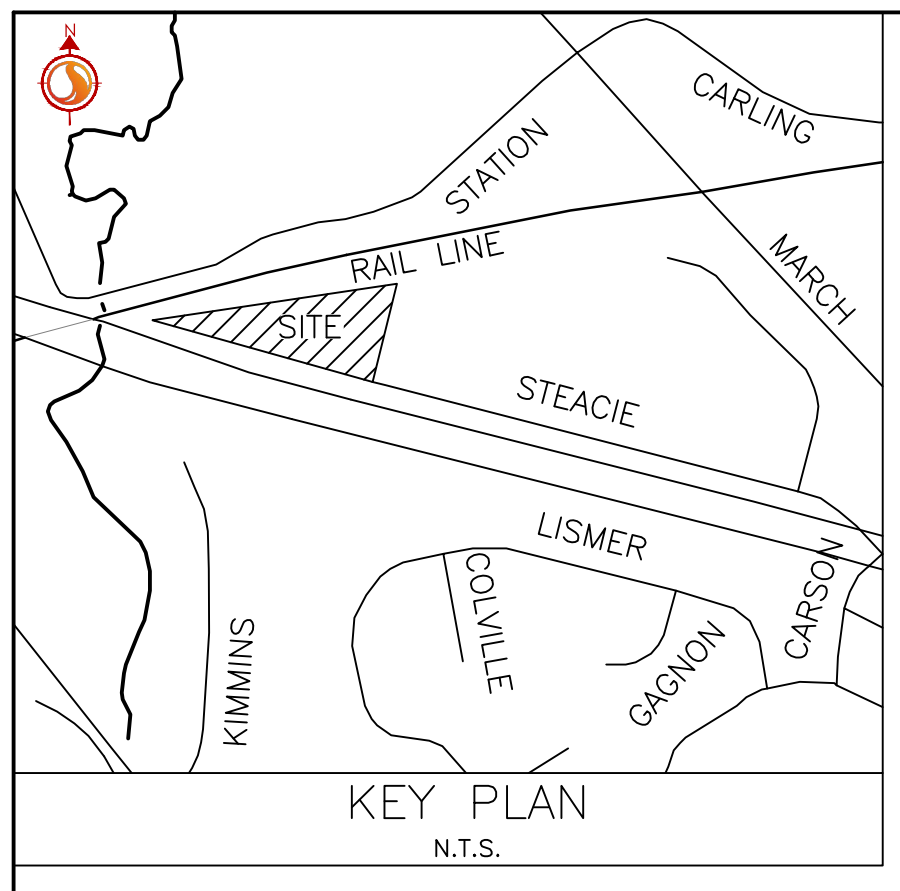

I:\11\_04\_2024\160401570\design\drawings\160401570 DB.dwg  
 2024/08/06 09:41:53 AM  
 2024/08/06 09:41:53 AM

Copyright Reserved

The Contractor shall verify and be responsible for all dimensions. DO NOT scale the drawing - any errors or omissions shall be reported to Stantec without delay.  
The Copyrights to all designs and drawings are the property of Stantec. Reproduction or use for any purpose other than that authorized by Stantec is forbidden.

Legend

- ORIGINAL GROUND ELEVATION
- PROPOSED ELEVATION
- PROPOSED LOT CORNER ELEVATION
- EXISTING ELEVATION AT LOT CORNER
- FLOW DIRECTION AND GRADE
- FINISHED FIRST FLOOR ELEVATION
- UNDERGROUD PARKING SLAB
- TERRACING 3:1 SLOPE MAXIMUM (UNLESS OTHERWISE SHOWN)
- DIRECTION OF EMERGENCY OVERLAND FLOW
- PROPOSED VALVE CHAMBER
- PROPOSED VALVE HYDRANT
- PROPOSED VALVE AND DMA CHAMBER AS PER CITY STD W3
- PROPOSED SANITARY SEWER MANHOLE
- PROPOSED STORM SEWER MANHOLE
- PROPOSED CATCH BASIN
- PROPOSED DEPRESSED CURB LOCATION
- PROPOSED BARRIER CURB
- HEAVY DUTY ASPHALT
- OVERLAND SPILL / HIGH POINT LOCATION
- TWS LOCATION AS PER CITY STD

Notes

Revision	By	Appd.	YY.MM.DD	
5	REVISED AS PER SITE PLAN AND CITY COMMENTS	MJS	DT	24.08.06
4	REVISED AS PER SITE PLAN AND CITY COMMENTS	MJS	DT	24.04.08
3	REVISED WATERMAIN SEE	MJS	DT	22.04.08
2	REVISED AS PER CITY COMMENTS	MJS	TR	21.05.07
1	ISSUED FOR REVIEW	MJS	TR	20.11.23

File Name:	MJS	AMP	MJS	20.08.17
160401570 DB	Dwn.	Chkd.	Dgn.	YY.MM.DD

Permit-Seal

Client/Project

BRIGIL  
100 STEACIE DRIVE  
OTTAWA, ON

Title

GRADING PLAN

Project No. 160401570	Scale 1:500	Sheet 5 of 9	Revision 5
--------------------------	----------------	-----------------	---------------

Drawing No. GP-1  
Revision 5  
PLAN# 18327

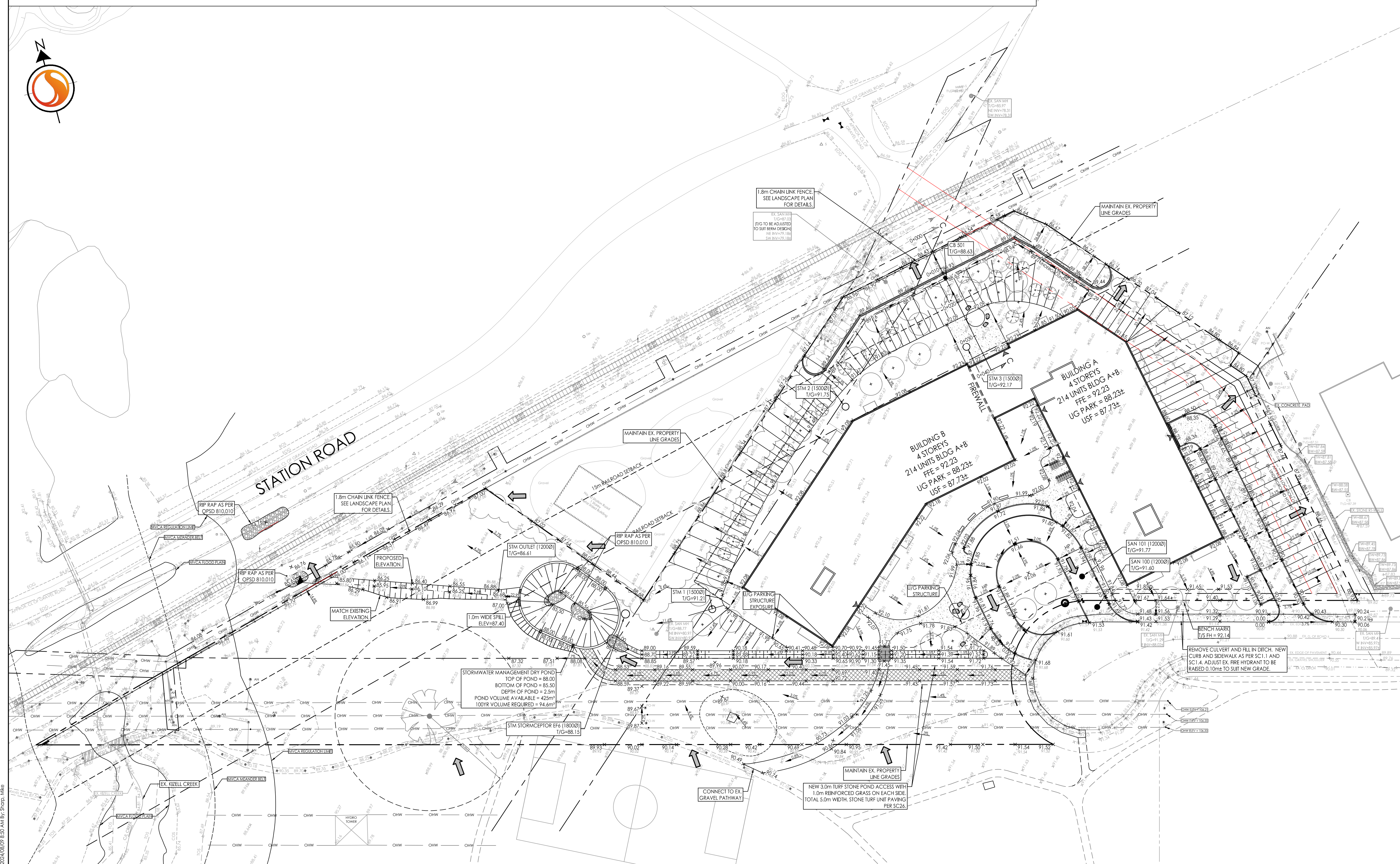
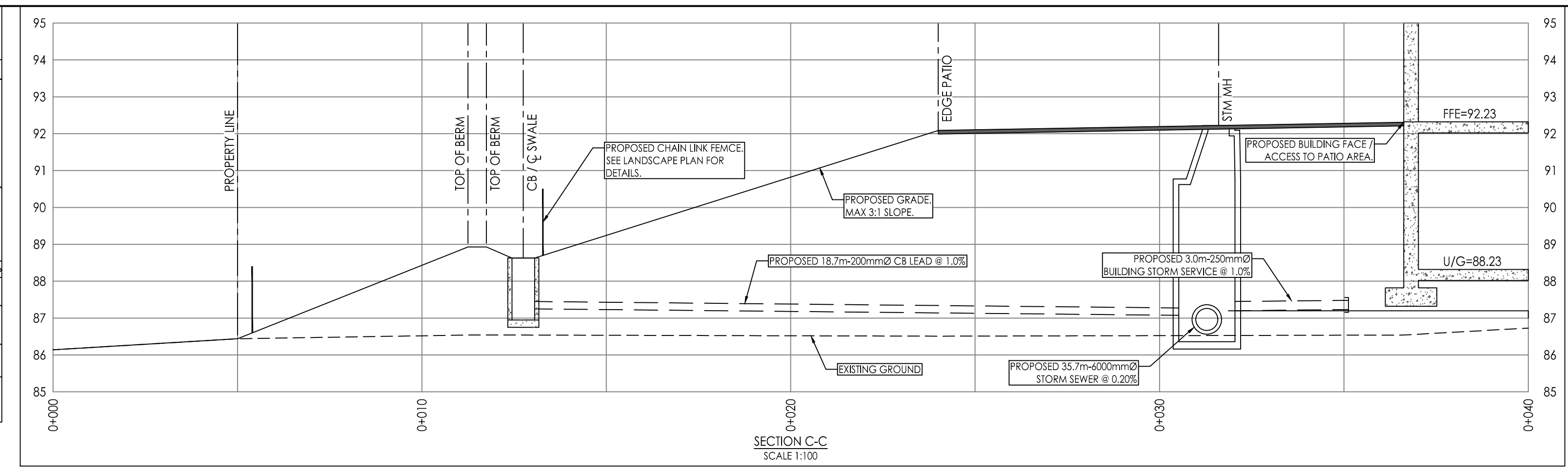
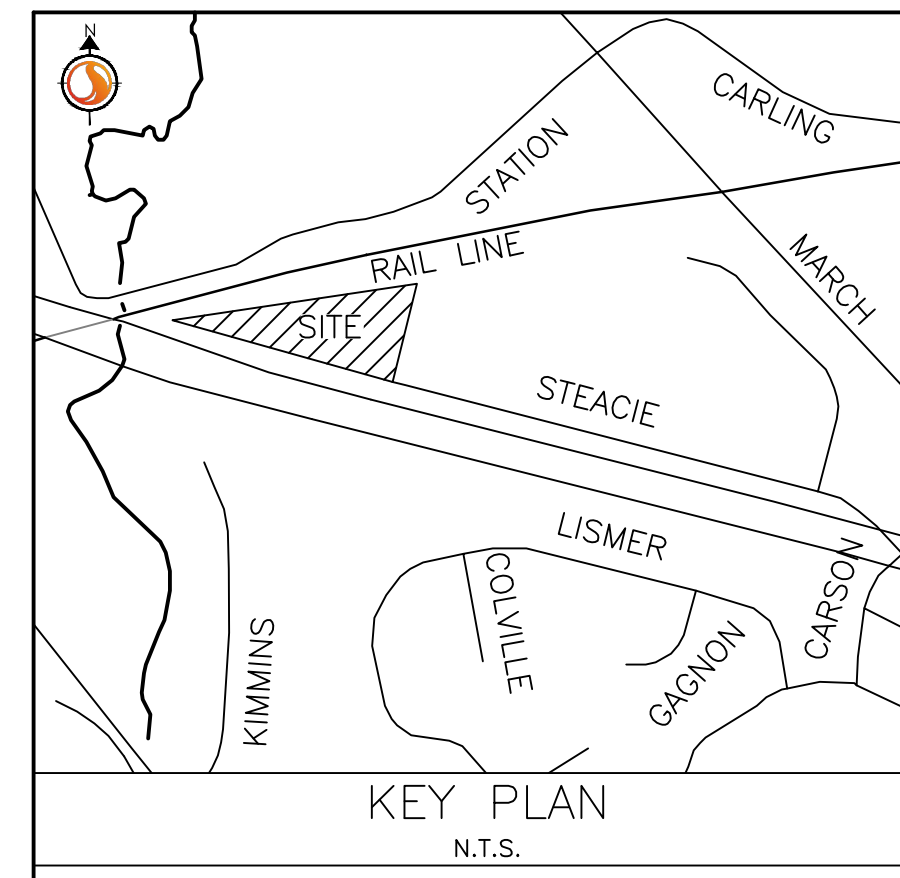











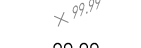
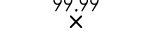

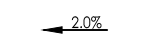
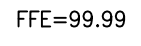
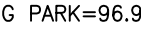
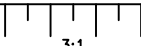
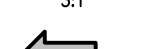

I:\Projects\160401570\160401570.dwg  
 2024/08/06 09:53:00 AM 160401570.dwg  
 ORIGINAL SHEET - ARCH-D

D02-02-02-0094

**Copyright Reserved**

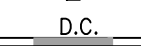
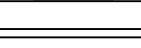
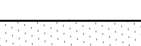
The Contractor shall verify and be responsible for all dimensions. DO NOT scale the drawing - any errors or omissions shall be reported to Stantec without delay.  
The Copyrights to all designs and drawings are the property of Stantec. Reproduction or use for any purpose other than that authorized by Stantec is forbidden.

**Legend**

-  ORIGINAL GROUND ELEVATION
-  PROPOSED ELEVATION
-  PROPOSED LOT CORNER ELEVATION
-  EXISTING ELEVATION AT LOT CORNER
-  FLOW DIRECTION AND GRADE
-  FINISHED FIRST FLOOR ELEVATION
-  UG PARK=96.99
-  TERRACING 3:1 SLOPE MAXIMUM (UNLESS OTHERWISE SHOWN)
-  DIRECTION OF EMERGENCY OVERLAND FLOW
-  PROPOSED VALVE BOX
-  PROPOSED VALVE CHAMBER
-  PROPOSED FIRE HYDRANT
-  PROPOSED VALVE AND DMA CHAMBER AS PER CITY STD W3
-  PROPOSED SANITARY SEWER MANHOLE
-  PROPOSED STORM SEWER MANHOLE
-  PROPOSED CATCH-BASIN
-  PROPOSED DEPRESSED CURB LOCATION
-  PROPOSED BARRIER CURB
-  HEAVY DUTY ASPHALT.
-  OVERLAND SPILL / HIGH POINT LOCATION
-  TWS LOCATION AS PER CITY STD

**Notes**

Revision	By	Appd.	YY.MM.DD	
5	REVISD AS PER SITE PLAN AND CITY COMMENTS	MJS	DT	24.08.06
4	REVISD AS PER SITE PLAN AND CITY COMMENTS	MJS	DT	24.04.08
3	REVISD WATERMAIN SEE	MJS	DT	22.04.08
2	REVISD AS PER CITY COMMENTS	MJS	TR	21.05.07
1	ISSUED FOR REVIEW	MJS	TR	20.11.23

Revision By Appd. YY.MM.DD

File Name:	160401570 DB	MJS	ANP	MJS	20.08.17
		Dwn.	Chkd.	Dsgn.	YY.MM.DD

Permit-Seal

Client/Project

BRIGIL

100 STEACIE DRIVE

OTTAWA, ON

Title

GRADING PLAN

Project No.  
160401570

Scale  
1:500



Drawing No.

Sheet

Revision

GP-2

6 of 9

5

PLAN# 18327

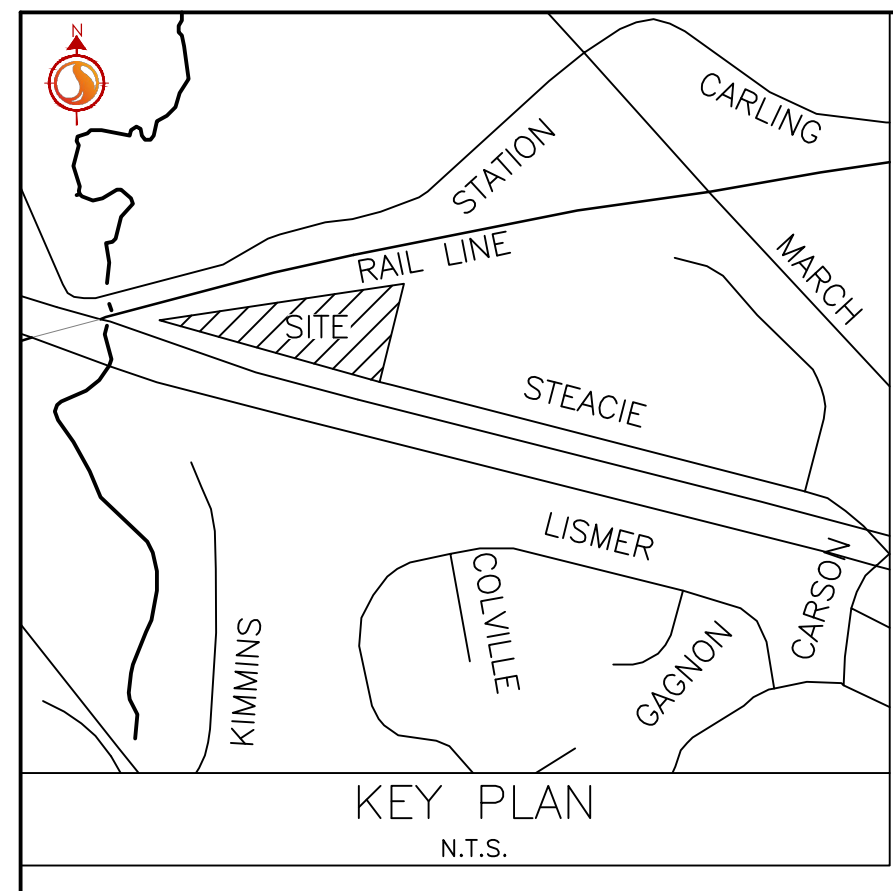

Copyright Reserved

The Contractor shall verify and be responsible for all dimensions. DO NOT scale the drawings - any errors or omissions shall be reported to Stantec without delay.  
The Copyrights to all designs and drawings are the property of Stantec. Reproduction or use for any purpose other than that authorized by Stantec is forbidden.

Legend

- PROPOSED SILT FENCE BOUNDARY AS PER OPSD 219.110
- PROPOSED STRAW BALE LOCATION AS PER OPSD 219.100
- PROPOSED CATCH BASIN PROTECTION AS PER DETAIL
- PROPOSED MUD MAT LOCATION
- PROPOSED VALVE BOX
- PROPOSED VALVE CHAMBER
- PROPOSED FIRE HYDRANT
- PROPOSED VALVE AND DIMA CHAMBER AS PER CITY STD W3
- PROPOSED SANITARY SEWER MANHOLE
- PROPOSED STORM SEWER MANHOLE
- PROPOSED CATCHBASIN

Notes

Best Management Practices

CONTRACTOR TO PROVIDE EROSION AND SEDIMENT CONTROLS (BEST MANAGEMENT PRACTICES) DURING CONSTRUCTION OF THIS PROJECT. THE CONTRACTOR SHALL IMPLEMENT BEST MANAGEMENT PRACTICES TO PROVIDE PROTECTION OF THE AREA DRAINAGE SYSTEM AND THE RECEIVING WATERCOURSE. DURING CONSTRUCTION ACTIVITIES, THE CONTRACTOR ACKNOWLEDGES THAT FAILURE TO IMPLEMENT APPROPRIATE EROSION AND SEDIMENT CONTROL MEASURES MAY BE SUBJECT TO PENALTIES IMPOSED BY ANY APPLICABLE REGULATORY AGENCY.

- LIMIT THE EXTENT OF EXPOSED SOILS AT ANY GIVEN TIME.
- REVEGETATE EXPOSED AREAS AND SLOPES AS SOON AS POSSIBLE.
- MINIMIZE AREA TO BE CLEARED AND GRUBBED.
- PROTECT EXPOSED SLOPES WITH PLASTIC OR SYNTHETIC MULCHES.

- INSTALL CATCH BASIN INSERTS OR EQUIVALENT IN ALL PROPOSED CATCH BASINS AND CATCH BASIN MANHOLES AND IN ALL EXISTING CATCH BASINS THAT WILL RECEIVE RUN-OFF FROM THE SITE.
- A SILT FENCE SHALL BE INSTALLED AROUND THE PERIMETER OF ALL AND ANY STOCKPILES OF MATERIAL TO BE USED OR REMOVED FROM SITE (LOCATION TO BE DETERMINED).
- A VISUAL INSPECTION SHALL BE DONE DAILY ON SEDIMENT CONTROL MEASURES AND CLEANED OF ANY ACCUMULATED SILT AS REQUIRED. THE DEPOSITS WILL BE DISPOSED OFF SITE AS PER THE REQUIREMENTS OF THE CONTRACT.
- SEDIMENT CONTROL BARRIERS MAY ONLY BE REMOVED TEMPORARILY WITH APPROVAL OF CONTRACT ADMINISTRATOR TO ACCOMMODATE CONSTRUCTION OPERATIONS. ALL AFFECTED BARRIERS MUST BE REINSTATED AT NIGHT WHEN CONSTRUCTION IS COMPLETED. NO REMOVAL WILL OCCUR IF THERE IS A SIGNIFICANT RAINFALL EVENT ANTICIPATED (>10mm) UNLESS A NEW DEVICE HAS BEEN INSTALLED TO PROTECT EXISTING STORM AND SANITARY SEWER SYSTEMS, OR DOWNSTREAM WATERCOURSES.
- NO REFUELING OR CLEANING OF EQUIPMENT IS PERMITTED NEAR ANY EXISTING WATERWAY.
- CONTRACTOR SHALL REMOVE SEDIMENT CONTROL MEASURES WHEN, IN THE OPINION OF THE CONTRACT ADMINISTRATOR, THE MEASURE(S) IS NO LONGER REQUIRED. NO CONTROL MEASURES SHALL BE PERMANENTLY REMOVED WITHOUT WRITTEN AUTHORIZATION FROM THE CONTRACT ADMINISTRATOR.
- THE CONTRACTOR SHALL PERIODICALLY, OR WHEN REQUESTED BY THE CONTRACT ADMINISTRATOR, CLEAN UP ACCUMULATED SEDIMENTS AS REQUIRED.
- THE CONTRACTOR SHALL IMMEDIATELY REPORT TO THE ENGINEER ANY ACCIDENTAL DISCHARGES OF SEDIMENT MATERIAL INTO THE WATERCOURSE. APPROPRIATE RESPONSE MEASURES, INCLUDING ANY REPAIRS TO EXISTING CONTROL MEASURES OR THE IMPLEMENTATION OF ADDITIONAL CONTROL MEASURES, SHALL BE CARRIED OUT BY THE CONTRACTOR WITHOUT DELAY.
- CONTRACTOR SHALL INSTALL MUD MATS AT ALL CONSTRUCTION ENTRANCES TO THE SITE.
- STORMWATER SWALES TO BE COVERED WITH HYDRO-SEED AND MULCH.

NO.	REVISION	DATE	BY	APPD.
5	REVISED AS PER SITE PLAN AND CITY COMMENTS	MJS	DT	24.08.06
4	REVISED AS PER SITE PLAN AND CITY COMMENTS	MJS	DT	24.04.08
3	REVISED WATERMAIN SIZE	MJS	DT	22.04.08
2	REVISED AS PER CITY COMMENTS	MJS	TR	21.05.07
1	ISSUED FOR REVIEW	MJS	TR	20.11.23

NO.	REVISION	DATE	BY	APPD.
5	REVISED AS PER SITE PLAN AND CITY COMMENTS	MJS	DT	24.08.06
4	REVISED AS PER SITE PLAN AND CITY COMMENTS	MJS	DT	24.04.08
3	REVISED WATERMAIN SIZE	MJS	DT	22.04.08
2	REVISED AS PER CITY COMMENTS	MJS	TR	21.05.07
1	ISSUED FOR REVIEW	MJS	TR	20.11.23

NO.	REVISION	DATE	BY	APPD.
5	REVISED AS PER SITE PLAN AND CITY COMMENTS	MJS	DT	24.08.06
4	REVISED AS PER SITE PLAN AND CITY COMMENTS	MJS	DT	24.04.08
3	REVISED WATERMAIN SIZE	MJS	DT	22.04.08
2	REVISED AS PER CITY COMMENTS	MJS	TR	21.05.07
1	ISSUED FOR REVIEW	MJS	TR	20.11.23

NO.	REVISION	DATE	BY	APPD.
5	REVISED AS PER SITE PLAN AND CITY COMMENTS	MJS	DT	24.08.06
4	REVISED AS PER SITE PLAN AND CITY COMMENTS	MJS	DT	24.04.08
3	REVISED WATERMAIN SIZE	MJS	DT	22.04.08
2	REVISED AS PER CITY COMMENTS	MJS	TR	21.05.07
1	ISSUED FOR REVIEW	MJS	TR	20.11.23

NO.	REVISION	DATE	BY	APPD.
5	REVISED AS PER SITE PLAN AND CITY COMMENTS	MJS	DT	24.08.06
4	REVISED AS PER SITE PLAN AND CITY COMMENTS	MJS	DT	24.04.08
3	REVISED WATERMAIN SIZE	MJS	DT	22.04.08
2	REVISED AS PER CITY COMMENTS	MJS	TR	21.05.07
1	ISSUED FOR REVIEW	MJS	TR	20.11.23

NO.	REVISION	DATE	BY	APPD.
5	REVISED AS PER SITE PLAN AND CITY COMMENTS	MJS	DT	24.08.06
4	REVISED AS PER SITE PLAN AND CITY COMMENTS	MJS	DT	24.04.08
3	REVISED WATERMAIN SIZE	MJS	DT	22.04.08
2	REVISED AS PER CITY COMMENTS	MJS	TR	21.05.07
1	ISSUED FOR REVIEW	MJS	TR	20.11.23

NO.	REVISION	DATE	BY	APPD.
5	REVISED AS PER SITE PLAN AND CITY COMMENTS	MJS	DT	24.08.06
4	REVISED AS PER SITE PLAN AND CITY COMMENTS	MJS	DT	24.04.08
3	REVISED WATERMAIN SIZE	MJS	DT	22.04.08
2	REVISED AS PER CITY COMMENTS	MJS	TR	21.05.07
1	ISSUED FOR REVIEW	MJS	TR	20.11.23

NO.	REVISION	DATE	BY	APPD.
5	REVISED AS PER SITE PLAN AND CITY COMMENTS	MJS	DT	24.08.06
4	REVISED AS PER SITE PLAN AND CITY COMMENTS	MJS	DT	24.04.08
3	REVISED WATERMAIN SIZE	MJS	DT	22.04.08
2	REVISED AS PER CITY COMMENTS	MJS	TR	21.05.07
1	ISSUED FOR REVIEW	MJS	TR	20.11.23

NO.	REVISION	DATE	BY	APPD.
5	REVISED AS PER SITE PLAN AND CITY COMMENTS	MJS	DT	24.08.06
4	REVISED AS PER SITE PLAN AND CITY COMMENTS	MJS	DT	24.04.08
3	REVISED WATERMAIN SIZE	MJS	DT	22.04.08
2	REVISED AS PER CITY COMMENTS	MJS	TR	21.05.07
1	ISSUED FOR REVIEW	MJS	TR	20.11.23

NO.	REVISION	DATE	BY	APPD.
5	REVISED AS PER SITE PLAN AND CITY COMMENTS	MJS	DT	24.08.06
4	REVISED AS PER SITE PLAN AND CITY COMMENTS	MJS	DT	24.04.08
3	REVISED WATERMAIN SIZE	MJS	DT	22.04.08
2	REVISED AS PER CITY COMMENTS	MJS	TR	21.05.07
1	ISSUED FOR REVIEW	MJS	TR	20.11.23

NO.	REVISION	DATE	BY	APPD.
5	REVISED AS PER SITE PLAN AND CITY COMMENTS	MJS	DT	24.08.06
4	REVISED AS PER SITE PLAN AND CITY COMMENTS	MJS	DT	24.04.08
3	REVISED WATERMAIN SIZE	MJS	DT	22.04.08
2	REVISED AS PER CITY COMMENTS	MJS	TR	21.05.07
1	ISSUED FOR REVIEW	MJS	TR	20.11.23

NO.	REVISION	DATE	BY	APPD.
5	REVISED AS PER SITE PLAN AND CITY COMMENTS	MJS	DT	24.08.06
4	REVISED AS PER SITE PLAN AND CITY COMMENTS	MJS	DT	24.04.08
3	REVISED WATERMAIN SIZE	MJS	DT	22.04.08
2	REVISED AS PER CITY COMMENTS	MJS	TR	21.05.07
1	ISSUED FOR REVIEW	MJS	TR	20.11.23

NO.	REVISION	DATE	BY	APPD.
5	REVISED AS PER SITE PLAN AND CITY COMMENTS	MJS	DT	24.08.06
4	REVISED AS PER SITE PLAN AND CITY COMMENTS	MJS	DT	24.04.08
3	REVISED WATERMAIN SIZE	MJS	DT	22.04.08
2	REVISED AS PER CITY COMMENTS	MJS	TR	21.05.07
1	ISSUED FOR REVIEW	MJS	TR	20.11.23

NO.	REVISION	DATE	BY	APPD.
5	REVISED AS PER SITE PLAN AND CITY COMMENTS	MJS	DT	24.08.06
4	REVISED AS PER SITE PLAN AND CITY COMMENTS	MJS	DT	24.04.08
3	REVISED WATERMAIN SIZE	MJS	DT	22.04.08
2	REVISED AS PER CITY COMMENTS	MJS	TR	21.05.07
1	ISSUED FOR REVIEW	MJS	TR	20.11.23

NO.	REVISION	DATE	BY	APPD.
5	REVISED AS PER SITE PLAN AND CITY COMMENTS	MJS	DT	24.08.06
4	REVISED AS PER SITE PLAN AND CITY COMMENTS	MJS	DT	24.04.08
3	REVISED WATERMAIN SIZE	MJS	DT	22.04.08
2	REVISED AS PER CITY COMMENTS	MJS	TR	21.05.07
1	ISSUED FOR REVIEW	MJS	TR	20.11.23

NO.	REVISION	DATE	BY	APPD.
5	REVISED AS PER SITE PLAN AND CITY COMMENTS	MJS	DT	24.08.06
4	REVISED AS PER SITE PLAN AND CITY COMMENTS	MJS	DT	24.04.08
3	REVISED WATERMAIN SIZE	MJS	DT	22.04.08
2	REVISED AS PER CITY COMMENTS	MJS	TR	21.05.07
1	ISSUED FOR REVIEW	MJS	TR	20.11.23

NO.	REVISION	DATE	BY	APPD.
5	REVISED AS PER SITE PLAN AND CITY COMMENTS	MJS	DT	24.08.06
4	REVISED AS PER SITE PLAN AND CITY COMMENTS	MJS	DT	24.04.08
3	REVISED WATERMAIN SIZE	MJS	DT	22.04.08
2	REVISED AS PER CITY COMMENTS	MJS	TR	21.05.07
1	ISSUED FOR REVIEW	MJS	TR	20.11.23

NO.	REVISION	DATE	BY	APPD.
5	REVISED AS PER SITE PLAN AND CITY COMMENTS	MJS	DT	24.08.06
4	REVISED AS PER SITE PLAN AND CITY COMMENTS	MJS	DT	24.04.08
3	REVISED WATERMAIN SIZE	MJS	DT	22.04.08
2	REVISED AS PER CITY COMMENTS	MJS	TR	21.05.07
1	ISSUED FOR REVIEW	MJS	TR	20.11.23

NO.	REVISION	DATE	BY	APPD.
5	REVISED AS PER SITE PLAN AND CITY COMMENTS	MJS	DT	24.08.06
4	REVISED AS PER SITE PLAN AND CITY COMMENTS	MJS	DT	24.04.08
3	REVISED WATERMAIN SIZE	MJS	DT	22.04.08
2	REVISED AS PER CITY COMMENTS	MJS	TR	21.05.07
1	ISSUED FOR REVIEW	MJS	TR	20.11.23

NO.	REVISION	DATE	BY	APPD.
5	REVISED AS PER SITE PLAN AND CITY COMMENTS	MJS	DT	24.08.06
4	REVISED AS PER SITE PLAN AND CITY COMMENTS	MJS	DT	24.04.08
3	REVISED WATERMAIN SIZE	MJS	DT	22.04.08
2	REVISED AS PER CITY COMMENTS	MJS	TR	21.05.07
1	ISSUED FOR REVIEW	MJS	TR	20.11.23

NO.	REVISION	DATE	BY	APPD.
5	REVISED AS PER SITE PLAN AND CITY COMMENTS	MJS	DT	24.08.06
4	REVISED AS PER SITE PLAN AND CITY COMMENTS	MJS	DT	24.04.08
3	REVISED WATERMAIN SIZE	MJS	DT	22.04.08
2	REVISED AS PER CITY COMMENTS	MJS	TR	21.05.07
1	ISSUED FOR REVIEW	MJS	TR	20.11.23

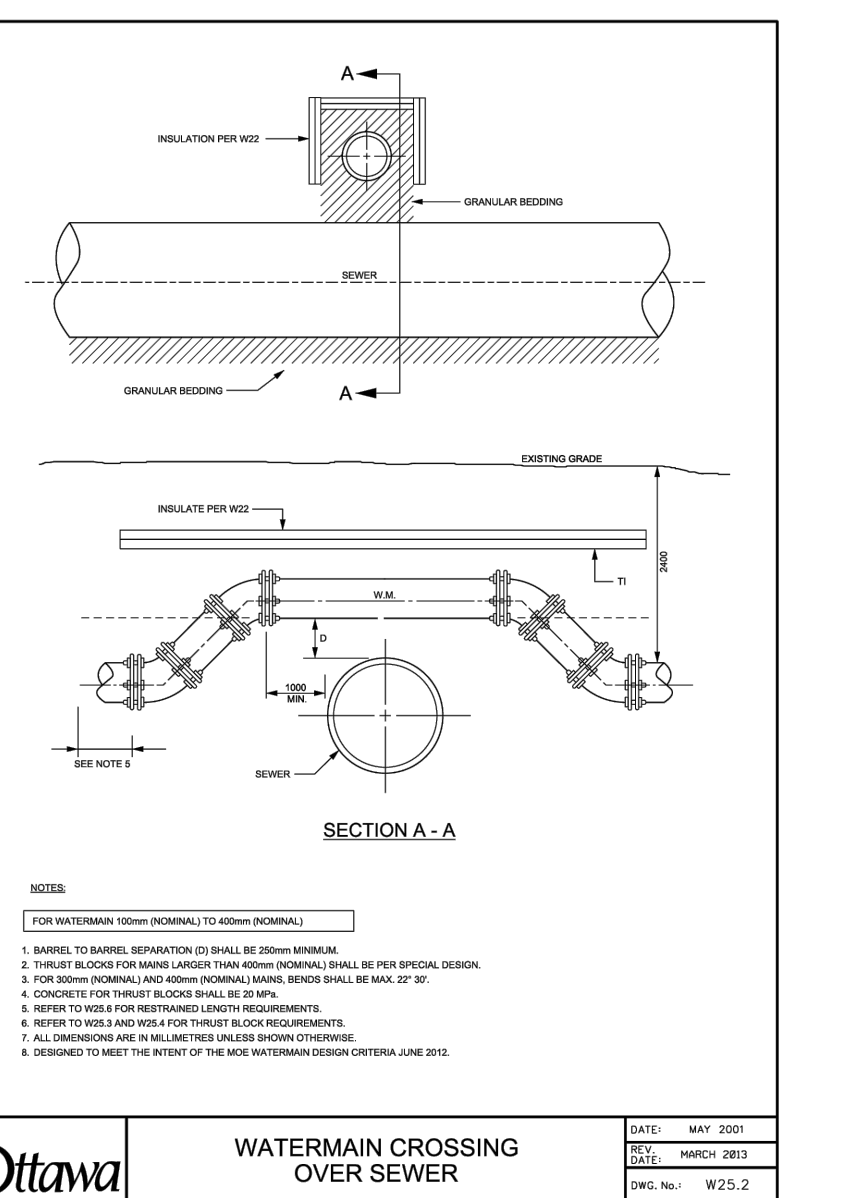
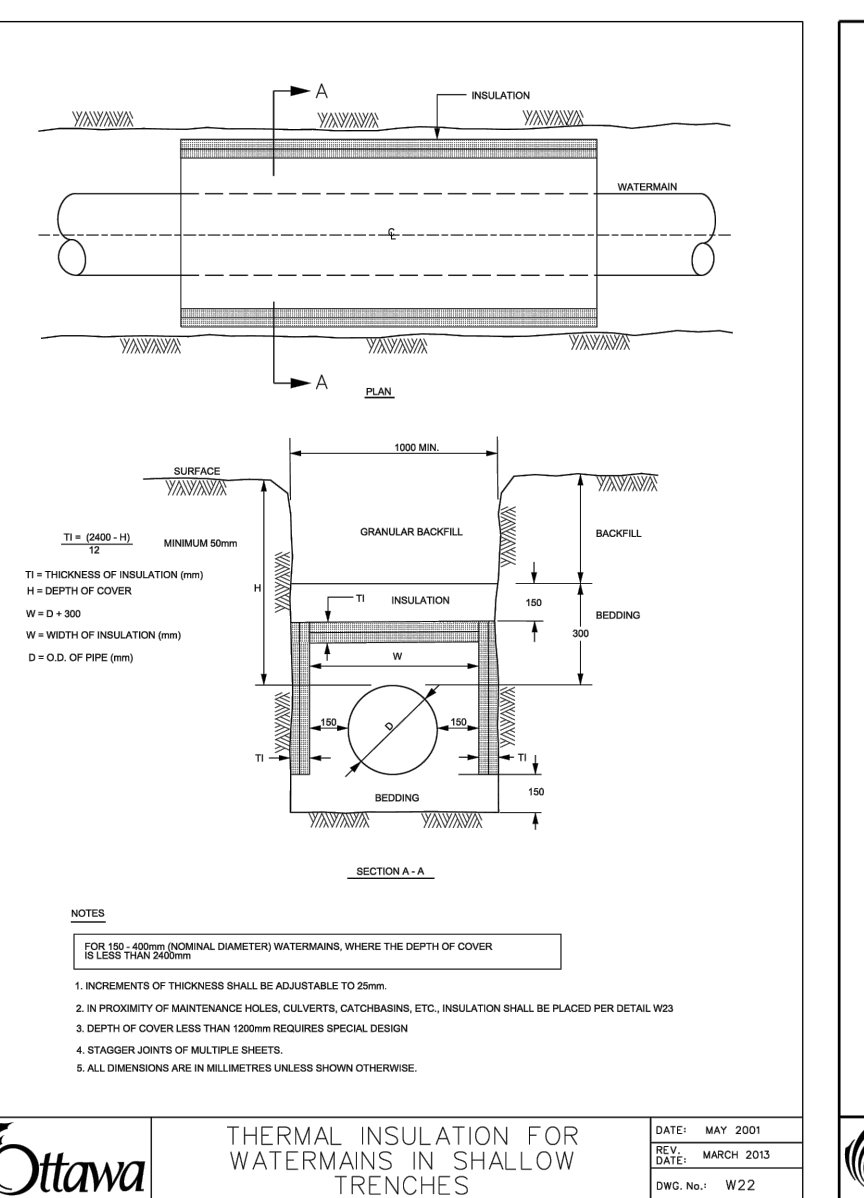
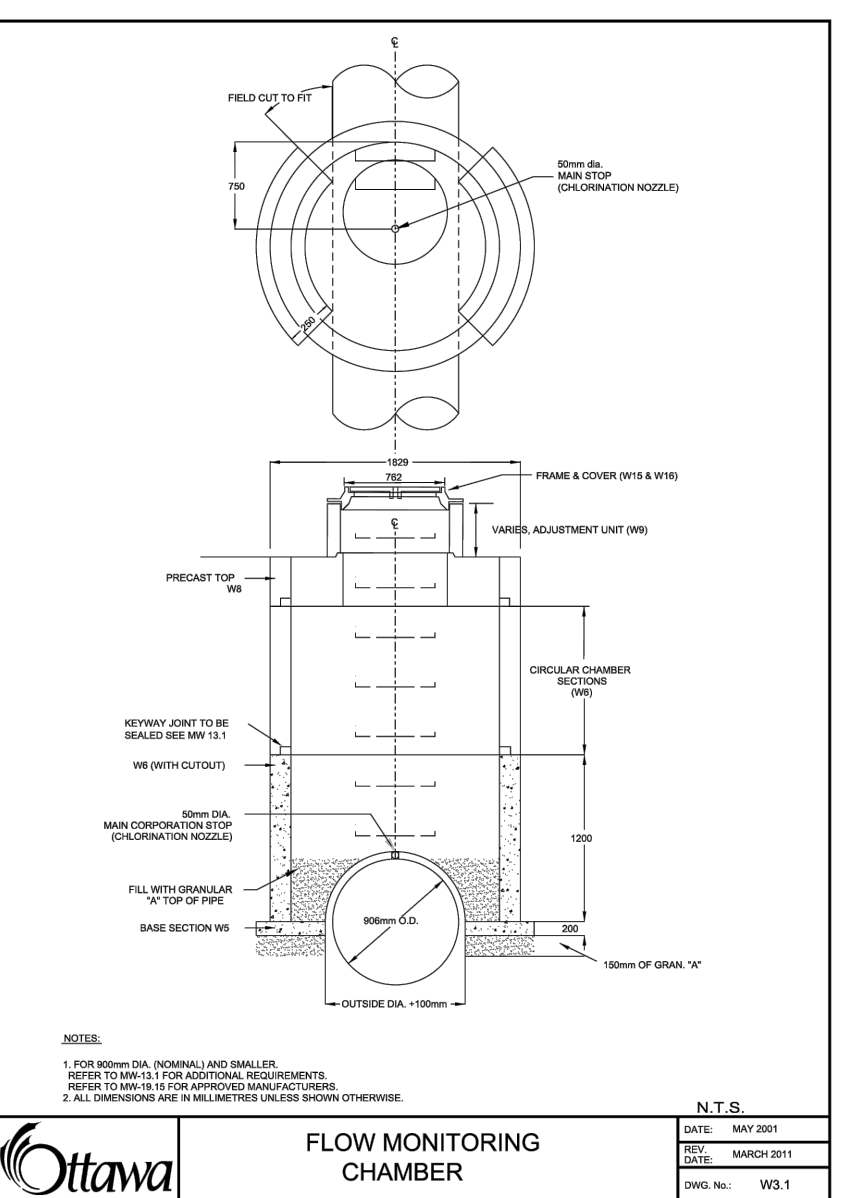
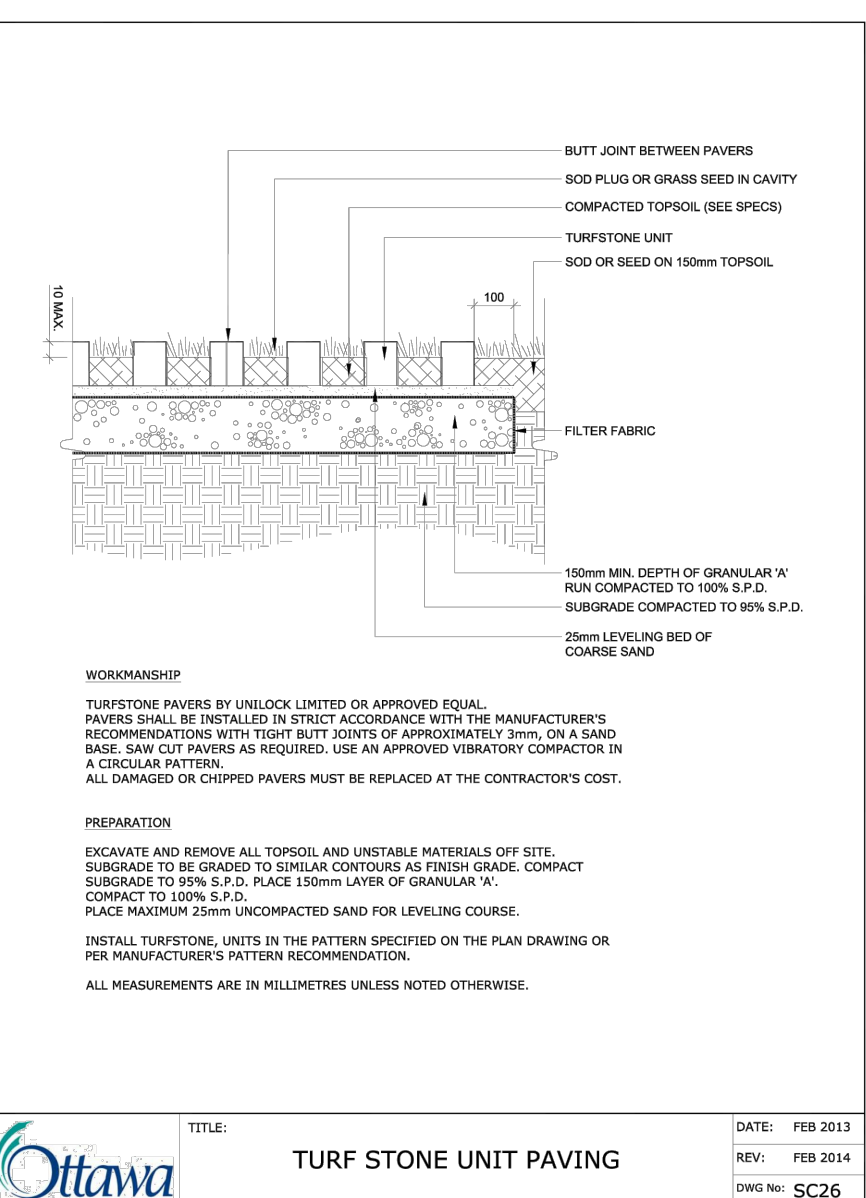
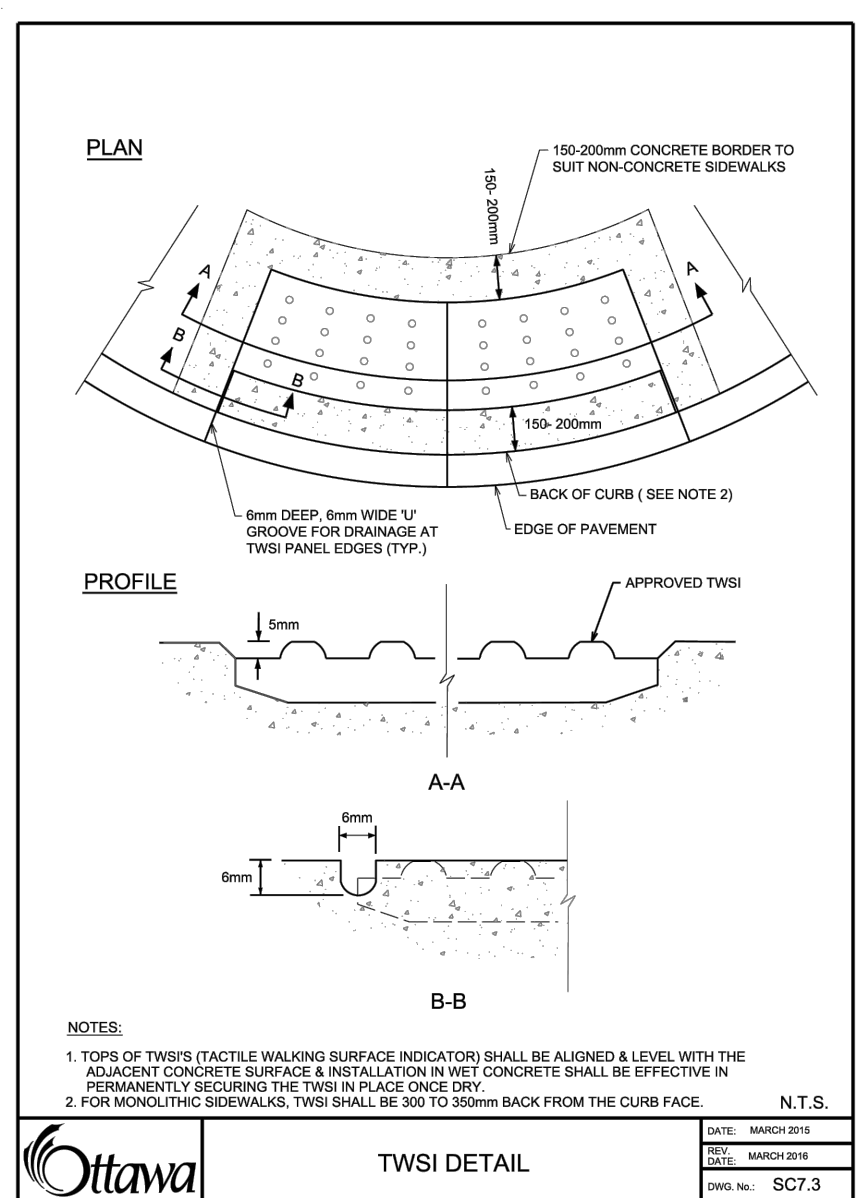
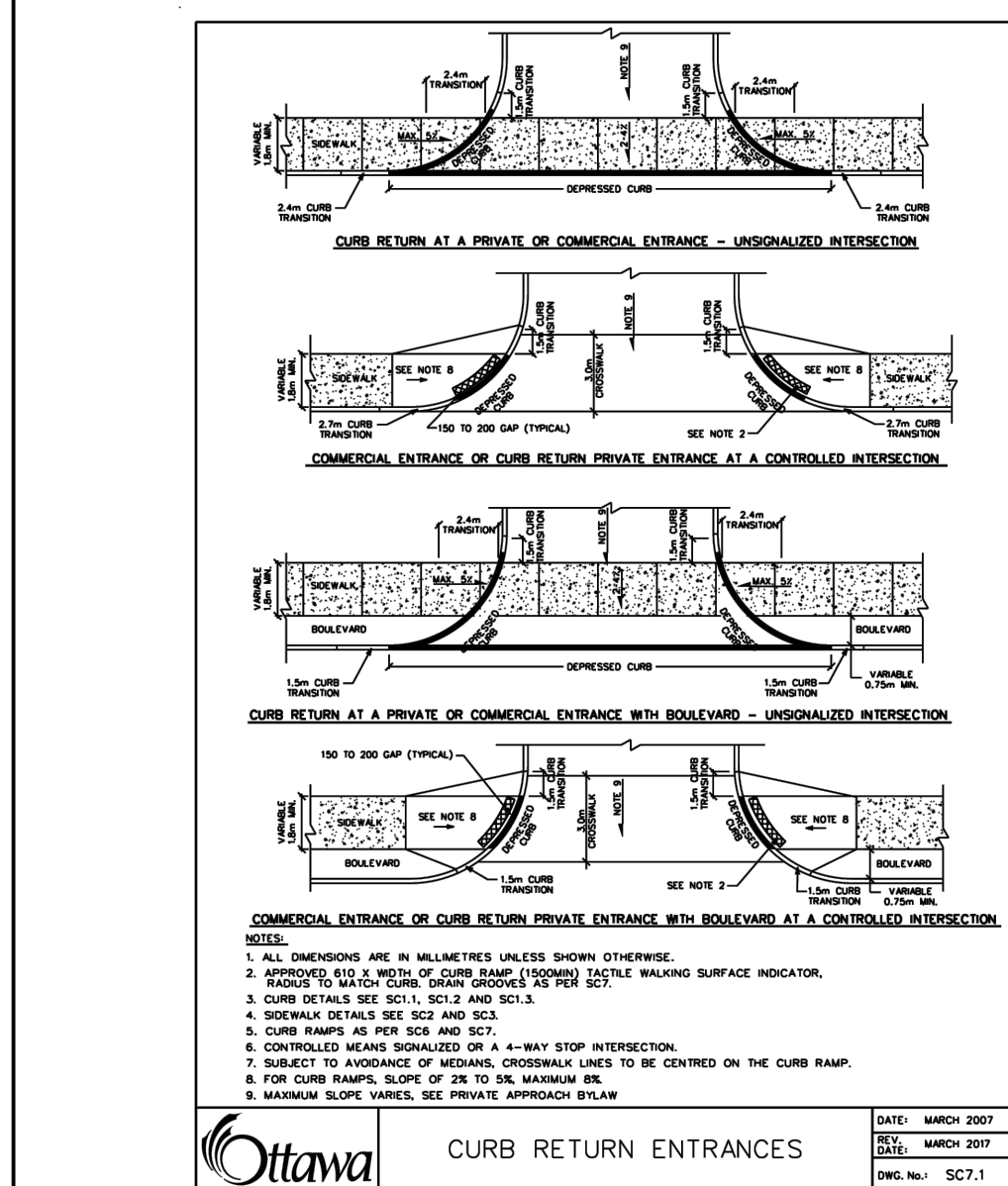
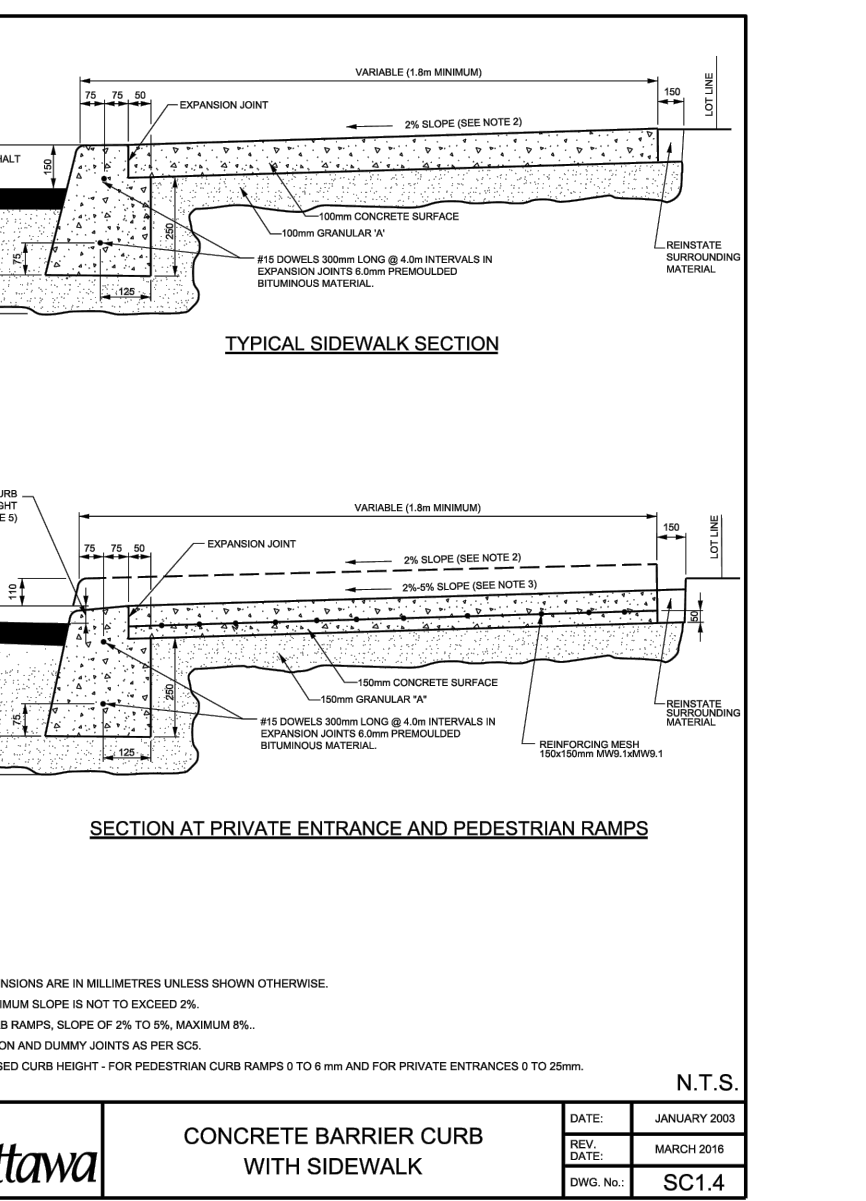
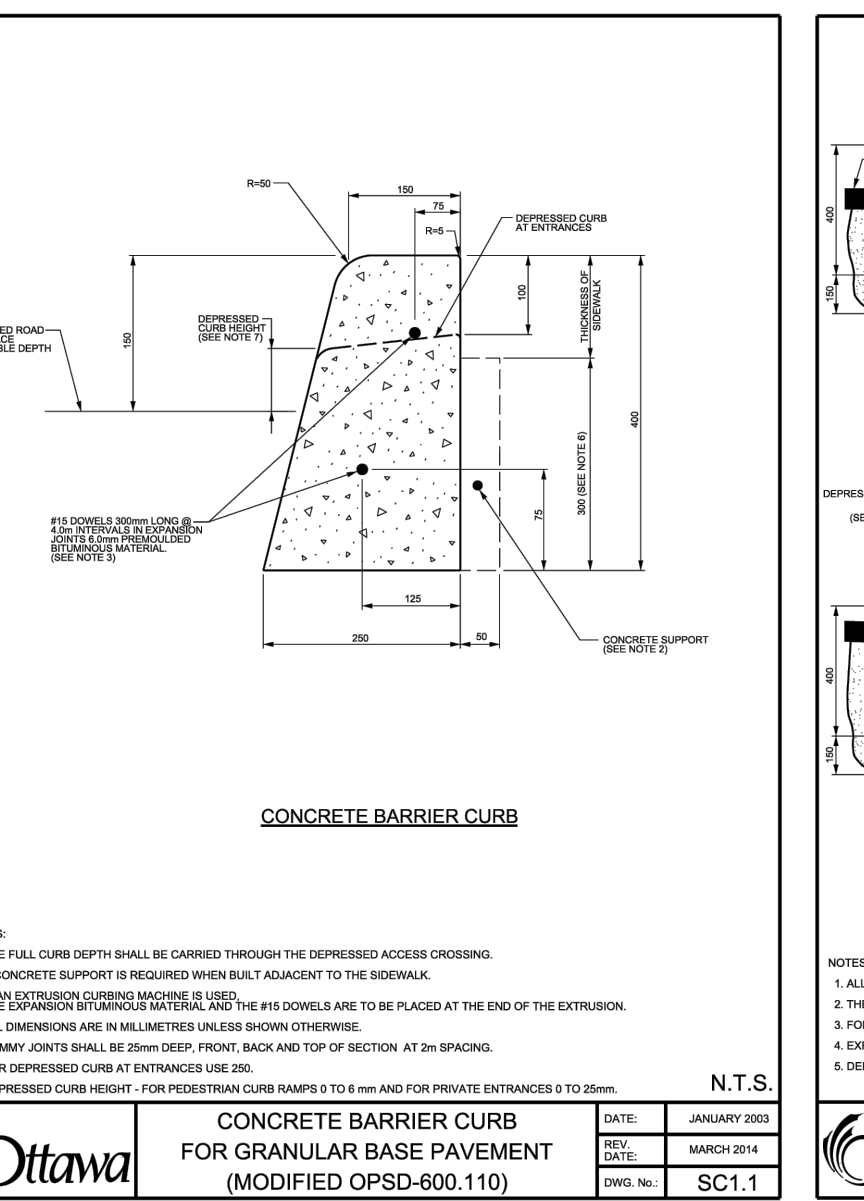
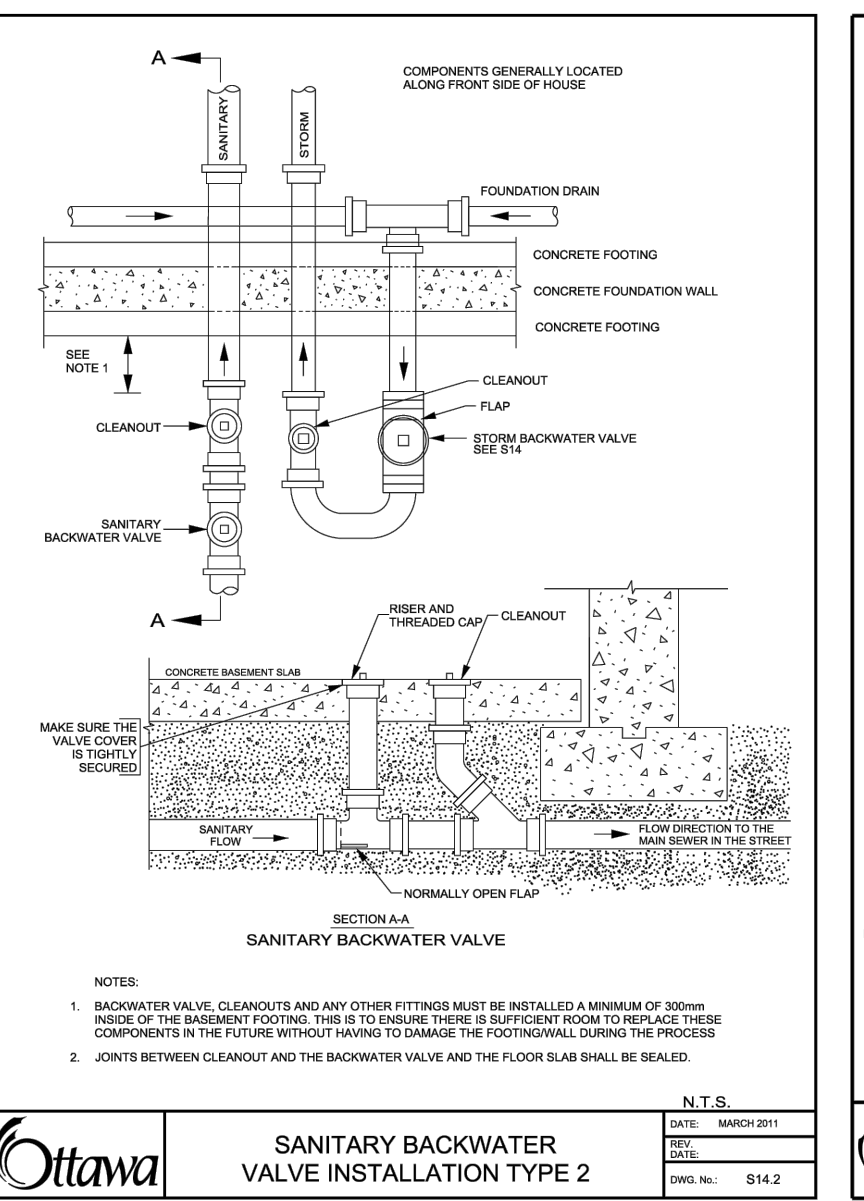
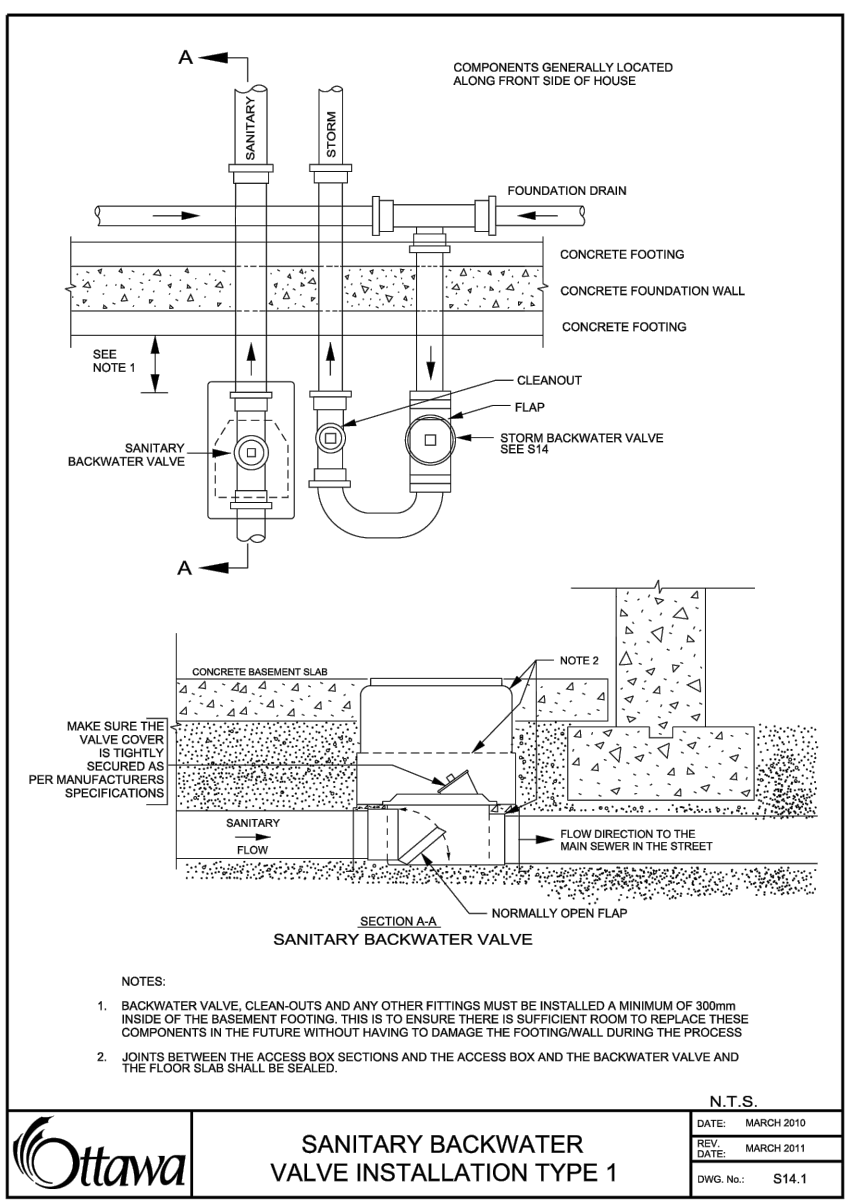
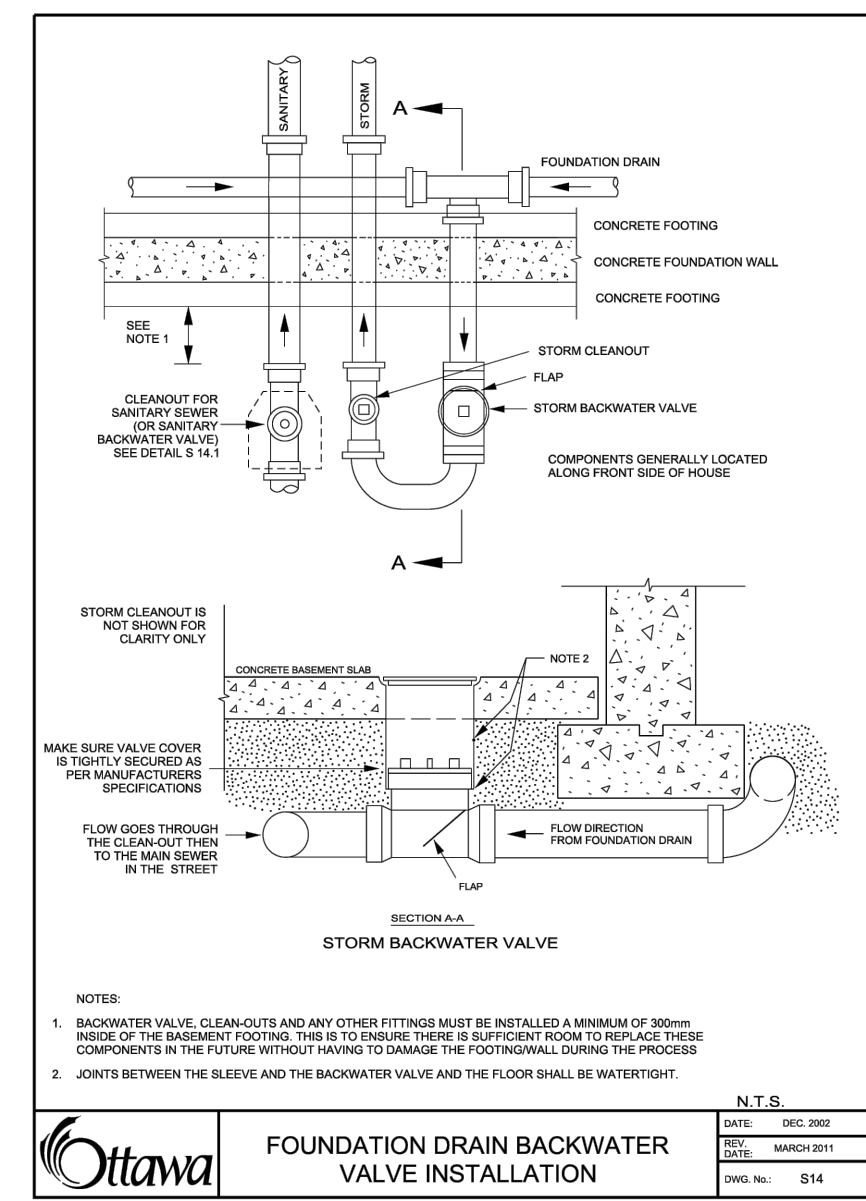
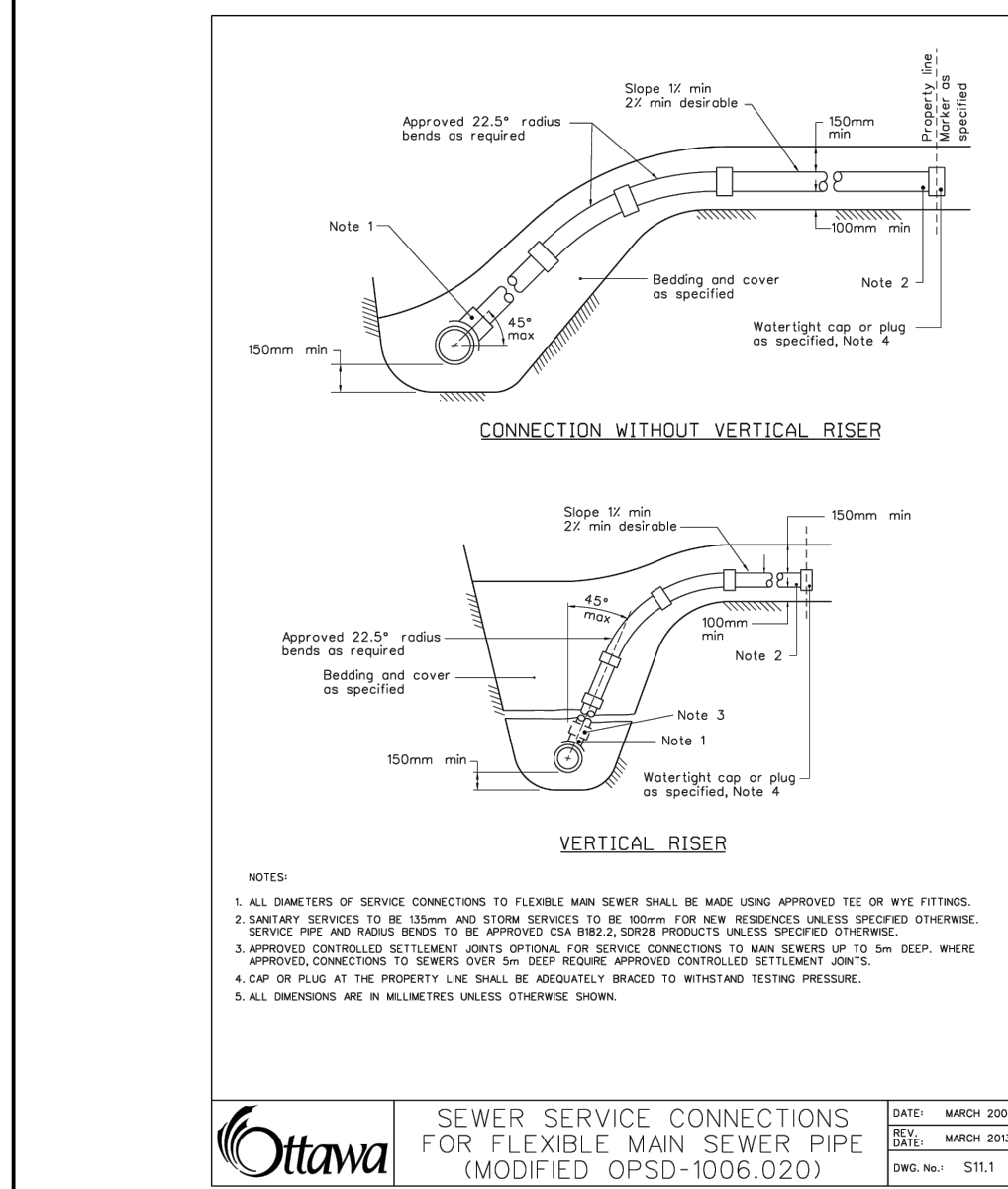
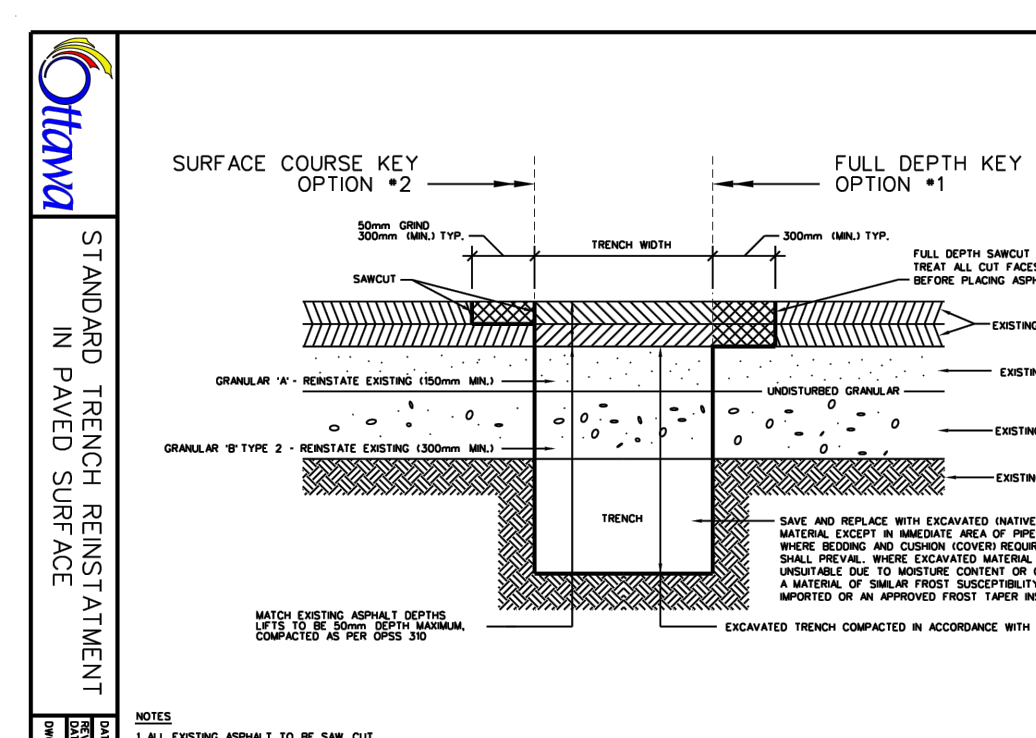
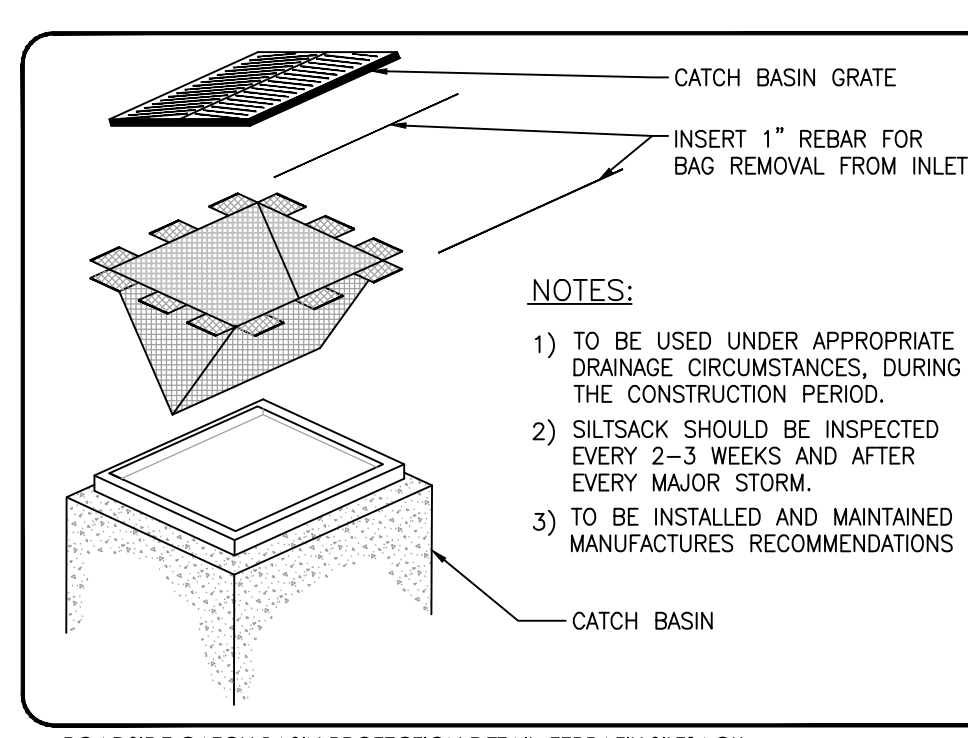
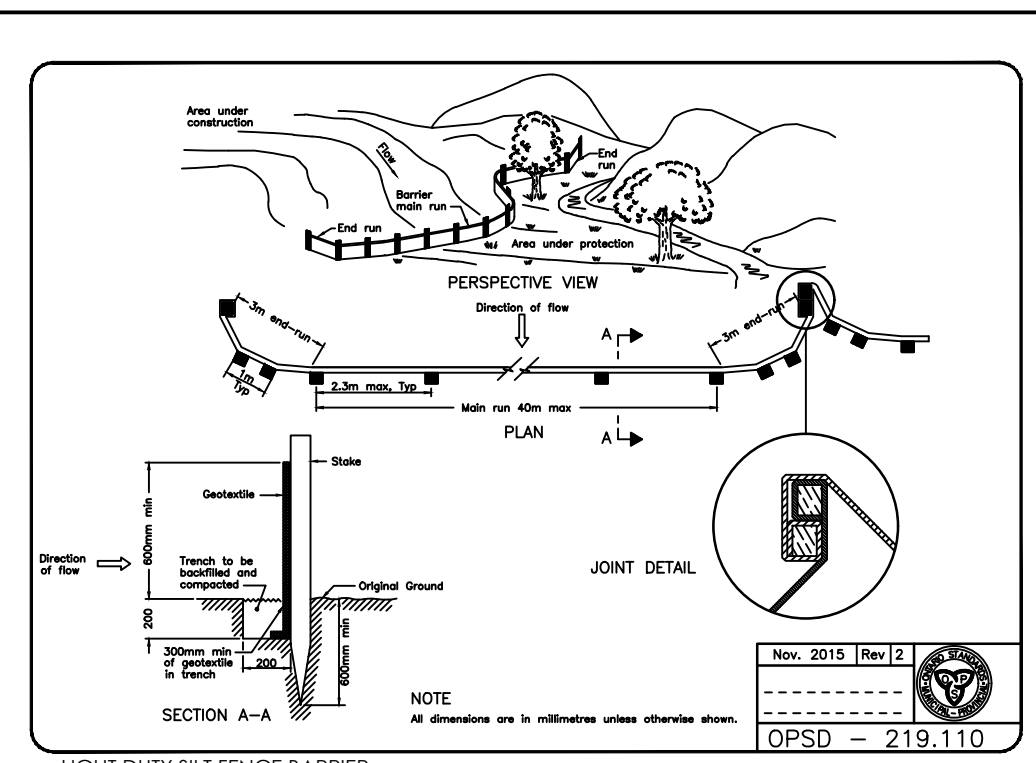
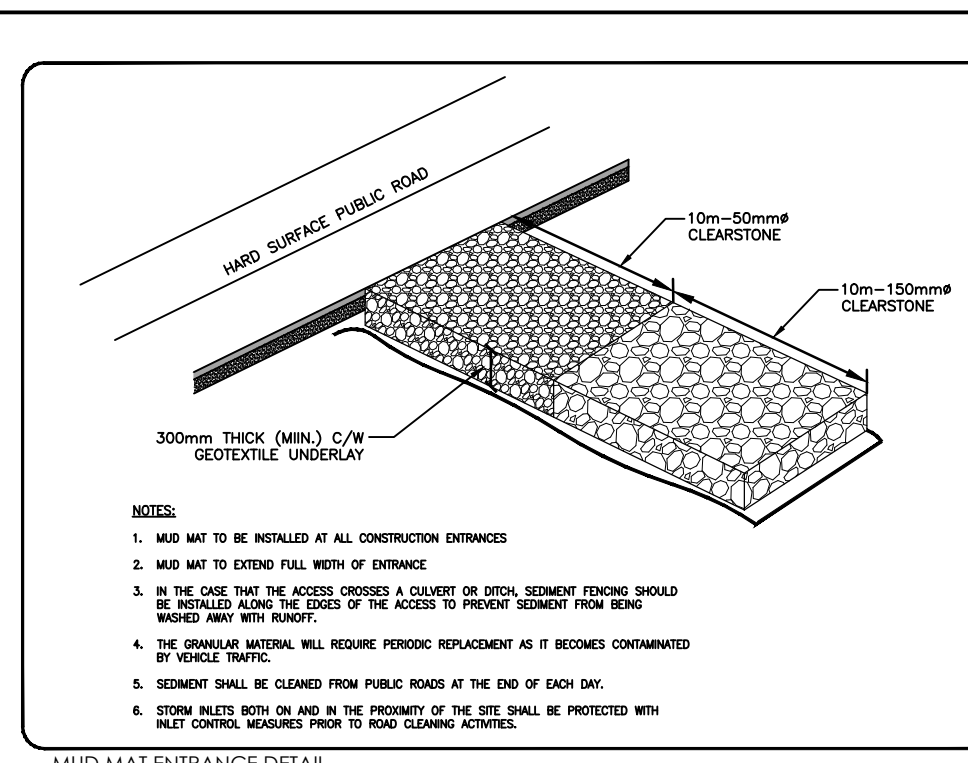
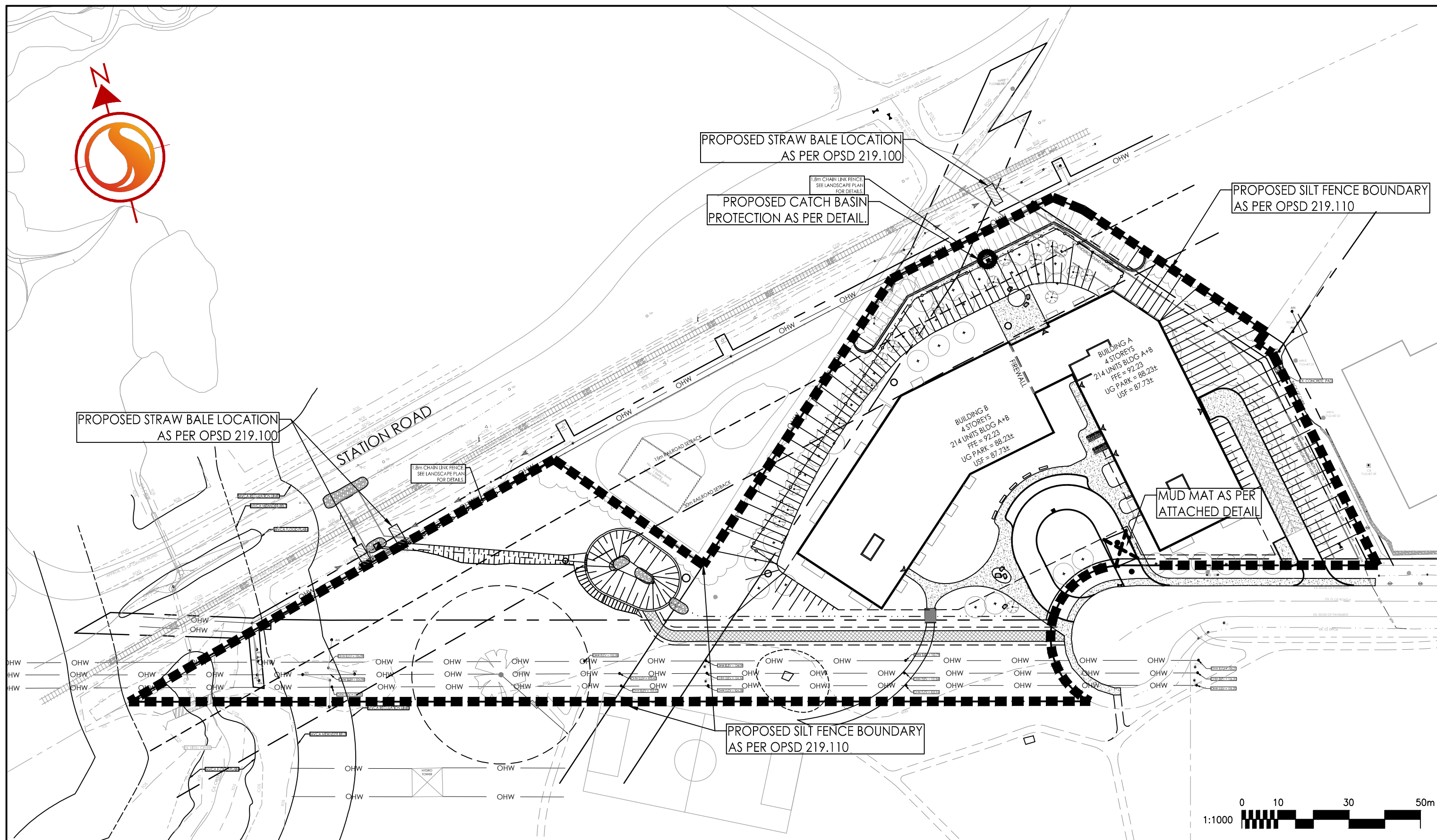

V:\06\160401570\160401570.dwg 2016/03/23 10:51 AM S:\P25\JMS

Copyright Reserved

The Contractor shall verify and be responsible for all dimensions. DO NOT scale the drawing - any errors or omissions shall be reported to Stantec without delay.  
The Copyrights to all designs and drawings are the property of Stantec. Reproduction or use for any purpose other than that authorized by Stantec is forbidden.

Legend

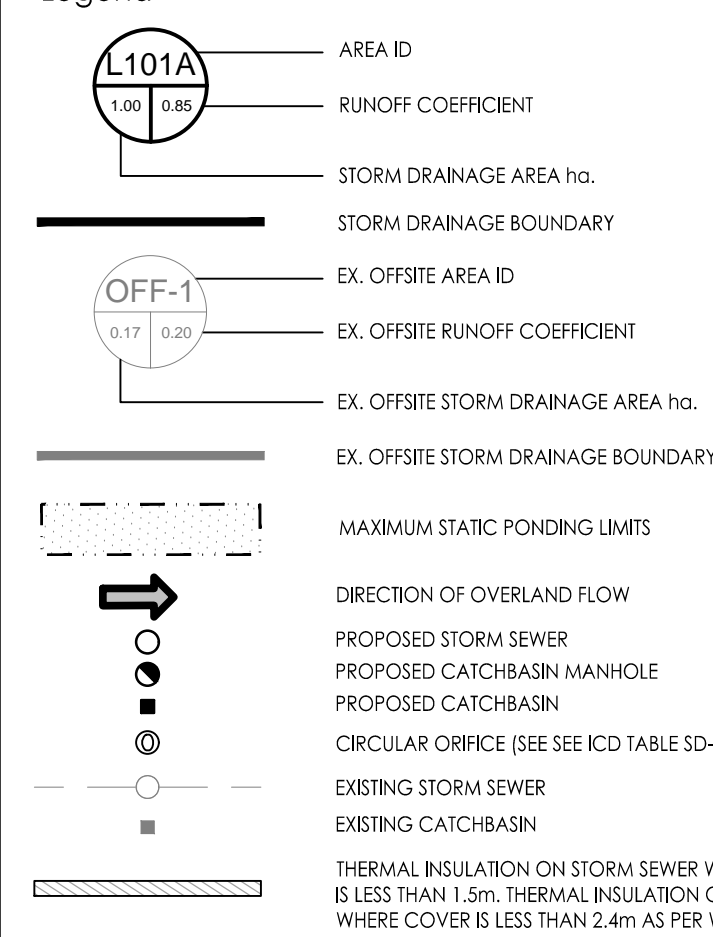

Notes

SCHEDULE OF INLET CONTROL DEVICES				
AREA ID	STRUCTURE ID	ICD TYPE	100YR HEAD (m)	100YR FLOW (L/s)
POND 1	STM OUTLET	200mm ORIFICE	0.97	83.42

SCHEDULE OF ROOF RELEASE RATES				
BUILDING	DRAIN TYPE	# DRAINS	100YR HEAD (m)	100YR RELEASE RATE (L/s)
BUILDING	WATTS ACCUFLOW	14	0.15	21.65

5	REVISED AS PER SITE PLAN AND CITY COMMENTS	MJS	DT	24.08.06
4	REVISED AS PER SITE PLAN AND CITY COMMENTS	MJS	DT	24.04.08
3	REVISED WATERMAIN SIZE	MJS	DT	22.04.08
2	REVISED AS PER CITY COMMENTS	MJS	TR	21.05.07
2	ISSUED FOR REVIEW	MJS	TR	20.11.23
Revision		By	Appd.	YY.MM.DD

File Name:	160401570 DB	MJS	ANP	MJS	20.08.17
		Dwn.	Chkd.	Dgn.	YY.MM.DD

Permit-Seal

Client/Project

BRIGIL  
  
100 STEACIE DRIVE  
  
OTTAWA, ON

Title

STORM DRAINAGE AREA PLAN

Project No.	160401570	Scale	0 5 15 25m 1:500
Drawing No.	SD-1	Sheet	8 of 9
		Revision	5

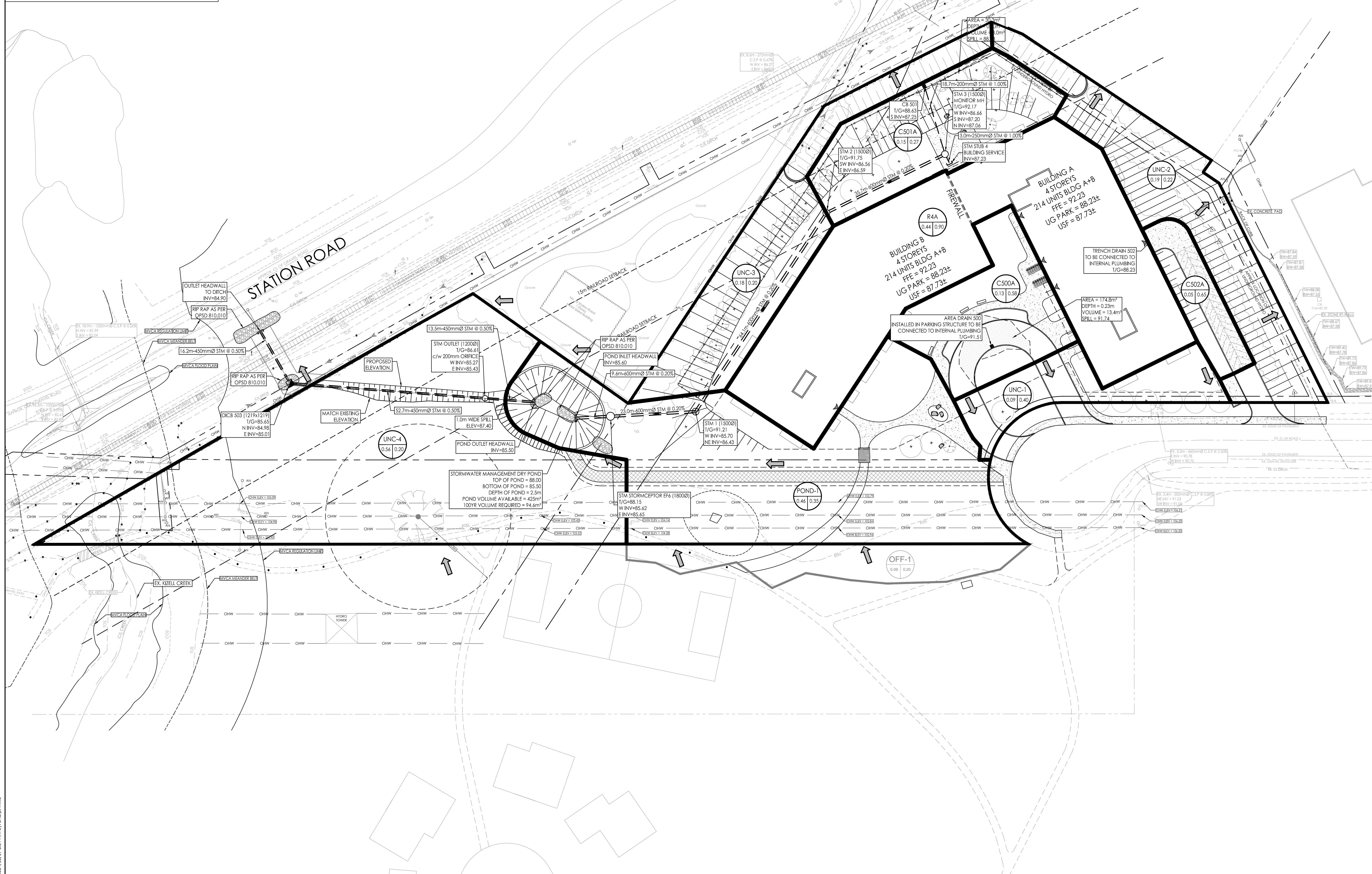
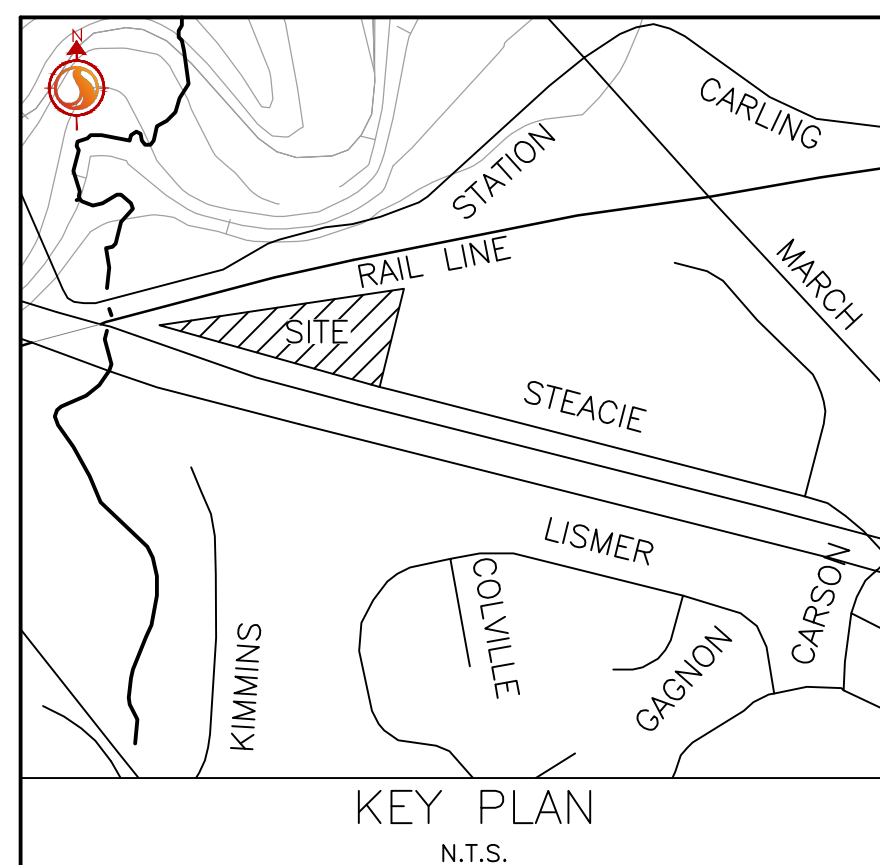



Copyright Reserved

The Contractor shall verify and be responsible for all dimensions. DO NOT scale the drawing - any errors or omissions shall be reported to Stantec without delay.  
The Copyrights to all designs and drawings are the property of Stantec. Reproduction or use for any purpose other than that authorized by Stantec is forbidden.

Legend

- SANITARY DRAINAGE AREA ID#
- POPULATION
- SANITARY DRAINAGE AREA
- PROPOSED SANITARY SEWER
- EXISTING SANITARY SEWER

Notes

5	REVISED AS PER SITE PLAN AND CITY COMMENTS	MJS	DT	24.08.06
4	REVISED AS PER SITE PLAN AND CITY COMMENTS	MJS	DT	24.04.08
3	REVISED WATERMAIN SIZE	MJS	DT	22.04.08
2	REVISED AS PER CITY COMMENTS	MJS	TR	21.05.07
1	ISSUED FOR REVIEW	MJS	TR	20.11.23
Revision		By	Appd.	YY.MM.DD

File Name:	160401570.DB	MJS	ANP	MJS	20.08.17
		Dwn.	Chkd.	Dgn.	YY.MM.DD

Permit-Seal

Client/Project

BRIGIL  
  
100 STEACIE DRIVE  
  
OTTAWA, ON

Title

SANITARY DRAINAGE AREA PLAN

Project No.	160401570	Scale	0 5 15 25m 1:500
Drawing No.	SA-1	Sheet	9 of 9
		Revision	5

