

NOTES:

1. ANY DISTURBED AREA DURING CONSTRUCTION TO BE RESTORED TO THE ORIGINAL CONDITION OR BETTER TO THE SATISFACTION OF THE AUTHORITIES HAVING JURISDICTION.
2. CONTRACTOR TO VERIFY THE PRECISE LOCATIONS AND INVERT ELEVATIONS OF EX. UNDERGROUND SERVICES AND EX. UTILITIES PRIOR TO STARTING CONSTRUCTION.
3. ALL EXISTING TREES, SHRUBS ETC. WITHIN LOTS, BLOCKS AND ROADS TO BE REMOVED, UNLESS OTHERWISE NOTED.
4. PERMISSION REQUIRED FOR WORK ON ADJACENT LANDS.
5. FOR WATERMAIN STUBS, 2.4m MIN. COVER TO BE PROVIDED.
6. ANY DISTURBED MATERIAL ENCOUNTERED BELOW THE SUBGRADE LEVEL WITHIN A BUILDING FOOTPRINT TO BE SUB-EXCAVATED AND BACKFILLED WITH COMPACTED ENGINEERED FILL AS PER GEOTECHNICAL ENGINEERS RECOMMENDATION.
7. FOR CATCHBASIN DATA, REFER TO DWG. No. 2 FOR DETAILS.
8. ALL DWELLINGS TO BE PROVIDED WITH PRESSURE REDUCING VALVES UNLESS OTHERWISE NOTED.



LEGEND

CROSS	BIKE RACK	EARTHEN (DWG. 3 FOR DETAILS)
45° BEND	STREET LIGHT STANDARD	CONCRETE SIDEWALK
LATERAL	CURB & RECESSED CURB	ASPHALT SIDEWALK
HYDRANT, VALVE & VB	CHAINLINK FENCE (1.5m UNLESS OTHERWISE NOTED)	NOISE BARRIER (2.2m)
TEE	WOODEN POST AND RAIL FENCE	CONSTRUCTION FENCE
VALVE & VC	POST AND RAIL FENCE	PROPERTY BOUNDARY
VALVE & VB	PHASING LIMITS	PROPERTY BOUNDARY
22.5° BEND	BOREHOLE (BH)	TEST PIT (TP)
11.25° BEND	CONCEPTUAL WELL LOCATION	AUGER HOLE (AH)
REDUCER	MONITORING WELL LOCATION	TOP OF FOUNDATION ELEVATION
CAP	FINISHED FLOOR ELEVATION	UNDERSIDE OF FOOTING ELEVATION
SANITARY MAINTENANCE HOLE	NUMBER OF RISERS	UNITS REQUIRING PRESSURE REDUCING VALVES
CURB INLET CATCHBASIN & LEAD	WALK-OUT UNITS	SLAB ON GRADE
CATCHBASIN/ MAINTENANCE HOLE INTERCONNECTED	OVERLAND FLOW DIRECTION	EXTERNAL OVERLAND FLOW DIRECTION
CATCH BASIN & LEADS	EMERGENCY OVERLAND FLOW DIRECTION	TACTILE WALKING SURFACE INDICATOR (AS PER CITY OF OTTAWA STD. SC6, SC7, SC7.1, SC7.2, SC7.3)
CURB STOP	PREVIOUS PHASES	EXISTING SANITARY MAINTENANCE HOLE
SINGLE SERVICE LOCATION (ST, SAN & WM)	EXISTING SANITARY MAINTENANCE HOLE	EXISTING STORM MAINTENANCE HOLE
TEE CATCHBASIN	EXISTING SANITARY MAINTENANCE HOLE	GROUNDWATER LEVEL PER PATTERSON GROUP DWG. PG0006-10
PERFORATED PIPE	EXISTING SANITARY MAINTENANCE HOLE	
ELBOW CATCHBASIN	EXISTING SANITARY MAINTENANCE HOLE	
DITCH AND CULVERT	EXISTING SANITARY MAINTENANCE HOLE	
36.0m-250# INFILTRATION TRENCH (TYP.), SEE DETAIL ON DRAWING 4.	EXISTING SANITARY MAINTENANCE HOLE	
HYDRO TRANSFORMER	EXISTING SANITARY MAINTENANCE HOLE	
RETAINING WALL (SEE NOTES ON DWG. 1 AND STRUCTURAL DWG'S FOR DETAIL)	EXISTING SANITARY MAINTENANCE HOLE	

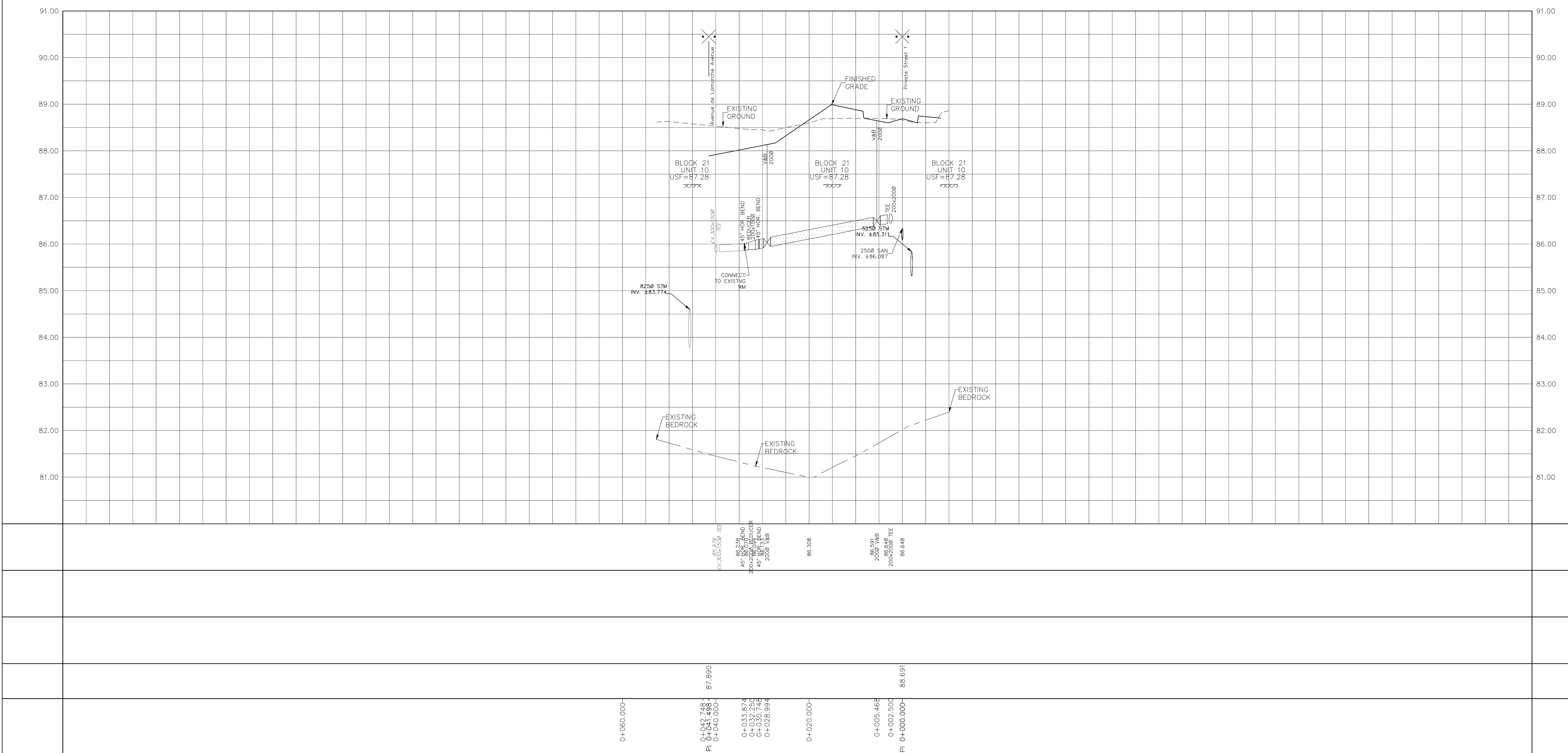

NOT FOR CONSTRUCTION

TOPOGRAPHIC INFORMATION
 TOPOGRAPHIC INFORMATION PROVIDED BY J.D. BARNES LIMITED
 PROJECT No. 16-10-116-00, SURVEYS DATED NOVEMBER 30, 2017.
 PROJECT No. 16-10-116-00_PH2, SURVEYS DATED SEPTEMBER 27, 2019.
 PROJECT No. 22-10-030-01, SURVEYS DATED JUNE 21, 2023.

SITE PLAN INFORMATION
 SITE PLAN PROVIDED BY Q4 ARCHITECTS, DATED ON AUGUST 6, 2024.

ELEVATION NOTE
 ELEVATIONS ARE GEODETIC AND ARE DERIVED FROM SITE BENCHMARK NCC CONTROL POINT 001196530229.
ELEVATION = 86.12 m

1	S.L.M.	2024-08-30	1st SUBMISSION
No.	BY	DATE	DESCRIPTION

CITY OF OTTAWA

PROJECT No. 24-1403

S. L. MERRICK
 LICENSED PROFESSIONAL ENGINEER
 100186523
 2024-08-30
 PROVINCE OF ONTARIO

CAIVAN (ORLEANS VILLAGE 2) LTD.

ORLEANS VILLAGE PHASE 4

DSEL

120 Iber Road, Unit 103
 Stittsville, ON K2S 1E9
 Tel: (613) 836-0856
 Fax: (613) 836-7153
 www.DSEL.ca

SERVICING 3

STA. 0+10.000 TO STA. 0+52.748

DRAWN BY:	C.P.B.	CHECKED BY:	S.L.M.	SHEET NO.
DESIGNED BY:	C.P.B.	CHECKED BY:	S.L.M.	16 OF 25
SCALE:	1:500	DATE:	AUGUST 2024	

CITY PLAN No. ###
CITY FILE No. ###