

NOTES:

1. ANY DISTURBED AREA DURING CONSTRUCTION TO BE RESTORED TO THE ORIGINAL CONDITION OR BETTER TO THE SATISFACTION OF THE AUTHORITIES HAVING JURISDICTION.
2. CONTRACTOR TO VERIFY THE PRECISE LOCATIONS AND INVERT ELEVATIONS OF EX. UNDERGROUND SERVICES AND EX. UTILITIES PRIOR TO STARTING CONSTRUCTION.
3. ALL EXISTING TREES, SHRUBS ETC. WITHIN LOTS, BLOCKS AND ROADS TO BE REMOVED, UNLESS OTHERWISE NOTED.
4. PERMISSION REQUIRED FOR WORK ON ADJACENT LANDS.
5. FOR WATERMAIN STUBS, 2.4m MIN. COVER TO BE PROVIDED.
6. ANY DISTURBED MATERIAL ENCOUNTERED BELOW THE SUBGRADE LEVEL WITHIN A BUILDING FOOTPRINT TO BE SUB-EXCAVATED AND BACKFILLED WITH COMPACTED ENGINEERED FILL AS PER GEOTECHNICAL ENGINEERS RECOMMENDATION.
7. FOR CATCHBASIN DATA, REFER TO DWG. No. 2 FOR DETAILS.
8. ALL DWELLINGS TO BE PROVIDED WITH PRESSURE REDUCING VALVES UNLESS OTHERWISE NOTED.

PRIVATE STREET 1

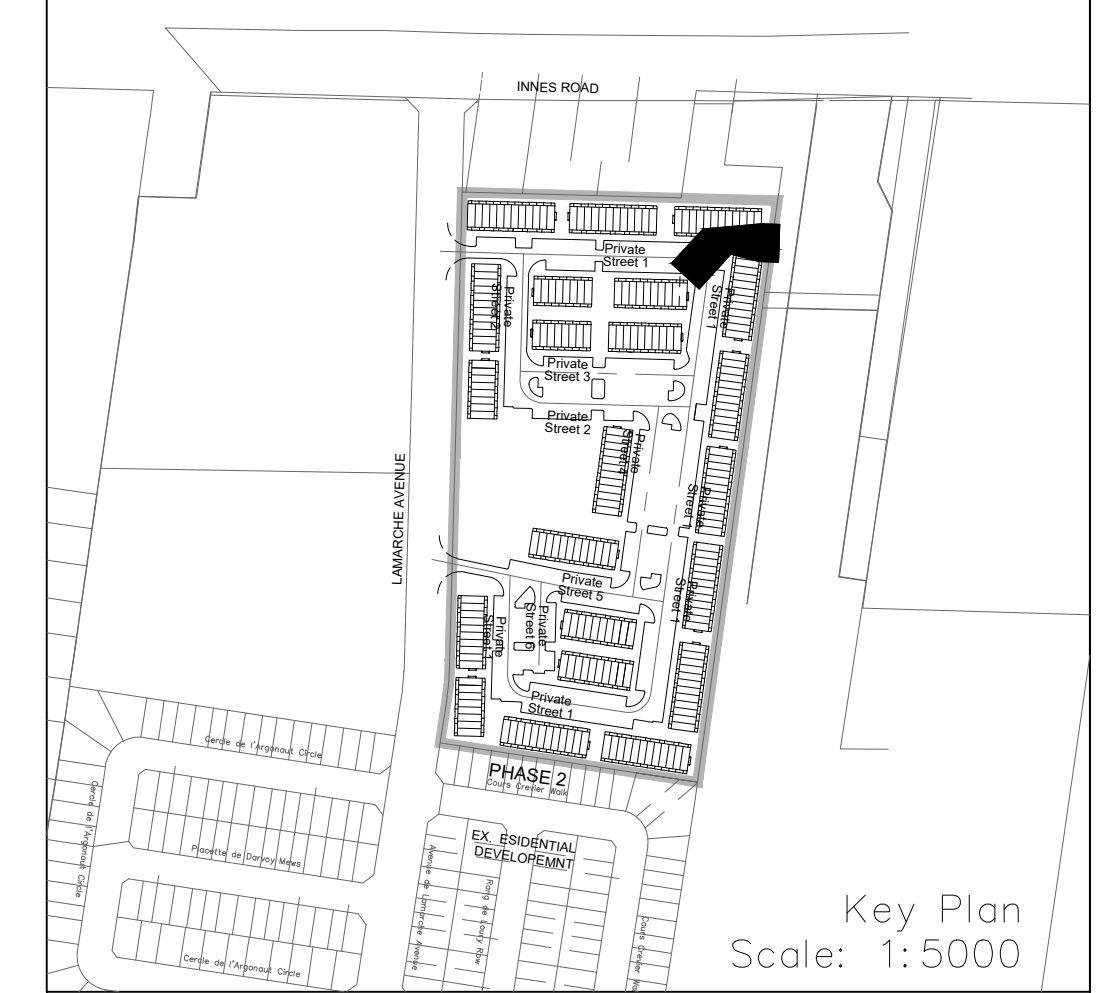
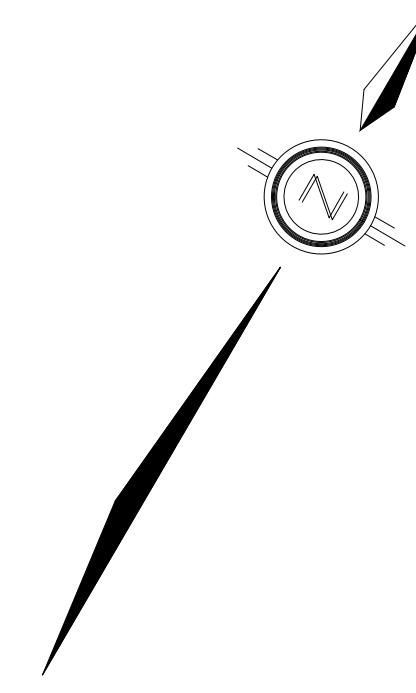
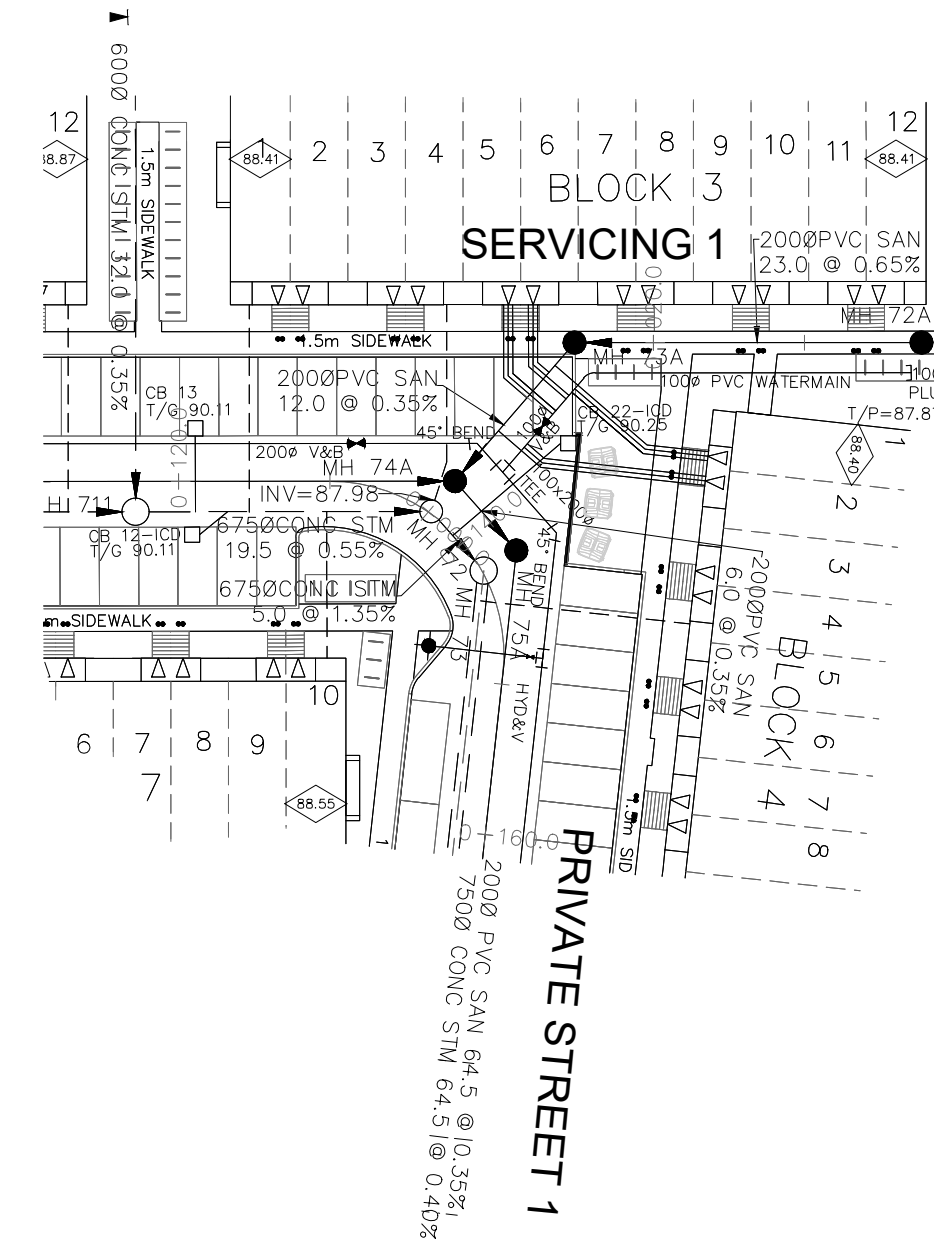

LEGEND

CROSS	BIKE RACK	EARTH BOLT (DWG. 3 FOR DETAILS)
45° BEND	STREET LIGHT STANDARD	CONCRETE SIDEWALK CURB & RECESSED CURB
LATERAL	ASPHALT SIDEWALK	CHAIN LINK FENCE (1.5m UNLESS OTHERWISE NOTED)
HYDRANT, VALVE & VB	WOODEN POST AND RAIL FENCE	NOISE BARRIER (2.2m)
TEE	CONSTRUCTION FENCE	POST AND RAIL FENCE
VALVE & VC	PHASING LIMITS	PROPERTY BOUNDARY
22.5° BEND	PHASING LIMITS	BOREHOLE (BH)
11.25° BEND	PHASING LIMITS	TEST PIT (TP)
REDUCER	PHASING LIMITS	AUGER HOLE (AH)
CAP	PHASING LIMITS	MONITORING WELL LOCATION
SANITARY MAINTENANCE HOLE	PHASING LIMITS	CONCEPTUAL WELL LOCATION
CAP	PHASING LIMITS	TOP OF FOUNDATION ELEVATION
STREET CATCHBASIN & LEAD	PHASING LIMITS	FINISHED FLOOR ELEVATION
STREET CATCHBASIN WITH CLOSED LID & LEAD	PHASING LIMITS	UNDERSIDE OF FOOTING ELEVATION
STORM MAINTENANCE HOLE	PHASING LIMITS	NUMBER OF RISERS
CURB INLET CATCHBASIN & LEAD	PHASING LIMITS	UNITS REQUIRING PRESSURE REDUCING VALVES
CATCHBASIN/ MAINTENANCE HOLE- INTERCONNECTED	PHASING LIMITS	WALK-OUT UNITS
CATCH BASIN & LEADS	PHASING LIMITS	SLAB ON GRADE
CAP	PHASING LIMITS	OVERLAND FLOW DIRECTION
CURB STOP	PHASING LIMITS	EXTERNAL OVERLAND FLOW DIRECTION
SINGLE SERVICE LOCATION (ST, SAN & WM)	PHASING LIMITS	EMERGENCY OVERLAND FLOW DIRECTION
TEE CATCHBASIN	PHASING LIMITS	TACTILE WALKING SURFACE INDICATOR (AS PER CITY OF OTTAWA STD. SC6, SC7, SC7.1, SC7.2, SC7.3)
PERFORATED PIPE	PHASING LIMITS	PREVIOUS PHASES
ELBOW CATCHBASIN	PHASING LIMITS	EXISTING SANITARY MAINTENANCE HOLE
DITCH AND CULVERT	PHASING LIMITS	EXISTING STORM MAINTENANCE HOLE
36.0m-250# INFILTRATION TRENCH (TYP.), SEE DETAIL ON DRAWING 4.	PHASING LIMITS	EXISTING SANITARY MAINTENANCE HOLE
HYDRO TRANSFORMER	PHASING LIMITS	EXISTING STORM MAINTENANCE HOLE
RETAINING WALL (SEE NOTES ON DWG. 1 AND STRUCTURAL DWG'S FOR DETAIL)	PHASING LIMITS	GROUNDWATER LEVEL PER PATERNON GROUP DWG. PG009-10

NOT FOR CONSTRUCTION

TOPOGRAPHIC INFORMATION
 TOPOGRAPHIC INFORMATION PROVIDED BY J.D. BARNES LIMITED
 PROJECT No. 16-10-116-00, SURVEYS DATED NOVEMBER 30, 2017.
 PROJECT No. 16-10-116-00_PH2, SURVEYS DATED SEPTEMBER 27, 2019.
 PROJECT No. 22-10-030-01, SURVEYS DATED JUNE 21, 2023.

SITE PLAN INFORMATION
 SITE PLAN PROVIDED BY Q4 ARCHITECTS, DATED ON AUGUST 6, 2024.

ELEVATION NOTE
 ELEVATIONS ARE GEODETIC AND ARE DERIVED FROM SITE BENCHMARK NCC CONTROL POINT 001196530229.
ELEVATION = 86.12 m

No.	BY	DATE	DESCRIPTION
1	S.L.M.	2024-08-30	1st SUBMISSION

CITY OF OTTAWA

PROJECT No. 24-1403

Licensed Professional Engineer
S. L. MERRICK
 100186523
 24-08-30
 PROVINCE OF ONTARIO

CAIVAN (ORLEANS VILLAGE 2) LTD. ORLEANS VILLAGE PHASE 4

DSEL 120 Iler Road, Unit 103
 Stittsville, ON K2S 1E9
 Tel: (613) 836-0856
 Fax: (613) 836-7183
 www.DSEL.ca

SERVICING 1 © DSEL
 STA. 0+10.000 TO STA. 0+47.737

DRAWN BY: C.P.B.	CHECKED BY: S.L.M.	SHEET NO. 14 OF 25
DESIGNED BY: C.P.B.	CHECKED BY: S.L.M.	
SCALE: 1:500	DATE: AUGUST 2024	

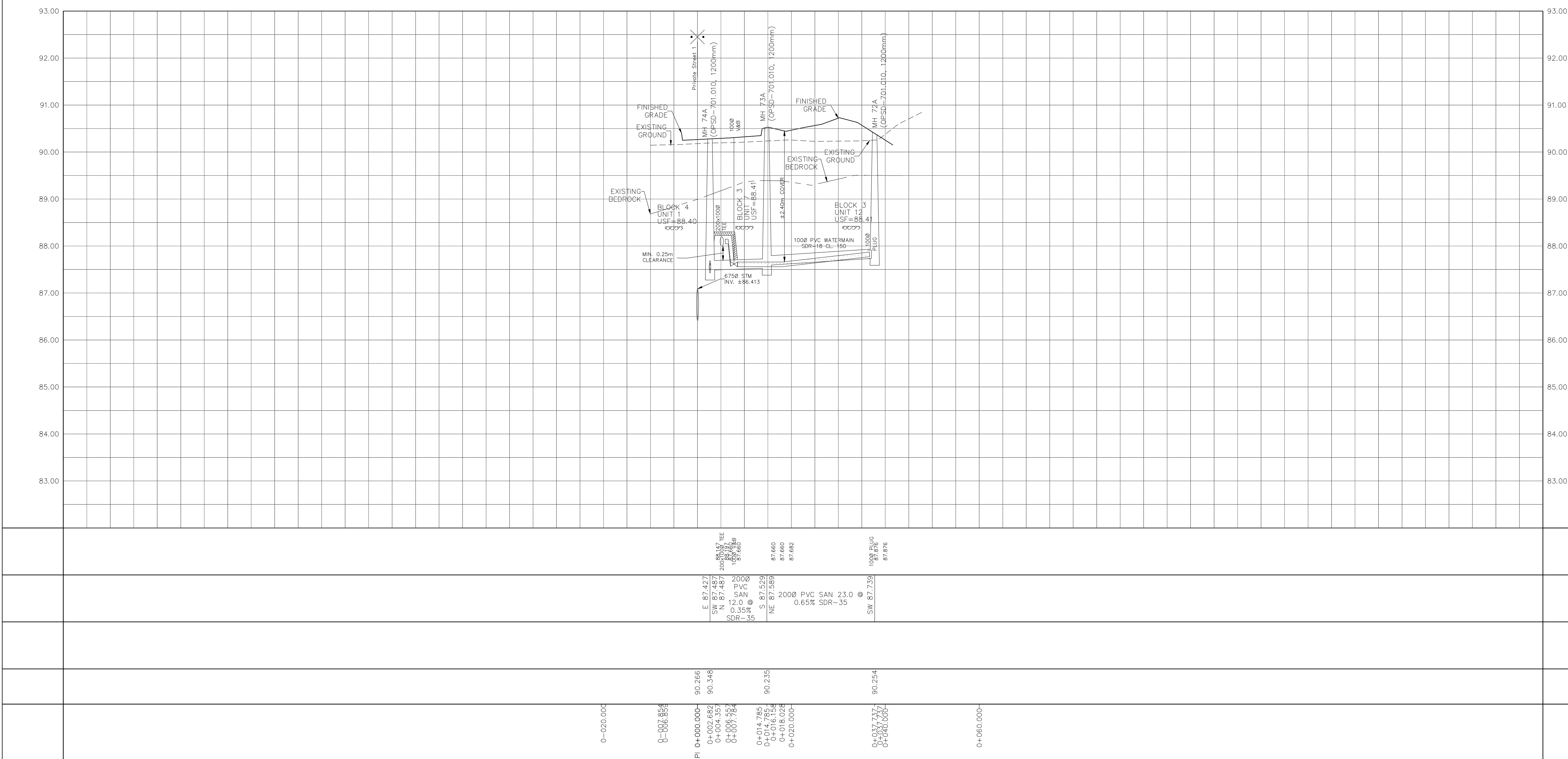

CITY PLAN No. ###
 CITY FILE No. ###