

**LEGEND**

- FFL FIRST FLOOR ELEVATION
- TOF TOP OF FOUNDATION
- USF UNDERSIDE OF FOOTING
- PROPERTY LINE
- C.R.Z CRITICAL ROOT ZONE
- CB CATCH BASIN
- CI CURB INLET CATCH BASIN
- MH STORM MANHOLE
- CB/MH CATCH-BASIN/MANHOLE
- MH STORM MANHOLE
- FH FIRE HYDRANT
- FDC FIRE DEPARTMENT CONNECTION
- EXISTING GRADE ELEVATION
- +99.99 PROPOSED GRADE ELEVATION
- 2% EXISTING SLOPE OF GRADE
- 2% PROPOSED SLOPE OF GRADE
- CENTERLINE OF SWALE
- 150mm BARRIER CURB
- D.C. DEPRESSED CURB
- SILT FENCE BARRIER
- CONCRETE
- LANDSCAPE

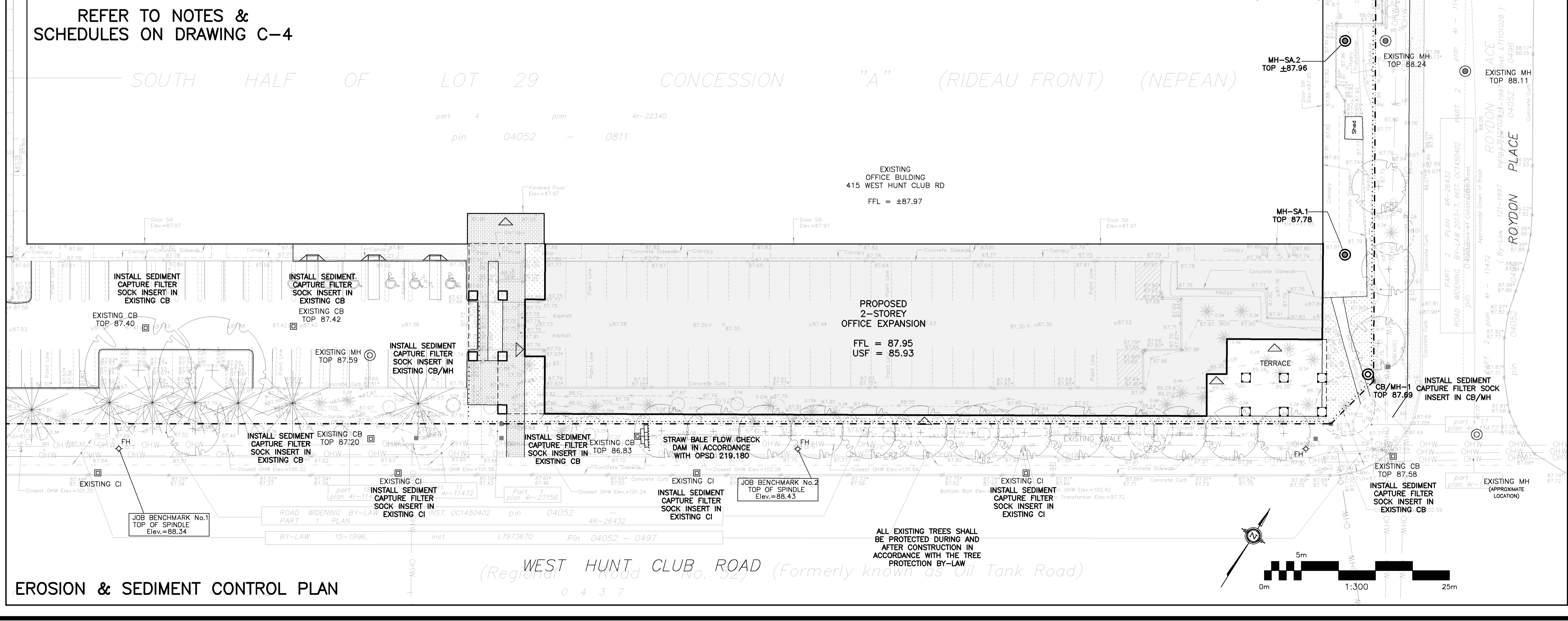
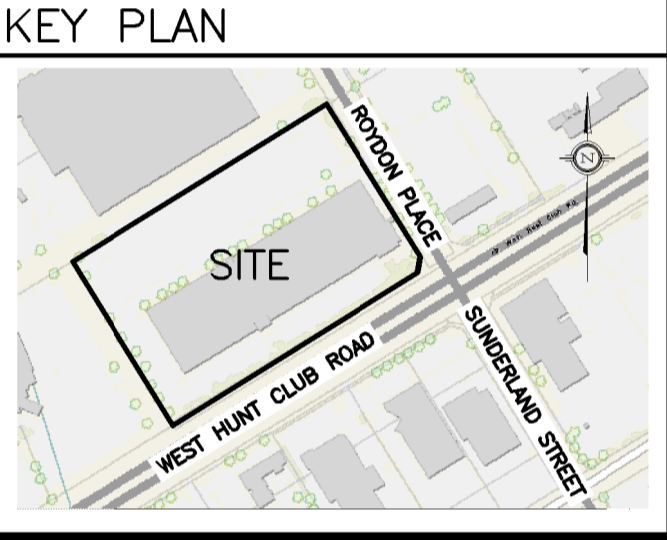

No.	DATE	REVISION
8	JAN 16-25	RE-ISSUED FOR APPROVAL
7	DEC 9-24	RE-ISSUED FOR APPROVAL
6	NOV 26-24	RE-ISSUED FOR APPROVAL
5	AUG 29-24	RE-ISSUED FOR APPROVAL
4	JUL 12-24	ISSUED FOR BUILDING PERMIT
3	JUN 19-24	RE-ISSUED FOR APPROVAL
2	DEC 21-23	ISSUED FOR APPROVAL
1	DEC 14-23	ISSUED FOR COORDINATION

**D. B. GRAY ENGINEERING INC.**  
 Stormwater Management • Grading & Drainage • Storm & Sanitary Sewers • Watermain  
 700 Long Point Circle 613-425-8044  
 Ottawa, Ontario d.gray@dbgrayengineering.com

Project  
**PROPOSED 2-STORY OFFICE EXPANSION**  
**415 WEST HUNT CLUB RD**  
 OTTAWA, ONTARIO

Drawing Title  
**POST-DEVELOPMENT PLAN & EROSION AND SEDIMENT CONTROL PLAN**

Engineer's Seal  
  
 NOT VALID UNLESS SIGNED & DATED

Drawn D.B.G.  
 H. Scale  
 V. Scale  
 Date DEC 14-23  
 Job No. 22093  
 Drawing No. **C-3 of 4**