

**POST-DEVELOPMENT DRAINAGE PLAN**

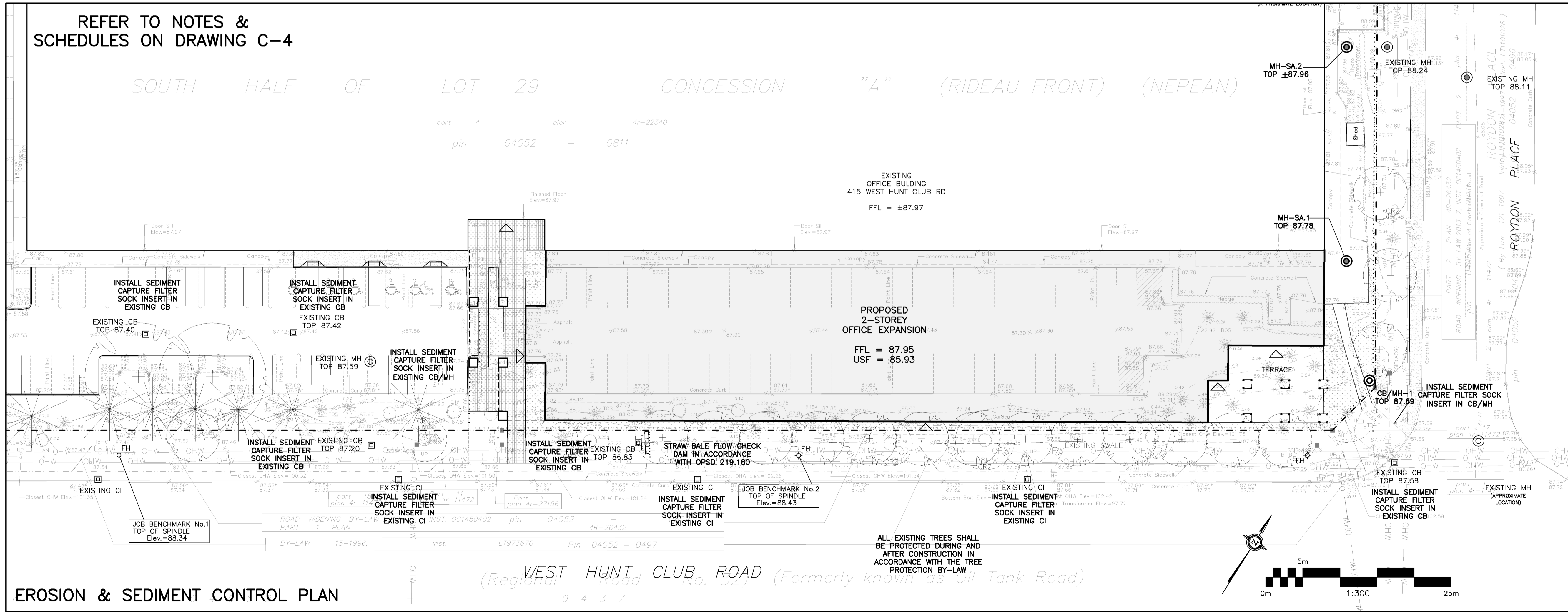

**EROSION & SEDIMENT CONTROL PLAN**

REFER TO NOTES & SCHEDULES ON DRAWING C-4

HALF OF LOT 29 CONCESSION "A" (RIDEAU FRONT) (NEPEAN)

**LEGEND**

DRAINAGE AREA

AREA (sq.m)

X XXX  
O.XX

5 YEAR RUNOFF COEFFICIENT

--- DRAINAGE BOUNDARY

**LEGEND**

- FFL FIRST FLOOR ELEVATION
- TOF TOP OF FOUNDATION
- USF UNDERSIDE OF FOOTING
- PROPERTY LINE
- C.R.Z. CRITICAL ROOT ZONE
- CB CATCH BASIN
- CI CURB INLET CATCH BASIN
- MH STORM MANHOLE
- CB/MH CATCH-BASIN/MANHOLE
- MH/MH SANY-MANHOLE
- FH FIRE HYDRANT
- FDC FIRE DEPARTMENT CONNECTION
- EXISTING GRADE ELEVATION
- +99.99 PROPOSED GRADE ELEVATION
- 2% EXISTING SLOPE OF GRADE
- 2% PROPOSED SLOPE OF GRADE
- CENTERLINE OF SWALE
- 150mm BARRIER CURB
- D.C. DEPRESSED CURB
- SILT FENCE BARRIER
- CONCRETE
- LANDSCAPE

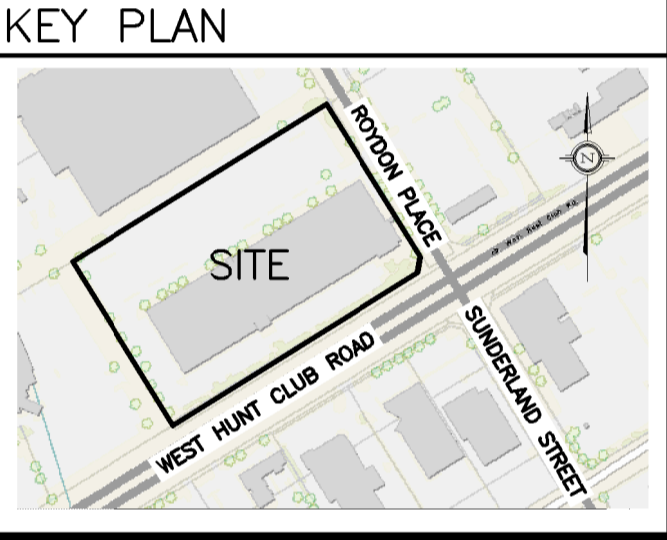

No.	DATE	REVISION
8	JAN 16-25	RE-ISSUED FOR APPROVAL
7	DEC 9-24	RE-ISSUED FOR APPROVAL
6	NOV 26-24	RE-ISSUED FOR APPROVAL
5	AUG 29-24	RE-ISSUED FOR APPROVAL
4	JUL 12-24	ISSUED FOR BUILDING PERMIT
3	JUN 19-24	RE-ISSUED FOR APPROVAL
2	DEC 21-23	ISSUED FOR APPROVAL
1	DEC 14-23	ISSUED FOR COORDINATION

**D. B. GRAY ENGINEERING INC.**  
 Stormwater Management • Grading & Drainage • Storm & Sanitary Sewers • Watermain  
 700 Long Point Circle 613-425-8044  
 Ottawa, Ontario d.gray@dbgrayengineering.com

**Project**  
 PROPOSED 2-STORY OFFICE EXPANSION  
 415 WEST HUNT CLUB RD  
 OTTAWA, ONTARIO

**Drawing Title**  
 POST-DEVELOPMENT PLAN & EROSION AND SEDIMENT CONTROL PLAN

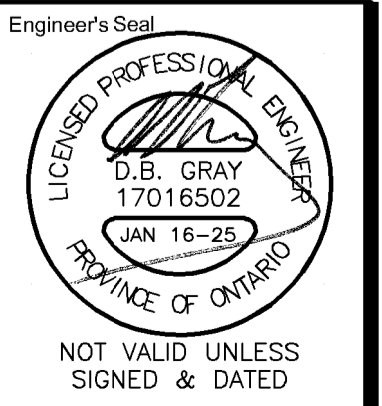

Engineer's Seal  
 H. Scale D.B.G.  
 V. Scale  
 Date DEC 14-23  
 Job No. 22093

Drawing No.  
**C-3**  
 of 4