

- GENERAL NOTES:**
- It is the responsibility of the appropriate contractor or official to report any errors, omissions or discrepancies on this plan with actual site conditions to the Landscape Architect before proceeding with construction.
 - The contractor is to notify all utility companies and authorities prior to any excavation and ascertain locations of underground services.
 - The contractor is to reinstate all areas and items damaged as a result of construction activity.
 - The contractor is to comply with all pertinent codes and by-laws.
 - The contractor is to maintain a positive surface run-off throughout the entire construction period.
 - The Landscape Architect is not responsible for subsurface conditions.
 - The contractor is to identify all existing trees to remain on site with the Landscape Architect prior to construction.
 - The contractor is to stake the proposed location of all plant material in conjunction with the Landscape Architect prior to excavation.
 - Minimum distances for selected deciduous trees are as follows:
 - Building Foundations 7.5m
 - Skewwalls 1.5m
 - Public Streets 2.5m
 - Underground Infrastructure 2.0m
 - All trees within 1m of underground utility trenches are to be excavated by hand.
 - Remove all protective wrapping from tree trunks after installation.
 - Staking of trees shall only be performed if necessary.
 - Ensure that mulch is pulled back a min. distance of 75mm from base of tree trunk.

40 YEAR CANOPY CALCULATION:

-511 m2 site area
 -1 Large tree proposed (154m2 ea.), & 4 small trees proposed (7m2 ea)
 =182m2 canopy cover =35.6% canopy cover

*Large trees calculated at 14m, small trees at 3m. We are unable to plant medium or large trees in the front yard due to existing overhead wires



KEY PLAN N.T.S.

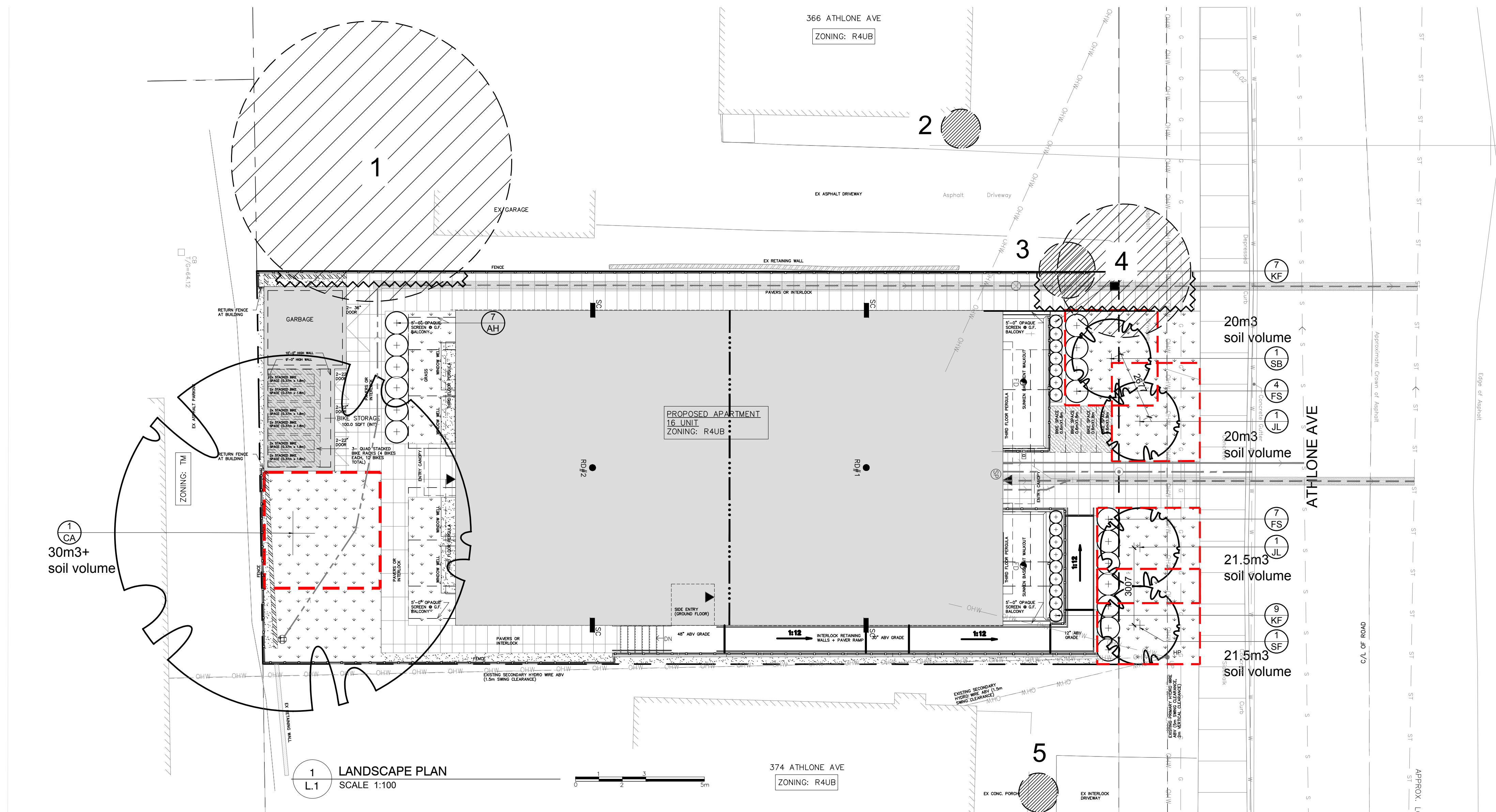

1 LANDSCAPE PLAN SCALE 1:100

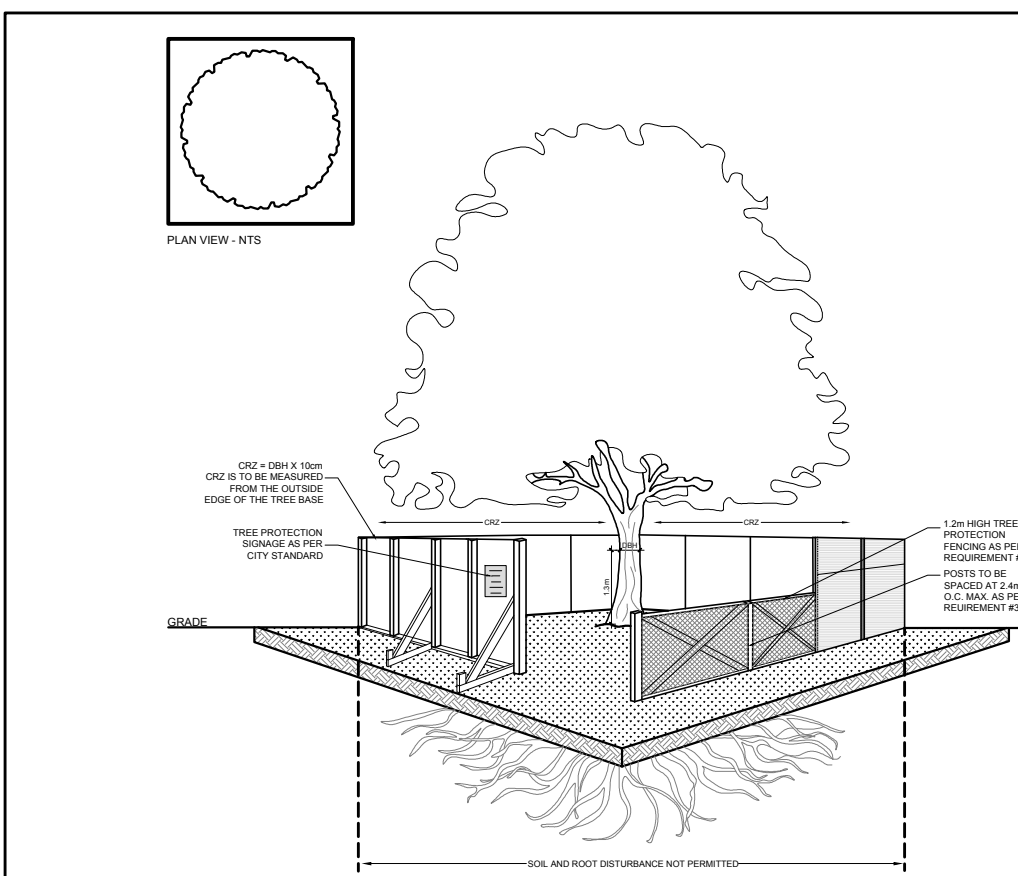

2 TREE PROTECTION FENCE SCALE: NTS

TREE PROTECTION REQUIREMENTS

- PROTECT ALL NEW ACTIVITY WITHIN THE CRITICAL ROOT ZONE (CRZ) + 10% DRAINAGE OF A TREE. TREE PROTECTION FENCING MUST BE INSTALLED IMMEDIATELY. THE CRITICAL ROOT ZONE AND REMAIN IN PLACE UNTIL THE WORK IS COMPLETE.
- LANDSCAPE PLANS APPROVED BY CITY FORESTRY STAFF, FOR WORKS WITHIN THE CRZ, OR EQUIPMENT INCLUDING OUTRIGGERS, SHALL NOT BE PLACED WITHIN THE CRZ. NOTICES OR POSTERS TO THE TREE: DO NOT MAKE OR COVER THE EXISTING GRADE, TUNNEL, OR NEW WORKINGS. DO NOT DAMAGE THE ROOT SYSTEM, TRUNK, OR BRANCHES OF ANY TREE. EQUIPMENT ARE NOT DIRECTED TOWARD ANY TREE. DO NOT CUTTER, BURN, OR SIGNIFICANTLY CHANGE LANDSCAPING.
- TREE PROTECTION FENCING MUST BE AT LEAST 1.3m IN HEIGHT AND COVERED WITH 100mm MULCH OR HOARDING, OR BRANDED ON A 2"X4" WOOD FRAME WITH 100mm MULCH. FENCING SHALL BE INSTALLED AND LOCATED AS PER ALL TRENCH, SIGNATURE AND LOCATION CHANGES. TREES IN SIGNATURE AND INSTALLATION MUST REMAIN UNCHANGED TO EXISTING ROOTS (SEE DETAIL).
- IF THE CRITICAL ROOT ZONE PROTECTION FENCING MUST BE DETERMINED BY AN ARBORIST AND/OR TRIMMED BY A CITY FORESTRY STAFF. THE CRITICAL ROOT ZONE AND REMAIN IN PLACE UNTIL THE WORK IS COMPLETE. THE PLAN AND CONSTRUCTION FENCING MUST BE APPROVED BY CITY FORESTRY STAFF PRIOR TO THE COMMENCEMENT OF WORK.
- IF THE CRITICAL ROOT ZONE PROTECTION FENCING MUST BE DETERMINED BY AN ARBORIST AND/OR TRIMMED BY A CITY FORESTRY STAFF. THE CRITICAL ROOT ZONE AND REMAIN IN PLACE UNTIL THE WORK IS COMPLETE. THE PLAN AND CONSTRUCTION FENCING MUST BE APPROVED BY CITY FORESTRY STAFF PRIOR TO THE COMMENCEMENT OF WORK.

BY-LAWS:
 ALL CITY OWNED TREES ARE PROTECTED UNDER THE MUNICIPAL TREES AND LANDSCAPE PROTECTION BY-LAW. PRIVATELY OWNED TREES GREATER THAN 100mm IN DBH ARE PROTECTED UNDER THE MUNICIPAL TREES AND LANDSCAPE PROTECTION BY-LAW. PRIVATELY OWNED TREES GREATER THAN 100mm IN DBH ARE PROTECTED UNDER THE MUNICIPAL TREES AND LANDSCAPE PROTECTION BY-LAW. PRIVATELY OWNED TREES GREATER THAN 100mm IN DBH ARE PROTECTED UNDER THE MUNICIPAL TREES AND LANDSCAPE PROTECTION BY-LAW.

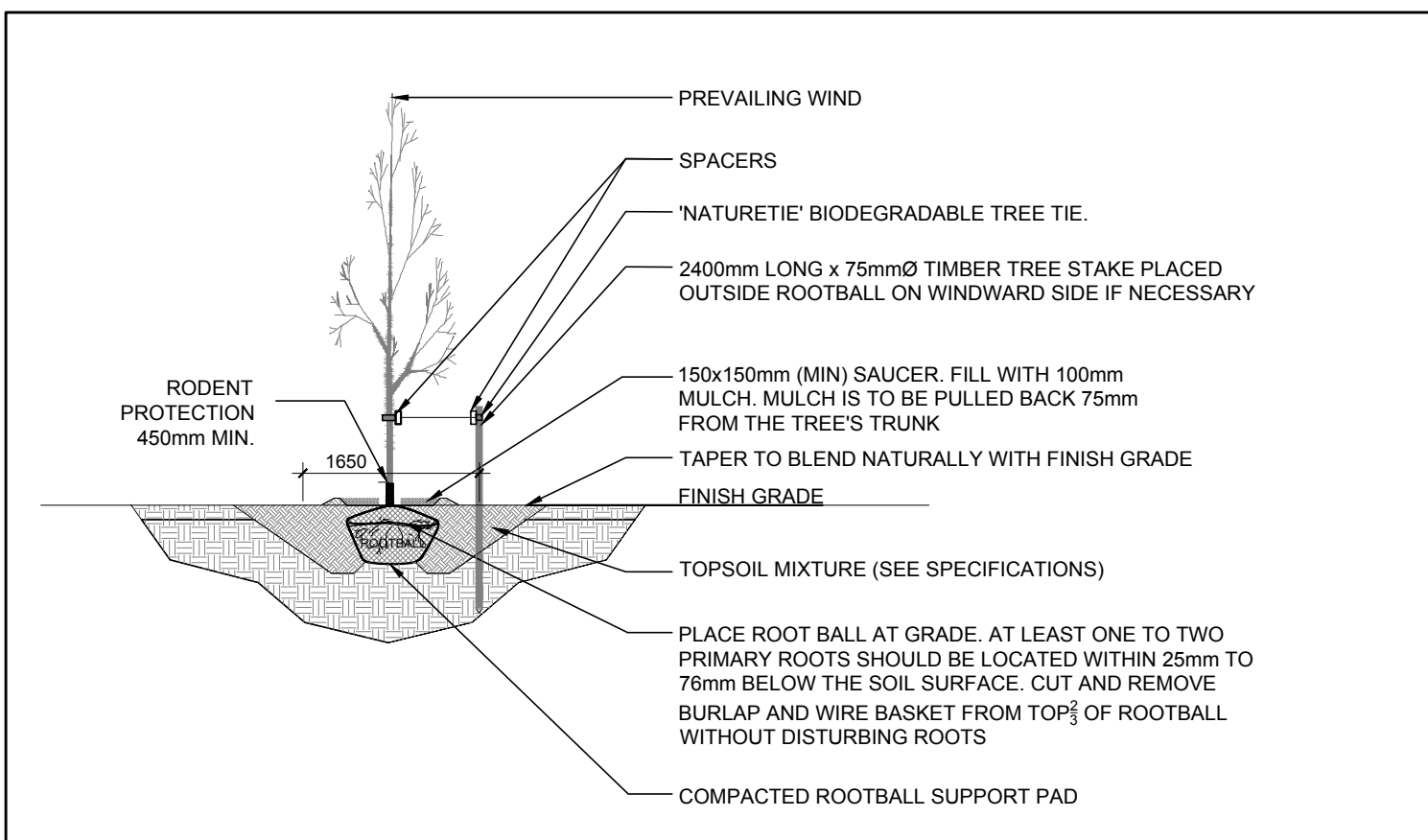

3 DECIDUOUS TREE PLANTING SCALE: NTS

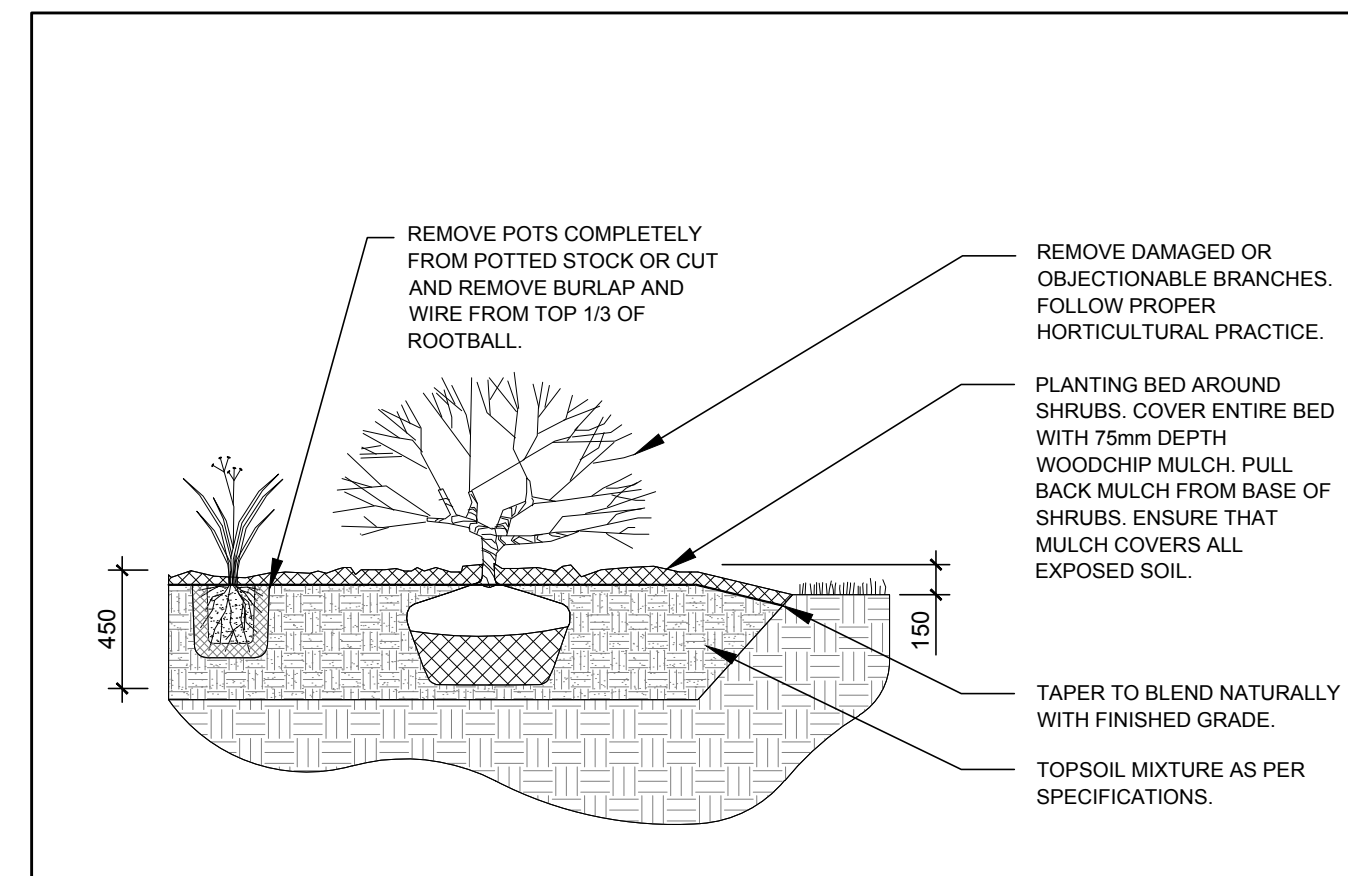

4 SHRUB / ORNAMENTAL GRASS PLANTING SCALE: NTS

KEY	BOTANICAL NAME	COMMON NAME	SIZE	CRITICAL ROOT ZONE	OWNERSHIP	CONDITION	ACTION
1	<i>Acer platanoides</i>	Norway Maple	550mm DBH	5500mm	366 Athlone	GOOD-TAR SPOT	TO REMAIN
2	<i>Thuja occidentalis 'Fastigiata'</i>	Pyramidal Cedar	150mm DBH	1500mm	366 Athlone	GOOD	TO REMAIN
3	<i>Ulmus americana</i>	American Elm	170mm DBH	1700mm	366 & 370 Athlone	FAIR-70% CAN.	TO REMAIN
4	<i>Acer platanoides</i>	Norway Maple	220,260mm DBH	2600mm	366 Athlone / City	GOOD-TAR SPOT	TO REMAIN
5	<i>Thuja occidentalis 'Fastigiata'</i>	Pyramidal Cedar	150mm DBH	1500mm	374 Athlone	GOOD	TO REMAIN

KEY	QTY	BOTANICAL NAME	COMMON NAME	SIZE	CONDITION	REMARKS
TREES						
JL	2	<i>Syringa reticulata</i>	Japanese Tree Lilac	50mm cal.	B&B	Proposed on City property
* SB	1	<i>Amelanchier canadensis</i>	Shadlow Serviceberry	50mm cal.	B&B	Proposed on private property
* SF	1	<i>Amelanchier laevis 'JFS-ARB'</i>	Spring Flurry Serviceberry	50mm cal.	B&B	Proposed on City property
* CA	1	<i>Catalpa speciosa</i>	Northern Catalpa	50mm cal.	B&B	Proposed on private property
SHRUBS						
AH	7	<i>Hydrangea arborescens 'Annabelle'</i>	Annabelle Hydrangea	1 gallon pot	Potted	Space 1000mm o.c.
* FS	11	<i>Rhus aromatica</i>	Fragrant Sumac	600mm ht.	Potted	Space 1000mm o.c.
ORNAMENTAL GRASSES						
KF	16	<i>Calamagrostis 'Karl Foerster'</i>	Karl Foerster Grass	250mm pot.	Potted	Space 800mm o.c.

CLIENT
JERSEY DEVELOPMENTS INC.

CONSULTANTS
 ARCHITECTS:
GRANT+HENLEY Design Group
 Tel: 613-291-0252

CIVIL ENGINEERS:
T.L. Mak Engineering Consultants Ltd.
 1455 Youville Drive, Suite 218
 Ottawa, ON, K1C 6Z7
 Tel: 613-837-5516

LEGEND

- SOIL VOLUME AREA
- PROPOSED DECIDUOUS TREE
- 40 YEAR CANOPY PROJECTION
- PROPOSED SHRUBS / ORNAMENTAL GRASSES
- PROPOSED SOD
- PROPOSED RIVERSTONE MULCH
- PROPOSED PAVERS
- PROPOSED CONCRETE
- TREE PROTECTION FENCE
- EXTENT OF CRITICAL ROOT ZONE
- EXISTING TREE TO REMAIN

10					
9					
8					
7					
6					
5					
4					
3	REVISED PER CITY COMMENTS	10/30/2024	ML	JL	
2	REVISED PER CIVIL DRAWING	06/20/2024	ML	JL	
1	ISSUED FOR DISCUSSION AND REVIEW	03/07/2024	ML	JL	

No. Issue Date M/M/YY DR. CK

JAMES B. LENNOX & ASSOCIATES INC. LANDSCAPE ARCHITECTS
 3332 CARLING AVE. OTTAWA, ONTARIO K2H 5A8
 Tel: (613) 732-5168 Fax: (866) 343-3942

PROJECT
 PROPOSED 16 UNIT APARTMENT
 370 ATHLONE AVENUE, OTTAWA ON

DRAWING
 LANDSCAPE PLAN

STAMP

SCALE
 AS SHOWN

START DATE
 FEBRUARY 2024

PROJECT NO.
 24MIS2408

DRAWING NO.
L.1

PLOT SIZE ARCH-D