

- GENERAL NOTES:**
- It is the responsibility of the appropriate contractor or official to report any errors, omissions or discrepancies on this plan with actual site conditions to the Landscape Architect before proceeding with construction.
 - The contractor is to notify all utility companies and authorities prior to any excavation and ascertain locations of underground services.
 - The contractor is to reinstate all areas and items damaged as a result of construction activity.
 - The contractor is to comply with all pertinent codes and by-laws.
 - The contractor is to maintain a positive surface run-off throughout the entire construction period.
 - The Landscape Architect is not responsible for subsurface conditions.
 - The contractor is to identify all existing trees to remain on site with the Landscape Architect prior to construction.
 - The contractor is to stake the proposed location of all plant material in conjunction with the Landscape Architect prior to excavation.
 - Minimum distances for selected deciduous trees are as follows:
 - Building Foundations 7.5m
 - Sidewalks 1.5m
 - Public Streets 2.5m
 - Underground Infrastructure 2.0m
 - All trees within 1m of underground utility trenches are to be excavated by hand.
 - Remove all protective wrapping from tree trunks after installation.
 - Staking of trees shall only be performed if necessary.
 - Ensure that mulch is pulled back a min. distance of 75mm from base of tree trunk.

40 YEAR CANOPY CALCULATION:

-511 m2 site area

-1 Large tree proposed (154m2 ea.), & 4 small trees proposed (7m2 ea)

=182m2 canopy cover =35.6% canopy cover

*Large trees calculated at 14m, small trees at 3m. We are unable to plant medium or large trees in the front yard due to existing overhead wires



KEY PLAN N.T.S.

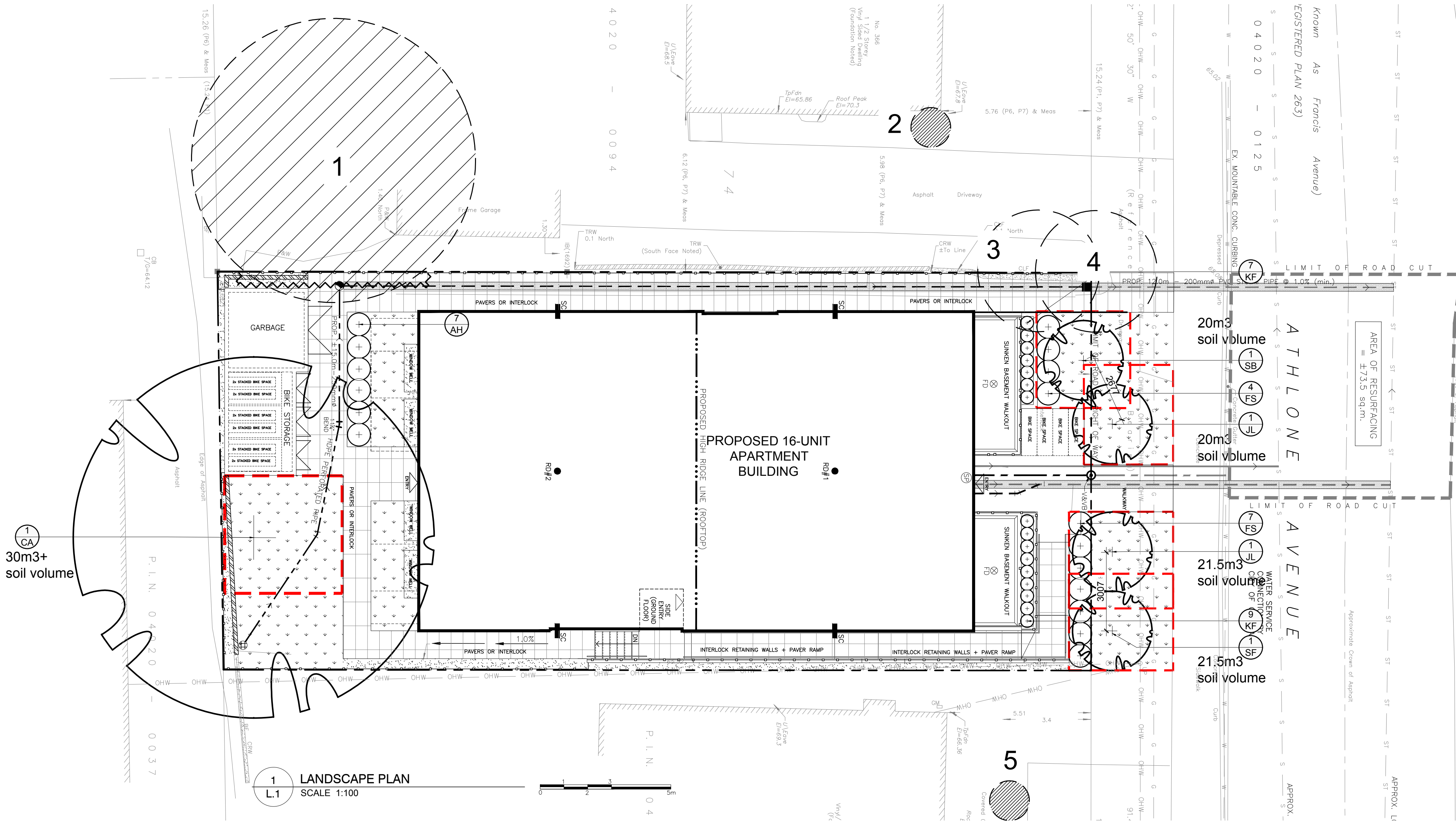

LANDSCAPE PLAN
SCALE 1:100

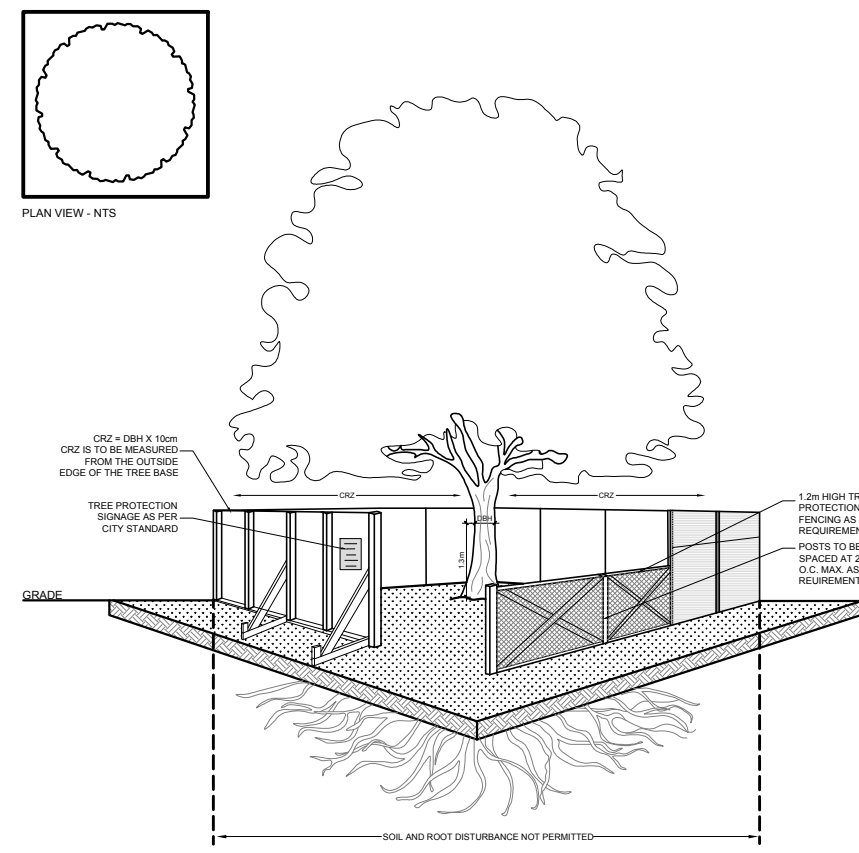

TREE PROTECTION FENCE
SCALE: NTS

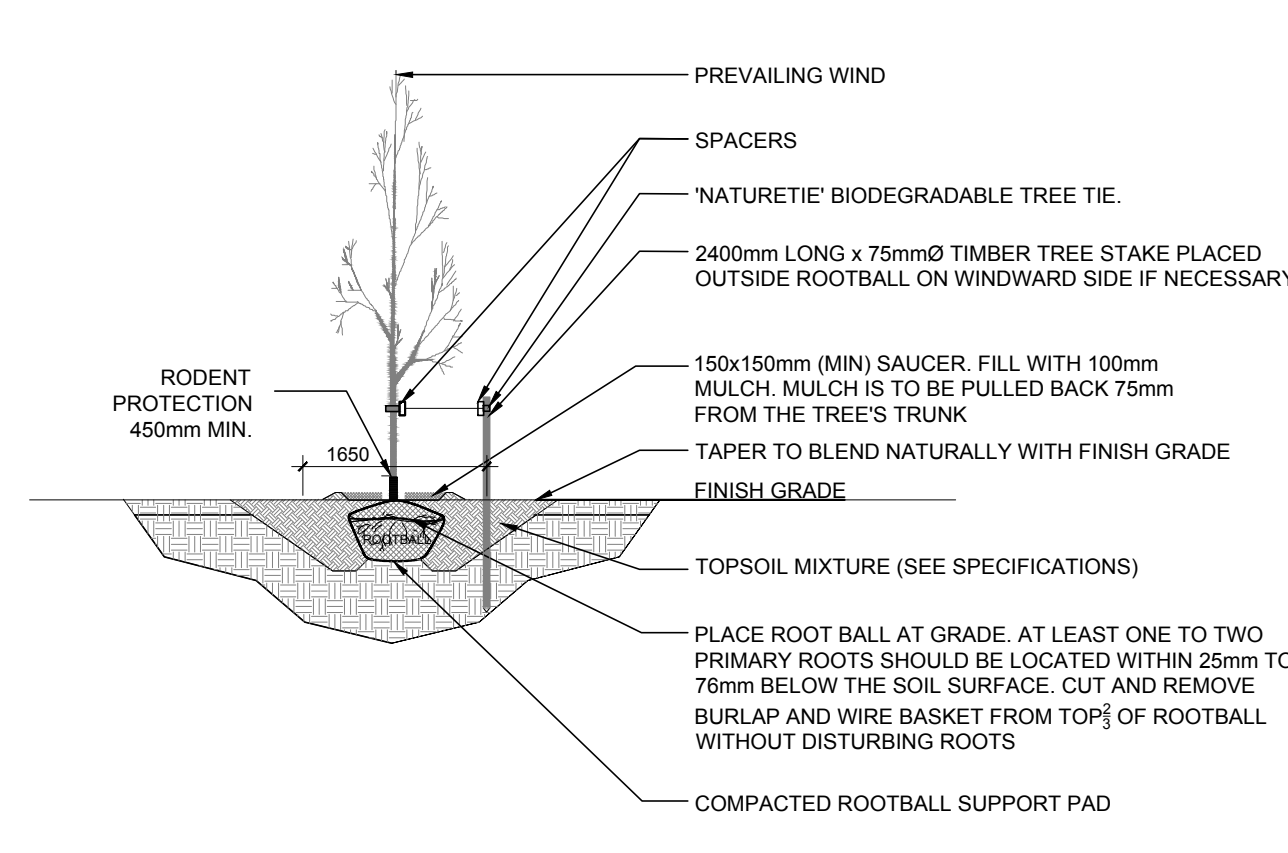

DECIDUOUS TREE PLANTING
SCALE: NTS

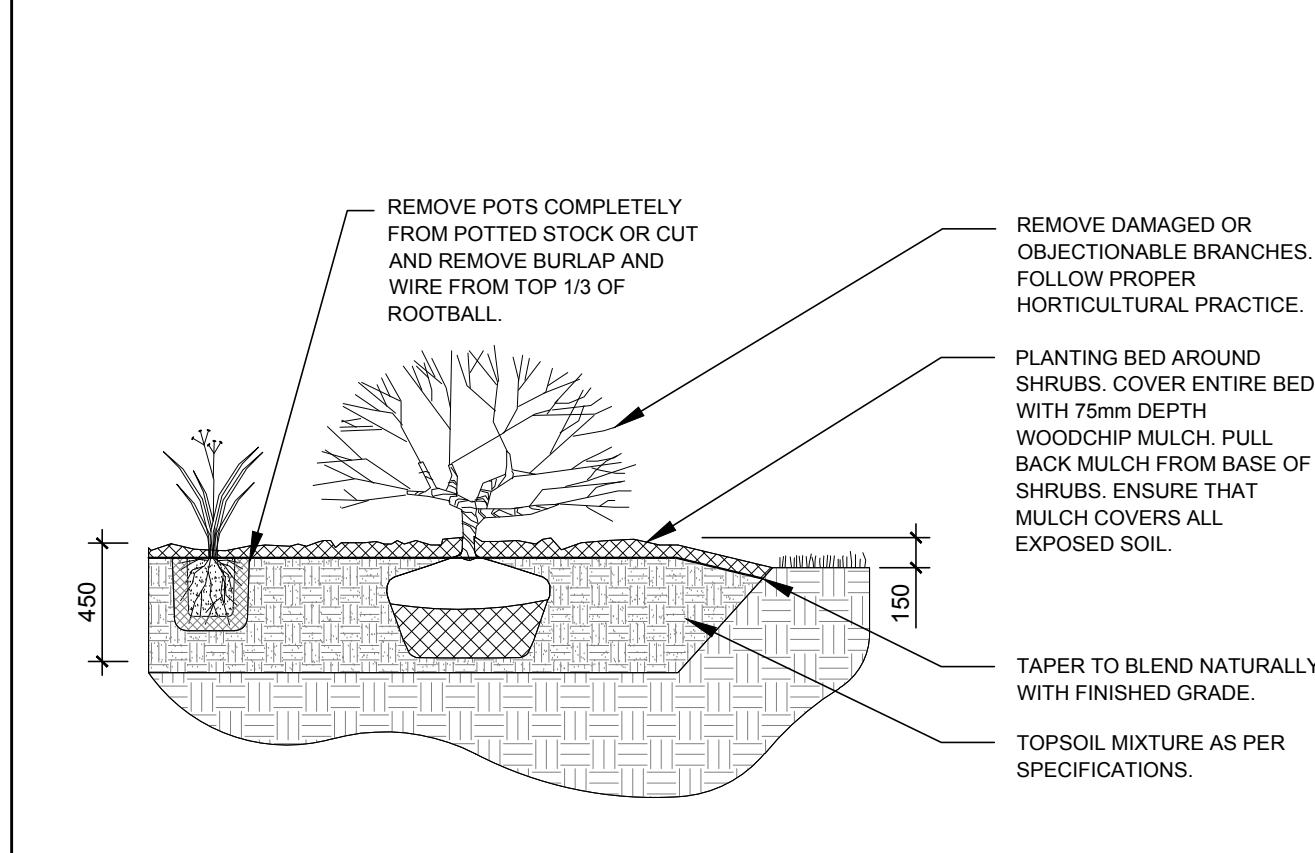

SHRUB / ORNAMENTAL GRASS PLANTING
SCALE: NTS

EXISTING TREE LIST #

KEY	BOTANICAL NAME	COMMON NAME	SIZE	CRITICAL ROOT ZONE	OWNERSHIP	CONDITION	ACTION
1	<i>Acer platanoides</i>	Norway Maple	550mm DBH	5500mm	366 Athlone	GOOD-TAR SPOT	TO REMAIN
2	<i>Thuja occidentalis 'Fastigiata'</i>	Pyramidal Cedar	150mm DBH	1500mm	366 Athlone	GOOD	TO REMAIN
3	<i>Ulmus americana</i>	American Elm	170mm DBH	1700mm	366 & 370 Athlone	FAIR-70% CAN.	TO BE REMOVED
4	<i>Acer platanoides</i>	Norway Maple	220,260mm DBH	2600mm	366 Athlone / City	GOOD-TAR SPOT	TO BE REMOVED
5	<i>Thuja occidentalis 'Fastigiata'</i>	Pyramidal Cedar	150mm DBH	1500mm	374 Athlone	GOOD	TO REMAIN

PROPOSED PLANT LIST

KEY	QTY	BOTANICAL NAME	COMMON NAME	SIZE	CONDITION	REMARKS
TREES						
JL	2	<i>Syringa reticulata</i>	Japanese Tree Lilac	50mm cal.	B&B	Proposed on City property
* SB	1	<i>Amelanchier canadensis</i>	Shadlow Serviceberry	50mm cal.	B&B	Proposed on private property
* SF	1	<i>Amelanchier laevis 'JFS-ARB'</i>	Spring Flurry Serviceberry	50mm cal.	B&B	Proposed on City property
* CA	1	<i>Catalpa speciosa</i>	Northern Catalpa	50mm cal.	B&B	Proposed on private property
SHRUBS						
AH	7	<i>Hydrangea arborescens 'Annabelle'</i>	Annabelle Hydrangea	1 gallon pot	Potted	Space 1000mm o.c.
* FS	11	<i>Rhus aromatica</i>	Fragrant Sumac	600mm ht.	Potted	Space 1000mm o.c.
ORNAMENTAL GRASSES						
KF	16	<i>Calamagrostis 'Karl Foerster'</i>	Karl Foerster Grass	250mm pot.	Potted	Space 800mm o.c.
*NATIVE TO ONTARIO						

ANDREW MCCREIGHT
MANAGER, DEVELOPMENT REVIEW CENTRAL
PLANNING, DEVELOPMENT & BUILDING SERVICES
DEVELOPMENT DEPARTMENT, CITY OF OTTAWA

APPROVED

By Andrew McCreight at 12:18 pm, Mar 18, 2025

JERSEY DEVELOPMENTS INC.

GRANT+HENLEY Design Group
Tel: 613-291-0252

T.L. Mak Engineering Consultants Ltd.
1455 Youville Drive, Suite 218
Ottawa, ON K1C 6Z7
Tel: 613-837-5516

LEGEND

- SOIL VOLUME AREA
- PROPOSED DECIDUOUS TREE
- 40 YEAR CANOPY PROJECTION
- PROPOSED SHRUBS / ORNAMENTAL GRASSES
- PROPOSED SOD
- PROPOSED RIVERSTONE MULCH
- PROPOSED PAVERS
- PROPOSED CONCRETE
- TREE PROTECTION FENCE
- EXTENT OF CRITICAL ROOT ZONE
- EXISTING TREE TO REMAIN
- EXISTING TREE TO BE REMOVED

10					
9					
8					
7					
6					
5					
4	TREES 3&4 SHOWN AS TO BE REMOVED	01/27/2025	ML	JL	
3	REVISED PER CITY COMMENTS	10/30/2024	ML	JL	
2	REVISED PER CIVIL DRAWING	06/20/2024	ML	JL	
1	ISSUED FOR DISCUSSION AND REVIEW	03/07/2024	ML	JL	
No.	Issue	Date	MM/DD/YY	DR	CK
JAMES B. LENNOX & ASSOCIATES INC.					
LANDSCAPE ARCHITECTS					
3332 CARLING AVE. OTTAWA, ONTARIO K2J 5A8					
Tel: (613) 722-5168 Fax: (866) 343-3942					

PROPOSED 16 UNIT APARTMENT
370 ATHLONE AVENUE, OTTAWA ON

LANDSCAPE PLAN

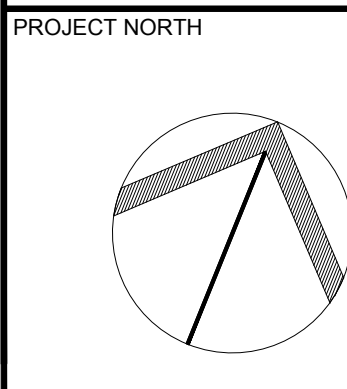
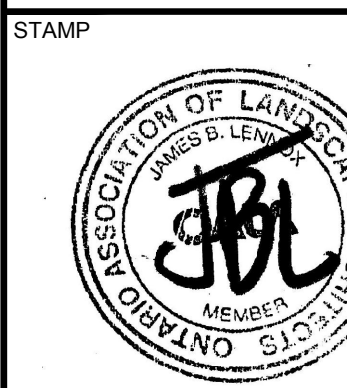

SCALE

AS SHOWN

START DATE

FEBRUARY 2024

PROJECT NO.

24MIS2408

DRAWING NO.

L.1

PLOT SIZE ARCH-D

#19203

D07-12-24-0114