

YORK STREET

GEORGE STREET

DALHOUSIE STREET

1
L.1

TREE CONSERVATION REPORT & LANDSCAPE PLAN AS VIEWED FROM ABOVE
SCALE 1:250

EXISTING TREE TO BE REMOVED						
KEY	QTY	BOTANICAL NAME	COMMON NAME	SIZE	CONDITION	REMARKS
TREES						
HL	1	Gleditsia triacanthos	Honey Locust	125mmø	Good	Off Site
HB	1	Celtis occidentalis	Hackberry	60mmø	Good	Off Site
SE	3	Ulmus pumila	Siberian Elm	60-250mmø	Good	Off Site

PROPOSED PLANT LIST					
KEY	QTY	BOTANICAL NAME	COMMON NAME	SIZE	REMARKS
TREES					
AM	1	Acer ginnala multistem	Multistem Amur Maple	50mm ø	Refer to detail 3/L.1
HL	9	Gleditsia triacanthos 'Skyline'	Skyline Honey Locust	50mm ø	Branching at 2.1m, Refer to detail 4/L.1
SM	3	Acer pensylvanicum	Striped Maple	50mm ø	
SHRUBS & ORNAMENTAL GRASS					
BD	8	Juniperus sabina 'Blue Danube'	Blue Danube Juniper	600 mm spr.	Potted 1000 mm o.c.
BH	9	Juniperus horizontalis 'Bar Harbor'	Bar Harbor Juniper	500 mm spr.	Potted 800 mm o.c.
DW	11	Cornus stolonifera	Red Osier Dogwood	1800 mm sp.	Potted 1000 mm o.c.
KF	16	Calamagrostis 'Karl Foerster'	Karl Foerster Grass	250 mm pot	Potted 800 mm o.c.
YE	11	Taxus cuspidata 'Capitata'	Upright Japanese Yew	600 mm spr.	Potted 1200 mm o.c.
SF	27	Sorbaria sorbifolia 'Sem'	Sem False Spirea	600 mm ht.	Potted 1000 mm o.c.

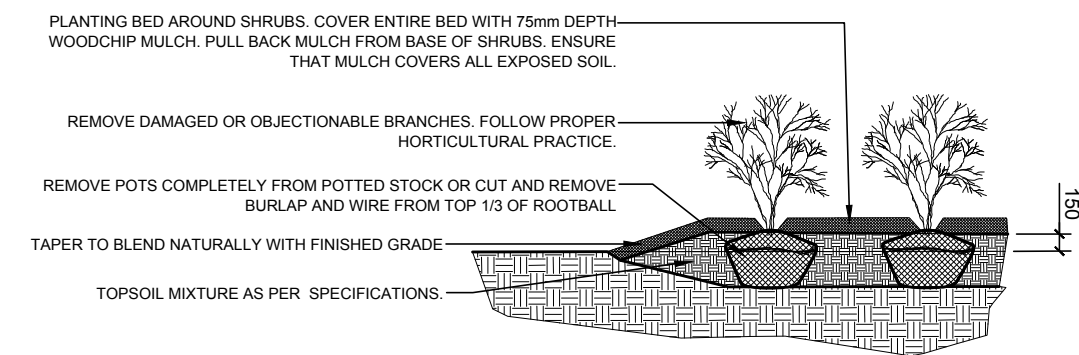

2
L.1

SHRUB PLANTING
SCALE N.T.S.

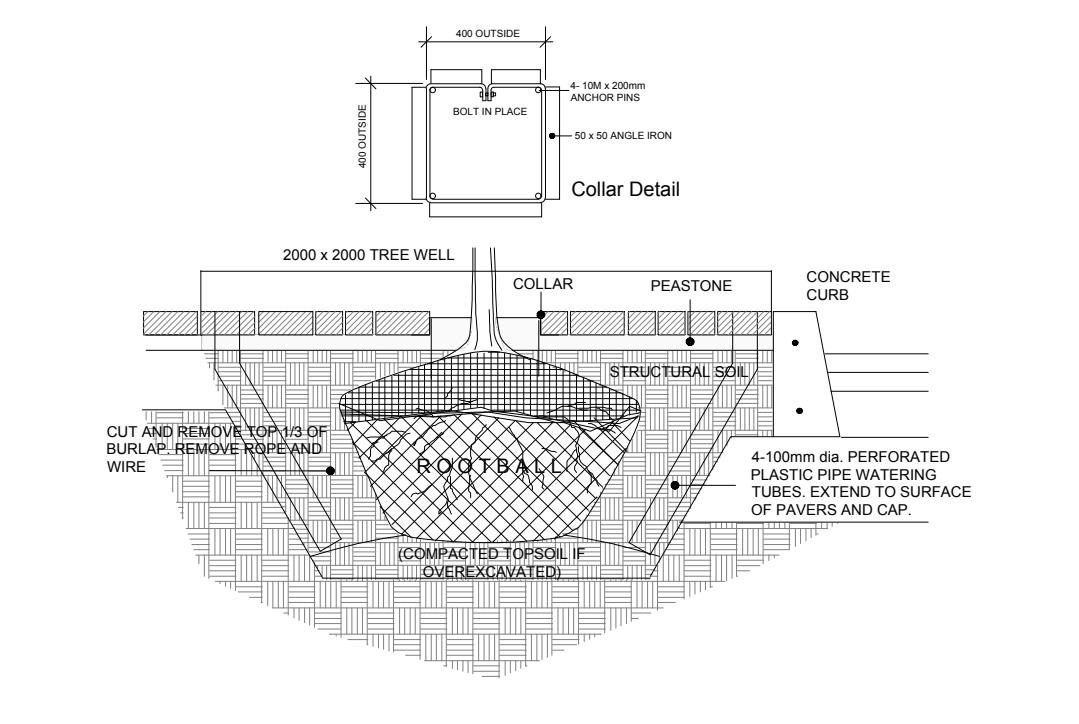

3
L.1

TREE PLANTING IN STRUCTURAL SOIL ON YORK STREET
SCALE N.T.S.

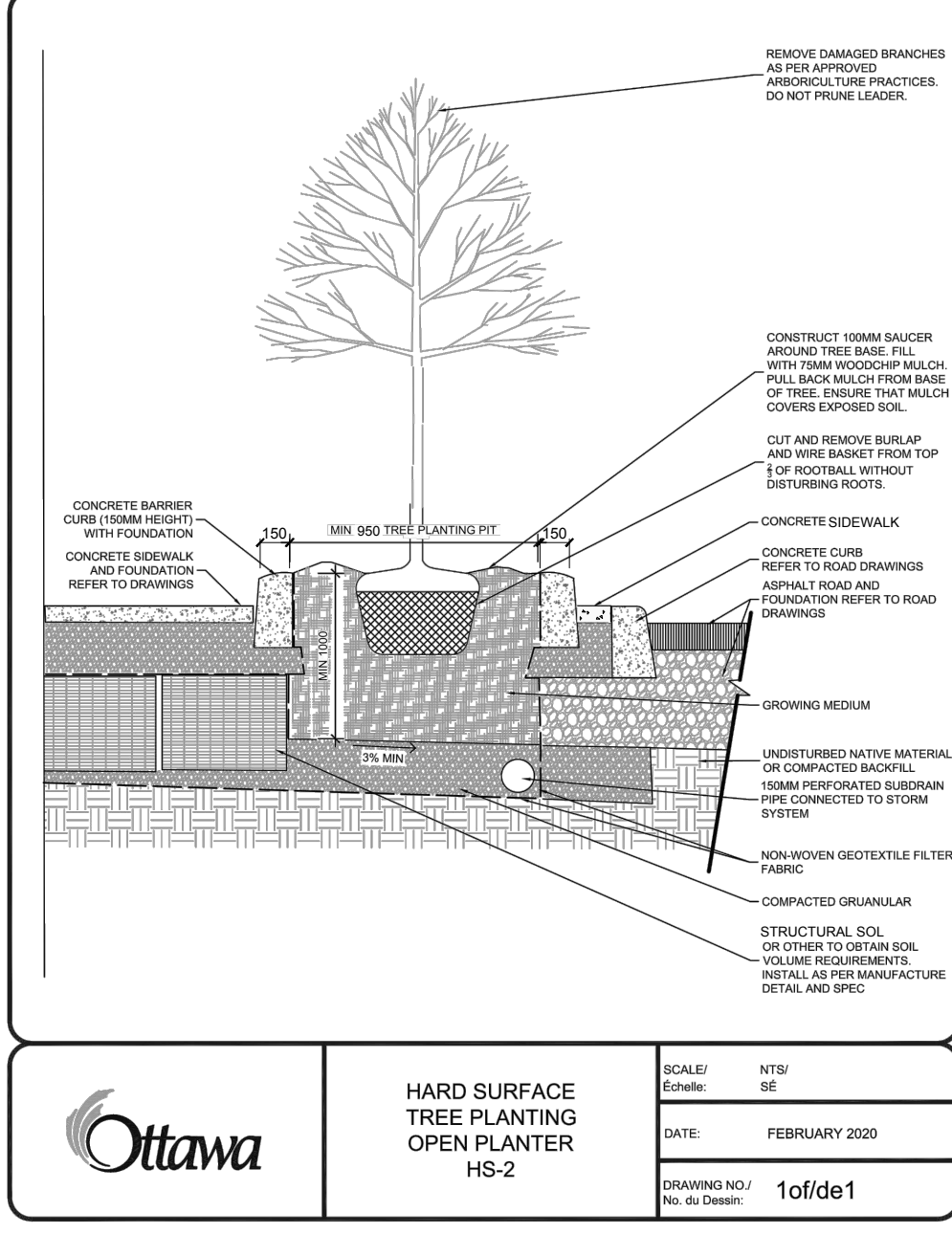

4
L.1

HS-2 TREE PLANTING IN OPEN PLANTER ON GEORGE STREET
SCALE N.T.S.

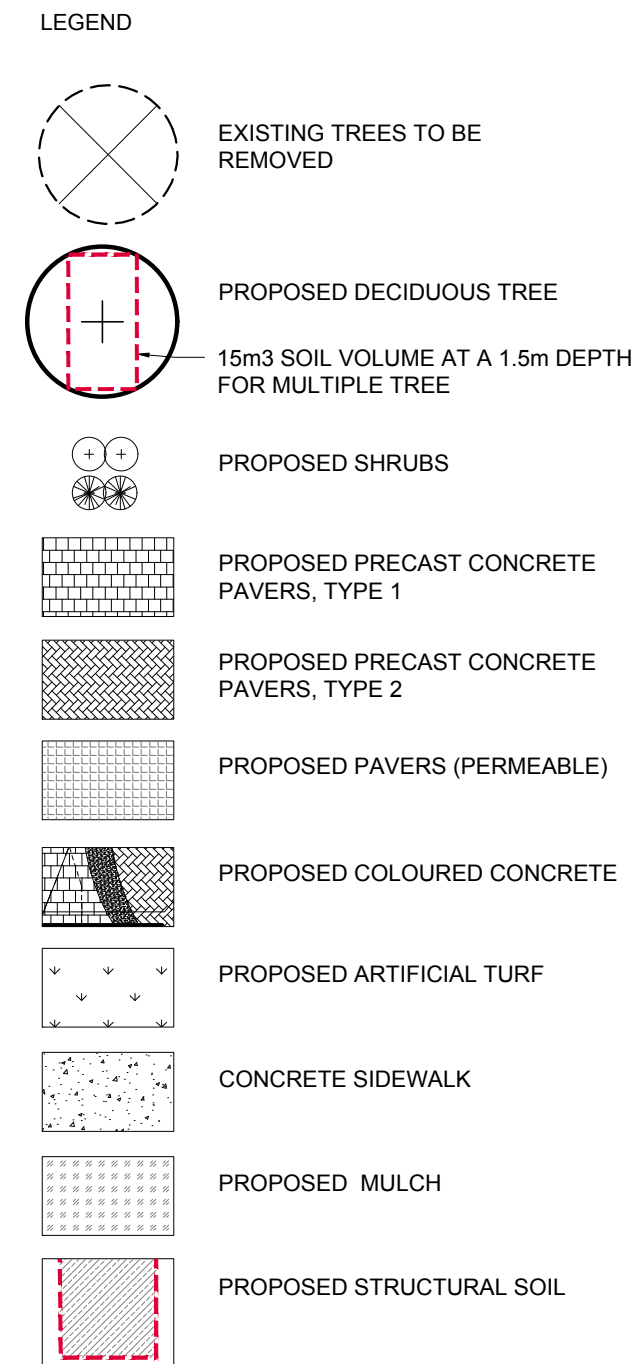

- GENERAL NOTES:**
- It is the responsibility of the appropriate contractor or official to report any errors, omissions or discrepancies on this plan with actual site conditions to the Landscape Architect before proceeding with construction.
 - The contractor is to notify all utility companies and authorities prior to any excavation and ascertain locations of underground services.
 - The contractor is to reinstate all areas and items damaged as a result of construction activity.
 - The contractor is to comply with all pertinent codes and by-laws.
 - The contractor is to maintain a positive surface run-off throughout the entire construction period.
 - The Landscape Architect is not responsible for subsurface conditions.
 - The contractor is to identify all existing trees to remain on site with the Landscape Architect prior to construction.
 - The contractor is to stake the proposed location of all plant material in conjunction with the Landscape Architect prior to excavation.
 - All trees within 1m of underground utility trenches are to be excavated by hand.
 - Remove all protective wrapping from tree trunks after installation.
 - Staking of trees shall only be performed if necessary.
 - Ensure that mulch is pulled back a min. distance of 75mm from base of tree trunk.
 - Deciduous trees to be planted on private property 450mm inside of property line.

York Street Tower Lands

Firstly: Part of PIN 04214-0207
Part of Lots 18 and 19 South York Street on Registered Plan 42482 being Part 1 on Plan 4R-36923

Secondly: Part of PIN 04214-0208
Part of Lot 19 South York Street on Registered Plan 42482 being Part 2 on Plan 4R-36923

Thirdly: Part of PIN 04214-0120
Part of Lot 20 South York Street on Registered Plan 42482 being Part 5 on Plan 4R-36923

City of Ottawa

George Street Tower Lands

Firstly: Part of PIN 04214-0207
Part of Lots 18 and 19 South York Street on Registered Plan 42482 being Part 11 on Plan 4R-36923

Secondly: Part of PIN 04214-0208
Part of Lot 19 South York Street on Registered Plan 42482 being Parts 3, 4, 7 and 12 on Plan 4R-36923
Part of Lot 19 South York Street and Part of Lots 18 and 19 North George Street on Registered Plan 42482 being Part 8 on Plan 4R-36923
Part of Lot 19 South York Street and Part of Lot 19 North George Street on Registered Plan 42482 being Part 14 on Plan 4R-36923

Thirdly: Part of PIN 04214-0120
Part of Lot 20 South York Street on Registered Plan 42482 being Parts 6, 9, 13 and 16 on Plan 4R-36923

Fourthly: Part of PIN 04214-0121
Part of Lot 20 North George Street on Registered Plan 42482 being Parts 10 and 15 on Plan 4R-36923

City of Ottawa

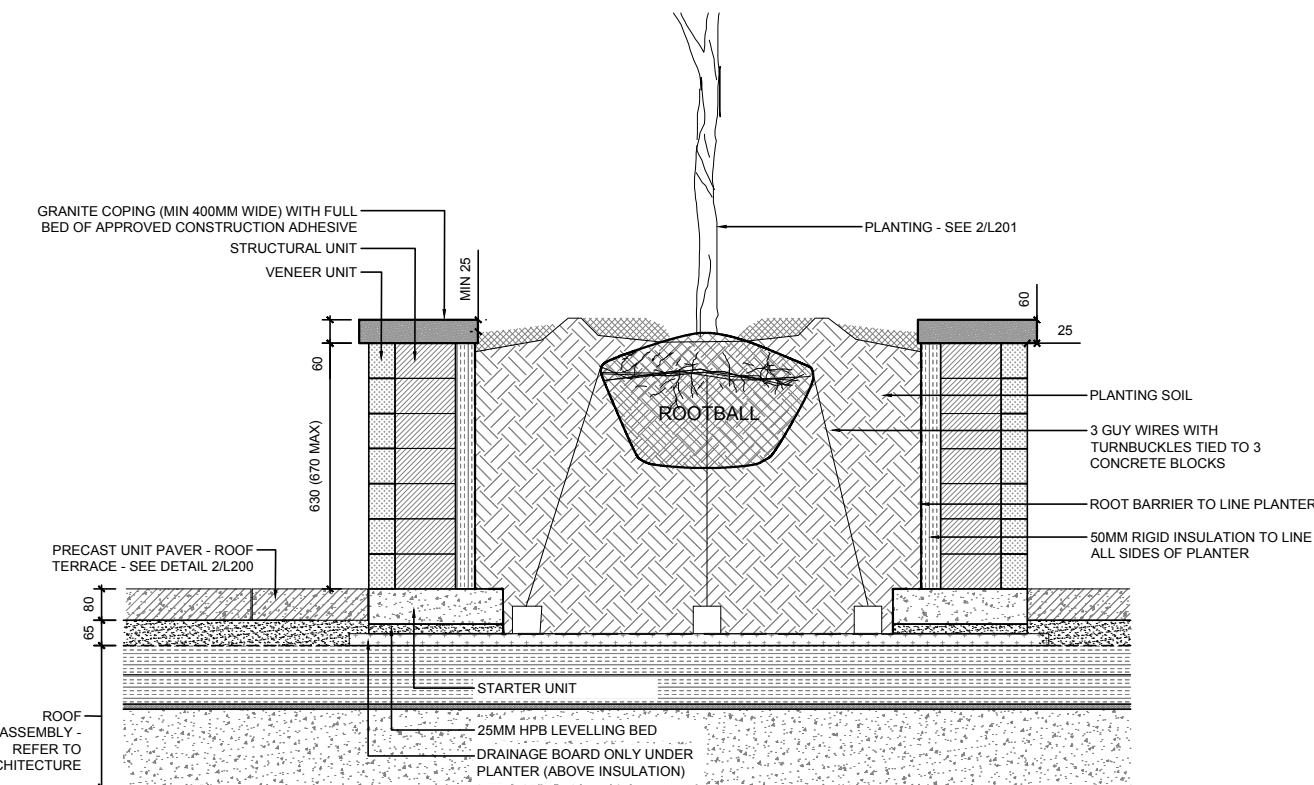

5
L.1

PRECAST CONCRETE PLANTER - ROOF TERRACE
SCALE N.T.S.

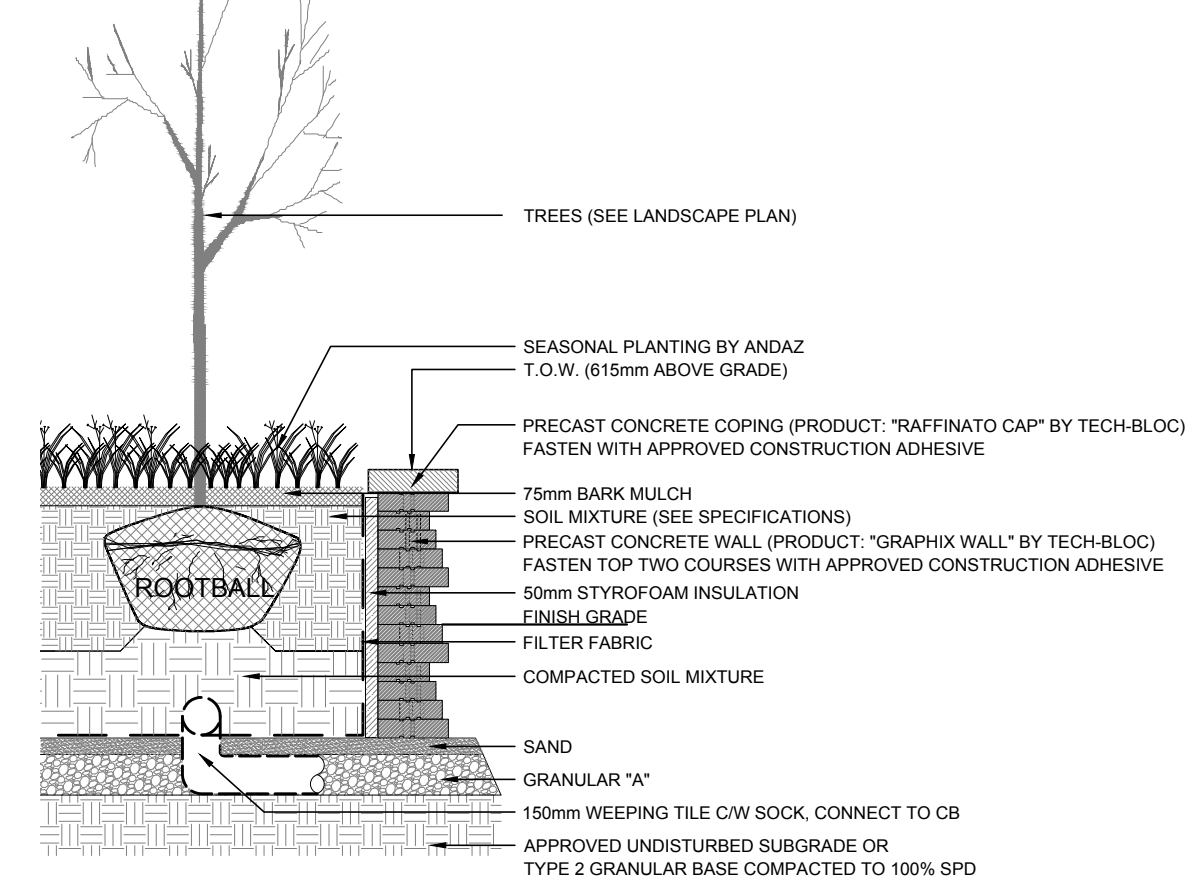

6
L.1

DECIDUOUS TREE IN CONCRETE PLANTER ON DALHOUSIE STREET
SCALE N.T.S.

CLIENT:

CLARIDGE HOMES
210 Gladstone Avenue, Suite 2001
Ottawa, Ontario K1P 0T6
Tel: (613) 533-0200
Fax: (613) 533-0200

LOCATION PLAN

CONSULTANTS

ARCHITECTS:
NEUF ARCHITECTS
2000 ave McGill College, suite 600
Montreal, Québec H3A 3H4

SURVEYORS:
ANNIS O'SULLIVAN VOLLEBEKK LTD.
Suite 500, 14 Concourse Gate,
Nepean, Ontario, K2E 7S6

CIVIL ENGINEERS:
NOVATECH ENGINEERING CONSULTANTS LTD.
Suite 200, 240 Michael Compton Drive,
Ottawa, ON, K2M 1P6

40 YEAR CANOPY CALCULATION:

- 4,646 m2 site area

- 9 medium deciduous trees proposed (78.5m2 ea.)
- 4 small deciduous trees proposed (7m2 ea.)

= 735m2 canopy cover = 16% canopy cover

*Medium deciduous tree calculated at 10m spread,
small deciduous tree at 3m spread.

8	REVISED AS PER CITY COMMENTS	07/21/2025	LC
7	REVISED AS PER CITY COMMENTS	06/30/2025	LC
6	ISSUED FOR SITE PLAN APPROVAL	11/07/2024	LC
5	ISSUED FOR TENDER	06/05/2024	LC
4	REVISED AS PER COMMENTS	05/01/2024	LC
3	REVISED AS PER COMMENTS	03/13/2024	LC
2	ISSUED FOR PERMITTING	12/21/2023	WF
1	ISSUED FOR SITE PLAN REVIEW	06/28/2023	JL

No. Revision Date By

JAMES B. LENNOX & ASSOCIATES INC.
LANDSCAPE ARCHITECTS
SUITE 300A HAMPTON PARK PLAZA, 1419 CARLING AVE. OTTAWA, ONTARIO K1Z 7L4
Tel. (613) 722-5168 Fax. 1(866) 343-3942

PROJECT

137, 141 GEORGE STREET, 110, 116 YORK STREET, AND 321, 325 DALHOUSIE STREET

DRAWING

GROUND FLOOR LANDSCAPE PLAN

STAMP

DRAWN BY:
LC

CHECKED BY:
JAMES LENNOX

SCALE
SEE PLAN

DATE
JUNE, 2023

PROJECT NORTH

PROJECT NO.

DRAWING NO.

L.1

PLOT SIZE A.1