

1015 DAIRY DRIVE

TSL DAIRY INC.

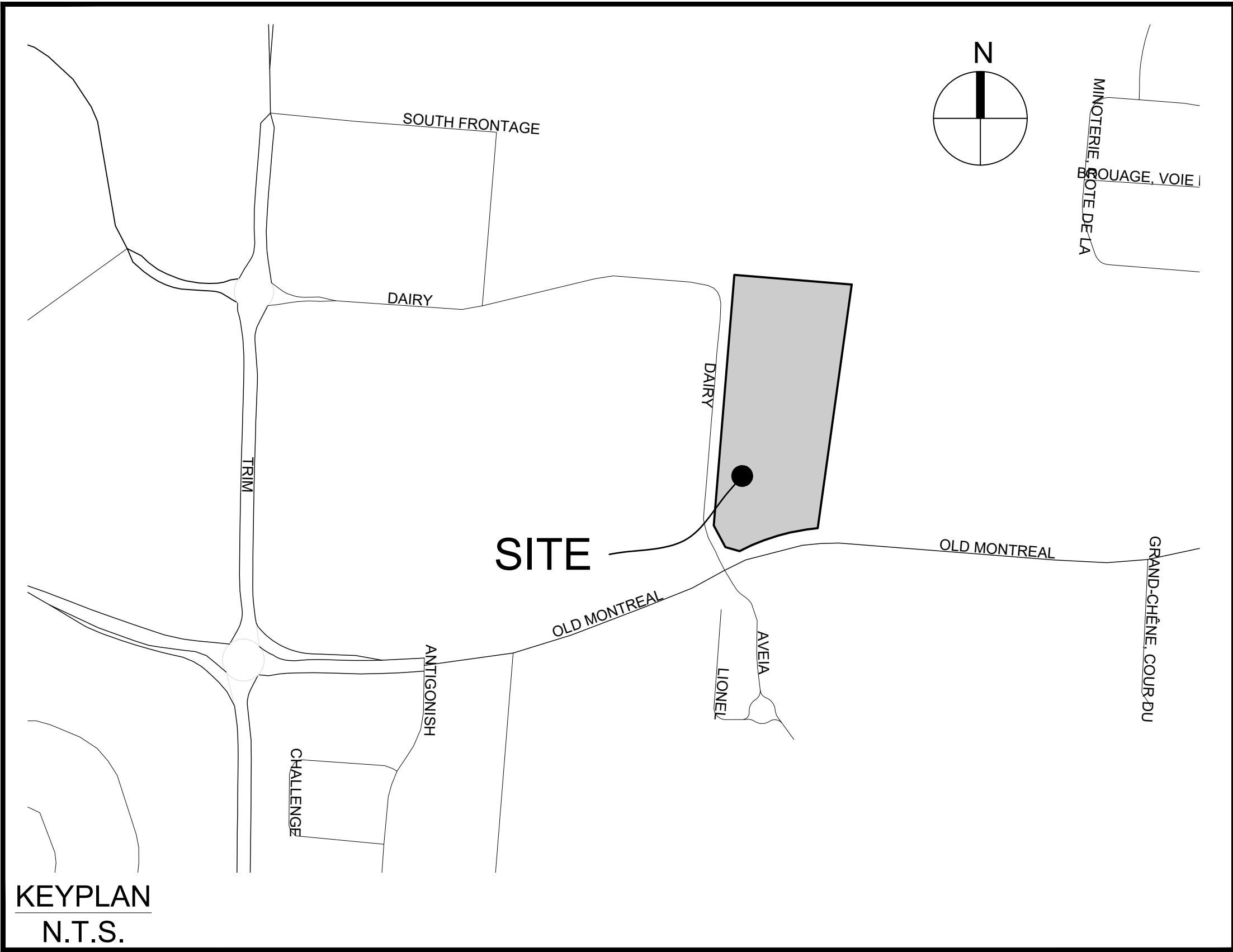

333 Preston Street - Suite 500
Ottawa ON K1S 5N4 Canada
tel 613 225 1311
www.arcadis.com



| Sheet List Table | |
|------------------|-----------------------------------|
| Sheet Number | Sheet Title |
| C-000 | COVER |
| C-001 | GENERAL PLAN |
| C-010 | NOTES DETAILS CB DATA |
| C-200 | GRADING PLAN |
| C-400 | SANITARY DRAINAGE AREA PLAN |
| C-500 | STORM DRAINAGE AREA PLAN |
| C-600 | PONDING PLAN |
| C-900 | EROSION AND SEDIMENT CONTROL PLAN |

CITY OF OTTAWA

CONTRACT NO. 142817

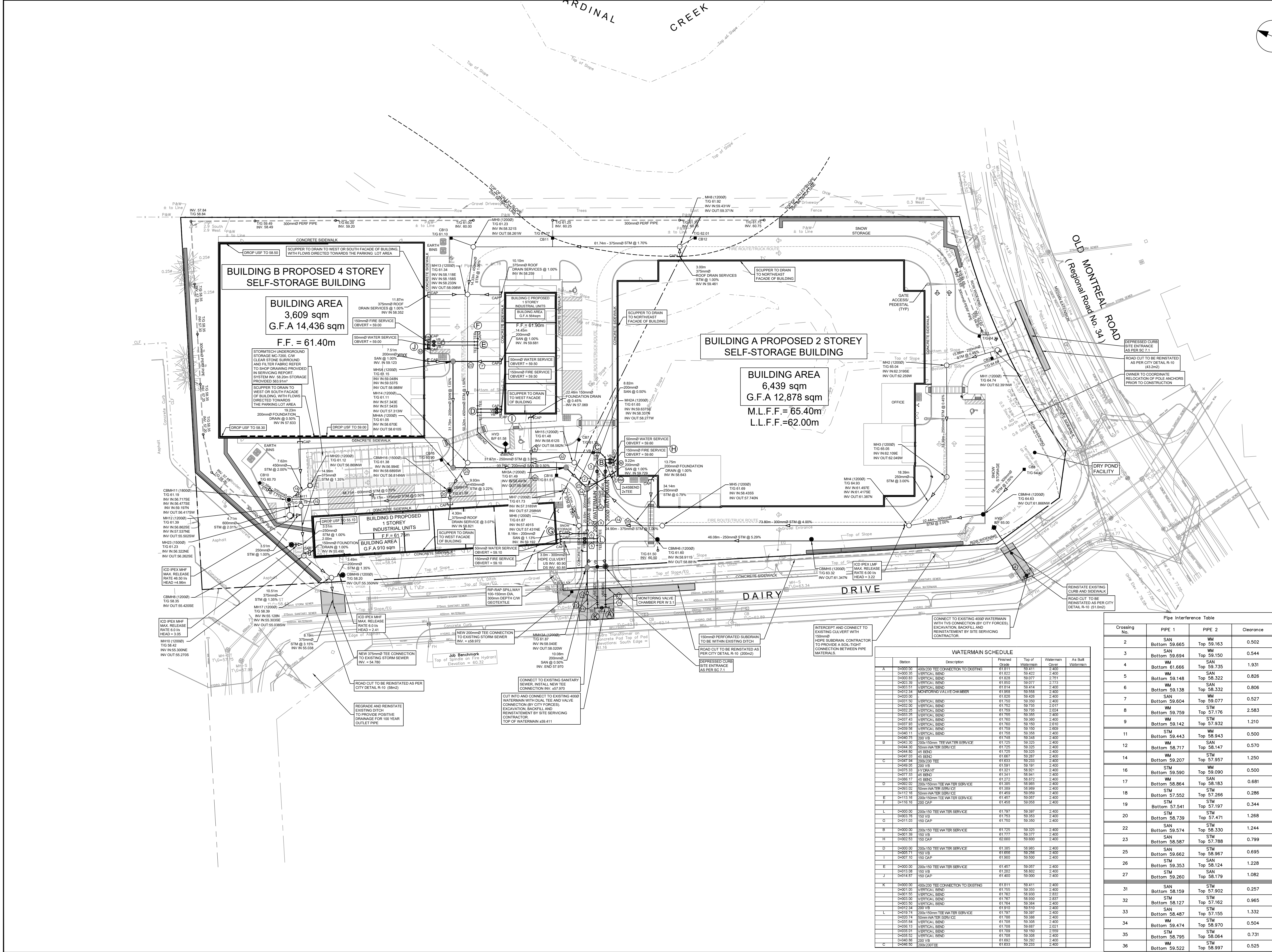

CLIENT

TSL DAIRY INC.

COPYRIGHT

This drawing has been prepared solely for the intended use, thus any reproduction or distribution for any purpose other than authorized by Arcadis is forbidden. Written dimensions shall have precedence over scaled dimensions. Contractors shall verify and be responsible for all dimensions and conditions on the job, and Arcadis shall be informed of any variations from the dimensions and conditions shown on the drawing. Shop drawings shall be submitted to Arcadis for general conformance before proceeding with fabrication.

Arcadis Professional Services (Canada) Inc.

Formerly B Group Professional Services (Canada) Inc.

ISSUES

| No. | DESCRIPTION | DATE |
|-----|----------------------------------|------------|
| 1 | SUBMISSION NO. 1 FOR CITY REVIEW | 2024-02-14 |
| 2 | SUBMISSION NO. 2 FOR CITY REVIEW | 2024-06-27 |
| 3 | SUBMISSION NO. 3 FOR CITY REVIEW | 2024-10-04 |
| 4 | SUBMISSION NO. 3 FOR CITY REVIEW | 2025-06-25 |
| 5 | | |
| 6 | | |

SEE 010, FOR NOTES, LEGEND, CB TABLE, STREET SECTIONS AND DETAILS

KEY PLAN

1:500

0 5 10 15 20m

SEAL

LICENCED PROFESSIONAL ENGINEER

D. Yannopoulos

2025/06/25

PROVINCE OF ONTARIO

PRIME CONSULTANT

ARCADIS

333 Preston Street - Suite 500
Ottawa ON K1S 5N4 Canada
tel 613 225 1311
www.arcadis.com

PROJECT

1015 DAIRY DRIVE

1015 DAIRY DRIVE

PROJECT NO:

142817

DRAWN BY:

M.M./A.B.

CHECKED BY:

R.M./D.Y.

PROJECT MGR:

R.M.

APPROVED BY:

D.Y.

SHEET TITLE

GENERAL PLAN OF SERVICES

SHEET NUMBER

C-001

ISSUE

4

GENERAL LEGEND

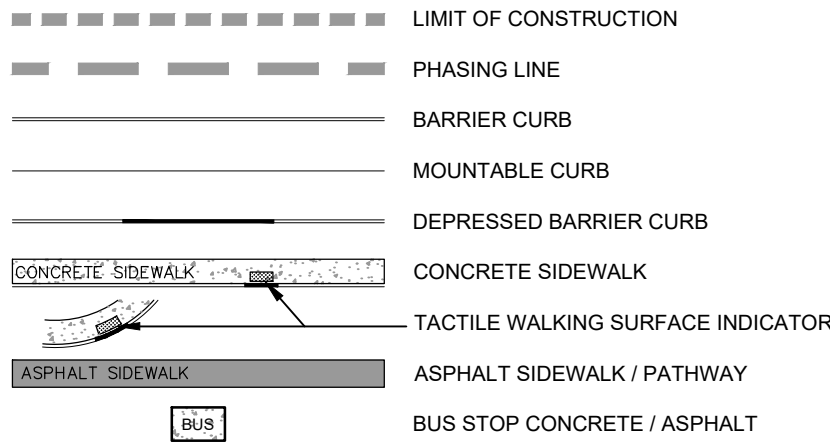

SERVICING LEGEND

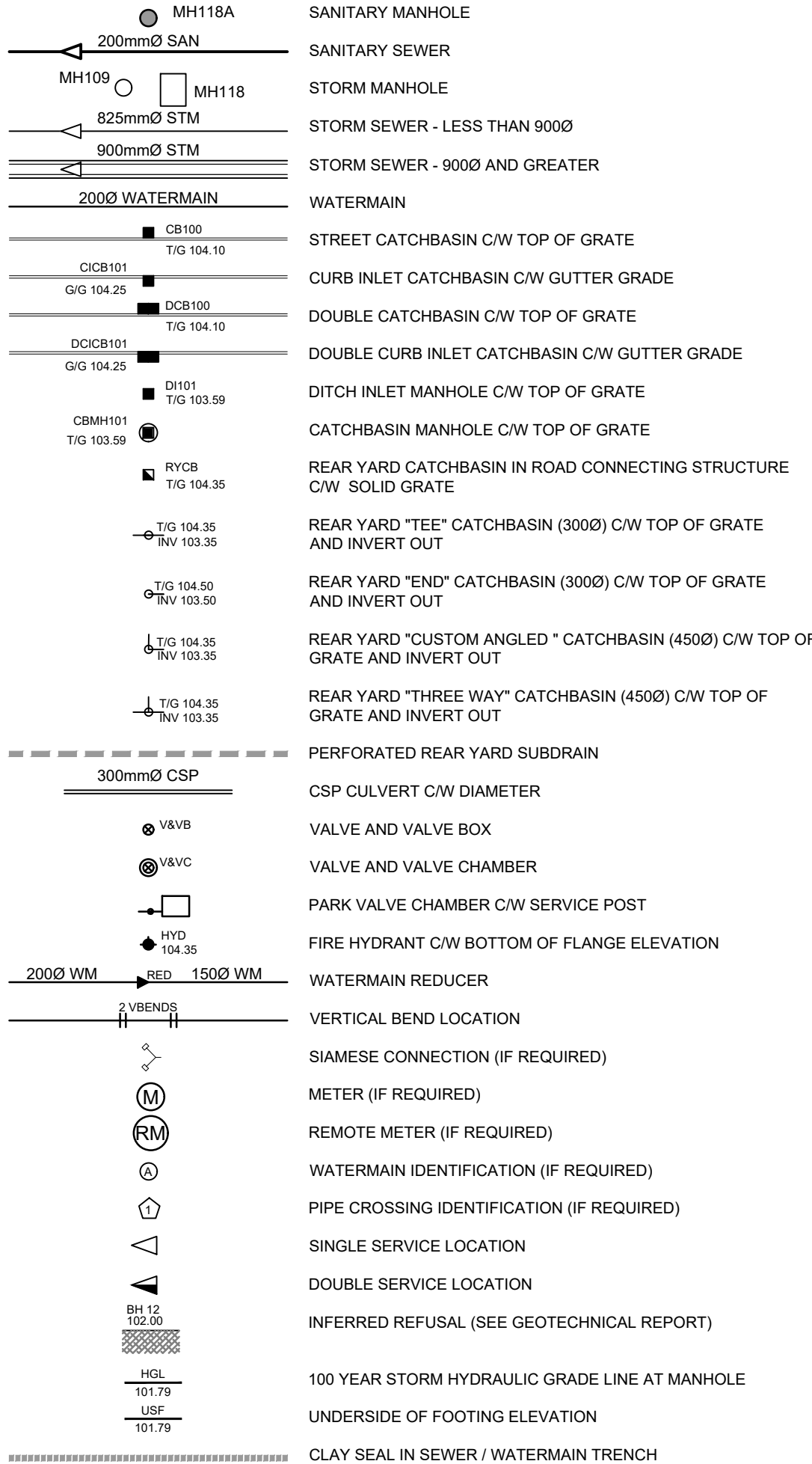

UTILITY NOTES :

- ALL MATERIALS AND CONSTRUCTION IS TO BE IN ACCORDANCE WITH THE CURRENT CITY OF OTTAWA STANDARD DRAWINGS & SPECIFICATIONS OR OPSD/OPSS IF CITY DRAWINGS AND SPECIFICATIONS DO NOT APPLY.
- THE POSITION OF UNDERGROUND AND ABOVEGROUND SERVICE, UTILITIES AND STRUCTURES ARE NOT NECESSARILY SHOWN ON THE CONTRACT DRAWINGS, AND WHERE SHOWN, THE ACCURACY OF THE POSITION OF SUCH SERVICE, UTILITIES AND STRUCTURES IS NOT GUARANTEED. THE CONTRACTOR IS RESPONSIBLE FOR DETERMINING THE EXACT LOCATION, SIZE, MATERIAL AND ELEVATION OF ALL EXISTING SERVICES AND UTILITIES PRIOR TO CONSTRUCTION.
- THE CONTRACTOR SHALL REPORT ALL CONFLICTS, DISCOVERIES OF ERROR AND DISCREPANCIES TO THE ENGINEER.
- THE CONTRACTOR SHALL BE RESPONSIBLE TO PROTECT AND ASSUME RESPONSIBILITY FOR ALL UTILITIES WHETHER OR NOT SHOW ON THESE DRAWINGS.
- THESE DRAWINGS ARE NOT TO BE SCALED OR USED FOR LAYOUT PURPOSES.
- THE COMPOSITE UTILITY PLAN HAS BEEN REVIEWED BY ARCADIS FOR CONFORMITY TO THE DESIGN CONCEPT FOR THE DEVELOPMENT AND FOR GENERAL ARRANGEMENT ONLY AND AS SUCH SHALL NOT RELIEVE THE CONTRACTOR OF RESPONSIBILITY FOR ERRORS OR OMISSIONS IN EITHER LAYOUT OR WORKMANSHIP.
- THIS DRAWING IS A COMPILATION OF OTHER UTILITY DESIGNS AND DOES NOT INDICATE IN ANY WAY THAT THE PARTY SIGNING THIS DRAWING HAS DESIGNED OR APPROVED THE RESPECTIVE UTILITY PLANTS INDICATED ON THIS DRAWING. THE DRAWING WAS PREPARED TO BE USED AS REFERENCE ONLY AS PER REQUIREMENTS OF THE CITY OF OTTAWA. IT IS THE CONTRACTORS RESPONSIBILITY TO ENSURE IT HAS REVIEWED THE CURRENT AND EXISTING DESIGNS BY HYDRO, STREET LIGHTING, BELL, CANADA POST, O.C. TRANSPQ, CABLE TV AND ANY OTHER PARTIES INCLUDED BUT NOT MENTIONED AND COMPLETE THE INSTALLATION IN ACCORDANCE WITH THE REQUIREMENTS OF THE STAKEHOLDER UTILITY DESIGNS.
- CONTRACTOR TO ADVISE ENGINEER IN WRITING OF ANY DISCREPANCIES IN THE HYDRO, BELL, ROGERS, ENBRIDGE, AND STREETLIGHT DRAWINGS, AND THE CUP AHEAD OF INSTALLATION.
- HYDRO INSPECTOR IS TO BE NOTIFIED AND PRESENT AHEAD OF HYDRO INSTALLATION
- BELL AND ROGERS VAULT EASEMENT SIZE AND LOCATION ARE AS SHOWN ON THE CUP. ANY LOCATION DISCREPANCIES ARE TO BE REPORTED TO THE ENGINEER IN WRITING AHEAD OF INSTALLATION.
- BELL AND ROGERS VAULTS ARE TO BE PLACED TO THE EXTENT POSSIBLE IN THE RIGHT OF WAY RESPECTING THE REQUIRED CLEARANCES FROM DUCTS IN THE JOINT UTILITY TRENCH. IF VAULTS ARE ON PRIVATE PROPERTY THEY MUST BE PLACED WITHIN THE EASEMENT. VERIFY VAULT CORNERS PRIOR TO FINAL INSTALLATION AND FIBRE LINE PLACEMENT. VAULTS INSTALLED IN THE WRONG LOCATION OR OUTSIDE THE EASEMENTS WILL BE RELOCATED AT THE COST OF BELL AND ROGERS.
- UTILITY EASEMENTS ARE TO BE STAKED - ALL 4 CORNERS WITH PROPOSED FINAL GRADES MARKED ON THE STAKES.
- STREETLIGHTS ARE TO BE INSTALLED AT THE OFFSETS FROM FACE OF CURB SHOWN ON THE APPROVED ROAD SECTIONS FOR THE PROJECT.
- CAD FILES OF THE CUP PROVIDED BY THE ENGINEER ARE AS A COURTESY ONLY TO ASSIST THE CONTRACTOR. LAYOUT OF THE UTILITIES IS THE RESPONSIBILITY OF THE CONTRACTOR AND LEGAL SURVEYOR.

NOTES :

- ALL MATERIALS AND CONSTRUCTION IS TO BE IN ACCORDANCE WITH THE CURRENT CITY OF OTTAWA STANDARD DRAWINGS & SPECIFICATIONS OR OPSD/OPSS IF CITY DRAWINGS AND SPECIFICATIONS DO NOT APPLY.
- THE POSITION OF UNDERGROUND AND ABOVEGROUND SERVICE, UTILITIES AND STRUCTURES ARE NOT NECESSARILY SHOWN ON THE CONTRACT DRAWINGS, AND WHERE SHOWN, THE ACCURACY OF THE POSITION OF SUCH SERVICE, UTILITIES AND STRUCTURES IS NOT GUARANTEED. THE CONTRACTOR IS RESPONSIBLE FOR DETERMINING THE EXACT LOCATION, SIZE, MATERIAL AND ELEVATION OF ALL EXISTING SERVICES AND UTILITIES PRIOR TO CONSTRUCTION.
- THE CONTRACTOR SHALL REPORT ALL CONFLICTS, DISCOVERIES OF ERROR AND DISCREPANCIES TO THE ENGINEER.
- THE CONTRACTOR SHALL BE RESPONSIBLE TO PROTECT AND ASSUME RESPONSIBILITY FOR ALL UTILITIES WHETHER OR NOT SHOW ON THESE DRAWINGS.
- THE CONTRACTOR SHALL BE RESPONSIBLE TO PROTECT ALL LANDS BEYOND THE SITE LIMITS. ANY AREAS BEYOND THE SITE LIMITS, WHICH ARE DISTURBED DURING CONSTRUCTION, SHALL BE REPAIRED AND RESTORED TO ORIGINAL CONDITION OR BETTER, TO THE SATISFACTION OF THE ADJACENT LAND OWNER, THE OWNER, THE OWNERS REPRESENTATIVES AND/OR THE AUTHORITY HAVING JURISDICTION AT THE EXPENSE OF THE CONTRACTOR.
- WHERE NECESSARY, THE CONTRACTOR SHALL IMPLEMENT A TRAFFIC MANAGEMENT PLAN TO THE SATISFACTION OF THE CITY OF OTTAWA. ALL CONSTRUCTION SIGNAGE MUST CONFORM TO THE LATEST VERSION OF THE M.T.O. MANUAL OF UNIFORM TRAFFIC CONTROL DEVICES. ALL TEMPORARY TRAFFIC CONTROL MEASURES MUST BE REMOVED UPON THE COMPLETION OF THE WORKS.
- SHOULD ANY BURIED ARCHAEOLOGICAL REMAINS BE FOUND ON THE PROPERTY DURING CONSTRUCTION ACTIVITIES, THE CONTRACTOR SHALL NOTIFY THE OWNER TO CONTACT THE HERITAGE OPERATIONS UNIT OF THE ONTARIO MINISTRY OF CULTURE MUST BE NOTIFIED IMMEDIATE, AND WORK WITHIN THE AREA SHALL BE CEASED UNTIL FURTHER NOTICE.
- FOR GEOTECHNICAL INFORMATION REFER TO GEOTECHNICAL REPORT PG6498-1 PREPARED BY PATERSON GROUP.

DRIVE ISLE, FIRE ROUTE AND HEAVY DUTY AREAS: (690mm)
40mm - SUPERPAVE 12.5 ASPHALTIC CONCRETE
50mm - SUPERPAVE 19.0 ASPHALTIC CONCRETE
150mm - OPSS GRANULAR "A" CRUSHED STONE
450mm - OPSS GRANULAR "B" TYPE II

CAR ONLY PARKING AREA: (600mm)
50mm - SUPERPAVE 12.5 ASPHALTIC CONCRETE
150mm - OPSS GRANULAR "A" CRUSHED STONE
300mm - OPSS GRANULAR "B" TYPE II
- FOR GEODETIC BENCHMARK AND GEOMETRIC LAYOUT OF STREET AND LOTS, REFER TO TOPOGRAPHICAL SURVEY AND PLAN OF SUBDIVISION PREPARED BY ANNIS O'SULLIVAN VOLLEBERG LTD. BENCHMARK BASED ON CAN-NET VIRTUAL REFERENCE SYSTEM NETWORK.
- FOR SITE PLAN INFORMATION, REFER TO SITE PLAN PREPARED BY ESPOSTO ARCHITECTS.
- THESE DRAWINGS ARE NOT TO BE SCALED OR USED FOR LAYOUT PURPOSES
- ROADWAY SECTIONS REQUIRING GRADE RAISE TO PROPOSED SUB GRADE LEVEL TO BE FILLED WITH ACCEPTABLE NATIVE EARTH BORROW OR IMPORTED OPSS SELECTED SUBGRADE MATERIAL IF NATIVE MATERIAL IS DEFICIENT AS PER RECOMMENDATION OF GEOTECHNICAL ENGINEER
- IN AREAS WHERE EXISTING GROUND IS BELOW THE PROPOSED ELEVATION OF SEWER AND WATERMAINS, GRADE RAISING AND FILLING IS TO BE IN ACCORDANCE WITH THE RECOMMENDATIONS OF THE GEOTECHNICAL REPORT. AS PER CITY GUIDELINES ALL WATERMAINS IN FILL AREAS ARE TO BE TIED WITH RESTRAINING JOINTS AND THRUST BLOCKS.
- THE CONTRACTOR SHALL IMPLEMENT THE EROSION AND SEDIMENT CONTROL PLAN PRIOR TO THE COMMENCEMENT OF ANY SITE CONSTRUCTION. ALL EROSION AND SEDIMENT CONTROL MEASURES SHALL BE INSTALLED TO THE SATISFACTION OF THE ENGINEER, OR ANY REGULATORY AGENCY. ALL EROSION AND SEDIMENT CONTROL MEASURES SHALL BE MAINTAINED UNTIL VEGETATION IS ESTABLISH OR UNTIL THE START OF A SUBSEQUENT PHASE.
- CONTRACTORS SHALL BE RESPONSIBLE FOR KEEPING CLEAN ALL ROADS WHICH BECOME COVERED IN DUST, DEBRIS AND/OR MUD AS A RESULT OF ITS CONSTRUCTION OPERATIONS.
- THE CONTRACTOR SHALL BE RESPONSIBLE FOR ANY ADDITIONAL BEDDING OR ADDITIONAL STRENGTH PIPE SHOULD THE MAXIMUM OPSD TRENCH WIDTH BE EXCEEDED.
- ALL PIPE, CULVERTS, STRUCTURES REFER TO NOMINAL INSIDE DIMENSIONS.
- SHOULD CLAY SEALS BE REQUIRED, THEY SHALL BE INSTALLED AS PER THE RECOMMENDATIONS WITHIN THE GEOTECHNICAL REPORT.
- UNLESS SPECIFICALLY NOTED OTHERWISE, PIPE MATERIALS SHALL BE AS FOLLOWS:
-WATERMAINS TO BE PVC DR18
-SANITARY SEWER TO BE PVC DR35
-PERFORATED STORM SEWERS IN REAR YARDS AND LANDSCAPE AREAS TO BE HDPE
-STORM SEWERS 375mm DIAMETER AND LESS TO BE PVC DR35
-STORM SEWERS 450mm DIAMETER AND GREATER TO BE CONCRETE, CLASS AS PER OPSD 807 010 OR 807 030, OR HIGHER
FOR SHALLOW SEWERS, REFER TO CITY STANDARD S35.
- ALL CONNECTIONS TO EXISTING WATERMAINS ARE TO BE COMPLETED BY CITY FORCES. CONTRACTOR IS TO EXCAVATE, BACKFILL, COMPACT AND REINSTATE.
- ANY WATERMAIN WITH LESS THAN 2.4m AND ANY SEWER WITH LESS THAN 2.0m DEPTH OF COVER REQUIRES THERMAL INSULATION AS PER CITY OF OTTAWA STANDARD W22 OR AS APPROVED BY THE ENGINEER.
- ALL FIRE HYDRANTS AS PER CITY STANDARD W19, c/w 150mmØ LEAD UNLESS OTHERWISE SPECIFIED.
- ALL STUBBED SEWERS SHALL HAVE PRE-MANUFACTURED CAPS INSTALLED.
- ALL CATCHBASINS SHALL HAVE A 600mm SUMP. ALL CATCHBASIN MANHOLES, AND ALL STORM MANHOLES WITH OUTLETTING PIPE SIZES LESS THAN 900mm, SHALL HAVE A 300mm SUMP.
- ALL SANITARY MANHOLES SHALL BE EQUIPPED WITH A WATERTIGHT COVER.
- ALL LEADS FOR STREET CATCHBASINS AND CURB INLET CATCHBASINS CONNECTED TO MAIN SHALL BE 200mmØ PVC DR35 @ MIN 2% SLOPE UNLESS NOTED OTHERWISE. ALL LEADS FOR RYCB'S CONNECTED TO MAIN SHALL BE 200mmØ PVC DR35 @ MIN 1% SLOPE UNLESS NOTED OTHERWISE.
- UNLESS SPECIFICALLY NOTED OTHERWISE, ALL STREET CATCHBASINS SHALL BE INSTALLED WITH TWO - 3.0m MINIMUM SUBDRAINS INSTALLED LONGITUDINALLY, PARALLEL WITH THE CURB. ALL CATCHBASINS IN ASPHALT AREAS, NOT ADJACENT TO A CURB, SHALL BE INSTALLED WITH FOUR - 3.0m MINIMUM SUBDRAINS INSTALLED ORTHOGONALLY.
- INLET CONTROL DEVICES SHALL BE INSTALLED PRIOR TO COMPLETING THE ROAD BASE (GRANULAR A).
- ALL SEWER SERVICE LATERALS WITH MAINLINE CONNECTIONS DEEPER THAN 5.0m REQUIRE A CONTROLLED SETTLEMENT JOINT.
- EACH BUILDING SHALL BE EQUIPPED WITH A SANITARY AND STORM SEWER BACKWATER VALVE AND CLEAN-OUT ON ITS PRIMARY SERVICE, AS PER ONTARIO BUILDING CODE REQUIREMENTS (BY OTHERS).
- THE SUBGRADE OF ALL STRUCTURES, PIPE, ROADS, SIDEWALKS, WALKWAYS, AND BUILDINGS SHALL BE INSPECTED BY THE GEOTECHNICAL ENGINEER PRIOR TO PROCEEDING WITH CONSTRUCTION.
- TOP COURSE ASPHALT SHALL NOT BE PLACED UNTIL THE FINAL CCTV INSPECTION AND NECESSARY REPAIRS HAVE BEEN COMPLETED TO THE SATISFACTION OF THE ENGINEER AND THE CITY OF OTTAWA.
- ALL RETAINING WALLS GREATER THAN 1.0m IN HEIGHT SHALL BE DESIGNED BY A QUALIFIED STRUCTURAL ENGINEER.
- ALL RETAINING WALLS GREATER THAN 0.6m IN HEIGHT REQUIRE A GUARD. ANY GUARD ON A RETAINING WALL GREATER THAN 1.0m IN HEIGHT SHALL BE DESIGNED BY THE QUALIFIED STRUCTURAL ENGINEER RESPONSIBLE FOR THE WALL DESIGN.
- UPON COMPLETION OF THE RETAINING WALL, THE CONTRACTOR SHALL REQUEST A CONFORMANCE CERTIFICATE FROM THE QUALIFIED ENGINEER RESPONSIBLE FOR THE WALL DESIGN.

CLIENT

TSL DAIRY INC.

COPYRIGHT

This drawing has been prepared solely for the intended use, thus any reproduction or distribution for any purpose other than authorized by Arcadis is forbidden. Written dimensions shall have precedence over scaled dimensions. Contractors shall verify and be responsible for all dimensions and conditions on the job, and Arcadis shall be informed of any variations from the dimensions and conditions shown on the drawing. Shop drawings shall be submitted to Arcadis for general conformance before proceeding with fabrication.

Arcadis Professional Services (Canada) Inc.
formerly B| Group Professional Services (Canada) Inc.

ISSUES

| No. | DESCRIPTION | DATE |
|-----|----------------------------------|------------|
| 1 | SUBMISSION NO.1 FOR CITY REVIEW | 2024-02-14 |
| 2 | SUBMISSION NO. 2 FOR CITY REVIEW | 2024-06-27 |
| 3 | SUBMISSION NO. 3 FOR CITY REVIEW | 2024-10-04 |
| 4 | SUBMISSION NO. 3 FOR CITY REVIEW | 2025-06-25 |
| 5 | | |
| 6 | | |

SEE 010, FOR NOTES, LEGEND, CB TABLE, STREET SECTIONS AND DETAILS

KEY PLAN

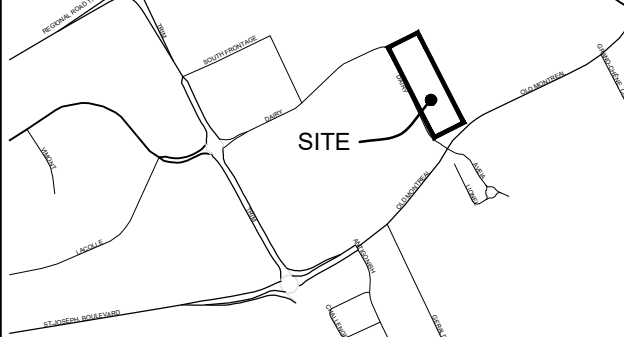

SEAL

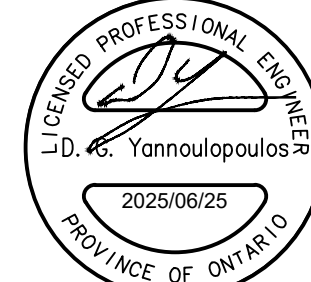

PRIME CONSULTANT



333 Preston Street - Suite 500
Ottawa ON K1S 5N4 Canada
tel 613 225 1311
www.arcadis.com

PROJECT

1015 DAIRY DRIVE

1015 DAIRY DRIVE

PROJECT NO:
142817

DRAWN BY:
M.M./A.B.

CHECKED BY:
R.M./D.Y.

PROJECT MGR:
R.M.

APPROVED BY:
D.Y.

SHEET TITLE

NOTES DETAILS CB DATA
TABLE

SHEET NUMBER

C-010

ISSUE

4

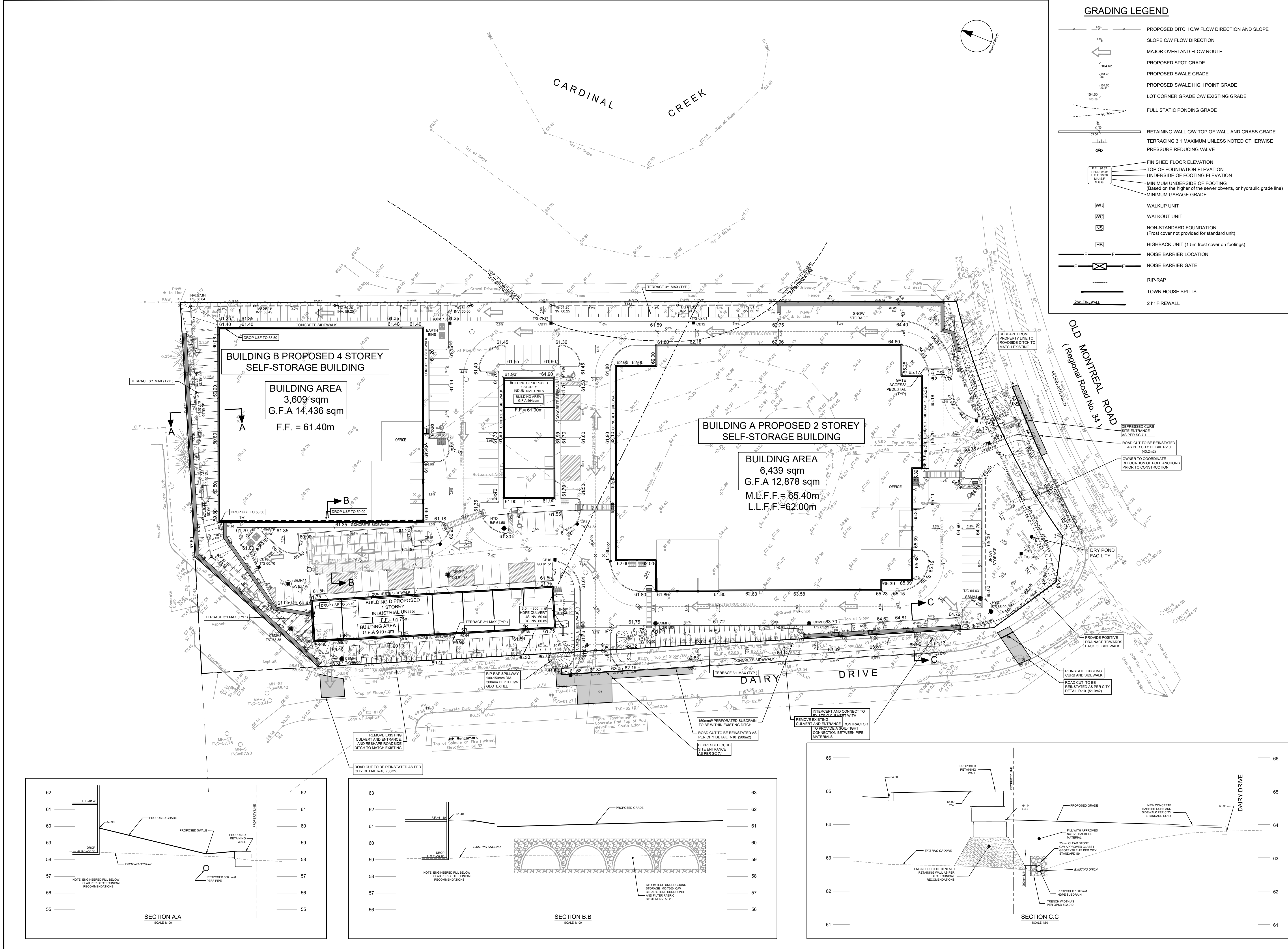

CLIENT

TSL DAIRY INC.

COPYRIGHT

This drawing has been prepared solely for the intended use, thus any reproduction or distribution for any purpose other than authorized by Arcadis is forbidden. Written dimensions shall have precedence over scaled dimensions. Contractors shall verify and be responsible for all dimensions and conditions on the job, and Arcadis shall be informed of any variations from the dimensions and conditions shown on the drawing. Shop drawings shall be submitted to Arcadis for general conformance before proceeding with fabrication.

Arcadis Professional Services (Canada) Inc.
Formerly BGI Group Professional Services (Canada) Inc.

ISSUES

| No. | DESCRIPTION | DATE |
|-----|----------------------------------|------------|
| 1 | SUBMISSION NO. 1 FOR CITY REVIEW | 2024-02-14 |
| 2 | SUBMISSION NO. 2 FOR CITY REVIEW | 2024-06-27 |
| 3 | SUBMISSION NO. 3 FOR CITY REVIEW | 2024-10-04 |
| 4 | SUBMISSION NO. 3 FOR CITY REVIEW | 2025-06-25 |
| 5 | | |
| 6 | | |

SEE 010, FOR NOTES, LEGEND, CB TABLE, STREET SECTIONS AND DETAILS

KEY PLAN

1:500

SEAL

PRIME CONSULTANT

333 Preston Street - Suite 500
Ottawa ON K1S 5N4 Canada
tel 613 225 1311
www.arcadis.com

PROJECT

1015 DAIRY DRIVE

1015 DAIRY DRIVE

PROJECT NO: 142817

DRAWN BY: M.M./A.B.

CHECKED BY: R.M./D.Y.

PROJECT MGR: R.M.

APPROVED BY: D.Y.

SHEET TITLE

GRADING PLAN

SHEET NUMBER

C-200

ISSUE

4

File Location: \\142817_1015 Dairy_DY_0_Producent\03_Design\04_Civil\Sheets\C-200 GRADING.dwg Last Saved: June 25, 2025 5:24:55 PM by Bluma, Don
D07-12-13-0249
XXXXX

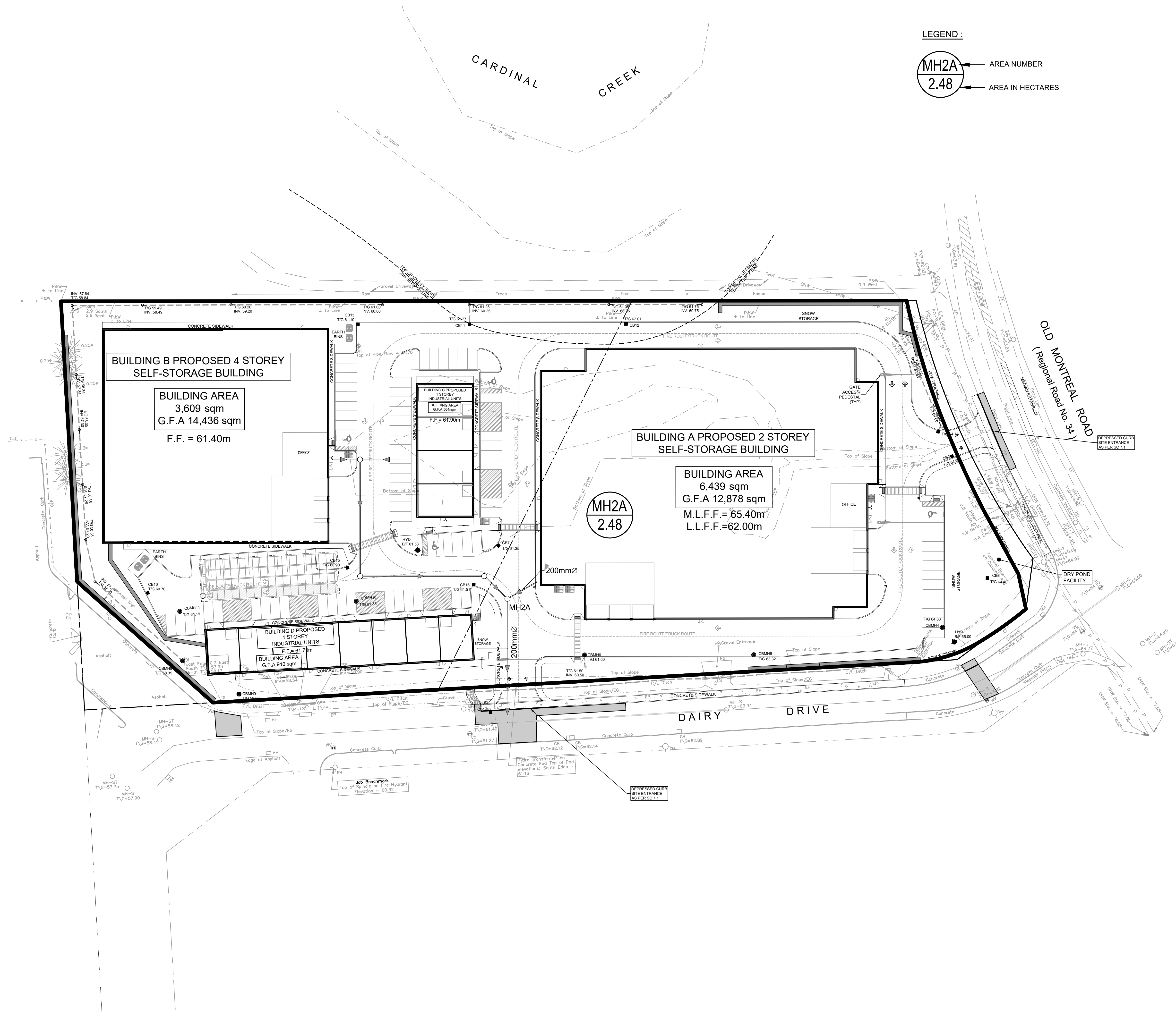

LEGEND :

MH2A

2.48

AREA NUMBER

AREA IN HECTARES

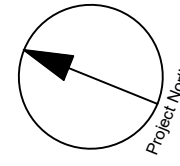

CLIENT

TSL DAIRY INC.

COPYRIGHT

This drawing has been prepared solely for the intended use, thus any reproduction or distribution for any purpose other than authorized by Arcadis is forbidden. Written dimensions shall have precedence over scaled dimensions. Contractors shall verify and be responsible for all dimensions and conditions on the job, and Arcadis shall be informed of any variations from the dimensions and conditions shown on the drawing. Shop drawings shall be submitted to Arcadis for general conformance before proceeding with fabrication.

Arcadis Professional Services (Canada) Inc.
Formerly B Group Professional Services (Canada) Inc.

| ISSUES | | |
|--------|----------------------------------|------------|
| No. | DESCRIPTION | DATE |
| 1 | SUBMISSION NO. 1 FOR CITY REVIEW | 2024-02-14 |
| 2 | SUBMISSION NO. 2 FOR CITY REVIEW | 2024-06-27 |
| 3 | SUBMISSION NO. 3 FOR CITY REVIEW | 2024-10-04 |
| 4 | SUBMISSION NO. 3 FOR CITY REVIEW | 2025-06-25 |
| 5 | | |
| 6 | | |

SEE 010, FOR NOTES, LEGEND, CB TABLE, STREET SECTIONS AND DETAILS

KEY PLAN

1:500

SEAL

PRIME CONSULTANT

333 Preston Street - Suite 500
Ottawa ON K1S 5N4 Canada
tel 613 225 1311
www.arcadis.com

PROJECT

1015 DAIRY DRIVE

1015 DAIRY DRIVE

PROJECT NO:

142817

DRAWN BY:

M.M./A.B.

CHECKED BY:

R.M./D.Y.

PROJECT MGR:

R.M.

APPROVED BY:

D.Y.

SHEET TITLE

SANITARY DRAINAGE AREA PLAN

SHEET NUMBER

C-400

ISSUE

4

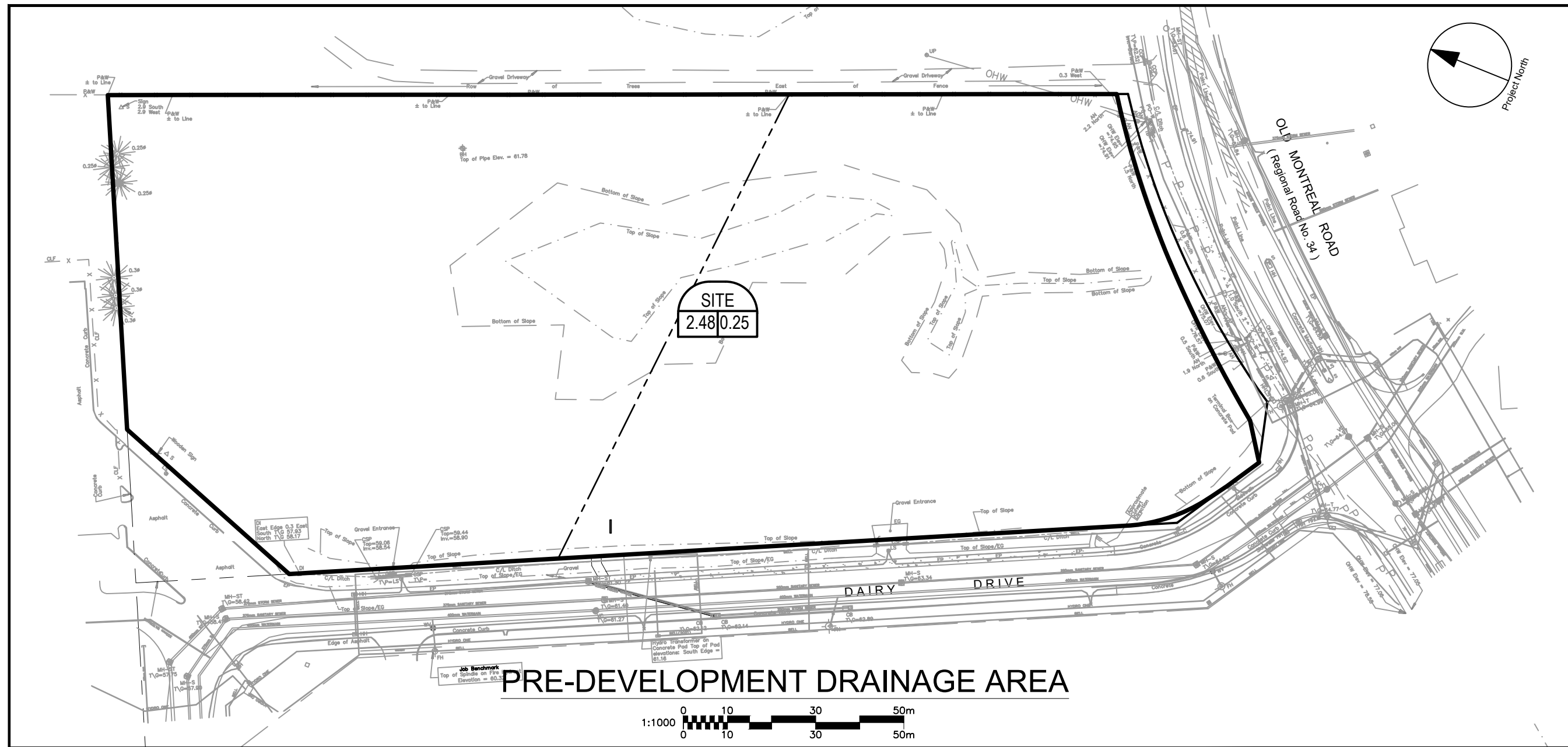

LEGEND :

UC1 AREA NUMBER
0.004 0.20 RUNOFF COEFFICIENT
AREA IN HECTARES
ICD AREAS

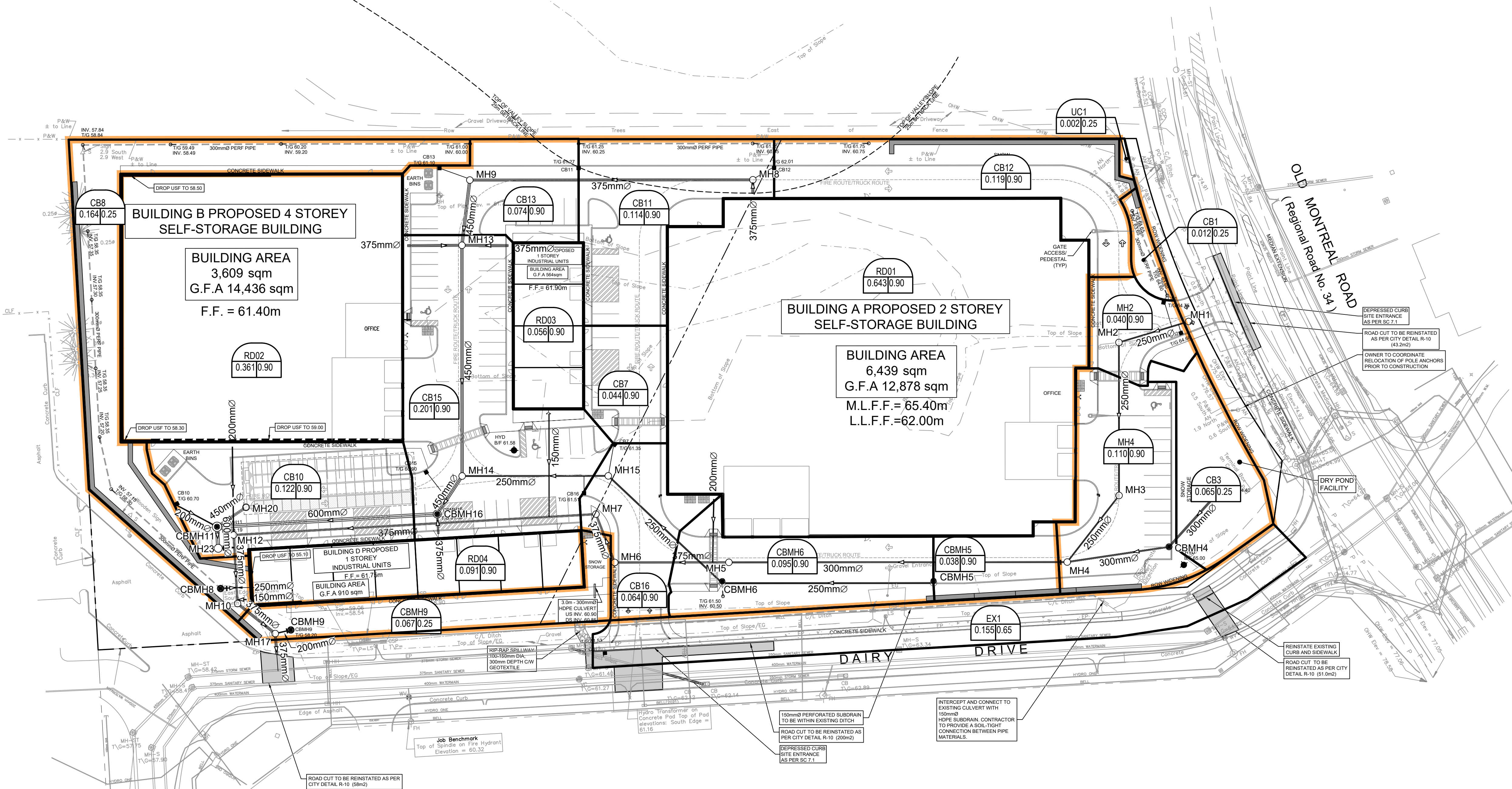
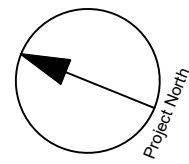

CLIENT
TSL DAIRY INC.

COPYRIGHT
This drawing has been prepared solely for the intended use, thus any reproduction or distribution for any purpose other than authorized by Arcadis is forbidden. Written dimensions shall have precedence over scaled dimensions. Contractors shall verify and be responsible for all dimensions and conditions on the job, and Arcadis shall be informed of any variations from the dimensions and conditions shown on the drawing. Shop drawings shall be submitted to Arcadis for general conformance before proceeding with fabrication.

Arcadis Professional Services (Canada) Inc.
Formerly B Group Professional Services (Canada) Inc.

| ISSUES | DESCRIPTION | DATE |
|--------|----------------------------------|------------|
| 1 | SUBMISSION NO. 1 FOR CITY REVIEW | 2024-02-14 |
| 2 | SUBMISSION NO. 2 FOR CITY REVIEW | 2024-06-27 |
| 3 | SUBMISSION NO. 3 FOR CITY REVIEW | 2024-10-04 |
| 4 | SUBMISSION NO. 3 FOR CITY REVIEW | 2025-06-25 |
| 5 | | |
| 6 | | |

SEE 010, FOR NOTES, LEGEND, CB TABLE, STREET SECTIONS AND DETAILS

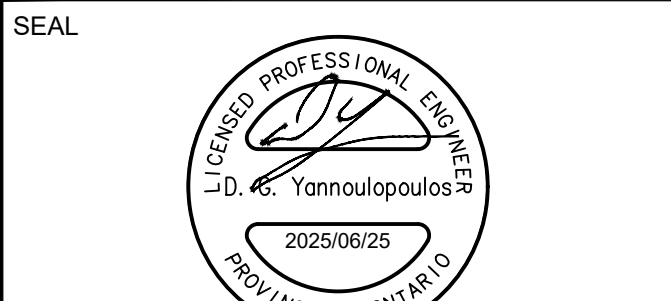
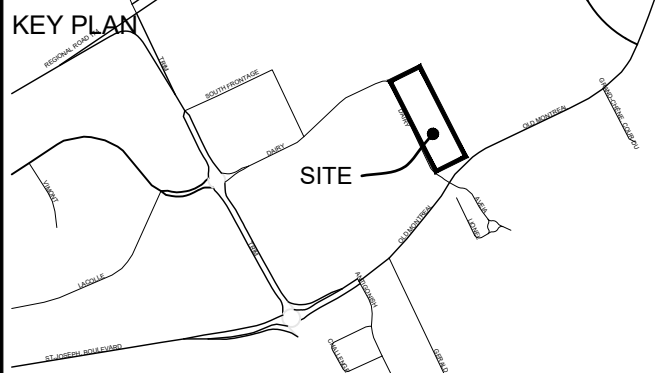

PRIME CONSULTANT
ARCADIS
333 Preston Street - Suite 500
Ottawa ON K1S 5N4 Canada
tel 613 225 1311
www.arcadis.com

PROJECT
1015 DAIRY DRIVE
1015 DAIRY DRIVE

PROJECT NO:
142817
DRAWN BY:
M.M./A.B.
PROJECT MGR:
R.M.

CHECKED BY:
R.M./D.Y.
APPROVED BY:
D.Y.

SHEET TITLE
STORM DRAINAGE AREA PLAN

SHEET NUMBER
C-500
ISSUE
4

0.0%

1.5%

PROPOSED DITCH C/W FLOW DIRECTION AND SLOPE

SLOPE C/W FLOW DIRECTION

MAJOR OVERLAND FLOW ROUTE

PROPOSED SPOT GRADE

PROPOSED SWALE GRADE

PROPOSED SWALE HIGH POINT GRADE

LOT CORNER GRADE C/W EXISTING GRADE

FULL STATIC AND 100%Y PONDING GRADE

TERRACING 3:1 MAXIMUM UNLESS NOTED OTHERWISE

104.62

104.50

104.60

96.79

X

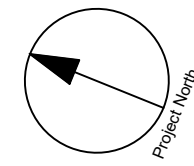

COPYRIGHT

This drawing has been prepared solely for the intended use, thus any reproduction or distribution for any purpose other than authorized by Arcadis is forbidden. Written dimensions shall have precedence over scaled dimensions. Contractors shall verify and be responsible for all dimensions and conditions on the job, and Arcadis shall be informed of any variations from the dimensions and conditions shown on the drawing. Shop drawings shall be submitted to Arcadis for general conformance before proceeding with fabrication.

Arcadis Professional Services (Canada) Inc.
formerly IBI Group Professional Services (Canada) Inc.

| ISSUES | | |
|--------|----------------------------------|------------|
| No. | DESCRIPTION | DATE |
| 1 | SUBMISSION NO.1 FOR CITY REVIEW | 2024-02-14 |
| 2 | SUBMISSION NO. 2 FOR CITY REVIEW | 2024-06-27 |
| 3 | SUBMISSION NO. 3 FOR CITY REVIEW | 2024-10-04 |
| 4 | SUBMISSION NO. 3 FOR CITY REVIEW | 2025-06-25 |
| 5 | | |
| 6 | | |

SEE 010, FOR NOTES, LEGEND, CB TABLE, STREET
SECTIONS AND DETAILS

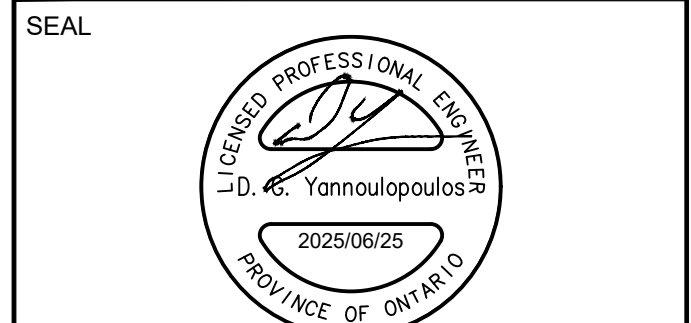
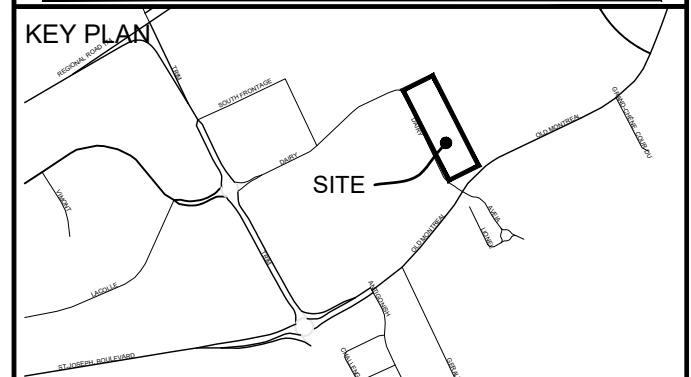

PRIME CONSULTANT

 **ARCADIS**

333 Preston Street - Suite 500
Ottawa ON K1S 5N4 Canada
tel 613 225 1311
www.arcadis.com

PROJECT
1015 DAIRY DRIVE

1015 DAIRY DRIVE

| |
|-----------------------|
| PROJECT NO: 142817 |
|-----------------------|

| | |
|-------------------------------|---------------------------------|
| DRAWN BY: M.M./A.B. | CHECKED BY: R.M./D.Y. |
|-------------------------------|---------------------------------|

| | |
|-----------------------------|-----------------------------|
| PROJECT MGR: R.M. | APPROVED BY: D.Y. |
|-----------------------------|-----------------------------|

| | |
|-------------|--------------|
| SHEET TITLE | PONDING PLAN |
|-------------|--------------|

| | |
|--------------|-------|
| SHEET NUMBER | ISSUE |
| C-600 | 4 |

File Location: J:\142817_1015_Dairy_D17.0_Production\7.03_Design\04_Civil\Sheets\C-600 PONDING.dwg
 Last Saved: June 25, 2025, by slurnad3150
 Plotted: June 25, 2025 5:32:50 PM by Slurna, Don
 D07-12-13-0249
 SCALE CHECK
 in 10mm
 XXXXXX

SCALE CHECK

| | |
|----|------|
| in | 10mm |
|----|------|



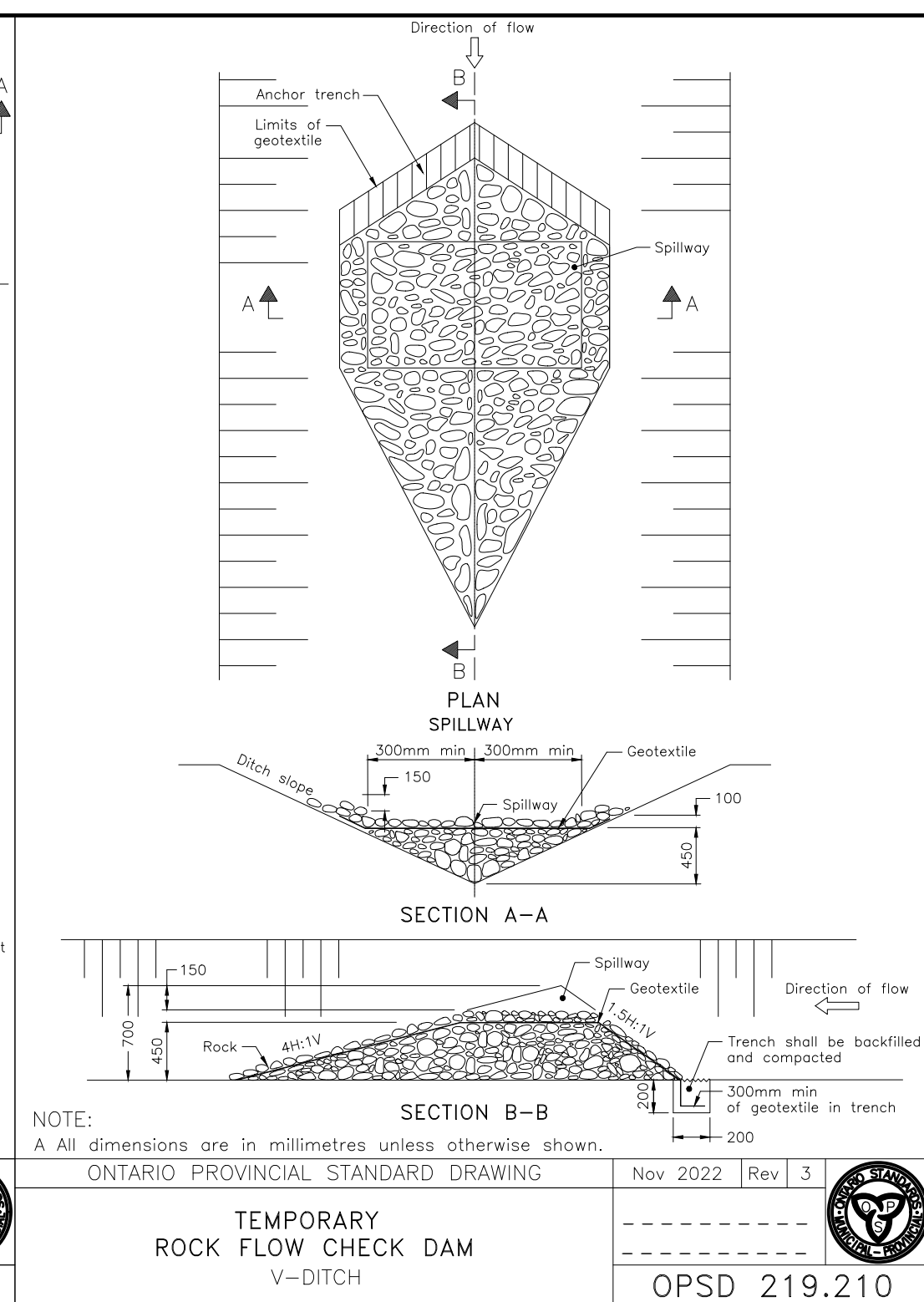

XXXXXX

D07-12-13-0249

File Location: J:\142817_1015_Data

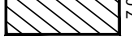

- NOTES:**
1. THE CONTRACTOR SHALL IMPLEMENT BEST MANAGEMENT PRACTICES, TO PROVIDE FOR PROTECTION OF THE AREA DRAINAGE SYSTEM AND THE RECEIVING WATERCOURSE, DURING CONSTRUCTION ACTIVITIES. THE CONTRACTOR ACKNOWLEDGES THAT FAILURE TO IMPLEMENT APPROPRIATE EROSION AND SEDIMENT CONTROL MEASURES MAY BE SUBJECT TO PENALTIES IMPOSED BY ANY APPLICABLE REGULATORY AGENCY,
 2. SILT FENCE TO BE ERECTED PRIOR TO EARTH WORKS BEING COMMENCED. SILT FENCE TO BE MAINTAINED UNTIL VEGETATION IS ESTABLISHED OR UNTIL START OF SUBSEQUENT PHASE.
 3. STRAW BALE SEDIMENT TRAPS TO BE CONSTRUCTED IN EXISTING ROAD SIDE DITCHES. TRAPS TO REMAIN AND BE MAINTAINED UNTIL VEGETATION IS ESTABLISHED.
 4. SILT SACK TO BE PLACED AND MAINTAINED UNDER COVER OF ALL CATCHBASINS. GEOTEXTILE SILT SACK IN STREET C&S TO REMAIN UNTIL ALL CURBS ARE CONSTRUCTED. GEOTEXTILE FABRIC IN RYCB TO REMAIN UNTIL VEGETATION IS ESTABLISHED. ALL CATCHBASINS TO BE REGULARLY INSPECTED AND CLEANED, AS NECESSARY, UNTIL SOD AND CURBS ARE CONSTRUCTED.
 5. CONTRACTOR TO PROVIDE DETAILS ON LOCATION(S) AND DESIGN OF Dewatering Trap(S) PRIOR TO COMMENCING WORK. CONTRACTOR ALSO RESPONSIBLE FOR MAINTAINING TRAP(S) AND ADJUSTING SIZE(S) IF DEEMED REQUIRED BY THE ENGINEER DURING CONSTRUCTION.
 6. CONTRACTOR TO PROTECT EXISTING CATCHBASINS WITH FILTER CLOTH UNDER THE COVERS TO TRAP SEDIMENTATION. REFER TO IDENTIFIED STRUCTURES.
 7. WORKS NOTED ABOVE ARE TO BE INSTALLED, INSPECTED, MAINTAINED AND ULTIMATELY REMOVED BY SERVICING CONTRACTOR.
 8. THIS IS A "LIVING DOCUMENT" AND MAY BE MODIFIED IN THE EVENT THE PROPOSED CONTROL MEASURES ARE INSUFFICIENT

| LEGEND: | |
|---|--|
|  | LIGHT DUTY SILT FENCE AS PER OPSD-219.110 |
|  | SNOW FENCE |
|  | STRAW BALE CHECK DAM AS PER OPSD-219.180 |
|  | ROCK CHECK DAM AS PER OPSD-219.210 |
|  | SILT SACK PLACED UNDER EXISTING CB COVER |
|  | TEMPORARY MUD MAT 0.15m THICK 50mm CLEAR STONE ON NON WOVEN FILTER CLOTH |

