

**CLIENT**  
**ROHIT COMMUNITIES**

550 91 STREET SW #101, EDMONTON, AB T6X0V1

**COPYRIGHT**  
 This drawing has been prepared solely for the intended use, thus any reproduction or distribution for any purpose other than authorized by Arcadis is forbidden. Written dimensions shall have precedence over scaled dimensions. Contractors shall verify and be responsible for all dimensions and conditions on the job, and Arcadis shall be informed of any variations from the dimensions and conditions shown on the drawing. Shop drawings shall be submitted to Arcadis for general conformance before proceeding with fabrication.

**Arcadis Professional Services (Canada) Inc.**  
 is a part of Arcadis

| No. | DESCRIPTION               | DATE       |
|-----|---------------------------|------------|
| 2   | ISSUED FOR SPA SUBMISSION | 2024-04-24 |
| 3   | ISSUED FOR SPA SUBMISSION | 2024-05-08 |
| 4   | ISSUED FOR SPA SUBMISSION | 2024-05-31 |
| 5   | ISSUED FOR SPA SUBMISSION | 2025-02-11 |
| 6   | ISSUED FOR SPA SUBMISSION | 2025-03-26 |

**LEGEND**

- TOPSOIL AND SOD AS SPECIFIED MINIMUM 150mm TOPSOIL DEPTH
- CONCRETE PAVING
- STONE MULCH
- WOOD CHIP MULCH
- PROPOSED TREES
- PROPOSED SHRUBS
- PROPOSED PERENNIALS
- PROPOSED ORNAMENTAL GRASSES
- PLANT SPECIES
- QUANTITY
- DETAIL NUMBER
- SHEET NUMBER
- SUBDIVISION TREES TO BE RELOCATED
- NEW LOCATION OF RELOCATED TREES

REFER TO TRANSPLANT NOTES AND TABLE ON THIS SHEET FOR MORE DETAILS.

**CONSULTANTS**  
 CIVIL: ARCADIS PROFESSIONAL SERVICES (CANADA) INC.  
 LANDSCAPE: ARCADIS PROFESSIONAL SERVICES (CANADA) SURVEY, ANNIS, O SULLIVAN, VOLLEBERG LTD.  
 ARCHITECTURE: NORR ARCHITECTS & ENGINEERING LTD.  
 STRUCTURAL: CUNLIFFE & ASSOCIATES  
 MECHANICAL: GOODKEY, WEEDMARK & ASSOCIATES LTD.  
 ELECTRICAL: GOODKEY, WEEDMARK & ASSOCIATES LTD.  
 OWNER: ROHIT AT WATERIDGE S LTD.

04272- 1232 BLOCK 6, PLAN 4M1718

**LANDSCAPE NOTES:**

- ALL WORK TO BE CARRIED OUT IN ACCORDANCE WITH BY-LAWS AND CODES HAVING JURISDICTION OVER SITE LOCATION.
- COMPLETE ALL WORK TO THE SATISFACTION OF THE LANDSCAPE ARCHITECT.
- REPORT ANY CHANGES, DISCREPANCIES OR SUBSTITUTIONS TO THE LANDSCAPE ARCHITECT FOR REVIEW. OBTAIN APPROVAL FROM THE LANDSCAPE ARCHITECT BEFORE PROCEEDING.
- IT IS THE CONTRACTOR'S RESPONSIBILITY TO DETERMINE EXISTING SERVICE LOCATIONS.
- EXACT LOCATIONS OF PLANT MATERIAL WILL BE DETERMINED BY PLACEMENT OF SITE SERVICES SUCH AS HYDRO VAULTS, METERS, UTILITIES ROOF RAIN WATER LEADERS, DRIVEWAYS, LIGHT STANDARDS, ETC.
- ALL PLANT MATERIAL LOCATIONS TO BE STAKED OR MARKED OUT AND APPROVED BY LANDSCAPE ARCHITECT PRIOR TO INSTALLATION.
- SUPPLY ALL PLANT MATERIAL IN ACCORDANCE WITH THE CANADIAN STANDARDS FOR NURSERY STOCK (B91 Ed.1).
- INSTALL PLANT MATERIAL ACCORDING TO DETAILS SHOWN.
- DISTURBED SOIL AREAS AROUND TREES AND SHRUBS ARE TO BE COVERED WITH SHREDDED CONIFER BARK MULCH SUCH AS 'CANADA RED' OR 'GRO-BARK' SPM MULCH, OR APPROVED EQUIVALENT. ALTERNATIVE MULCHES MUST BE APPROVED BY THE LANDSCAPE ARCHITECT.
- CONTRACTOR TO UTILIZE LAYOUT DIMENSIONS WHERE PROVIDED.
- PROVIDE PLANTING BED AREA AS NOTED ON THE DRAWING OR TO ACCOMMODATE MATURE SIZE OF PLANT MATERIAL.
- ALL SUPPORT SYSTEMS MUST BE REMOVED BY THE CONTRACTOR AT TIME OF FINAL ACCEPTANCE. NO EXTRAS WILL BE PAID TO COMPLETE THIS WORK.
- SUPPLY AND PLACE TOPSOIL IN ACCORDANCE WITH OPSS 570 TO A MINIMUM DEPTH OF 150mm UNLESS OTHERWISE SPECIFIED.
- SUPPLY AND PLACE SOD IN ACCORDANCE WITH OPSS 571 UNLESS OTHERWISE SPECIFIED.
- SUPPLY AND PLACE SEED IN ACCORDANCE WITH OPSS 572 UNLESS OTHERWISE SPECIFIED. ALL S/1 OR GREATER SLOPES TO BE SEEDED WITH TACIFIER. CONTRACTOR TO PROVIDE NECESSARY EROSION CONTROL PROTECTION AS REQUIRED TO ENSURE SOIL STABILIZATION AND PROPER SEED GERMINATION.
- ALL DIMENSIONS IN METRES UNLESS OTHERWISE NOTED.
- IF DISCREPANCIES ARISE BETWEEN PLANT MATERIAL COUNT SHOWN ON DRAWING AND PLANT LIST, THE DRAWING SHALL BE CONSIDERED CORRECT.
- CONTRACTOR TO PROVIDE MINIMUM TWO (2) YEAR WARRANTY FROM DATE ACCEPTED ON ALL WORK UNLESS OTHERWISE SPECIFIED.
- ANY SITE PLAN OR GRADING AND SERVICING SHOWN IS FOR INFORMATION ONLY. REFER TO APPROVED DRAWINGS.
- NOT FOR CONSTRUCTION UNLESS STAMPED, SIGNED AND DATED BY LANDSCAPE ARCHITECT.
- DRAWINGS NOT TO BE REPRODUCED WITHOUT WRITTEN CONSENT FROM LANDSCAPE ARCHITECT.
- APPROVAL OF LANDSCAPE PLAN TO BE OBTAINED FROM MUNICIPALITY.
- FOR GRADING AND SERVICING INFORMATION REFER TO THE CONSULTING ENGINEER'S DRAWINGS.
- FOR LIGHTING INFORMATION AND POWER DISTRIBUTION REFER TO THE ELECTRICAL CONSULTANT'S DRAWINGS.

**LANDSCAPE PLANTING SCHEDULE:**

| KEY                             | QTY. | BOTANICAL NAME   | COMMON NAME                      | CALIPER (mm) | SIZE (cm) | CONDITION/FORM  | MIN. O.C. SPACING (m) | OWNERSHIP | NATIVE (YES/NO) |
|---------------------------------|------|--|----------------------------------|--------------|-----------|-----------------|-----------------------|-----------|-----------------|
| <b>TREES</b>                    |      |  |                                  |              |           |                 |                       |           |                 |
| Ab                              | 1    | <i>Abies Balsamea</i>  | White Spruce                     |              | 150       | W.B.            | As Shown              | Private   | Yes             |
| Ac                              | 10   | <i>Amelanchier canadensis</i>                                  | Shadblow Serviceberry            | 50           |           | W.B.            | As Shown              | Private   | Yes             |
| Ar                              | 5    | <i>Acer rubrum</i>   | Red Maple                        | 50           |           | W.B.            | As Shown              | Private   | Yes             |
| ArA                             | 3    | <i>Acer rubrum 'Armstrong'</i>                                 | Armstrong Maple                  | 50           |           | W.B.            | As Shown              | Private   | No              |
| Cc                              | 3    | <i>Carpinus caroliniana</i>                                    | Blue Beech                       | 50           |           | W.B.            | As Shown              | Private   | Yes             |
| GbP                             | 8    | <i>Ginkgo biloba 'Princeton Sentry'</i>                        | Princeton Sentry Maidentree      | 50           |           | W.B.            | As Shown              | Private   | No              |
| GIS                             | 2    | <i>Gleditsia triacanthos f. inermis 'Skycole'</i>              | Skyline Honeylocust              | 50           |           | W.B.            | As Shown              | Private   | No              |
| LF                              | 13   | <i>Liriodendron tulipifera 'Fastigata'</i>                     | Columnar Tulip Tree              | 50           |           | W.B.            | As Shown              | Private   | No              |
| Pg                              | 9    | <i>Picea glauca</i>  | White Spruce                     |              | 150       | W.B.            | As Shown              | Private   | Yes             |
| PoB                             | 5    | <i>Picea omarika 'Bruns'</i>                                   | Bruns Serbian Spruce             | 150          |           | W.B.            | As Shown              | Private   | No              |
| Po                              | 6    | <i>Platanus occidentalis</i>                                   | American Sycamore                | 50           |           | W.B.            | As Shown              | Private   | Yes             |
| Pr                              | 3    | <i>Pinus resinosa</i>  | Red Pine                         | 150          |           | W.B.            | As Shown              | Private   | Yes             |
| Qr                              | 5    | <i>Quercus rubra</i>   | Northern Red Oak                 | 50           |           | W.B.            | As Shown              | Private   | Yes             |
| Srl                             | 4    | <i>Syringa reticulata 'Ivory Silk'</i>                         | Ivory Silk Japanese Lilac Tree   | 50           |           | W.B.            | As Shown              | Private   | No              |
| TOTAL: 77                       |      |  |                                  |              |           |                 |                       |           |                 |
| <b>SHRUBS</b>                   |      |  |                                  |              |           |                 |                       |           |                 |
| ArP                             | 14   | <i>Amelanchier canadensis 'Glenn Form' syn. Rainbow Pillar</i> | Rainbow Pillar Serviceberry      |              | 200       | W.B., Multistem | As Shown              | Private   | No              |
| Cs                              | 18   | <i>Cornus sericea</i>  | Red Osier Dogwood                | 60           | 3 Gal     |                 | 2                     | Private   | Yes             |
| Cst                             | 15   | <i>Cornus stolonifera</i>                                      | Arctic Fire Dogwood              | 60           | 4 Gal     |                 | 1                     | Private   | Yes             |
| HaA                             | 64   | <i>Hydrangea abrosscens 'Annabelle'</i>                        | Annabelle Hydrangea              | 60           | 3 Gal     |                 | 1                     | Private   | No              |
| HdP                             | 106  | <i>Hydrangea paniculata 'Strawberry Sundae'</i>                | Strawberry Sundae Hydrangea      | 60           | 3 Gal     |                 | 1                     | Private   | No              |
| JmD                             | 151  | <i>Juniperus sabina 'Monard'</i>                               | Moor-dense Juniper               | 50           | 3 Gal     |                 | 1                     | Private   | No              |
| Pop                             | 13   | <i>Physocarpus opulifolius</i>                                 | Common ninebark                  | 50           | 3 Gal     |                 | 1.5                   | Private   | No              |
| Sc                              | 9    | <i>Sambucus canadensis</i>                                     | Common Elderberry                | 60           | 3 Gal     |                 | 2                     | Private   | Yes             |
| SbG                             | 204  | <i>Spiraea betulifolia 'Glow girl'</i>                         | Glow Girl Birch Leaf Spirea      | 40           | 3 Gal     |                 | 0.5                   | Private   | No              |
| SP                              | 400  | <i>Spiraea japonica 'Pineapple Fizz'</i>                       | Pineapple Fizz Spirea            | 40           | 3 Gal     |                 | 0.5                   | Private   | No              |
| SJM                             | 176  | <i>Spiraea japonica 'Walburna'</i>                             | Magic Carpet Spirea              | 40           | 3 Gal     |                 | 0.5                   | Private   | No              |
| St                              | 53   | <i>Spiraea tomentosa</i>                                       | Steeplebush                      | 40           | 3 Gal     |                 | 0.5                   | Private   | Yes             |
| SmP                             | 35   | <i>Syringa meyeri 'Palibin'</i>                                | Dwarf Korean Lilac               | 60           | 3 Gal     |                 | 1.5                   | Private   | No              |
| TmH                             | 104  | <i>Taxus cuspidata 'nana'</i>                                  | Dwarf Japanese Yew               | 60           | 3 Gal     |                 | 1                     | Private   | No              |
| ToE                             | 45   | <i>Thuja occidentalis 'Emerald'</i>                            | Emerald Cedar                    | 175          | 10 Gal    |                 | 1.5                   | Private   | No              |
| Wn                              | 99   | <i>Weigela florida 'Nana Variegata'</i>                        | Dwarf Variegated Weigela         | 50           | 3 Gal     |                 | 1                     | Private   | No              |
| WV                              | 260  | <i>Weigela florida 'Vell'neig'</i>                             | My Monet Weigela                 | 50           | 3 Gal     |                 | 1                     | Private   | No              |
| TOTAL: 1766                     |      |  |                                  |              |           |                 |                       |           |                 |
| <b>PERENNIALS &amp; GRASSES</b> |      |  |                                  |              |           |                 |                       |           |                 |
| AaF                             | 80   | <i>Astilbe arendsii 'Fanal'</i>                                | Astilbe Fanal                    |              |           | 1 Gal           | 0.5                   | Private   | No              |
| AcV                             | 166  | <i>Astilbe chinensis 'Vision in White'</i>                     | Chinese Astilbe                  |              |           | 1 Gal           | 0.5                   | Private   | No              |
| CaK                             | 173  | <i>Calamagrostis acutiflora 'Karl Foerster'</i>                | Karl Foerster Feather Reed Grass |              |           | 1 Gal           | 0.5                   | Private   | No              |
| FgE                             | 780  | <i>Festuca glauca 'Elijah Blue'</i>                            | Blue Fescue                      |              |           | 1 Gal           | 0.5                   | Private   | No              |
| Ha                              | 195  | <i>Hosta 'Anne'</i>  | Hosta                            |              |           | 1 Gal           | 0.5                   | Private   | No              |
| Hp                              | 247  | <i>Hosta 'Patriot'</i>   | Hosta                            |              |           | 1 Gal           | 0.5                   | Private   | No              |
| HbS                             | 146  | <i>Heuchera X 'Berry Smoothie'</i>                             | Berry Smoothie Cora Bell         |              |           | 1 Gal           | 0.5                   | Private   | No              |
| HcF                             | 430  | <i>Heuchera X 'Cajun Fire'</i>                                 | Cajun Fire Cora Bell             |              |           | 1 Gal           | 0.5                   | Private   | No              |
| Hg                              | 395  | <i>Heuchera X 'Guacamole'</i>                                  | Guacamole Cora Bell              |              |           | 1 Gal           | 0.5                   | Private   | No              |
| Hs                              | 129  | <i>Hemerocallis 'Steffa de Oro'</i>                            | Stella de Oro Daylily            |              |           | 1 Gal           | 0.5                   | Private   | No              |
| MsP                             | 319  | <i>Miscanthus sinensis 'Purpurascens'</i>                      | Flame Grass                      |              |           | 1 Gal           | 0.5                   | Private   | No              |
| TOTAL: 3060                     |      |  |                                  |              |           |                 |                       |           |                 |

**TRANSPLANT NOTES:**

THE OWNER ACKNOWLEDGES AND AGREES TO TRANSPLANT 4 TREES FROM THE CITY OF OTTAWA RIGHT OF WAY, IN ADVANCE OF CONSTRUCTION TO A PROTECTED AREA OF THE PROPERTY TO COMPLETE SITE CONSTRUCTION. UPON COMPLETION OF CONSTRUCTION, THE TREES WILL BE TRANSPLANTED TO THEIR FINAL PLANTING LOCATION. IF ANY OF THE TREES DECLINE OR DIE WITHIN 2 YEARS OF THE FINAL PLANTING DATE, AS SHOWN IN THE LANDSCAPE PLAN PREPARED BY ARCADIS, DATED AUGUST 2024 COMPENSATION IN THE FORM OF 1:1 REPLACEMENT TREE PLANTING WILL BE REQUIRED. IF DECLINE OR DEATH OCCURS, THE OWNER SHALL PREPARE AND SUBMIT AN AMENDED LANDSCAPE PLAN PREPARED TO THE SATISFACTION OF THE DEVELOPMENT REVIEW MANAGER OF THE RELEVANT BRANCH WITHIN THE PLANNING, REAL ESTATE AND ECONOMIC DEVELOPMENT DEPARTMENT, OR HIS/HER DESIGNATE, SHOWING THE LOCATION, STOCK SIZE, AND SPECIES OF TREE BEING PLANTED AS A REPLACEMENT(S).

| KEY                       | QTY. | BOTANICAL NAME                               | COMMON NAME               |
|---------------------------|------|--|---------------------------|
| <b>TRANSPLANTED TREES</b> |      |  |                           |
| 1                         | 1    | <i>Catalpa speciosa</i>                      | Northern Catalpa          |
| 2                         | 1    | <i>Ulmus japonica x pumila 'New Horizon'</i> | New Horizon Elm           |
| 3                         | 1    | <i>Quercus ellipsoidalis</i>                 | Northern Pin Oak          |
| 4                         | 1    | <i>Gleditsia triacanthos 'Draves'</i>        | Street Keeper Honeylocust |

\*NOTE THAT TREES ARE TRANSPLANTED IN THE RIGHT OF WAY AND NOT WITHIN PRIVATE PROPERTY AND ARE NOT INCLUDED IN THE FUTURE CANOPY COVER PROJECTION CALCULATIONS

**LANDSCAPE AREA STATISTICS:**

| SITE AREA - 11636.72 m <sup>2</sup> |                     |
|-------------------------------------|---------------------|
| HARDSCAPE (8.9% OF SITE AREA)       |                     |
| CONCRETE                            | 850 m <sup>2</sup>  |
| UNIT PAVER                          | 170 m <sup>2</sup>  |
| PEAGRAVEL                           | 26 m <sup>2</sup>   |
| TOTAL                               | 1046 m <sup>2</sup> |
| SOFTSCAPE (37.8% OF SITE AREA)      |                     |
| PLANT BEDS (INCLUDING MULCH BEDS)   | 2103 m <sup>2</sup> |
| SOD                                 | 2306 m <sup>2</sup> |
| TOTAL                               | 4409 m <sup>2</sup> |

**SEAL**

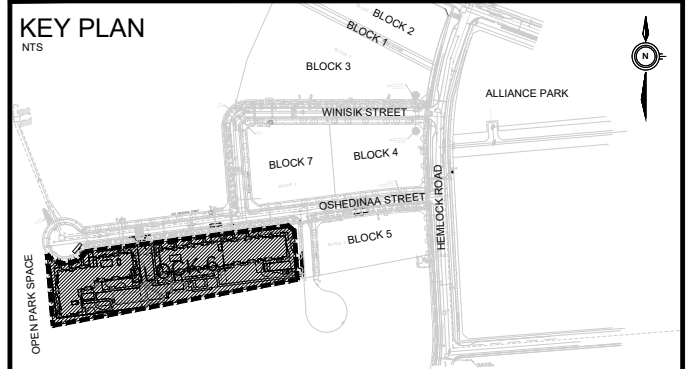

**PRIME CONSULTANT**

**ARCADIS**

410 Albert Street - Suite 101  
 Waterloo ON N2L 3V3 Canada  
 tel 519 585 2255  
 www.arcadis.com

**PROJECT**  
**ROHIT WATERIDGE VILLAGE BLOCK 6**  
 OTTAWA, ON

**PROJECT NO:**  
 144148

**DRAWN BY:**  
 R.S.

**CHECKED BY:**  
 M.P.

**PROJECT MGR:**  
 M.P.

**APPROVED BY:**  
 T.O.

**SHEET TITLE**  
**LANDSCAPE SITE PLAN**

**SHEET NUMBER**  
**LP1**

**ISSUE**  
**6**

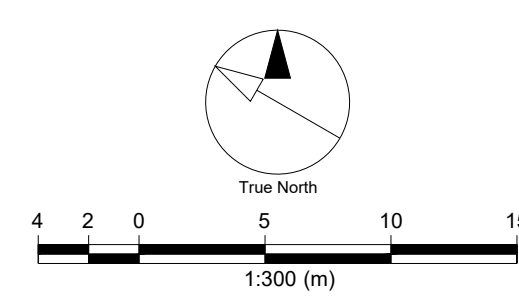



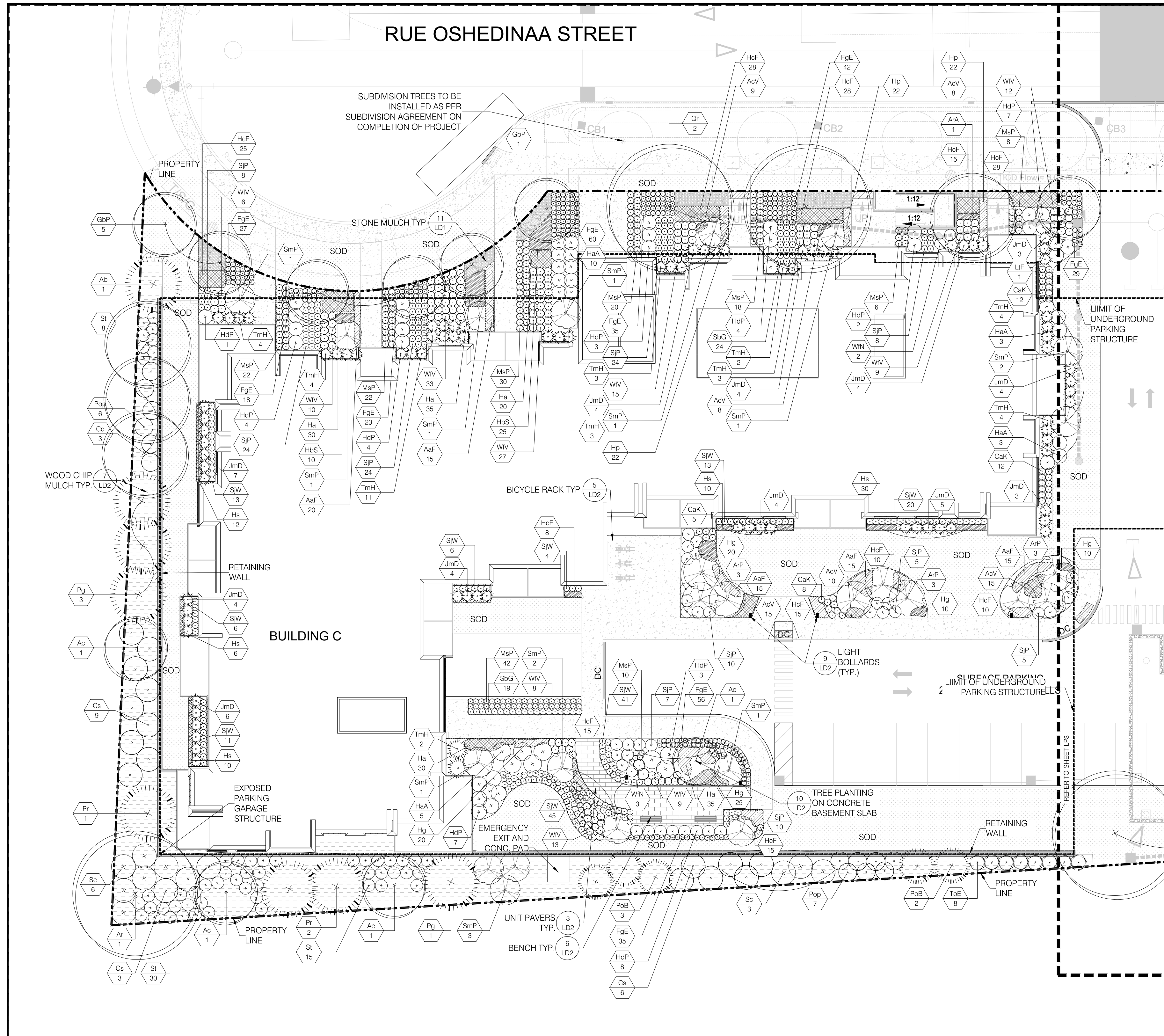

CLIENT  
**ROHIT COMMUNITIES**

550 91 STREET SW #101, EDMONTON, AB  
T6X0V1

**COPYRIGHT**  
This drawing has been prepared solely for the intended use, thus any reproduction or distribution for any purpose other than authorized by Arcadis is forbidden. Written dimensions shall have precedence over scaled dimensions. Contractors shall verify and be responsible for all dimensions and conditions on the job, and Arcadis shall be informed of any variations from the dimensions and conditions shown on the drawing. Shop drawings shall be submitted to Arcadis for general conformance before proceeding with fabrication.

**Arcadis Professional Services (Canada) Inc.**  
is a part of Arcadis

**ISSUES**

| No. | DESCRIPTION               | DATE       |
|-----|---------------------------|------------|
| 2   | ISSUED FOR SPA SUBMISSION | 2024-04-24 |
| 3   | ISSUED FOR SPA SUBMISSION | 2024-05-08 |
| 4   | ISSUED FOR SPA SUBMISSION | 2024-05-31 |
| 5   | ISSUED FOR SPA SUBMISSION | 2025-02-11 |
| 6   | ISSUED FOR SPA SUBMISSION | 2025-03-26 |

**LEGEND**

|  |                                   |
|--|-----------------------------------|
|  | TOPSOIL AND SOD AS SPECIFIED      |
|  | MINIMUM 150mm TOPSOIL DEPTH       |
|  | CONCRETE PAVING                   |
|  | STONE MULCH                       |
|  | WOOD CHIP MULCH                   |
|  | PROPOSED TREES                    |
|  | PROPOSED SHRUBS                   |
|  | PROPOSED PERENNIALS               |
|  | PROPOSED ORNAMENTAL GRASSES       |
|  | PLANT SPECIES                     |
|  | QUANTITY                          |
|  | DETAIL NUMBER                     |
|  | SHEET NUMBER                      |
|  | SUBDIVISION TREES TO BE RELOCATED |
|  | NEW LOCATION OF RELOCATED TREES   |

PREFER TO TRANSPLANT NOTES AND TABLE ON THIS SHEET FOR MORE DETAILS.

**CONSULTANTS**  
 CIVIL: ARCADIS PROFESSIONAL SERVICES (CANADA) INC.  
 LANDSCAPE: ARCADIS PROFESSIONAL SERVICES (CANADA) INC.  
 SURVEY: ARNOLD & SULLIVAN VOLLEBERG LTD.  
 ARCHITECTURE: NORR ARCHITECTS & ENGINEERING LTD.  
 STRUCTURAL: CUNLIFFE & ASSOCIATES  
 MECHANICAL: GOODKEY, WEEDMARK & ASSOCIATES LTD.  
 ELECTRICAL: GOODKEY, WEEDMARK & ASSOCIATES LTD.  
 OWNER: ROHIT AT WATERIDGE S LTD.

04272- 1232 BLOCK 6, PLAN 4M1718

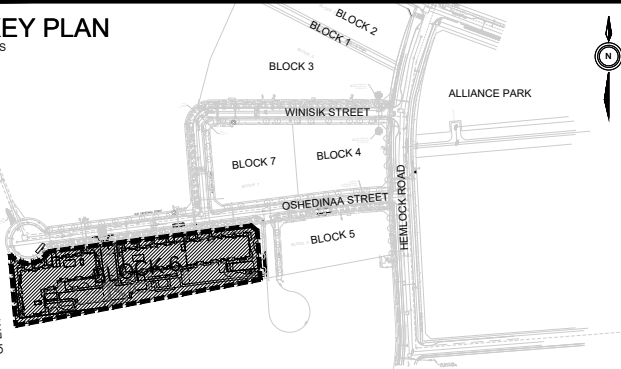
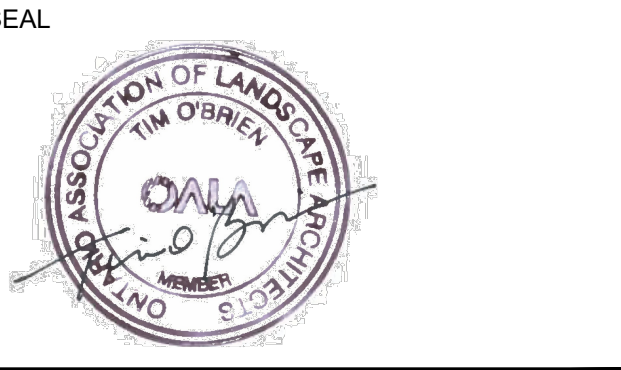

**ARCADIS**  
 410 Albert Street - Suite 101  
 Waterloo ON N2L 3V3 Canada  
 tel 519 585 2255  
 www.arcadis.com

PROJECT  
**ROHIT WATERIDGE VILLAGE  
BLOCK 6**  
OTTAWA, ON

PROJECT NO:  
144148  
 DRAWN BY: R.S. CHECKED BY: M.P.  
 PROJECT MGR: M.P. APPROVED BY: T.O.

SHEET TITLE  
**LANDSCAPE PLAN BUILDING C**

SHEET NUMBER  
**LP2** ISSUE  
**6**

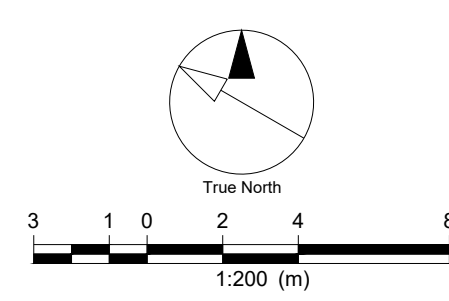

File Location: J:\Ottawa\144148\_Block\_6\_Ph1\_Y0\_Production\7.03\_Design\7.03\_Design\Sheet\144148\_Block\_6\_LP.dwg Last Saved: February 12, 2025, 5:25:52 PM by shenoy0564 Plot: March 25, 2025, 5:25:52 PM by shenoy0564  
 SCALE CHECK: 1/16



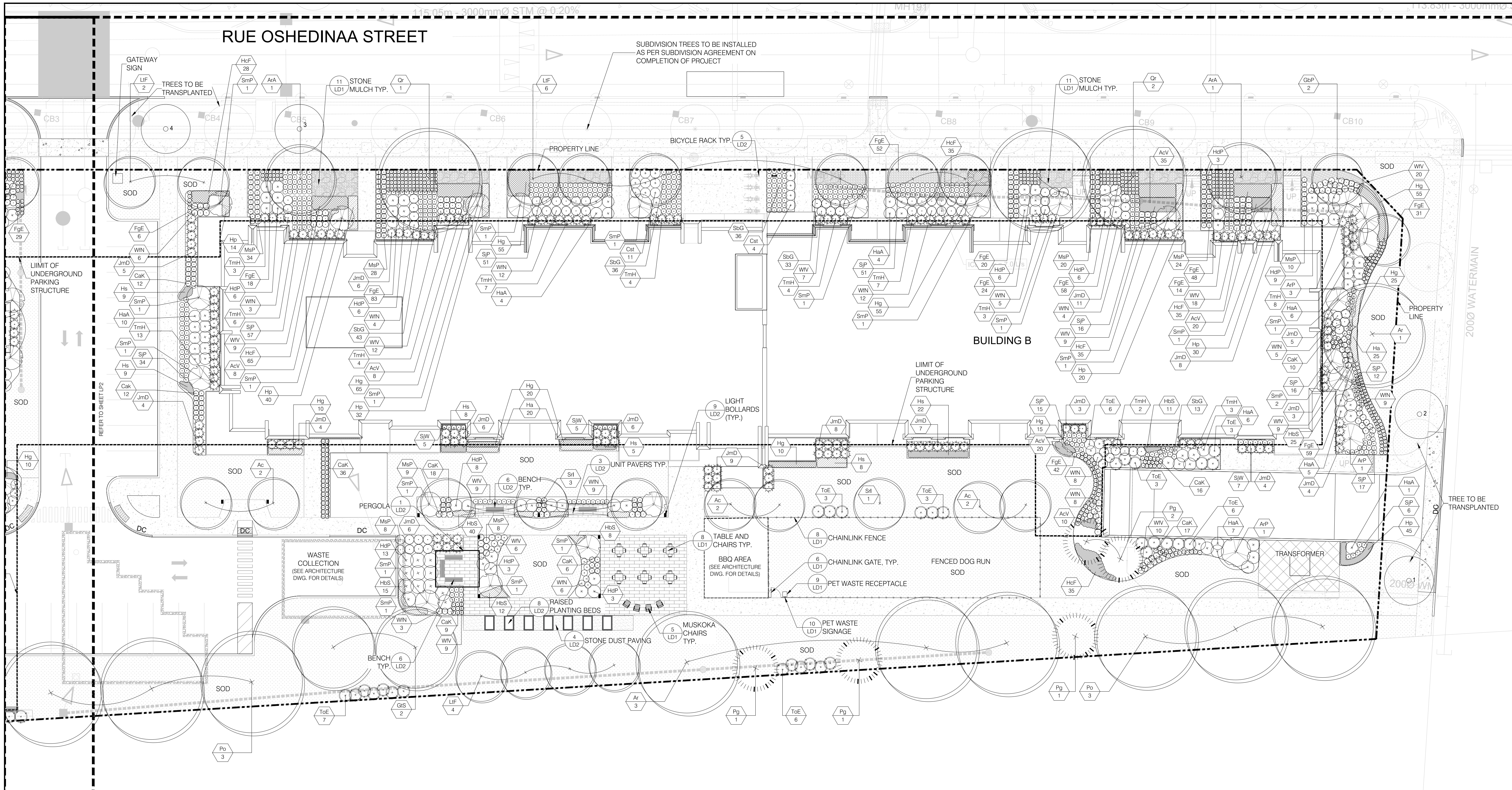

CLIENT  
**ROHIT COMMUNITIES**  
 550 91 STREET SW #101, EDMONTON, AB  
 T6X0V1

**COPYRIGHT**  
 This drawing has been prepared solely for the intended use, thus any reproduction or distribution for any purpose other than authorized by Arcadis is forbidden. Written dimensions shall have precedence over scaled dimensions. Contractors shall verify and be responsible for all dimensions and conditions on the job, and Arcadis shall be informed of any variations from the dimensions and conditions shown on the drawing. Shop drawings shall be submitted to Arcadis for general conformance before proceeding with fabrication.

Arcadis Professional Services (Canada) Inc.  
 is a part of Arcadis

**ISSUES**

| No. | DESCRIPTION               | DATE       |
|-----|---------------------------|------------|
| 2   | ISSUED FOR SPA SUBMISSION | 2024-04-24 |
| 3   | ISSUED FOR SPA SUBMISSION | 2024-05-08 |
| 4   | ISSUED FOR SPA SUBMISSION | 2024-05-31 |
| 5   | ISSUED FOR SPA SUBMISSION | 2025-02-11 |
| 6   | ISSUED FOR SPA SUBMISSION | 2025-03-26 |

**LEGEND**

|  |                                   |
|--|-----------------------------------|
|  | TOPSOIL AND SOD AS SPECIFIED      |
|  | CONCRETE PAVING                   |
|  | STONE MULCH                       |
|  | WOOD CHIP MULCH                   |
|  | PROPOSED TREES                    |
|  | PROPOSED SHRUBS                   |
|  | PROPOSED PERENNIALS               |
|  | PROPOSED ORNAMENTAL GRASSES       |
|  | PLANT SPECIES                     |
|  | QUANTITY                          |
|  | DETAIL NUMBER                     |
|  | SHEET NUMBER                      |
|  | SUBDIVISION TREES TO BE RELOCATED |
|  | NEW LOCATION OF RELOCATED TREES   |

REFER TO TRANSPLANT NOTES AND TABLE ON THIS SHEET FOR MORE DETAILS

**CONSULTANTS**  
 CIVIL: ARCADIS PROFESSIONAL SERVICES (CANADA) INC.  
 LANDSCAPE: ARCADIS PROFESSIONAL SERVICES (CANADA) INC.  
 SURVEY: ARNS, O'SULLIVAN, VOLLEBERG LTD.  
 ARCHITECTURE: NORR ARCHITECTS & ENGINEERING LTD.  
 STRUCTURAL: CUNLIFE & ASSOCIATES  
 MECHANICAL: GOODKEY, WEEDMARK & ASSOCIATES LTD.  
 ELECTRICAL: GOODKEY, WEEDMARK & ASSOCIATES LTD.  
 OWNER: ROHIT AT WATERIDGE 5 LTD.

04272- 1232 BLOCK 6, PLAN 4M1718

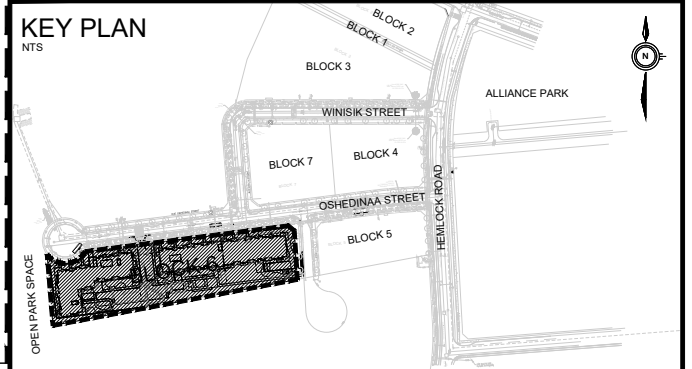
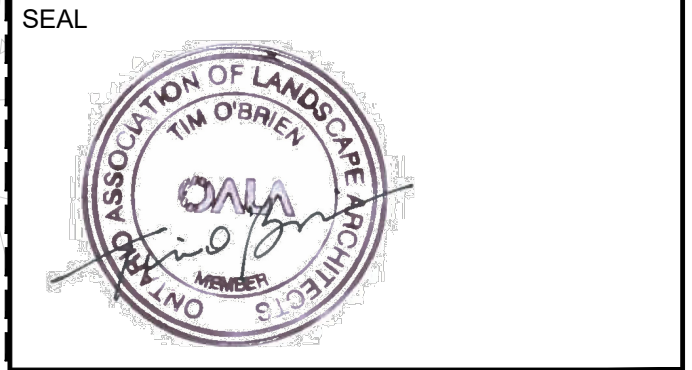

**PRIME CONSULTANT**

**ARCADIS**

410 Albert Street - Suite 101  
 Waterloo ON N2L 3V3 Canada  
 tel 519 585 2255  
 www.arcadis.com

**PROJECT**  
 ROHIT WATERIDGE VILLAGE  
 BLOCK 6  
 OTTAWA, ON

**PROJECT NO:**  
 144148

**DRAWN BY:** R.S  
**CHECKED BY:** M.P.

**PROJECT MGR:** M.P.  
**APPROVED BY:** T.O.

**SHEET TITLE**  
 LANDSCAPE PLAN BUILDING B

**SHEET NUMBER**  
 LP3

**ISSUE**  
 6

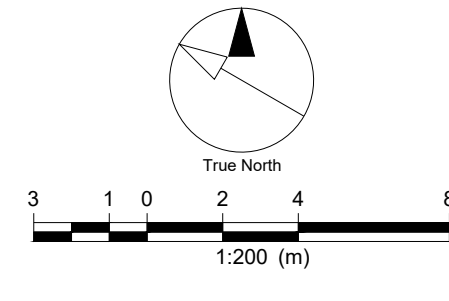

File Location: I:\Ottawa\144148\_Block\_6\_Ph1\_Y0\_Production\7.03\_Design\05\_Landscape\Sheet\144148\_LP.dwg Last Saved: February 12, 2025, by ahenny0564 Plot: March 25, 2025 5:25:43 PM by Sherry Kocachery\_Rathna



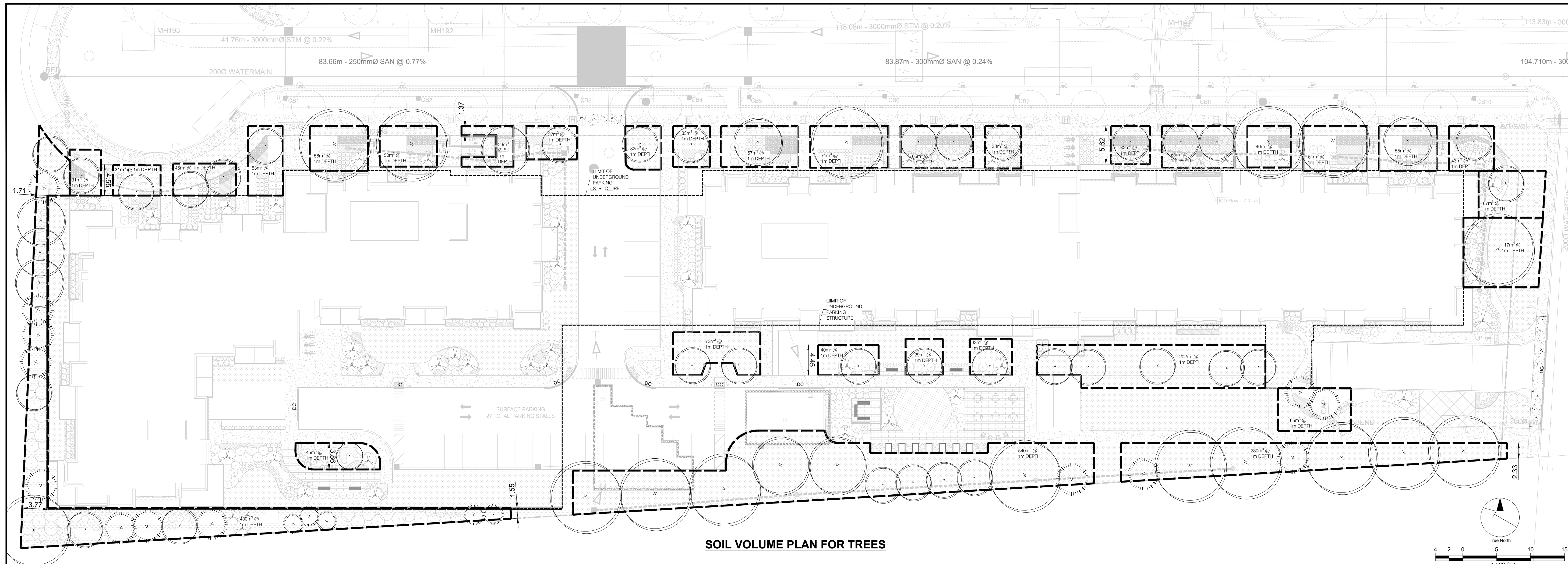

SOIL VOLUME PLAN FOR TREES

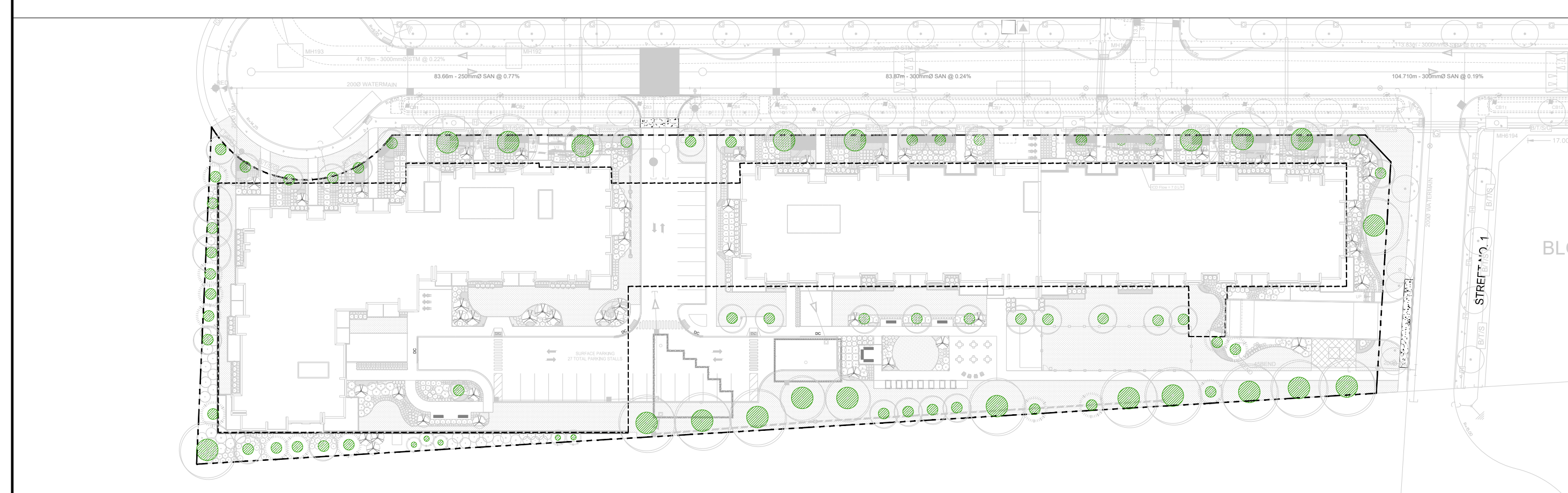

CANOPY PLAN - AS PLANTED

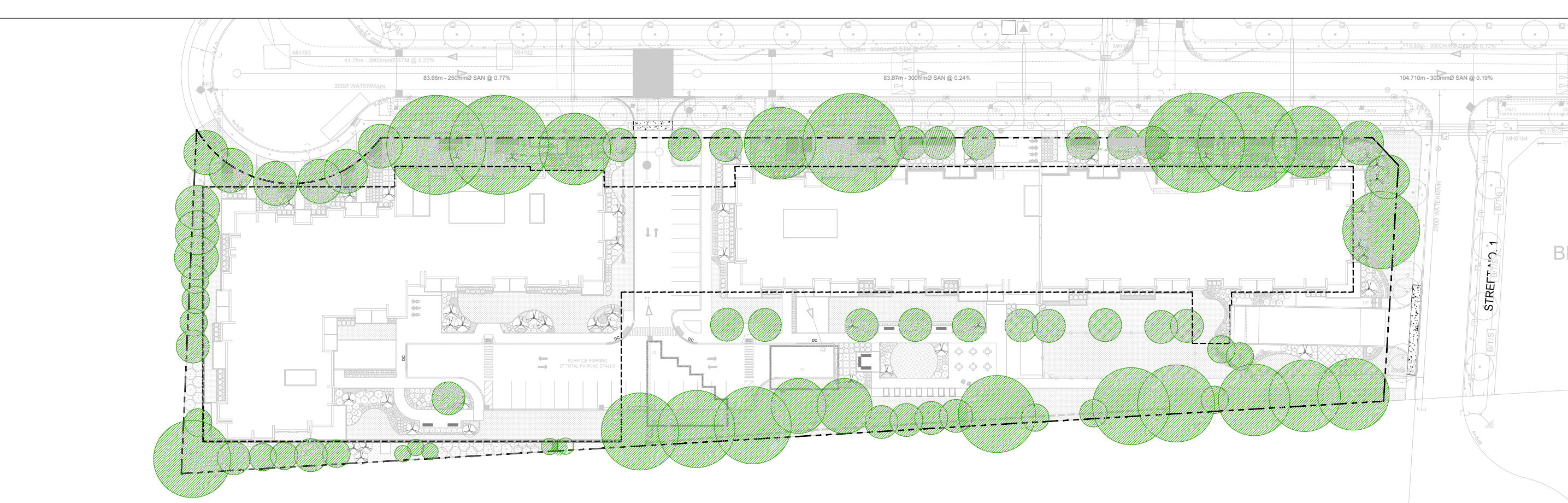

CANOPY PLAN IN 40 YEARS

CANOPY COVER CALCULATIONS

| KEY  | BOTANICAL NAME  | COMMON NAME                    | QTY.      | CROWN AREA PER TREE WHEN PLANTED (m²) | CANOPY AREA SUBTOTAL WHEN PLANTED (m²) | CROWN AREA PER TREE WHEN MATURE (m²) | CANOPY AREA SUBTOTAL WHEN MATURE (m²) | PERCENTAGE OF TOTAL CANOPY (%) | PERCENTAGE OF TOTAL GENUS (%) |
|--|---|--------------------------------|-----------|---------------------------------------|--|--------------------------------------|---------------------------------------|--------------------------------|-------------------------------|
| <b>LARGE STATURE TREES (12m+ SPREAD)</b>             |   |                                |           |                                       |  |                                      |                                       |                                |                               |
| Ar   | <i>Acer rubrum</i>  | Red Maple                      | 5         | 7                                     | 35                                     | 154                                  | 770                                   | 22.9%                          | 10.4%                         |
| Po   | <i>Platanus occidentalis</i>                              | American Sycamore              | 6         | 3                                     | 15                                     | 78.5                                 | 471                                   | 14.0%                          | 7.8%                          |
| Or   | <i>Quercus rubra</i>                                      | Northern Red Oak               | 5         | 7                                     | 35                                     | 154                                  | 770                                   | 22.9%                          | 6.5%                          |
| <b>MEDIUM STATURE TREES (8-12m SPREAD)</b>           |   |                                |           |                                       |  |                                      |                                       |                                |                               |
| ArA  | <i>Acer rubrum</i> 'Armstrong'                            | Armstrong Maple                | 3         | 3                                     | 7.5                                    | 78.5                                 | 235.5                                 | 7.0%                           |                               |
| Cc   | <i>Carpinus caroliniana</i>                               | Blue Beech                     | 3         | 1                                     | 3                                      | 7                                    | 21                                    | 0.6%                           | 3.9%                          |
| GS   | <i>Gleditsia triacanthos</i> f. <i>inermis</i> 'Skycolle' | Skyline Honeylocust            | 2         | 3                                     | 5                                      | 78.5                                 | 157                                   | 4.7%                           | 2.6%                          |
| <b>SMALL STATURE TREES (3-8m SPREAD)</b>             |   |                                |           |                                       |  |                                      |                                       |                                |                               |
| Ab   | <i>Abies Balsamea</i>                                     | White Spruce                   | 1         | 1                                     | 1                                      | 7                                    | 7                                     | 0.2%                           | 1.3%                          |
| Ac   | <i>Amelanchier canadensis</i>                             | Shadblow Serviceberry          | 10        | 1                                     | 10                                     | 7                                    | 70                                    | 2.1%                           | 13.0%                         |
| Pr   | <i>Pinus resinosa</i>                                     | Red Pine                       | 3         | 1                                     | 3                                      | 7                                    | 21                                    | 0.6%                           | 3.9%                          |
| GbP  | <i>Ginkgo biloba</i> 'Princeton Sentry'                   | Princeton Sentry Maidentree    | 8         | 3                                     | 24                                     | 78.5                                 | 628                                   | 18.6%                          | 10.4%                         |
| LfF  | <i>Liriodendron tulipifera</i> 'Fastigata'                | Columnar Tulip Tree            | 13        | 1                                     | 13                                     | 7                                    | 91                                    | 2.7%                           | 16.9%                         |
| PoB  | <i>Picea omorika</i> 'Brun's'                             | Brun's Serbian Spruce          | 5         | 1                                     | 5                                      | 7                                    | 35                                    | 1.0%                           |                               |
| Pg   | <i>Picea glauca</i>                                       | White Spruce                   | 9         | 1                                     | 9                                      | 7                                    | 63                                    | 1.9%                           | 18.2%                         |
| Srl  | <i>Syringa reticulata</i> 'Ivory Silk'                    | Ivory Silk Japanese Lilac Tree | 4         | 1                                     | 4                                      | 7                                    | 28                                    | 0.8%                           | 5.2%                          |
| <b>TOTAL</b>   |   |                                | <b>77</b> |                                       | <b>169.5</b>                           |                                      | <b>3367.5</b>                         | <b>100.0%</b>                  | <b>100.0%</b>                 |
| <b>TOTAL SITE AREA (m2)</b>                          |   |                                |           | <b>11636.72</b>                       |  |                                      |                                       |                                |                               |
| <b>TOTAL TREE CANOPY PERCENTAGE WHEN PLANTED (%)</b> |   |                                |           | <b>1.5%</b>                           |  |                                      |                                       |                                |                               |
| <b>TOTAL MATURE TREE CANOPY PERCENTAGE (%)</b>       |   |                                |           | <b>28.9%</b>                          |  |                                      |                                       |                                |                               |

\* MATURE TREE CANOPY AREAS ARE DERIVED FROM OAKVILLE CANOPY COVER GUIDELINES

CLIENT  
**ROHIT COMMUNITIES**

550 91 STREET SW #101, EDMONTON, AB T6X0V1

COPYRIGHT  
This drawing has been prepared solely for the intended use, thus any reproduction or distribution for any purpose other than authorized by Arcadis is forbidden. Written dimensions shall have precedence over scaled dimensions. Contractors shall verify and be responsible for all dimensions and conditions on the job, and Arcadis shall be informed of any variations from the dimensions and conditions shown on the drawing. Shop drawings shall be submitted to Arcadis for general conformance before proceeding with fabrication.

Arcadis Professional Services (Canada) Inc.  
is a part of Arcadis

| ISSUES | No. | DESCRIPTION               | DATE       |
|--------|-----|---------------------------|------------|
|        | 1   | ISSUED FOR SPA SUBMISSION | 2024-05-08 |
|        | 2   | ISSUED FOR SPA SUBMISSION | 2024-05-31 |
|        | 3   | ISSUED FOR SPA SUBMISSION | 2025-02-11 |
|        | 4   | ISSUED FOR SPA SUBMISSION | 2025-03-26 |

CONSULTANTS  
CIVIL: ARCADIS PROFESSIONAL SERVICES (CANADA) INC.  
LANDSCAPE: ARCADIS PROFESSIONAL SERVICES (CANADA) INC.  
SURVEY: ANNIS O SULLIVAN VOLLEBERG LTD  
ARCHITECTURE: NORR ARCHITECTS & ENGINEERING LTD.  
STRUCTURAL: CUNLIFFE & ASSOCIATES  
MECHANICAL: GOODKEY, WEEDMARK & ASSOCIATES LTD.  
ELECTRICAL: GOODKEY, WEEDMARK & ASSOCIATES LTD.  
OWNER: ROHIT AT WATERIDGE 5 LTD.

04272- 1232 BLOCK 6, PLAN 4M1718

SEAL

KEY PLAN

PRIME CONSULTANT

**ARCADIS**

410 Albert Street - Suite 101  
Waterloo ON N2L 3V3 Canada  
tel 519 585 2255  
www.arcadis.com

PROJECT  
**ROHIT WATERIDGE VILLAGE  
BLOCK 6**

OTTAWA, ON

PROJECT NO:  
144148

DRAWN BY: **R.S** CHECKED BY: **M.P.**

PROJECT MGR: **M.P.** APPROVED BY: **T.O.**

SHEET TITLE  
**LANDSCAPE SOIL AND  
CANOPY COVER PLANS**

SHEET NUMBER **LP4** ISSUE **4**

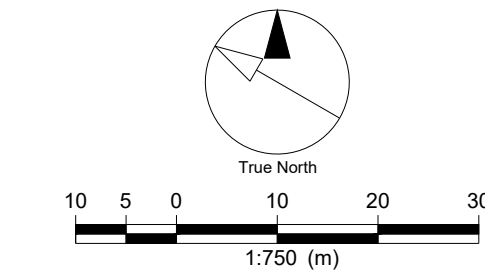



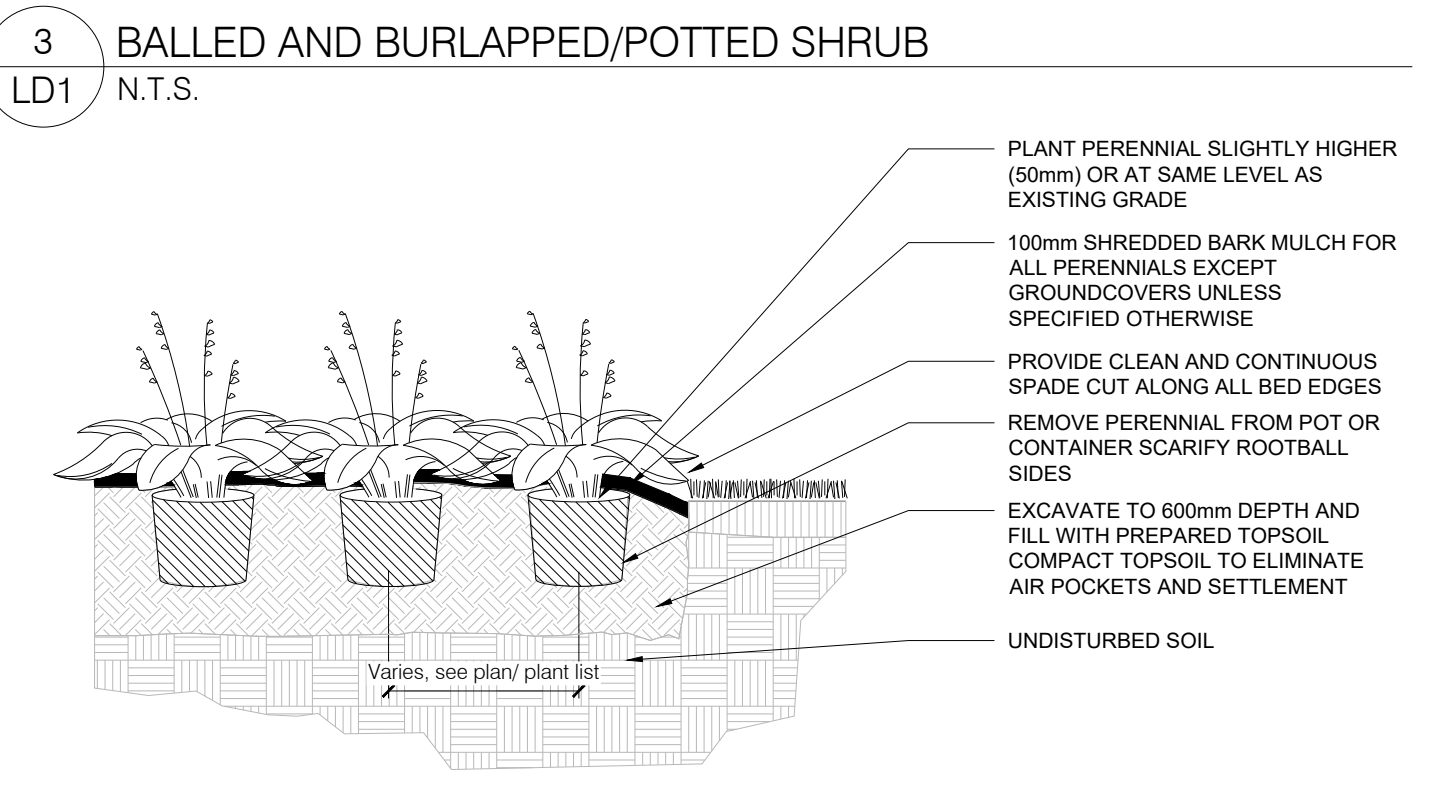
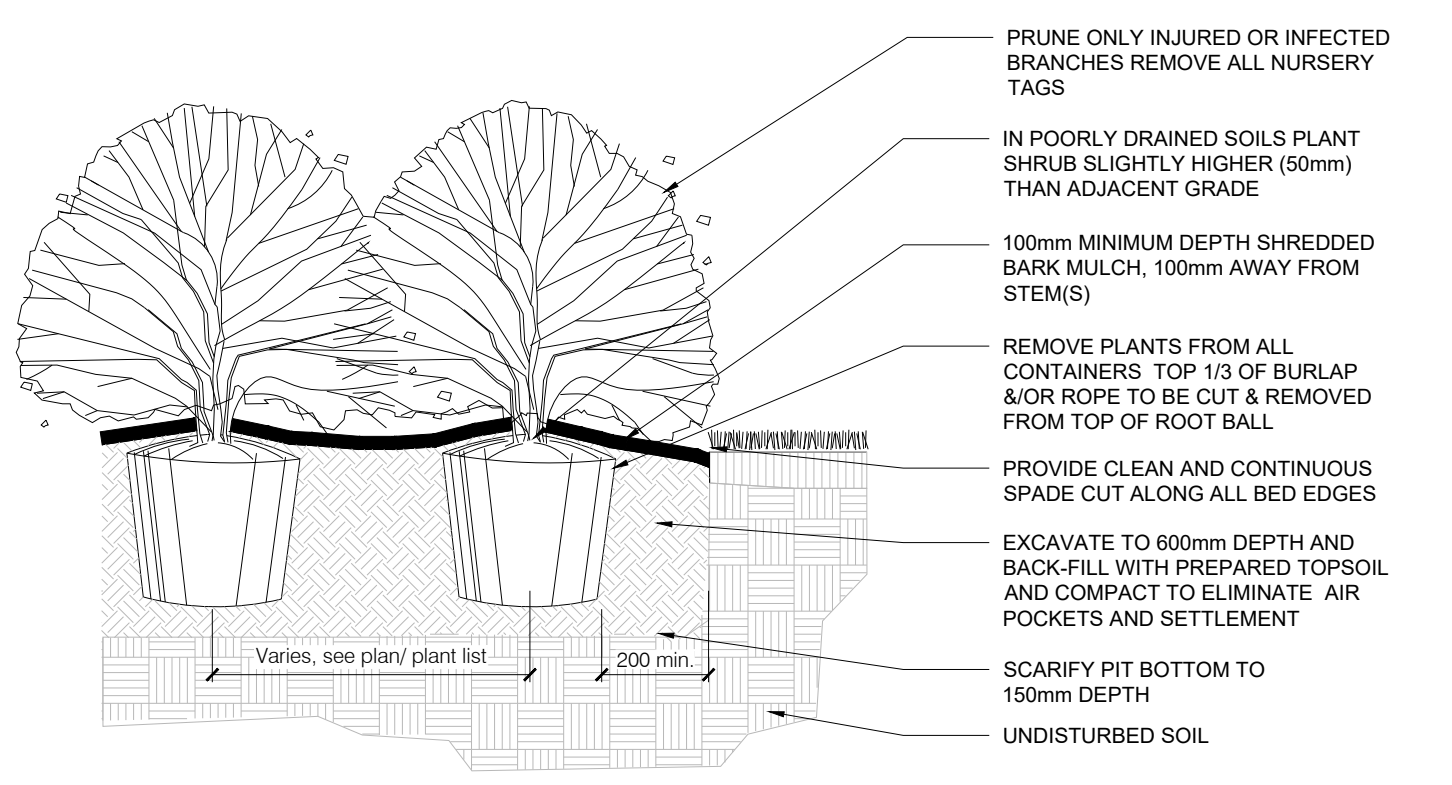
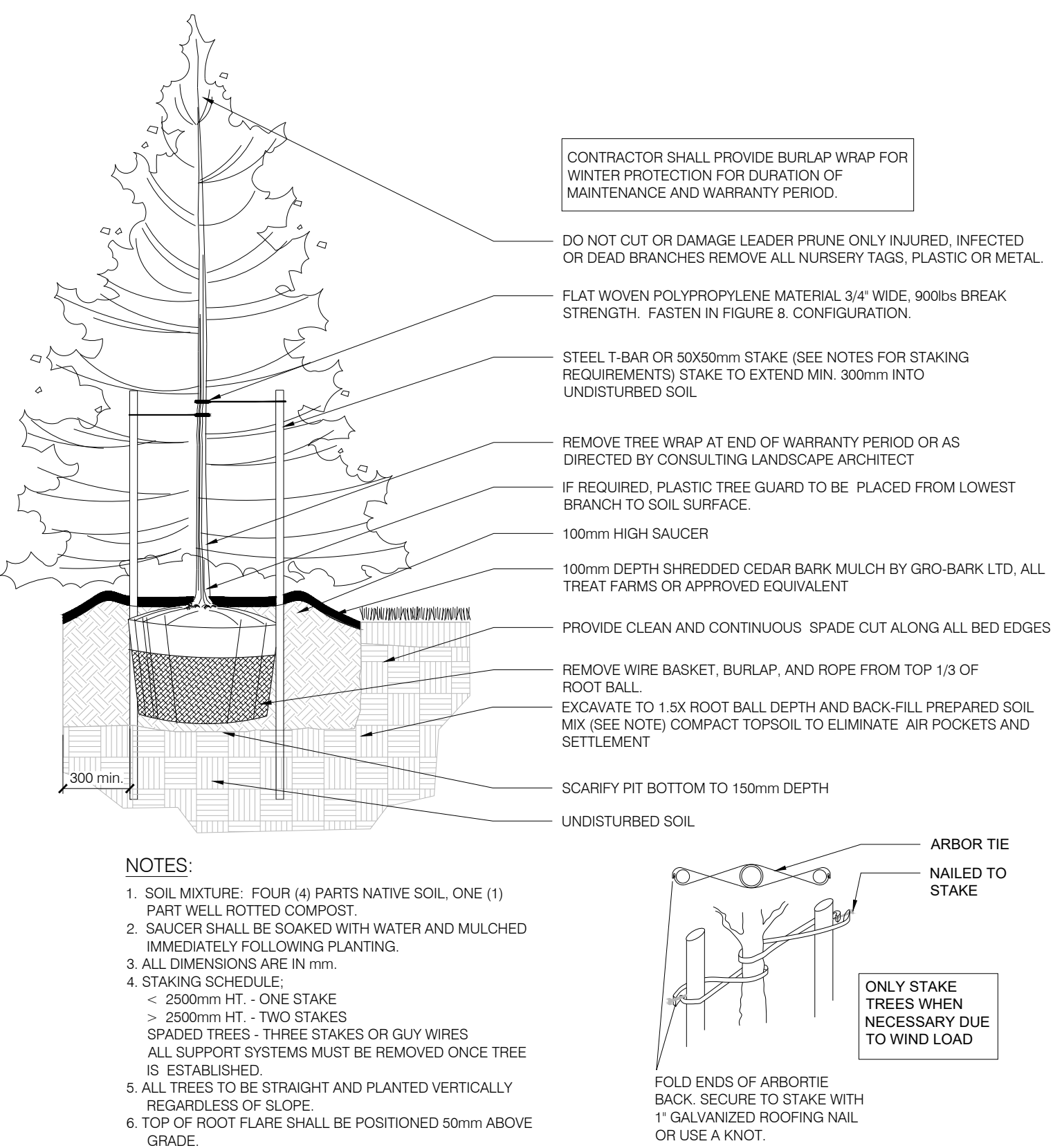
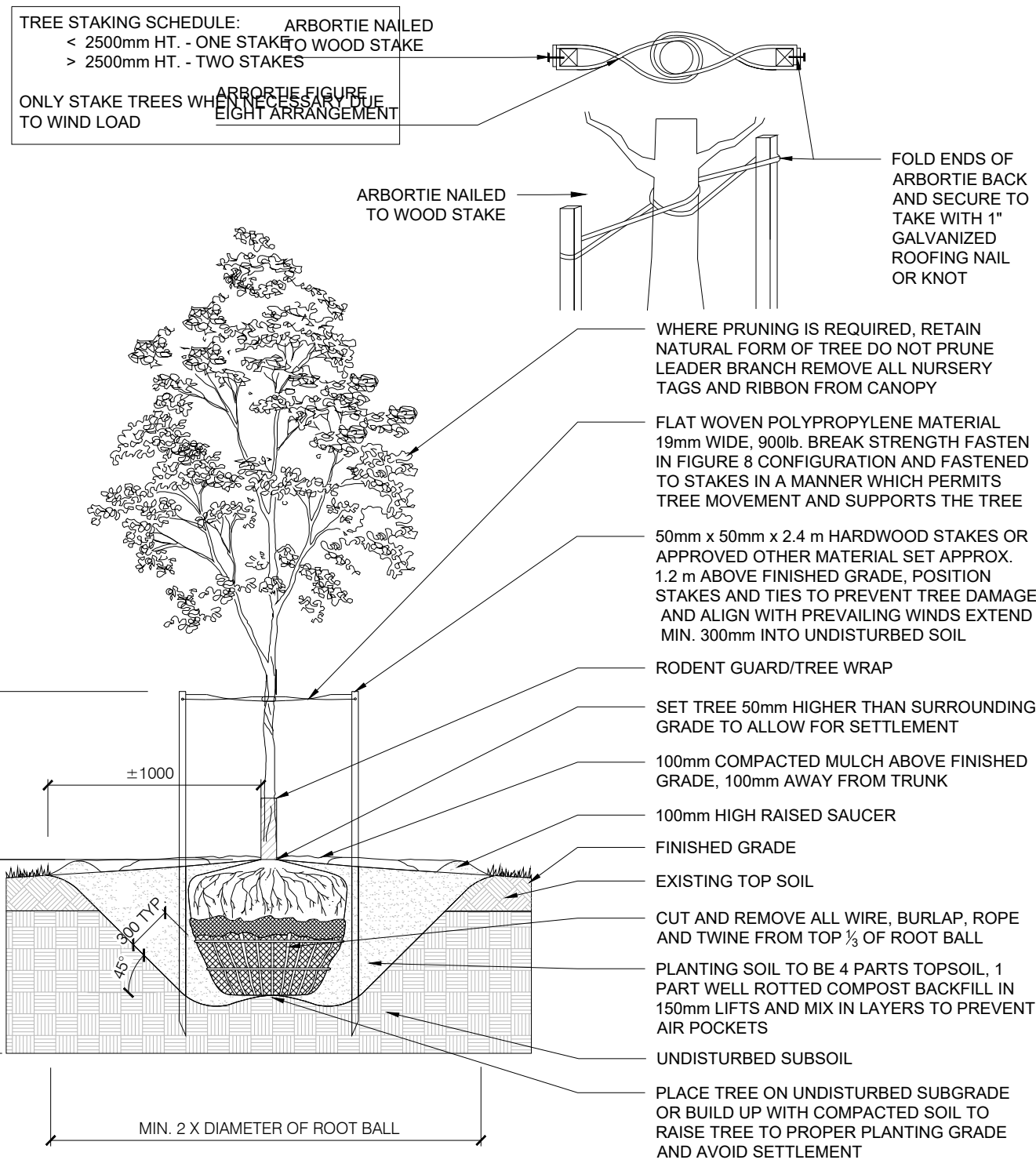

1 BALLED & BURLAPPED/WIRE BASKET DECIDUOUS LD1 N.T.S.

2 BALLED & BURLAPPED/WIRE BASKET CONIFEROUS TREE LD1 N.T.S.

3 BALLED & BURLAPPED/POTTED SHRUB LD1 N.T.S.

4 CONTAINER GROWN PERENNIAL/GRASS LD1 N.T.S.

**Maine Adirondack Chair**  
 HCSC-280 - Maine Adirondack Chair

The Maine Adirondack Chair is constructed of 100% recycled plastics, and is UV stabilized to prevent fading. This modern outdoor furniture is virtually maintenance free, and will not crack, split, rot or splinter. Available in a wide array of colour choices.

SUPPLIER: HAUSER OR APPROVED EQUIVALENT

**HAUSER SITE FURNITURE**

Width: 31.5" (80.0 cm)  
 Depth: 36.5" (92.7 cm)  
 Height: 36.5" (92.7 cm)  
 Seat Height: 14" (35.6 cm)  
 Arm Height: 22" (55.9 cm)  
 Weight: 45.0 lb (22.2 kg)

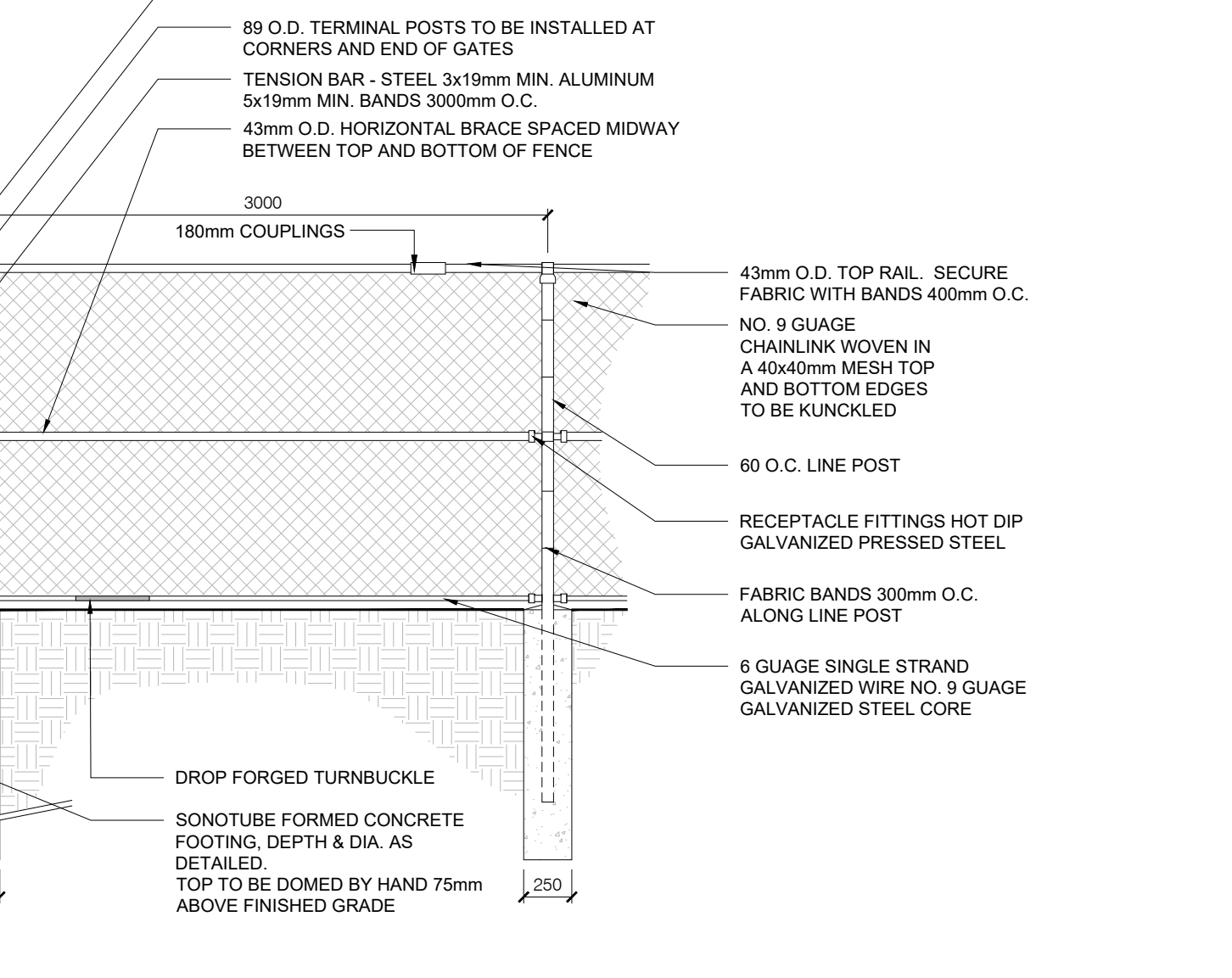
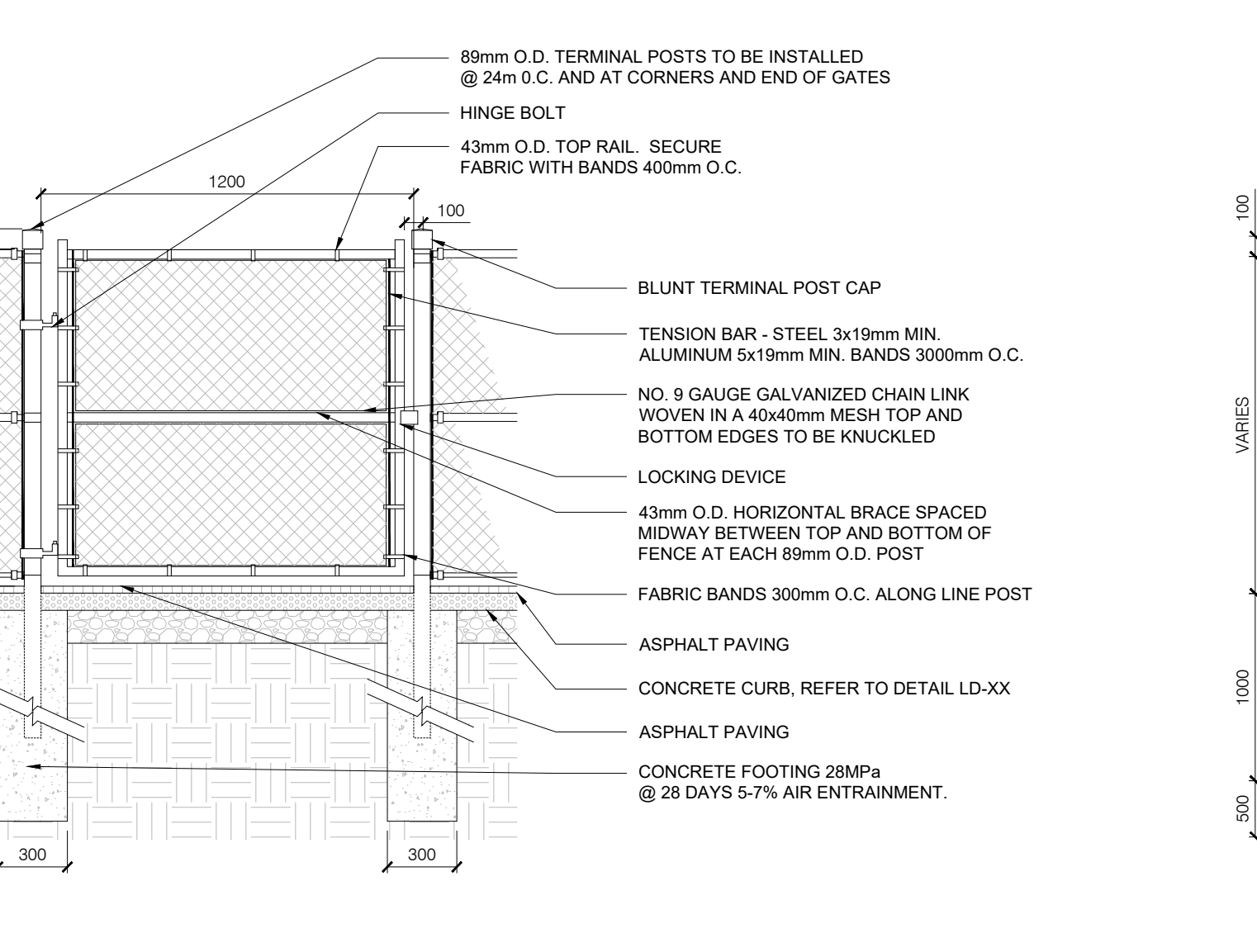

5 MUSKOKA CHAIR LD1 N.T.S.

6 CHAINLINK GATE LD1 N.T.S.

7 CHAINLINK FENCE - FENCED DOG RUN LD1 N.T.S.

SUPPLIER: ULINE  
 TELEPHONE: (905) 864-7660  
 WEBSITE: https://www.uline.ca/  
 EMAIL: customer.service@uline.ca

**PARO TABLES**

| MODEL NO. | DESCRIPTION      | SIZE W x L x H | WT. (kg) | PRICE EACH  |
|-----------|------------------|----------------|----------|-------------|
| H-8590    | 34" Square Table | 34 x 34 x 29"  | 43       | \$393 \$350 |
| H-8591    | 46" Square Table | 46 x 46 x 29"  | 61       | 491 \$459   |

SUPPLIER: ULINE  
 TELEPHONE: (905) 864-7660  
 WEBSITE: https://www.uline.ca/  
 EMAIL: customer.service@uline.ca

**DOGIPOT**

The Smart Solution To Long Holidays

PLEASE CLEAN UP AFTER YOUR DOG!

| MODEL NO. | DESCRIPTION | SIZE L x W x H | WT. (kg) | PRICE EACH  |
|-----------|-------------|----------------|----------|-------------|
| H-2897    | Dispenser   | 9 x 3 x 16"    | 7        | \$196 \$189 |

SUPPLIER: ULINE  
 TELEPHONE: (905) 864-7660  
 WEBSITE: https://www.uline.ca/  
 EMAIL: customer.service@uline.ca

**PET WASTE TRANSMITS DISEASE**

**LEASH AND CLEAN UP AFTER YOUR PET**

**PLEASE KEEP THIS AREA CLEAN**

| MODEL NO. | DESCRIPTION | SIZE W x H | WT. (kg) | PRICE EACH |
|-----------|-------------|------------|----------|------------|
| H-2898    | Sign        | 12 x 18"   | 2        | \$48 \$45  |

8 TABLE AND CHAIR - ULINE LD1 N.T.S.

9 PET WASTE RECEPTACLES - ULINE LD1 N.T.S.

10 PET WASTE SIGNAGE - ULINE LD1 N.T.S.

11 STONE MULCH LD1 N.T.S.

**CLIENT**  
 ROHIT COMMUNITIES

550 91 STREET SW #101,  
 EDMONTON, AB T6X0V1

**COPYRIGHT**  
 This drawing has been prepared solely for the intended use, thus any reproduction or distribution for any purpose other than authorized by Arcadis is forbidden. Written dimensions shall have precedence over scaled dimensions. Contractors shall verify and be responsible for all dimensions and conditions on the job, and Arcadis shall be informed of any variations from the dimensions and conditions shown on the drawing. Shop drawings shall be submitted to Arcadis for general conformance before proceeding with fabrication.

**Arcadis Professional Services (Canada) Inc.**  
 is a part of Arcadis

| ISSUES | No. | DESCRIPTION               | DATE       |
|--------|-----|---------------------------|------------|
|        | 1   | ISSUED FOR SPA SUBMISSION | 2024-03-15 |
|        | 2   | ISSUED FOR SPA SUBMISSION | 2024-04-24 |
|        | 3   | ISSUED FOR SPA SUBMISSION | 2024-05-08 |
|        | 4   | ISSUED FOR SPA SUBMISSION | 2024-05-31 |
|        | 5   | ISSUED FOR SPA SUBMISSION | 2025-02-11 |
|        | 6   | ISSUED FOR SPA SUBMISSION | 2025-03-26 |

**PLANTING NOTES**

- The Contractor must notify the Landscape Architect prior to the commencement of any planting. The Contractor shall supply all plants and materials in quantities sufficient to complete the work shown on this drawing. Any discrepancies between quantities shall be reported to the Landscape Architect.
- All landscape works will be warranted for a period of two years following inspection and written notice of start of warranty period as determined and provided by the Landscape Architect. Plant material, which is not in a healthy, vigorous growing condition at the end of the warranty period, shall be replaced to the satisfaction of the Landscape Architect / Owner.
- The Landscape Architect reserves the right to extend Contractor's warranty responsibilities for an additional year if, at the end of initial warranty period, leaf development and growth is not sufficient to ensure future survival as determined by the Landscape Architect.
- The Contractor is to identify with Landscape Architect/Owner any maintenance requirements necessary for warranty purposes.
- Plant materials specified for this project will conform to the Canadian Nursery Landscape Association (C.N.L.A.) for size, variety and condition as indicated on the plant schedule shown on these drawings. Any plant materials which do not conform will be promptly removed from the site and replaced by the Contractor at no additional cost to the project.
- The Landscape Architect is to be contacted for inspection and written approval prior to plant material arriving on site. The Landscape Architect reserved the right to reject any plant materials that have not been inspected and approved.
- The Landscape Architect reserves the right to refuse acceptance of any plant displaying poor growth habits, injury or disease. Any plant material that is rejected by the Landscape Architect will be promptly removed from the site and replaced with material of acceptable quality at no additional charge to the project.
- Plant materials collected from wild sources will not be accepted without written approval of the Landscape Architect. The Landscape Architect reserves the right to require that supplier invoices be submitted for inspection and approval prior to acceptance.
- On-site layout of the plant materials to be approved by the Landscape Architect prior to installation. Minor field adjustments to plant material locations may be necessary to respond to the locations of existing plants and site conditions. The Contractor to review with Landscape Architect where relocations are necessary. The Contractor must receive approval from Landscape Architect prior to installation.
- Plants are not to be installed during extreme heat, drought, or other undesirable conditions. Thoroughly water all plants immediately after installation. The Contractor shall regularly monitor site conditions and water as required to ensure healthy growth conditions throughout the duration of the warranty period.
- Do not plant directly in centerline of drainage swales or depression areas. Where proposed planting locations conflict with constructed swales or low-lying wet areas, contact Landscape Architect for direction.
- All plants are to be planted in accordance with the planting details shown on this drawing. All plants are to be installed vertical and plumb, regardless of ground slope.
- Supply and place topsoil in accordance with OPSS 802 to a minimum depth of 150mm in seed/sod areas and 600mm in planting beds unless otherwise specified. Each source of topsoil, imported or native to be approved by Landscape Architect prior to use. Submit topsoil analysis/test results to Landscape Architect prior to order or delivery to site. Testing to be in accordance with Contract specifications. Prepared topsoil shall be 4 parts topsoil to one part well-rotted compost.
- Mulch: to be spread uniformly around the base of trees and shrubs to a minimum depth of 100 mm. Do not place mulch in direct contact with trunk or stem(s). Allow a 100 mm mulch free zone at trunk/stems. Shrubs to be in continuously mulched planting beds unless otherwise specified.
- Supply and place seed in accordance with OPSS 804 unless otherwise specified. All 5:1 or greater slopes to be seeded with tackifier. All slopes greater than 3:1 shall be matted with an erosion control blanket. Supply and place sod in accordance with OPSS 803 unless otherwise specified.
- The Contractor is to remove dead or damaged branches on trees or shrubs. All pruning shall be performed in accordance with standard horticultural practices and appropriate timing for each species.
- All stakes and associated ties are to be removed after the first full growing season. Rodent guards are to be removed at the conclusion of the warranty period. If utilized, Gatorbags are to be removed for winter months.

**CONSULTANTS**  
 CIVIL: ARCADIS PROFESSIONAL SERVICES (CANADA) INC.  
 LANDSCAPE: ARCADIS PROFESSIONAL SERVICES (CANADA) SURVEY, ANNS, O SULLIVAN, VOLLEBERG LTD  
 ARCHITECTURE: NORR ARCHITECTS & ENGINEERING LTD.  
 STRUCTURAL: CUNIFFE & ASSOCIATES  
 MECHANICAL: GOODKIE, WEEDMARK & ASSOCIATES LTD.  
 ELECTRICAL: GOODKIE, WEEDMARK & ASSOCIATES LTD.  
 OWNER: ROHIT AT WATERIDGE 5 LTD.

04272- 1232 BLOCK 6, PLAN 4M1718

**SEAL**

**PRIME CONSULTANT**  
**ARCADIS**

410 Albert Street - Suite 101  
 Waterloo ON N2L 3V3 Canada  
 tel 519 585 2255  
 www.arcadis.com

**PROJECT**  
 ROHIT WATERIDGE VILLAGE BLOCK 6  
 OTTAWA, ON

**PROJECT NO:** 144148  
**DRAWN BY:** R.S  
**CHECKED BY:** M.P.  
**PROJECT MGR:** M.P.  
**APPROVED BY:** T.O.

**SHEET TITLE**  
 LANDSCAPE DETAILS

**SHEET NUMBER** LD1 **ISSUE** 6

File Location: J:\Ottawa\144148\_Block\_6\_Ph1\_Y\_0\_Production\7.03\_Design\05\_Landscape\Sheet\144148\_LP.dwg Last Saved: February 12, 2025, 5:26:16 PM by Shenoy Kojachery, Raahika  
 Project: March 25, 2025, 5:26:16 PM by Shenoy Kojachery, Raahika  
 Scale: 1/8" = 1'-0"



CUSTOM SIZE (5M X 5M)

**Pergola, 6.5' X 10.5' X 8' H**  
ST10-C14V-6.5x10.5-8 - Pergola

Our 'Pergola' is the ideal solution for any shade requirement. Flexible and versatile, the all-aluminum 4" x 4" post and cross beam construction has been professionally engineered to allow for an infinite number of configurations. Create smaller shade zones with this 6' x 8' pergola or scale it up to cover a more substantial footprint. Shown here with 1.5" x 4" vertically oriented cedar purlins; a variety of inset roof slat sizes and materials are available to choose from. The Pergola incorporates our proprietary Konnect System to ensure that each design is as fluid as possible, while still meeting the requisite load and wind analysis. The Hauser Konnect System, consisting of custom engineered Konnect Blocks and stainless steel countersunk hardware, ensures that each beam and column connection is seamless, strong and virtually undetectable. Built-in surface mount plates with concealed covers provide the finishing element to secure the connection. The core frame has been designed to accept a variety of lighting, charging and heat options. Create your own custom size and shape.



Width: 126" (320.0 cm)  
Depth: 78" (198.1 cm)  
Height: 96" (243.8 cm)  
Weight: 278.0 lb (126.2 kg)

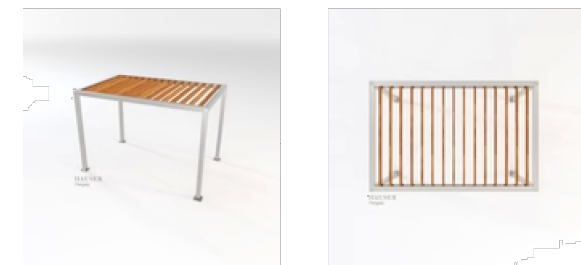

SUPPLIER: HAUSER  
TELEPHONE: (800)-268-7328  
WEBSITE: <https://hauserite.com/>  
EMAIL: [sales@hauserite.com](mailto:sales@hauserite.com)

[sales@hauserite.com](mailto:sales@hauserite.com) | 1-800-268-7328 | [hauserite.com](https://hauserite.com)

**1 HAUSER - PERGOLA**  
LD2 N.T.S.

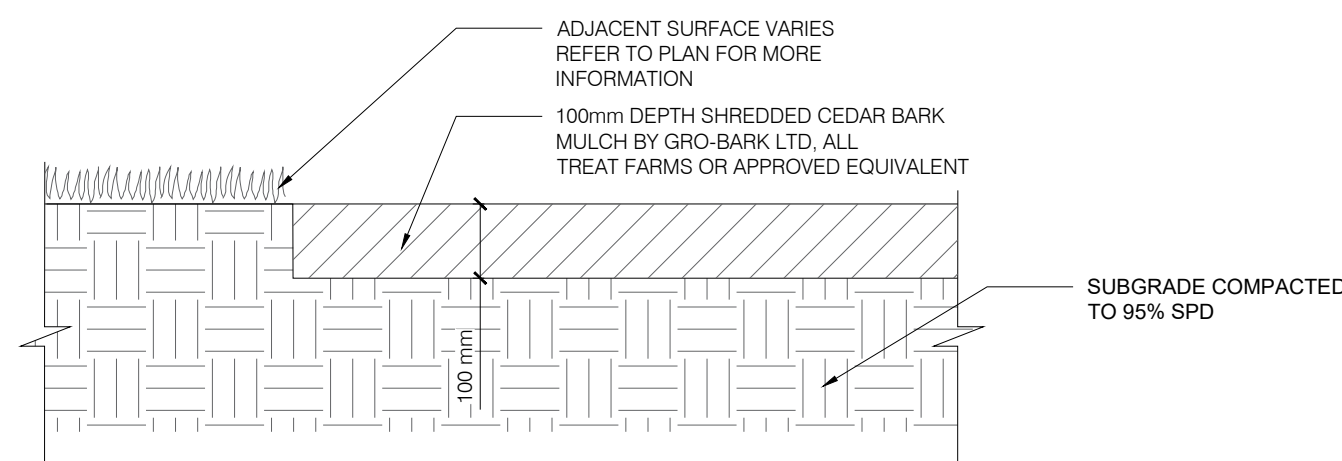

**7 WOOD CHIP MULCH**  
LD2 N.T.S.

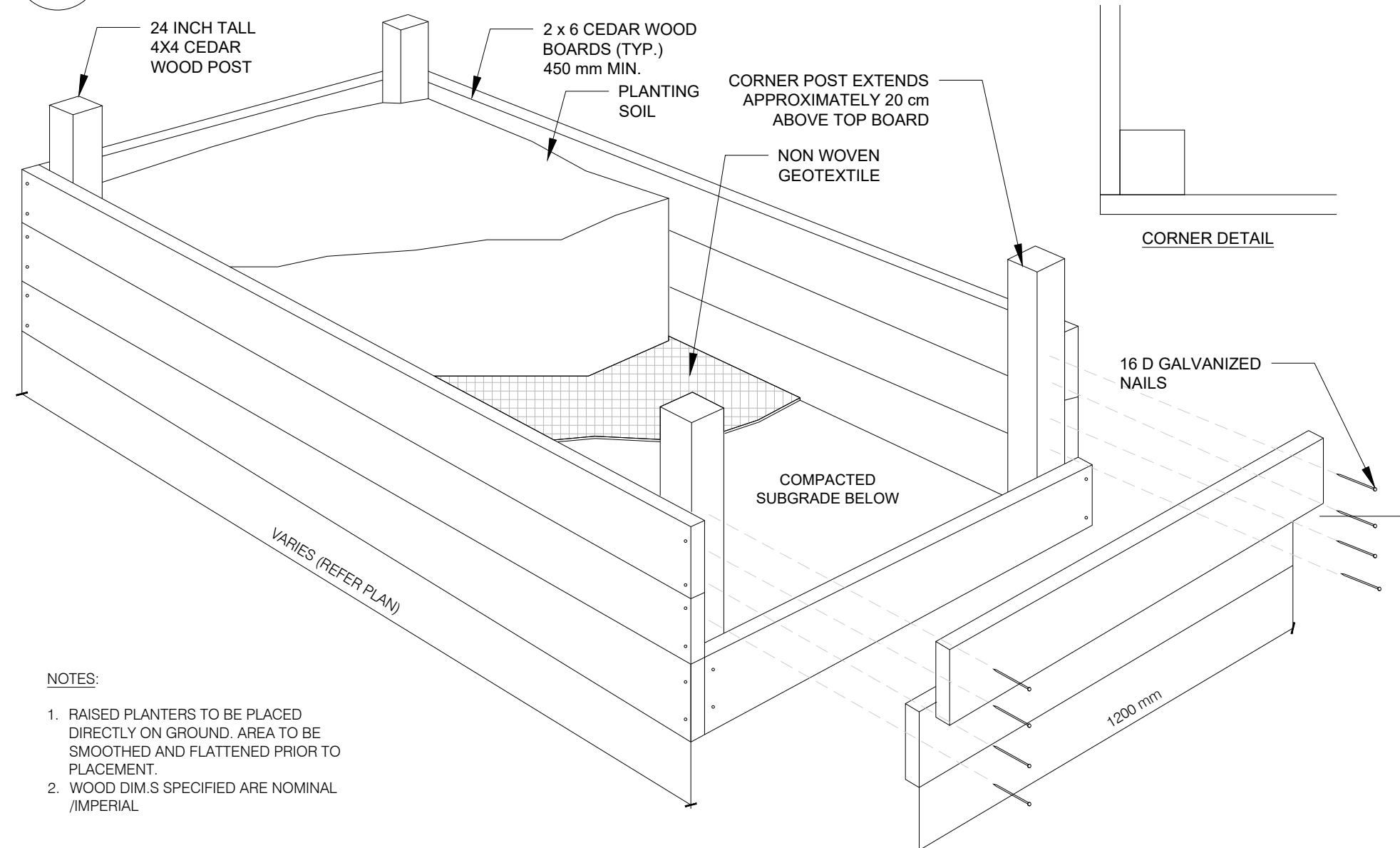

**8 RAISED PLANTING BED**  
LD2 N.T.S.

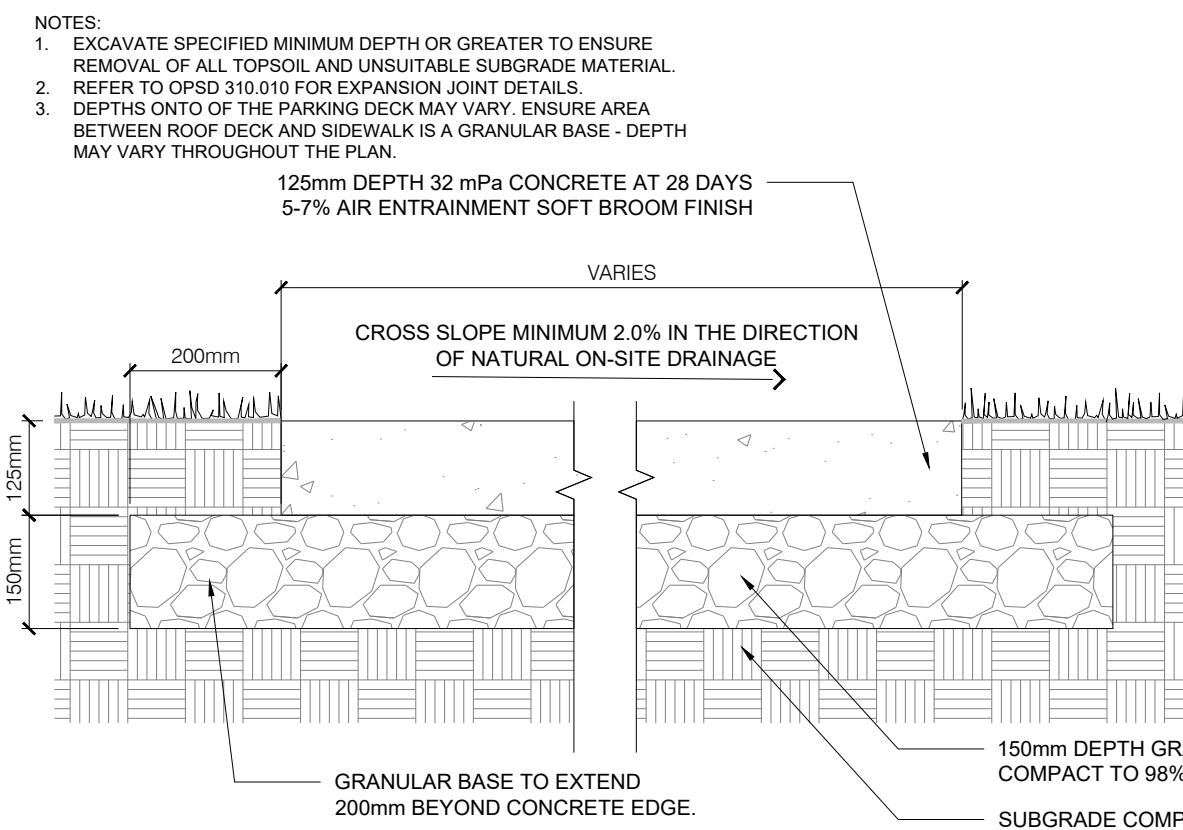

**2 CONCRETE PAVING - PEDESTRIAN**  
LD2 N.T.S.

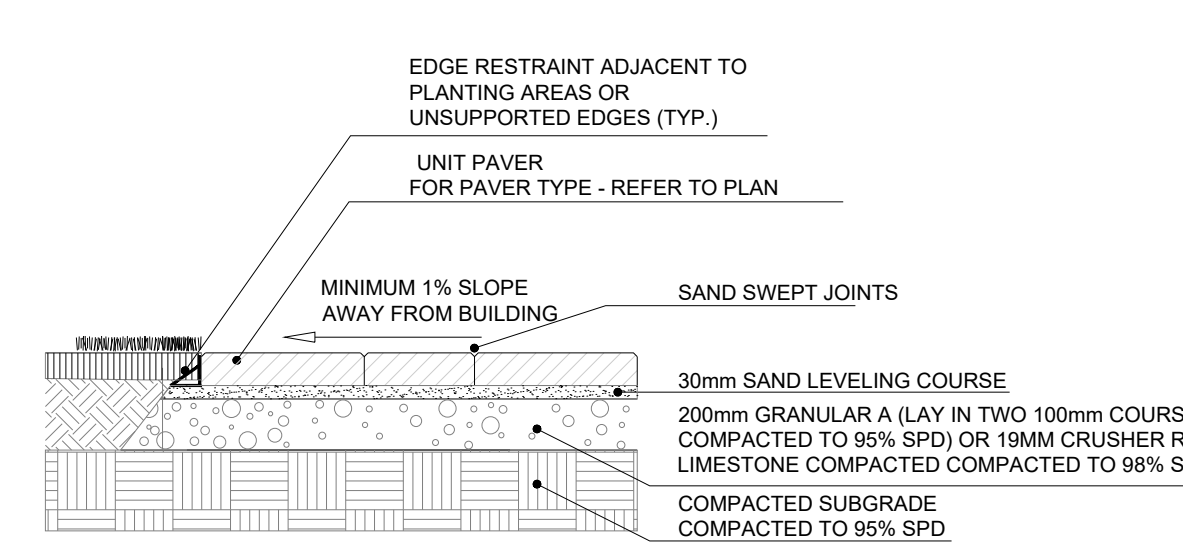

**3 UNIT PAVING**  
LD2 N.T.S.

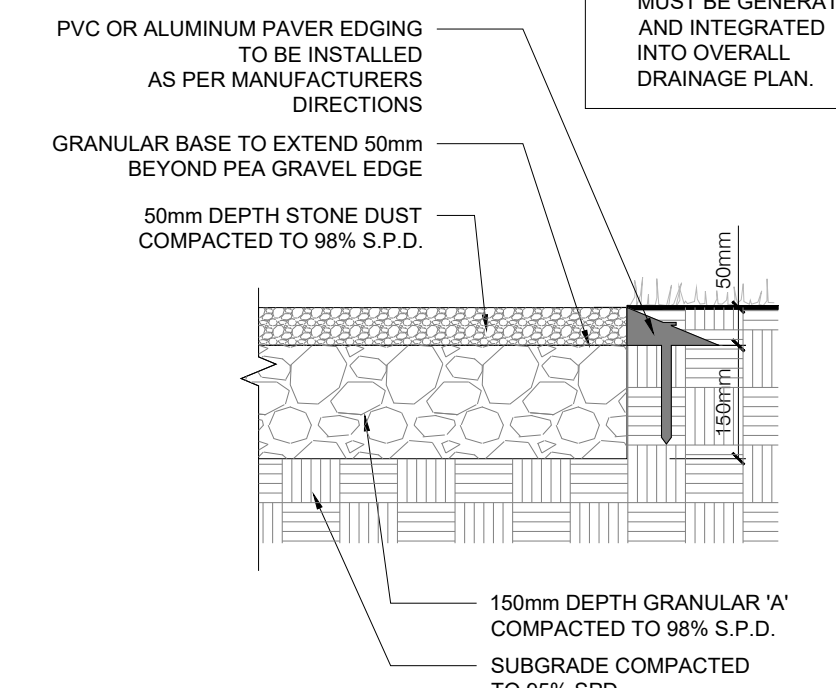

**4 STONE DUST PAVING**  
LD2 N.T.S.

**Skyline Bike Rack With Tropical Wood Accent**  
PS-78-102-21-AW Skyline Bike Rack

Our Skyline Bike Rack features an all-welded, powdercoated aluminum construction. Shown here with our 'Pewter' powdercoat finish, and an Ipe tropical wood accent. Custom sizes available upon request.



Width: 30" (76.2 cm)  
Depth: 2" (5.1 cm)  
Height: 32" (81.3 cm)



SUPPLIER: HAUSER  
TELEPHONE: (800)-268-7328  
WEBSITE: <https://hauserite.com/>  
EMAIL: [sales@hauserite.com](mailto:sales@hauserite.com)

**5 HAUSER - BIKE RACK**  
LD2 N.T.S.

**Ridgewood Bench With Arms**  
PS-692-22-AL-72-WD3-WD3-A-BD

Our 'Ridgewood' bench with Armrests features an all-welded aluminum, powdercoated frame with 'Ipe' tropical wood, envirowood, or aluminum slats. Available in a variety of sizes and finishes.



Width: 72" (182.9 cm)  
Depth: 24.43" (62.1 cm)  
Height: 30.16" (76.6 cm)  
Weight: 120.0 lb (54.5 kg)



SUPPLIER: HAUSER  
TELEPHONE: (800)-268-7328  
WEBSITE: <https://hauserite.com/>  
EMAIL: [sales@hauserite.com](mailto:sales@hauserite.com)

**6 HAUSER - BENCH**  
LD2 N.T.S.

SPECIFICATIONS:  
SUPPLIER: LUMENS  
ITEM#: BEG481342  
MFR ID: 77265-BLK  
PANEL HEIGHT: 914mm (3)  
SIZE: 9.9X 27.9  
COLOUR: GRAPHITE  
INSTALLATION TYPE: IN GROUND  
WEBSITE: <https://www.lumens.com/>  
PHONE: (877) 445-4466



**9 LUMENS - LIGHT BOLLARDS**  
LD2 N.T.S.

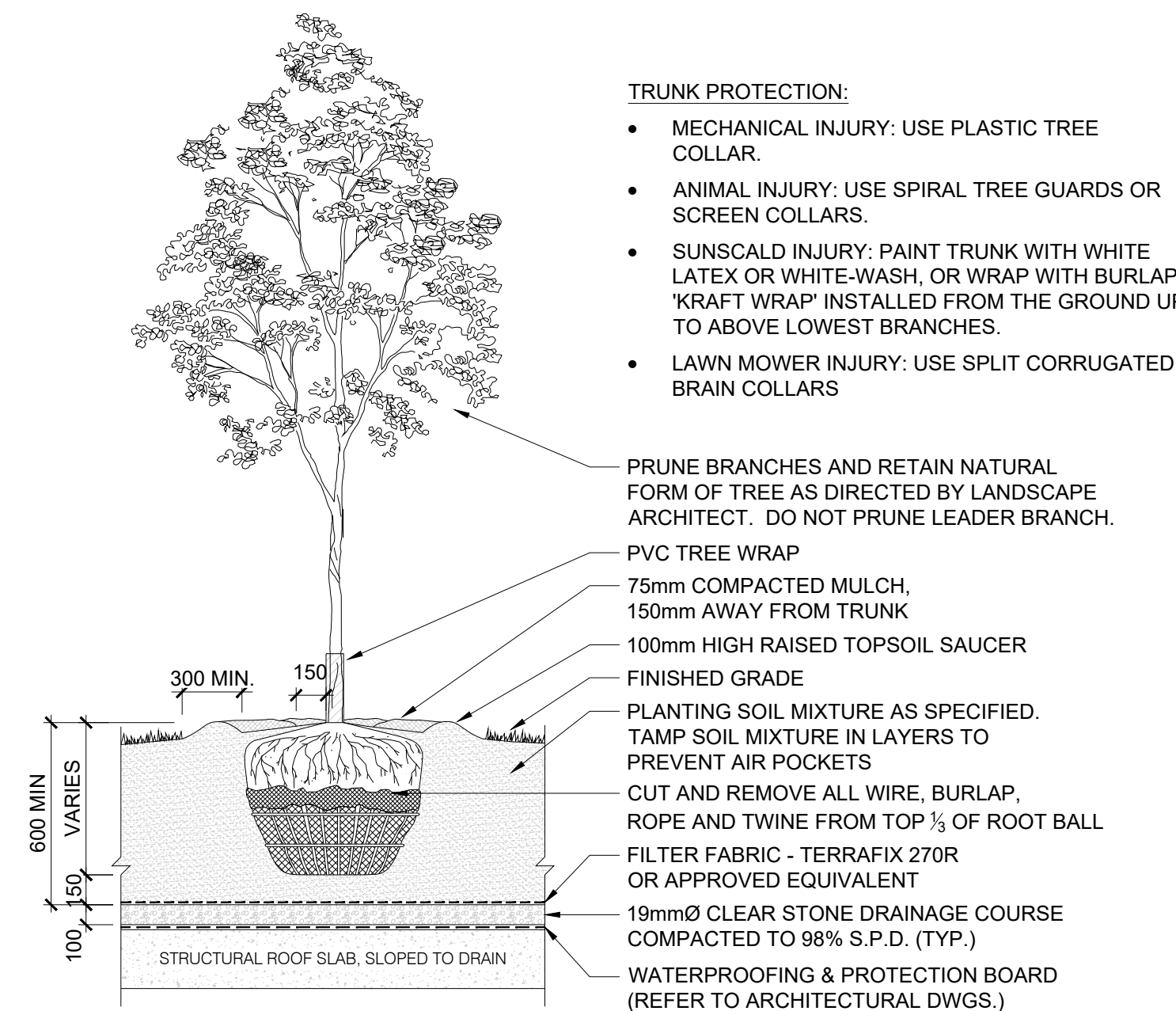

**10 TREE PLANTING ON CONCRETE BASEMENT SLAB**  
LD2 N.T.S.

- NOTES:
- DIG ALL HOLES BY HAND WHEN CLOSER THAN 1000mm TO UNDERGROUND POWER, TELEPHONE AND GAS ALIGNMENTS.
  - USE ROOT DEFLECTOR ON THE UTILITY SIDE OF REQUIRED.
  - ENSURE BASE OF TREE PIT IS STABLE IN ORDER TO MAINTAIN THE DESIRED TREE LEVEL AND GRADE
  - TREES TO BE SPRAYED WITH APPROVED ANTI-DESSICANT PRIOR TO TRANSPLANTING UNLESS PLANTED WITHIN 48 HOURS OF DIGGING (IF PLANTED IN FULL LEAF).
  - SET TREE 50mm HIGHER THAN SURROUNDING GRADE TO ALLOW FOR SETTLEMENT.
  - SCARIFY COMPACTED SUB-GRADE TO 500mm DEEP IN AREA 5 X ROOTBALL DIAMETER.
  - DIG PIT 300mm WIDER THAN ROOTBALL PERIMETER
  - MULCH WITH SHREDDED BARK OR COMPOSTED HARDWOOD CHIPS.
  - REMOVE TREE STAKES AND TREE WRAP AFTER ONE SEASON.

CLIENT  
**ROHIT COMMUNITIES**

550 91 STREET SW #101, EDMONTON, AB T6X0V1

**COPYRIGHT**  
This drawing has been prepared solely for the intended use, thus any reproduction or distribution for any purpose other than authorized by Arcadis is forbidden. Written dimensions shall have precedence over scaled dimensions. Contractors shall verify and be responsible for all dimensions and conditions on the job, and Arcadis shall be informed of any variations from the dimensions and conditions shown on the drawing. Shop drawings shall be submitted to Arcadis for general conformance before proceeding with fabrication.

Arcadis Professional Services (Canada) Inc.  
is a part of Arcadis

| No. | DESCRIPTION               | DATE       |
|-----|---------------------------|------------|
| 1   | ISSUED FOR SPA SUBMISSION | 2024-03-15 |
| 2   | ISSUED FOR SPA SUBMISSION | 2024-04-24 |
| 3   | ISSUED FOR SPA SUBMISSION | 2024-05-08 |
| 4   | ISSUED FOR SPA SUBMISSION | 2024-05-31 |
| 5   | ISSUED FOR SPA SUBMISSION | 2025-02-11 |
| 6   | ISSUED FOR SPA SUBMISSION | 2025-03-26 |

CONSULTANTS  
CIVIL: ARCADIS PROFESSIONAL SERVICES (CANADA) INC.  
LANDSCAPE: ARCADIS PROFESSIONAL SERVICES (CANADA) SURVEY, ANNIS, O SULLIVAN, VOLLEBERG LTD  
ARCHITECTURE: NORR ARCHITECTS & ENGINEERING LTD.  
STRUCTURAL: CUNLIFFE & ASSOCIATES  
MECHANICAL: GOODKEY, WEEDMARK & ASSOCIATES LTD.  
ELECTRICAL: GOODKEY, WEEDMARK & ASSOCIATES LTD.  
OWNER: ROHIT AT WATERIDGE 5 LTD.

04272- 1232 BLOCK 6, PLAN 4M1718



PRIME CONSULTANT  
**ARCADIS**  
410 Albert Street - Suite 101  
Waterloo ON N2L 3V3 Canada  
tel 519 585 2255  
[www.arcadis.com](http://www.arcadis.com)

PROJECT  
**ROHIT WATERIDGE VILLAGE BLOCK 6**  
OTTAWA, ON

PROJECT NO: 144148  
DRAWN BY: R.S  
PROJECT MGR: M.P.  
CHECKED BY: M.P.  
APPROVED BY: T.O.

SHEET TITLE  
**LANDSCAPE DETAILS**

SHEET NUMBER  
**LD2**  
ISSUE  
**6**